

DISTRICT I
P. O. Box 1980
Hobbs, NM 88241-1980

State of New Mexico
Energy, Minerals, and Natural Resources Department

Form C-102
Revised 02-10-94

Instructions on back

DISTRICT II
P. O. Drawer DD
Artesia, NM 88211-0719

OIL CONSERVATION DIVISION
P. O. Box 2088
Santa Fe, New Mexico 87504-2088

Submit to the Appropriate
District Office
State Lease - 4 copies
Fee Lease - 3 copies

☒ AMENDED REPORT

DISTRICT III
1000 Rio Brazo Rd.
Aztec, NM 87410

DISTRICT IV
P. O. Box 2088
Santa Fe, NM 87507-2088

WELL LOCATION AND ACREAGE DEDICATION PLAT

1 API Number		2 Pool Code		3 Pool Name Cedar Canyon Bone Spring					
4 Property Code		5 Property Name H B '11' FEDERAL						6 Well Number 3	
7 OGRID No.		8 Operator Name SANTA FE ENERGY RESOURCES, INC.						9 Elevation 2953'	
10 SURFACE LOCATION									
UL or lot no. N	Section 11	Township 24 SOUTH	Range 29 EAST, N.M.P.M.	Lot Ida	Feet from the 850'	North/South line SOUTH	Feet from the 2100'	East/West line WEST	County EDDY
11 "BOTTOM HOLE LOCATION IF DIFFERENT FROM SURFACE"									
UL or lot no.	Section	Township	Range	Lot Ida	Feet from the	North/South line	Feet from the	East/West line	County
12 Dedicated Acres 40		13 Joint or Infill		14 Consolidation Code		15 Order No.			

NO ALLOWABLE WELL BE ASSIGNED TO THIS COMPLETION UNTIL ALL INTERESTS HAVE BEEN CONSOLIDATED OR A NON-STANDARD UNIT HAS BEEN APPROVED BY THE DIVISION

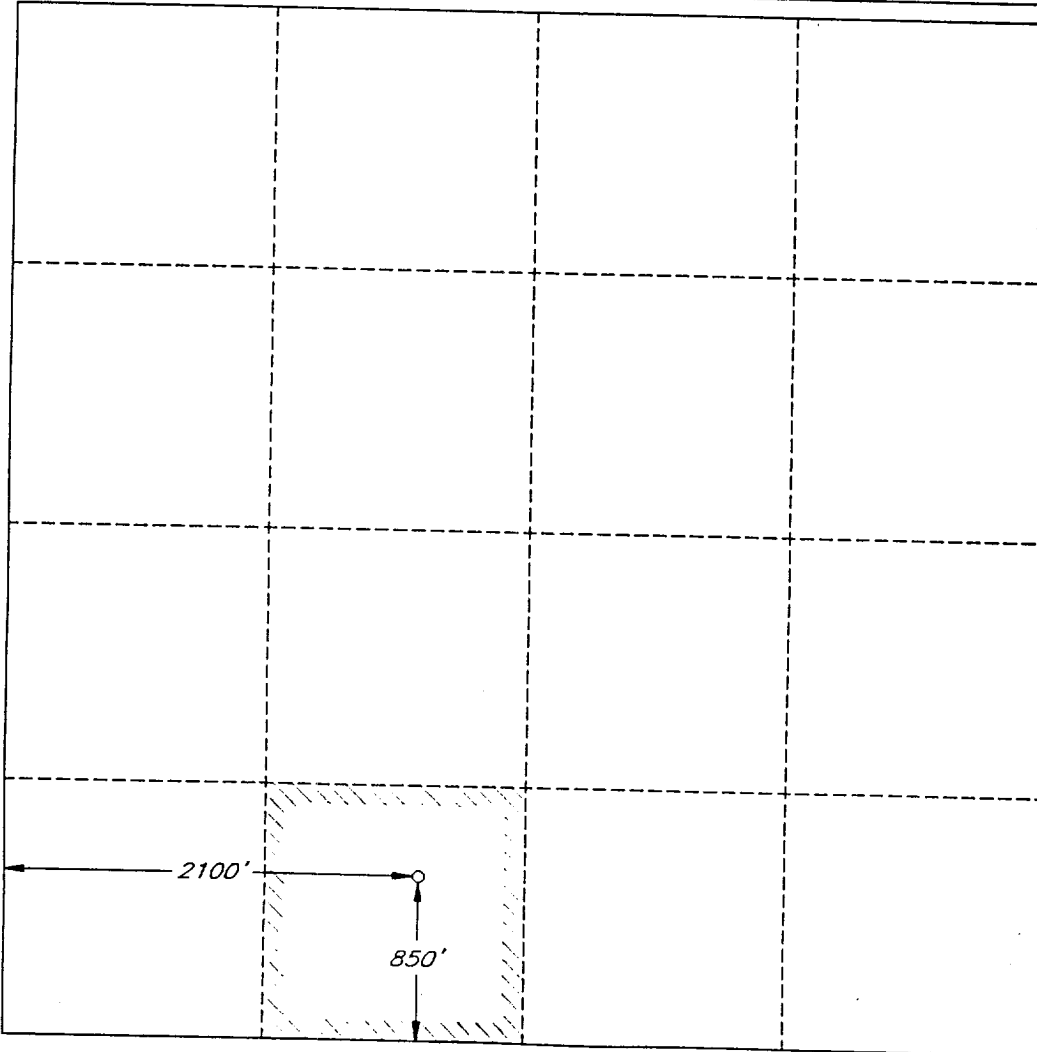

OPERATOR CERTIFICATION

I hereby certify that the information contained herein is true and complete to the best of my knowledge and belief.

Signature
James P. "Phil" Stinson

Printed Name
James P. "Phil" Stinson

Title
Agent for Santa Fe Energy

Date

SURVEYOR CERTIFICATION

I hereby certify that the well location shown on this plat was plotted from field notes of actual surveys made by me or under my supervision, and that the same is true and correct to the best of my belief.

Date of Survey
OCTOBER 31, 1998

Signature and Seal of
Professional Surveyor

V. LYNN
BEZNER
NO. 7920

Certified LAND SURVEYOR
V. L. BEZNER R.P.S. #7920

JOB #48278 / 23 NW / VHB