

District I  
PO Box 1980, Hobbs, NM 88241-1980  
District II  
PO Drawer DD, Artesia, NM 88211-0719  
District III  
1000 Rio Brazos Rd., Aztec, NM 87410  
District IV  
PO Box 2088, Santa Fe, NM 87504-2088

State of New Mexico  
Energy, Minerals & Natural Resources Department

OIL CONSERVATION DIVISION  
PO Box 2088  
Santa Fe, NM 87504-2088

Revised February 10, 1994  
Instructions on back  
Submit to Appropriate District Office  
State Lease - 6 Copies  
Fee Lease - 5 Copies

Form C-101

☐ AMENDED REPORT

APPLICATION FOR PERMIT TO DRILL, RE-ENTER, DEEPEN, PLUGBACK, OR ADD A ZONE

Operator Name and Address: Santa Fe Energy Resources, Inc. 550 W. Texas, Suite 1330 Midland, TX 79701		OGRID Number 20305
Property Code 16670	Property Name Weems	API Number 30-015-29477
		Well No. 2

Surface Location

UL or lot no.	Section	Township	Range	Lot Idn	Feet from the	North/South line	Feet from the	East/West line	County
F	27	22-S	27-E		2037	North	1901	West	Eddy

Proposed Bottom Hole Location If Different From Surface

UL or lot no.	Section	Township	Range	Lot Idn	Feet from the	North/South line	Feet from the	East/West line	County
Proposed Pool 1 22640					Proposed Pool 2				
UNDES ESPERANZA, DELAWARE									

Work Type Code N	Well Type Code O	Cable/Rotary Rotary	Lease Type Code Private	Ground Level Elevation 3116
Multiple No	Proposed Depth 5700	Formation Delaware	Contractor To be determined	Spud Date 4-15-97

Proposed Casing and Cement Program

Hole Size	Casing Size	Casing weight/foot	Setting Depth	Sacks of Cement	Estimated TOC
12 1/4"	8 5/8"	24.0	456'	310	Surface
7 7/8"	5 1/2"	17.0	5700'	475	3000'

Describe the proposed program. If this application is to DEEPEN or PLUG BACK give the data on the present productive zone and proposed new productive zone. Describe the blowout prevention program, if any. Use additional sheets if necessary.

18  
Rig up rotary tools. Set 8 5/8" casing @ 800'. WOC 1 hrs. NU 3M double ram BOP w/annular. Test casing to 1000 psi. Drill to a TD of 5700'. Run logs, either run and cement 5 1/2" casing or plug and abandon per State requirements.

Can't figure out the bottom hole location. Change casing program as follows:  
13 1/8" = 456', 7 7/8" = 5700', 5 1/2" = 5700'

I hereby certify that the information given above is true and complete to the best of my knowledge and belief.

Signature: James P. Stinson  
Printed name: James P. Stinson

Title: Agent for Santa Fe Energy

Date: Phone: (915) 682-6373

OIL CONSERVATION DIVISION

Approved by: Jim W. Beem B6A

Title: District Supervisor

Approval Date: 4-3-97 Expiration Date: 4-3-98

Conditions of Approval:  
Attached ☐

DISTRICT I  
P. O. Box 1980  
Hobbs, NM 88241-1980

State of New Mexico  
Enr Minerals, and Natural Resources Department

Form C-102  
Revised 02-10-94

Instructions on back

DISTRICT II  
P. O. Drawer DD  
Artesia, NM 88211-0719

**OIL CONSERVATION DIVISION**  
P. O. Box 2088  
Santa Fe, New Mexico 87504-2088

Submit to the Appropriate  
District Office  
State Lease - 4 copies  
Fee Lease - 3 copies

☐ AMENDED REPORT

DISTRICT IV  
P. O. Box 2088  
Santa Fe, NM 87507-2088

**WELL LOCATION AND ACREAGE DEDICATION PLAT**

1 API Number		2 Pool Code		3 Pool Name					
4 Property Code		5 Property Name <b>WEEMS</b>						6 Well Number <b>2</b>	
7 OGRID No.		8 Operator Name <b>SANTA FE ENERGY RESOURCES, INC.</b>						9 Elevation <b>3116'</b>	
10 SURFACE LOCATION									
UL or lot no. <b>F</b>	Section <b>27</b>	Township <b>22 SOUTH</b>	Range <b>27 EAST, N.M.P.M.</b>	Lot Ida	Feet from the <b>2037'</b>	North/South line <b>NORTH</b>	Feet from the <b>1901'</b>	East/West line <b>WEST</b>	County <b>EDDY</b>
11 BOTTOM HOLE LOCATION IF DIFFERENT FROM SURFACE									
UL or lot no.	Section	Township	Range	Lot Ida	Feet from the	North/South line	Feet from the	East/West line	County
12 Dedicated Acres <b>40</b>		13 Joint or Infill		14 Consolidation Code		15 Order No.			

NO ALLOWABLE WELL BE ASSIGNED TO THIS COMPLETION UNTIL ALL INTERESTS HAVE BEEN CONSOLIDATED OR A NON-STANDARD UNIT HAS BEEN APPROVED BY THE DIVISION

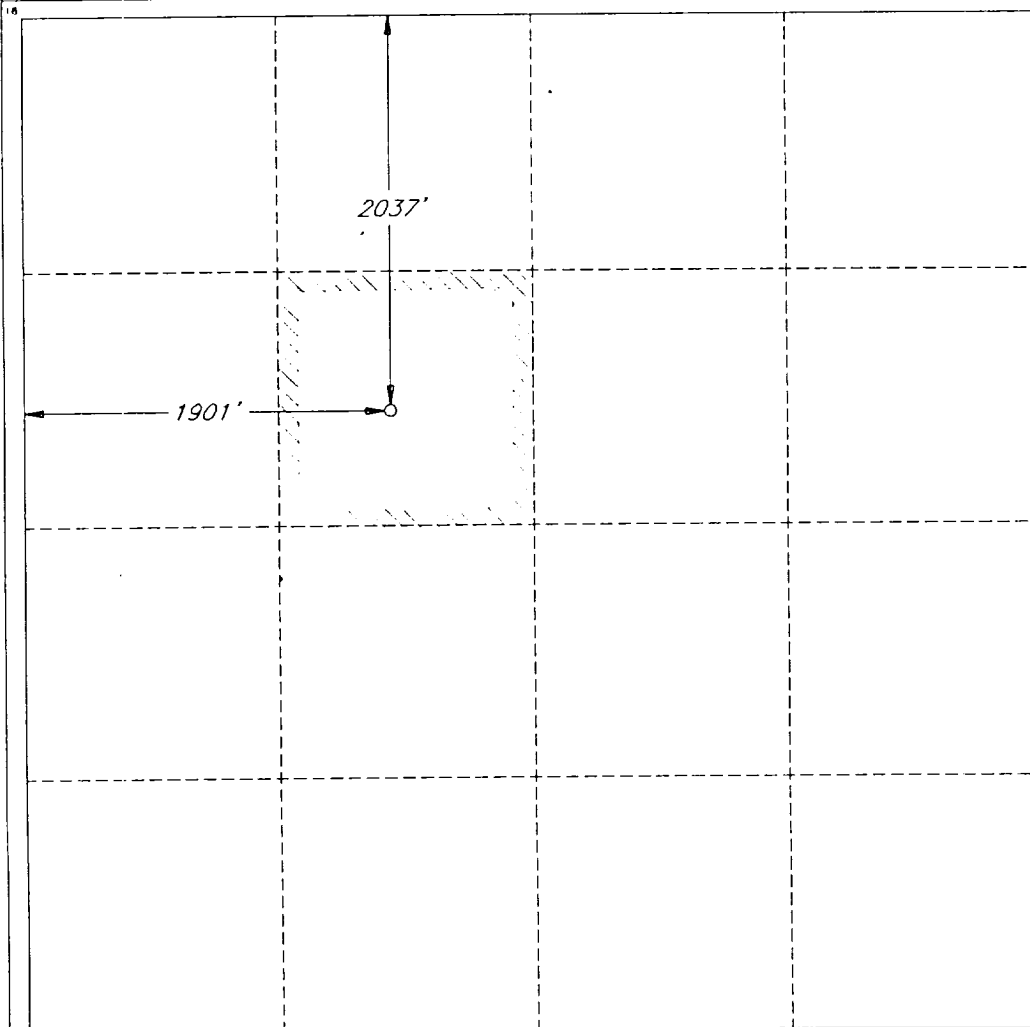

**OPERATOR CERTIFICATION**

I hereby certify that the information contained herein is true and complete to the best of my knowledge and belief.

Signature *James P. "Phil" Stinson*  
Printed Name

James P. "Phil" Stinson  
Title  
Agent for Santa Fe Energy

Date  
**3-31-97**

**SURVEYOR CERTIFICATION**

I hereby certify that the well location shown on this plat was plotted from field notes of actual surveys made by me or under my supervision, and that the same is true and correct to the best of my belief.

Date of Survey  
**MARCH 18, 1997**

Signature and Seal of  
Professional Surveyor

*Roger M. Robbins*  
Certificate No.  
**ROGER M. ROBBINS P.S. #12128**  
JOB #50687 / 49 SW / V.H.B.