

(SUBMIT IN TRIPLICATE)

UNITED STATES
DEPARTMENT OF THE INTERIOR
GEOLOGICAL SURVEY

Land Office _____

Lease No. LC 062/08

Unit _____

SUNDRY NOTICES AND REPORTS ON WELLS

NOTICE OF INTENTION TO DRILL.....	<input checked="" type="checkbox"/>	SUBSEQUENT REPORT OF WATER SHUT-OFF.....	
NOTICE OF INTENTION TO CHANGE PLANS.....		SUBSEQUENT REPORT OF SHOOTING OR ACIDIZING.....	
NOTICE OF INTENTION TO TEST WATER SHUT-OFF.....		SUBSEQUENT REPORT OF ALTERING CASING.....	
NOTICE OF INTENTION TO RE-DRILL OR REPAIR WELL.....		SUBSEQUENT REPORT OF RE-DRILLING OR REPAIR.....	
NOTICE OF INTENTION TO SHOOT OR ACIDIZE.....		SUBSEQUENT REPORT OF ABANDONMENT.....	
NOTICE OF INTENTION TO PULL OR ALTER CASING.....		SUPPLEMENTARY WELL HISTORY.....	
NOTICE OF INTENTION TO ABANDON WELL.....			

(INDICATE ABOVE BY CHECK MARK NATURE OF REPORT, NOTICE, OR OTHER DATA)

November 5, 1958

Ashland
Well No. 1 is located 660' ft. from N line and 660 ft. from W line of sec. 26
C SW SW 26 25 S. 26 E.
($\frac{1}{4}$ Sec. and Sec. No.) (Twp.) (Range) (Meridian)
Wilcox Eddy New Mexico
(Field) (County or Subdivision) (State or Territory)

The elevation of the derrick floor above sea level is 3325 ft.

DETAILS OF WORK

(State names of and expected depths to objective sands; show sizes, weights, and lengths of proposed casings; indicate mudding jobs, cementing points, and all other important proposed work)

We expect to set 150' of 8 5/8" Casing, 24# H-40 with 125 sacks cement.
We expect top of Delaware sand (Bell Canyon member) at 2088 feet. All fresh water zones will be protected and the casing program used will be according to the rules and regulations of the U.S.G.S. Well will be drilled to an approximate depth of 2200 feet with rotary tools with Cree Drilling Co., Inc. as contractor and operator.

I understand that this plan of work must receive approval in writing by the Geological Survey before operations may be commenced.

Company Cree Drilling Company, Inc.Address P. O. Box 1249,Abilene, TexasBy Charles W. LambertTitle Geologist

NEW MECISO OIL CONSERVATION COMMISSION
Well location and Acreage Dedication Plat

Section A

Date Nov. 1, 1958

Operator Cree Drilling Co. Inc. Lease ~~State~~ Federal
Well NO. 1 Unit Letter Section 26 Township 25S Range 26E N. M. P. M.
Located 660 ft from South line, 660 feet from West Line
County Eddy G. L. Elevation 3313 Dedicated Acreage 40 Acres
Name of Producing Formation Delaware Pool Wildcat

1. Is the operator the only owner in the dedicated acreage on the plat below?
yes Yes N.
2. If the answer to question one is "no", have the interests of all owners been consolidated by communitization agreement or otherwise? Yes No . If answer is "yes," Type of Consolidation
3. If the answer to question two is "no", list all owners and their respective interests below:

Owner

Land Description

RECEIVED
NOV 6 1958
U. S. GEOLOGICAL SURVEY
ARTESIA, NEW MEXICO

Section B

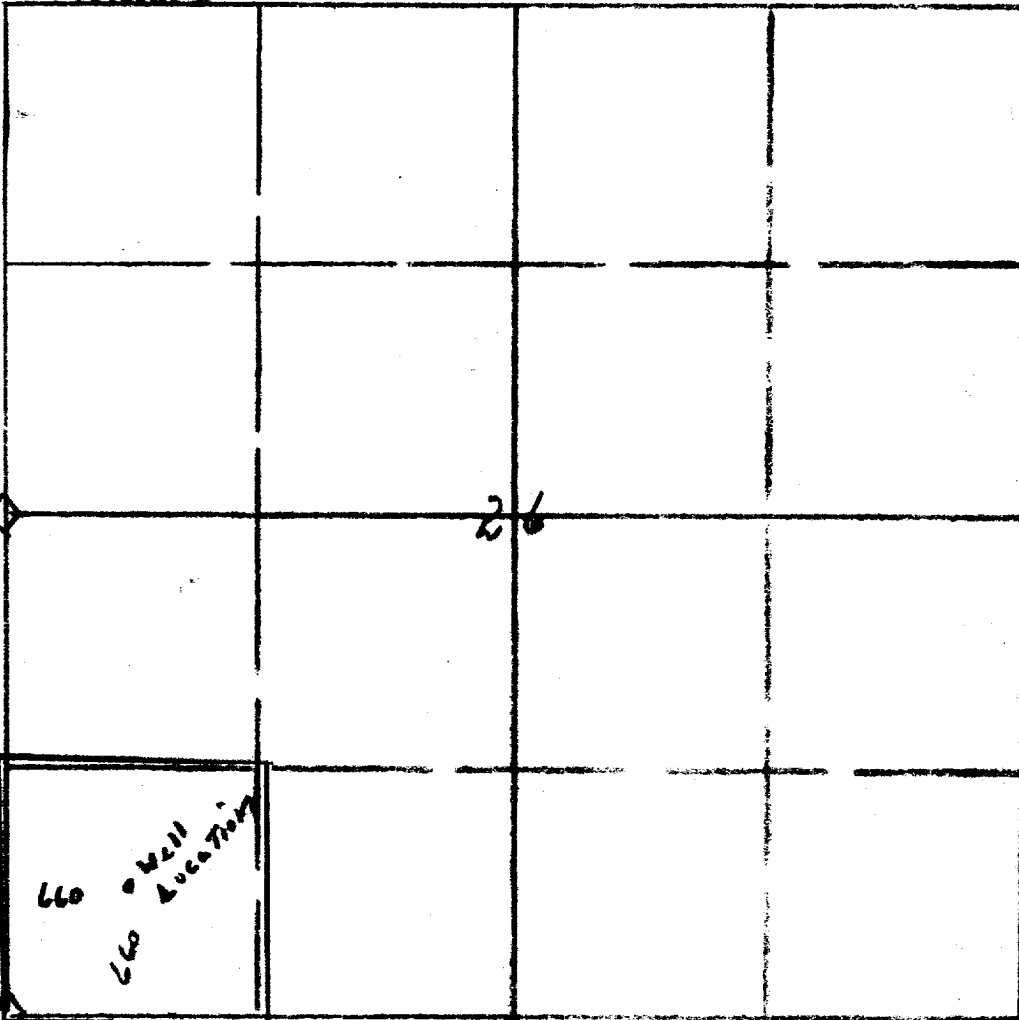

This is to certify that the information is Section A above is true and complete to the best of my knowledge and belief.

Cree Drilling Company, Inc.
(Operator)
Charles W. Lambert
(Representative)
P.O. Box 1249
Abilene, Texas
Address

This is to certify that the well location shown on the plat in Section B was plotted from field notes of actual surveys made by me or under my supervision and that the same is true and correct to the best of my knowledge and belief.

Date surveyed Oct. 31, 1958

John W. Lamb
Registered Professional
Engineer and/or Land Surveyor

Certificate No. 220