

(SUBMIT IN TRIPLICATE)

Land Office Artesia

UNITED STATES RECEIVED  
DEPARTMENT OF THE INTERIOR  
GEOLOGICAL SURVEY

File No. 42-061581

Unit 77

OCT 5 1960

O. C. C.  
ARTESIA, OFFICE

30-015-03740

SUNDRY NOTICES AND REPORTS ON WELLS

NOTICE OF INTENTION TO DRILL.....	<input checked="" type="checkbox"/>	SUBSEQUENT REPORT OF WATER SHUT-OFF.....	
NOTICE OF INTENTION TO CHANGE PLANS.....		SUBSEQUENT REPORT OF SHOOTING OR ACIDIZING.....	
NOTICE OF INTENTION TO TEST WATER SHUT-OFF.....		SUBSEQUENT REPORT OF ALTERING CASING.....	
NOTICE OF INTENTION TO RE-DRILL OR REPAIR WELL.....		SUBSEQUENT REPORT OF RE-DRILLING OR REPAIR.....	
NOTICE OF INTENTION TO SHOOT OR ACIDIZE.....		SUBSEQUENT REPORT OF ABANDONMENT.....	
NOTICE OF INTENTION TO PULL OR ALTER CASING.....		SUPPLEMENTARY WELL HISTORY.....	
NOTICE OF INTENTION TO ABANDON WELL.....			

(INDICATE ABOVE BY CHECK MARK NATURE OF REPORT, NOTICE, OR OTHER DATA)

September 28, 1960

Half-Federal Bore

Well No. 2 is located 660 ft. from N line and 1930 ft. from E line of sec. 24

1/4 of 1/4 Sec. 24 T76S R-29-E N10W  
(1/4 Sec. and Sec. No.) (Twp.) (Range) (Meridian)

Brewery Draw - Delaware (Ext) Edg. County New Mexico  
(Field) (County or Subdivision) (State or Territory)

The elevation of the ~~drill hole~~ ground level above sea level is 2987 ft.

RECEIVED

OCT 3 1960

DETAILS OF WORK

(State names of and expected depths to objective sands; show sizes, weights, and lengths of proposed casings; indicate casing points, and all other important proposed work)

Propose to drill with cable tools into the top of the Delaware Sand. Set 4 1/2" casing @ the top of the pay and cement with sufficient cement to fill up the annulus in excess of 600' through a packer shoe. Set cement plug in annulus between 4 1/2" casing and hole to fill up from 200' to 300', and set 100' of 7" casing with sufficient cement to circulate to the surface (in accordance with approval given on our Hanson-Federal #1).

Make an open hole completion in the top of the productive section of the Delaware Sand. Run 2" tubing and cased well in.

Estimated top at Delaware Line -- 173' subsea.

Estimated top at Delaware Sand -- 225' subsea.

I understand that this plan of work must receive approval in writing by the Geological Survey before operations may be commenced.

Company Curtis Hankamer

Address 1422 Bank of the Southwest Bldg.

Houston 2, Texas

By Bill C. Hankamer

Title Engineer

NEW MEXICO OIL CONSERVATION COMMISSION  
OCT 5 1960

Well Location And Acreage Dedication Plat P. C. C.

ARTESIA, OFFICE  
Date Sept. 27, 1960

Section A.

Operator Curtis Hankamer Lease ~~XXXXXX~~ Gulf-Federal Beaty  
Well No. 2 Unit Letter B Section 24 Township 26S Range 29 E NMPM  
Located 560 Feet From North Line, 1980 Feet From East Line  
County Eddy G.L.Elevation 2987 Dedicated Acreage 40 Acres  
Name of producing Formation Delaware Pool Brushy Draw *(Del.)*

1. Is the operator the only owner\* in the dedicated acreage outline on the plat below?  
Yes X No
2. If the answer to question one is "no", have the interests of all the owners been consolidated by communitization agreement or otherwise? Yes \_\_\_\_\_ No \_\_\_\_\_ If answer is "Yes," Type of consolidation \_\_\_\_\_
3. If the answer to question two is "no," list all the owners and their respective interests below.

Owner Land Description

RECEIVED

OCT 3 1960

U. S. GEOLOGICAL SURVEY  
ARTESIA, NEW MEXICO

Section B

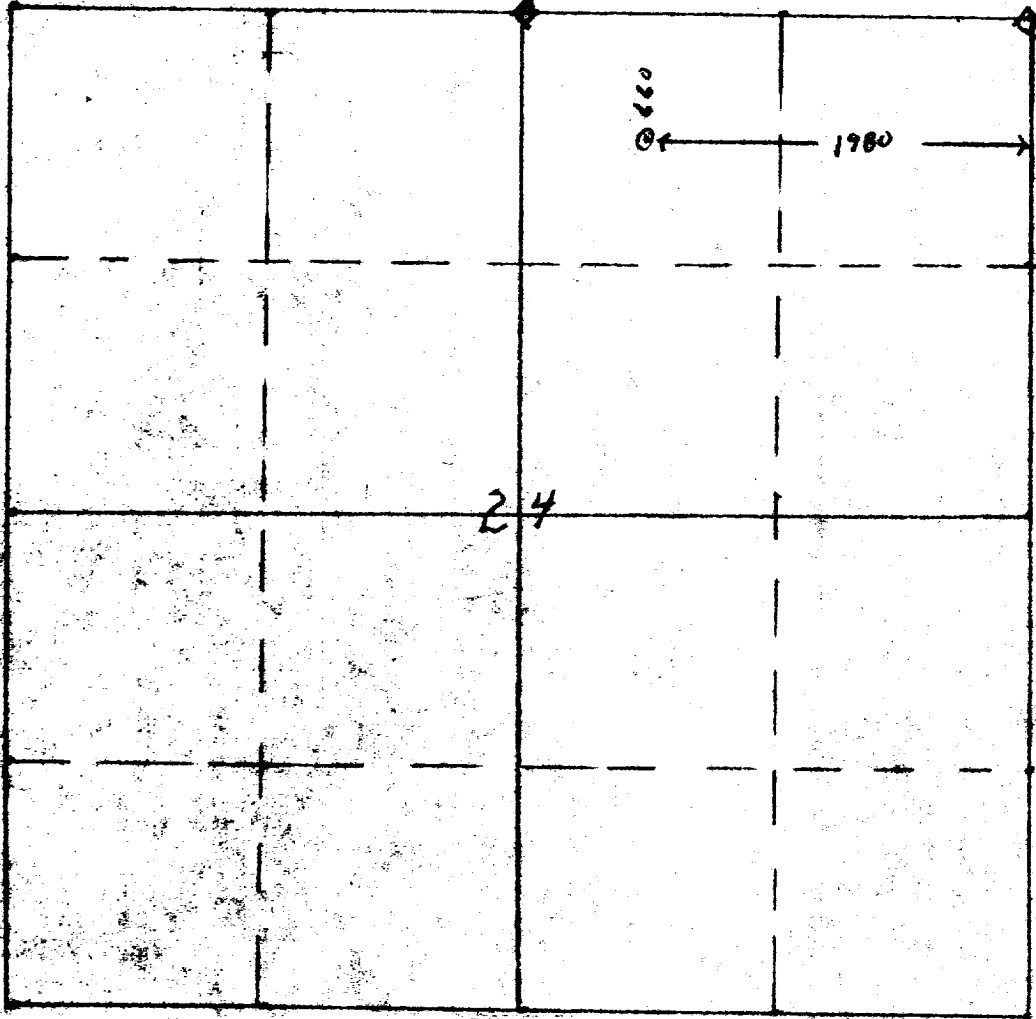

This is to certify that the information in Section A above is true and complete to the best of my knowledge and belief.

Curtis Hankamer  
(Operator)

Phil C. Hankamer  
(Representative)

1422 Bank of the Southwest Bldg  
Address Houston 2, Texas

This is to certify that the well location shown on the plat in Section B was plotted from field notes of actual surveys made by me or under my supervision and that the same is true and correct to the best of my knowledge and belief.

Date Surveyed Sept. 27, 1960

Registered Professional  
Engineer and Land Surveyor  
Certificate No. 220