

NO. OF COPIES RECEIVED	
DISTRIBUTION	
SANTA FE	
FILE	
U.S.G.S.	
LAND OFFICE	
OPERATOR	

NEW MEXICO OIL CONSERVATION COMMISSION

RECEIVED

FEB 24 1976

30-015-21742-

Form C-101
Revised 1-1-65

5A. Indicate Type of Lease STATE <input checked="" type="checkbox"/> FEE <input type="checkbox"/>
5. State Oil & Gas Lease No. K-6034
7. Unit Agreement Name
8. Farm or Lease Name Cities State
9. Well No. 1
10. Field and Pool, or Wildcat Washington Ranch-Canyon Applied For
12. County Edley
18. Proposed Depth 6100
19A. Formation Canyon
20. Rotary or C.P. Rotary
21. Operations (Show whether DP, RF, etc.) 3832.1 Ground Level
21A. Kind & Status Plug. Bond Statewide on File
21B. Drilling Contractor To be decided
22. Approx. Date Work will start April 1, 1976

APPLICATION FOR PERMIT TO DRILL, DEEPEN, OR PLUG BACK

1a. Type of Work b. Type of Well OIL WELL <input checked="" type="checkbox"/> GAS WELL <input type="checkbox"/> OTHER <input type="checkbox"/> DRILL <input checked="" type="checkbox"/> DEEPEN <input type="checkbox"/> PLUG BACK <input type="checkbox"/> SINGLE ZONE <input type="checkbox"/> MULTIPLE ZONE <input type="checkbox"/>	2. Name of Operator Black River Corporation	3. Address of Operator 620 Commercial Bank Tower, Midland, Texas 79701	4. Location of Well UNIT LETTER P LOCATED 330 FEET FROM THE South LINE AND 330 FEET FROM THE East LINE OF SEC. 32 TWP. 25 RGE. 24 NMPM
23. PROPOSED CASING AND CEMENT PROGRAM			

SIZE OF HOLE	SIZE OF CASING	WEIGHT PER FOOT	SETTING DEPTH	SACKS OF CEMENT	EST. TOP
13 1/2"	9 5/8"	36#	600	Circulate to surface	
7 7/8"	4 1/2"	10.5#	6100	275 sacks	

We propose to drill a 13 1/2" hole to approximately 600'. After setting 9 5/8" casing and circulating cement to surface will then W.O.C. a minimum of 24 hours. From this point will drill 7 7/8" hole to 6100'. A double ram B.O.P. will be used from 9 5/8" casing point to total depth. If well appears productive, 4 1/2" production casing will be set at total depth. See attached mud program

APPROVAL VALID
FOR 90 DAYS UNLESS
DRILLING COMMENCED,

EXPIRES 5-25-76

IN ABOVE SPACE DESCRIBE PROPOSED PROGRAM; IF PROPOSAL IS TO DEEPEN OR PLUG BACK, GIVE DATA ON PRESENT PRODUCTIVE ZONE AND PROPOSED NEW PRODUCTIVE ZONE. GIVE BLOWOUT PREVENTER PROGRAM, IF ANY.

I hereby certify that the information above is true and complete to the best of my knowledge and belief.

Signed Ronnie Sawyers Title Vice President Date 2-20-76

(This space for State Use)

APPROVED BY W. A. Lovett TITLE SUPERVISOR, DISTRICT II DATE FEB 25 1976

CONDITIONS OF APPROVAL, IF ANY:

Cement must be circulated to surface behind 9 5/8" casing

BLACK RIVER CORPORATION
Attachment to Form C-101
Cities State #1
330' FSL 330' FEL
Section 32: T-25-S, R-24-E
Lease K-6034, Eddy County, New Mexico

Mud Program:

The surface hole will be drilled with high viscosity gelled water containing 5 to 8 pounds per barrel of loss circulation material. The production hole will be drilled with fresh water containing lime and corrosion inhibitor to a depth of approximately 5600'. At the depth of approximately 5600', the contractor will commence converting the existing drilling fluid system to a system composed of Magcogel, Bennex, Sipan and Soda Ash. This system is to be maintained with the following required characteristics:

Weight: 8.6 to 9.0 pounds per gallon, or consistent with preventing excessive gas cutting of the system.

Viscosity: 34 to 36 or more seconds per thousand cc's.

Water Loss: 10.0 cc or less.

Sufficient material will be available to raise the weight as required.
No Wolfcamp section is present.

N MEXICO OIL CONSERVATION COMMISS
WELL LOCATION AND ACREAGE DEDICATION PLAT

Form C-102
 Supersedes C-128
 Effective 1-1-65

All distances must be from the outer boundaries of the Section

Operator BLACK RIVER CORP.			Lease Cities-State		Well No. 1
Section P	Section 32	Township 25 South	Range 24 East	County Eddy	
Actual Well Location of Well: 330 feet from the south line and 330 feet from the east line					
Ground Elev. 3832.1	Producing Formation Canyon	Pool: Washington-Raney-Canyon Applied For <i>Ind.</i>		Dedicated Acreage: 40 Acres	

- 1 Outline the acreage dedicated to the subject well by colored pencil or hatchure marks on the plat below.
- 2 If more than one lease is dedicated to the well, outline each and identify the ownership thereof (both as to working interest and royalty).
3. If more than one lease of different ownership is dedicated to the well, have the interests of all owners been consolidated by communitization, unitization, force-pooling, etc?

☐ Yes ☐ No If answer is "yes," type of consolidation _____

If answer is "no," list the owners and tract descriptions which have actually been consolidated. (Use reverse side of this form if necessary.) _____

No allowable will be assigned to the well until all interests have been consolidated (by communitization, unitization, forced-pooling, or otherwise) or until a non-standard unit, eliminating such interests, has been approved by the Commission.

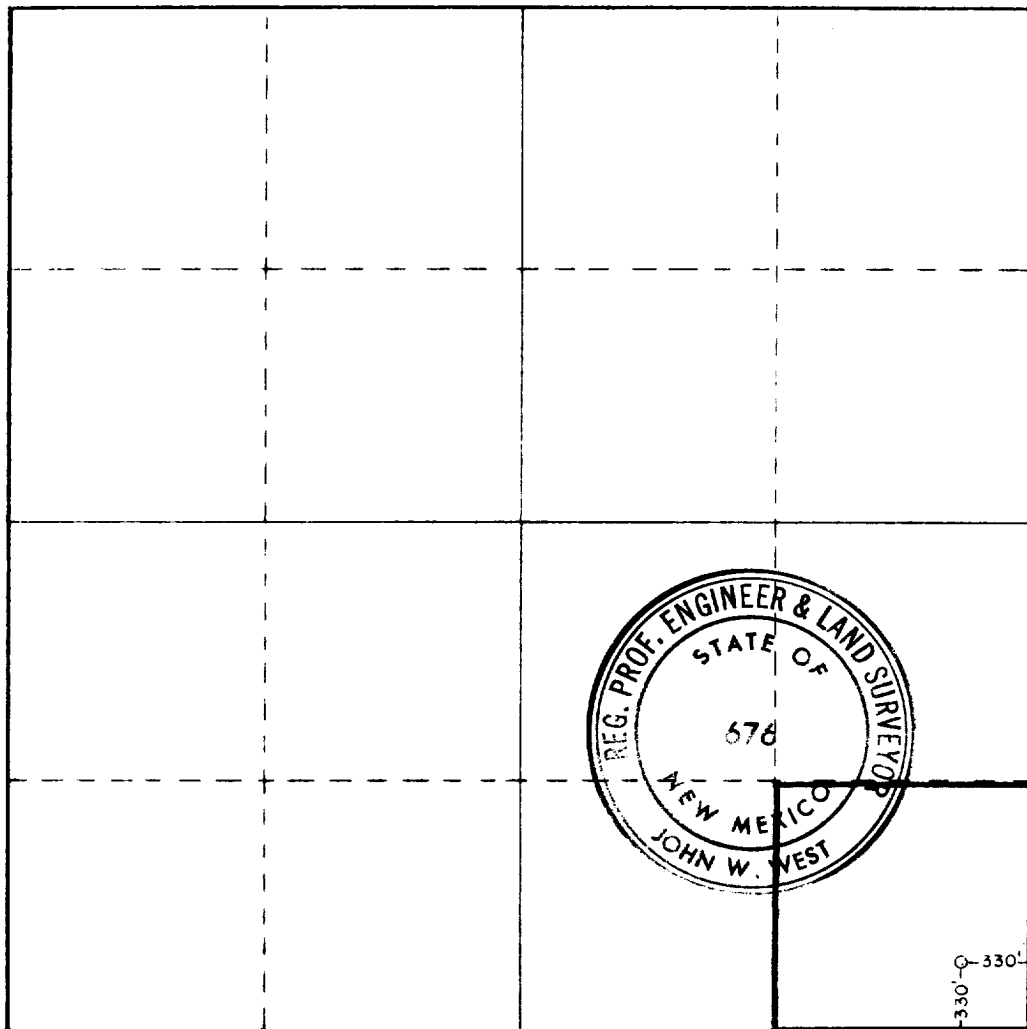

CERTIFICATION

I hereby certify that the information contained herein is true and complete to the best of my knowledge and belief.

Name
Ronnie Lowder
 Position
Vice President
 Company
Black River Corporation
 Date
2-19-76

I hereby certify that the well location shown on this plat was plotted from field notes of actual surveys made by me or under my supervision, and that the same is true and correct to the best of my knowledge and belief.

Date Surveyed
Feb. 11, 1976
 Registered Professional Engineer and/or Land Surveyor

John W. West
 Certificate No. **676**

