

Submit to Appropriate
District Office
State Lease - 6 copies
Fee Lease - 5 copies

State of New Mexico
Energy, Minerals and Natural Resources Department

Form C-101
Revised 1-1-89

OIL CONSERVATION DIVISION
P.O. Box 2088
Santa Fe, New Mexico 87504-2088

DISTRICT I
P.O. Box 1980, Hobbs, NM 88240

DISTRICT II
P.O. Drawer DD, Artesia, NM 88210

DISTRICT III
1000 Rio Brazos Rd., Aztec, NM 87410

API NO. (assigned by OCD on New Wells)
30-015-26105

5. Indicate Type of Lease
STATE ☒ FEE ☐

6. State Oil & Gas Lease No.
V-1085

7. Lease Name or Unit Agreement Name
East Apple State Unit

8. Well No.
1

9. Pool name or Wildcat
Wildcat

APPLICATION FOR PERMIT TO DRILL, DEEPEN, OR PLUG BACK

1a. Type of Work:
DRILL ☒ RE-ENTER ☐ DEEPEN ☐ PLUG BACK ☐

b. Type of Well:
OIL WELL ☒ GAS WELL ☐ OTHER ☐
SINGLE ZONE ☐ MULTIPLE ZONE ☐

2. Name of Operator
Yates Petroleum Corporation

3. Address of Operator
105 South Fourth Street, Artesia, N.M. 88210

4. Well Location
Unit Letter G : 1980' Feet From The North Line and 1980' Feet From The East Line
Section 5 Township 26S Range 28E NMPM Eddy County

10. Proposed Depth
8400'

11. Formation
Bone Springs

12. Rotary or C.T.
Rotary

13. Elevations (Show whether DF, RT, GR, etc.)
3026 GL

14. Kind & Status Plug. Bond
Blanket

15. Drilling Contractor
undesignated

16. Approx. Date Work will start
ASAP

17. PROPOSED CASING AND CEMENT PROGRAM

SIZE OF HOLE	SIZE OF CASING	WEIGHT PER FOOT	SETTING DEPTH	SACKS OF CEMENT	EST. TOP
17 1/2"	13 3/8"	54.5# J-55	Approx. 375'	350 sacks	circulated
12 1/4"	8 5/8"	24# J-55	Approx. 3150'	1000 sacks	circulated
7 7/8"	5 1/2"	15 & 17# J-55	TD	300 sacks	

We propose to drill and test the Bone Springs and intermediate formations. Approximately 3150' of surface casing will be set and cement circulated to surface. If commercial, production casing will be run and cement with adequate cover, perforated, and stimulated as needed for production.

MUD PROGRAM: FW to 375', fresh water to 3150', cut brine, SW gel to TD.

BOP PROGRAM: BOP's and hydril on 8 5/8" casing and pipe rams tested daily for operational.

APPROVAL VALID FOR 180 DAYS
PERMIT EXPIRES 10-24-89
UNLESS DRILLING UNDERWAY

IN ABOVE SPACE DESCRIBE PROPOSED PROGRAM: IF PROPOSAL IS TO DEEPEN OR PLUG BACK, GIVE DATA ON PRESENT PRODUCTIVE ZONE AND PROPOSED NEW PRODUCTIVE ZONE. GIVE BLOWOUT PREVENTER PROGRAM, IF ANY.

I hereby certify that the information above is true and complete to the best of my knowledge and belief.

SIGNATURE Ken Beardemphl TITLE Landman DATE 4/20/89
TYPE OR PRINT NAME Ken Beardemphl TELEPHONE NO. 748-1471

(This space for State Use)

Original Signed By
Mike Williams

APPROVED BY _____ TITLE _____ DATE _____

CONDITIONS OF APPROVAL, IF ANY:

APR 24 1989

NEW MEXICO OIL CONSERVATION COMMISSION
WELL LOCATION AND ACREAGE DEDICATION PLAT

Form C-102
Supersedes C-128
Effective 1-1-65

All distances must be from the outer boundaries of the Section.

Operator YATES PETROLEUM CORPORATION			Lease East Apple State Unit		Well No. 1
Unit Letter G	Section 5	Township 26 South	Range 28 East	County Eddy County, N.M.	
Actual Footage Location of Well: 1980 feet from the North line and 1980 feet from the East line					
Ground Level Elev. 3026.	Producing Formation BONE SPRINGS	Pool Wild cat		Dedicated Acreage: 40 Acres	

1. Outline the acreage dedicated to the subject well by colored pencil or hatchure marks on the plat below.
2. If more than one lease is dedicated to the well, outline each and identify the ownership thereof (both as to working interest and royalty).
3. If more than one lease of different ownership is dedicated to the well, have the interests of all owners been consolidated by communitization, unitization, force-pooling, etc?

☐ Yes ☐ No If answer is "yes," type of consolidation _____

If answer is "no," list the owners and tract descriptions which have actually been consolidated. (Use reverse side of this form if necessary.) _____

No allowable will be assigned to the well until all interests have been consolidated (by communitization, unitization, forced-pooling, or otherwise) or until a non-standard unit, eliminating such interests, has been approved by the Commission.

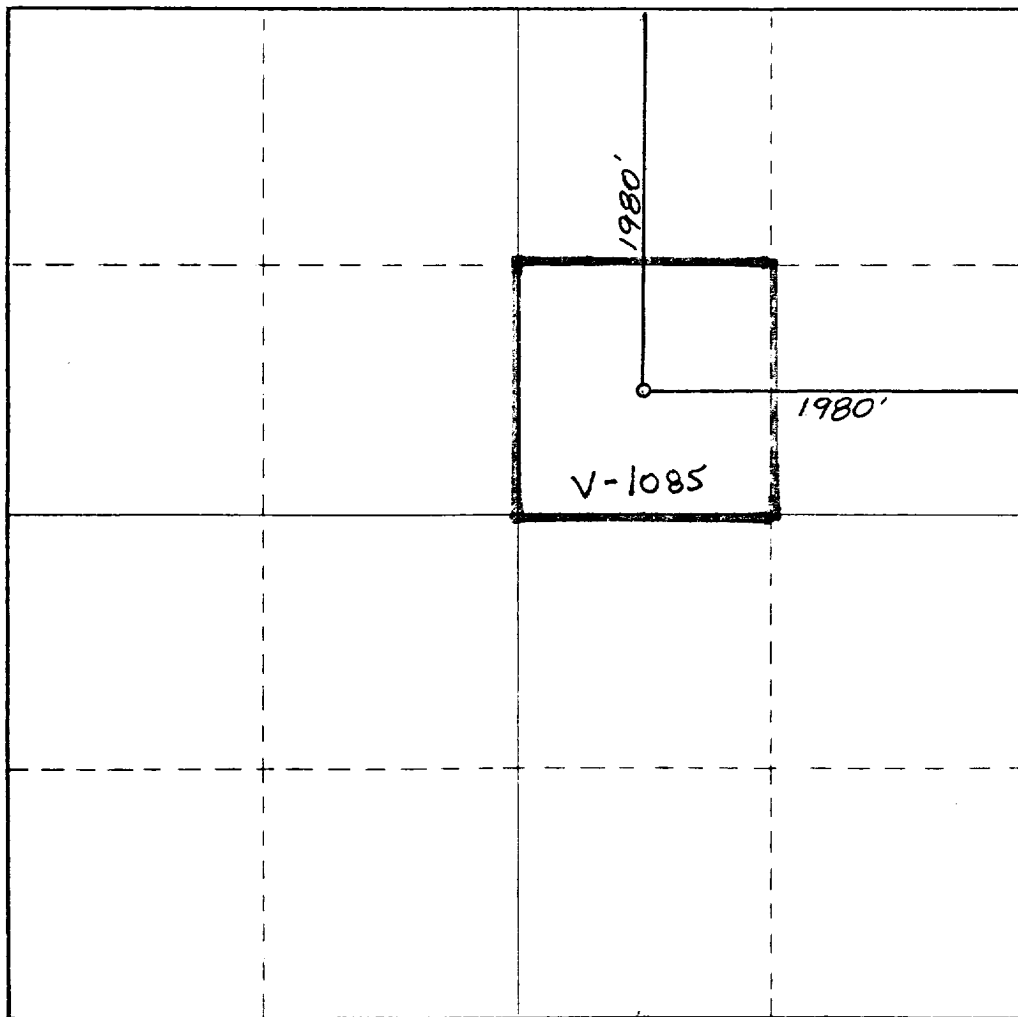

CERTIFICATION

I hereby certify that the information contained herein is true and complete to the best of my knowledge and belief.

Ken Beaudoult

Name

LAWSON

Position

Yates Pet. Corp.

Company

4-20-89

Date

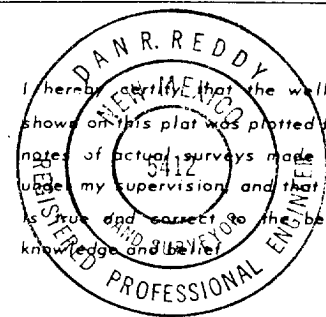

I hereby certify that the well location shown on this plat was plotted from field notes of actual surveys made by me or under my supervision and that the same is true and correct to the best of my knowledge and belief.

Date Surveyed

March 20, 1989

Registered Professional Engineer and/or Land Surveyor

Dan R. Reddy

Certificate No.

NM PE&LS NO. 5412

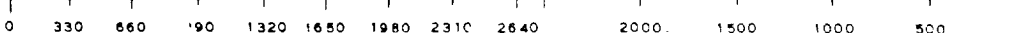

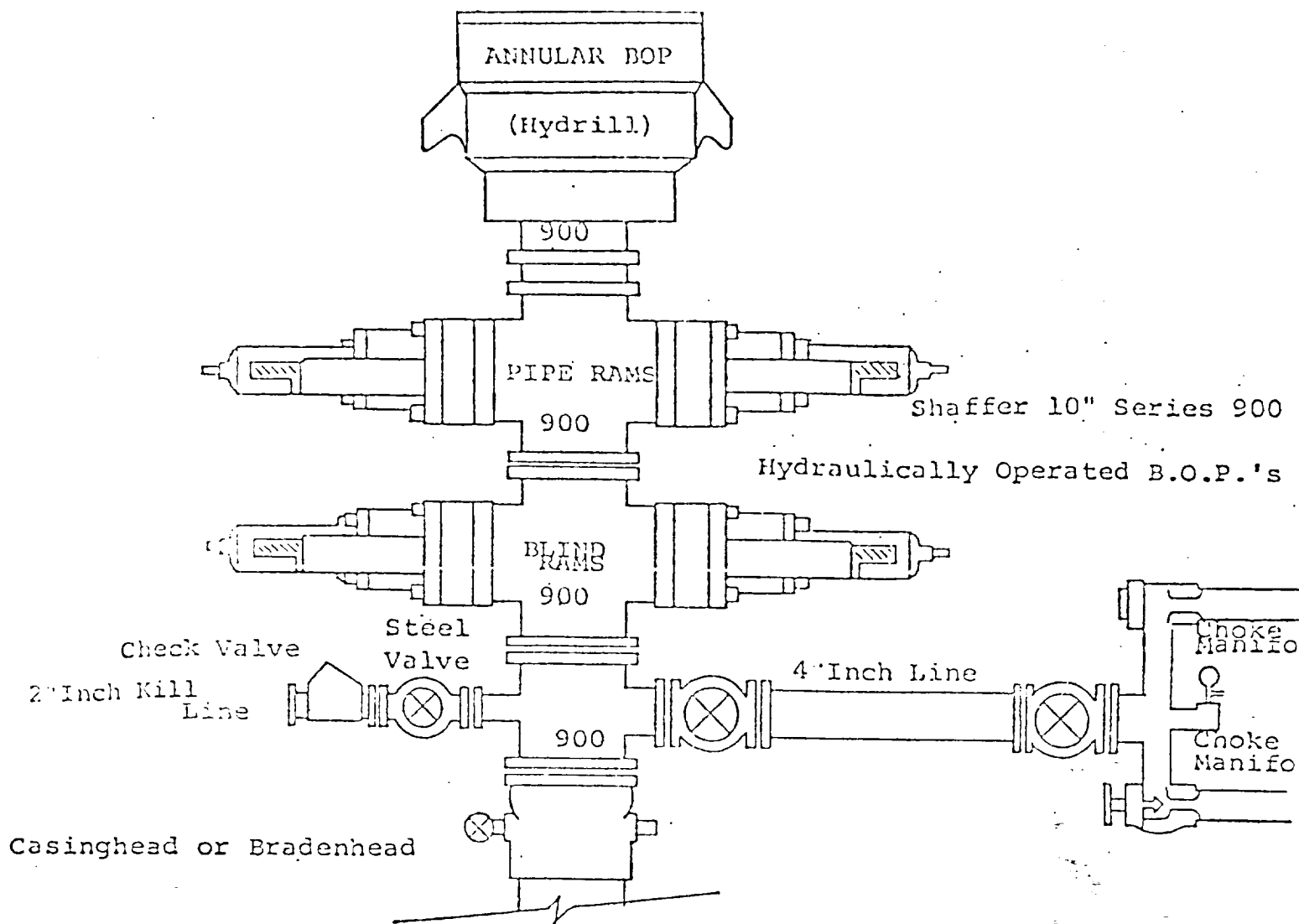

THE FOLLOWING CONSTITUTE MINIMUM BLOWOUT PREVENTER REQUIREMENTS

1. All preventers to be hydraulically operated with secondary manual control installed prior to drilling out from under casing.
2. Choke outlet to be a minimum of 2" diameter.
3. Kill line to be of all steel construction of 2" minimum diameter.
4. All connections from operating manifolds to preventers to be all steel. hole or tube a minimum of one inch in diameter.
5. The available closing pressure shall be at least 15% in excess of that required with sufficient volume to operate the B.O.P.'s.
6. All connections to and from preventer to have a pressure rating equivalent to that of the B.O.P.'s.
7. Inside blowout preventer to be available on rig floor.
8. Operating controls located a safe distance from the rig floor.
9. Hole must be kept filled on trips below intermediate casing.
10. D. P. float must be installed and used below zone of first gas intrusior