

NO. OF COPIES REQUIRED	3
DISTRIBUTION	
SANTA FE	1
FILE	1
U.S.G.S.	
LAND OFFICE	
OPERATOR	1

NEW MEXICO OIL CONSERVATION COMMISSION

RECEIVED

Form O-101
Revised 10-1-77

JAN 27 1982

O. C. D.
ARTESIA, OFFICE

5A. Initial Type of Lease	STATE <input type="checkbox"/>	FEE <input checked="" type="checkbox"/>
5. Title of Lease		

APPLICATION FOR PERMIT TO DRILL, DEEPEN, OR PLUG BACK

1a. Type of Work		7. Unit Agreement Name	
DRILL <input checked="" type="checkbox"/> DEEPEN <input type="checkbox"/> PLUG BACK <input type="checkbox"/> b. Type of Well OIL WELL <input type="checkbox"/> GAS WELL <input type="checkbox"/> OTHER <input type="checkbox"/> Stratigraphic Test Hole SINGLE ZONE <input type="checkbox"/> MULTIPLE ZONE <input type="checkbox"/>		8. Firm or Lease Name Cibola	
2. Name of Operator Cibola Energy Corporation		9. Well No. 6-D	
3. Address of Operator P.O. Box 1668, Albuquerque, New Mexico 87103		10. Field and Field or Wellhead N/A	
4. Location of Well UNIT LETTER D LOCATED 660 FEET FROM THE North LINE AND 660 FEET FROM THE West LINE OF SEC. 27 TWP. 9S RGE. 27E NADPM		11. County Chaves	
12. Proposed Depth		13A. Formation	
12. Rotary or C.T.		Rotary	
14. Is well to be plugged? (whether DP, H, etc.)		21A. Kind & Status Plug. Bond Statewide	
21B. Drilling Contractor Harry Bevers		22. Approx. Date Work will start 1-27-82	

23. PROPOSED CASING AND CEMENT PROGRAM					
SIZE OF HOLE	SIZE OF CASING	WEIGHT PER FOOT	SETTING DEPTH	SACKS OF CEMENT	EST. TOP
4 1/2"	N/A	N/A	N/A	N/A	N/A

We plan to drill a 4 1/2" hole 20' into Yates formation. A Gamma Ray log will be run to determine the top of the Yates. A suitable cement plug will be pumped into the hole to plug from TD to the top of the water zone. Location will be cleaned and marker set.

THIS WELL IS BEING DRILLED AS A STRATIGRAPHIC TEST FOR LOCATION OF OIL AND GAS INFORMATION ONLY AND UNDER NO CIRCUMSTANCES WILL IT BE PRODUCED.

IN ABOVE SPACE DESCRIBE PROPOSED PROGRAM: IF PROPOSAL IS TO DEEPEN OR PLUG BACK, GIVE DATA ON PRESENT PRODUCTIVE ZONE AND PROPOSED NEW PRODUCTIVE ZONE. GIVE BLOWOUT PREVENTER PROGRAM, IF ANY.

I hereby certify that the information above is true and complete to the best of my knowledge and belief.

Signed Quinta Vigil Title Drilling Secretary Date 1-25-82

(This space for State Use)

APPROVED BY Mike Williams TITLE OIL AND GAS INSPECTOR DATE JAN 29 1982

CONDITIONS OF APPROVAL, IF ANY:

NEW MEXICO OIL CONSERVATION COMMISSION
WELL LOCATION AND ACREAGE DEDICATION PLAT

RECEIVED

Form C-102
Supersedes C-128
Effective 1-1-65

FEB 16 1982

All distances must be from the outer boundaries of the Section.

Operator Cibola Energy			Lease Cibola Strat Test			Well No. Cibola 6-D		
Unit Letter D	Section 27	Township 9 South	Range 27 East	County Chaves				
Actual Footage Location of Well:								
660.0		feet from the north		line and 660.0		feet from the west		line
Ground Level Elev. 3862.0		Producing Formation		Pool		Dedicated Acreage:		

1. Outline the acreage dedicated to the subject well by colored pencil or hatchure marks on the plat below.
2. If more than one lease is dedicated to the well, outline each and identify the ownership thereof (both as to working interest and royalty).
3. If more than one lease of different ownership is dedicated to the well, have the interests of all owners been consolidated by communitization, unitization, force-pooling, etc?

☐ Yes ☐ No If answer is "yes," type of consolidation _____

If answer is "no," list the owners and tract descriptions which have actually been consolidated. (Use reverse side of this form if necessary.) _____

No allowable will be assigned to the well until all interests have been consolidated (by communitization, unitization, forced-pooling, or otherwise) or until a non-standard unit, eliminating such interests, has been approved by the Commission.

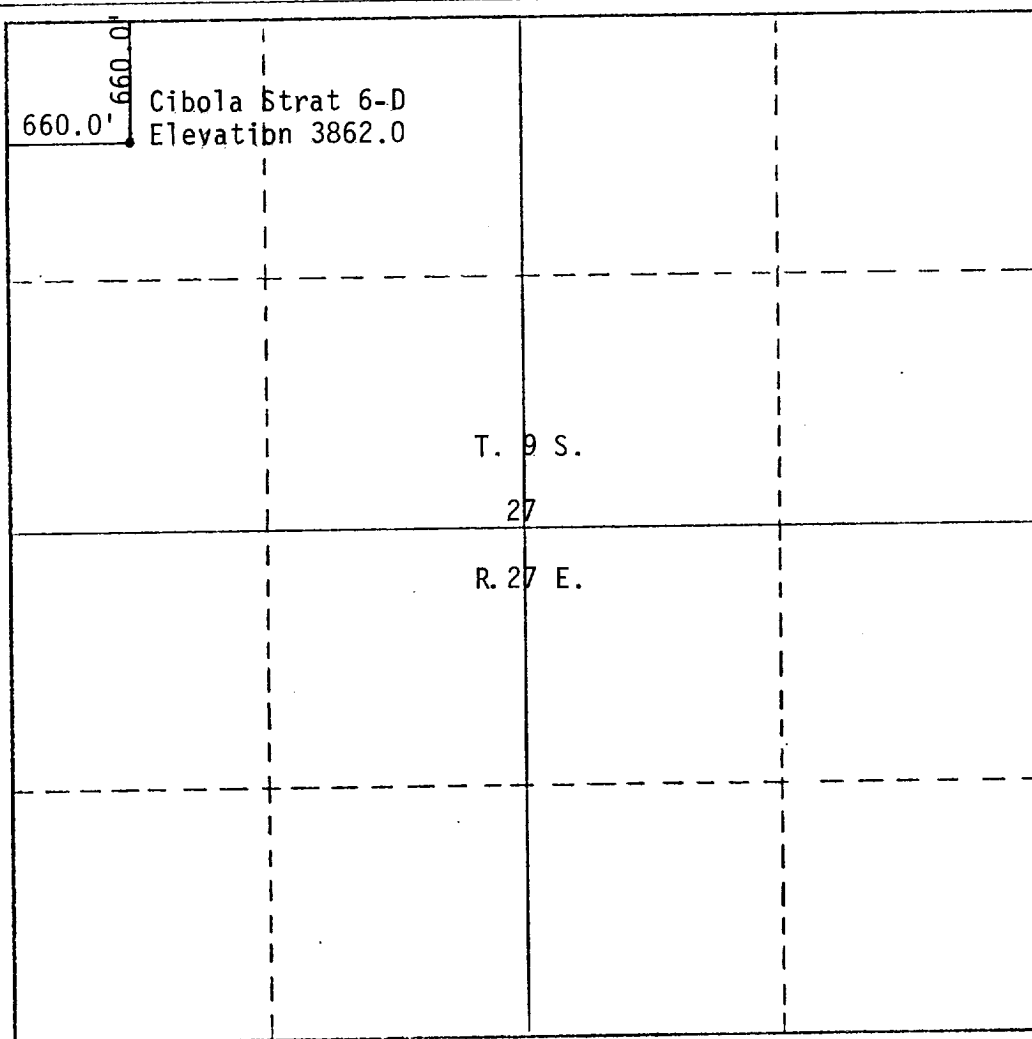

CERTIFICATION

I hereby certify that the information contained herein is true and complete to the best of my knowledge and belief.

Name
R. B. Wright
Position
Agent
Company
Cibola Energy Corp.
Date
2/13/82

I hereby certify that the well location shown on this plat was plotted from field notes of actual surveys made by me or under my supervision, and that the same is true and correct to the best of my knowledge and belief.

Date Surveyed
2/13/82
Registered Professional Engineer and/or Land Surveyor

Richard B. Wright

Certificate No.
7929

0 330 660 990 1320 1650 1980 2310 2640 2970 3300 3630 3960 4290 4620 4950 5280 5610 5940 6270 6600

NEW MEXICO OIL CONSERVATION COMMISSION
WELL LOCATION AND ACREAGE DEDICATION PLAT

RECEIVED

Form C-102
Supersedes C-128
Effective 1-1-65

FEB 16 1982

All distances must be from the outer boundaries of the Section.

Operator Cibola Energy			Lease Cibola Strat Test			O. C. D. ARTESIA, OFFICE			Well No. Cibola 6-D		
Plot Letter D	Section 27	Township 9 South	Range 27 East	County Chaves							
Well Location of Well:											
660.0		feet from the north		660.0		feet from the west		Elev.			
3862.0		Elevating Elevation		Foot		Dedicated Acreage		Acreage			

1. Outline the acreage dedicated to the subject well by colored pencil or hatchure marks on the plat below.
2. If more than one lease is dedicated to the well, outline each and identify the ownership thereof (both as to working interest and royalty).
3. If more than one lease of different ownership is dedicated to the well, have the interests of all owners been consolidated by communitization, unitization, force-pooling, etc?

☐ Yes ☐ No If answer is "yes," type of consolidation _____

If answer is "no," list the owners and tract descriptions which have actually been consolidated. (Use reverse side of this form if necessary.) _____

No allowable will be assigned to the well until all interests have been consolidated (by communitization, unitization, forced-pooling, or otherwise) or until a non-standard unit, eliminating such interests, has been approved by the Commission.

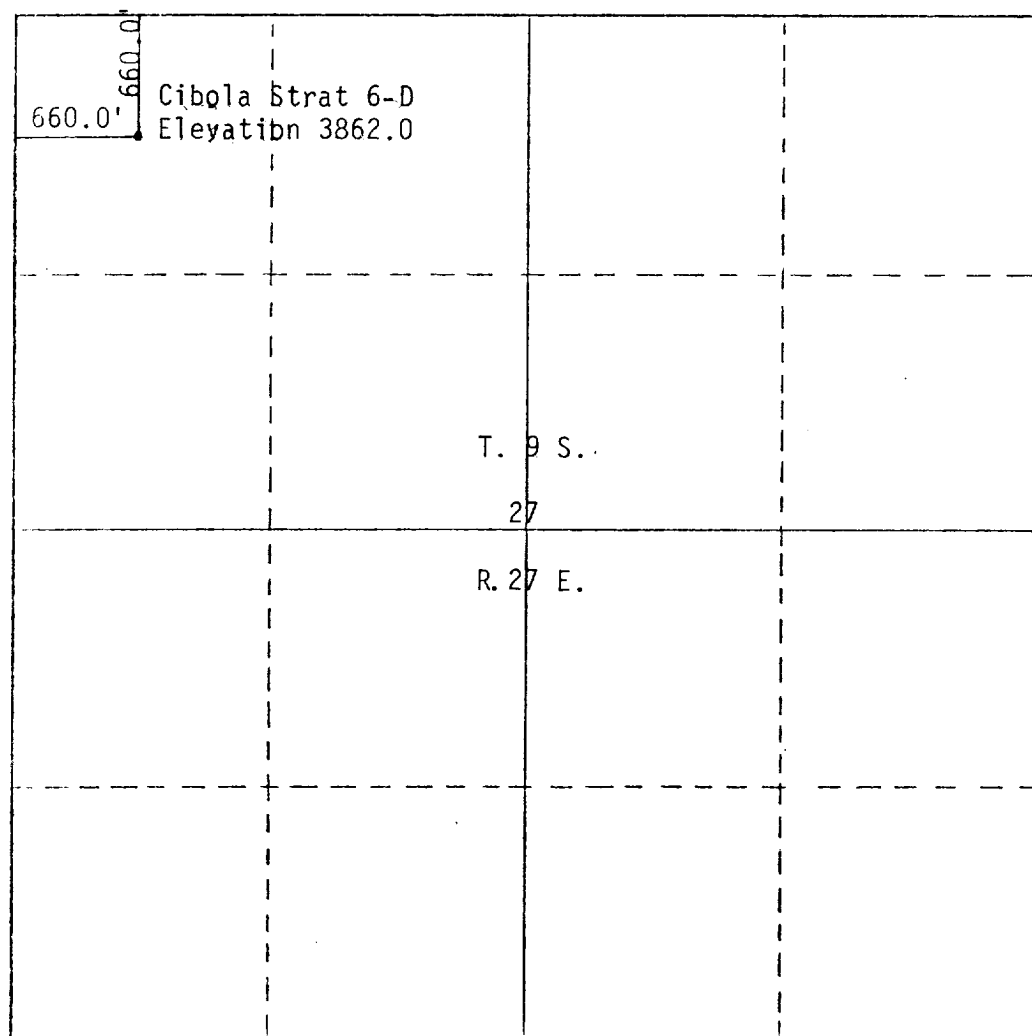

CERTIFICATION

I hereby certify that the information contained herein is true and complete to the best of my knowledge and belief.

Name
R. B. Wright

Position

Agent

Company

Cibola Energy Corp.

Date

2/13/82

I hereby certify that the well location shown on this plat was plotted from field notes of actual surveys made by me or under my supervision, and that the same is true and correct to the best of my knowledge and belief.

Date Survey

2/13/82

Registered Professional
and/or Land Surveyor

Richard B. Wright

Certificate No.

7929

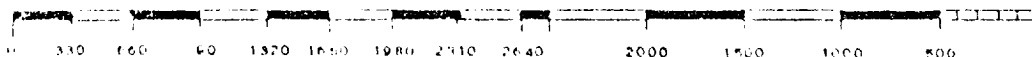

NEW MEXICO OIL CONSERVATION COMMISSION
WELL LOCATION AND ACREAGE DEDICATION PLAT

RECEIVED

Form C-102
Supersedes C-128
Effective 1-1-65

All distances must be from the outer boundaries of the Section.

FEB 16 1982

Operator Cibola Energy		Lease Cibola Strat Test		Well No. Cibola 6-D
Plat Letter D	Section 27	Township 9 South	Range 27 East	County Chaves

O. C. D.
ARTESIA, OFFICE

Actual Footage Location of Well:

660.0	feet from the	north	line and	660.0	feet from the	west	line
3862.0	Elevation		Pool		Dedicated Acreage		Acres

1. Outline the acreage dedicated to the subject well by colored pencil or hatchure marks on the plat below.
2. If more than one lease is dedicated to the well, outline each and identify the ownership thereof (both as to working interest and royalty).
3. If more than one lease of different ownership is dedicated to the well, have the interests of all owners been consolidated by communitization, unitization, force-pooling, etc?

☐ Yes ☐ No If answer is "yes," type of consolidation _____

If answer is "no," list the owners and tract descriptions which have actually been consolidated. (Use reverse side of this form if necessary.) _____

No allowable will be assigned to the well until all interests have been consolidated (by communitization, unitization, forced-pooling, or otherwise) or until a non-standard unit, eliminating such interests, has been approved by the Commission.

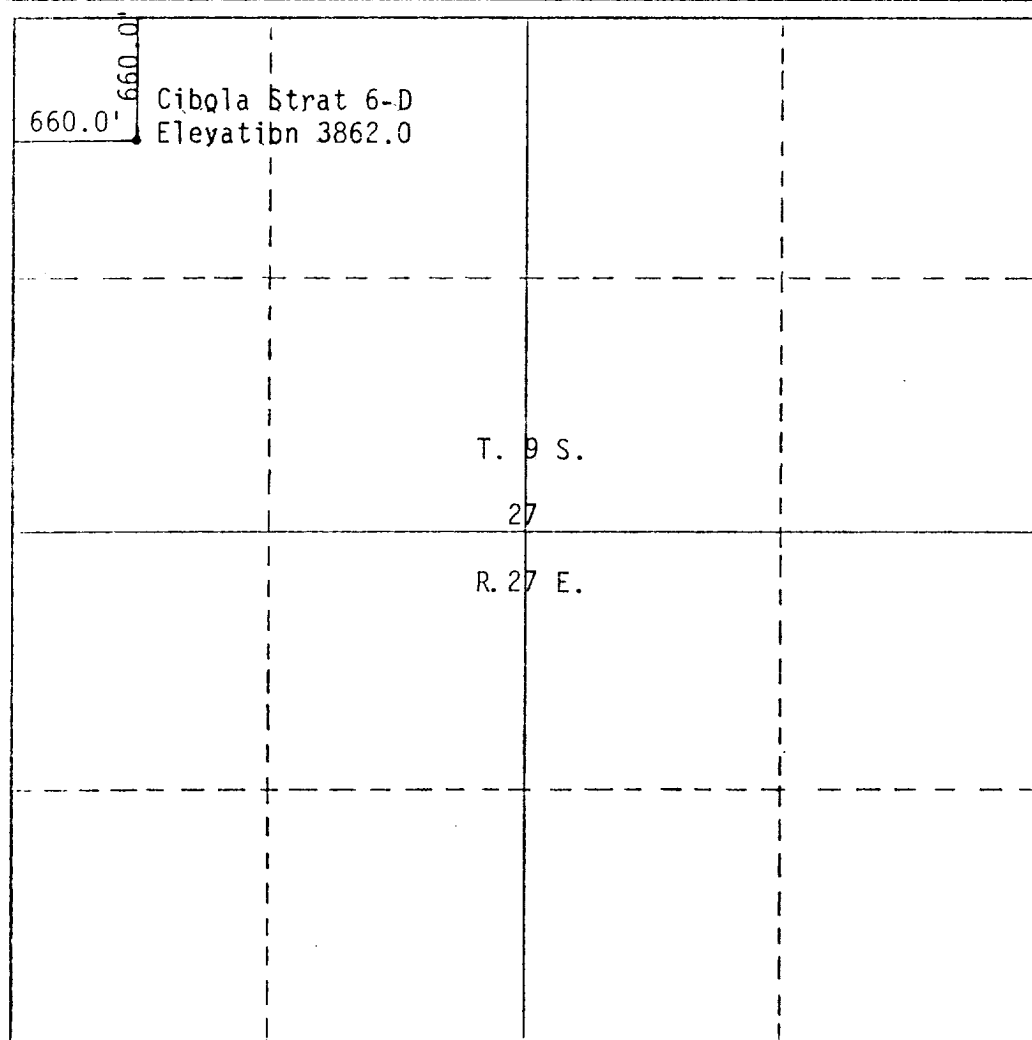

CERTIFICATION

I hereby certify that the information contained herein is true and complete to the best of my knowledge and belief.

Name _____

R. B. Wright

Position

Agent

Company

Cibola Energy Corp.

Date

2/13/82

I hereby certify that the well location shown on this plat was plotted from field notes of actual surveys made by me or under my supervision, and that the same is true and correct to the best of my knowledge and belief.

2/13/82

Date Survey

Registered Professional
and/or Land Surveyor

Richard B. Wright

Certificate No.

7929

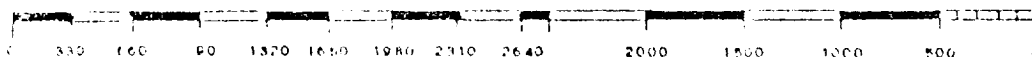

NEW MEXICO OIL CONSERVATION COMMISSION RECEIVED
WELL LOCATION AND ACREAGE DEDICATION PLAT

Form C-102
Supersedes C-128
Effective 1-1-65

All distances must be from the outer boundaries of the Section FEB 16 1982

Operator Cibola Energy		Lease Cibola Strat Test O. C. D.		Well No. Cibola 6-D
Plat Letter D	Section 27	Township 9 South	Range 27 East	County ARTESIA, OFFICE Chaves

Actual Postage Location of Well:

660.0	feet from the	north	line and	660.0	feet from the	west	line	
Ground Level Elev. 3862.0	Predicted Formation		Pool		Dedicated Acreage per			Acreage

- Outline the acreage dedicated to the subject well by colored pencil or hachure marks on the plat below.
- If more than one lease is dedicated to the well, outline each and identify the ownership thereof (both as to working interest and royalty).
- If more than one lease of different ownership is dedicated to the well, have the interests of all owners been consolidated by communitization, unitization, force-pooling, etc?

☐ Yes ☐ No If answer is "yes," type of consolidation _____

If answer is "no," list the owners and tract descriptions which have actually been consolidated. (Use reverse side of this form if necessary.) _____

No allowable will be assigned to the well until all interests have been consolidated (by communitization, unitization, forced-pooling, or otherwise) or until a non-standard unit, eliminating such interests, has been approved by the Commission.

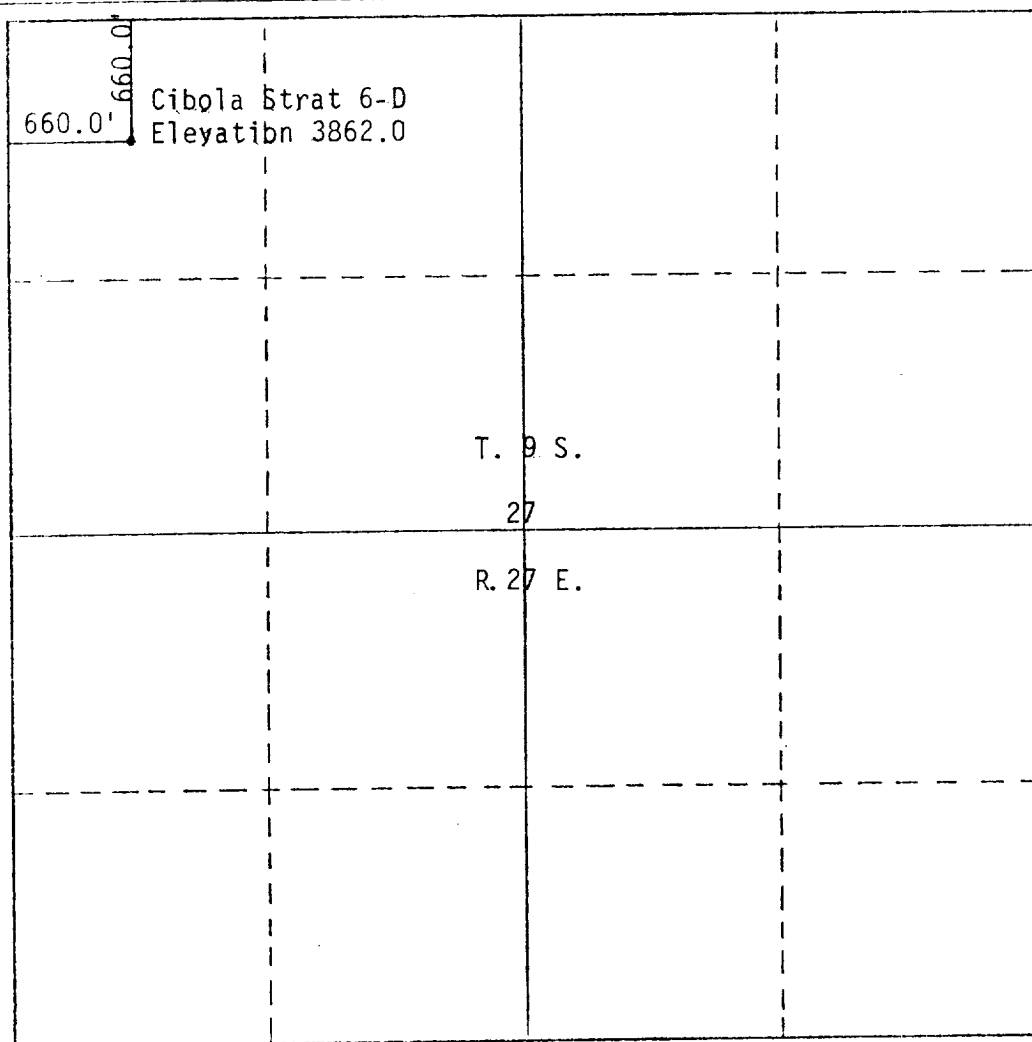

CERTIFICATION

I hereby certify that the information contained herein is true and complete to the best of my knowledge and belief.

Name R. B. Wright
Position Agent
Company Cibola Energy Corp.
Date 2/13/82

I hereby certify that the well location shown on this plat was plotted from field notes of actual surveys made by me or under my supervision, and that the same is true and correct to the best of my knowledge and belief.

Date Surveyed 2/13/82
Registered Professional Engineer and/or Land Surveyor Richard B. Wright

Certificate No. 7929

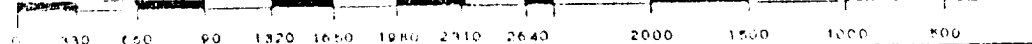

NEW MEXICO OIL CONSERVATION COMMISSION
WELL LOCATION AND ACREAGE DEDICATION PLAT

RECEIVED

Form C-102
Supersedes C-128
Effective 1-1-65

All distances must be from the outer boundaries of the Section.

FEB 16 1982

Operator Cibola Energy			Lease Cibola Strat Test			Well No. Cibola 6-D		
Unit Letter D	Section 27	Township 9 South	Range 27 East	County Chaves	O. C. D. ARTESIA, OFFICE			
Actual Postage Location of Well:								
660.0 feet from the north line and			660.0 feet from the west line					
Ground Level Elev. 3862.0		Existing Formation		Pool		Dedicated Acreage		

1. Outline the acreage dedicated to the subject well by colored pencil or hatchure marks on the plat below.
2. If more than one lease is dedicated to the well, outline each and identify the ownership thereof (both as to working interest and royalty).
3. If more than one lease of different ownership is dedicated to the well, have the interests of all owners been consolidated by communitization, unitization, force-pooling, etc?

☐ Yes ☐ No If answer is "yes," type of consolidation _____

If answer is "no," list the owners and tract descriptions which have actually been consolidated. (Use reverse side of this form if necessary.) _____

No allowable will be assigned to the well until all interests have been consolidated (by communitization, unitization, forced-pooling, or otherwise) or until a non-standard unit, eliminating such interests, has been approved by the Commission.

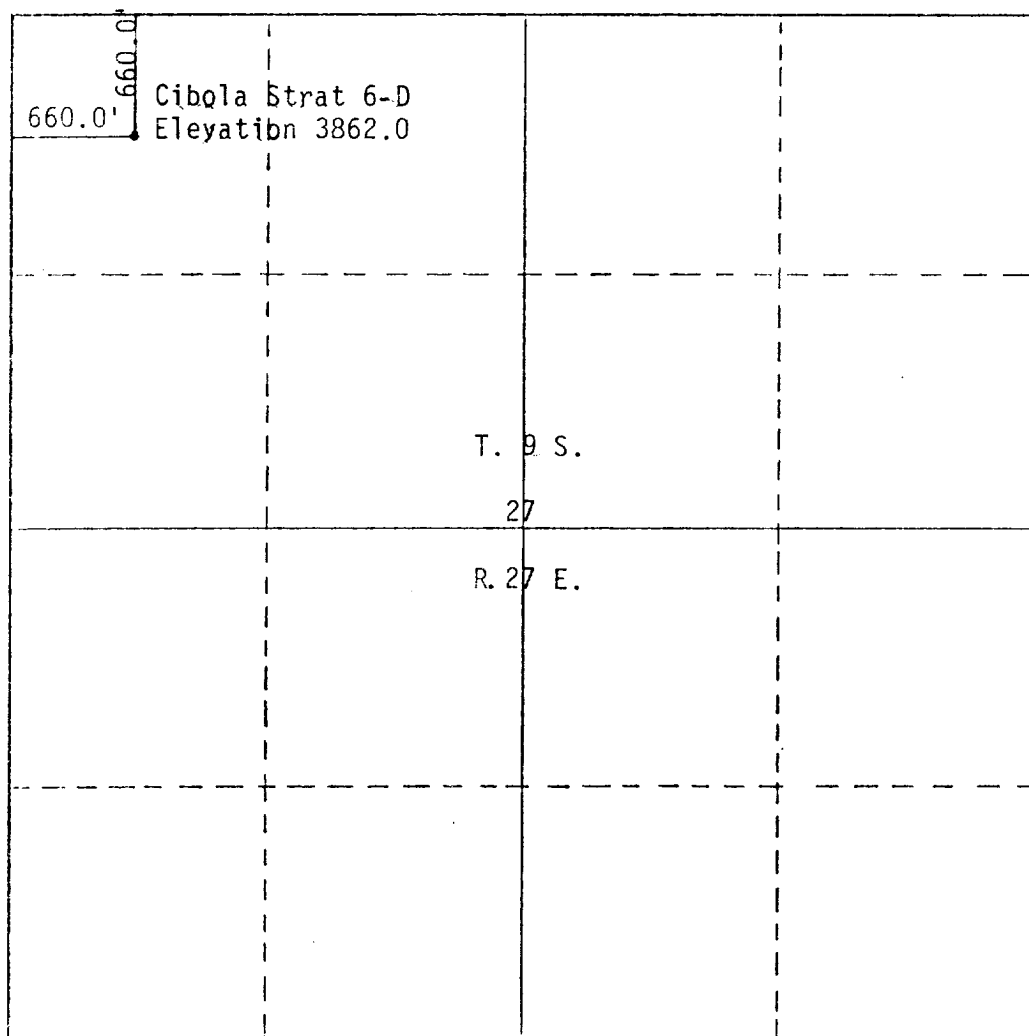

CERTIFICATION

I hereby certify that the information contained herein is true and complete to the best of my knowledge and belief.

Name

R. B. Wright

Position

Agent

Company

Cibola Energy Corp.

Date

2/13/82

I hereby certify that the well location shown on this plat was plotted from field notes of actual surveys made by me or under my supervision, and that the same is true and correct to the best of my knowledge and belief.

2/13/82

Date Surveyed

Registered Professional Engineer and/or Land Surveyor

Richard B. Wright

Certificate No.

7929

NEW MEXICO OIL CONSERVATION COMMISSION
WELL LOCATION AND ACREAGE DEDICATION PLAT

RECEIVED

Form C-102
Supersedes C-128
Effective 1-1-65

All distances must be from the outer boundaries of the Section.

FEB 16 1982

Operator Cibola Energy		Lease Cibola Strat Test		Well No. Cibola 6-D	
Unit Letter D	Section 27	Township 9 South	Range 27 East	County Chaves	O. C. D. ARTESIA, OFFICE
Actual Footage Location of Well:					
660.0 feet from the north line and		660.0 feet from the west line		Bore	
Ground Level Elev. 3862.0	Predicted Formation		Pool	Dedicated Acreage	

1. Outline the acreage dedicated to the subject well by colored pencil or hatchure marks on the plat below.
2. If more than one lease is dedicated to the well, outline each and identify the ownership thereof (both as to working interest and royalty).
3. If more than one lease of different ownership is dedicated to the well, have the interests of all owners been consolidated by communitization, unitization, force-pooling, etc?

☐ Yes ☐ No If answer is "yes," type of consolidation _____

If answer is "no," list the owners and tract descriptions which have actually been consolidated. (Use reverse side of this form if necessary.) _____

No allowable will be assigned to the well until all interests have been consolidated (by communitization, unitization, forced-pooling, or otherwise) or until a non-standard unit, eliminating such interests, has been approved by the Commission.

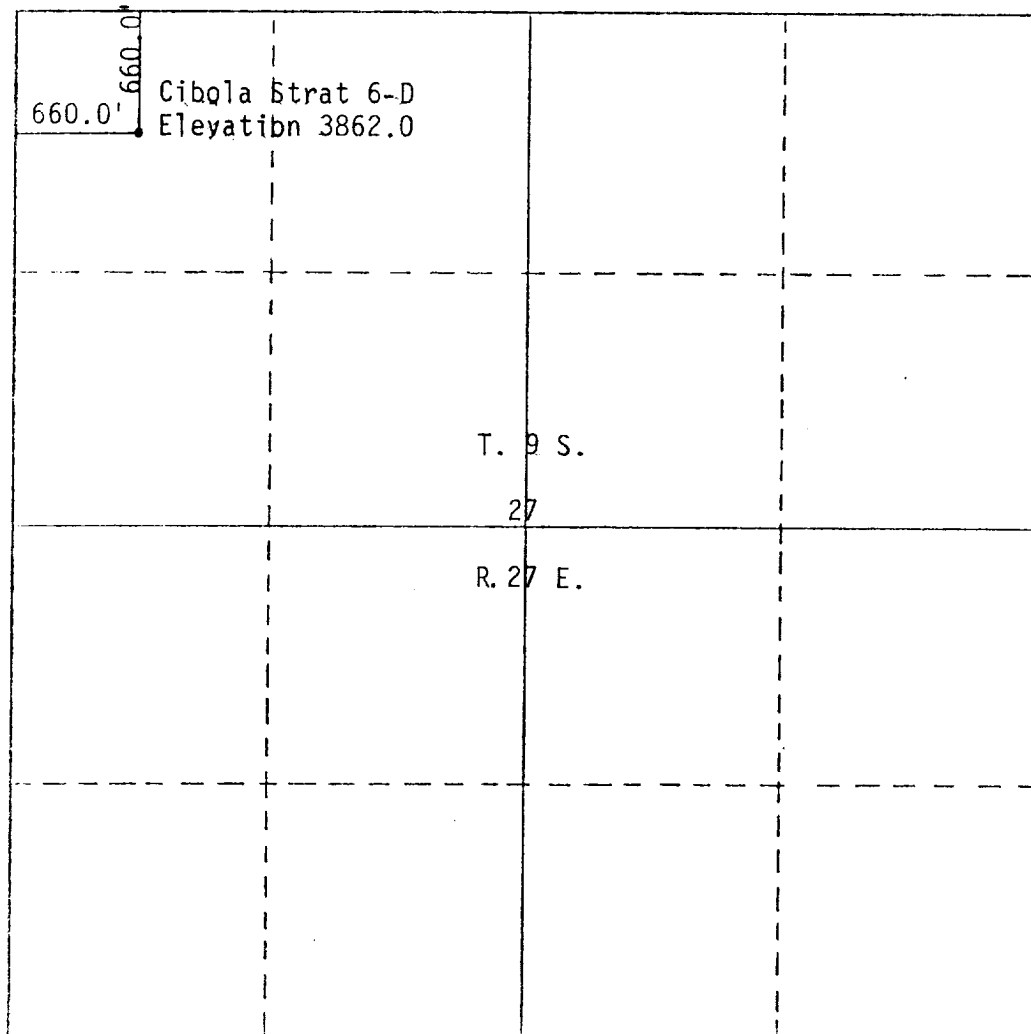

CERTIFICATION

I hereby certify that the information contained herein is true and complete to the best of my knowledge and belief.

Name

R. B. Wright

Position

Agent

Company

Cibola Energy Corp.

Date

2/13/82

I hereby certify that the well location shown on this plat was plotted from field notes of actual surveys made by me or under my supervision and that the same is true and correct to the best of my knowledge and belief.

Date Surveyed

Registered Professional
and/or Land Surveyor

Richard B. Wright

Certificate No.

7929

