

AUG 20 1981

O. C. D.
ARTESIA, OFFICE

30-005-61094
Form C-101
Revised 10-1-78

NO. OF COPIES RECEIVED	
DISTRIBUTION	
STATE	1
FILE	1
U.S.G.S.	2
LAND OFFICE	
OPERATOR	1

5A. Indicate Type of Lease
STATE ☐ FEDERAL ☒

5. State Oil & Gas Lease No.

APPLICATION FOR PERMIT TO DRILL, DEEPEN, OR PLUG BACK

1a. Type of Work DRILL <input checked="" type="checkbox"/> DEEPEN <input type="checkbox"/> PLUG BACK <input type="checkbox"/>				7. Unit Agreement Name	
b. Type of Well OIL WELL <input type="checkbox"/> GAS WELL <input checked="" type="checkbox"/> OTHER <input type="checkbox"/> SINGLE ZONE <input checked="" type="checkbox"/> MULTIPLE ZONE <input type="checkbox"/>				8. Farm or Lease Name RIC	
2. Name of Operator MESA PETROLEUM CO				9. Well No. 3	
3. Address of Operator 1000 VAUGHN BLDG <i>Midland Texas 79701</i>				10. Field and Pool, or Wildcat WILDCAT ABO	
4. Location of Well UNIT LETTER <u>C</u> LOCATED <u>660</u> FEET FROM THE <u>NORTH</u> LINE AND <u>1980</u> FEET FROM THE <u>WEST</u> LINE OF SEC. <u>25</u> TWP. <u>6S</u> RGE. <u>24E</u> NMPM				12. County CHAVES	
19. Proposed Depth 4300		19A. Formation ABO		20. Rotary or C.T. ROTARY	
21. Elevations (show whether DF, RT, etc.) 3805.6' GR		21A. Kind & Status Plug. Bond BLANKET		21B. Drilling Contractor TOM BROWN	
22. Approx. Date Work will start AUGUST 30, 1981					

23. PROPOSED CASING AND CEMENT PROGRAM					
SIZE OF HOLE	SIZE OF CASING	WEIGHT PER FOOT	SETTING DEPTH	SACKS OF CEMENT	EST. TOP
17 1/2"	13 3/8"	48#	800'	500	surface
11"	8 5/8"	24#	1600'	500	Isolate wtr O&G
7 7/8"	4 1/2"	10.5#	4300'	500	Cover all pay

Propose to drill 17 1/2" hole to approximately 800' and set 13 3/8" surface casing and cement to surface. Will reduce hole to 11" and drill to approximately 1600' and set 8 5/8" casing. Will reduce hole to 7 7/8", nipple up RAM type BOP's and drill to total depth. Drilling medium will be air, foam, or mud as required.

APPROVAL VALID FOR 180 DAYS
PERMIT EXPIRES 2-25-82
UNLESS DRILLING UNDERWAY

Gas Sales are dedicated

xc: NMOC (6), TLS, CEN RCDS, ACCTG, ROSWELL, MEC, LAND, PARTNERS, FILE

IN ABOVE SPACE DESCRIBE PROPOSED PROGRAM; IF PROPOSAL IS TO DEEPEN OR PLUG BACK, GIVE DATA ON PRESENT PRODUCTIVE ZONE AND PROPOSED NEW ZONE. GIVE BLOWOUT PREVENTER PROGRAM, IF ANY.

hereby certify that the information above is true and complete to the best of my knowledge and belief.

Signed R. E. Mathis Title REGULATORY COORDINATOR Date 8-17-81

(This space for State Use)

APPROVED BY W. A. Gressett TITLE SUPERVISOR, DISTRICT II DATE AUG 25 1981

CONDITIONS OF APPROVAL, IF ANY:

*Posted ID-1
API & RL B-1
8-28-81*

N. MEXICO OIL CONSERVATION COMMISS
WELL LOCATION AND ACREAGE DEDICATION PLAT

Form C-102
 Supersedes C-128
 Effective 1-1-65

All distances must be from the outer boundaries of the Section.

Operator MESA PETROLEUM CO.			Lease RIC.		Well No. 3
Unit Letter C	Section 25	Township 6 SOUTH	Range 24 EAST	County CHAVES	
Actual Footage Location of Well: 660 feet from the NORTH line and 1980 feet from the WEST line					
Ground Level Elev. 3805.6	Producing Formation ABO	Pool Wildcat also		Dedicated Acreage: NW/4 160 Acres	

1. Outline the acreage dedicated to the subject well by colored pencil or hatchure marks on the plat below.
2. If more than one lease is dedicated to the well, outline each and identify the ownership thereof (both as to working interest and royalty).
3. If more than one lease of different ownership is dedicated to the well, have the interests of all owners been consolidated by communitization, unitization, force-pooling, etc?

☐ Yes ☐ No If answer is "yes," type of consolidation _____

If answer is "no," list the owners and tract descriptions which have actually been consolidated (Use reverse side of this form if necessary.) _____

No allowable will be assigned to the well until all interests have been consolidated (by communitization, unitization, forced-pooling, or otherwise) or until a non-standard unit, eliminating such interests, has been approved by the Commission.

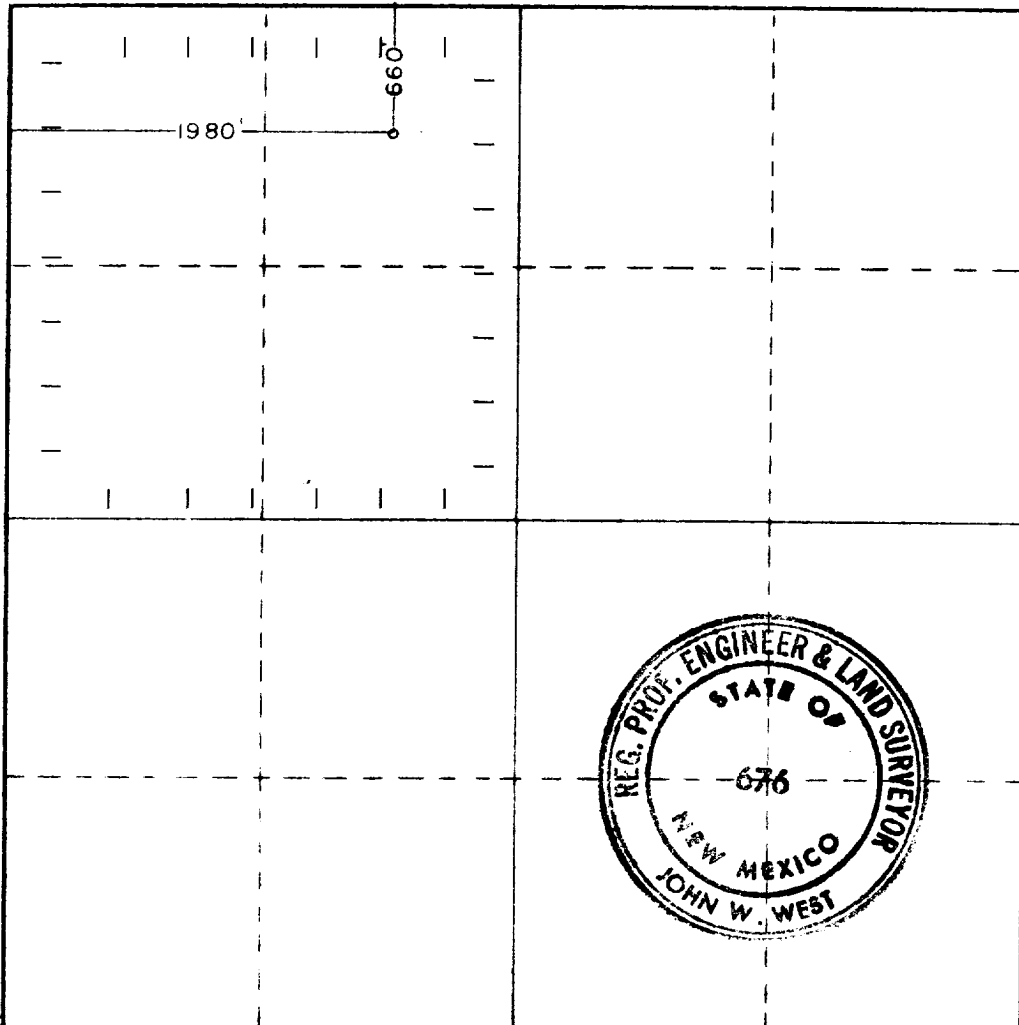

CERTIFICATION

I hereby certify that the information contained herein is true and complete to the best of my knowledge and belief.

R. E. Mathis

Name

R. E. MATHIS

Position

REGULATORY COORDINATOR

Company

MESA PETROLEUM CO

Date

8-17-81

I hereby certify that the well location shown on this plat was plotted from field notes of actual surveys made by me or under my supervision, and that the same is true and correct to the best of my knowledge and belief.

Date Surveyed

8-5-81

Registered Professional Engineer and Land Surveyor

John W. West

Certificate No. **JOHN W. WEST 676**
PATRICK A. ROMERO 6663
Ronald J. Eidson 3239

