

All distances must be from the outer boundaries of the Section.

Operator McKay Oil Corp. ✓		Lease Four Mile Draw Federal		Well No. #10
Unit Letter F	Section 17	Township 6 South	Range 22 East	County Chaves
Actual Postage Location of Well: 1780 feet from the West line and 1980 feet from the North line				
Ground Level Elev. 4370	Producing Formation Abo	Pool W. Pecos Slope Abo	Dedicated Acreage: 160	

1. Outline the acreage dedicated to the subject well by colored pencil or hachure marks on the plat below.
  2. If more than one lease is dedicated to the well, outline each and identify the ownership thereof (both as to working interest and royalty).
  3. If more than one lease of different ownership is dedicated to the well, have the interests of all owners been consolidated by communitization, unitization, force-pooling, etc?
 

RECEIVED BY  
 JAN 30 1987  
 O. C. D.  
 ARTESIA OFFICE
- ☐ Yes ☐ No If answer is "yes," type of consolidation

If answer is "no," list the owners and tract descriptions which have actually been consolidated. (Use reverse side of this form if necessary.)

No allowable will be assigned to the well until all interests have been consolidated (by communitization, unitization, forced-pooling, or otherwise) or until a non-standard unit, eliminating such interests, has been approved by the Division.

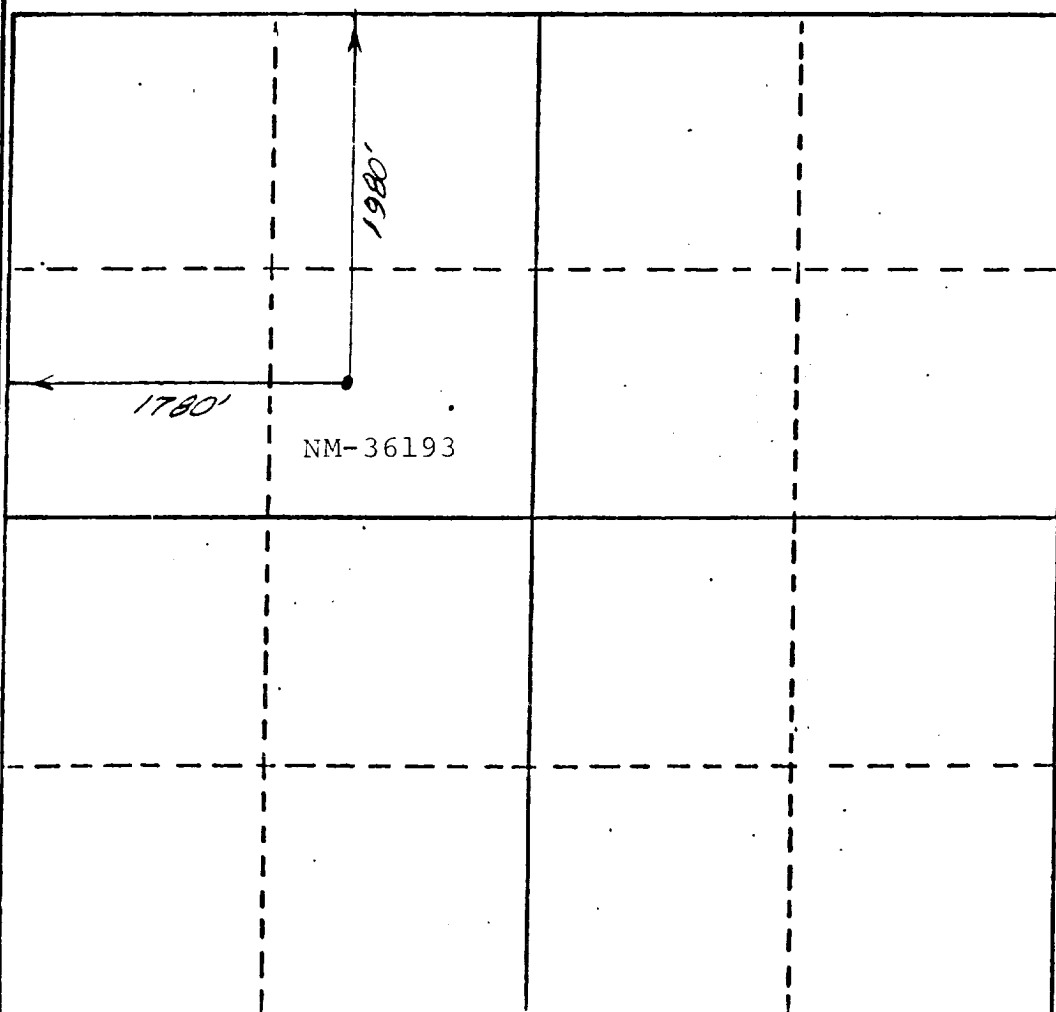

CERTIFICATION

I hereby certify that the information contained herein is true and complete to the best of my knowledge and belief.

Name  
Sam L. Shackelford  
Position  
Agent  
Company  
McKay Oil Corp.  
Date  
12-30-86

I hereby certify that the well location shown on this plat was plotted from field notes of actual surveys made by me or under my supervision, and that the same is true and correct to the best of my knowledge and belief.

JOHN D. JAQUES  
Date Surveyed  
December 29, 1986  
Registered Professional Engineer and/or Land Surveyor  
John D. Jaques  
Certificate No. 6290

