

Development plan for surface use to accompany, "Applications to Drill Onshore Oil, Gas, or Geothermal Steam Wells on Public Domain and acquired Federal Lands:"

- Existing roads. See Attached Topo Map - Roads are caliched and maintained as needed.
  - Planned access roads. See Attached Topo Map - Access road on South bank of draw on rocky terrian.
  - Location of wells. See Attached Topo Map - Development well in Eagle Creek San Andres Field
  - Lateral roads to wells locations. See Attached Topo Map - no lateral roads needed on first well.
  - Location of tank batteries and flowlines. See Attached Topo Map - Tank battery and flowlines alongside Access Road.
  - Locations and types of water supply. Fresh water supply well in Eagle Creek Field; water trucked to location on existing roads.
  - Methods for handling waste disposal. Mud and engine oil in mud pits; trash in trash barrel for subswquent disposal in approved burial dump.
  - Location of camps NA
  - Location of airstrips. NA
  - Location layout to include position of the rig, mud tanks, reserve pits, burn pits, pipe racks, etc. See Sketch Below
  - Plans for restoration of the surface. Pits to be fenced; dried and leveled upon abandonment, surface restored to near original.
  - Any other information which the Approving Official considers essential to his assessment of the impact on the environment. Patented surface. Hard rock out crop at wellsite, broken rock and thin soil elsewhere. Inviroment protected to satisfaction of Rancher, W.E. McIlhaneey, Rtl Artesia, NM. 746-3034
- The affected Federal and State surface managing agencies shall have access to or. if feasible, may be provided with copies of such development.

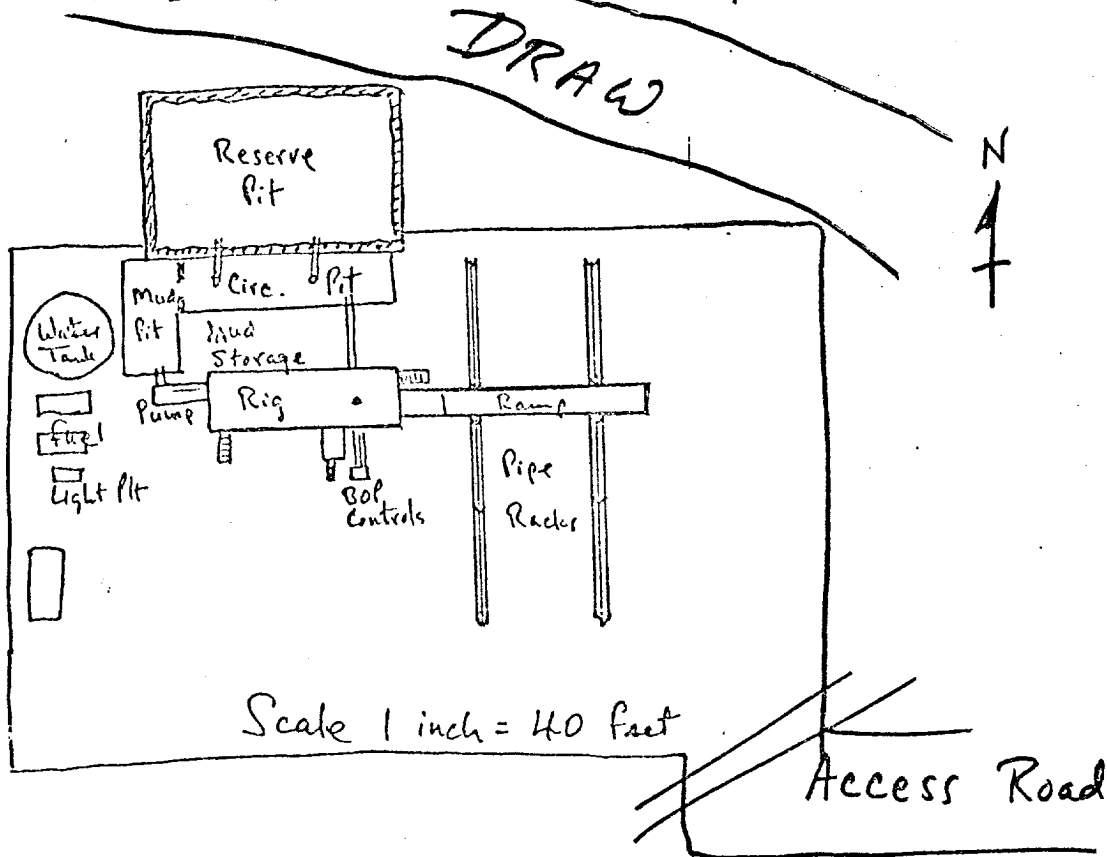

Submitted by:  
  
Yates Petroleum Corporation.  
BY Eddie M. Mahfood  
Eddie M. Mahfood, Engineer

Approved by:  
  
U. S. Geological Survey  
BY \_\_\_\_\_