

RECEIVED BY
Form 3160-3
(November 1983)
APR 18 1985

SUBMIT IN TRIPLICATE*
(Other instructions on
reverse side)

Form approved.
Budget Bureau No. 1004-0136
Expires August 31, 1985
30-015-25266

UNITED STATES
DEPARTMENT OF THE INTERIOR
BUREAU OF LAND MANAGEMENT

O. C. D.

ARTESIA OFFICE

APPLICATION FOR PERMIT TO DRILL, DEEPEN, OR PLUG BACK

1a. TYPE OF WORK

DRILL ☒

DEEPEN ☐

PLUG BACK ☐

b. TYPE OF WELL

OIL
WELL ☒

GAS
WELL ☐

OTHER

SINGLE
ZONE ☒

MULTIPLE
ZONE ☐

2. NAME OF OPERATOR

HANSON OPERATING COMPANY, INC. ✓

(Grant Smith)

(505-622-7330)

3. ADDRESS OF OPERATOR

P. O. Box 1515, Roswell, New Mexico 88202-1515

4. LOCATION OF WELL (Report location clearly and in accordance with any State requirements.)*

At surface

890' FSL & 1650' FWL of Section

At proposed prod. zone
same

(Unit N)

(SE 1/4 SW 1/4)

14. DISTANCE IN MILES AND DIRECTION FROM NEAREST TOWN OR POST OFFICE*

30 air miles west-southwest of Jal, New Mexico

10. DISTANCE FROM PROPOSED*

LOCATION TO NEAREST

PROPERTY OR LEASE LINE, FT.

(Also to nearest drlg. unit line, if any)

990'

(330')

16. NO. OF ACRES IN LEASE

900.80

17. NO. OF ACRES ASSIGNED
TO THIS WELL

40

18. DISTANCE FROM PROPOSED LOCATION*

TO NEAREST WELL, DRILLING, COMPLETED,
OR APPLIED FOR, ON THIS LEASE, FT.

560'

19. PROPOSED DEPTH

± 7100'

20. ROTARY OR CABLE TOOLS

Rotary

21. ELEVATIONS (Show whether DF, RT, GR, etc.)

3146 G.L.

22. APPROX. DATE WORK WILL START*

April 25, 1985

23. PROPOSED CASING AND CEMENTING PROGRAM

SIZE OF HOLE	SIZE OF CASING	WEIGHT PER FOOT	SETTING DEPTH	QUANTITY OF CEMENT
17 1/2"	13 3/8"	48#	± 1050'	Sufficient to circulate
11 "	8 5/8"	24 & 32#	4050'	250 sacks
7 5/8"	5 1/2"	15.5#	7100'	Tie back into 8 5/8" csg.

Pay zone will be selectively perforated and stimulated as needed for optimum production.

Attached are: 1. Well Location & Acreage Dedication Plat
2. Supplemental Drilling Data
3. Surface Use Plan

IN ABOVE SPACE DESCRIBE PROPOSED PROGRAM: If proposal is to deepen or plug back, give data on present productive zone and proposed new productive zone. If proposal is to drill or deepen directionally, give pertinent data on subsurface locations and measured and true vertical depths. Give blowout preventer program, if any.

24.

SIGNED

James A. Knauf
James A. Knauf

TITLE

Agent

DATE April 1, 1985

(This space for Federal or State office use)

PERMIT NO.

APPROVAL DATE

APPROVED BY

TITLE

DATE

4-17-85

CONDITIONS OF APPROVAL, IF ANY:

APPROVAL SUBJECT TO
GENERAL REQUIREMENTS AND
SPECIAL STIPULATIONS
ATTACHED

*See Instructions On Reverse Side

**NEW MEXICO OIL CONSERVATION COMM. ON
WELL LOCATION AND ACREAGE DEDICATION PLAT**

Form C-102
Supersedes C-128
Effective 1-1-65

All distances must be from the outer boundaries of the Section.

Operator HANSON OPERATING CO., INC.			Lease HANSON FEDERAL			Well No. 11		
Well Letter N	Section 25	Township 26S		Range 31E	County EDDY			
Actual Well Location of Well: 1000 feet from the WEST line and 890 feet from the SOUTH line								
Well Type, Elev. dry, 0	Producing Formation Brushy Draw			Pool North Mason		Dedicated Acreage 40 Acres		

1. Outline the acreage dedicated to the subject well by colored pencil or hatchure marks on the plat below.
2. If more than one lease is dedicated to the well, outline each and identify the ownership thereof (both as to working interest and royalty).
3. If more than one lease of different ownership is dedicated to the well, have the interests of all owners been consolidated by communitization, unitization, force-pooling, etc?

☒ Yes ☐ No If answer is "yes," type of consolidation _____

If answer is "no," list the owners and tract descriptions which have actually been consolidated (Use reverse side of this form if necessary.) _____

No allowable will be assigned to the well until all interests have been consolidated (by communitization, unitization, forced-pooling, or otherwise) or until a non-standard unit, eliminating such interests, has been approved by the Commission.

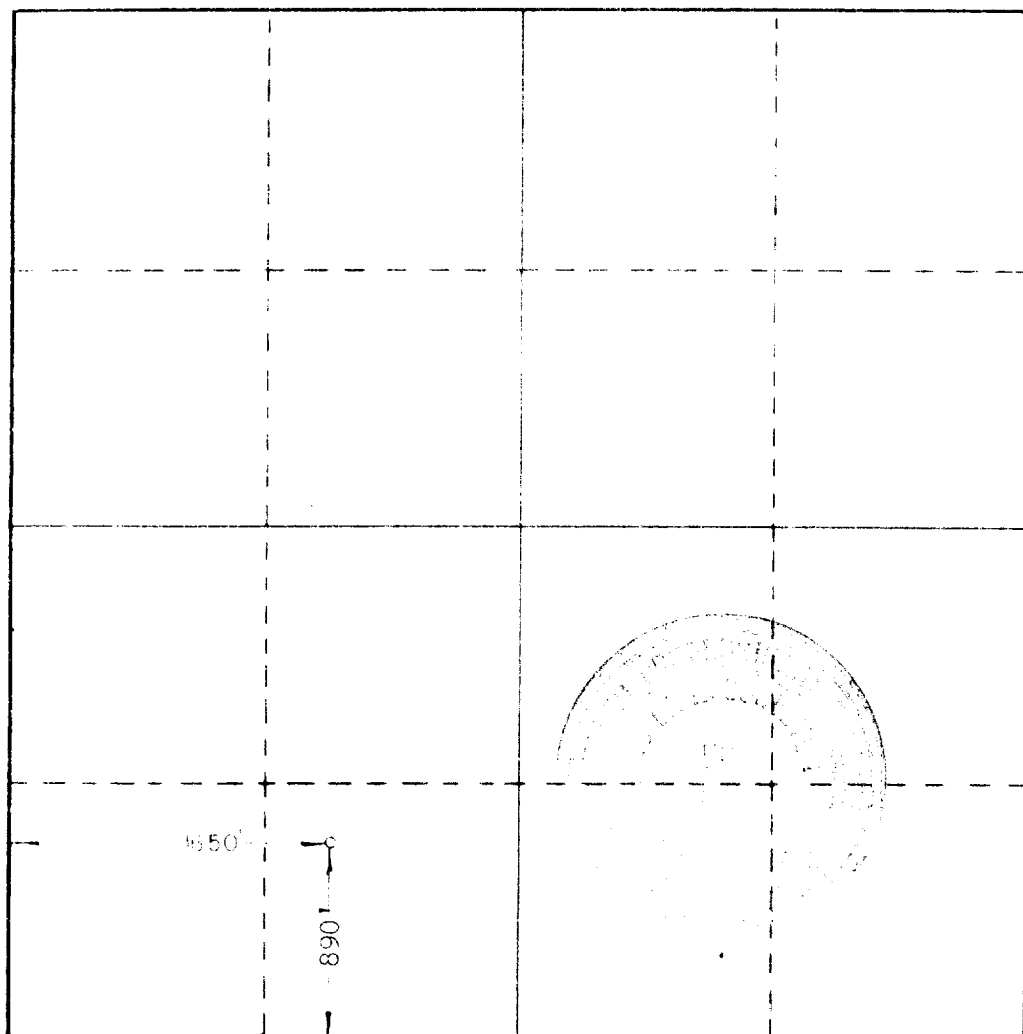

CERTIFICATION

I hereby certify that the information contained herein is true and complete to the best of my knowledge and belief.

James A. Knauf
James A. Knauf

Position
Agent

Company
HANSON OPERATING CO., INC.

Date
April 1, 1985

I hereby certify that the well location shown on this plat was plotted from field notes of actual surveys made by me or under my supervision, and that the same is true and correct to the best of my knowledge and belief.

Date Surveyed
3/23/85

Registered Professional Engineer
and/or Land Surveyor

John W. West

Certificate No. **JOHN W. WEST, 676**
RONALD J. EIDSON, 3239

330 660 990 1320 1650 1980 2310 2640 2970 3300 3630 3960 4290 4620 4950 5280 5610 5940 6270 6600 6930 7260 7590 7920 8250 8580 8910 9240 9570 9900

BLOWOUT PREVENTER ARRANGEMENT
Hanson Operating Company, Inc.
Well #16 Hanson Federal
890' FSL & 1550' FWL Sec. 25-26S-31E

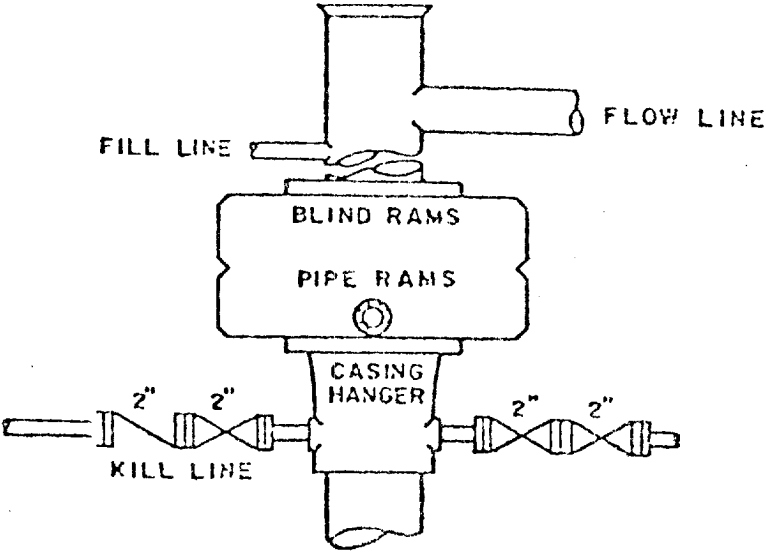

900 Series

SUPPLEMENTAL DRILLING DATA

HANSON OPERATING COMPANY, INC.
WELL #16 HANSON FEDERAL
SE $\frac{1}{4}$ SW $\frac{1}{4}$ SEC. 25-26S-31E
EDDY COUNTY, NEW MEXICO

1. SURFACE FORMATION: Quaternary.

2. ESTIMATED TOPS OF GEOLOGIC MARKERS:

Anhydrite	1000'	Delaware Sand	4170'
Base Lower Salt	3920'	Cherry Canyon	5100'
Delaware Lime	4130'	Brushy Canyon	6400'

3. POSSIBLE HYDROCARBON BEARING ZONES:

Bell Canyon: Oil
Cherry Canyon: Oil
Brushy Canyon: Oil

4. CASING DESIGN:

<u>Size</u>	<u>Interval</u>	<u>Weight</u>	<u>Grade</u>	<u>Joint</u>
13 3/8"	0 - 1050'	48.0#	J-55	STC
8 5/8"	0 - 2450'	24.0#	J-55	STC
	2450 - 4050'	32.0#	J-55	STC
5 1/2"	0 - 7100'	15.5#	J-55	STC

5. PRESSURE CONTROL EQUIPMENT: Two Ram-Type Preventors. A sketch of BOP stack is attached.

6. CIRCULATING MEDIUM:

0 - 1050' Fresh water with gel or lime as needed.
1050 - 4050' Brine.
4050 - 7100' Cut brine conditioned as necessary for control of viscosity and water loss.

7. AUXILIARY EQUIPMENT: Drill string safety valve.

8. TESTING, LOGGING AND CORING PROGRAMS: No coring or DST's are planned. Electric logs will include a Compensated Neutron Log with Gamma Ray.

9. ABNORMAL PRESSURES, TEMPERATURES OR GAS: None anticipated.

10. ANTICIPATED STARTING DATE: It is planned that operations will commence about April 25, 1985. Duration of drilling, testing, and completion operations should be 3 to 9 weeks.

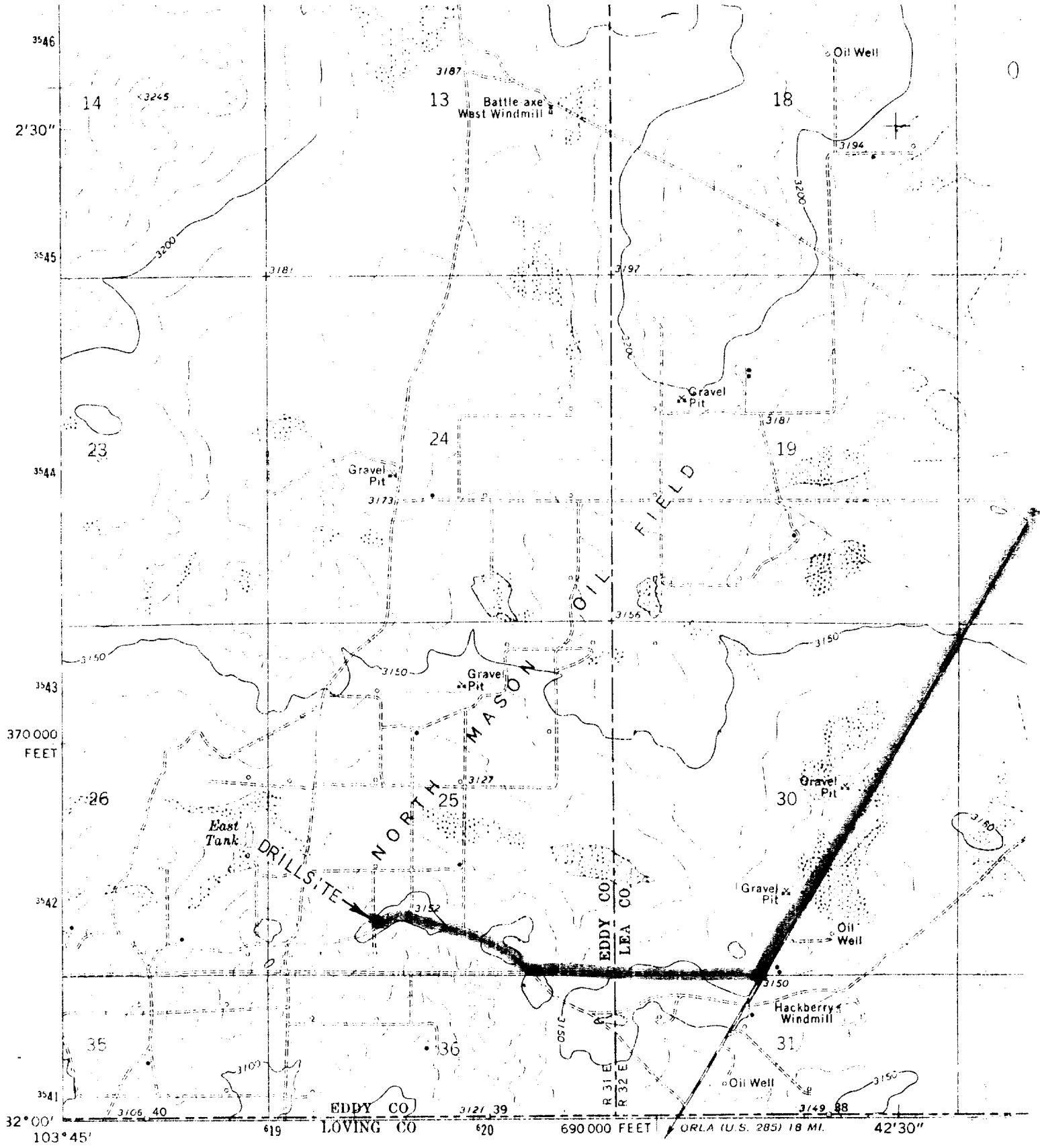

Mapped, edited, and published by the Geological Survey
 Control by USGS and NOS/NOAA
 Topography by photogrammetric methods from aerial
 photographs taken 1971. Field checked 1973
 Projection and 10,000-foot grid ticks: New Mexico
 coordinate system, east zone (transverse Mercator)
 1000-metre Universal Transverse Mercator grid ticks,
 zone 13, shown in blue. 1927 North American datum
 Fine red dashed lines indicate selected fence lines

SUP Exhibit "B"
 TOPOGRAPHIC MAP
 Hanson Operating Company, Inc.
 Well #16 Hanson Federal
 890' FSL & 1650' FWL Sec. 25-26S-31E

UTM GRID AND 1973 MAGNETIC NORTH
 DECLINATION AT CENTER OF SHEET

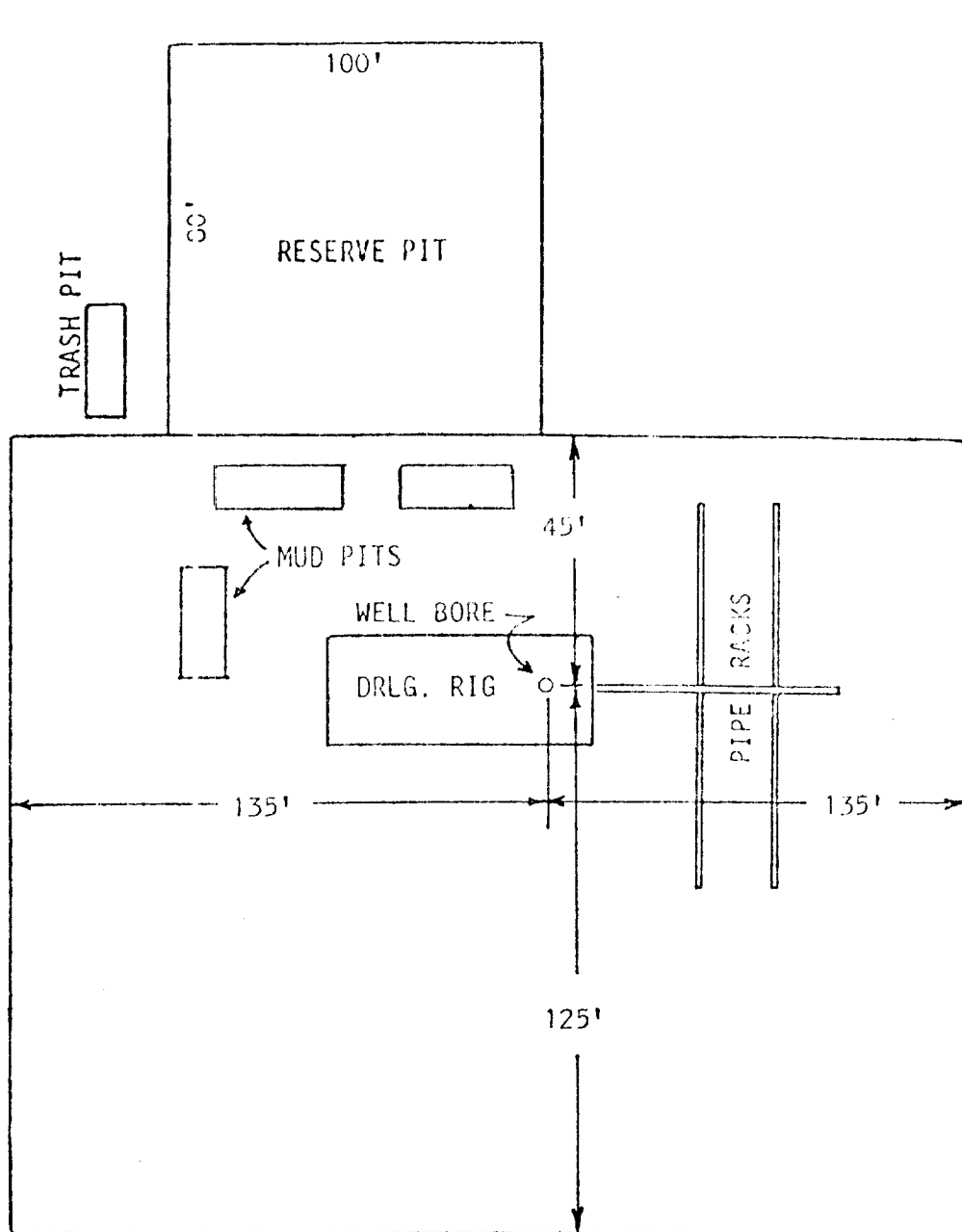

SUP Exhibit "D"
SKETCH OF WELL PAD

Hanson Operating Company, Inc.
Well #16 Hanson Federal
890' FSL & 1650' FWL Sec. 25-26S-31E