

DISTRICT I
 P. O. Box 1980
 Hobbs, NM 88240

OIL CONSERVATION DIVISION
 P. O. Box 2088
 Santa Fe, New Mexico 87504-2088

DISTRICT II
 P. O. Drawer DD
 Artesia, NM 88210

DISTRICT III
 1000 Rio Brazos Rd
 Aztec, NM 87410

WELL LOCATION AND ACREAGE DEDICATION PLAT
 All distances must be from the outer boundaries of the section.

Operator SANTA FE ENERGY OPER. PART, L.P.			Lease STERLING SILVER '33' FEDERAL		Well No. 17
Unit Letter P	Section 33	Township 23 SOUTH	Range 31 EAST, N.M.P.M.		County EDDY
Actual Footage Location of Well					
660 feet from the SOUTH line and		660 feet from the EAST line			
Ground Level Elev. 3412'	Producing Formation Delaware	Pool Sand Dunes, West (Delaware)		Acres 40	

- Outline the acreage dedicated to the subject well by colored pencil or hachure marks on the plat below.
- If more than one lease is dedicated to the well, outline each and identify the ownership thereof (both as to working interest and royalty).
- If more than one lease of different ownership is dedicated to the well, have the interest of all the owners been consolidated by communitization, unitization, forced-pooling, etc.?
 Yes No If answer is "yes", type of consolidation _____
 If the answer is "no", list the owners and tract descriptions which have actually been consolidated. (Use the reverse side of this form if necessary.) _____
 No allowable will be assigned to the well until all interests have been consolidated (by communitization, unitization, forced-pooling, or otherwise) or until a non-standard unit, eliminating such interest, has been approved by the division.

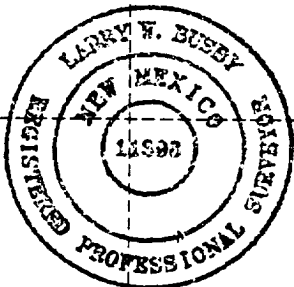
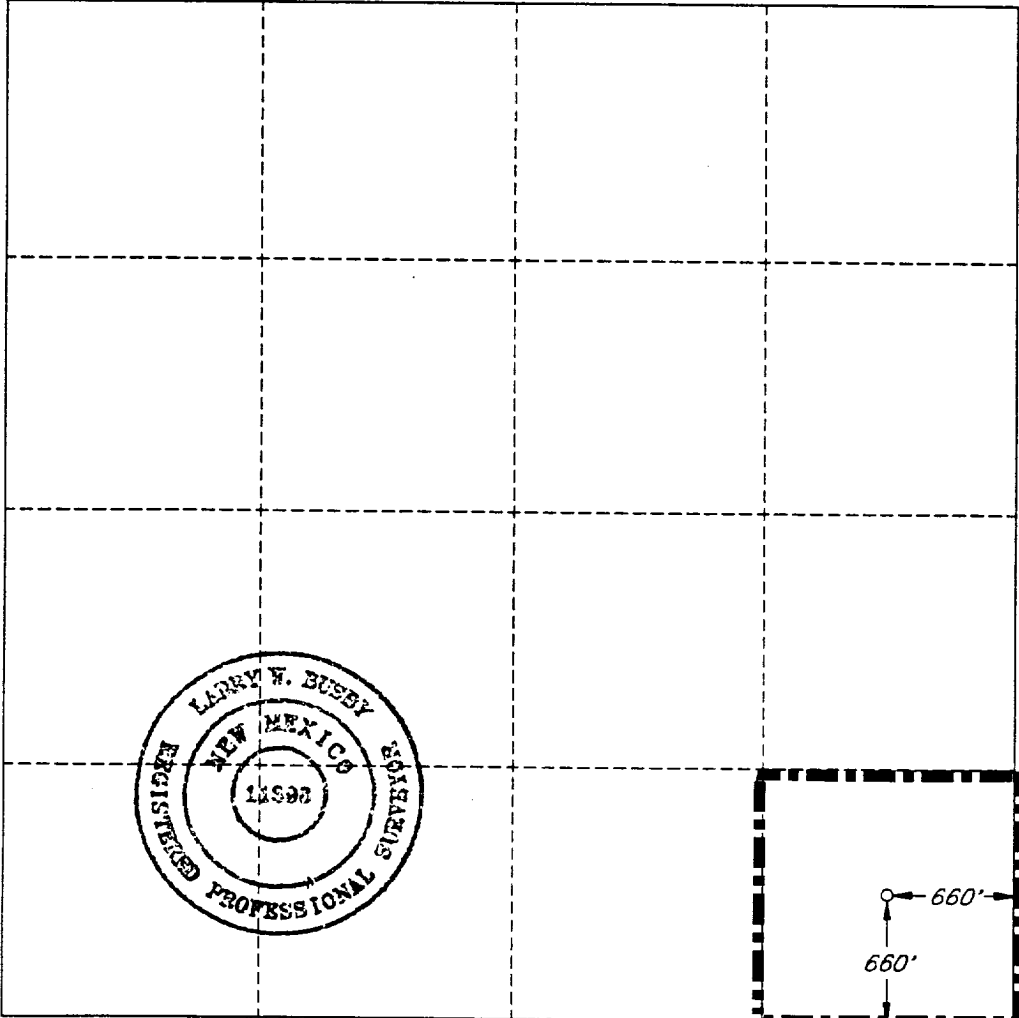

OPERATOR CERTIFICATION

I hereby certify that the information herein is true and complete to the best of my knowledge and belief.

Signature
Darrell Roberts

Printed Name
 Darrell Roberts

Position
 Sr. Drilling Engineer

Company
 Santa Fe Energy Operating Partners, L.P.

Date
 4/7/93

SURVEYOR CERTIFICATION

I hereby certify that the well location shown on this plat was plotted from field notes of actual surveys made by me or under my supervision, and that the same is true and correct to the best of my knowledge and belief.

Date Surveyed
 MARCH 11, 1993

Signature and Seal of Professional Surveyor
Larry W. Busby

Certificate No.
 LARRY W. BUSBY R.P.S. #11398

JOB NO. 94830 V.H.B.