

NM OIL & GAS COMMISSION

DRAWER DD

ARTESIA, NM 88210

UNITED STATES

DEPARTMENT OF THE INTERIOR

BUREAU OF LAND MANAGEMENT

Form 3160-3 (December 1990)

SUBMIT IN TRIPLICATE*

(Other instructions on reverse side)

Form approved.

Budget Bureau No. 1004-0136

Expires: December 31, 1991

O. C. D. ARTESIA

LEASE DESIGNATION AND SERIAL NO. NM 025533

IF INDIAN, ALLOTTEE OR TRIBE NAME

UNIT AGREEMENT NAME

Poker Lake Unit

FARM OR LEASE NAME, WELL NO. 1794

Poker Lake Unit #99

AP WELL NO. 30-015-27960

FIELD AND POOL OR WILDCAT

Poker Lake (Delaware), SW

SEC., T., R., M., OR BLK. AND SURVEY OR AREA 96047

Section 19, T-24-S, R-31-E

COUNTY OR PARISH: Eddy STATE: New Mexico

APPLICATION FOR PERMIT TO DRILL OR DEEPEN

1a. TYPE OF WORK DRILL [X] DEEPEN []

b. TYPE OF WELL OIL WELL [X] GAS WELL [] OTHER [] SINGLE ZONE [X] MULTIPLE ZONE []

2. NAME OF OPERATOR Bass Enterprises Production Co. 1801

3. ADDRESS AND TELEPHONE NO. P.O. Box 2760, Midland, Texas 79702 (915) 683-2277

4. LOCATION OF WELL (Report location clearly and in accordance with any State requirements.*) At surface 1980' FNL & 660' FWL, Section 19, T-24-S, R-31-E At proposed prod. zone LOT. 2

14. DISTANCE IN MILES AND DIRECTION FROM NEAREST TOWN OR POST OFFICE* 16 miles east of Malaga, New Mexico

15. DISTANCE FROM PROPOSED* LOCATION TO NEAREST PROPERTY OR LEASE LINE, FT. (Also to nearest drilg. unit line, if any) 660

16. NO. OF ACRES IN LEASE 324.37

17. NO. OF ACRES ASSIGNED TO THIS WELL 40

18. DISTANCE FROM PROPOSED LOCATION* TO NEAREST WELL, DRILLING, COMPLETED, OR APPLIED FOR, ON THIS LEASE, FT. 1320

19. PROPOSED DEPTH 8300'

20. ROTARY OR CABLE TOOLS Rotary

21. ELEVATIONS (Show whether DF, RT, GR, etc.) 3471' GR

22. APPROX. DATE WORK WILL START* Upon Approval

PROPOSED CASING AND CEMENTING PROGRAM

SIZE OF HOLE	GRADE SIZE OF CASING	WEIGHT PER FOOT	SETTING DEPTH	QUANTITY OF CEMENT
*14 3/4"	WC-40 11 3/4"	42#	390'	495 Sx Circ. to surface
**11"	WC-50 8 5/8"	32#	4100'	770 Sx Circ. to surface
*** 7 7/8"	K-55 5 1/2"	15.5#	8300'	610 Sx Circ. (tie back to int. csg @ 3900')

*Surface casing to be +/- 100' above salts in the Rustler Anhydrite.

**Intermediate casing to be set in the top of the Lamar Lime.

***D.V. Tool to be set +/- 6000'; cement to tie back to 3900'.

Part FD-1 5-20-94 New Mexico BPE

Drilling Procedure, BOP diagram, anticipated tops and surface use plan attached.

This well is outside the R-111 Potash Area.

CERTIFIED# P 237 023 593 - BGH:PGO

IN ABOVE SPACE DESCRIBE PROPOSED PROGRAM: If proposal is to deepen, give data on present productive zone and proposed new productive zone. If proposal is to drill or deepen directionally, give pertinent data on subsurface locations and measured and true vertical depths. Give blowout preventer program, if any.

SIGNED William R. Donnell TITLE Division Drilling Supt. DATE 4-8-94

(This space for Federal or State office use)

APPROVAL SUBJECT TO GENERAL REQUIREMENTS AND SPECIAL STIPULATIONS ATTACHED

PERMIT NO. APPROVAL DATE Application approval does not warrant or certify that the applicant holds legal or equitable title to those rights in the subject lease which would entitle the applicant to conduct operations thereon.

CONDITIONS OF APPROVAL, IF ANY:

APPROVED BY [Signature] TITLE AREA MANAGER DATE 5-11-94

*See Instructions On Reverse Side

OIL CONSERVATION DIVISION

P.O. Box 2088

Santa Fe, New Mexico 87504-2088

DISTRICT I
 P.O. Box 1960, Hobbs, NM 88240

DISTRICT II
 P.O. Drawer DD, Artesia, NM 88210

DISTRICT III
 1000 Elko Brazos Rd., Artec, NM 87410

WELL LOCATION AND ACREAGE DEDICATION PLAT

All Distances must be from the outer boundaries of the section

Operator BASS ENTERPRISES PRODUCTION COMPANY		Lease POKER LAKE UNIT		Well No. 99
Unit Letter LOT 2	Section 19	Township 24 SOUTH	Range 31 EAST NMPM	County EDDY
Actual Footage Location of Well:				
1980 feet from the NORTH line and		660 feet from the WEST line		
Ground Level Elev. 3471'	Producing Formation Delaware	Pool Poker Lake (Delaware), SW	Dedicated Acreage: 40 Acres	

- Outline the acreage dedicated to the subject well by colored pencil or hachure marks on the plat below.
- If more than one lease is dedicated to the well, outline each and identify the ownership thereof (both as to working interest and royalty).
- If more than one lease of different ownership is dedicated to the well, have the interest of all owners been consolidated by communitization, unitization, force-pooling, etc.?

Yes No If answer is "yes" type of consolidation _____

If answer is "no" list of owners and tract descriptions which have actually been consolidated. (Use reverse side of this form necessary.)

No allowable will be assigned to the well unit all interests have been consolidated (by communitization, unitization, forced-pooling, otherwise) or until a non-standard unit, eliminating such interest, has been approved by the Division.

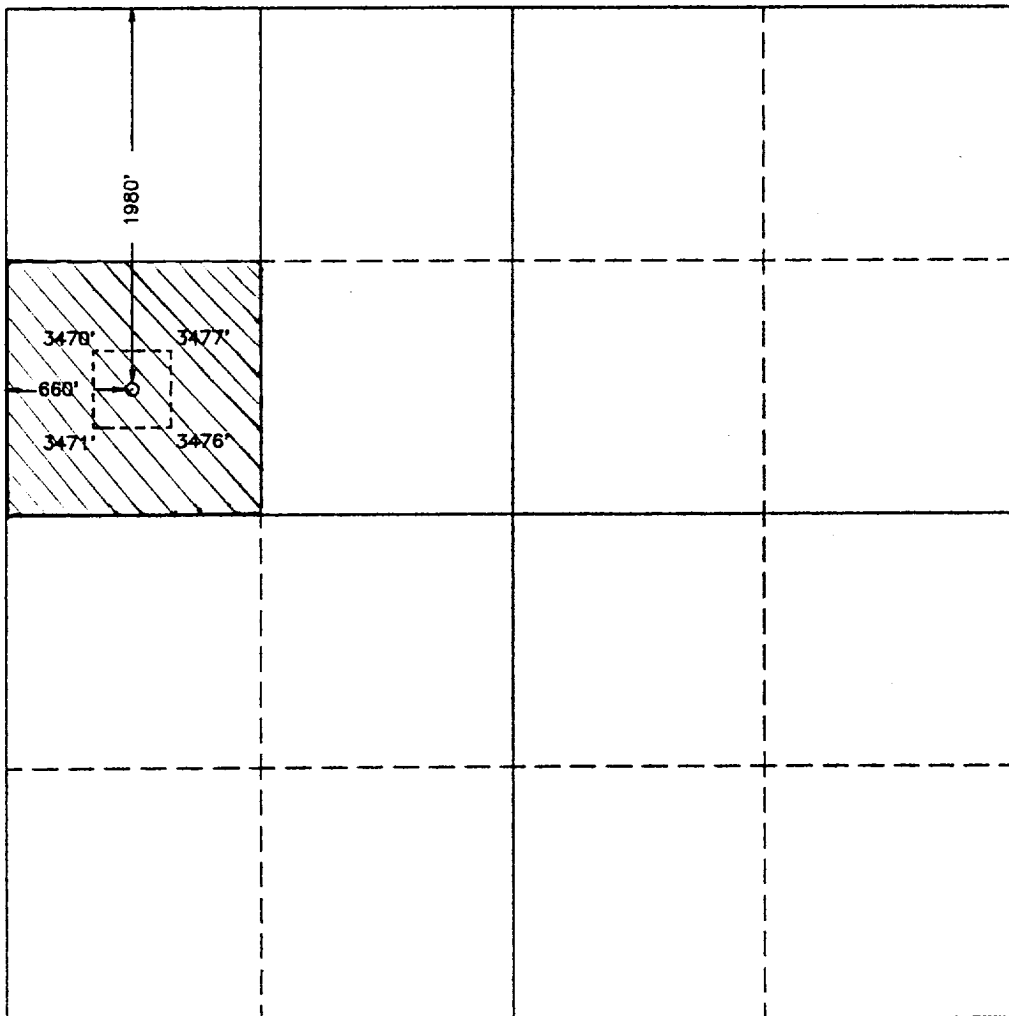

OPERATOR CERTIFICATION

I hereby certify the the information contained herein is true and complete to the best of my knowledge and belief.

Signature
William R. Dannels
 Printed Name
 W.R. Dannels
 Position
 Division Dir. Supt.
 Company
 Bass Enterprises Prod. Co.
 Date
 4-8-94

SURVEYOR CERTIFICATION

I hereby certify that the well location shown on this plat was plotted from field notes of actual surveys made by me or under my supervision, and that the same is true and correct to the best of my knowledge and belief.

Date Surveyed
 MARCH 3, 1994
 Signature & Seal of Professional Surveyor

 Certificate No. WEST, 676
 J. EIDSON, 3239
 GARY L. JONES, 7977

3000 PSI WP

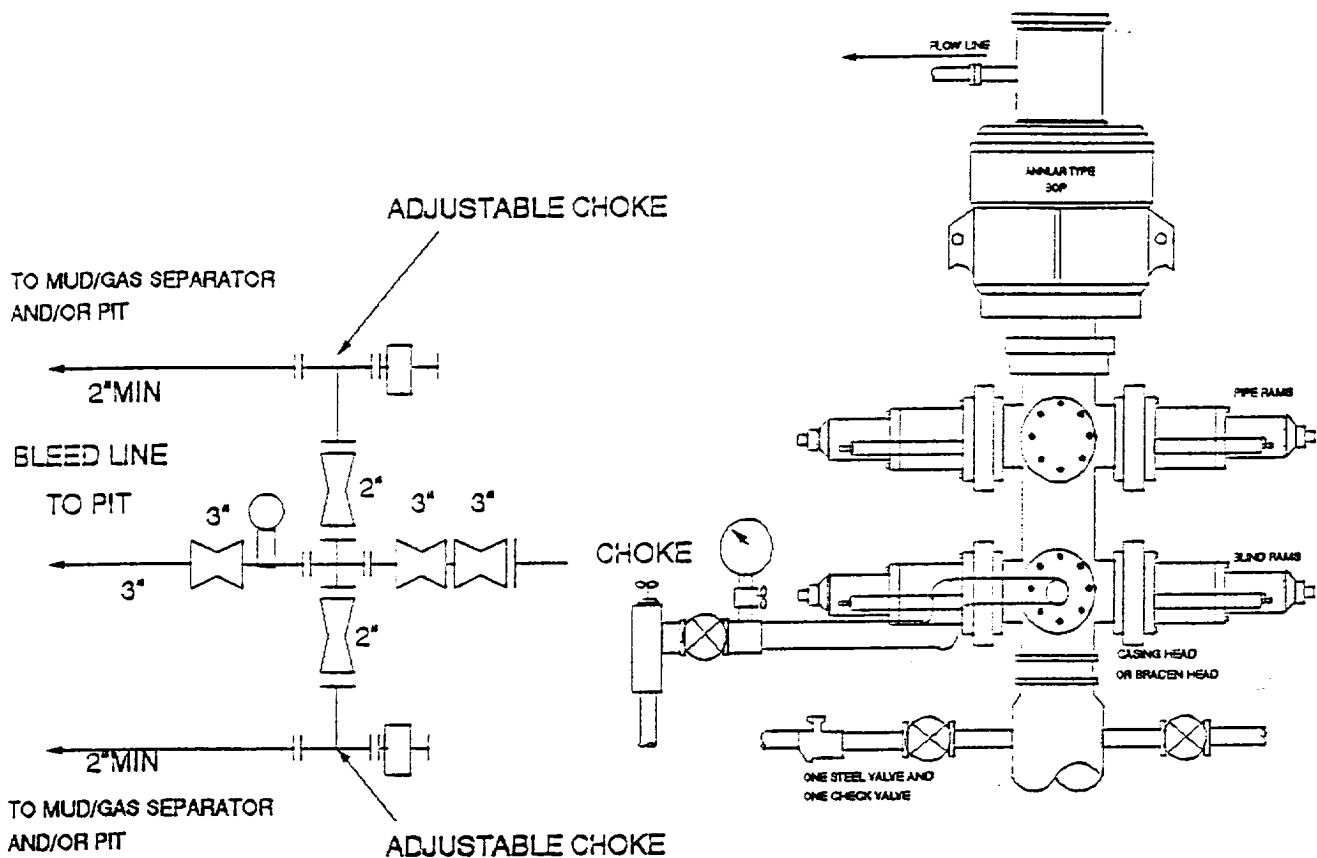

THE FOLLOWING CONSTITUTE MINIMUM BLOWOUT PREVENTER REQUIREMENTS

- A. One double gate blowout preventer with lower rams for pipe and upper rams blind, all hydraulically controlled.
- B. Opening on preventers between rams to be flanged, studded or clamped and at least two inches in diameter.
- C. All connections from operating manifold to preventers to be all steel hose or tube a minimum of one inch in diameter.
- D. The available closing pressure shall be at least 15% in excess of that required with sufficient volume to operate (close, open, and re-close) the preventers.
- E. All connections to and from preventers to have a pressure rating equivalent to that of the BOP's.
- F. Manual controls to be installed before drilling cement plug.
- G. Valve to control flow through drill pipe to be located on rig floor.
- H. Choke may be either positive or adjustable. Choke spool may be used between rams.