

District I

P.O. Box 1900, Belden, NM

District II

P.O. Box 1900, Belden, NM

District III

1000 Rio Bravo Rd., Artesia, NM

**State of New Mexico**  
Energy, Minerals and Natural Resources Department

**OIL CONSERVATION DIVISION**  
P.O. BOX 2088  
SANTA FE, NEW MEXICO 87504-2088

Outside **B1144**  
V/A  
No TPTT

SUBMIT 1 COPY TO  
APPROPRIATE  
DISTRICT OFFICE  
AND 1 COPY TO  
SANTA FE OFFICE

**PIT REMEDIATION AND CLOSURE REPORT**

30-045-25234

Operator: BP AMERICA PRODUCTION CO. Telephone: (505) 326-9200

Address: 200 ENERGY COURT, FARMINGTON, NM 87401

Facility or Well Name: BCU # 133E

Location: Unit or Qtr/Qtr Sec C Sec 17 T 29N R 12W County San Juan

Pit Type: Separator    Dehydrator    Other Blow

Land Type: BLM X, State   , Fee   , Other   

Pit Location:  
(Attach diagram)

Pit dimensions: length NA, width NA, depth NA

Reference: wellhead X, other   

Footage from reference: 138'

Direction from reference: 64 Degrees    East    North ✓  
   West    South   

**Depth To Groundwater:**

(Vertical distance from  
contaminants to seasonal  
high water elevation of  
groundwater)

Less than 50 feet	(20 points)	
50 feet to 99 feet	(10 points)	
Greater than 100 feet	(0 points)	<u>0</u>

**Wellhead Protection Area:**

(Less than 200 feet from a private  
domestic water source, or; less than  
1000 feet from all other water sources)

Yes	(20 points)	
No	(0 points)	<u>0</u>

**Distance To Surface Water:**

(Horizontal distance to perennial  
lakes, ponds, rivers, streams, creeks,  
irrigation canals and ditches)

Less than 100 feet	(20 points)	
100 feet to 1000 feet	(10 points)	
Greater than 1000 feet	(0 points)	<u>0</u>

**RANKING SCORE (TOTAL POINTS):** 0

Date Remediation Started: \_\_\_\_\_ Date Completed: 2-6-03

Remediation Method: Excavation X Approx. cubic yards NA  
(Check all appropriate sections) Landfarmed \_\_\_\_\_ Insitu Bioremediation \_\_\_\_\_  
Other CLOSE AS IS.

Remediation Location: Onsite X Offsite \_\_\_\_\_  
(i.e. landfarmed onsite, name and location of offsite facility)

General Description of Remedial Action: Excavation. Test hole advanced. No remediation necessary.  
no TPH analysis conducted

Groundwater Encountered: No X Yes \_\_\_\_\_ Depth \_\_\_\_\_

Final Pit Closure Sampling:

(If multiple samples, attach sample results and diagram of sample locations and depths)

Sample location see Attached Documents

Sample depth 8' (Test hole bottom)

Sample date 2-6-03 Sample time 0855

Sample Results

Soil: Benzene	(ppm) _____	Water: Benzene	(ppb) _____
Total BTEX	(ppm) _____	Toluene	(ppb) _____
Field Headspace	(ppm) <u>0.0</u>	Ethylbenzene	(ppb) _____
TPH	(ppm) _____	Total Xylenes	(ppb) _____

Groundwater Sample: Yes \_\_\_\_\_ No X (If yes, attach sample results)

I HEREBY CERTIFY THAT THE INFORMATION ABOVE IS TRUE AND COMPLETE TO THE BEST OF MY KNOWLEDGE AND BELIEF

DATE 2-6-03 PRINTED NAME Jeffrey C. Blagg

SIGNATURE Jeffrey C. Blagg AND TITLE President P.E. # 11607

CLIENT: BP

**BLAGG ENGINEERING, INC.**  
**P.O. BOX 87, BLOOMFIELD, NM 87413**  
**(505) 632-1199**

LOCATION NO: 81144COCR NO: —**FIELD REPORT: PIT CLOSURE VERIFICATION**PAGE No: 1 of 1LOCATION: NAME: GCU WELL#: 133E TYPE: BLOWDATE STARTED: 2/6/03QUAD/UNIT: C SEC: 17 TWP: 29N RING: 12W PM: NM CNTY: SJ ST: NMDATE FINISHED: —QTR/FOOTAGE: 850'N/1550'W NE/NW CONTRACTOR: SIERRA (HAROLD)ENVIRONMENTAL SPECIALIST: NVEXCAVATION APPROX. NA FT. x NA FT. x NA FT. DEEP. CUBIC YARDAGE: NADISPOSAL FACILITY: ON-SITE REMEDIATION METHOD: CLOSE AS ISLAND USE: RANGE - BLM LEASE: NM078391C FORMATION: DKFIELD NOTES & REMARKS: PIT LOCATED APPROXIMATELY 138 FT. N64W FROM WELLHEAD.DEPTH TO GROUNDWATER: >100' NEAREST WATER SOURCE: >1000' NEAREST SURFACE WATER: >1000'NMOCD RANKING SCORE: 0 NMOCD TPH CLOSURE STD: 5000 PPM**SOIL AND EXCAVATION DESCRIPTION:**

OVM CALIB. READ. = 52.8 ppm  
 OVM CALIB. GAS = 100 ppm RF = 0.52  
 TIME: 12:45 am/pm DATE: 2/5/03

SOIL TYPE: SAND SILTY SAND / SILT / SILTY CLAY / CLAY / GRAVEL / OTHER —SOIL COLOR: DR. YEL. ORANGE TO MOD. YEL. BROWNCOHESION (ALL OTHERS): NON COHESIVE SLIGHTLY COHESIVE / COHESIVE / HIGHLY COHESIVECONSISTENCY (NON COHESIVE SOILS): LOOSE FIRM DENSE / VERY DENSE

PLASTICITY (CLAYS): NON PLASTIC / SLIGHTLY PLASTIC / COHESIVE / MEDIUM PLASTIC / HIGHLY PLASTIC

DENSITY (COHESIVE CLAYS &amp; SILTS): SOFT / FIRM / STIFF / VERY STIFF / HARD

MOISTURE: DRY / SLIGHTLY MOIST MOIST / WET / SATURATED / SUPER SATURATEDDISCOLORATION/STAINING OBSERVED: YES NO EXPLANATION - CLOSEDHC ODOR DETECTED: YES NO EXPLANATION - —SAMPLE TYPE: GRAB COMPOSITE - # OF PTS. —ADDITIONAL COMMENTS: NO TPH ANALYSIS WAS CONDUCTED.

SCALE



0 FT

## FIELD 418.1 CALCULATIONS

SAMP. TIME	SAMP. ID	LAB NO.	WEIGHT (g)	mL FREON	DILUTION	READING	CALC. (ppm)

## PIT PERIMETER

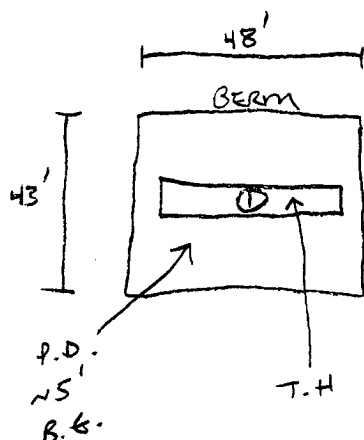
OVM  
READING

SAMPLE ID	FIELD HEADSPACE (ppm)
1 @ 8'	0.0
2 @	
3 @	
4 @	
5 @	

## LAB SAMPLES

SAMPLE ID	ANALYSIS	TIME
		0855

## PIT PROFILE

NOT APPLICABLE

P.D. = PIT DEPRESSION; B.G. = BELOW GRADE; B = BELOW  
 T.H. = TEST HOLE; ~ = APPROX.; T.B. = TANK BOTTOM

TRAVEL NOTES:

CALLOUT: 2/6/03 - MORN. ONSITE: 2/6/03 - MORN.