

Submit 3 Copies To Appropriate District
Office
District I
1625 N. French Dr., Hobbs, NM 88240
District II
1301 W. Grand Ave., Artesia, NM 88210
District III
1000 Rio Brazos Rd., Aztec, NM 87410
District IV
1220 S. St. Francis Dr., Santa Fe, NM
87505

State of New Mexico
Energy, Minerals and Natural Resources

Form C-103
Revised March 25, 1999

OIL CONSERVATION DIVISION
1220 South St. Francis Dr.
Santa Fe, NM 87505

WELL API NO.
30-045-30993
5. Indicate Type of Lease
STATE ☒ FEE ☐
6. State Oil & Gas Lease No.
B-11242

SUNDRY NOTICES AND REPORTS ON WELLS
(DO NOT USE THIS FORM FOR PROPOSALS TO DRILL OR TO DEEPEN OR PLUG BACK TO A
DIFFERENT RESERVOIR. USE "APPLICATION FOR PERMIT" (FORM C-101) FOR SUCH
PROPOSALS.)

1. Type of Well:
Oil Well ☐ Gas Well ☒ Other

2. Name of Operator
Richardson Operating Company

3. Address of Operator
3100 La Plata Highway Farmington, NM 87401

4. Well Location

Unit Letter C : 1186 feet from the North line and 1392 feet from the West line

Section 16 Township 29N Range 14W NMPM County San Juan

10. Elevation (Show whether DR, RKB, RT, GR, etc.)
5190' GR

7. Lease Name or Unit Agreement Name:
Ropco 16

7. Well No.
#2

9. Pool name or Wildcat
Basin Fruitland Coal

11. Check Appropriate Box to Indicate Nature of Notice, Report or Other Data

NOTICE OF INTENTION TO:

PERFORM REMEDIAL WORK ☐ PLUG AND ABANDON ☐

TEMPORARILY ABANDON ☐ CHANGE PLANS ☐

PULL OR ALTER CASING ☐ MULTIPLE COMPLETION ☐

OTHER: Add Fruitland Coal/Alter Acreage Dedication

SUBSEQUENT REPORT OF:

REMEDIAL WORK ☐ ALTERING CASING ☐

COMMENCE DRILLING OPNS. ☐ PLUG AND ABANDONMENT ☐

CASING TEST AND CEMENT JOB ☐

OTHER: ☐

12. Describe proposed or completed operations. (Clearly state all pertinent details, and give pertinent dates, including estimated date of starting any proposed work). SEE RULE 1103. For Multiple Completions: Attach wellbore diagram of proposed completion or recompilation.

Richardson Operating Company proposes adding the Fruitland Coal in this well pursuant to NMOCDC Order No. R-8768-C. Please find the attached C-102 depicting the dedicated acreage.

The Ropco 16 #1 is the other planned Fruitland Coal well in this dedicated acreage. This well has not yet been drilled.

I hereby certify that the information above is true and complete to the best of my knowledge and belief.

SIGNATURE [Signature] TITLE Operations Manager DATE 02-18-03

Type or print name Drew Carnes

Telephone No. 505-564-3100

(This space for State use)

APPROVED BY [Signature] TITLE DEPUTY OIL & GAS INSPECTOR, DIST. #2 DATE FEB 19 2003

Conditions of approval, if any:

State of New Mexico
Energy, Minerals & Mining Resources Department
OIL CONSERVATION DIVISION
2040 South Pacheco
Santa Fe, NM 87505

Form C - 102

☒ AMENDED REPORT

WELL LOCATION AND ACREAGE DEDICATION PLAT

APA Number	Pool Code 71629/86620	Pool Name Basin Fruitland Coal & Twin Mounds Pictured Cliffs
Property Code	Property Name ROPCO 16	Well Number 2
OGED No.	Operator Name RICHARDSON OPERATING COMPANY	Elevation 5190'

Surface Location									
U. or Lot	Sec.	Twp.	Rgn.	Lot No.	Foot from	North/South	Foot from	East/West	County
C	16	29 N.	14 W.		186'	NORTH	1392'	WEST	SAN JUAN

Bottom Hole Location if Different from Surface									
U. or Lot	Sec.	Twp.	Rgn.	Lot No.	Foot from	North/South	Foot from	East/West	County
Dedication	John ?	Consolidation			Order No.				

NO ALLOWABLE WELL ASSIGNED TO THIS COMPLETION UNTIL ALL INTERESTS HAVE BEEN CONSOLIDATED
OR A NON-STANDARD UNIT HAS BEEN APPROVED BY THE DIVISION

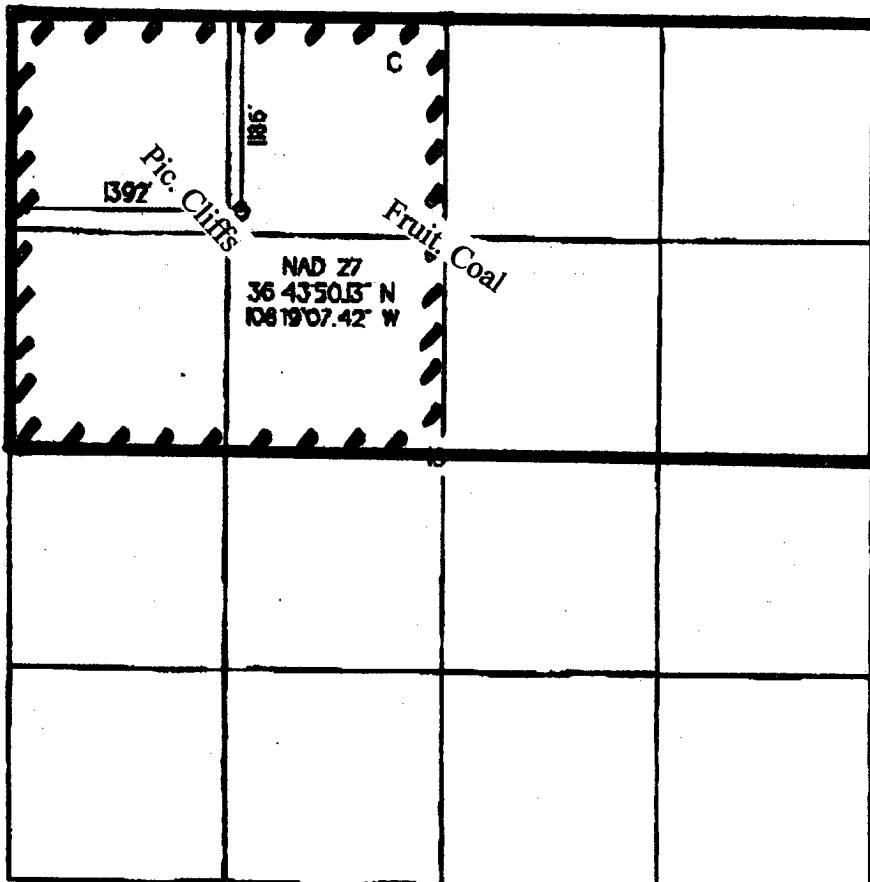

OPERATOR CERTIFICATION

I hereby certify that the information contained herein is true and complete to the best of my knowledge and belief.

Signature

Printed Name Drew Carnes

Title Operations Manager

Date February 18, 2003

SURVEYOR CERTIFICATION

I hereby certify that the well location on this plat was plotted from field notes of actual surveys made by me or under my supervision, and that the same is true and correct to the best of my belief.

Date of Survey

