

Submit 3 Copies To Appropriate District Office  
District I  
1625 N. French Dr., Hobbs, NM 88240  
District II  
1301 W. Grand Ave., Artesia, NM 88210  
District III  
1000 Rio Brazos Rd., Aztec, NM 87410  
District IV  
1220 S. St. Francis Dr., Santa Fe, NM 87505

State of New Mexico  
Energy, Minerals and Natural Resources

OIL CONSERVATION DIVISION  
1220 South St. Francis Dr.  
Santa Fe, NM 87505

30-04532366

Form C-103  
March 4, 2004

<b>SUNDRY NOTICES AND REPORTS ON WELLS</b> (DO NOT USE THIS FORM FOR PROPOSALS TO DRILL OR TO DEEPEN OR PLUG BACK TO A DIFFERENT RESERVOIR. USE "APPLICATION FOR PERMIT" (FORM C-101) FOR SUCH PROPOSALS.)		WELL API NO. <b>NEW WELL</b>
1. Type of Well: Oil Well <input type="checkbox"/> Gas Well <input checked="" type="checkbox"/> Other		5. Indicate Type of Lease STATE <input type="checkbox"/> FEE <input type="checkbox"/>
2. Name of Operator <b>BP AMERICA PRODUCTION CO</b>		6. State Oil & Gas Lease No.
3. Address of Operator <b>P.O. BOX 3092 HOUSTON, TX 77079-2064</b>		7. Lease Name or Unit Agreement Name <b>LUDWICK LS</b> (APD filed with BLM 5/13/04 SF 078194)
4. Well Location Unit Letter <b>J</b> : <b>2450</b> feet from the <b>SOUTH</b> line and <b>1780</b> feet from the <b>EAST</b> line Section <b>19</b> Township <b>30N</b> Range <b>10W</b> NMPM <b>SAN JUAN</b> County		8. Well Number <b>15 M</b>
11. Elevation (Show whether DR, RKB, RT, GR, etc.) <b>6269'</b>		9. OGRID Number
10. Pool name or Wildcat <b>Basin Dakota &amp; Blanco Mesaverde</b>		
<b>Pit or Below-grade Tank Application (For pit or below-grade tank closures, a form C-144 must be attached)</b>		
Pit Location: UL <b>J</b> Sect <b>19</b> Twp <b>30N</b> Rng <b>10W</b> Pit type <b>Drilling</b> Depth to Groundwater <b>&gt;100'</b> Distance from nearest fresh water well <b>&gt;1000'</b> Distance from nearest surface water <b>&gt;1000'</b> Below-grade Tank Location UL <b>J</b> Sect <b>19</b> Twp <b>30N</b> Rng <b>10W</b> ; <b>2550</b> feet from the <b>SOUTH</b> line and <b>1755</b> feet from the <b>EAST</b> line PLEASE SEE ATTACHED PAD LAYOUT		

12. Check Appropriate Box to Indicate Nature of Notice, Report or Other Data	
<b>NOTICE OF INTENTION TO:</b>	<b>SUBSEQUENT REPORT OF:</b>
PERFORM REMEDIAL WORK <input type="checkbox"/> PLUG AND ABANDON <input type="checkbox"/>	REMEDIAL WORK <input type="checkbox"/> ALTERING CASING <input type="checkbox"/>
TEMPORARILY ABANDON <input type="checkbox"/> CHANGE PLANS <input type="checkbox"/>	COMMENCE DRILLING OPNS. <input type="checkbox"/> PLUG AND ABANDONMENT <input type="checkbox"/>
PULL OR ALTER CASING <input type="checkbox"/> MULTIPLE COMPLETION <input type="checkbox"/>	CASING TEST AND CEMENT JOB <input type="checkbox"/>
OTHER: <b>Lined Drk</b> <b>PIT PERMIT</b> <input checked="" type="checkbox"/>	OTHER: <input type="checkbox"/>

13. Describe proposed or completed operations. (Clearly state all pertinent details, and give pertinent dates, including estimated date of starting any proposed work). SEE RULE 1103. For Multiple Completions: Attach wellbore diagram of proposed completion or recompletion.  
Please reference BP America's San Juan Basin Drilling/Workover Pit Construction Plan on file with the NMOCD. Pit construction Plan issued date of 04/15/2004. Pit will be closed according to closure plan on file.

I hereby certify that the information above is true and complete to the best of my knowledge and belief. I further certify that any pit or below-grade tank has been/will be constructed or closed according to NMOCD guidelines ☐, a general permit ☐ or an (attached) alternative OCD-approved plan ☐.

SIGNATURE Cherry Hlava TITLE Regulatory Analyst DATE 5/20/04  
Type or print name Cherry Hlava E-mail address: hlavacl@bp.com Telephone No. 281-366-4081

(This space for State use)

APPROVED BY Henry Tang TITLE DEPUTY OIL & GAS INSPECTOR, DIST. # DATE MAY 24 2004  
Conditions of approval, if any:

**PAD LAYOUT PLAN & PROFILE**  
**BP AMERICA PRODUCTION COMPANY**  
 Ludwick LS #15M  
 2450' F/SL 1780' F/EL  
 SEC. 19, T30N, R10W, N.M.P.M.  
 SAN JUAN COUNTY, NEW MEXICO

Lat: 36°47'48"  
 Long: 107°55'21"

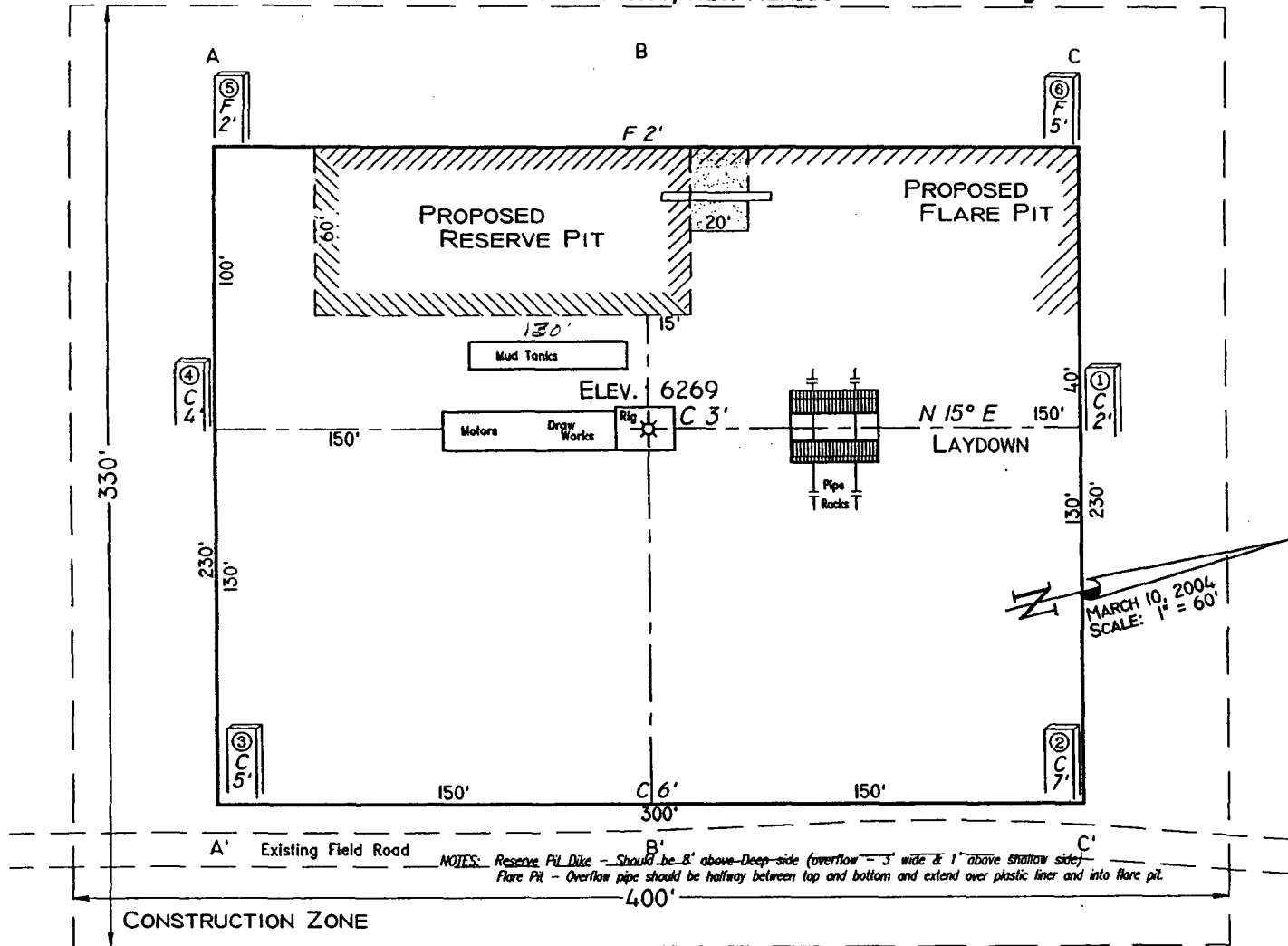

Area of Construction Zone - 330'x400' or 3.03 acres, more or less.

SCALE: 1"=60'-HORIZ.  
 1"=40'-VERT.

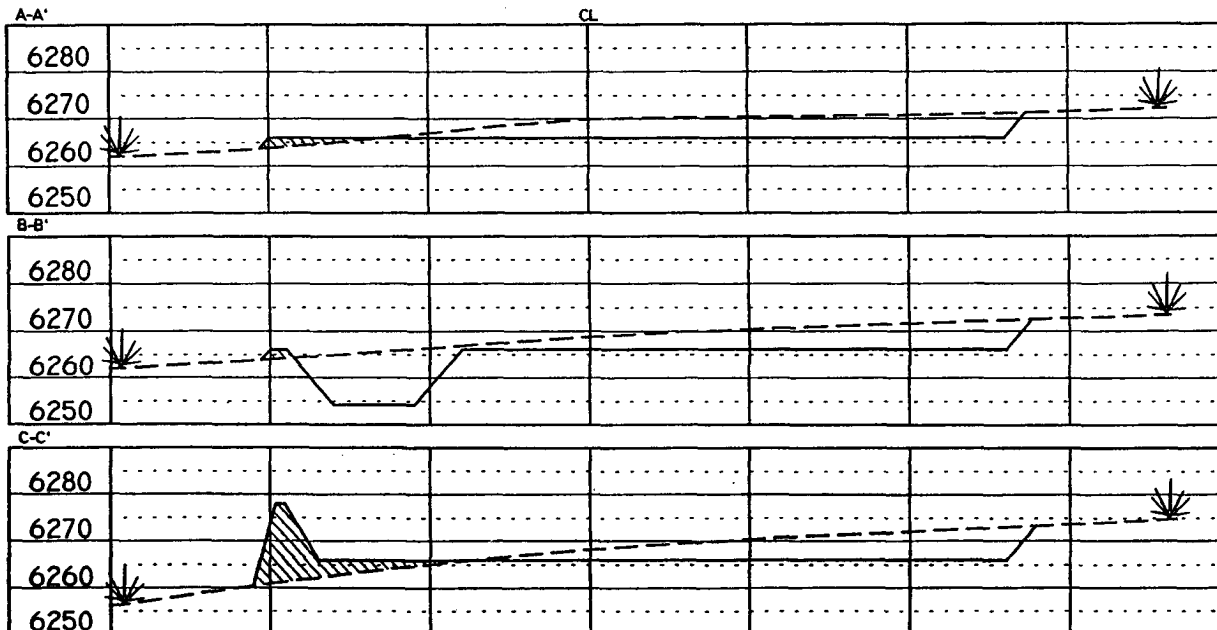

NOTE: Contractor should call One-Call for location of any marked or unmarked buried pipelines or cables, well pad and/or access road at least two (2) working days prior to construction.

Cuts and fills shown are approximate - final finish elevation is to be adjusted as earthwork will balance. Corner stakes are approximate and do not include additional areas needed for sideslopes and drainage. Final Pad Dimensions are to be verified by Contractor.

VANN SURVEY  
 P. O. Box 130  
 Farmington, N.M.