

Submit 3 Copies To Appropriate District Office.

District I

1625 N. French Dr., Hobbs, NM 88240

District II

1301 W. Grand Ave., Artesia, NM 88210

District III

1000 Rio Brazos Rd., Aztec, NM 87410

District IV

1220 S. St. Francis Dr., Santa Fe, NM 87505

State of New Mexico  
Energy, Minerals and Natural Resources

Form C-103

March 4, 2004

OIL CONSERVATION DIVISION

1220 South St. Francis Dr.

Santa Fe, NM 87505

WELL API NO.

30-045-31987

5. Indicate Type of Lease

STATE ☐ FEE ☐

6. State Oil & Gas Lease No.

7. Lease Name or Unit Agreement Name

Neal

(APD filed with BLM SF 078051)

8. Well Number

20 M

9. OGRID Number

10. Pool name or Wildcat

Basin Dakota & Blanco Mesaverde

SUNDRY NOTICES AND REPORTS ON WELLS

(DO NOT USE THIS FORM FOR PROPOSALS TO DRILL OR TO DEEPEN OR PLUG BACK TO A DIFFERENT RESERVOIR. USE "APPLICATION FOR PERMIT" (FORM C-101) FOR SUCH PROPOSALS.)

1. Type of Well:

Oil Well ☐ Gas Well ☒ Other

2. Name of Operator

BP AMERICA PRODUCTION CO

3. Address of Operator

P.O. BOX 3092 HOUSTON, TX 77079-2064

4. Well Location

Unit Letter K : 2285 feet from the South line and 1595 feet from the West line

Section 33

Township 32N

Range 11W

NMPM SAN JUAN

County

11. Elevation (Show whether DR, RKB, RT, GR, etc.)

6160'

Pit or Below-grade Tank Application (For pit or below-grade tank closures, a form C-144 must be attached)

Pit Location: UL K Sect 33 Twp 32N Rng 11W Pit type Drilling Depth to Groundwater >100' Distance from nearest fresh water well 1000'

Distance from nearest surface water >1000' Below-grade Tank Location UL K Sect 33 Twp 32N Rng 11W ;

2385 feet from the South line and 1595 feet from the West line PLEASE SEE ATTACHED PAD LAYOUT

12. Check Appropriate Box to Indicate Nature of Notice, Report or Other Data  
NOTICE OF INTENTION TO:

PERFORM REMEDIAL WORK ☐ PLUG AND ABANDON ☐

TEMPORARILY ABANDON ☐ CHANGE PLANS ☐

PULL OR ALTER CASING ☐ MULTIPLE COMPLETION ☐

OTHER: PIT PERMIT ☒

SUBSEQUENT REPORT OF:

REMEDIAL WORK ☐ ALTERING CASING ☐

COMMENCE DRILLING OPNS. ☐ PLUG AND ABANDONMENT ☐

CASING TEST AND CEMENT JOB ☐

OTHER: ☐

13. Describe proposed or completed operations. (Clearly state all pertinent details, and give pertinent dates, including estimated date of starting any proposed work). SEE RULE 1103. For Multiple Completions: Attach wellbore diagram of proposed completion or recompletion.

BP America will construct a lined drilling pit per general construction plan on file 4/15/04.

I hereby certify that the information above is true and complete to the best of my knowledge and belief. I further certify that any pit or below-grade tank has been/will be constructed or closed according to NMOCD guidelines ☐, a general permit ☐ or an (attached) alternative OCD-approved plan ☐.

SIGNATURE Cherry Hlava TITLE Regulatory Analyst DATE 6-4-04

Type or print name Cherry Hlava

E-mail address: hlavacl@bp.com

Telephone No. 281-366-4081

(This space for State use)

APPROVED BY Denny Hart TITLE DEPUTY OIL & GAS INSPECTOR, DIST. 3 DATE JUN - 7 2004

Conditions of approval, if any:

**PAD LAYOUT PLAN & PROFILE**  
**BP AMERICA, PRODUCTION COMPANY**  
**NEAL #20M**  
 1610' F/NL 1850' F/WL  
 SEC. 33, T32N, R11W, N.M.P.M.  
 SAN JUAN COUNTY, NEW MEXICO

Lat: 36°56'39"  
 Long: 107°59'48"

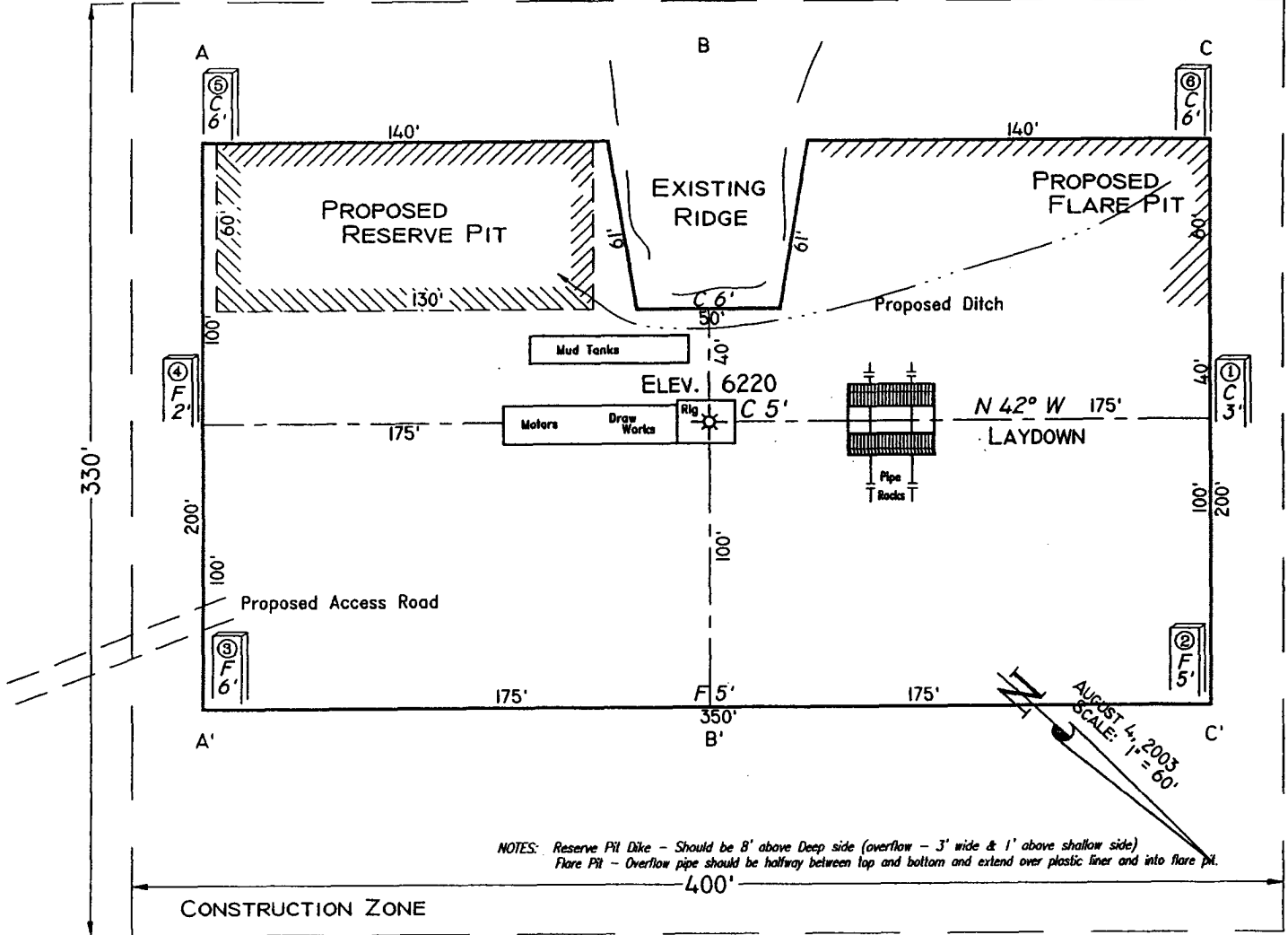

NOTES: Reserve Pit Dike - Should be 8' above Deep side (overflow - 3' wide & 1' above shallow side)  
 Flare Pit - Overflow pipe should be halfway between top and bottom and extend over plastic liner and into flare pit.

Area of Construction Zone - 330'x400' or 3.03 acres, more or less.

SCALE: 1"=60'-HORIZ.  
 1"=40'-VERT.

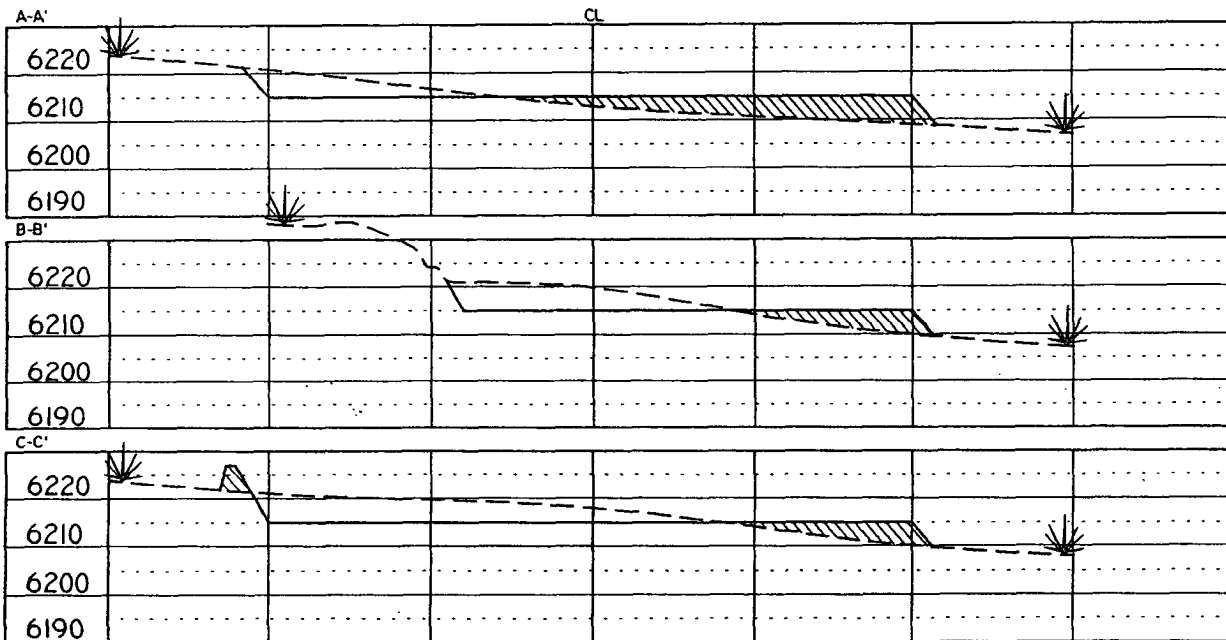

NOTE: Contractor should call One-Call for location of any marked or unmarked buried pipelines or cables on well pad and/or access road at least two (2) working days prior to construction.

Cuts and fills shown are approximate - final finished elevation is to be adjusted so earthwork will balance. Corner stakes are approximate and do not include additional areas needed for sideslopes and drainages. Final Pad Dimensions are to be verified by Contractor.

YANN SURVEYS  
 P. O. Box 1306  
 Farmington, NM