

UNITED STATES
DEPARTMENT OF THE INTERIOR
BUREAU OF LAND MANAGEMENT

APPLICATION FOR PERMIT TO DRILL, DEEPEN, OR PLUG BACK

RECEIVED

11

1a. Type of Work
DRILL

1b. Type of Well
GAS

2. Operator
BURLINGTON
RESOURCES OIL & GAS COMPANY LP

3. Address & Phone No. of Operator
PO Box 4289, Farmington, NM 87499
(505) 326-9700

4. Location of Well
920' FSL, 1495' FEL
Latitude 36° 46.44, Longitude 107° 24.44

14. Distance in Miles from Nearest Town
9 miles from Gobernador

15. Distance from Proposed Location to Nearest Property or Lease Line
920'

16. Acres in Lease

18. Distance from Proposed Location to Nearest Well, Drlg, Compl, or Applied for on this Lease
1000'

19. Proposed Depth
3722'

21. Elevations (DF, FT, GR, Etc.)
6715' GR

23. Proposed Casing and Cementing Program
See Operations Plan attached

24. Authorized by: Nancy Olman
Senior Staff Specialist

5. Lease Number
NMSF-078741

Unit Reporting Number
070 Farmington, NM

6. If Indian, All. or Tribe

7. Unit Agreement Name
San Juan 30-6 Unit

8. Farm or Lease Name
San Juan 30-6 Unit

9. Well Number
490S

10. Field, Pool, Wildcat
Basin Fruitland Coal

11. Sec., Twn, Rge, Mer. (NMPM)
Sec. 25, T-30-N, R-6-W
API # 30-039-27719

12. County
Rio Arriba

13. State
NM

17. Acres Assigned to Well
229.56 E/2

20. Rotary or Cable Tools
Rotary

22. Approx. Date Work will Start
10-19-03

PERMIT NO.

APPROVAL DATE

APPROVED BY

TITLE

DATE

Archaeological Report attached

Threatened and Endangered Species Report attached

NOTE: This format is issued in lieu of U.S. BLM Form 3160-3

Title 18 U.S.C. Section 1001, makes it a crime for any person knowingly and willfully to make to any department or agency of the United States any false, fictitious or fraudulent statements or presentations as to any matter within its jurisdiction.

✓
This application is subject to technical and
procedural review pursuant to 43 CFR 3165.3
and appeal pursuant to 43 CFR 3165.4

NMOC

DRILLING OPERATIONS AUTHORIZED ARE
SUBJECT TO COMPLIANCE WITH ATTACHED
"GENERAL REQUIREMENTS".

Submit to Appropriate District Office
State Lease - 4 Copies
Fee Lease - 3 Copies

JASON C. EDWARDS
Certificate Number 15269

OPERATIONS PLAN

Well Name: San Juan 30-6 Unit #490S
Location: 920' FSL, 1495' FEL, Section 25, T-30-N, R-6-W
Latitude 36° 46.44, Longitude 107° 24.44
Rio Arriba County, NM
Formation: Basin Fruitland Coal
Elevation: 6715' GR

Formation:	Top	Bottom	Contents
Surface	San Jose	2812'	
Ojo Alamo	2812'	2924'	aquifer
Kirtland	2924'	3157'	gas
Fruitland	3157'	3450'	gas
Intermediate casing	3400'		
Top of Coal	3450'	3637'	
Base of Coal	3637'		
Pictured Cliffs	3687'		
Total Depth	3722'		

Logging Program:

Open hole - GR/RHOB from TD to 3400'
Mud log - TD to 3400'

Coring Program: none

Mud Program:

Interval	Type	Weight	Vis.	Fluid Loss
0- 120'	Spud/Air/Air Mist	8.4-9.0	40-50	no control
120-3400'	Non-dispersed	8.4-9.0	30-60	no control
3400-3722'	Air/Mist			no control

Casing Program (as listed, the equivalent, or better):

Hole Size	Depth Interval	Csg. Size	Wt.	Grade
12 1/4"	0' - 120'	9 5/8"	32.3#	H-40
8 3/4"	0' - 3400'	7"	20.0#	J-55
6 1/4"	3400' - 3722'	open hole		

Alternate Casing Program (as listed, the equivalent, or better):

Hole Size	Depth Interval	Csg. Size	Wt.	Grade
12 1/4"	0' - 120'	9 5/8"	32.3#	H-40
8 3/4"	0' - 3400'	7"	20.0#	J-55
6 1/4"	3360' - 3722'	5 1/2"	15.5#	J-55

Tubing Program:

0' - 3722' 2 3/8" 4.7# J-55

Float Equipment: 9 5/8" surface casing - saw tooth guide shoe. Centralizers will be run in accordance with Onshore Order #2.

7" intermediate casing - guide shoe and self-fill float collar. Standard centralizers run every other joint above shoe. Two turbolizing type centralizers - one below and one into the base of the Ojo Alamo @ 2924'. Standard centralizers thereafter every fourth joint up to the base of the surface pipe.

Wellhead Equipment: 9 5/8" x 7" x 2 3/8" x 11" 2000 psi xmas tree assembly.

Cementing:

9 5/8" surface casing -

Pre-Set Drilled Cement with 23 sx Type I, II cement with 20% flyash mixed at 14.5 ppg, 1.61 cu ft per sack yield. (37 cu ft of slurry, bring cement to surface) Wait on cement for 24 hours for pre-set holes before pressure testing or drilling out from under surface.

Conventionally Drilled:

Cement with 88 sx Type III cement with 0.25 pps Celloflake, 3% CaCl. (113 cu ft of slurry, 200% excess, bring cement to surface) Wait on cement for 8 hrs for conventionally set holes before pressure tessting or drilling out from under surface.

Wait on cement until cement establishes 250 psi compressive strength prior to nipple up of BOP.

7" intermediate casing - lead w/302 sacks Premium Lite cement with 3% calcium chloride, 0.25 pps Celloflake, 5 pps LCM-1, 0.4% fluid loss, 0.4% sodium metasilicate. Tail with 90 sacks Type III cement with 1% calcium chloride, 0.25 pps Celloflake, 0.2% fluid loss (766 cu.ft., 50% excess to circulate to surface).

5 1/2" liner - will not be cemented if run.

Note: If open hole logs are run, cement volumes will be based on 25% excess over caliper volumes.

BOP and tests:

Surface to intermediate TD - 11" 2000 psi (minimum) double gate BOP stack (Reference Figure #1). Prior to drilling out surface casing, test BOPE to 600 psi for 30 min.

Intermediate TD to Total Depth - 7 1/6" 2000 psi (minimum) completion BOP stack (Reference Figure #4). Prior to drilling out intermediate casing, test BOPE and casing to 1500 psi for 30 minutes.

From surface to 7" TD - a choke manifold will be installed in accordance with Onshore Order No. 2 (Reference Figure #3). When the cavitation completion rig drills the production hole, the completion rig configuration will be used (Reference Figure #4).

Pipe rams will be actuated at least once each day and blind rams actuated once each trip to test proper functioning. An upper kelly cock valve with handle and drill string safety valves to fit each drill string will be maintained and available on the rig floor.

Additional information:

- The Fruitland Coal formation will be completed.
- Anticipated pore pressure for the Fruitland is 500 psi.
- This gas is dedicated.
- The east half of Section 25 is dedicated to this well.

Drilling Engineer:

Jim McClathy

Date:

4-21-04

Completion/Workover Rig
BOP Configuration
2,000 psi System

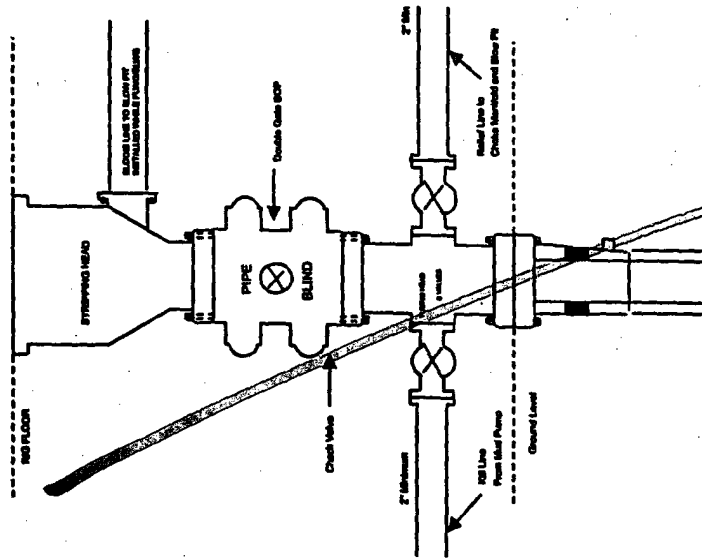

Minimum BOP installation for all Completion/Workover Operations. 7-1/16" bore, 2000 psi minimum working pressure double gate BOP to be equipped with blind and pipe rams. A stripping head to be installed on the top of the BOP. All BOP equipment is 2000 psi working pressure or greater excluding 500 psi stripping head.

Figure #2

Drilling Rig
Choke Manifold Configuration
2000 psi System

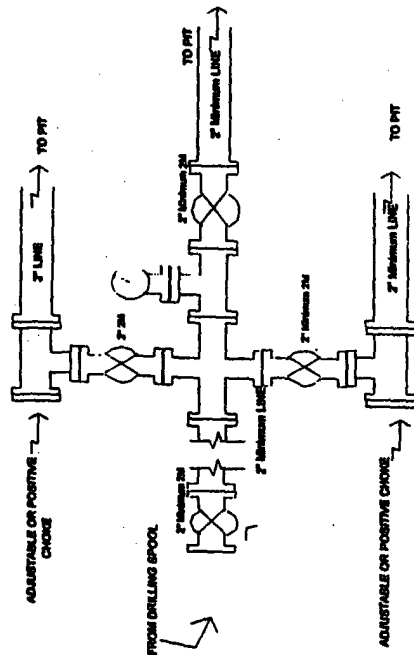

Choke manifold installation from Surface Casing Point to Total Depth. 2,000psi working pressure equipment with two chokes.

Figure #3

Drilling Rig
2000 psi System

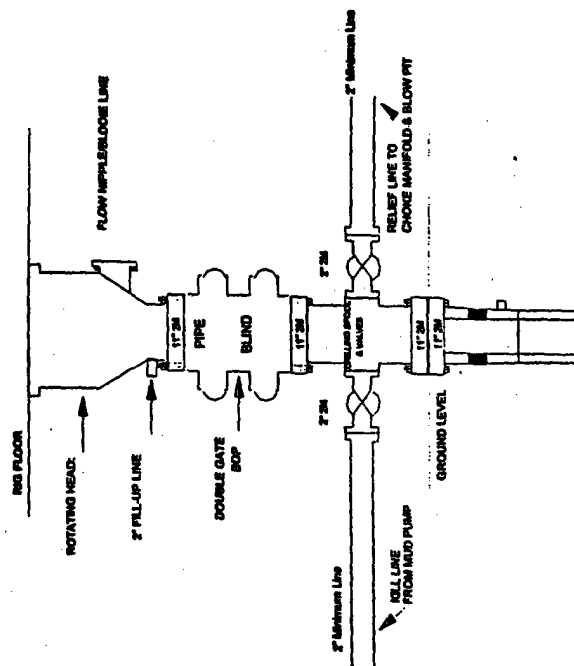

BOP installation from Surface Casing Point to Total Depth. 11" Bore 10" Nominal, 2000 psi working pressure double gate BOP to be equipped with blind rams and pipe rams. A 500 psi stripping head on top of ram preventers. All BOP equipment @ 2,000 psi working pressure

Figure #1

BURLINGTON RESOURCES

FIGURE #4

Cavitation Rig
BOP Configuration
2,000 psi Minimum System

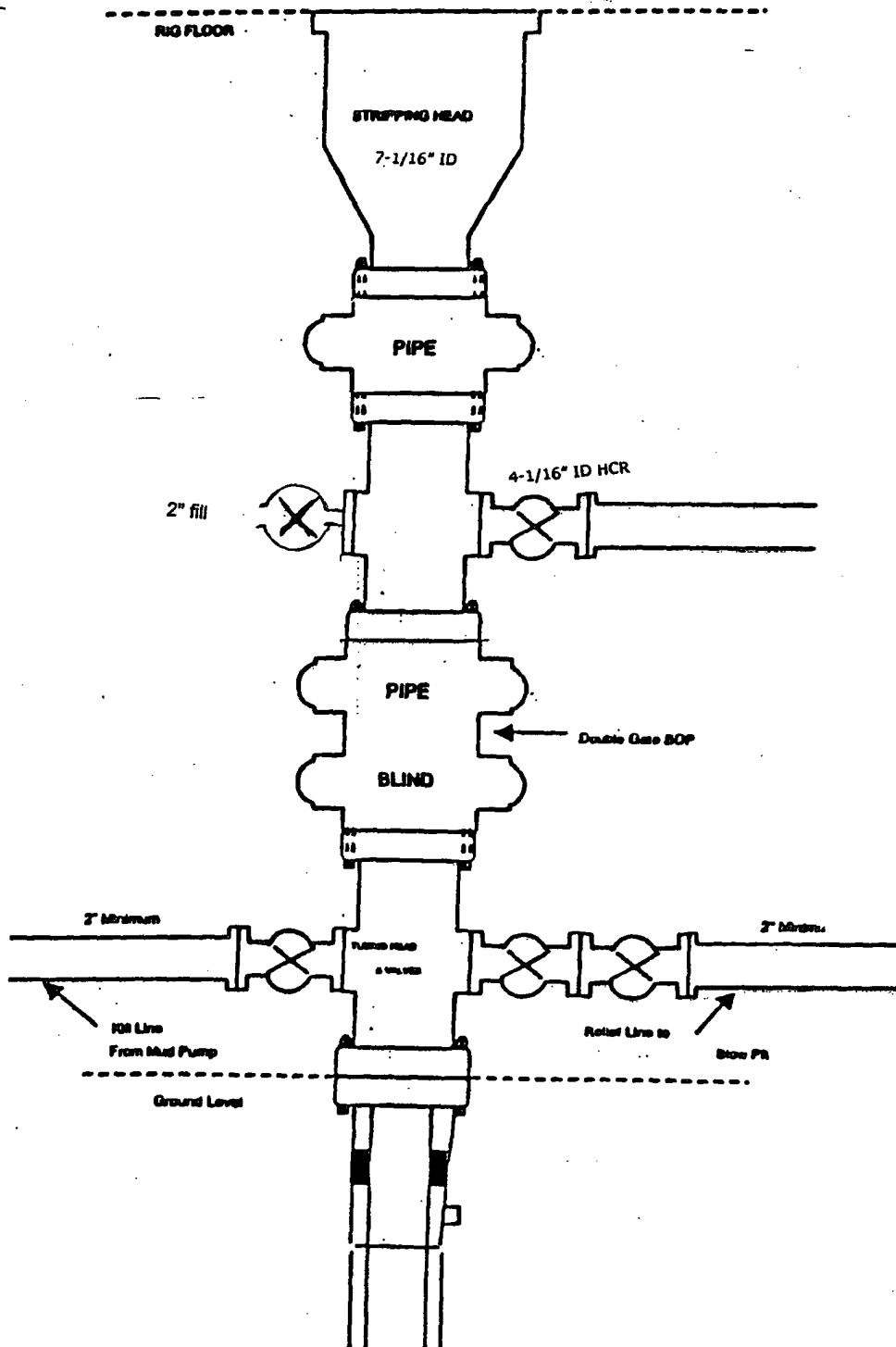

District I

1625 N. French Dr., Hobbs, NM 88240

District II

1301 W. Grand Ave., Artesia, NM 88210

District III

1000 Rio Brazos Rd., Aztec, NM 87410

District IV

1220 S. St. Francis Dr., Santa Fe, NM
87505OIL CONSERVATION DIVISION
1220 South St. Francis Dr.
Santa Fe, NM 87505

WELL API NO.

30-039-

5. Indicate Type of Lease

STATE ☐ FEE ☐

6. State Oil & Gas Lease No.

NMSF-078741

7. Lease Name or Unit Agreement Name

San Juan 30-6 Unit

8. Well Number

490S

9. OGRID Number

14538

10. Pool name or Wildcat

Basin Fruitland Coal

SUNDRY NOTICES AND REPORTS ON WELLS

(DO NOT USE THIS FORM FOR PROPOSALS TO DRILL OR TO DEEPEN OR PLUG BACK TO A
DIFFERENT RESERVOIR. USE "APPLICATION FOR PERMIT" (FORM C-101) FOR SUCH
PROPOSALS.)

1. Type of Well:

Oil Well ☐ Gas Well ☒ Other

2. Name of Operator

Burlington Resources Oil & Gas Company LP

3. Address of Operator

3401 E. 30th Street, Farmington, NM 87402

4. Well Location

Unit Letter O : 320 feet from the South line and 1495 feet from the East lineSection 25 Township 30N Range 6W NMPM Rio Arriba County, NM

11. Elevation (Show whether DR, RKB, RT, GR, etc.)

Pit or Below-grade Tank Application (For pit or below-grade tank closures, a form C-144 must be attached)

Pit Location: UL O Sect 25 Twp 30N Rng 6W Pit type New Depth to Groundwater >100' Distance from nearest fresh waterwell >1000' Distance from nearest surface water >1000' Below-grade Tank Location UL Sect Twp Rng ; feet from the line and feet from the line

12. Check Appropriate Box to Indicate Nature of Notice, Report or Other Data

NOTICE OF INTENTION TO:

PERFORM REMEDIAL WORK ☐ PLUG AND ABANDON ☐TEMPORARILY ABANDON ☐ CHANGE PLANS ☐PULL OR ALTER CASING ☐ MULTIPLE
COMPLETION ☐OTHER: New Drill Pit ☒

SUBSEQUENT REPORT OF:

REMEDIAL WORK ☐ ALTERING CASING ☐COMMENCE DRILLING OPNS. ☐ PLUG AND
ABANDONMENT ☐CASING TEST AND
CEMENT JOB ☐OTHER: ☐13. Describe proposed or completed operations. (Clearly state all pertinent details, and give pertinent dates, including estimated date
of starting any proposed work). SEE RULE 1103. For Multiple Completions: Attach wellbore diagram of proposed completion
or recompletion.Burlington Resources proposes to construct a new drill pit. The new drill pit will be an unlined pit as detailed in Burlington's
general pit construction plan dated April 26, 2004 on file at the NMOCD office.I hereby certify that the information above is true and complete to the best of my knowledge and belief. I further certify that any pit or below-
grade tank has been/will be constructed or closed according to NMOCD guidelines ☐, a general permit ☒ or an (attached) alternative OCD-approved plan ☐.SIGNATURE Cassady Harraden TITLE Regulatory Specialist DATE 5/5/04Type or print name Cassady Harraden E-mail address: charraden@br-inc.com Telephone No. 326-9700

(This space for State use)

APPROVED BY TITLE DATE

Conditions of approval, if any:

920' FSL & 1495' FEL, SECTION 25, T30N, R6W, NMPM, RIO ARriba COUNTY, NM
 GROUND ELEVATION: 6715' DATE: AUGUST 5, 2003

205' X 240' 305' X 340' = 2.38 ACRES

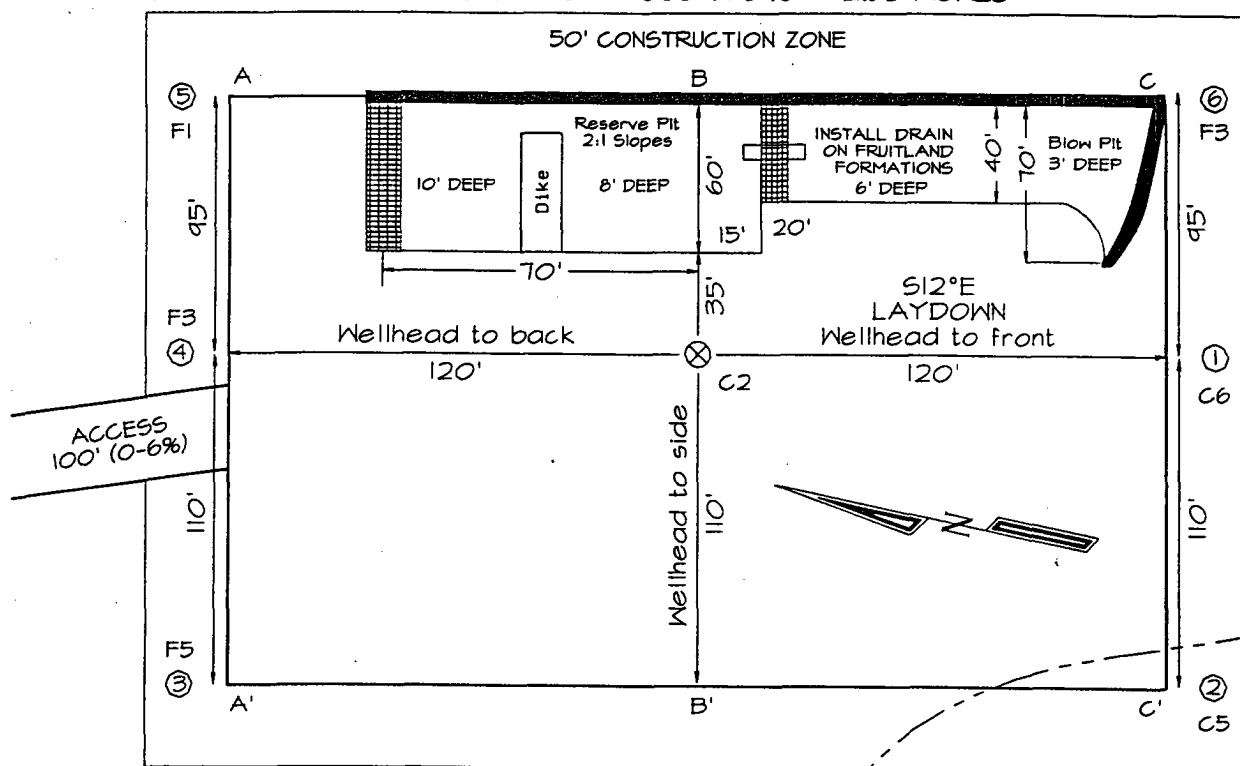

LATITUDE: 36°46'44"
 LONGITUDE: 107°24'44"
 DATUM: NAD1927

Reserve Pit Dike: to be 8' above Deep side (overflow - 3' wide and 1' above shallow side).
 Blow Pit: overflow pipe halfway between top and bottom and to extend over plastic liner and into blow pit.

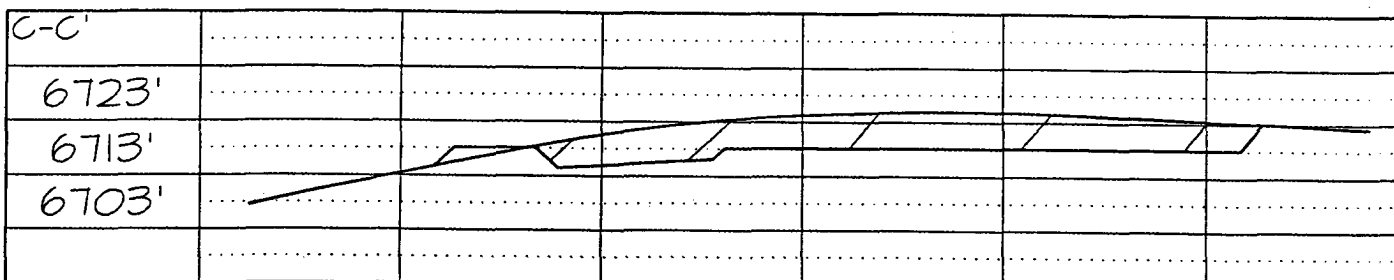
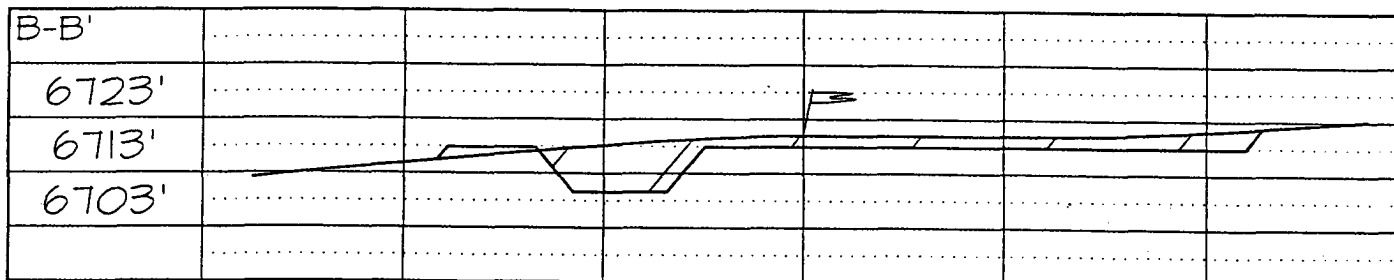
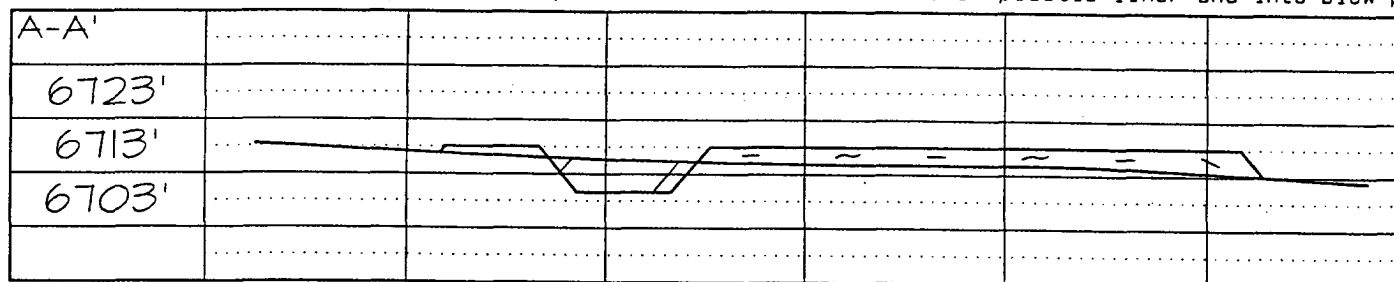

Note: Contractor should call One-Call for location of any marked or unmarked buried pipelines or cables on well pad and/or access road at least two (2) working days prior to construction

BURLINGTON RESOURCES

SAN JUAN DIVISION

*Released
June 8, 2004*

January 20, 2004

(Certified Mail – Return Receipt Requested)

AS
Re: San Juan 30-6 Unit 490S
Basin Fruitland Coal
920'FSL, 1495'FEL Section 25, T-30-N, R-6-W
Rio Arriba County, New Mexico



To the Affected Persons:

Burlington Resources Oil & Gas Company LP is submitting the enclosed Application for Permit to Drill to the appropriate regulatory agency(s) for approval. This well is located inside the High Productivity Area of the Basin-Fruitland Coal Pool as indicated on the attached plat. Notice is being made pursuant to New Mexico Oil Conservation Commission Order R-8768-F dated July 17, 2003.

The affected parties have twenty (20) days from receipt of this notice in which to file with the District Office of the New Mexico Oil Conservation Division written objection to the proposed Application for Permit to Drill.

Sincerely,

Frances Bond

Frances Bond
Regulatory Assistant

2. Article Number



7110 6605 9540 0007 5371

1. Article Addressed to:

ConocoPhillips Company
Chief Landman San Jaun/Rockies
PO Box 2197
PO Box 2197
Houston, TX 77252-2197

12/1/2003 1:34 PM

Code: FTC HPA Infill

COMPLETE THIS SECTION ON DELIVERY

A. Signature

X

☐ Agent☐ Addressee

B. Received by (Printed Name)

C. Date of Delivery

JAN 20 2004

D. Is delivery address different from item 1? ☐ Yes
If YES enter delivery address below: ☐ No

3. Service Type



Certified

4. Restricted Delivery? (Extra Fee)



Yes

5930-6 Unit \$905

PS Form 3811

Domestic Return Receipt

