

Submit 3 Copies To Appropriate District
Office
District I
1625 N. French Dr., Hobbs, NM 88240
District II
1301 W. Grand Ave., Artesia, NM 88210
District III
1000 Rio Brazos Rd., Aztec, NM 87410
District IV
1220 S. St. Francis Dr., Santa Fe, NM
87505

State of New Mexico
Energy, Minerals and Natural Resources

Form C-103
March 4, 2004

OIL CONSERVATION DIVISION
1220 South St. Francis Dr.
Santa Fe, NM 87505

WELL API NO. 30-045-32322
5. Indicate Type of Lease STATE <input checked="" type="checkbox"/> FEE <input type="checkbox"/>
6. State Oil & Gas Lease No. <i>Aztec City well</i>
7. Lease Name or Unit Agreement Name Blanco Com 1
8. Well Number 1 M
9. OGRID Number
10. Pool name or Wildcat Basin Dakota & Blanco Mesaverde

SUNDRY NOTICES AND REPORTS ON WELLS
(DO NOT USE THIS FORM FOR PROPOSALS TO DRILL OR TO DEEPEN OR PLUG BACK TO A
DIFFERENT RESERVOIR. USE "APPLICATION FOR PERMIT" (FORM C-101) FOR SUCH
PROPOSALS.)

1. Type of Well:
Oil Well ☐ Gas Well ☒ Other

2. Name of Operator
BP AMERICA PRODUCTION CO

3. Address of Operator
P.O. BOX 3092 HOUSTON, TX 77079-2064

4. Well Location
Unit Letter **H** : **2285** feet from the **North** line and **765** feet from the **East** line

Section **2** Township **30N** Range **11W** NMPM **SAN JUAN** County

11. Elevation (Show whether DR, RKB, RT, GR, etc.)
5959'

Pit or Below-grade Tank Application (For pit or below-grade tank closures, a form C-144 must be attached)

Pit Location: UL **H** Sect **2** Twp **30N** Rng **11W** Pit type **Drilling** Depth to Groundwater **>100'** Distance from nearest fresh water well **>1000'**

Distance from nearest surface water **>1000'** Below-grade Tank Location UL **H** Sect **2** Twp **30N** Rng **11W** ;

2185 feet from the **North** line and **780** feet from the **West** line PLEASE SEE ATTACHED PAD LAYOUT

12. Check Appropriate Box to Indicate Nature of Notice, Report or Other Data

NOTICE OF INTENTION TO:		SUBSEQUENT REPORT OF:	
PERFORM REMEDIAL WORK <input type="checkbox"/>	PLUG AND ABANDON <input type="checkbox"/>	REMEDIAL WORK <input type="checkbox"/>	ALTERING CASING <input type="checkbox"/>
TEMPORARILY ABANDON <input type="checkbox"/>	CHANGE PLANS <input type="checkbox"/>	COMMENCE DRILLING OPNS. <input type="checkbox"/>	PLUG AND ABANDONMENT <input type="checkbox"/>
PULL OR ALTER CASING <input type="checkbox"/>	MULTIPLE COMPLETION <input type="checkbox"/>	CASING TEST AND CEMENT JOB <input type="checkbox"/>	
OTHER: Lined Drilling PIT PERMIT & DHC <input checked="" type="checkbox"/>		OTHER: DHC 1541A2 <input type="checkbox"/>	

13. Describe proposed or completed operations. (Clearly state all pertinent details, and give pertinent dates, including estimated date of starting any proposed work). SEE RULE 1103. For Multiple Completions: Attach wellbore diagram of proposed completion or recompletion.

BP America will construct a lined drilling pit per general construction plan on file.

On 04/28/04, BP America Production Company submitted an application for permit to drill and complete the subject well into the Basin Dakota, produce the well in order to establish a production rate, isolate the zone, then add the Blanco Mesaverde and commingle production Downhole. APD Approved 05/24/2004. BP now seeks NMOCD approval to Downhole commingle production in the subject well as per procedure on reverse side of this Form.

The Basin Dakota (71599) & the Blanco Mesaverde (72319) Pools are Pre-Approved for Downhole Commingling per NMOCD Order R - 11363. The royalty & overriding royalty interest is the same but the working interest owners are different, therefore notification of this application is required by certified mail, return receipt. All working interest owners have been notified by copy of this application on June 18, 2004.

Production is proposed to be based on a fixed percentage. We will complete in the Basin Dakota Pool, isolate the Dakota; complete into the Blanco Mesaverde, establish a production rate; drill out the bridge plug and commingle production downhole. The deliverability test will be performed on the combined zones and MV rate will be subtracted from the total well stream to establish the DK rate. Commingling Production Downhole in the subject well from the proposed pools will not reduce the value of the total remaining production.

The Commissioner of Public Lands was sent a \$30.00 check on 6/18/04.

I hereby certify that the information above is true and complete to the best of my knowledge and belief. I further certify that any pit or below-grade tank has been/will be constructed or closed according to NMOCD guidelines ☐, a general permit ☐ or an (attached) alternative OCD-approved plan ☐.

SIGNATURE Cherry Hlava TITLE Regulatory Analyst DATE 6/23/04

Type or print name Cherry Hlava E-mail address: hlavacl@bp.com Telephone No. 281-366-4081

(This space for State use)

APPROVED BY [Signature] TITLE DEPUTY OIL & GAS INSPECTOR, DIST. # DATE JUN 28 2004

Conditions of approval, if any:

1. Run TDT/CBL
2. Perforate DK
3. Frac the DK (Slick Water)
4. RU SU. Clean out DK frac, perform flow test, collect DK gas sample, and obtain 12-hour BHPBU
5. Set bridge plug to isolate MV from DK formation
6. Perforate and frac (2- Stage N2 Foam) the MV Formation
7. Clean out MV frac, perform flow test for production allocation and collect MV gas sample
8. Drill out isolation plug, commingle MV/DK and clean out wellbore to PBTD.
9. Run completion string. RDSU
10. Put well on Line

PAD LAYOUT PLAN & PROFILE
BP AMERICA PRODUCTION COMPANY
 Blanco Com 1 #1M
 2285' F/NL 765' F/EL
 SEC. 2, T30N, R11W, N.M.P.M.
 SAN JUAN COUNTY, NEW MEXICO

Lat: 36°50'31"
 Long: 107°57'14"

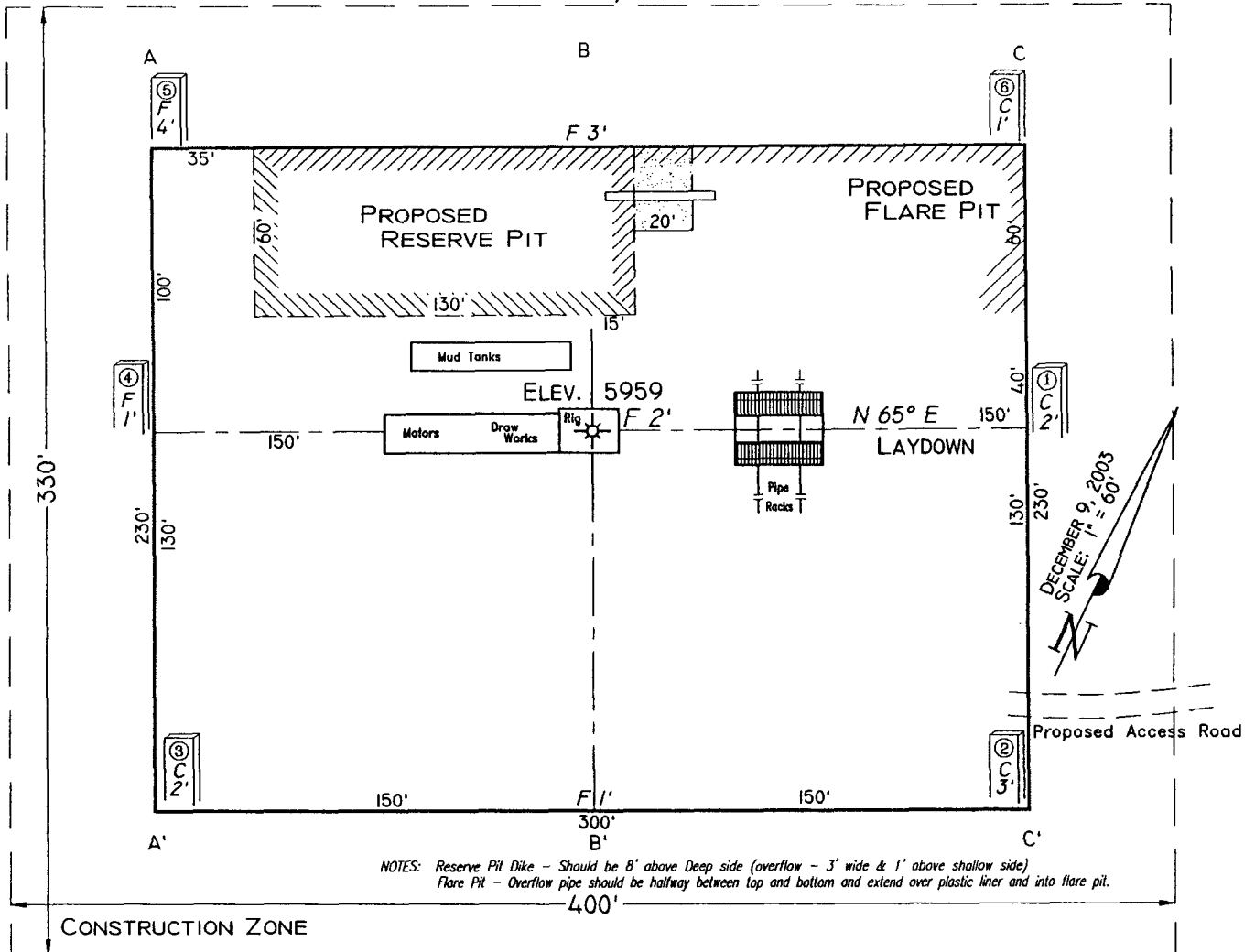

Area of Construction Zone - 330'x400' or 3.03 acres, more or less.

SCALE: 1"=60'-HORIZ.
 1"=40'-VERT.

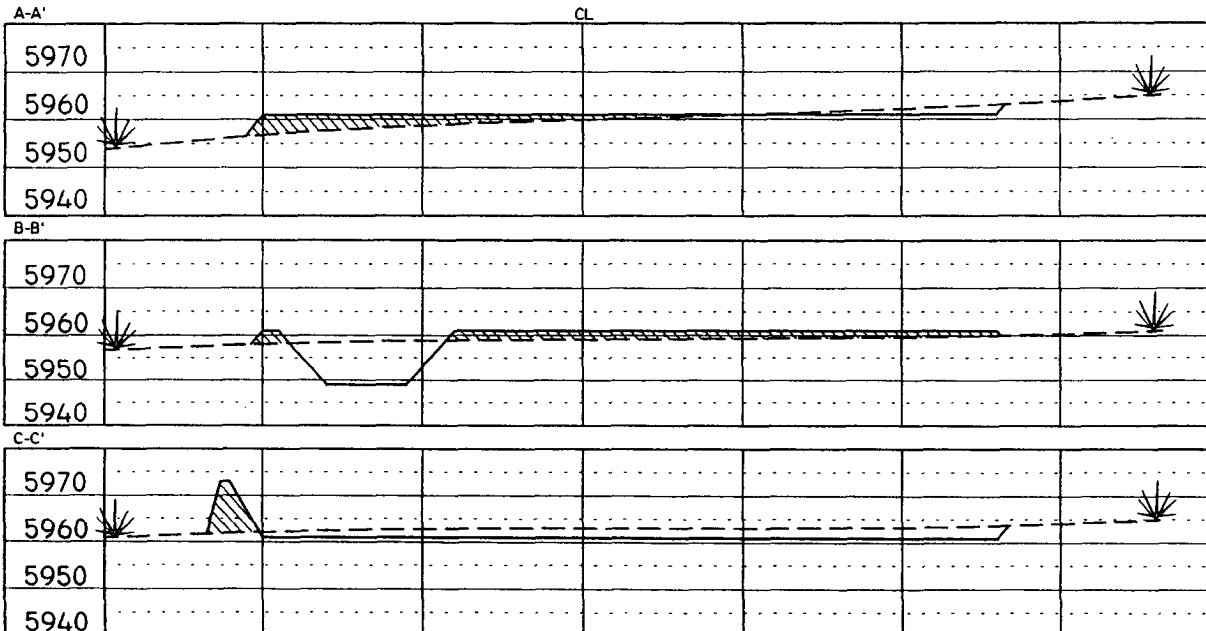

NOTE: Contractor should call One-Call for location of any marked or unmarked buried pipelines or cables on well pad and/or access road at least two (2) working days prior to construction.

Cuts and fills shown are approximate - final finished elevation is to be adjusted so earthwork will balance. Corner stakes are approximate and do not include additional areas needed for sideslopes and drainages. Final Pad Dimensions are to be verified by Contractor.

VANN SURVEYS
 P. O. Box 1306
 Farmington, NM