

UNITED STATES
DEPARTMENT OF THE INTERIOR
BUREAU OF LAND MANAGEMENT

APPLICATION FOR PERMIT TO DRILL, DEEPEN, OR PLUG BACK

1a. Type of Work
DRILL

1b. Type of Well
GAS

2. Operator
BURLINGTON
RESOURCES OIL & GAS COMPANY LP

3. Address & Phone No. of Operator
PO Box 4289, Farmington, NM 87499
(505) 326-9700

4. Location of Well
1440' FNL, 1660' FWL
Latitude 36° 49.49, Longitude 107° 30.25

5. Lease Number
~~NMM-03403~~
Unit Reporting Number

6. If Indian, All. or Tribe

7. Unit Agreement Name
San Juan 30-6 Unit

8. Farm or Lease Name
San Juan 30-6 Unit

9. Well Number
450S

10. Field, Pool, Wildcat
Basin Fruitland Coal

11. Sec., Twn, Rge, Mer. (NMPM)
Sec. 7, T-30-N, R-6-W
API # 30-039-27711

12. County
Rio Arriba

13. State
NM

14. Distance in Miles from Nearest Town
16 miles from Navajo City

15. Distance from Proposed Location to Nearest Property or Lease Line
1440'

16. Acres in Lease

17. Acres Assigned to Well
320 W/2

18. Distance from Proposed Location to Nearest Well, Drig, Compl, or Applied for on this Lease
75'

19. Proposed Depth
3488'

20. Rotary or Cable Tools
Rotary

21. Elevations (DF, FT, GR, Etc.)
6464' GR

22. Approx. Date Work will Start

23. Proposed Casing and Cementing Program
See Operations Plan attached

24. Authorized by: Nancy Oltmann
Senior Staff Specialist

Date 10-15-03

PERMIT NO.

APPROVAL DATE

APPROVED BY

TITLE

DATE

Archaeological Report attached

Threatened and Endangered Species Report submitted for the San Juan 30-6 Unit #88A

NOTE: This format is issued in lieu of U.S. BLM Form 3160-3

Title 18 U.S.C. Section 1001, makes it a crime for any person knowingly and willfully to make to any department or agency of the United States any false, fictitious or fraudulent statements or presentations as to any matter within its jurisdiction.

DRILLING OPERATIONS AUTHORIZED ARE
SUBJECT TO COMPLIANCE WITH ATTACHED
"GENERAL REQUIREMENTS".

NMOC

This action is subject to technical and
procedural review pursuant to 43 CFR 3165.3
and appeal pursuant to 43 CFR 3165.4

District II
PO Drawer DD, Artesia, NM 88211-0719Instructions on back
Submit to Appropriate District Office
State Lease - 4 Copies
Fee Lease - 3 CopiesDistrict III
1000 Rio Brazos Rd., Aztec, NM 87410OIL CONSERVATION DIVISION
PO Box 2088
Santa Fe, NM 87504-2088District IV
PO Box 2088, Santa Fe, NM 87504-2088

RECEIVED AMENDED REPORT

WELL LOCATION AND ACREAGE DEDICATION PLAT

2004 APR 28 PM 2:57

API Number 30-039-27711		Pool Code 71629	Pool Name 070 PANHANDLE, NM Basin Fruitland Coal
Property Code 7469	Property Name SAN JUAN 30-6 UNIT		Well Number 450S
GRID No. 14538	Operator Name BURLINGTON RESOURCES OIL & GAS COMPANY, LP		Elevation 6464'

10 Surface Location

UL or lot no.	Section	Township	Range	Lot Idn	Feet from the	North/South line	Feet from the	East/West line	County
F	7	30N	6W		1440	NORTH	1660	WEST	RIO ARriba

11 Bottom Hole Location If Different From Surface

UL or lot no.	Section	Township	Range	Lot Idn	Feet from the	North/South line	Feet from the	East/West line	County

12 Dedicated Acres FTC-W/320	13 Joint or Infill	14 Consolidation Code	15 Order No.
---------------------------------	--------------------	-----------------------	--------------

NO ALLOWABLE WILL BE ASSIGNED TO THIS COMPLETION UNTIL ALL INTERESTS HAVE BEEN CONSOLIDATED
OR A NON-STANDARD UNIT HAS BEEN APPROVED BY THE DIVISION

	<p>17 OPERATOR CERTIFICATION</p> <p>I hereby certify that the information contained herein is true and complete to the best of my knowledge and belief</p> <p><i>Nancy Oltmanns</i> Signature</p> <p>Nancy Oltmanns Printed Name</p> <p>Senior Staff Specialist Title</p> <p>10-15-03 Date</p> <p>18 SURVEYOR CERTIFICATION</p> <p>I hereby certify that the well location shown on this plat was plotted from field notes of actual surveys made by me or under my supervision, and that the same is true and correct to the best of my belief.</p> <p>Survey Date: AUGUST 8, 2003</p> <p>Signature and Seal of Professional Surveyor</p> <p><i>JASON C. EDWARDS</i> Certificate Number 15269</p>
--	------------------------------------------------------------------------------------------------------------------------------------------------------------------------------------------------------------------------------------------------------------------------------------------------------------------------------------------------------------------------------------------------------------------------------------------------------------------------------------------------------------------------------------------------------------------------------------------------------------------------------------------------------------------------------------------------------------------------

OPERATIONS PLAN

Well Name: San Juan 30-6 Unit #450S
Location: 1440' FNL, 1660' FWL, Section 7, T-30-N, R-6-W
Latitude 36° 49.49, Longitude 107° 30.25
Rio Arriba County, NM
Formation: Basin Fruitland Coal
Elevation: 6464' GR

Formation:	Top	Bottom	Contents
Surface	San Jose	2499'	
Ojo Alamo	2499'	2561'	aquifer
Kirtland	2561'	2911'	gas
Fruitland	2911'	3123'	gas
Intermediate casing	3103'		
Top of Coal	3123'	3403'	
Base of Coal	3403'		
Pictured Cliffs	3405'		
Total Depth	3488'		

Logging Program:

Open hole - none
Mud log - TD to 3103'

Coring Program: none

Mud Program:

Interval	Type	Weight	Vis.	Fluid Loss
0-160'	Spud/Air/Air Mist	8.4-9.0	40-50	no control
160-3103'	Non-dispersed	8.4-9.0	30-60	no control
3103-3488'	Air/Mist			no control

Casing Program (as listed, the equivalent, or better):

Hole Size	Depth Interval	Csg. Size	Wt.	Grade
12 1/4"	0' - 160'	9 5/8"	32.3#	H-40
8 3/4"	0' - 3103'	7"	20.0#	J-55
6 1/4"	3103' - 3488'	open hole		

Alternate Casing Program (as listed, the equivalent, or better):

Hole Size	Depth Interval	Csg. Size	Wt.	Grade
12 1/4"	0' - 160'	9 5/8"	32.3#	H-40
8 3/4"	0' - 3103'	7"	20.0#	J-55
6 1/4"	3003' - 3488'	5 1/2"	15.5#	J-55

Tubing Program:

0' - 3488' 2 3/8" 4.7# J-55

Float Equipment: 9 5/8" surface casing - saw tooth guide shoe. Centralizers will be run in accordance with Onshore Order #2.

7" intermediate casing - guide shoe and self-fill float collar. Standard centralizers run every other joint above shoe. Two turbolizing type centralizers - one below and one into the base of the Ojo Alamo @ 2561'. Standard centralizers thereafter every fourth joint up to the base of the surface pipe.

Wellhead Equipment: 9 5/8" x 7" x 2 3/8" x 11" 2000 psi xmas tree assembly.

Cementing:

9 5/8" surface casing -

Pre-Set Drilled Cement with 31 sx Type I, II cement with 20% flyash mixed at 14.5 ppg, 1.61 cu ft per sack yield. (50 cu ft of slurry, bring cement to surface) Wait on cement for 24 hours for pre-set holes before pressure testing or drilling out from under surface.

Conventionally Drilled:

Cement with 117 sx Type III cement with 0.25 pps Celloflake, 3% calcium chloride (150 cu ft of slurry, 200% excess, bring cement to surface) Wait on cement for 8 hrs for conventionally set holes before pressure testing or drilling out from under surface.

Wait on cement until cement establishes 250 psi compressive strength prior to nipple up of BOP.

7" intermediate casing - lead w/248 sacks Premium Lite cement with 3% calcium chloride, 0.25 pps Celloflake, 5 pps LCM-1, 0.4% fluid loss, 0.4% sodium metasilicate. Tail with 90 sacks Type III cement with 1% calcium chloride, 0.25 pps Celloflake, 0.2% fluid loss (653 cu.ft., 50% excess to circulate to surface).

5 1/2" liner - will not be cemented if run.

Note: If open hole logs are run, cement volumes will be based on 25% excess over caliper volumes.

BOP and tests:

Surface to intermediate TD - 11" 2000 psi (minimum) double gate BOP stack (Reference Figure #1). Prior to drilling out surface casing, test BOPE to 600 psi for 30 min.

Intermediate TD to Total Depth - 7 1/6" 2000 psi (minimum) completion BOP stack (Reference Figure #2). Prior to drilling out intermediate casing, test BOPE and casing to 1500 psi for 30 minutes.

From surface to 7" TD - a choke manifold will be installed in accordance with Onshore Order No. 2 (Reference Figure #3). When the cavitation completion rig drills the production hole, the completion rig configuration will be used (Reference Figure #4).

Pipe rams will be actuated at least once each day and blind rams actuated once each trip to test proper functioning. An upper kelly cock valve with handle and drill string safety valves to fit each drill string will be maintained and available on the rig floor.

Additional information:

- The Fruitland Coal formation will be completed.
- Anticipated pore pressure for the Fruitland is 500 psi.
- This gas is dedicated.
- The west half of Section 7 is dedicated to this well.

Drilling Engineer:

John M. McCauley

Date:

4-21-04

**Completion/Workover Rig
BOP Configuration
2,000 psi System**

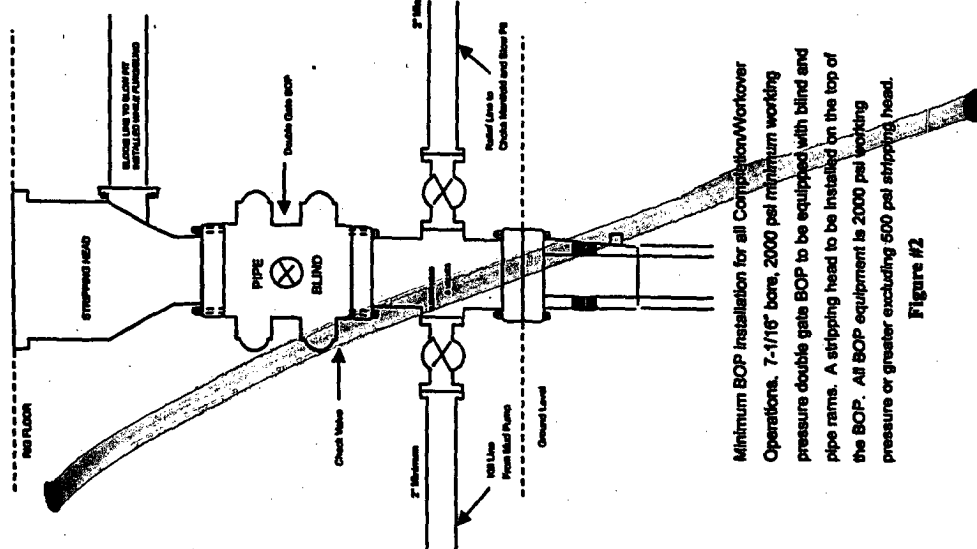

Figure #2

Minimum BOP installation for all Compaction/Workover Operations. 7-1/16" bore, 2000 psi minimum working pressure double gate BOP to be equipped with blind and pipe rams. A stripping head to be installed on the top of the BOP. All BOP equipment is 2000 psi working pressure or greater excluding 500 psi stripping head.

**Drilling Rig
Choke Manifold Configuration
2000 psi System**

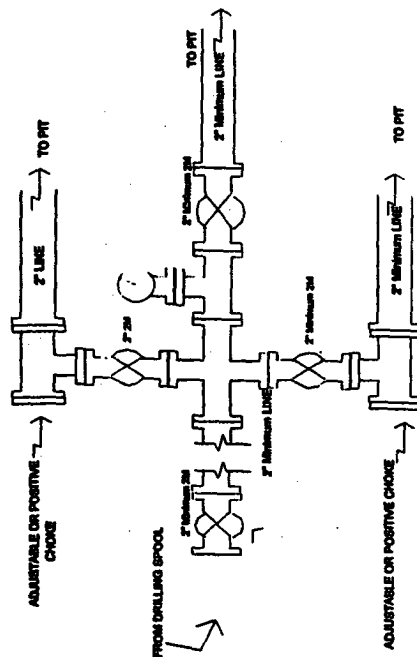

Figure #3

Choke manifold installation from Surface Casing Point to Total Depth. 2,000psi working pressure equipment with two chokes.

**Drilling Rig
2000 psi System**

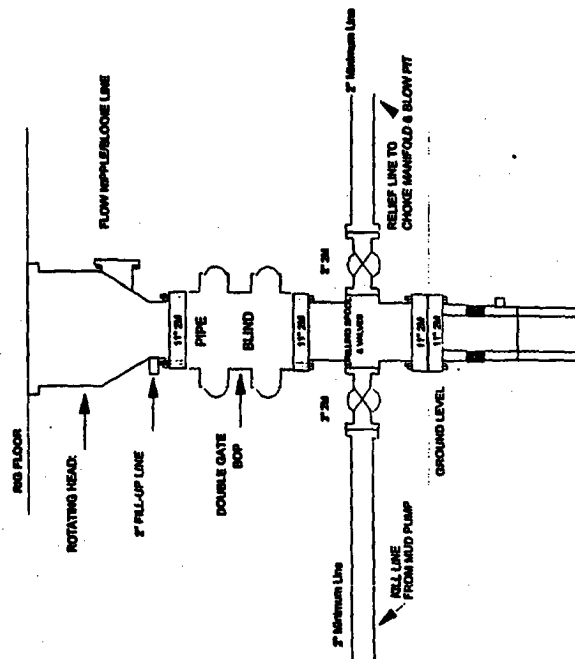

Figure #1

BOP Installation from Surface Casing Point to Total Depth. 11" Bore 10" Nominal, 2000 psi working pressure double gate BOP to be equipped with blind rams and pipe rams. A 500 psi rotating head on top of ram preventers. All BOP equipment is 2,000 psi working pressure.

BURLINGTON RESOURCES

FIGURE #4

Cavitation Rig
BOP Configuration
2,000 psi Minimum System

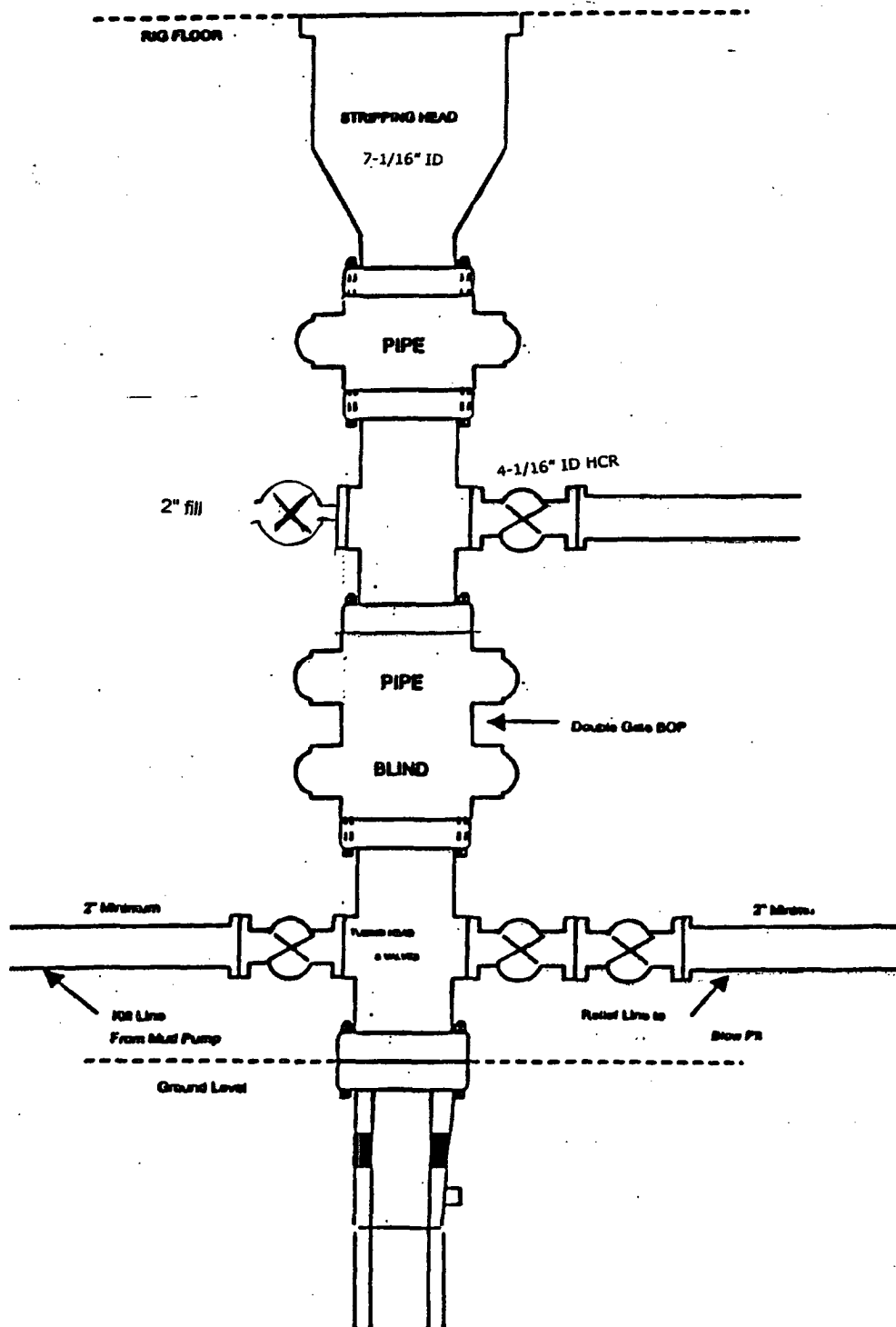

Conditions of approval, if any:

205' X 220' 305' X 320' = 2.24 ACRES

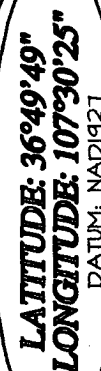

A-A'						
6474'						
6464'						
6454'						

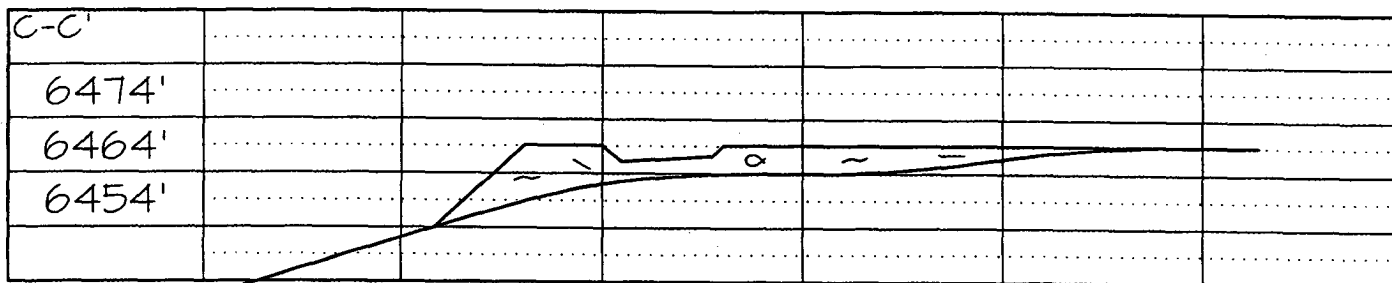
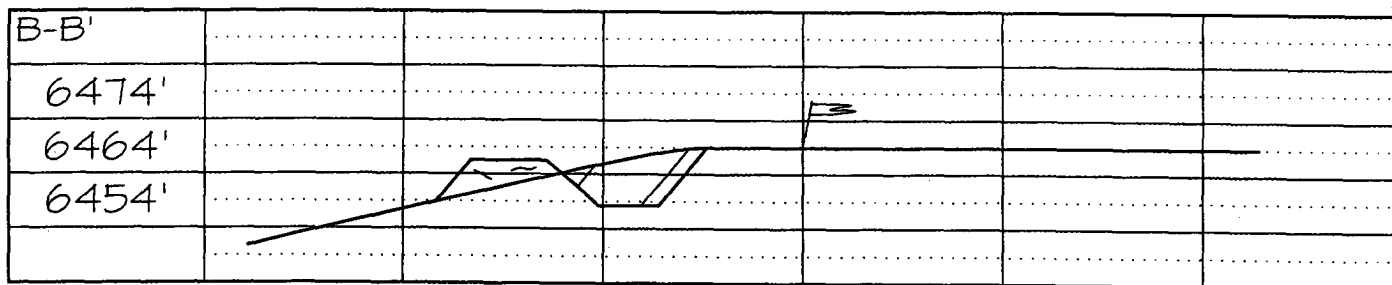

Note: Contractor should call One-Call for location of any marked or unmarked buried pipelines or cables on well pad and/or access road at least two (2) working days prior to construction

BURLINGTON RESOURCES

SAN JUAN DIVISION

Received June 18th 2004

November 13, 2003

(Certified Mail – Return Receipt Requested)

Re: San Juan 30-6 Unit 450S
Basin Fruitland Coal
1440'FNL, 1660'FWL Section 7, T-30-N, R-6-W
San Juan County, New Mexico



To the Affected Persons:

Burlington Resources Oil & Gas Company LP is submitting the enclosed Application for Permit to Drill to the appropriate regulatory agency(s) for approval. This well is located inside the High Productivity Area of the Basin-Fruitland Coal Pool as indicated on the attached plat. Notice is being made pursuant to New Mexico Oil Conservation Commission Order R-8768-F dated July 17, 2003.

The affected parties have twenty (20) days from receipt of this notice in which to file with the District Office of the New Mexico Oil Conservation Division written objection to the proposed Application for Permit to Drill.

Sincerely,

Frances Bond

Frances Bond
Regulatory Assistant

Legend

▲ FRUITLAND COAL
Current Operator in T30N-R6W

Current Operator

● Unknown

● BURLINGTON RESOURCES O&G CO LP

● BURLINGTON RESOURCES OIL & GAS COMPANY

● EL PASO NATURAL GAS COMPANY

● MERIDIAN OIL INCORPORATED

● CONOCOPHILLIPS COMPANY

● PHILLIPS PETROLEUM COMPANY

● NORTHWEST PIPELINE CORPORATION



BURLINGTON
RESOURCES



1:71,167,736 - 1" equals 5,930,645'

GCS North American 1927

BURLINGTON RESOURCES

San Juan

San Juan 30-6 Unit #450S

T30N-R6W

Section 7

Prepared By: JMC Date: 9/19/2003

File Number: Revised Date: 9/19/2003

File Name: C:\at\hmc\Protects\Infill 30.6 7\Infill 30.6 7.mxd

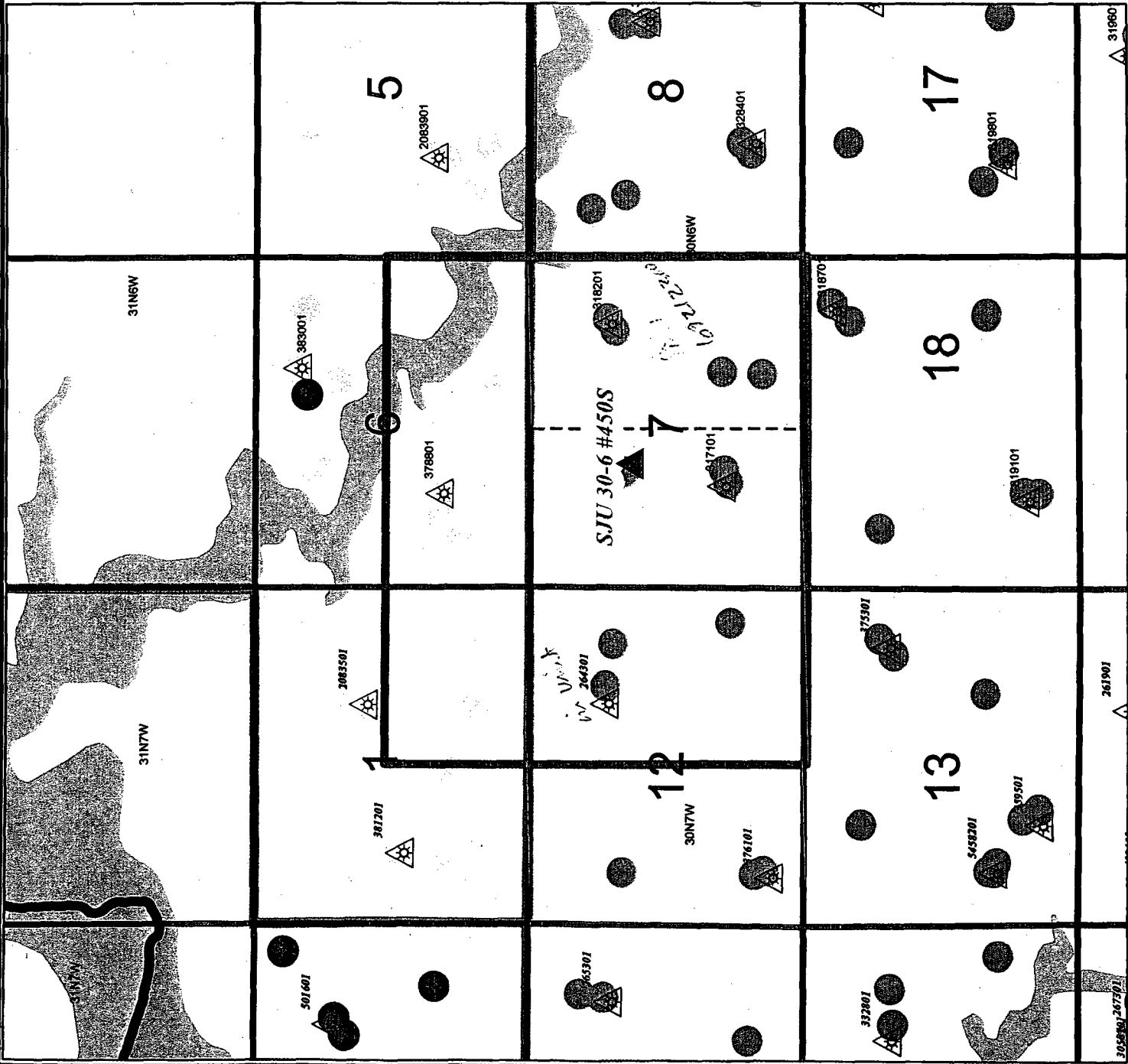

7110 6605 9590 0007 4978

RETURN RECEIPT SERVICE		POSTAGE	POSTMARK OR DATE
	RESTRICTED DELIVERY FEE	\$0.34	
	CERTIFIED FEE	\$0.00	
	RETURN RECEIPT FEE	\$2.10	
	RETURN RECEIPT FEE	\$1.75	
SENT TO:		TOTAL POSTAGE AND FEES	\$4.19

Code: FTC HPA Infill 59 30-6 450 S

ConocoPhillips Company
Chief Landman San Jaun/Rockies
PO Box 2197
PO Box 2197
Houston, TX 77252-2197

PS FORM 3800 10/28/2003 4:01 PM



RECEIPT FOR CERTIFIED MAIL
NO INSURANCE COVERAGE PROVIDED
NOT FOR INTERNATIONAL MAIL
(SEE OTHER SIDE)