

UNITED STATES
DEPARTMENT OF THE INTERIOR
BUREAU OF LAND MANAGEMENT

FORM APPROVED
OMB No. 1004-0136
Expires November 30, 2000

APPLICATION FOR PERMIT TO DRILL OR REENTER

1a. Type of Work: <input checked="" type="checkbox"/> DRILL <input type="checkbox"/> REENTER		5. Lease Serial No. SF-081089
1b. Type of Well: <input type="checkbox"/> Oil Well <input checked="" type="checkbox"/> Gas Well <input type="checkbox"/> Other <input checked="" type="checkbox"/> Single Zone <input type="checkbox"/> Multiple Zone		6. If Indian, Allottee or Tribe Name
2. Name of Operator CONOCOPHILLIPS COMPANY Contact: VICKI WESTBY E-Mail: Vicki.R.Westby@conocophillips.com		7. If Unit or CA Agreement, Name and No.
3a. Address 4001 PENBROOK, SUITE 346 ODESSA, TX 79762	3b. Phone No. (include area code) Ph: 915.368.1352	8. Lease Name and Well No. SAN JUAN 32-8 UNIT 237A
4. Location of Well (Report location clearly and in accordance with any State requirements.) At surface NESE 1640FSL 940FEL At proposed prod. zone		9. API Well No. 30-045-32369
14. Distance in miles and direction from nearest town or post office*	15. Distance from proposed location to nearest property or lease line, ft. (Also to nearest drig. unit line, if any)	10. Field and Pool, or Exploratory BASIN FRUITLAND COAL
16. No. of Acres in Lease	17. Spacing Unit dedicated to this well 320 E/2	11. Sec., T., R., M., or Blk. and Survey or Area Sec 23 T31N R8W Mer NMP
18. Distance from proposed location to nearest well, drilling, completed, applied for, on this lease, ft.	19. Proposed Depth 3434 MD	12. County or Parish SAN JUAN
20. BLM/BIA Bond No. or file	21. Elevations (Show whether DF, KB, RT, GL, etc.) 6456 GL	13. State NM
22. Approximate date work will start	23. Estimated duration	

24. Attachments

The following, completed in accordance with the requirements of Onshore Oil and Gas Order No. 1, shall be attached to this form:

- | | |
|---|--|
| 1. Well plat certified by a registered surveyor. | 4. Bond to cover the operations unless covered by an existing bond on file (see item 20 above). |
| 2. A Drilling Plan. | 5. Operator certification |
| 3. A Surface Use Plan (if the location is on National Forest System Lands, the SUPO shall be filed with the appropriate Forest Service Office). | 6. Such other site specific information and/or plans as may be required by the authorized officer. |

25. Signature (Electronic Submission)	Name (Printed/Typed) VICKI WESTBY	Date 05/17/2004
Title AGENT		
Approved by (Signature) <i>[Signature]</i>	Name (Printed/Typed)	Date 6-8-04
Title AFM	Office FFO	

Application approval does not warrant or certify the applicant holds legal or equitable title to those rights in the subject lease which would entitle the applicant to conduct operations thereon.
Conditions of approval, if any, are attached.

Title 18 U.S.C. Section 1001 and Title 43 U.S.C. Section 1212, make it a crime for any person knowingly and willfully to make to any department or agency of the United States any false, fictitious or fraudulent statements or representations as to any matter within its jurisdiction.

Additional Operator Remarks (see next page)

Electronic Submission #30813 verified by the BLM Well Information System
For CONOCOPHILLIPS COMPANY, sent to the Farmington

is subject to technical and
operational review pursuant to 43 CFR 3165.2
to appeal pursuant to 43 CFR 3165.4

APPLICANT'S OPERATIONS ARE
SUBJECT TO COMPLIANCE WITH ATTACHED
"GENERAL REQUIREMENTS".

** OPERATOR-SUBMITTED ** OPERATOR-SUBMITTED ** OPERATOR-SUBMITTED **

OPERATOR

Additional Operator Remarks:

ConocoPhillips Company proposes to drill a vertical wellbore to the Basin Fruitland Coal formation. This well will be drilled and equipped in accordance with the attachments submitted herewith. This well falls within the HPA and according to NMOCD Order R-8768-F, the affected parties will be notified by Certified Mail. This notification will be put in the mail 5/17/04 and the Affected Parties will have 20 days to file their written objection to the proposed APD to the NMOCD in Aztec. Verification that the notice was received by the Affected Party will be mailed to the NMOCD upon receipt. This application is for APD/ROW.

District I
PO Box 1980, Hobbs, NM 88241-1980

District II
PO Drawer 00, Artesia, NM 88211-0719

District III
1000 Rio Brazos Rd., Aztec, NM 87410

District IV
PO Box 2088, Santa Fe, NM 87504-2088

State of New Mexico
Energy, Minerals & Natural Resources Department

OIL CONSERVATION DIVISION
PO Box 2088
Santa Fe, NM 87504-2088

Form C-102
Revised February 21, 1994
Instructions on back
Submit to Appropriate District Office
State Lease - 4 Copies
Fee Lease - 3 Copies

☐ AMENDED REPORT

WELL LOCATION AND ACREAGE DEDICATION PLAT

*API Number 30045-32369		*Pool Code 71629	*Pool Name BASIN FRUITLAND COAL
*Property Code 31330	*Property Name SAN JUAN 32-8 UNIT		*Well Number 237A
*OGRID No. 217817	*Operator Name CONOCOPHILLIPS COMPANY		*Elevation 6456'

¹⁰ Surface Location

UL or lot no.	Section	Township	Range	Lot Idn	Feet from the	North/South line	Feet from the	East/West line	County
I	23	31N	8W		1640	SOUTH	940	EAST	SAN JUAN

¹¹ Bottom Hole Location If Different From Surface

UL or lot no.	Section	Township	Range	Lot Idn	Feet from the	North/South line	Feet from the	East/West line	County

¹² Dedicated Acres 320.0 Acres - E/2	¹³ Joint or Infill	¹⁴ Consolidation Code	¹⁵ Order No.
--	-------------------------------	----------------------------------	-------------------------

NO ALLOWABLE WILL BE ASSIGNED TO THIS COMPLETION UNTIL ALL INTERESTS HAVE BEEN CONSOLIDATED
OR A NON-STANDARD UNIT HAS BEEN APPROVED BY THE DIVISION

<div data-bbox="305 1045 630 1381"></div> <div data-bbox="673 1234 982 1270">LEASE SF-081089</div> <div data-bbox="581 1333 646 1381">23</div> <div data-bbox="673 1491 868 1549">LAT: 36°52.8222' N LONG: 107°38.3218' W DATUM: NAD27</div> <div data-bbox="933 1491 998 1522">940'</div> <div data-bbox="852 1617 885 1690">1640'</div> <div data-bbox="560 1743 673 1774">5212.68'</div> <div data-bbox="178 1302 211 1407">5187.60'</div> <div data-bbox="998 1302 1031 1407">5176.38'</div>	<div data-bbox="1047 934 1445 1018"><p>¹⁷ OPERATOR CERTIFICATION I hereby certify that the information contained herein is true and complete to the best of my knowledge and belief</p><p><i>Vicki Westby</i> Signature Vicki R. Westby Printed Name Sr. Analyst Title May 17, 2004 Date</p></div> <div data-bbox="1047 1281 1445 1396"><p>¹⁸ SURVEYOR CERTIFICATION I hereby certify that the well location shown on this plat was plotted from field notes of actual surveys made by me or under my supervision, and that the same is true and correct to the best of my belief.</p><p>Date of Survey: MARCH 17, 2004</p><p>Signature and Seal of Professional Surveyor</p><div data-bbox="1112 1449 1372 1701"></div><p><i>JASON C. EDWARDS</i> Certificate Number 15269</p></div>
--	---

Submit 3 Copies To Appropriate District
Office
District I
1625 N. French Dr., Hobbs, NM 88240
District II
1301 W. Grand Ave., Artesia, NM 88210
District III
1000 Rio Brazos Rd., Aztec, NM 87410
District IV
1220 S. St. Francis Dr., Santa Fe, NM
87505

State of New Mexico
Energy, Minerals and Natural Resources

Form C-103
March 4, 2004

OIL CONSERVATION DIVISION
1220 South St. Francis Dr.
Santa Fe, NM 87505

WELL API NO.	
5. Indicate Type of Lease STATE <input type="checkbox"/> FEE <input type="checkbox"/>	
6. State Oil & Gas Lease No.	
7. Lease Name or Unit Agreement Name San Juan 32-8 Unit	
8. Well Number 237A	
9. OGRID Number 217817	
10. Pool name or Wildcat Basin Fruitland Coal	
SUNDRY NOTICES AND REPORTS ON WELLS (DO NOT USE THIS FORM FOR PROPOSALS TO DRILL OR TO DEEPEN OR PLUG BACK TO A DIFFERENT RESERVOIR. USE "APPLICATION FOR PERMIT" (FORM C-101) FOR SUCH PROPOSALS.)	
1. Type of Well: Oil Well <input type="checkbox"/> Gas Well <input checked="" type="checkbox"/> Other	
2. Name of Operator ConocoPhillips Company	
3. Address of Operator 4001 Penbrook, Odessa, TX 79762	
4. Well Location Unit Letter <u>I</u> : <u>1640</u> feet from the <u>South</u> line and <u>940</u> feet from the <u>East</u> line Section <u>23</u> Township <u>31N</u> Range <u>8W</u> NMPM San Juan County	
11. Elevation (Show whether DR, RKB, RT, GR, etc.) 6456' GL	
Pit or Below-grade Tank Application (For pit or below-grade tank closures, a form C-144 must be attached)	
Pit Location: UL <u>I</u> Sect <u>23</u> Twp <u>31N</u> Rng <u>8W</u> Pit type <u>Drill Pit</u> Depth to Groundwater <u>>100'</u> Distance from nearest fresh water well <u>>1000'</u> Distance from nearest surface water <u>>1000'</u> Below-grade Tank Location UL <u></u> Sect <u></u> Twp <u></u> Rng <u></u> ; feet from the <u></u> line and <u></u> feet from the <u></u> line	

12. Check Appropriate Box to Indicate Nature of Notice, Report or Other Data
NOTICE OF INTENTION TO:

PERFORM REMEDIAL WORK ☐ PLUG AND ABANDON ☐
TEMPORARILY ABANDON ☐ CHANGE PLANS ☐
PULL OR ALTER CASING ☐ MULTIPLE COMPLETION ☐

OTHER: ☐

SUBSEQUENT REPORT OF:

REMEDIAL WORK ☐ ALTERING CASING ☐
COMMENCE DRILLING OPNS. ☐ PLUG AND ABANDONMENT ☐
CASING TEST AND CEMENT JOB ☐

OTHER: ☐

13. Describe proposed or completed operations. (Clearly state all pertinent details, and give pertinent dates, including estimated date of starting any proposed work). SEE RULE 1103. For Multiple Completions: Attach wellbore diagram of proposed completion or recompletion.

ConocoPhillips Company's Generic Pit Plan is on file at NMOCD in Aztec, NM. See the attached diagram that details the location of the pit in reference to the proposed wellhead. The drill pit will be lined. The drill pit will be closed after the well has been completed. The solids left after the water has been disposed of will be sampled and NMOCD approval will be obtained prior to closure of this pit.

I hereby certify that the information above is true and complete to the best of my knowledge and belief. I further certify that any pit or below-grade tank has been/will be constructed or closed according to NMOCD guidelines ☐, a general permit ☐ or an (attached) alternative OCD-approved plan ☐.

SIGNATURE Vicki Westby TITLE Sr. Analyst DATE 5/17/04

Type or print name Vicki Westby E-mail address: Vicki.R.Westby@conocophillips.com Telephone No. 432-368-1352

(This space for State use)

APPROVED BY [Signature] TITLE DATE

Conditions of approval, if any:

CONOCOPHILLIPS COMPANY SAN JUAN 32-8 UNIT #237A
1640' FSL & 940' FEL, SECTION 23, T31N, R8W, NMPM
SAN JUAN COUNTY, NEW MEXICO ELEVATION: 6456'

LATITUDE: 36.88037° N
LONGITUDE: 107.63870° W
 DATUM: NAD1927

PLAT NOTE:

***SURFACE OWNER:**
 Bureau of Land
 Management

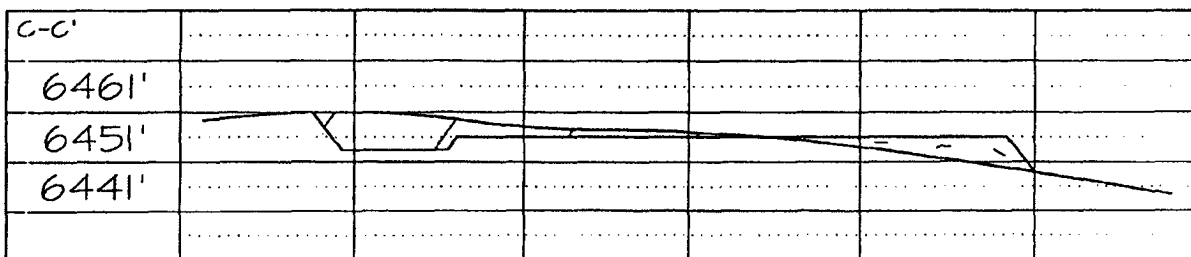
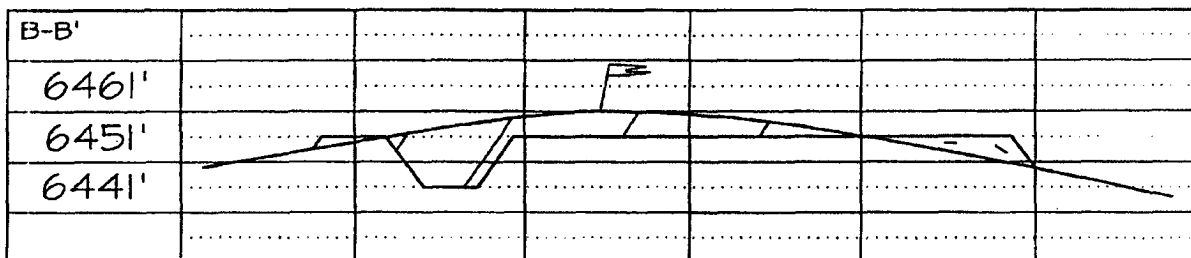
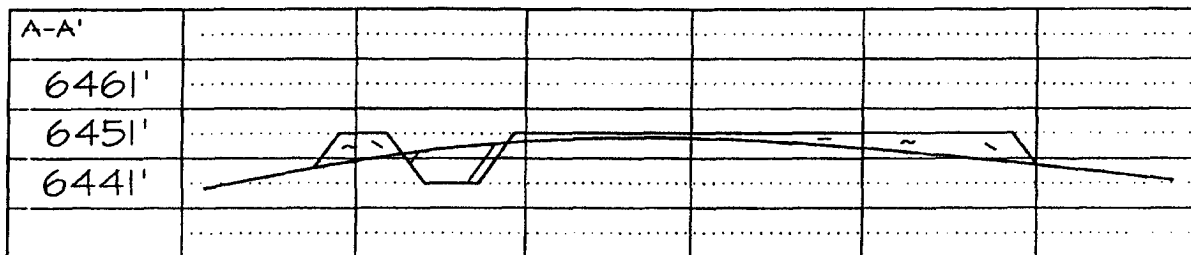
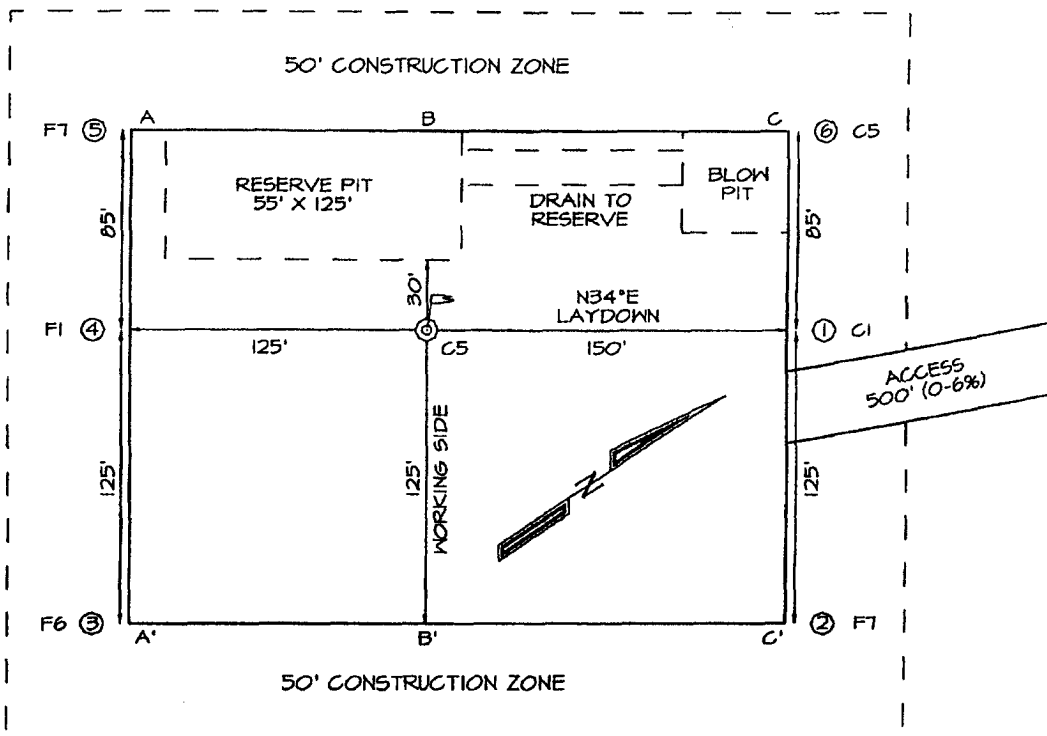

CONOCOPHILLIPS COMPANY

WELL NAME: San Juan 32-8 #237A

DRILLING PROGNOSIS

1. Location of Proposed Well: 1640' FSL & 940' FEL
Section 23, T31N, R8W
2. Unprepared Ground Elevation: @ 6456'
3. The geological name of the surface formation is San Jose.
4. Type of drilling tools will be rotary.
5. Proposed drilling depth is 3434'.
6. The estimated tops (MD RKB) of important geologic markers are as follows:
Note: RKB is 13' above ground level.

<u>San Jose -</u>	<u>13'</u>	<u>Base of Lowest Coal -</u>	<u>3354'</u>
<u>Nacimiento -</u>	<u>684'</u>	<u>Total Depth -</u>	<u>3434'</u>
<u>Ojo Alamo -</u>	<u>2215'</u>		
<u>Kirtland Shale -</u>	<u>2314'</u>		
<u>Fruitland -</u>	<u>2954'</u>		
<u>Intermediate Csg -</u>	<u>3124'</u>		

7. The estimated depths at which anticipated water, oil, gas or other mineral bearing formations are expected to be encountered are as follows:

Water:	<u>Ojo Alamo -</u>	<u>2215' - 2314'</u>
Oil:	<u>none</u>	
Gas:	<u>Fruitland Coal -</u>	<u>2954' - 3434'</u>
Gas & Water:	<u>Fruitland Coal -</u>	<u>2954' - 3434'</u>

8. The proposed casing program is as follows:

Surface String: 9-5/8", 32.3#, H-40, ST & C @ 200' below ground level*
Intermediate String: 7", 20#, J-55, ST&C @ 3124' MD RKB
Prod Liner Option: 5-1/2", 15.5#, J-55, LT & C @ 3104' - 3434' MD RKB

* The surface casing will be set at a minimum of 200' below ground level, but could be set deeper if required to maintain hole stability.

9. Cement Program:

Surface String: 150 sx Class G cement with 1.16 cuft/sx yield, 2% bwoc CaCl2 (S001), 0.25#/sx Cellophane Flake (D029) = 174.0 cf

9. Cement program: (continued from Page 1)

Intermediate String:

Lead Cement: 404 sx Class G w/3% D079 (chemical extender) 0.25#/sx D029 (Cellophane flakes), 0.05 GPS D047 (antifoam agent) 0.2% D046 (antifoam agent) mixed at 11.7 ppg and yield of 2.61 cuft/sx = 1054.4 cf.

Tail: 100 sx – 50/50/G/POZ cement w/2% D020 (bentonite extender), 2% S001 (CaCl₂), 5#/sx D024 (gilsonite), ¼#/sx D029 (cellophane flakes) & 2% D046 (antifoam agent) @ a weight of 13.5 ppg and yield of 1.27 cuft/sx = 127.0 cf.

Note: ConocoPhillips Company continually works to improve the cement slurries on our wells. Our Cementing Service Companies are currently trying to improve what we are using now and before we would use a new cement program it would have to have stronger properties than we are currently using.

Centralizer Program:

Surface: Total four (4) - 10' above shoe and top of 2nd, 3rd, & 4th jts.

Intermediate: Total seven (7) - 10' above shoe and top of 1st, 2nd, 4th, 6th, 8th, & 1st jt. into shoe.

Turbulators: Total three (3) - one at 1st jt below Ojo Alamo and next 2 jts up.

10. Cavitation Option: Depending on well conditions the well may be cavitated or may be completed without cavitation.
11. Production liner option: Depending on well conditions a 5-1/2" liner may be run or the well may be completed without a liner. If a liner is run, it would be run without a liner hanger – or possibly with a liner hanger – and would be left uncemented.
12. Perforations: If a liner is run, it will be perforated using electric line perforating guns in the Fruitland Coal interval(s).
13. Tubing will be run in either flowing well configuration or in pumping well configuration. The size of tubing run and the configuration (either pumping or flowing configuration) will be dependent on the well conditions and flow test results. Our proposed options for the tubing string are as follows:

Pumping Well Configuration:

- o Mud Anchor consisting of one joint 2-7/8" tubing, orange peeled, with slots in the upper 2' of the joint below the upset.
- o 2-7/8" x 2-3/8" x-over
- o 2-3/8" OD x 1.78" ID F-Nipple
- o 2-3/8", 4.7#, J-55, EUE 8RD tubing to surface
- o Insert pump run on rods and set in F-Nipple

2-3/8" Flowing Well Configuration:

- o 2-3/8" OD x 1.78" ID F-Nipple
- o 2-3/8", 4.7#, J-55, EUE 8RD tubing to surface

2-7/8" Flowing Well Configuration:

- o 2-7/8" OD x 2.5" ID F-Nipple
- o 2-7/8", 6.5#, J-55, EUE 8RD tubing to surface

3-1/2" Flowing Well Configuration:

- o 3-1/2" OD x 1.78" ID F-Nipple
- o 3-1/2", 9.2# J-55 FL4S (as an option inside the liner or in the open hole)
- o 3-1/2" 9.3# J-55 EUE 8rd tubing to surface

14. The minimum specifications for pressure control equipment which are to be used, a schematic diagram thereof showing sizes, pressure ratings (or) API series and the testing procedure and testing frequency are enclosed within the APD packet.
15. Drilling Mud Prognosis:
- o Surface - spud mud on surface casing.
 - o Intermediate - fresh water w/polymer sweeps. Bentonite as required for viscosity.
 - o Below Intermediate - air / water mist drilling media with foamer and polymer as needed for hole stability and with corrosion inhibitor.
16. The testing, logging, and coring programs are as follows:
- o D.S.T.s: Flow Tests and Shut-In pressure build up tests will be taken as needed in the Fruitland coal interval.
 - o Cores: None
 - o Logs: Mud logs only
17. Anticipated no abnormal pressures or temperatures to be encountered or any other potential hazards such as Hydrogen Sulfide Gas. Low risk H2S equipment will be used.

Estimated Bottomhole pressures: Fruitland Coal - +/- 175 psi

18. The anticipated starting date is sometime around July 5, 2004 with duration of drilling and completion operations (in discontinuous operations) for approximately 60 days thereafter. A drilling rig will be used to topset the 7" casing above the Fruitland coal. At a later date, a cavitation rig will be brought in to drill out, possibly cavitate, and complete the Fruitland coal.

BLOWOUT PREVENTER ARRANGEMENT & PROGRAM

For Drilling to Intermediate Casing Point & Setting 7" Intermediate Casing

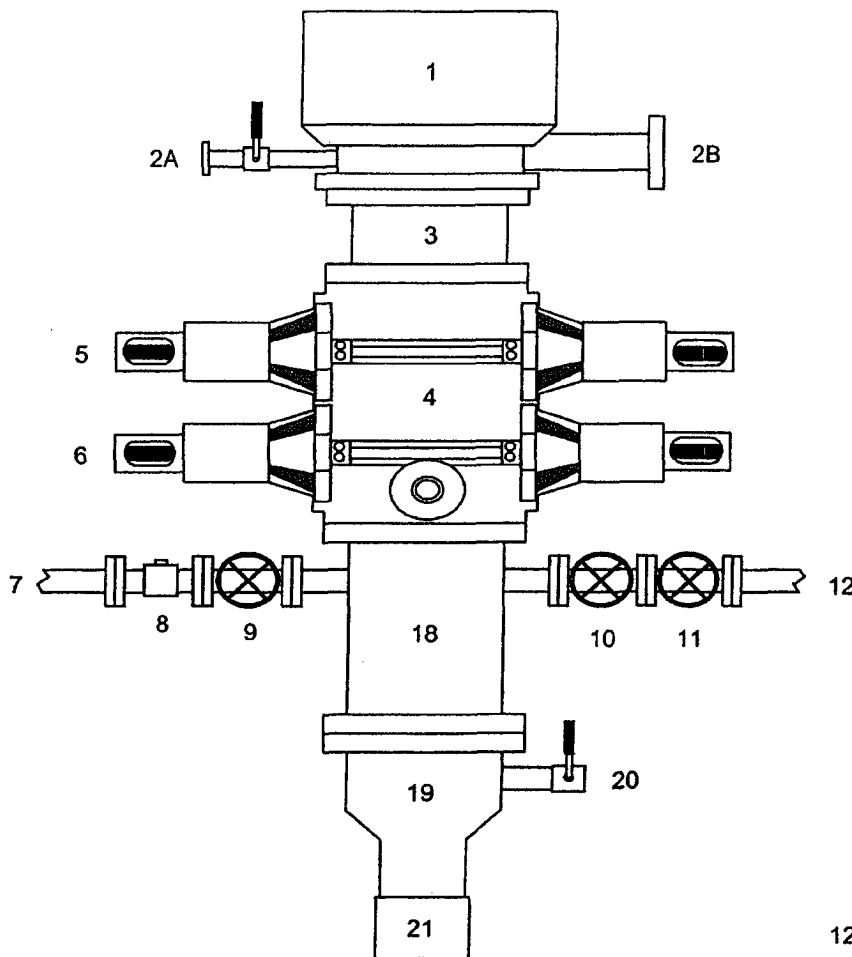

1. Rotating Head
- 2A. Fill-up Line & valve
- 2B. Flowline
3. Spacer Spool
4. Double Ram BOP (11", 3000 psi)
5. Pipe Rams
6. Blind Rams
7. Kill Line
8. Kill Line Check Valve
9. Kill Line Valve
10. Inner Choke Line Valve (3")
11. Outer Choke Line Valve (3")
12. Choke Line (3")
13. Variable Choke
14. Choke Line Valve (2")
15. Panic Line Valve (3")
16. Choke Manifold Pressure Gauge
17. Choke Line (2")
18. Mud Cross Spacer Spool
19. Casing Head "A" Section
20. Casing Head "A" Section 2" Valve
21. 9 5/8" Casing Collar

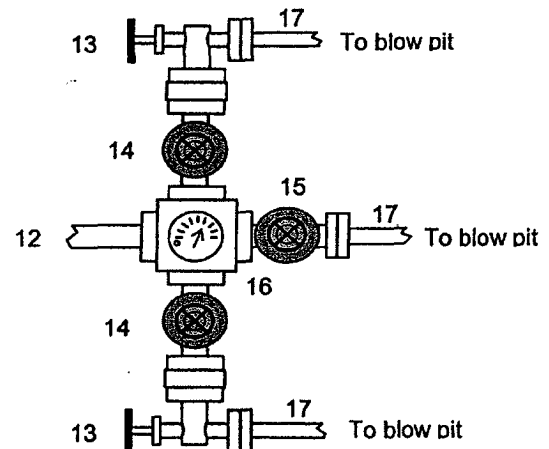

A 12-1/4" hole will be drilled to approximately 220' and the 9-5/8" surface casing will be run and cemented. The Casing Head "A" Section will be screwed onto the 9-5/8" surface casing stub. The BOP will be installed on the Casing Head "A" Section. A test plug will be set in the wellhead and the pipe rams and choke manifold will be tested to 200 psi to 300 psi (low pressure test) for 2-3 minutes and to 1000 psi (high pressure test) for 10 minutes. Then the test plug will be removed, and the 9-5/8" casing will be pressure tested against closed blind rams to 200 psi to 300 psi for 2-3 minutes and to 1000 psi for 30 minutes (this value is one 44% of the minimum internal yield pressure of the 9-5/8" casing). (Note: per regulatory requirements we will wait on cement at least 8 hrs after placement before testing the 9-5/8" surface casing). Then an 8-3/4" hole will be drilled to intermediate casing point and 7" intermediate casing will be run and cemented.

In addition to the equipment in the above diagram the following equipment will comprise the BOP system:

1. Upper Kelly cock Valve with handle
2. Stab-in TIW valve for all drillstrings in use

BLOWOUT PREVENTER ARRANGEMENT & PROGRAM

For Cavitation Program

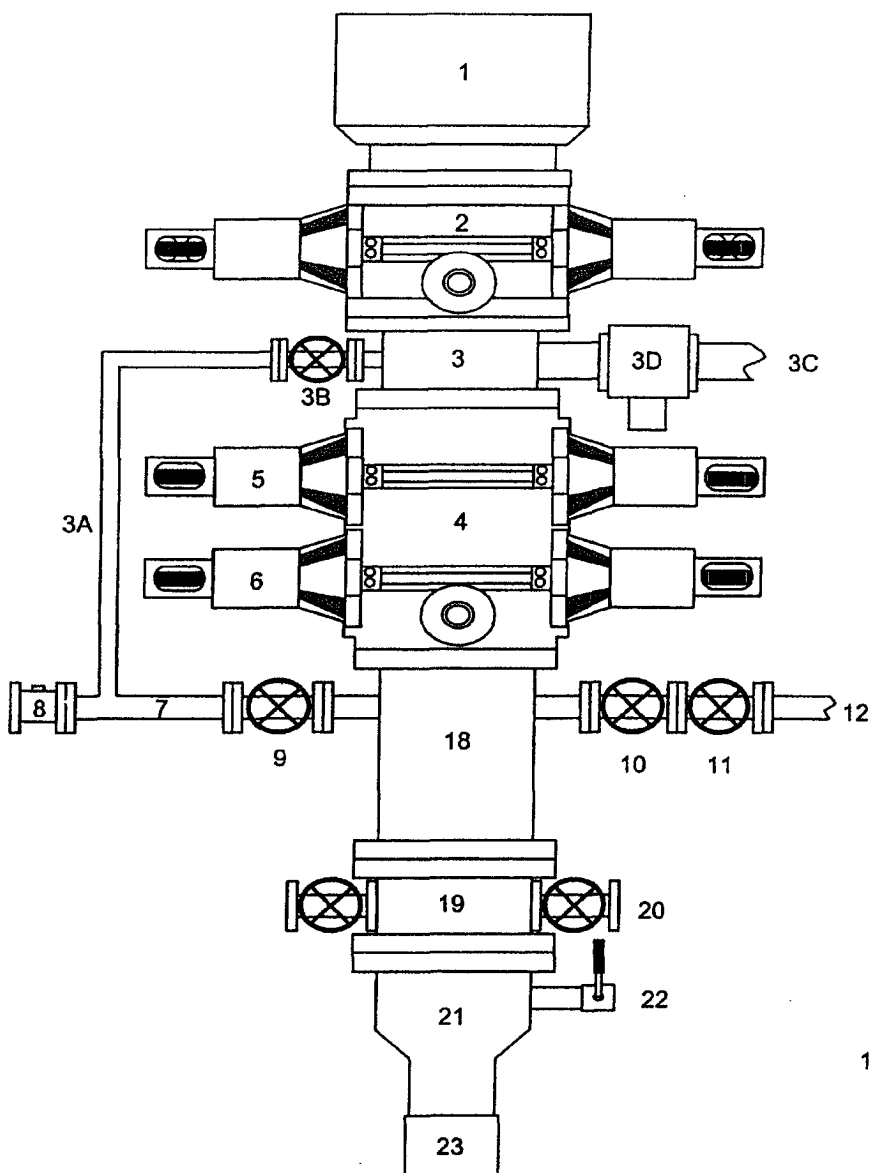

1. Rotating Head
2. Single Ram BOP (7-1/16", 3M)
3. Mud Cross
 - 3A. Equalizing Line (2")
 - 3B. Wing Valve (2-1/16", 3M)
 - 3C. Blooie Line (2 ea, 5" OD)
 - 3D. HCR Valve (1 ea per line, 4-1/16")
4. Double Ram BOP (7-1/16", 3M)
5. Pipe Rams
6. Blind Rams
7. Kill Line
8. Kill Line Check Valve
9. Kill Line Valve
10. Inner Choke Line Valve (3")
11. Outer Choke Line Valve (3")
12. Choke Line (3")
13. Variable Choke
14. Choke Line Valve (2")
15. Panic Line Valve (3")
16. Choke Manifold Pressure Gauge
17. Vent Line (2")
18. Spacer Spool
19. Tubing Head
20. Tubing Head Valves (2- 9/16")
21. Casing Head "A" Section
22. Casing Head "A" Section 2" Valve
23. 9-5/8" Casing Collar

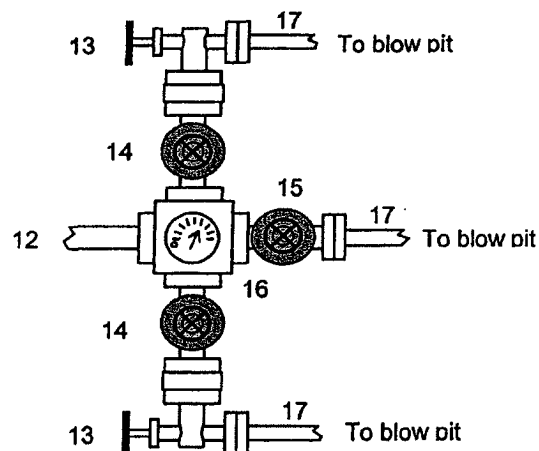

This BOP arrangement and test program is for the cavitation program. The BOP will be installed on the tubing head. The 7" casing will be pressure tested against closed blind rams to 200 psi to 300 psi for 2-3 minutes and to 1800 psi for 30 minutes - this test pressure is 48% of the minimum internal yield strength of 3740 psi for the 7", 20#, J-55, STC casing. The pipe rams and choke manifold will be tested to 200 psi to 300 psi (low pressure test) for 2-3 minutes and to 1800 psi (high pressure test) for 10 minutes - This test will be done with a test plug or possibly without a test plug (ie against casing). If we conduct this test without a test plug we will ensure that we have sufficient drillstring weight in the hole to exceed the upward force generated by the test.

We use a power swivel and air/mist to drill the 6-1/4" hole in our cavitation program. We do not use a kelly. In addition to the equipment in the above diagram the following equipment will comprise the BOP system:

1. String floats will be used inside the drillpipe
2. Stab-in TIW valve for all drillstrings in use
3. Each blooie line is equipped with a hydraulically controlled valve (HCR valve).

ConocoPhillips

Release June 8, 2004

May 18, 2004

30-045-32369

**ConocoPhillips Company
RPA – Property Tax, Real
Estate, Right of Way and
Claims**

Vicki R. Westby
Sr. Analyst
4001 Penbrook St., Ste. 317
Odessa TX, 79762
Phone (432)368-1352
Fax (432)368-1287

CERTIFIED MAIL – RETURN RECEIPT REQUESTED

RE: San Juan 32-8 #237A Well
Basin Fruitland Coal
1640' FSL & 940' FEL, Section 23, T31N-R8W
San Juan County, New Mexico



To the Affected Parties:

ConocoPhillips Company is submitting the enclosed Application for Permit to Drill to the appropriate regulatory agency(s) for approval. This well is located inside the High Productivity Area of the Basin-Fruitland Coal Pool as indicated on the attached plat. Notice is being made pursuant to New Mexico Oil Conservation Commission Order R-8768-F dated July 17, 2003.

The affected parties have twenty (20) days from receipt of this notice in which to file with the District Office of the New Mexico Oil Conservation Division written objection to the proposed Application for Permit to Drill.

Sincerely,

Vicki Westby
Sr. Analyst

Cc: NMOCD Aztec
Well File

San Juan 32-8 #237A – HPA “Affected Parties”

Devon Energy Corp.
20 North Broadway
Oklahoma City, OK 73102-8260
(Certified Receipt #7003 0500 0001 8091 4457)

SENDER: COMPLETE THIS SECTION		COMPLETE THIS SECTION ON DELIVERY	
<ul style="list-style-type: none">■ Complete items 1, 2, and 3. Also complete item 4 if Restricted Delivery is desired.■ Print your name and address on the reverse so that we can return the card to you.■ Attach this card to the back of the mailpiece, or on the front if space permits.		A. Signature <input checked="" type="checkbox"/> <i>Hartford</i> <input type="checkbox"/> Agent <input type="checkbox"/> Addressee	
1. Article Addressed to: Devon Energy Corp. 20 North Broadway Oklahoma City, OK 73102-8260		B. Received by (Printed Name)	C. Date of Delivery 5/19/04
		D. Is delivery address different from item 1? <input type="checkbox"/> Yes if YES, enter delivery address below: <input type="checkbox"/> No	
		3. Service Type <input checked="" type="checkbox"/> Certified Mail <input type="checkbox"/> Express Mail <input type="checkbox"/> Registered <input checked="" type="checkbox"/> Return Receipt for Merchandise <input type="checkbox"/> Insured Mail <input type="checkbox"/> C.O.D.	
		4. Restricted Delivery? (Extra Fee) <input type="checkbox"/> Yes	
2. Article Number (Transfer from service)		7003 0500 0001 8091 4457	
PS Form 3811, August 2001		Domestic Return Receipt	
		2ACPRI-03-P-4081	

SAN JUAN 32-8 #237A
OFFSET OPERATOR PLAT

TOWNSHIP 31 NORTH, RANGE 8 WEST

1640' FSL 940' FEL

ConocoPhillips	23	ConocoPhillips
ConocoPhillips		ConocoPhillips
ConocoPhillips	ConocoPhillips	Devon Energy Corporation