

Submit 3 Copies To Appropriate District  
Office  
District I  
1625 N. French Dr., Hobbs, NM 88240  
District II  
1301 W. Grand Ave., Artesia, NM 88210  
District III  
1000 Rio Brazos Rd., Aztec, NM 87410  
District IV  
1220 S. St. Francis Dr., Santa Fe, NM  
87505

State of New Mexico  
Energy, Minerals and Natural Resources

Form C-103  
March 4, 2004

OIL CONSERVATION DIVISION  
1220 South St. Francis Dr.  
Santa Fe, NM 87505

WELL API NO. 30-039-27586
5. Indicate Type of Lease STATE <input type="checkbox"/> FEE <input checked="" type="checkbox"/>
6. State Oil & Gas Lease No.
7. Lease Name or Unit Agreement Name Badger Com 10
8. Well Number 1B
9. OGRID Number 22044
10. Pool name or Wildcat Blanco Mesa Verde

SUNDRY NOTICES AND REPORTS ON WELLS  
(DO NOT USE THIS FORM FOR PROPOSALS TO DRILL OR TO DEEPEN OR PLUG BACK TO A  
DIFFERENT RESERVOIR. USE "APPLICATION FOR PERMIT" (FORM C-101) FOR SUCH  
PROPOSALS.)

1. Type of Well:  
Oil Well ☐ Gas Well ☒ Other

2. Name of Operator  
McElvain Oil & Gas Properties, Inc.

3. Address of Operator  
1050 17<sup>th</sup> Street, Suite 1800 Denver, CO 80265

4. Well Location

Unit Letter J : 1670 feet from the South line and 1705 feet from the East line  
Section 10 Township 25N Range 2W NMPM Rio Arriba County

11. Elevation (Show whether DR, RKB, RT, GR, etc.)  
7383' GL

Pit or Below-grade Tank Application (For pit or below-grade tank closures, a form C-144 must be attached)

Pit Location: UL J Sect 10 Twp 25N Rng 2W Pit type Drilling Depth to Groundwater >100' Distance from nearest fresh water well >1000'  
Distance from nearest surface water 500' Below-grade Tank Location UL  Sect  Twp  Rng  ;  
feet from the  line and  feet from the  line

12. Check Appropriate Box to Indicate Nature of Notice, Report or Other Data  
NOTICE OF INTENTION TO:

PERFORM REMEDIAL WORK ☐ PLUG AND ABANDON ☐  
TEMPORARILY ABANDON ☐ CHANGE PLANS ☐  
PULL OR ALTER CASING ☐ MULTIPLE COMPLETION ☐  
OTHER: Construct drilling reserve pit ☒

SUBSEQUENT REPORT OF:

REMEDIAL WORK ☐ ALTERING CASING ☐  
COMMENCE DRILLING OPNS. ☐ PLUG AND ABANDONMENT ☐  
CASING TEST AND CEMENT JOB ☐  
OTHER: ☐

13. Describe proposed or completed operations. (Clearly state all pertinent details, and give pertinent dates, including estimated date of starting any proposed work). SEE RULE 1103. For Multiple Completions: Attach wellbore diagram of proposed completion or recompletion.

Request permit to construct a lined reserve pit and unlined blow pit in conjunction with construction of this location. Reserve pit will be constructed in accordance with guidelines of interim pit regulations as shown on the attached cut and fill diagram. A closure permit will be submitted within six months of cessation of operations.

I hereby certify that the information above is true and complete to the best of my knowledge and belief. I further certify that any pit or below-grade tank has been/will be constructed or closed according to NMOCD guidelines ☒, a general permit ☐ or an (attached) alternative OCD-approved plan ☐.

SIGNATURE Robert E. Fielder TITLE Agent DATE July 7, 2004

Type or print name Robert E. Fielder

E-mail address: pmci@acs-online.net Telephone No. (505)632-3869

(This space for State use)

APPROVED BY Denny Funt TITLE DEPUTY OIL & GAS INSPECTOR, DIST. 9 DATE JUL - 8 2004  
Conditions of approval, if any:

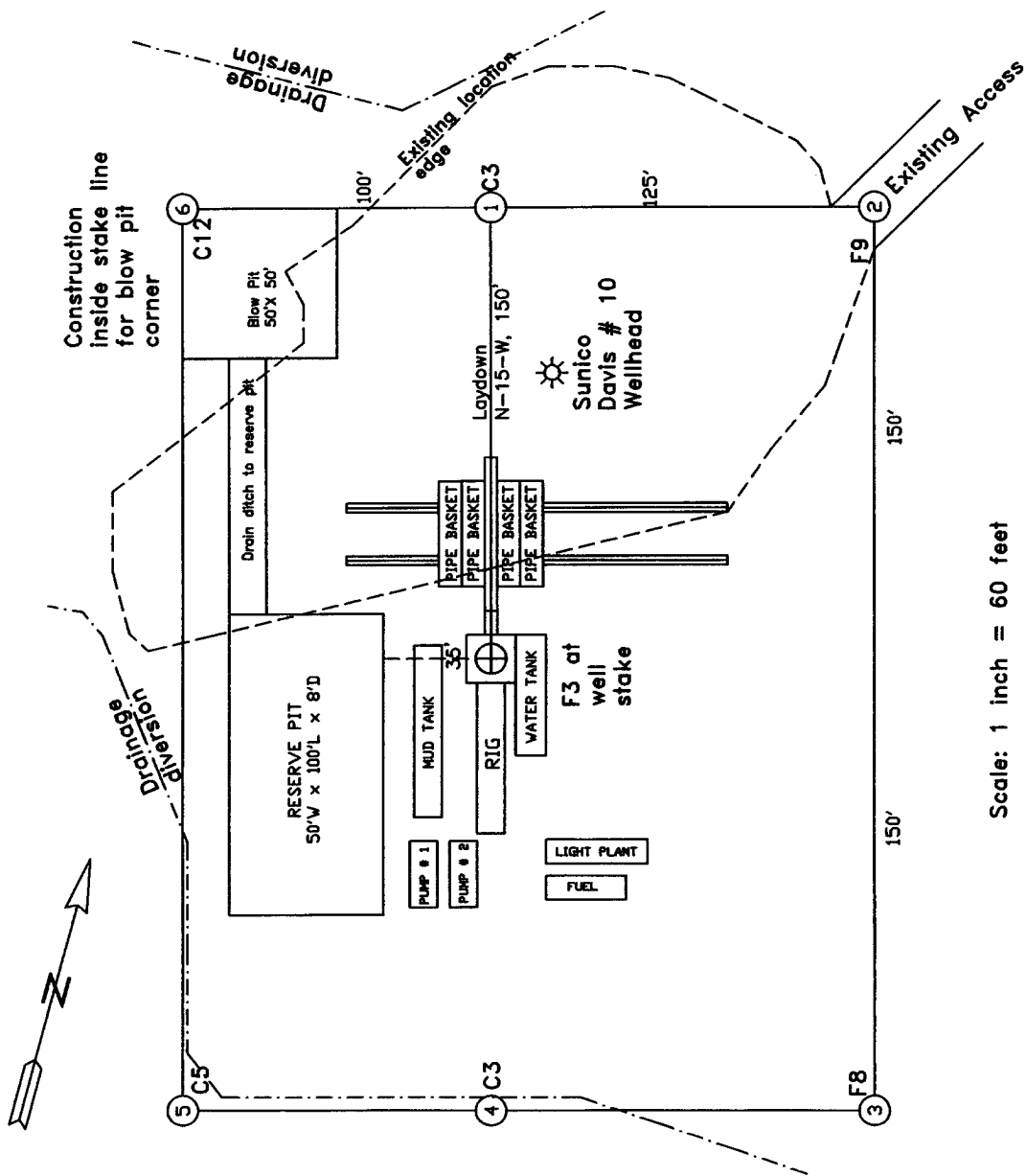

Scale: 1 inch = 60 feet

**McElwain Oil & Gas Properties, Inc.**

**Wellsite Layout**

Badger Com 10 No. 1B

1670'FSL & 1705'FEL

Section 10, T25N, R2W, NMPM

Rio Arriba Co., New Mexico

**1670' FSL, 1705' FEL, SECTION 10, T25N, R2W, NMPM  
RIO ARriba COUNTY, NM GROUND ELEVATION: 7383'**

