

UNITED STATES
DEPARTMENT OF THE INTERIOR
BUREAU OF LAND MANAGEMENT

APPLICATION FOR PERMIT TO DRILL, DEEPEN, OR PLUG BACK

1a. Type of Work DRILL	5. Lease Number NM-8010516-7 PM 2:34 Unit Reporting Number MV-8910009490 DK-891000949A
1b. Type of Well GAS	6. If Indian, All. or Tribe
2. Operator BURLINGTON RESOURCES Oil & Gas Company	7. Unit Agreement Name San Juan 28-5 Unit
3. Address & Phone No. of Operator PO Box 4289, Farmington, NM 87499 (505) 326-9700	8. Farm or Lease Name San Juan 28-5 Unit 9. Well Number 79N
4. Location of Well 830' FSL, 190' FEL Latitude 36° 40.2448, Longitude 107° 23.4936	10. Field, Pool, Wildcat Basin DK/Blanco MV 11. Sec., Twn, Rge, Mer. (NMPM) Sec. 7, T28N, R5W API # 30-039-27770
14. Distance in Miles from Nearest Town 29 miles to PO in Blanco NM	12. County Rio Arriba 13. State NM
15. Distance from Proposed Location to Nearest Property or Lease Line 190'	
16. Acres in Lease	17. Acres Assigned to Well 322.96 AK OK 282.96 All-MV
18. Distance from Proposed Location to Nearest Well, Drig, Compl, or Applied for on this Lease 1547'	
19. Proposed Depth 8048'	20. Rotary or Cable Tools Rotary
21. Elevations (DF, FT, GR, Etc.) 6685' GR	22. Approx. Date Work will Start
23. Proposed Casing and Cementing Program See Operations Plan attached	
24. Authorized by: <u>Joni Clark</u> Regulatory/Compliance Specialist	Date <u>3/19/04</u>

PERMIT NO. _____

APPROVAL DATE _____

AUG 04 2004

APPROVED BY Original Signed: Stephen Mason

TITLE _____

DATE AUG 04 2004

Archaeological Report to be submitted

Threatened and Endangered Species Report to be submitted

NOTE: This format is issued in lieu of U.S. BLM Form 3160-3

Title 18 U.S.C. Section 1001, makes it a crime for any person knowingly and willfully to make to any department or agency of the United States any false, fictitious or fraudulent statements or presentations as to any matter within its jurisdiction.

This action is subject to technical and procedural review pursuant to 43 CFR 3165.3 and appeal pursuant to 43 CFR 3165.4

DRILLING OPERATIONS AUTHORIZED ARE
SUBJECT TO COMPLIANCE WITH ATTACHED
"GENERAL REQUIREMENTS".

NMOC

DISTRICT II
811 South First, Artesia, N.M. 88210

DISTRICT III
1000 Rio Brazos Rd., Aztec, N.M. 87410

DISTRICT IV
2040 South Pacheco, Santa Fe, NM 87505

OIL CONSERVATION DIVISION

2040 South Pacheco
Santa Fe, NM 87505

Submit to Appropriate District Office
State Lease - 4 Copies
Fee Lease - 3 Copies

☐ AMENDED REPORT

WELL LOCATION AND ACREAGE DEDICATION PLAT

*API Number 30-039 27770		*Pool Code 71599/72319	*Pool Name Basin Dakota/Blanco Mesaverde	
*Property Code 7460	*Property Name SAN JUAN 28-5 UNIT			*Well Number 79N
*OGRID No. 14538	*Operator Name BURLINGTON RESOURCES OIL AND GAS COMPANY LP			*Elevation 6685'

¹⁰ Surface Location

UL or lot no.	Section	Township	Range	Lot Idn	Feet from the	North/South line	Feet from the	East/West line	County
P	7	28-N	5-W		830'	SOUTH	190'	EAST	RIO ARRIBA

11 Bottom Hole Location If Different From Surface

UL or lot no.	Section	Township	Range	Lot Idn	Feet from the	North/South line	Feet from the	East/West line	County
²² Dedicated Acres MV A11/322.96 <i>282.96</i> DK A11 /322.96			²³ Joint or Infill		²⁴ Consolidation Code		²⁵ Order No. <i>DK R-2948 unit 1</i>		

**NO ALLOWABLE WILL BE ASSIGNED TO THIS COMPLETION UNTIL ALL INTERESTS HAVE BEEN CONSOLIDATED
OR A NON-STANDARD UNIT HAS BEEN APPROVED BY THE DIVISION**

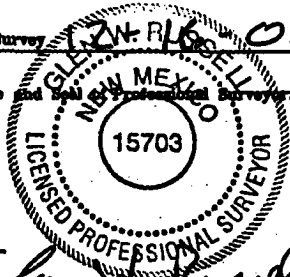
<div style="position: relative; width: 100%; height: 100%;"> 16 <!-- Grid area --> </div>						<p>17 OPERATOR CERTIFICATION</p> <p>I hereby certify that the information contained herein is true and complete to the best of my knowledge and belief.</p> <p style="font-family: cursive; font-size: 1.5em;">Joni Clark</p> <hr/> <p>Signature Joni Clark</p> <hr/> <p>Printed Name Regulatory Specialist</p> <hr/> <p>Title 2-4-04</p> <hr/> <p>Date</p>	
<div style="position: relative; width: 100%; height: 100%;"> <!-- Map area --> </div>						<p>18 SURVEYOR CERTIFICATION</p> <p>I hereby certify that the well location shown on this plan was plotted from field notes of actual surveys made by me or under my supervision, and that the same is true and correct to the best of my belief.</p> <p>Date of Survey 12-24-RLS-03</p> <hr/> <p>Signature and Seal of Professional Surveyor:</p> <div style="text-align: center;">  </div> <p>Certificate Number 15703</p>	

Map Details:

- Section 7 (Left): LOT 4, LOT 3, LOT 2, LOT 1. Township: N40-05-14W, Range: E23S-R1E.
- Section 8 (Right): LOT 4, LOT 3, LOT 2, LOT 1. Township: N40-05-14W, Range: E23S-R1E.
- Well Location: Section 8, Lot 3. Coordinates: LAT: 36°40.2448' N, LONG: 107°23.4936' W, NAD 1983.
- Distances: 190' (East), 830' (South).
- Survey Data: USA NM-010518, H89-47-37W, 2638.71'

District I

1625 N. French Dr., Hobbs, NM 88240

District II

1301 W. Grand Ave., Artesia, NM 88210

District III

1000 Rio Brazos Rd., Aztec, NM 87410

District IV

1220 S. St. Francis Dr., Santa Fe, NM 87505

State of New Mexico
Energy, Minerals and Natural Resources

OIL CONSERVATION DIVISION
1220 South St. Francis Dr.
Santa Fe, NM 87505

March 4, 2004

<p align="center">SUNDRY NOTICES AND REPORTS ON WELLS</p> <p>(DO NOT USE THIS FORM FOR PROPOSALS TO DRILL OR TO DEEPEN OR PLUG BACK TO A DIFFERENT RESERVOIR. USE "APPLICATION FOR PERMIT" (FORM C-101) FOR SUCH PROPOSALS.)</p>		<p>WELL API NO. 30-039-</p>
<p>1. Type of Well: Oil Well <input type="checkbox"/> Gas Well <input checked="" type="checkbox"/> Other</p>		<p>5. Indicate Type of Lease STATE <input type="checkbox"/> FEE <input type="checkbox"/></p>
<p>2. Name of Operator Burlington Resources Oil & Gas Company LP</p>		<p>6. State Oil & Gas Lease No. NMNM-010516</p>
<p>3. Address of Operator 3401 E. 30th Street, Farmington, NM 87402</p>		<p>7. Lease Name or Unit Agreement Name San Juan 28-5 Unit</p>
<p>4. Well Location Unit Letter <u>P</u> : <u>830</u> feet from the <u>South</u> line and <u>190</u> feet from the <u>East</u> line Section <u>7</u> Township <u>28N</u> Range <u>5W</u> NMPM Rio Arriba County, NM</p>		<p>8. Well Number 79N</p>
<p>11. Elevation (Show whether DR, RKB, RT, GR, etc.)</p>		<p>9. OGRID Number 14538</p>
<p>10. Pool name or Wildcat Blanco Mesaverde/Basin Dakota</p>		
<p>Pit or Below-grade Tank Application (For pit or below-grade tank closures, a form C-144 must be attached)</p>		
<p>Pit Location: UL <u>P</u> Sect <u>7</u> Twp <u>28N</u> Rng <u>5W</u> Pit type <u>New</u> Depth to Groundwater <u><50'</u> Distance from nearest fresh water well <u>>1000'</u> Distance from nearest surface water <u>>1000'</u> Below-grade Tank Location UL _____ Sect _____ Twp _____ Rng _____ ; _____ feet from the _____ line and _____ feet from the _____ line</p>		

12. Check Appropriate Box to Indicate Nature of Notice, Report or Other Data

NOTICE OF INTENTION TO:

PERFORM REMEDIAL WORK ☐ PLUG AND ABANDON ☐

TEMPORARILY ABANDON ☐ CHANGE PLANS ☐

PULL OR ALTER CASING ☐ MULTIPLE COMPLETION ☐

OTHER: New Drill Pit ☒

SUBSEQUENT REPORT OF:

REMEDIAL WORK ☐ ALTERING CASING ☐

COMMENCE DRILLING OPNS. ☐ PLUG AND ABANDONMENT ☐

CASING TEST AND CEMENT JOB ☐

OTHER: ☐

13. Describe proposed or completed operations. (Clearly state all pertinent details, and give pertinent dates, including estimated date of starting any proposed work). SEE RULE 1103. For Multiple Completions: Attach wellbore diagram of proposed completion or recompletion.

Burlington Resources proposes to construct a new drill pit. The new drill pit will be a lined pit as detailed in Burlington's general pit construction plan dated April 26, 2004 on file at the NMOCD office.

I hereby certify that the information above is true and complete to the best of my knowledge and belief. I further certify that any pit or below-grade tank has been/will be constructed or closed according to NMOCD guidelines ☐, a general permit ☒ or an (attached) alternative OCD-approved plan ☐.

SIGNATURE Joni Clark TITLE Regulatory Specialist DATE 6/7/04

Type or print name Joni Clark E-mail address: jclark@br-inc.com Telephone No. 326-9700

(This space for State use)

APPROVED BY [Signature] TITLE DEPUTY OIL & GAS INSPECTOR, DIST. 20 DATE AUG 6 2004
Conditions of approval, if any:

BURLINGTON RESOURCES OIL & GAS COMPANY LP
SAN JUAN 28-5 UNIT #79N, 830' FSL & 190' FEL
SECTION 7, T-28-N, R-5-W, NMPM, RIO ARriba COUNTY, NM
GROUND ELEVATION: 6685', DATE: DECEMBER 1, 2003

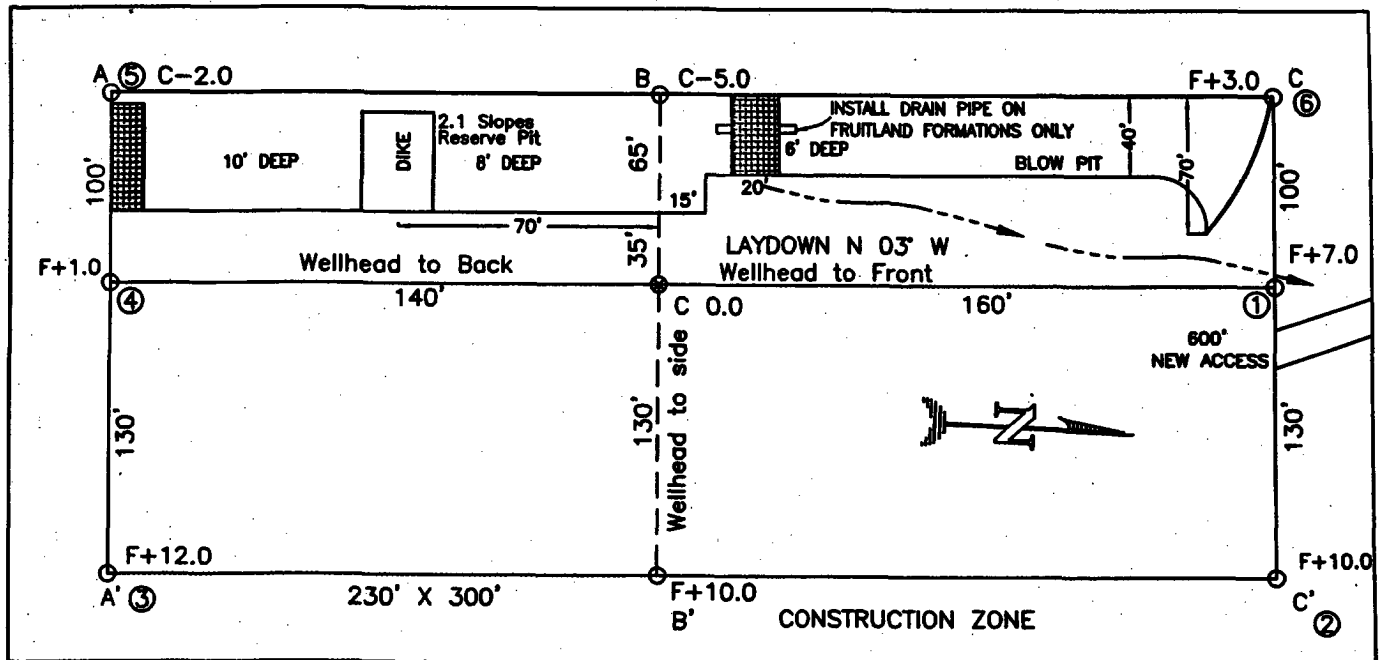

(330' X 400') = 3.03 ACRES

RESERVE PIT DIKE: TO BE 8' ABOVE DEEP SIDE (OVERFLOW - 3' WIDE AND 1' ABOVE SHALLOW SIDE).
 BLOW PIT: OVERFLOW PIPE HALFWAY BETWEEN TOP AND BOTTOM AND TO EXTEND OVER PLASTIC LINER AND INTO BLOW PIT.

ELEV. A-A'

C/L

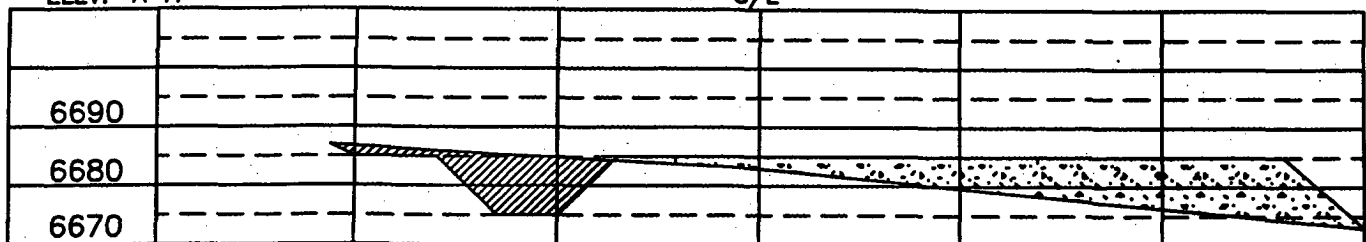

ELEV. B-B'

C/L

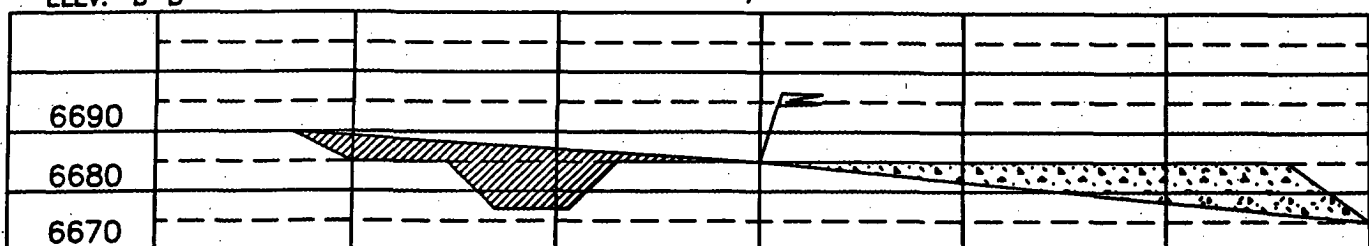

ELEV. C-C'

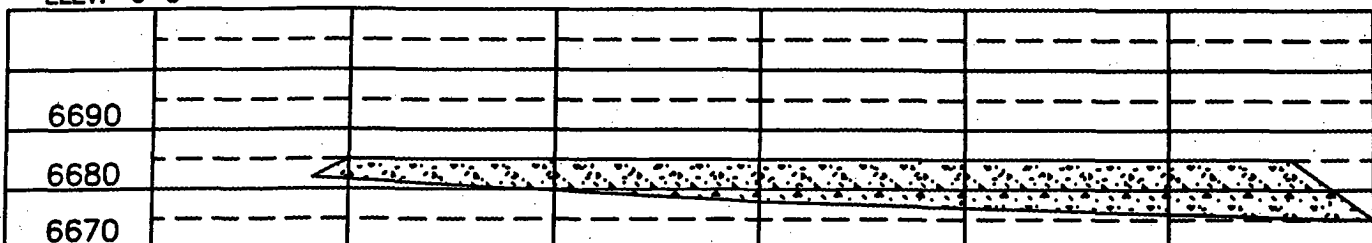

NOTE: VECTOR SURVEYS IS NOT LIABLE FOR UNDERGROUND UTILITIES OR PIPELINES.
 CONTRACTOR SHOULD CALL ONE-CALL FOR LOCATION OF ANY MARKED OR UNMARKED BURIED PIPELINES OR CABLES
 ON WELL PAD AND OR ACCESS ROAD AT LEAST TWO (2) WORKING DAYS PRIOR TO CONSTRUCTION.

OPERATIONS PLAN

Well Name: San Juan 28-5 Unit #79N
Location: 830' FSL, 190' FEL, Sec 7, T-28-N, R-5-W
Rio Arriba County, NM
Latitude 36° 40.2448, Longitude 107° 23.4936
Formation: Blanco Mesaverde/Basin Dakota

Total Depth: 8048'

Logging Program: See San Juan 28-5 Unit Master Operations Plan

Mud Program: See 28-5 Unit Master Operations Plan

Casing Program (as listed, the equivalent, or better):

<u>Hole Size</u>	<u>Depth Interval</u>	<u>Csg. Size</u>	<u>Wt.</u>	<u>Grade</u>	<u>Cement</u>
12 1/4"	0' - 120'	9 5/8"	32.3#	WC-50	113 cu.ft.
8 3/4"	0' - 3794'	7"	20.0#	J-55	849 cu.ft.
6 1/4"	0' - 7800'	4 1/2"	10.5#	J-55	
6 1/4"	7800' - 8048'	4 1/2"	11.6#	N-80	579 cu.ft.

Tubing Program: See 28-5 Unit Master Operations Plan

- The Mesaverde and Dakota formations will be completed and commingled.
- The all of Section 7 is dedicated to the Mesaverde and the Dakota formations in this well.
- Gas is dedicated.

Sean Corrigan
Drilling Engineer

April 7, 2004
Date