

UNITED STATES
DEPARTMENT OF THE INTERIOR
BUREAU OF LAND MANAGEMENT

FORM APPROVED
OMB No. 1004-0136
Expires November 30, 2000

APPLICATION FOR PERMIT TO DRILL OR REENTER

1a. Type of Work: <input checked="" type="checkbox"/> DRILL <input type="checkbox"/> REENTER		5. Lease Serial No. NM 03404
1b. Type of Well: <input type="checkbox"/> Oil Well <input checked="" type="checkbox"/> Gas Well <input type="checkbox"/> Other <input checked="" type="checkbox"/> Single Zone <input type="checkbox"/> Multiple Zone		6. If Indian, Allottee or Tribe Name
2. Name of Operator CONOCOPHILLIPS COMPANY		7. If Unit or CA Agreement, Name and No.
Contact: VICKI WESTBY E-Mail: Vicki.R.Westby@conocophillips.com		8. Lease Name and Well No. SAN JUAN 31-6 UNIT 212A
3a. Address 4001 PENBROOK, SUITE 346 ODESSA, TX 79762	3b. Phone No. (include area code) Ph: 915.368.1352	9. API Well No. 30039 27812
4. Location of Well (Report location clearly and in accordance with any State requirements.) At surface SESE 1311FSL 610FEL At proposed prod. zone		10. Field and Pool, or Exploratory BASIN FRUITLAND COAL
14. Distance in miles and direction from nearest town or post office*		11. Sec., T., R., M., or Blk. and Survey or Area Sec 5 T30N R6W Mer NMP
15. Distance from proposed location to nearest property or lease line, ft. (Also to nearest drig. unit line, if any)	16. No. of Acres in Lease	12. County or Parish RIO ARRIBA
18. Distance from proposed location to nearest well, drilling, completed, applied for, on this lease, ft.	19. Proposed Depth 3337 MD	13. State NM
21. Elevations (Show whether DF, KB, RT, GL, etc.) 6317 GL	22. Approximate date work will start	17. Spacing Unit dedicated to this well
23. Estimated duration		

24. Attachments

The following, completed in accordance with the requirements of Onshore Oil and Gas Order No. 1, shall be attached to this form:

1. Well plat certified by a registered surveyor.
2. A Drilling Plan.
3. A Surface Use Plan (if the location is on National Forest System Lands, the SUPO shall be filed with the appropriate Forest Service Office).
4. Bond to cover the operations unless covered by an existing bond on file (see Item 20 above).
5. Operator certification
6. Such other site specific information and/or plans as may be required by the authorized officer.

25. Signature (Electronic Submission)	Name (Printed/Typed) VICKI WESTBY	Date 06/22/2004
Title AGENT		
Approved by (Signature) <i>[Signature]</i>	Name (Printed/Typed)	Date 8-17-04
Title AFM	Office FFO	

Application approval does not warrant or certify the applicant holds legal or equitable title to those rights in the subject lease which would entitle the applicant to conduct operations thereon.
Conditions of approval, if any, are attached.

Title 18 U.S.C. Section 1001 and Title 43 U.S.C. Section 1212, make it a crime for any person knowingly and willfully to make to any department or agency of the United States any false, fictitious or fraudulent statements or representations as to any matter within its jurisdiction.

Additional Operator Remarks (see next page)

Electronic Submission #32225 verified by the BLM Well Information System
For CONOCOPHILLIPS COMPANY, sent to the Farmington

This action is subject to technical and procedural review pursuant to 43 CFR 3165.3 and appeal pursuant to 43 CFR 3165.4

DRILLING OPERATIONS AUTHORIZED ARE
SUBJECT TO COMPLIANCE WITH ATTACHED
"GENERAL REQUIREMENTS".

HOLD C104 FOR NWSL

** OPERATOR-SUBMITTED ** OPERATOR-SUBMITTED ** OPERATOR-SUBMITTED **

NMOCD

Form C-102
Revised June 10, 2003
Submit to Appropriate District Office
State Lease - 4 Copies
Fee Lease - 3 Copies

☐ AMENDED REPORT

OPERATOR CERTIFICATION

I hereby certify that the information contained herein is true and complete to the best of my knowledge and belief.

Vicki Westby
Signature

Vicki Westby
Printed Name

Sr. Assistant
Title and E-mail Address

6/22/04
Date

SURVEYOR CERTIFICATION

I hereby certify that the well location shown on this plat was plotted from field notes of actual surveys made by me or under my supervision, and that the same is true and correct to the best of my belief.

Date of Survey: 05/19/04
Signature and Seal of Professional Surveyor

DEAN HENRY P. BARNHARTT, JR.
REGISTERED PROFESSIONAL SURVEYOR
NEW YORK STATE
071393
6/19/04

Certificate Number: 071393

Submit 3 Copies To Appropriate District
Office
District I
1625 N. French Dr., Hobbs, NM 88240
District II
1301 W. Grand Ave., Artesia, NM 88210
District III
1000 Rio Brazos Rd., Aztec, NM 87410
District IV
1220 S. St. Francis Dr., Santa Fe, NM
87505

State of New Mexico
Energy, Minerals and Natural Resources

Form C-103
March 4, 2004

OIL CONSERVATION DIVISION
1220 South St. Francis Dr.
Santa Fe, NM 87505

WELL API NO.
5. Indicate Type of Lease STATE <input type="checkbox"/> FEE <input type="checkbox"/>
6. State Oil & Gas Lease No.
7. Lease Name or Unit Agreement Name San Juan 31-6 Unit
8. Well Number 212A
9. OGRID Number 217817
10. Pool name or Wildcat Basin Fruitland Coal

SUNDRY NOTICES AND REPORTS ON WELLS
(DO NOT USE THIS FORM FOR PROPOSALS TO DRILL OR TO DEEPEN OR PLUG BACK TO A DIFFERENT RESERVOIR. USE "APPLICATION FOR PERMIT" (FORM C-101) FOR SUCH PROPOSALS.)

1. Type of Well:
Oil Well ☐ Gas Well ☒ Other

2. Name of Operator
ConocoPhillips Company

3. Address of Operator
4001 Penbrook, Odessa, TX 79762

4. Well Location

Unit Letter P : 1311 feet from the SOUTH line and 610 feet from the EAST line

Section 5 Township 31N Range 6W NMPM Rio Arriba County

11. Elevation (Show whether DR, RKB, RT, GR, etc.)
6317' GL

Pit or Below-grade Tank Application (For pit or below-grade tank closures, a form C-144 must be attached)

Pit Location: UL P Sect 5 Twp 31N Rng 6W Pit type Drill Pit Depth to Groundwater >100' Distance from nearest fresh water well >1000'
Distance from nearest surface water >200'<1000' Below-grade Tank Location UL Sect Twp Rng ; feet from the line and feet from the line

12. Check Appropriate Box to Indicate Nature of Notice, Report or Other Data

NOTICE OF INTENTION TO:

PERFORM REMEDIAL WORK ☐ PLUG AND ABANDON ☐

TEMPORARILY ABANDON ☐ CHANGE PLANS ☐

PULL OR ALTER CASING ☐ MULTIPLE COMPLETION ☐

OTHER: Drill Pit Notification ☒

SUBSEQUENT REPORT OF:

REMEDIAL WORK ☐ ALTERING CASING ☐

COMMENCE DRILLING OPNS. ☐ PLUG AND ABANDONMENT ☐

CASING TEST AND CEMENT JOB ☐

OTHER: ☐

13. Describe proposed or completed operations. (Clearly state all pertinent details, and give pertinent dates, including estimated date of starting any proposed work). SEE RULE 1103. For Multiple Completions: Attach wellbore diagram of proposed completion or recompletion.

ConocoPhillips Company's Generic Pit Plan is on file at NMOCD in Aztec, NM. See the attached diagram that details the location of the pit in reference to the proposed wellhead. The drill pit will be lined. The drill pit will be closed after the well has been completed. The solids left after the water has been disposed of will be sampled and NMOCD approval will be obtained prior to closure of this pit.

I hereby certify that the information above is true and complete to the best of my knowledge and belief. I further certify that any pit or below-grade tank has been/will be constructed or closed according to NMOCD guidelines ☐, a general permit ☐ or an (attached) alternative OCD-approved plan ☐.

SIGNATURE Vicki Westby TITLE Sr. Analyst DATE 6/22/04

Type or print name Vicki Westby E-mail address: Vicki.R.Westby@conocophillips.com Telephone No. 432-368-1352

(This space for State use)

APPROVED BY [Signature] TITLE DEPUTY OIL & GAS INSPECTOR, DIST. III DATE AUG 23 2004
Conditions of approval, if any:

CONOCOPHILLIPS COMPANY SAN JUAN 31-6 UNIT #212A
 1311' FSL & 610' FEL, SECTION 5, T30N, R6W, NMPM
 RIO ARRIBA COUNTY, NEW MEXICO, ELEVATION: 6317

LATITUDE: 36.83778° N
 LONGITUDE: 107.47917° W
 DATUM: NAD83

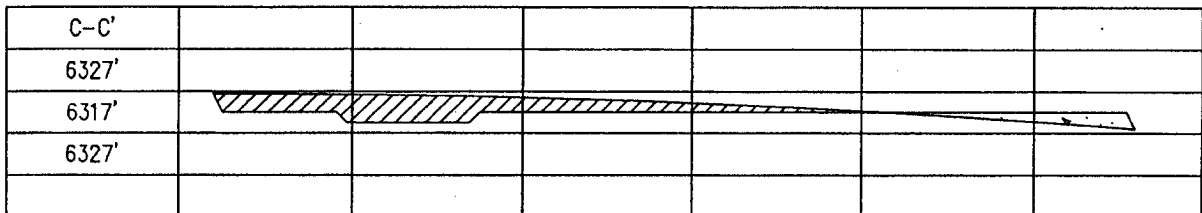
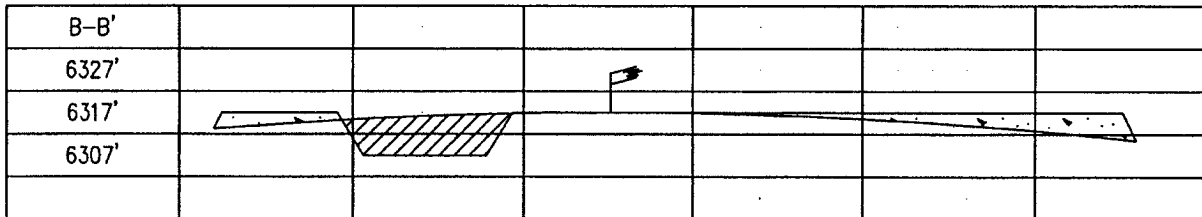
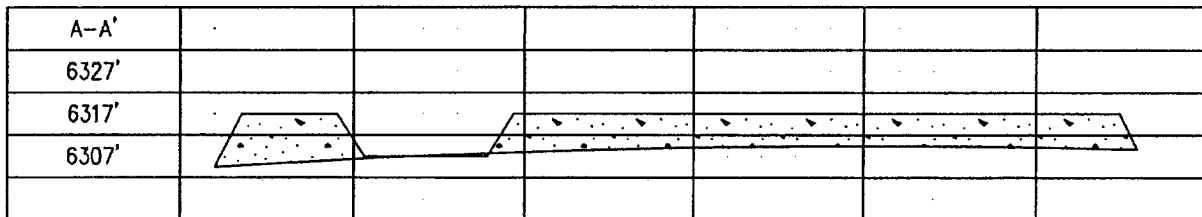
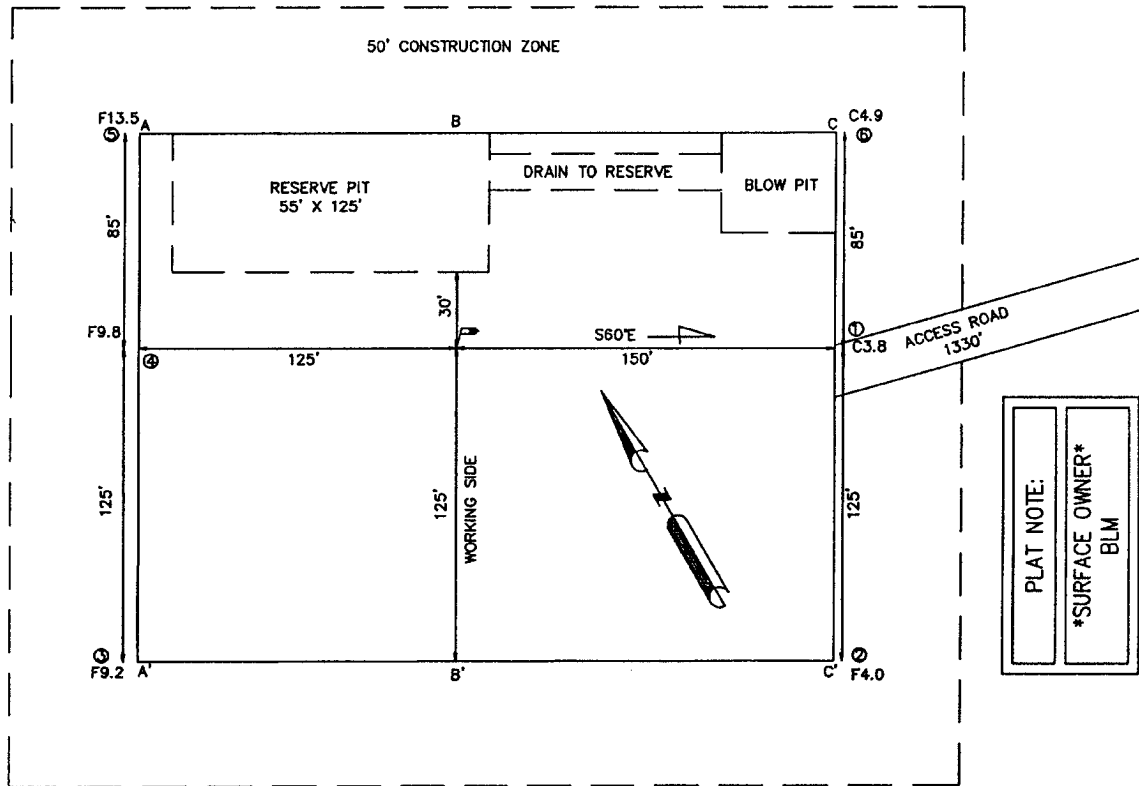



San Juan Business Unit

PROJECT PROPOSAL - New Drill / Sidetrack

SAN JUAN 31-6 212A

Lease:	AFE #: WAN.CBM.4164		AFE \$:	
Field Name: hPHILLIPS 31-6	Rig: 486-0597	State: NM	County: RIO ARRIBA	API #:
Geoscientist: Murphy, Jim O.	Phone: 832-486-2361	Prod. Engineer: Bergman, Pat W.	Phone: (832) 486-2358	
Res. Engineer: Anderson, Derrick K	Phone: 832 486-3486	Proj. Field Lead:	Phone:	

Primary Objective (Zones):

Zone	Zone Name
JCV	BASIN FRUITLAND COAL (GAS)

Location: Surface				Straight Hole	
Latitude: 36.84	Longitude: -107.48	X:	Y:	Section: 5	Range: 6W
Footage X: 610 FEL	Footage Y: 1311 FSL	Elevation: 6317 (FT)	Township: 30N		

Tolerance:

Location Type:	Start Date (Est.):	Completion Date:	Date In Operation:
----------------	--------------------	------------------	--------------------

Formation Data: Assume KB = 6330 Units = FT

Formation Call & Casing Points	Depth (TVD in Ft)	SS (Ft)	Depletion (Yes/No)	BHP (PSIG)	BHT	Remarks
SAN JOSE	0	6330	<input type="checkbox"/>			
Surface Casing	213	6117	<input type="checkbox"/>			12-1/4 hole. 9 5/8" 32.3 ppf, H-40, STC casing. Circulate cement to surface.
NCMT	1168	5162	<input type="checkbox"/>			
OJAM	2278	4052	<input type="checkbox"/>			Possible water flows.
KRLD	2418	3912	<input type="checkbox"/>			
FRLD	2834	3496	<input type="checkbox"/>			Possible gas.
Intermediate Casing	2979	3351	<input type="checkbox"/>			8 3/4" Hole. 7", 20 ppf, J-55, STC Casing. Circulate cement to surface.
BASE MAIN COAL	3134	3196	<input type="checkbox"/>	125		
PC TONGUE	3144	3186	<input type="checkbox"/>			
BASE LOWEST COAL	3259	3071	<input type="checkbox"/>			
PCCF	3264	3066	<input type="checkbox"/>			
Total Depth	3337	2993	<input type="checkbox"/>			6-1/4" hole possibly underreamed to 9.5". Optional Liner: 5.5", 15.5#, J-55 LTC - left uncemented.

Reference Wells:

Reference Type	Well Name	Comments
----------------	-----------	----------

Logging Program:

Intermediate Logs:	<input type="checkbox"/> Log only if show	<input type="checkbox"/> GR/ILD	<input type="checkbox"/> Triple Combo
TD Logs:	<input type="checkbox"/> Triple Combo	<input type="checkbox"/> Dipmeter	<input type="checkbox"/> RFT <input type="checkbox"/> Sonic <input type="checkbox"/> VSP <input type="checkbox"/> TDT

Additional Information:

Comments: Location/Tops/Logging - This well will target the inter-tongue coal. If it is not encountered, the td will be shortened to 20 feet below the projected base of the lower coal package.

Zones - HPA

General/Work Description - Fruitland Coal 160-acre infill well

Mud Log from intermediate casing shoe to TD will be obtained.

Drilling Mud Program:

Printed on: 06/22/2004 10:19:43 AM

TD includes 80 feet sump/rathole & COPC will comply with the BLM's Conditions of Approval for the proposed sump/rathole in this non-producing Pictured Cliffs formation.

San Juan 31-6 # 212A		
9-5/8" Surface Casing		
Cement Slurry	Class G	
	+ 2% S001 Calcium Chloride	
	+ 0.25 lb/sx D029 Cellophane Flakes	
Cement Volume	155	sx
Cement Yield	1.16	cuft/sx
Cement Volume	179.75	cuft
Cement Density	15.8	ppg
Water Required	4.983	gal/sx

San Juan 31-6 # 212A

7" Intermediate Casing		
Lead Slurry		
Cement Slurry	Class G	
	+ 3% D079 Extender	
	+ 0.25 lb/sx D029 Cellophane Flakes	
	+ 0.2% D046 Antifoam	
Cement Volume	382	sx
Cement Yield	2.61	cuft/sx
Cement Volume	997.30	cuft
Cement Density	11.7	ppg
Water Required	15.876	gal/sx

7" Intermediate Casing		
Tail Slurry		
Cement Slurry	50% POZ / 50% Class G cement	
	+ 2% D020 Bentonite	
	+ 2% S001 Calcium Chloride	
	+ 0.25 lb/sx D029 Cellophane Flakes	
	+ 5 lb/sx Gilsonite Extender	
	+ 0.2% D046 Antifoam	
Cement Volume	100	sx
Cement Yield	1.27	cuft/sx
Cement Volume	126.80	cuft
Cement Density	13.5	ppg
Water Required	5.182	gal/sx

BLOWOUT PREVENTER ARRANGEMENT & PROGRAM

For Drilling to Intermediate Casing Point & Setting 7" Intermediate Casing

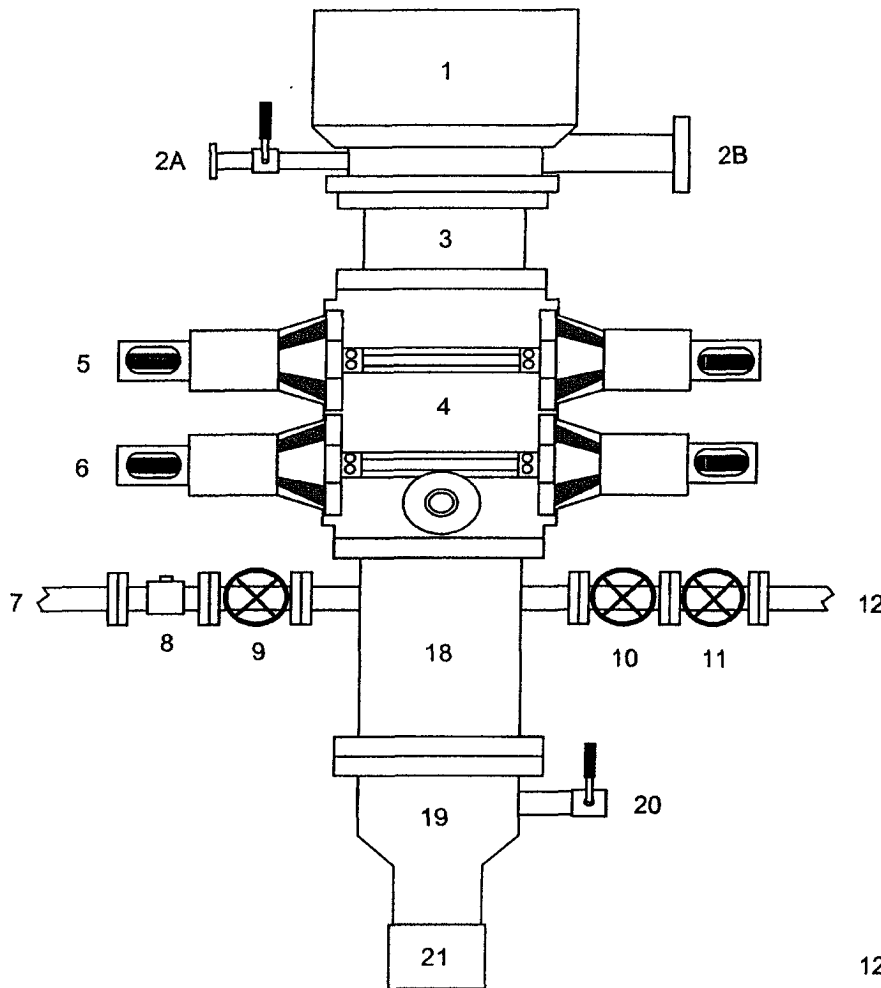

1. Rotating Head
- 2A. Fill-up Line & valve
- 2B. Flowline
3. Spacer Spool
4. Double Ram BOP (11", 3000 psi)
5. Pipe Rams
6. Blind Rams
7. Kill Line
8. Kill Line Check Valve
9. Kill Line Valve
10. Inner Choke Line Valve (3")
11. Outer Choke Line Valve (3")
12. Choke Line (3")
13. Variable Choke
14. Choke Line Valve (2")
15. Panic Line Valve (3")
16. Choke Manifold Pressure Gauge
17. Choke Line (2")
18. Mud Cross Spacer Spool
19. Casing Head "A" Section
20. Casing Head "A" Section 2" Valve
21. 9 5/8" Casing Collar

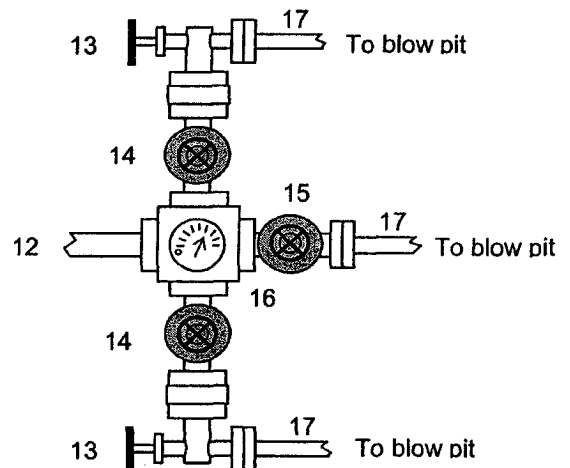

A 12-1/4" hole will be drilled to approximately 220' and the 9-5/8" surface casing will be run and cemented. The Casing Head "A" Section will be screwed onto the 9-5/8" surface casing stub. The BOP will be installed on the Casing Head "A" Section. A test plug will be set in the wellhead and the pipe rams and choke manifold will be tested to 200 psi to 300 psi (low pressure test) for 2-3 minutes and to 1000 psi (high pressure test) for 10 minutes. Then the test plug will be removed, and the 9-5/8" casing will be pressure tested against closed blind rams to 200 psi to 300 psi for 2-3 minutes and to 1000 psi for 30 minutes (this value is one 44% of the minimum internal yield pressure of the 9-5/8" casing). (Note: per regulatory requirements we will wait on cement at least 8 hrs after placement before testing the 9-5/8" surface casing). Then an 8-3/4" hole will be drilled to intermediate casing point and 7" intermediate casing will be run and cemented.

In addition to the equipment in the above diagram the following equipment will comprise the BOP system:

1. Upper Kelly cock Valve with handle
2. Stab-in TIW valve for all drillstrings in use

BLOWOUT PREVENTER ARRANGEMENT & PROGRAM

For Cavitation Program

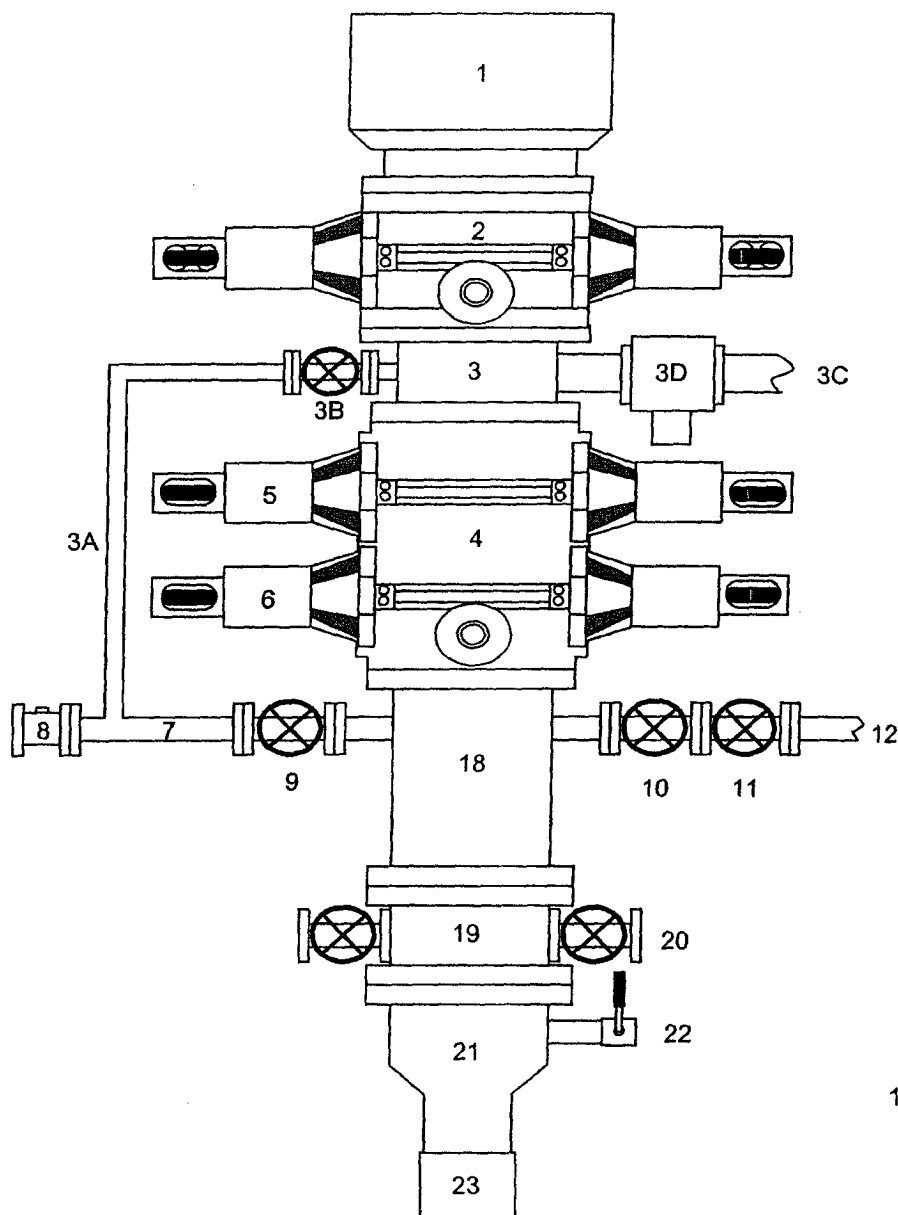

1. Rotating Head
2. Single Ram BOP (7-1/16", 3M)
3. Mud Cross
- 3A. Equalizing Line (2")
- 3B. Wing Valve (2-1/16", 3M)
- 3C. Blooie Line (2 ea, 5" OD)
- 3D. HCR Valve (1 ea per line, 4-1/16")
4. Double Ram BOP (7-1/16", 3M)
5. Pipe Rams
6. Blind Rams
7. Kill Line
8. Kill Line Check Valve
9. Kill Line Valve
10. Inner Choke Line Valve (3")
11. Outer Choke Line Valve (3")
12. Choke Line (3")
13. Variable Choke
14. Choke Line Valve (2")
15. Panic Line Valve (3")
16. Choke Manifold Pressure Gauge
17. Vent Line (2")
18. Spacer Spool
19. Tubing Head
20. Tubing Head Valves (2- 9/16")
21. Casing Head "A" Section
22. Casing Head "A" Section 2" Valve
23. 9-5/8" Casing Collar

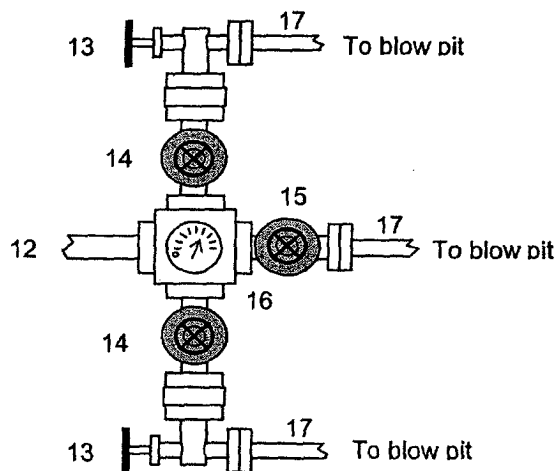

This BOP arrangement and test program is for the cavitation program. The BOP will be installed on the tubing head. The 7" casing will be pressure tested against closed blind rams to 200 psi to 300 psi for 2-3 minutes and to 1800 psi for 30 minutes - this test pressure is 48% of the minimum internal yield strength of 3740 psi for the 7", 20#, J-55, STC casing. The pipe rams and choke manifold will be tested to 200 psi to 300 psi (low pressure test) for 2-3 minutes and to 1800 psi (high pressure test) for 10 minutes - This test will be done with a test plug or possibly without a test plug (ie against casing). If we conduct this test without a test plug we will ensure that we have sufficient drillstring weight in the hole to exceed the upward force generated by the test.

We use a power swivel and air/mist to drill the 6-1/4" hole in our cavitation program. We do not use a kelly. In addition to the equipment in the above diagram the following equipment will comprise the BOP system:

1. String floats will be used inside the drillpipe
2. Stab-in TIW valve for all drillstrings in use
3. Each blooie line is equipped with a hydraulically controlled valve (HCR valve).

Cathodic Protection System Description

Anode Bed Type	Deep Well	
Hole Size	8"	
Hole Depth	200' - 500'	As required to place anodes below moisture and in low resistance strata.
Surface Casing	8" Diam., \geq 20' Length. Cemented In Annular Space	When needed, casing will be installed at an adequate depth to control ground water flow. Casing will extend a minimum of 2' above grade, be surrounded by a concrete pad, and sealed with a PVC cap. Steel casing will be substituted when boulders are encountered.
Vent Pipe	1" Diam. PVC	Vent pipe will extend from bottom of hole, through top of casing cap, and sealed with a 1" perforated PVC cap.
Type Of Anodes	Cast Iron Or Graphite	
Number Of Anodes	8 - 20	Sufficient quantity to achieve a total anode bed resistance of < 1 ohm and a design life \geq 20 years.
Anode Bed Backfill	Lorasco SW Calcined Petroleum Coke Breeze	Installed from bottom of hole to 10' above top anode.
Anode Junction Box	8 - 20 Circuit Fiberglass Or Metal	Sealed to prevent insect & rodent intrusion.
Current Splitter Box	2 - 5 Circuit Metal	Sealed to prevent insect & rodent intrusion.
DC / AC Cable	DC: #2, #4, #6, #8 Stranded Copper (One Size Or Any Combination Of) With High Molecular Weight Polyethylene (HMWPE) Insulation. AC: #8 Stranded Copper HMWPE	18" depth in typical situation, 24" depth in roadway, & 36" depth in arroyos and streams. EXCEPTION: If trenching is in extremely hard substratum, depth will be 8 - 12" with cable installed in conduit. Installed above foreign pipelines if 1' clearance is available, if not, installed under foreign pipeline with 1' clearance (AC cable always installed under foreign pipeline in conduit).
Power Source	1) Rectifier 2) Solar Power Unit 3) Thermoelectric Generator	Choice of power source depending on availability of AC & other economic factors.
External Painting	Color to be selected according to BLM specifications.	Paint applied to any surface equipment associated with the CP system which can reasonably be painted.

ConocoPhillips

**ConocoPhillips Company
PTRRC**

Peggy James
4001 Penbrook St. , Ste. 302
Odessa TX, 79762
Phone (432)368-1230
Fax (432)368-1287

Release 7-14-04

July 2, 2004

NMOCD
Attn: Steve Hayden
1000 Rio Brazos Road
Aztec, NM 87410

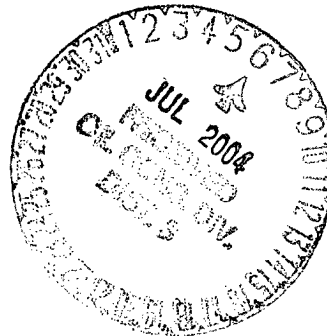

RE: San Juan 31-6 #212A Well
Section 5, T31N-R6W
San Juan County, New Mexico

Dear Steve:

Please find attached a copy of the HPA Notification Letter and a copy of the certified return receipts for the San Juan 31-6 #212A well, located in Section 5, T31N, R6W, San Juan County, New Mexico.

Sincerely,

Peggy James
Peggy James
PTRRC / Odessa

SENDER: COMPLETE THIS SECTION		COMPLETE THIS SECTION ON DELIVERY	
<p>■ Complete items 1, 2, and 3. Also complete item 4 if Restricted Delivery is desired.</p> <p>■ Print your name and address on the reverse so that we can return the card to you.</p> <p>■ Attach this card to the back of the mailpiece, or on the front if space permits.</p>		<p>A. Signature <input checked="" type="checkbox"/> <i>[Signature]</i> <input type="checkbox"/> Agent <input type="checkbox"/> Address</p>	
<p>1. Article Addressed to:</p> <p>Burlington Resources Attn: Dawn Howell P.O. Box 4289 Farmington NM 87499</p>		<p>B. Received by (Printed Name) <i>Bob Williams</i></p> <p>C. Date of Delivery <i>6-29-01</i></p>	
<p>2. Article Number (Transfer from service label)</p>		<p>D. Is delivery address different from item 1? <input type="checkbox"/> Yes If YES, enter delivery address below: <input type="checkbox"/> No</p>	
<p>3. Service Type</p> <p><input checked="" type="checkbox"/> Certified Mail <input type="checkbox"/> Express Mail <input type="checkbox"/> Registered <input type="checkbox"/> Return Receipt for Merchandise <input type="checkbox"/> Insured Mail <input type="checkbox"/> C.O.D.</p>		<p>4. Restricted Delivery? (Extra Fee) <input type="checkbox"/> Yes</p>	
<p>PS Form 3811, August 2001</p>		<p>Domestic Return Receipt 102595-02-M-15</p>	

7000 0600 0028 7723 5335



**ConocoPhillips Company
PTRRC**

Peggy James
4001 Penbrook St. , Ste. 302
Odessa TX, 79762
Phone (432)368-1230
Fax (432)368-1287

CERTIFIED MAIL -- RETURN RECEIPT REQUESTED

June 22, 2004

RE: San Juan 31-6 #212A Well
Basin Fruitland Coal
1311' FSL & 610' FEL, Section 5, T31N-R6W
San Juan County, New Mexico

To the Affected Parties:

ConocoPhillips Company is submitting the enclosed Application for Permit to Drill to the appropriate regulatory agency(s) for approval. This well is located inside the High Productivity Area of the Basin-Fruitland Coal Pool as indicated on the attached plat. Notice is being made pursuant to New Mexico Oil Conservation Commission Order R-8768-F dated July 17, 2003.

The affected parties have twenty (20) days from receipt of this notice in which to file with the District Office of the New Mexico Oil Conservation Division written objection to the proposed Application for Permit to Drill.

Sincerely,

A handwritten signature in cursive script, appearing to read 'Peggy James'.

Peggy James
PTRRC / Odessa

Cc: NMOCD Aztec
Well File

SAN JUAN 31-6 #212A
OFFSET OPERATOR PLAT

TOWNSHIP 30 **NORTH,** **RANGE** 6 **WEST**

1311' FSL 610' FEL

ConocoPhillips		ConocoPhillips
5		
ConocoPhillips	●	ConocoPhillips
Burlington Resources O & G	Burlington Resources O & G	Burlington Resources O & G