

District I  
1625 N. French Dr., Hobbs, NM 88240

District II  
1301 W. Grand Avenue, Artesia, NM 88210

District III  
1000 Rio Brazos Road, Aztec, NM 87410

District IV  
1220 S. St. Francis Dr., Santa Fe, NM 87505

State of New Mexico  
Energy Minerals and Natural Resources

Form C-101  
May 27, 2004

Oil Conservation Division  
1220 South St. Francis Dr.  
Santa Fe, NM 87505

Submit to appropriate District Office

☐ AMENDED REPORT

APPLICATION FOR PERMIT TO DRILL, RE-ENTER, DEEPEN, PLUGBACK, OR ADD A ZONE

<sup>1</sup> Operator Name and Address <b>Energen Resources Corp</b> c/o Walsh Engineering & Production, 7415 East Main Farmington, NM 87402		<sup>4</sup> OGRID Number 162928
		<sup>5</sup> API Number 30 - 045-32536
<sup>3</sup> Property Code 32227 300424	<sup>6</sup> Property Name Santa Rosa 32	<sup>8</sup> Well No. #2
<sup>9</sup> Proposed Pool 1 Basin Fruitland Coal		<sup>10</sup> Proposed Pool 2

<sup>7</sup> Surface Location

UL or lot no.	Section	Township	Range	Lot Idn	Feet from the	North/South line	Feet from the	East/West line	County
O	32	30N	9W		840'	South	1855'	East	San Juan

<sup>8</sup> Proposed Bottom Hole Location If Different From Surface

UL or lot no.	Section	Township	Range	Lot Idn	Feet from the	North/South line	Feet from the	East/West line	County

Additional Well Information

<sup>11</sup> Work Type Code N	<sup>12</sup> Well Type Code G	<sup>13</sup> Cable/Rotary R	<sup>14</sup> Lease Type Code P	<sup>15</sup> Ground Level Elevation 5702'
<sup>16</sup> Multiple No	<sup>17</sup> Proposed Depth 2500'	<sup>18</sup> Formation Fruitland	<sup>19</sup> Contractor	<sup>20</sup> Spud Date 9/1/04
Depth to Groundwater > 100'		Distance from nearest fresh water well > 1000'		Distance from nearest surface water > 1000'
<sup>21</sup> Pit: Liner: Synthetic <input type="checkbox"/> _____ mils thick Clay <input type="checkbox"/> Pit Volume: 2000 bbls Drilling Method: Closed-Loop System <input type="checkbox"/> Fresh Water <input checked="" type="checkbox"/> Brine <input type="checkbox"/> Diesel/Oil-based <input type="checkbox"/> Gas/Air <input type="checkbox"/>				

<sup>21</sup> Proposed Casing and Cement Program

Hole Size	Casing Size	Casing weight/foot	Setting Depth	Sacks of Cement	Estimated TOC
12-1/4"	8-5/8"	24 ppf	300'	210 sx	Surface
7-7/8"	5-1/2"	15.5 ppf	2500'	215 poz & 150 Class "B"	Surface

<sup>22</sup> Describe the proposed program. If this application is to DEEPEN or PLUG BACK, give the data on the present productive zone and proposed new productive zone. Describe the blowout prevention program, if any. Use additional sheets if necessary.

Energen Resources proposes to drill a vertical well at the above described location and test the Fruitland Coal formation. A 12-1/4" surface hole will be drilled to ~300'. 8-5/8", 24# casing will be set & cemented to surface w/ 210 sx of Class "B". Will then drill a 7-7/8" hole w/ water & polymer mud system to 150' below base coal (~2500'). 5-1/2", 15.5 # casing will be set and cemented w/ 215 sx of 50/50 poz and 150 sx of Class "B" cement w/ additives (volumes will be calculated to bring cement to surface). After 8-5/8" surface casing is set a 2M (double ram) blowout preventer or annular preventer will be installed & pressure tested to 600 psi. A 2" kill line & 2" line to a choke manifold will also be installed.

The Fruitland Coal formation will then be selectively perforated and fracture stimulated to test for production. If productive, the well will be produced thru 2-3/8" tubing.

<sup>23</sup> I hereby certify that the information given above is true and complete to the best of my knowledge and belief. I further certify that the drilling pit will be constructed according to NMOCDC guidelines ☒ a general permit ☒ or an (attached) alternative OCD-approved plan ☐

Printed name: John C. Thompson

Title: Agent/Engineer

E-mail Address: john@walsheng.net

Date: 11/18/04

Phone: 505-327-4892

OIL CONSERVATION DIVISION

Approved by:

Title: DEPUTY OIL & GAS INSPECTOR, DIST. 05

Approval Date: AUG 24 2004

Expiration Date: AUG 24 2005

Conditions of Approval Attached ☐

District I  
1625 N. French Dr., Hobbs, NM 88240  
District II  
1301 W. Grand Avenue, Artesia, NM 88210  
District III  
1000 Rio Brazos Rd., Aztec, NM 87410  
District IV  
1220 S. St. Francis Dr., Santa Fe, NM 87505

State of New Mexico  
Energy, Minerals & Natural Resources Department  
**OIL CONSERVATION DIVISION**  
1220 South St. Francis Dr.  
Santa Fe, NM 87505

Form C-102  
Revised August 15, 2000  
Submit to Appropriate District Office  
State Lease - 4 Copies  
Fee Lease - 3 Copies

☐ AMENDED REPORT

**WELL LOCATION AND ACREAGE DEDICATION PLAT**

API Number <b>30-045-32536</b>		Pool Code <b>71624</b>	Pool Name <b>Basin Fruitland Coal</b>
Property Code <b>300424</b>	Property Name <b>SANTA ROSA 32</b>		Well Number <b>2</b>
GRID No. <b>162928</b>	Operator Name <b>ENERGEN RESOURCES CORPORATION</b>		Elevation <b>5702</b>

**Surface Location**

UL or lot no.	Section	Township	Range	Lot Idn	Feet from the	North/South line	Feet from the	East/West line	County
0	32	30N	9W		840	South	1855	East	San Juan

**Bottom Hole Location If Different From Surface**

UL or lot no.	Section	Township	Range	Lot Idn	Feet from the	North/South line	Feet from the	East/West line	County

Dedicated Acres <b>320.00</b>	Joint or Infill	Consolidation Code	Order No.
----------------------------------	-----------------	--------------------	-----------

NO ALLOWABLE WILL BE ASSIGNED TO THIS COMPLETION UNTIL ALL INTERESTS HAVE BEEN CONSOLIDATED OR A NON-STANDARD UNIT HAS BEEN APPROVED BY THE DIVISION

	<b>17 OPERATOR CERTIFICATION</b> I hereby certify that the information contained herein is true and complete to the best of my knowledge and belief.  Signature <b>John C. Thompson</b> Printed Name <b>AGENT / Engineer</b> Title <b>8/18/04</b> Date
	<b>18 SURVEYOR CERTIFICATION</b> I hereby certify that the well location shown on this plat was plotted from field notes of actual surveys made by me or under my supervision, and that the same is true and correct to the best of my belief.  Date of Survey <b>09-04</b> Signature of Professional Surveyor <b>William E. Mahlike II</b> Certificate Number <b>8466</b>

ENERGEN RESOURCES CORP.  
 SANTA ROSA 32 #2  
 840' FSL & 1855' FEL  
 Sec. 32, T30N, R9W, NMPM  
 San Juan Co., NM

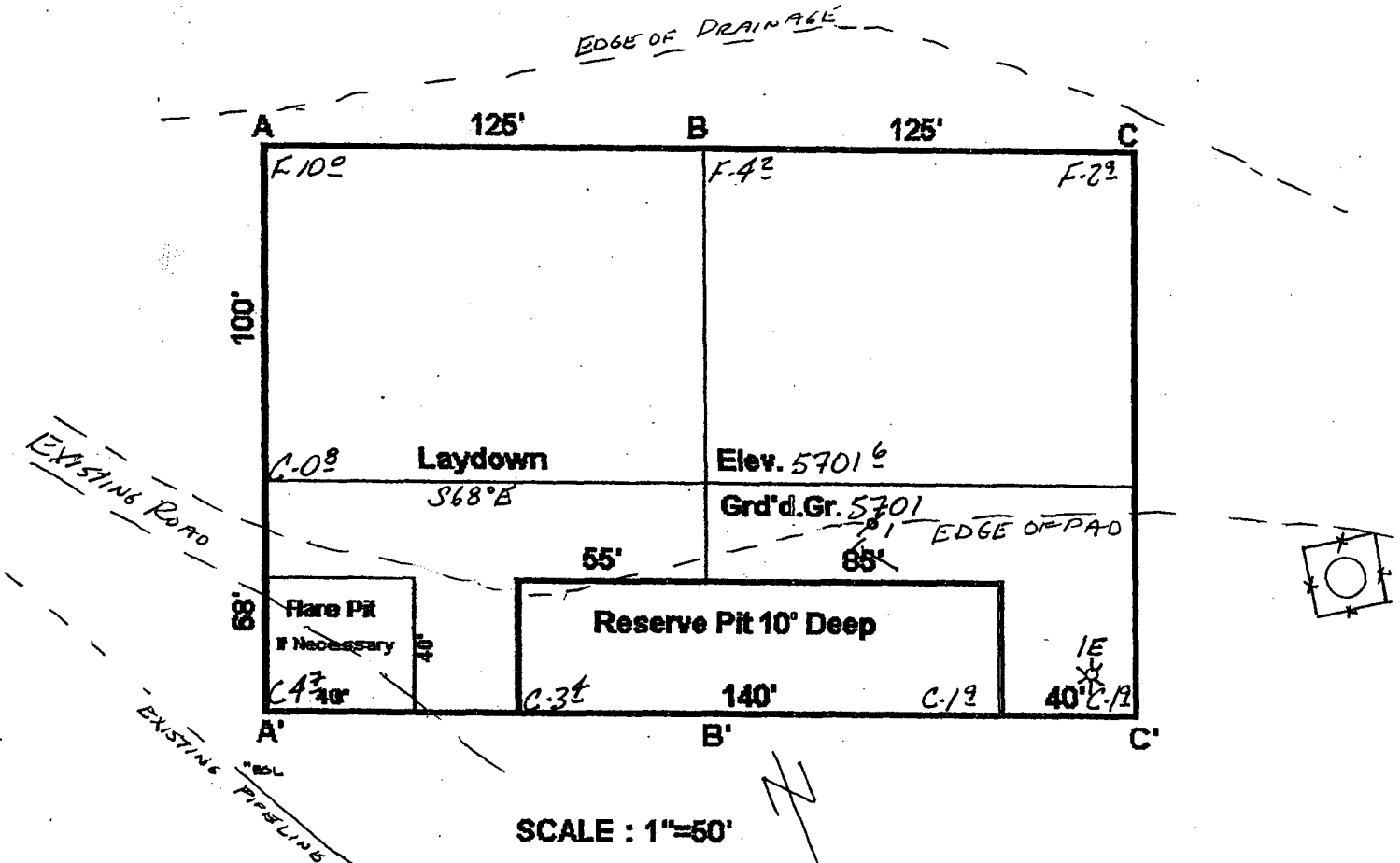

A-A'	Vert: 1"=30'	Horiz: 1"=50'	C/L				
5705							
5695							

B-B'							
5705							
5695							

C-C'							
5705							
5695							