

District I  
1625 N. French Dr., Hobbs, NM 88240  
District II  
1301 W. Grand Ave., Artesia, NM 88210  
District III  
1000 Rio Brazos Rd., Aztec, NM 87410  
District IV  
1220 S. St. Francis Dr., Santa Fe, NM 87505

OIL CONSERVATION DIVISION  
1220 South St. Francis Dr.  
Santa Fe, NM 87505

WELL API NO. 30-045-30536
5. Indicate Type of Lease STATE <input type="checkbox"/> FEE <input type="checkbox"/>
6. State Oil & Gas Lease No. N/A
7. Lease Name or Unit Agreement Name HOLLOWAY
8. Well Number 6-1
9. OGRID Number 025773
10. Pool name or Wildcat West Kutz Gallup

SUNDRY NOTICES AND REPORTS ON WELLS  
(DO NOT USE THIS FORM FOR PROPOSALS TO DRILL OR TO DEEPEN OR PLUG BACK TO A DIFFERENT RESERVOIR. USE "APPLICATION FOR PERMIT" (FORM C-101) FOR SUCH PROPOSALS.)

1. Type of Well: Oil Well <input type="checkbox"/> Gas Well <input checked="" type="checkbox"/> Other
2. Name of Operator Dominion Oklahoma Texas Exploration & Production, Inc.
3. Address of Operator P.O. Box 370, Carlsbad, New Mexico 88221

4. Well Location Unit Letter <u>A</u> : <u>870</u> feet from the <u>North</u> line and <u>1180</u> feet from the <u>East</u> line Section <u>6</u> Township <u>26 N</u> Range <u>11W</u> NMPM County <u>San Juan</u>	11. Elevation (Show whether DR, RKB, RT, GR, etc.) 6145' ungraded
--	--

Pit or Below-grade Tank Application <input checked="" type="checkbox"/> or Closure <input type="checkbox"/>
Pit type <u>dry</u> Depth to Groundwater <u>600'</u> Distance from nearest fresh water well <u>1500'+</u> Distance from nearest surface water <u>5 miles</u>
Pit Liner Thickness: <u>12</u> mil Below-Grade Tank: Volume _____ bbls; Construction Material <u>Sub</u>

12. Check Appropriate Box to Indicate Nature of Notice, Report or Other Data

NOTICE OF INTENTION TO:

PERFORM REMEDIAL WORK <input type="checkbox"/>	PLUG AND ABANDON <input type="checkbox"/>
TEMPORARILY ABANDON <input type="checkbox"/>	CHANGE PLANS <input type="checkbox"/>
PULL OR ALTER CASING <input type="checkbox"/>	MULTIPLE COMPL <input type="checkbox"/>

OTHER: Permit dry pit construction ☒

SUBSEQUENT REPORT OF:

REMEDIAL WORK <input type="checkbox"/>	ALTERING CASING <input type="checkbox"/>
COMMENCE DRILLING OPNS. <input type="checkbox"/>	P AND A <input type="checkbox"/>
CASING/CEMENT JOB <input type="checkbox"/>	

OTHER: ☐

13. Describe proposed or completed operations. (Clearly state all pertinent details, and give pertinent dates, including estimated date of starting any proposed work). SEE RULE 1103. For Multiple Completions: Attach wellbore diagram of proposed completion or recompletion.

Reserve pit shown on attached schematic.



I hereby certify that the information above is true and complete to the best of my knowledge and belief. I further certify that any pit or below-grade tank has been/will be constructed or closed according to NMOCD guidelines ☐, a general permit ☐ or an (attached) alternative OCD-approved plan ☐.

SIGNATURE Gene Simer TITLE District Operations Manager DATE 9-20-04

Type or print name Gene Simer E-mail address: \_\_\_\_\_ Telephone No. (505) 885-1313

For State Use Only

APPROVED BY: Wenny Fort TITLE ASSISTANT OIL & GAS INSPECTOR, DIST. 53 DATE SEP 21 2004

Conditions of Approval (if any): \_\_\_\_\_

# Location Layout for Gary Nail Drilling Rig

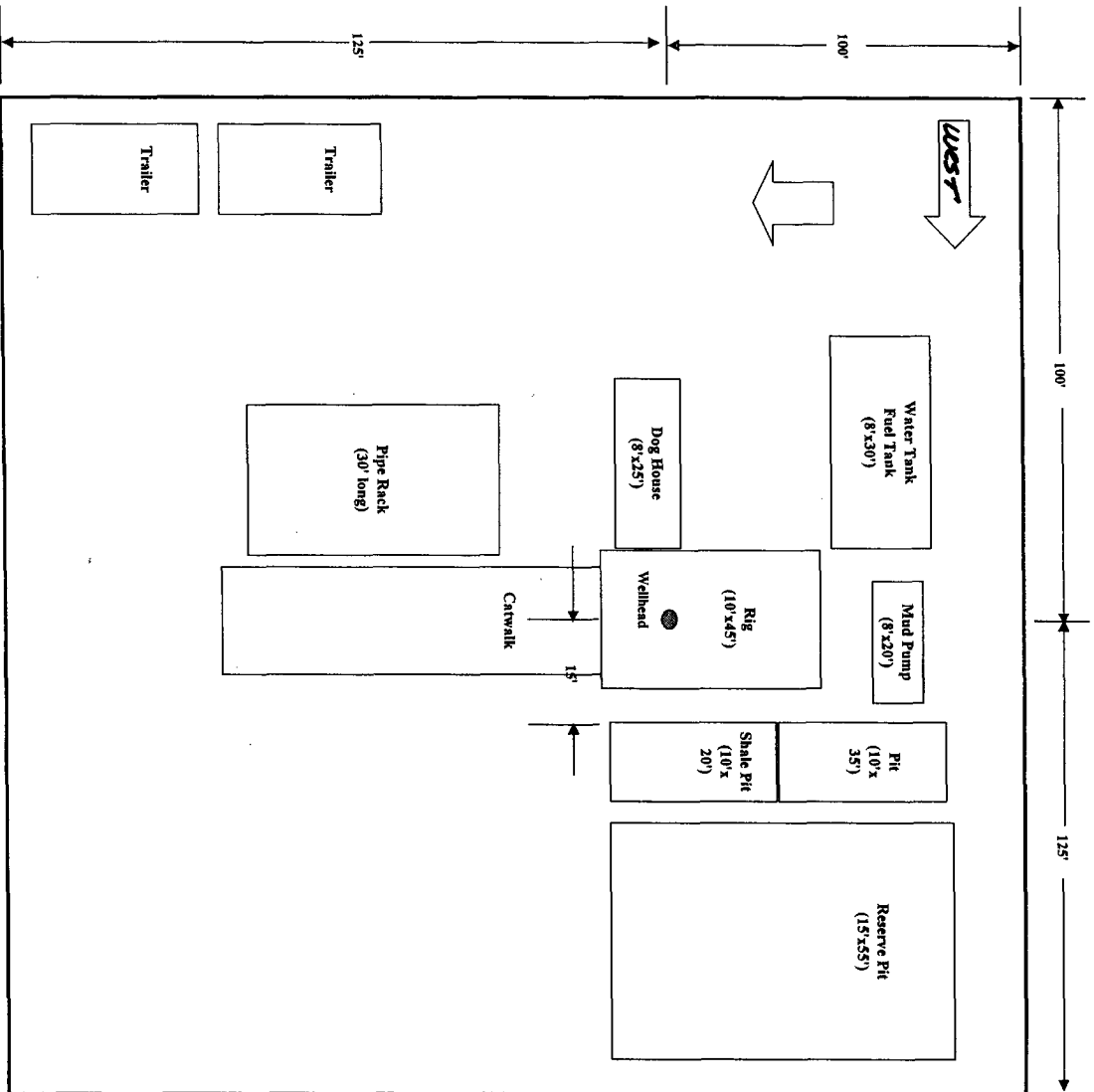

## Wellhead to East Location Boundary

- 15 to shale pit
- 10 shale pit
- 10 between pits
- 15 Reserve Pit
- 10 extra
- 10 extra
- 70 Minimum distance

## Wellhead to South Location Boundary

- 20 Floor & pipe racks
- 35 V-door & catwalk
- 40 Traffic access
- 95 Minimum distance

## Wellhead to West Location Boundary

- 5 Work floor
- 5 rig to water tank
- 30 Water tank
- 50 Access & trailers
- 90 Minimum distance

## Wellhead to North Location Boundary

- 50 Reserve less 5'
- 40 Access to Pit / Water / Fuel tanks
- 90 Minimum distance