

District I  
1625 N. French Dr., Hobbs, NM 88240  
District II  
1301 W. Grand Avenue, Artesia, NM 88210  
District III  
1000 Rio Brazos Road, Aztec, NM 87410  
District IV  
1220 S. St. Francis Dr., Santa Fe, NM 87505

State of New Mexico  
Energy Minerals and Natural Resources

Form C-144  
June 1, 2004

Oil Conservation Division

1220 South St. Francis Dr.  
Santa Fe, NM 87505

For drilling and production facilities, submit to  
appropriate NMOCD District Office.

For downstream facilities, submit to Santa Fe  
office

Pit or Below-Grade Tank Registration or Closure

Is pit or below-grade tank covered by a general plan? Yes ☒ No ☐

Type of action: Registration of a pit or below-grade tank ☐ Closure of a pit or below-grade tank ☒

Operator: BURLINGTON RESOURCES OIL & GAS COMPANY LP Telephone: 505-326-9700 e-mail address: jclark@br-inc.com  
Address: 3401 E. 30TH STREET, FARMINGTON, NM 87402 Formation: \_\_\_\_\_  
Facility or well name: Cain 9E API #: 30-045-23973 U/I or Qtr/Qtr D Sec 16 T 28N R 10W  
County: San Juan, NM Latitude 36.66677 Longitude -107.90704 NAD: 1927 ☒ 1983 ☐ Surface Owner Federal ☐ State ☐ Private ☐ Indian ☐

Pit

Type: Drilling ☐ Production ☐ Disposal ☐  
Workover ☒ Emergency ☐  
Lined ☐ Unlined ☒  
Liner type: Synthetic ☐ Thickness \_\_\_\_\_ mil Clay ☐  
Pit Volume \_\_\_\_\_ bbl

Below-grade tank

Volume: \_\_\_\_\_ bbl Type of fluid: \_\_\_\_\_  
Construction material: \_\_\_\_\_  
Double-walled, with leak detection? Yes ☐ If If not, explain why not.

Depth to ground water (vertical distance from bottom of pit to seasonal high  
water elevation of ground water.)

Less than 50 feet	(20 points)
50 feet or more, but less than 100 feet	(10 points)
100 feet or more	( 0 points)
	0 points

Wellhead protection area: (Less than 200 feet from a private domestic  
water source, or less than 1000 feet from all other water sources.)

Yes	(20 points)
No	( 0 points)
	0 points

Distance to surface water: (horizontal distance to all wetlands, playas,  
irrigation canals, ditches, and perennial and ephemeral watercourses.)

Less than 200 feet	(20 points)
200 feet or more, but less than 1000 feet	(10 points)
1000 feet or more	( 0 points)
	0 points

Ranking Score (Total Points)	0 points
------------------------------	----------

If this is a pit closure: (1) attach a diagram of the facility showing the pit's relationship to other equipment and tanks. (2) Indicate disposal location: (check the onsite box if  
you are burying in place) onsite ☒ offsite ☐ If offsite, name of facility \_\_\_\_\_. (3) Attach a general description of remedial action taken including  
remediation start date and end date. (4) Groundwater encountered: No ☒ Yes ☐ If yes, show depth below ground surface \_\_\_\_\_ ft. and attach sample results. (5)  
Attach soil sample results and a diagram of sample locations and excavations.

Additional Comments:

Approximate Pit Date Closure 8/23/04

See attached for pit footages

I hereby certify that the information above is true and complete to the best of my knowledge and belief. I further certify that the above-described pit or below-grade tank has  
been/will be constructed or closed according to NMOCD guidelines ☐, a general permit ☒, or an (attached) alternative OCD-approved plan ☐.

Date: 9/17/2004

Printed Name/Title Senior Regulatory Specialist

Signature

Joni Clark

Your certification and NMOCD approval of this application/closure does not relieve the operator of liability should the contents of the pit or tank contaminate ground water or  
otherwise endanger public health or the environment. Nor does it relieve the operator of its responsibility for compliance with any other federal, state, or local laws and/or  
regulations.

Approval:

DEPUTY OIL & GAS INSPECTOR, DIST. IV

Printed Name/Title

Signature

Denny Zett

Date:

SEP 20 2004

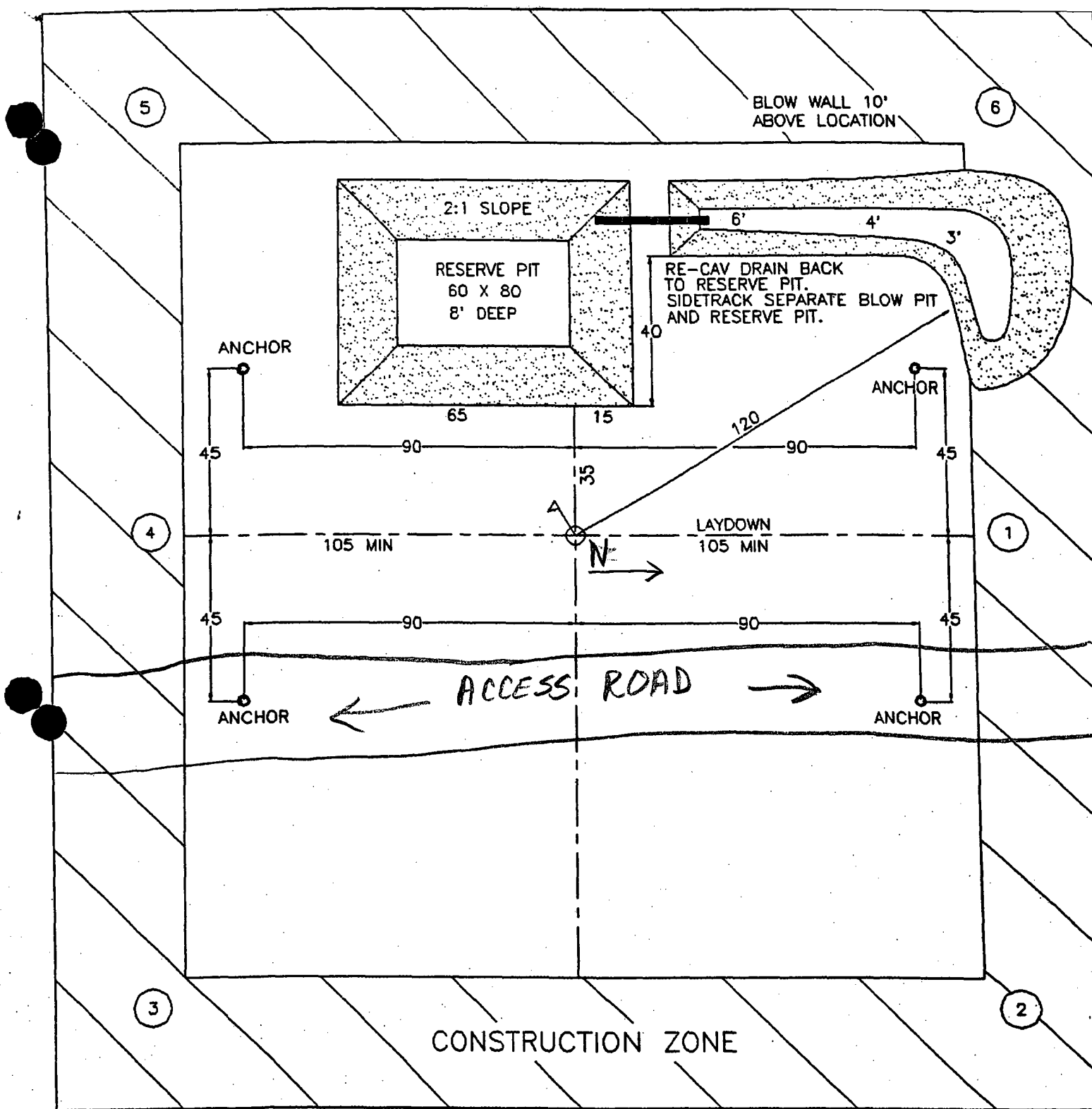

Blow pit overflow dike halfway between top and bottom and extend over plastic liner and into blow pit.

BURLINGTON RESOURCES OIL & GAS COMPANY LP

WORKOVER PIT DIAGRAM