

UNITED STATES
DEPARTMENT OF THE INTERIOR
BUREAU OF LAND MANAGEMENT

APPLICATION FOR PERMIT TO DRILL, DEEPEN, OR PLUG BACK

1a. Type of Work DRILL	2004 AUG 20 RECEIVED OTO FARMING	5. Lease Number SF-078509 Unit Reporting Number
1b. Type of Well GAS		6. If Indian, All. or Tribe
2. Operator BURLINGTON RESOURCES Oil & Gas Company	7. Unit Agreement Name San Juan 32-9 Unit	
3. Address & Phone No. of Operator PO Box 4289, Farmington, NM 87499 (505) 326-9700	8. Farm or Lease Name San Juan 32-9 Unit 9. Well Number #275S	
4. Location of Well 1685' FNL, 805' FWL Latitude 36° 57.4982'N, Longitude 107° 48.5138'	10. Field, Pool, Wildcat Basin Fruitland Coal 11. Sec., Twn, Rge, Mer. (NMPM) W E Sec. 29, T32N, R9W API # 30-045- 32546	
14. Distance in Miles from Nearest Town 18 miles to Aztec	12. County San Juan ✓	13. State NM
15. Distance from Proposed Location to Nearest Property or Lease Line 805'		
16. Acres in Lease	17. Acres Assigned to Well W/2 320.12	
18. Distance from Proposed Location to Nearest Well, Drlg, Compl, or Applied for on this Lease 650'		
19. Proposed Depth 3469'	20. Rotary or Cable Tools Rotary	
21. Elevations (DF, FT, GR, Etc.) 6561' GR	22. Approx. Date Work will Start	
23. Proposed Casing and Cementing Program See Operations Plan attached		
24. Authorized by: <u>Joni Clark</u> Regulatory/Compliance Specialist	Date <u>8/12/04</u>	

PERMIT NO. _____ APPROVAL DATE _____
APPROVED BY [Signature] TITLE Acting AFM DATE 10/28/04

Archaeological Report attached

Threatened and Endangered Species Report attached

NOTE: This format is issued in lieu of U.S. BLM Form 3160-3

Title 18 U.S.C. Section 1001, makes it a crime for any person knowingly and willfully to make to any department or agency of the United States any false, fictitious or fraudulent statements or presentations as to any matter within its jurisdiction.

DRILLING OPERATIONS AUTHORIZED ARE
SUBJECT TO COMPLIANCE WITH ATTACHED
"GENERAL REQUIREMENTS".

NMOCED

This action is subject to technical and
procedural review pursuant to 43 CFR 3165.3
and appeal pursuant to 43 CFR 3165.4

District II
PO Drawer DD, Artesia, NM 88211-0719OIL CONSERVATION DIVISION
PO Box 2088
Santa Fe, NM 87504-2088Instructions on back
Submit to Appropriate District Office
State Lease - 4 Copies
Fee Lease - 3 CopiesDistrict III
1000 Rio Brazos Rd., Aztec, NM 87410District IV
PO Box 2088, Santa Fe, NM 87504-2088☐ AMENDED REPORT

WELL LOCATION AND ACREAGE DEDICATION PLAT

*API Number 30-045-32546		*Pool Code 71629	*Pool Name Basin Fruitland Coal
*Property Code 7473	*Property Name SAN JUAN 32-9 UNIT		*Well Number 2755
*GRID No. 14538	*Operator Name BURLINGTON RESOURCES OIL & GAS COMPANY, LP		*Elevation 6561'

10 Surface Location

UL or lot no.	Section	Township	Range	Lot Idn	Feet from the	North/South line	Feet from the	East/West line	County
E	29	32N	9W		1685	NORTH	805	WEST	SAN JUAN

11 Bottom Hole Location If Different From Surface

UL or lot no.	Section	Township	Range	Lot Idn	Feet from the	North/South line	Feet from the	East/West line	County

12 Dedicated Acres W/2 320.12	13 Joint or Infill	14 Consolidation Code	15 Order No.
----------------------------------	--------------------	-----------------------	--------------

NO ALLOWABLE WILL BE ASSIGNED TO THIS COMPLETION UNTIL ALL INTERESTS HAVE BEEN CONSOLIDATED
OR A NON-STANDARD UNIT HAS BEEN APPROVED BY THE DIVISION

				17 OPERATOR CERTIFICATION I hereby certify that the information contained herein is true and complete to the best of my knowledge and belief. <u>John Clark for Tammy Jones</u> Signature Printed Name Regulatory Specialist Title Date 8/2/04	
LEASE USA SF-078509				18 SURVEYOR CERTIFICATION I hereby certify that the well location shown on this plat was plotted from field notes of actual surveys made by me or under my supervision, and that the same is true and correct to the best of my belief. Date of Survey: MAY 28, 2004 Signature and Seal of Professional Surveyor <u>JASON C. EDWARDS</u> Certificate Number 15269	

Office

District I

1625 N. French Dr., Hobbs, NM 88240

District II

1301 W. Grand Ave., Artesia, NM 88210

District III

1000 Rio Brazos Rd., Aztec, NM 87410

District IV

1220 S. St. Francis Dr., Santa Fe, NM 87505

State of New Mexico

Energy, Minerals and Natural Resources

OIL CONSERVATION DIVISION

1220 South St. Francis Dr.

Santa Fe, NM 87505

Form C-103

March 4, 2004

WELL API NO.

5. Indicate Type of Lease

STATE ☐FEE ☐

6. State Oil & Gas Lease No.

NMSF-078509

7. Lease Name or Unit Agreement Name

San Juan 32-9 Unit

8. Well Number

275S

9. OGRID Number

14538

10. Pool name or Wildcat

Basin Fruitland Coal

SUNDRY NOTICES AND REPORTS ON WELLS
(DO NOT USE THIS FORM FOR PROPOSALS TO DRILL OR TO DEEPEN OR PLUG BACK TO A
DIFFERENT RESERVOIR. USE "APPLICATION FOR PERMIT" (FORM C-101) FOR SUCH
PROPOSALS.)

1. Type of Well:

Oil Well ☐Gas Well ☒

Other

2. Name of Operator

BURLINGTON RESOURCES OIL & GAS COMPANY LP

3. Address of Operator

3401 E. 30TH STREET, FARMINGTON, NM 87402

4. Well Location

Unit Letter E : 1685 feet from the North line and 805 feet from the West lineSection 29Township 32NRange 9W

NMPM

County

San Juan, NM

11. Elevation (Show whether DR, RKB, RT, GR, etc.)

Pit or Below-grade Tank Application (For pit or below-grade tank closures, a form C-144 must be attached)

Pit Location: UL E Sect 29 Twp 32N Rng 9W Pit type New Depth to Groundwater <50' Distance from nearest fresh water well >1000'Distance from nearest surface water >1000' Below-grade Tank Location UL Sect Twp Rng ; feet from the line and feet from the line

12. Check Appropriate Box to Indicate Nature of Notice, Report or Other Data

NOTICE OF INTENTION TO:

PERFORM REMEDIAL WORK ☐ PLUG AND ABANDON ☐TEMPORARILY ABANDON ☐ CHANGE PLANS ☐PULL OR ALTER CASING ☐ MULTIPLE COMPLETION ☐OTHER: New Drill Pit ☒

SUBSEQUENT REPORT OF:

REMEDIAL WORK ☐ ALTERING CASING ☐COMMENCE DRILLING OPNS. ☐ PLUG AND ABANDONMENT ☐CASING TEST AND CEMENT JOB ☐OTHER: ☐

13. Describe proposed or completed operations. (Clearly state all pertinent details, and give pertinent dates, including estimated date of starting any proposed work). SEE RULE 1103. For Multiple Completions: Attach wellbore diagram of proposed completion or recompletion.

Burlington Resources proposes to construct a new drill pit. The new drill pit will be a lined pit as detailed in Burlington's general pit plan dated April 26, 2004 on file at the NMOCD office. Burlington Resources anticipates closing the pit according to the general pit permit on file at the NMOCD office.

I hereby certify that the information above is true and complete to the best of my knowledge and belief. I further certify that any pit or below-grade tank has been/will be constructed or closed according to NMOCD guidelines ☐, a general permit ☒, or an (attached) alternative OCD-approved plan ☐.

SIGNATURE Bruce Clark for TITLE Regulatory Specialist DATE 8/4/2004Type or print name Tammy Jones E-mail address: twimsatt@br-inc.com Telephone No. 326-9700

(This space for State use)

APPROVED BY [Signature] TITLE DEPUTY OIL & GAS INSPECTOR, DIST. IV DATE NOV - 1 2004Conditions of approval, if any: OK. DGC

PLAT #: BURLINGTON RESOURCES OIL & GAS COMPANY, LP
 -SAN JUAN 32-9 UNIT #275S, 1685' FNL & 805' FWL
 SECTION 29, T32N, R9W, NMPM, SAN JUAN COUNTY, NM
 GROUND ELEVATION: 6561' DATE: MAY 28, 2004

LATITUDE: 36°57'30"
LONGITUDE: 107°48'31"
 DATUM: NAD1927

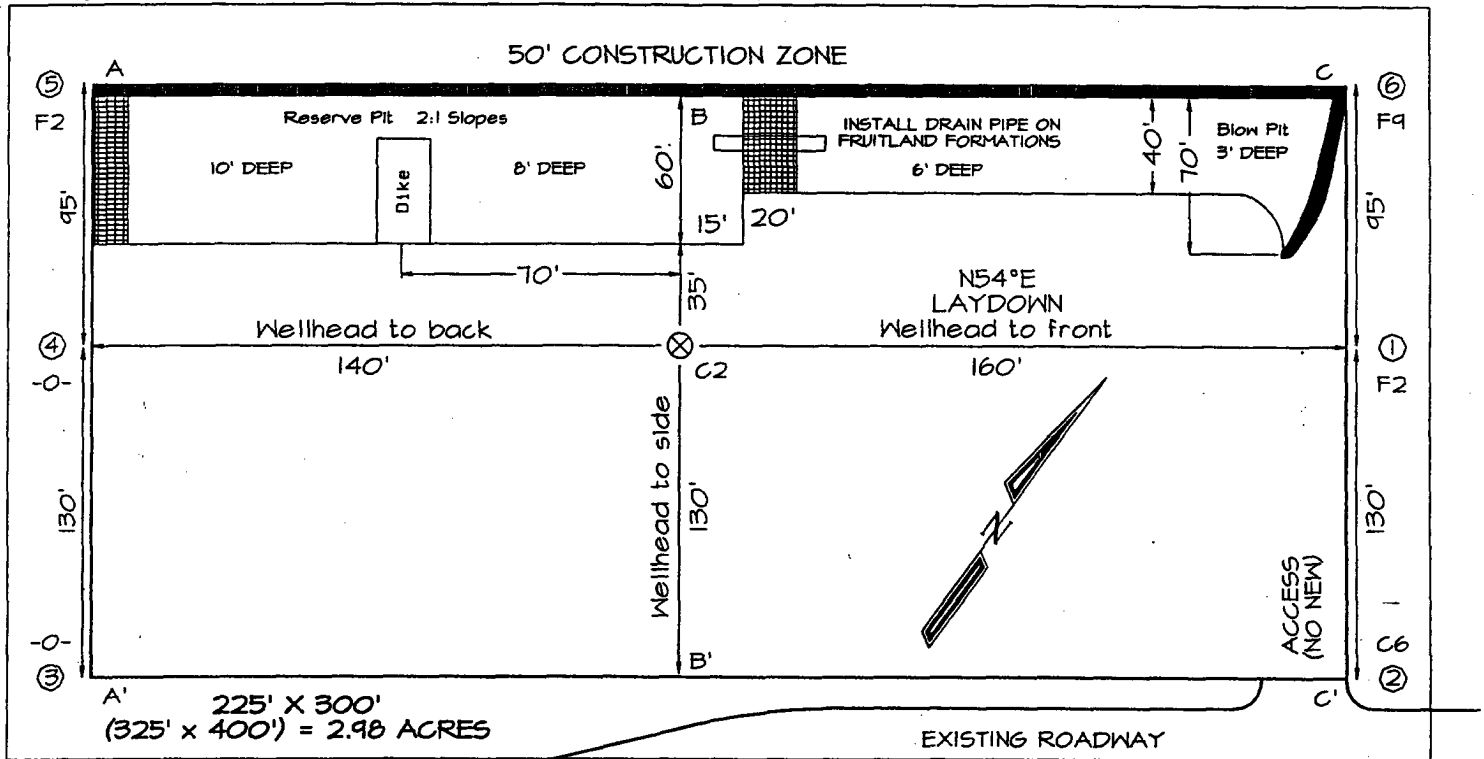

Reserve Pit Dike: to be 8' above Deep side (overflow - 3' wide and 1' above shallow side).
 Blow Pit: overflow pipe halfway between top and bottom and to extend over plastic liner and into blow pit.

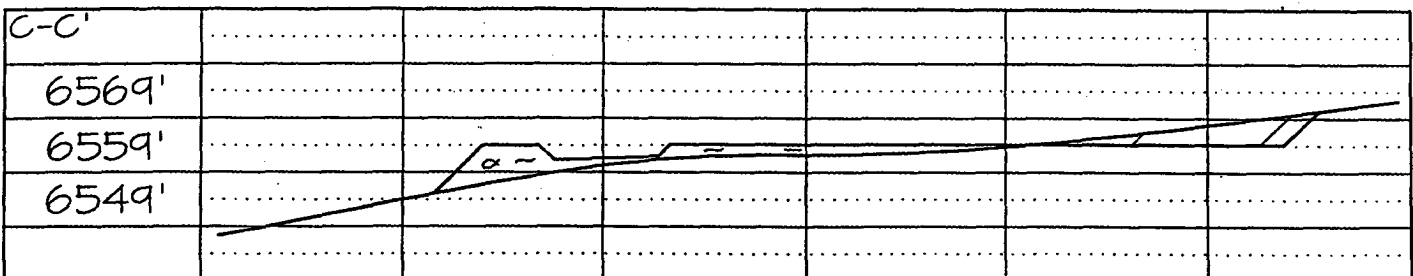
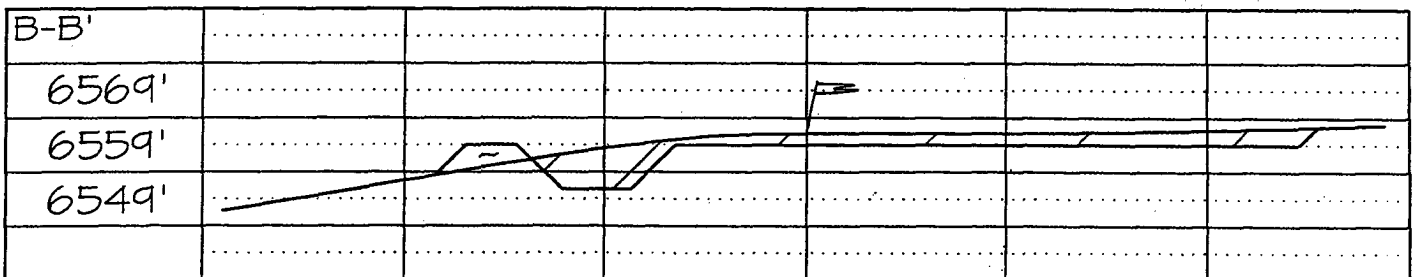
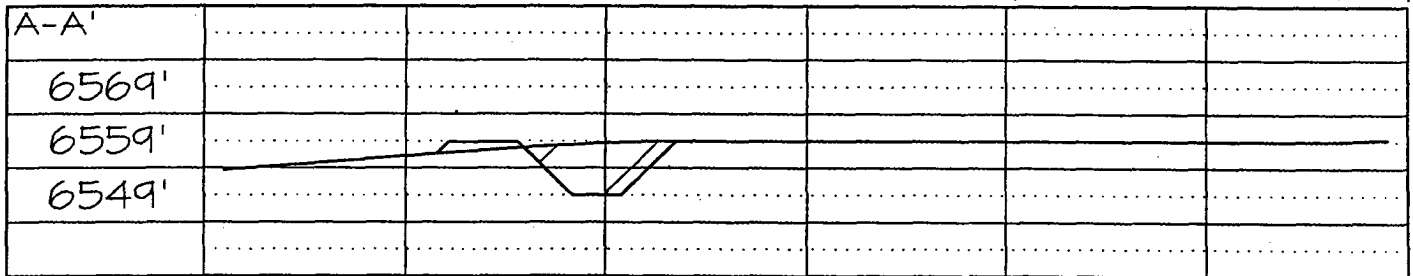

Note: Contractor should call One-Call for location of any marked or unmarked buried pipelines or cables on well pad and/or access road at least two (2) working days prior to construction

UNITED STATES
DEPARTMENT OF THE INTERIOR
BUREAU OF LAND MANAGEMENT

Sundry Notices and Reports on Wells

2007 AUG 24 PM 2 53

1. Type of Well

GAS

RECEIVED

070 FARMINGTON NM

Lease Number

SF-078509

6. If Indian, All. or

Tribe Name

2. Name of Operator

BURLINGTON

RESOURCES OIL & GAS COMPANY

7. Unit Agreement Name

San Juan 32-9 Unit

3. Address & Phone No. of Operator

PO Box 4289, Farmington, NM 87499 (505) 326-9700

8. Well Name & Number

San Juan 32-9 Unit #275S

4. Location of Well, Footage, Sec., T, R, M

1685' FNL, 805' FWL, Sec. 29, T32N, R09W, NMPM

9. API Well No.

30-045- 32544

10. Field and Pool

Basin Fruitland Coal

11. County and State

San Juan Co, NM

12. CHECK APPROPRIATE BOX TO INDICATE NATURE OF NOTICE, REPORT, OTHER DATA

Type of Submission

Type of Action

☐ Notice of Intent☐ Abandonment☐ Change of Plans☒ Subsequent Report☐ Recompletion☐ New Construction☐ Final Abandonment☐ Plugging Back☐ Non-Routine Fracturing☐ Casing Repair☐ Water Shut off☐ Altering Casing☐ Conversion to Injection☒ Other - Sump Request

13. Describe Proposed or Completed Operations

Burlington Resources is requesting a sump on this well.

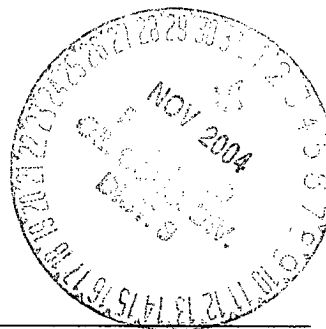

14. I hereby certify that the foregoing is true and correct.

Signed

Joni Clark

Title Regulatory Specialist Date 8/24/04

(This space for Federal or State Office use)

APPROVED BY

Thane Wenzel

Title

Acting AFM

Date

10/28/07

CONDITION OF APPROVAL, if any:

Title 18 U.S.C. Section 1001, makes it a crime for any person knowingly and willfully to make to any department or agency of the United States any false, fictitious or fraudulent statements or representations as to any matter within its jurisdiction.

NMOCD

OPERATIONS PLAN

Well Name: San Juan 32-9 Unit #275S

Location: 1685' FNL, 805' FWL, Sec 29, T-32-N, R-9-W
San Juan County, NM

Latitude 36° 57.4982'N, Longitude 107° 48.5138'W

Formation: Basin Fruitland Coal

Total Depth: 3469'

Logging Program: See San Juan 32-9 Unit Master Operations Plan

Mud Program: See San Juan 32-9 Unit Master Operations Plan

Casing Program (as listed, the equivalent, or better):

Hole Size	Depth Interval	Csg	Wt.	Grade	Cement	
12 1/4	0' - 300	9.625"	32.3#	H-40	282	cu.ft
8 3/4	0' - 3082	7"	20.0#	J-55	680	cu.ft
6 1/4	3042 - 3469'	5 1/2"	15.5#	J-55	0	cu.ft

Tubing Program: See San Juan 32-9 Unit Master Operations Plan

- * The Fruitland Coal formation will be completed.
- * The west half of Section 29 is dedicated to the Fruitland Coal formation in this well.
- * Gas is dedicated.

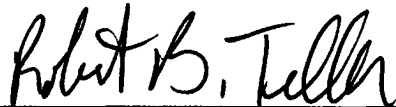

Drilling Engineer

8-19-04

Date

BURLINGTON RESOURCES

SAN JUAN DIVISION

October 11, 2004

(Certified Mail – Return Receipt Requested)

Re: San Juan 32-9 Unit #275S
Basin Fruitland Coal
1685'FNL, 805'FWL Section 29, T-32-N, R-9-W
San Juan County, New Mexico

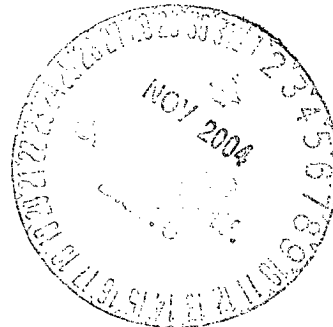

To the Affected Persons:

Burlington Resources Oil & Gas Company LP is submitting the enclosed Application for Permit to Drill to the appropriate regulatory agency(s) for approval. This well is located inside the High Productivity Area of the Basin-Fruitland Coal Pool as indicated on the attached plat. Notice is being made pursuant to New Mexico Oil Conservation Commission Order R-8768-F dated July 17, 2003.

The affected parties have twenty (20) days from receipt of this notice in which to file with the District Office of the New Mexico Oil Conservation Division written objection to the proposed Application for Permit to Drill.

Sincerely,

A handwritten signature in cursive script that reads "Tammy Jones".

Tammy Jones
Regulatory Specialist

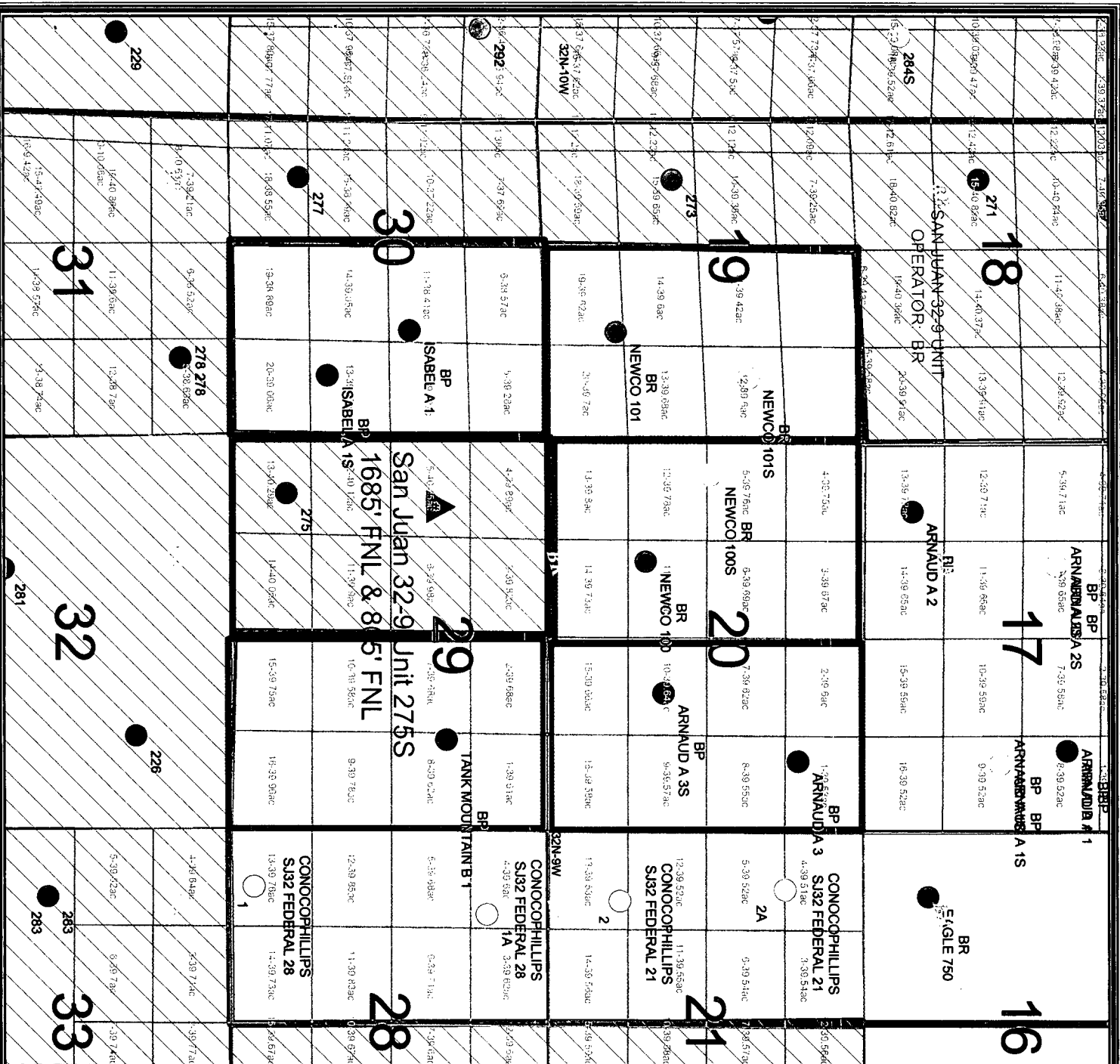

Legend

Current Operator

● BP AMERICA

● BURLINGTON

○ CONOCOPHILLIPS

▨ pa-fruitleland

▨ SJD New Mexico Lots

▨ Sections_(SJD)

▨ Townships_(SJD)

▨ San Juan Federal Units

▨ PROPOSED WELL

▨ OFFSET OPERATOR:

1. Burlington 100% GWI

2. BP America

BURLINGTON
RESOURCES



0 700 1400 2100 2800 3500
1:29,179 1" equals 2,432'
Fee

BURLINGTON RESOURCES

San Juan

San Juan 32-9 Unit 275S FTC - HPA

Sec 29 T32N R9W
San Juan County, NM

Prepared By: DMM Date: 10/5/2004
File Number: Revised Date: 10/5/2004
File Name: C:\platt\m1\Projects\HPA S132-9 Unit 275S.mxd

2. Article Number  7110 6605 9590 0009 7472 1. Article Addressed to: JOHN S BROWN JR 7301 BURNET RD STE 102-122 AUSTIN, TX 78757-2248 10/7/2004 3:24 PM Code: SJ32-9 Unit 2705, 2735, 2745, 2755, 2765, 2865 <i>FTC/HPA</i>	COMPLETE THIS SECTION ON DELIVERY A. Signature <input checked="" type="checkbox"/> Agent <input type="checkbox"/> Addressee <i>Earl Brown</i> B. Received by (Printed Name) <i>Earl Brown</i> C. Date of Delivery D. Is delivery address different from item 1? <input type="checkbox"/> Yes If YES enter delivery address below: <input type="checkbox"/> No 3. Service Type <input checked="" type="checkbox"/> Certified 4. Restricted Delivery? (Extra Fee) <input type="checkbox"/> Yes
--	---

PS Form 3811

Domestic Return Receipt

2. Article Number  7110 6605 9590 0009 7465 1. Article Addressed to: FOUR STAR OIL & GAS COMPANY ATTN BARBARA NELMS PO BOX 36366 HOUSTON, TX 77236 10/7/2004 3:24 PM Code: SJ32-9 Unit 2705, 2735, 2745, 2755, 2765, 2865 <i>FTC/HPA</i>	COMPLETE THIS SECTION ON DELIVERY A. Signature <input type="checkbox"/> Agent <input type="checkbox"/> Addressee <i>Barbara Nelms</i> B. Received by (Printed Name) C. Date of Delivery D. Is delivery address different from item 1? <input type="checkbox"/> Yes If YES enter delivery address below: <input type="checkbox"/> No 3. Service Type <input checked="" type="checkbox"/> Certified 4. Restricted Delivery? (Extra Fee) <input type="checkbox"/> Yes
--	--

PS Form 3811

Domestic Return Receipt

2. Article Number  7110 6605 9590 0009 7502 1. Article Addressed to: T H MCELVAIN OIL & GAS LTD PARTNERSHIP 1050 17TH ST STE 1800 DENVER, CO 80265 10/7/2004 3:24 PM Code: SJ32-9 Unit 2705, 2735, 2745, 2755, 2765, 2865 <i>FTC/HPA</i>	COMPLETE THIS SECTION ON DELIVERY A. Signature <input type="checkbox"/> Agent <input type="checkbox"/> Addressee <i>M. Johnson</i> B. Received by (Printed Name) C. Date of Delivery <i>10/28/04</i> D. Is delivery address different from item 1? <input type="checkbox"/> Yes If YES enter delivery address below: <input type="checkbox"/> No 3. Service Type <input checked="" type="checkbox"/> Certified 4. Restricted Delivery? (Extra Fee) <input type="checkbox"/> Yes
--	--

PS Form 3811

Domestic Return Receipt

2. Article Number  7110 6605 9590 0009 7434		COMPLETE THIS SECTION ON DELIVERY A. Signature X <i>[Signature]</i> <input type="checkbox"/> Agent <input type="checkbox"/> Addressee B. Received by (Printed Name) <i>[Signature]</i> C. Date of Delivery D. Is delivery address different from item 1? <input type="checkbox"/> Yes If YES enter delivery address below: <input type="checkbox"/> No	
1. Article Addressed to: BP AMERICA PRODUCTION COMPANY ATTN BRYAN ANDERSON OSO ENGINEER SAN JUAN BU WEST LAKE 1 ROOM 19-114 501 WESTLAKE PARK BLVD HOUSTON, TX 77079 10/7/2004 3:24 PM		3. Service Type <input checked="" type="checkbox"/> Certified 4. Restricted Delivery? (Extra Fee) <input type="checkbox"/> Yes	
Code: SJ32-9 Unit 2705, 2735, 2745, 2755, 2765, 2865 FTC/HPA			

PS Form 3811

Domestic Return Receipt

2. Article Number  7110 6605 9590 0009 7489		COMPLETE THIS SECTION ON DELIVERY A. Signature X <i>[Signature]</i> <input checked="" type="checkbox"/> Agent <input type="checkbox"/> Addressee B. Received by (Printed Name) <i>[Signature]</i> C. Date of Delivery <i>[Signature]</i> D. Is delivery address different from item 1? <input type="checkbox"/> Yes If YES enter delivery address below: <input checked="" type="checkbox"/> No	
1. Article Addressed to: JRP SAN JUAN LP ATTN JAMES M RAYMOND MGR PO BOX 291445 KERRVILLE, TX 78029-1445 10/7/2004 3:24 PM		3. Service Type <input checked="" type="checkbox"/> Certified 4. Restricted Delivery? (Extra Fee) <input type="checkbox"/> Yes	
Code: SJ32-9 Unit 2705, 2735, 2745, 2755, 2765, 2865 FTC/HPA			

PS Form 3811

Domestic Return Receipt

2. Article Number  7110 6605 9590 0009 7496		COMPLETE THIS SECTION ON DELIVERY A. Signature X <i>[Signature]</i> <input type="checkbox"/> Agent <input type="checkbox"/> Addressee B. Received by (Printed Name) <i>[Signature]</i> C. Date of Delivery <i>[Signature]</i> D. Is delivery address different from item 1? <input type="checkbox"/> Yes If YES enter delivery address below: <input type="checkbox"/> No	
1. Article Addressed to: PHILLIPS-SAN JUAN PARTNERS C/O CONOCOPHILLIPS ATTN CHIEF LANDMAN SAN JUAN/ROCKIES PO BOX 2197 HOUSTON, TX 77252-2197 10/7/2004 3:24 PM		3. Service Type <input checked="" type="checkbox"/> Certified 4. Restricted Delivery? (Extra Fee) <input type="checkbox"/> Yes	
Code: SJ32-9 Unit 2705, 2735, 2745, 2755, 2765, 2865 FTC/HPA			

PS Form 3811

Domestic Return Receipt

2. Article Number



7110 6605 9590 0009 7526

1. Article Addressed to:

Peoples Energy Prod-TX L.P.
909 Fanin, Ste 1300
Houston, TX 77010

10/7/2004 3:30 PM

Code: SJ 32-9 Unit FTC - HPA

2545

COMPLETE THIS SECTION ON DELIVERY

A. Signature

X

☒ Agent
☒ Addressee

B. Received by (Printed Name)

Danielle Marthelichini

C. Date of Delivery

OCT 18 2004

D. Is delivery address different from item 1? ☐ Yes

If YES enter delivery address below:

☐ No

3. Service Type



Certified

4. Restricted Delivery? (Extra Fee)



Yes

PS Form 3811

Domestic Return Receipt

2. Article Number



7110 6605 9590 0009 7441

1. Article Addressed to:

CONOCOPHILLIPS COMPANY
ATTN CHIEF LANDMAN SAN JUAN/ROCKIES
PO BOX 2197

HOUSTON, TX 77252-2197

10/7/2004 3:24 PM

Code: SJ32-9 Unit 2705, 2735, 2745, 2755, 2765, 2865

FTC/HPA

COMPLETE THIS SECTION ON DELIVERY

A. Signature

X

☐ Agent
☒ Addressee

B. Received by (Printed Name)

DAVID DAVIS

C. Date of Delivery

OCT 18 2004

D. Is delivery address different from item 1? ☐ Yes

If YES enter delivery address below:

☐ No

3. Service Type



Certified

4. Restricted Delivery? (Extra Fee)



Yes

PS Form 3811

Domestic Return Receipt

7110 6605 9590 0009 7519

RETURN RECEIPT SERVICE	RESTRICTED DELIVERY FEE	\$0.37
	CERTIFIED FEE	\$0.00
	RETURN RECEIPT FEE	\$2.10
	TOTAL POSTAGE AND FEE'S	\$1.75
SENT TO:		\$4.22

Code: SJ32-9 Unit 270

WILLIAMS PRODUCTION COMPANY
ONE WILLIAMS CENTER
PO BOX 3102 MS25-3

TULSA, OK 74101

PS FORM 3800 7/2004 3:24 PM



RECEIPT FOR CERTIFIED MAIL
NO INSURANCE COVERAGE PROVIDED
NOT FOR INTERNATIONAL MAIL
(SEE OTHER SIDE)

7110 6605 9590 0009 7458

RETURN RECEIPT SERVICE	POSTAGE		POSTMARK OR DATE
	RESTRICTED DELIVERY FEE	\$0.37	
	CERTIFIED FEE	\$0.00	
	RETURN RECEIPT FEE	\$2.10	
SENT TO:	TOTAL POSTAGE AND FEE'S	\$1.75	
		\$4.22	

Code: SJ32-9 Unit 270

DEVON ENERGY PRODUCTION CO LP
ATTN LAND DEPT
20 N BROADWAY STE 1500

OKLAHOMA CITY, OK 73102

PS FORM 3800 7/2004 3:24 PM



RECEIPT FOR CERTIFIED MAIL
NO INSURANCE COVERAGE PROVIDED
NOT FOR INTERNATIONAL MAIL
(SEE OTHER SIDE)

7110 6605 9590 0009 7427

RETURN RECEIPT SERVICE	POSTAGE		POSTMARK OR DATE
	RESTRICTED DELIVERY FEE	\$0.37	
	CERTIFIED FEE	\$0.00	
	RETURN RECEIPT FEE	\$2.10	
SENT TO:	TOTAL POSTAGE AND FEE'S	\$1.75	
		\$4.22	

Code: SJ32-9 Unit 270

BOLACK MINERALS CO
ATTN TOMMY BOLACK
3901 BLOOMFIELD HWY
RT 3 BOX 47
FARMINGTON, NM 87401

PS FORM 3800 7/2004 3:24 PM



RECEIPT FOR CERTIFIED MAIL
NO INSURANCE COVERAGE PROVIDED
NOT FOR INTERNATIONAL MAIL
(SEE OTHER SIDE)

PROPOSED PIPELINE ROUTE

BURLINGTON RESOURCES OIL & GAS SAN JUAN 32-9 UNIT #2755

1685' FNL & 805' FWL, SECTION 29, T32N, R9W, N.M.P.M.
SAN JUAN COUNTY, NEW MEXICO

SURVEY FOLLOWS EXISTING ROAD AND BP AMERICA PIPELINE
AND TIES-IN TO AN EXISTING BURLINGTON RESOURCES PIPELINE
LOCATED IN THE SW/4 OF THE SW/4 OF SECTION 29, T32N, R9W

TOTAL FOOTAGE 4259.1'
Bureau of Land Management

Ice Spring

Tank