

Submit 3 Copies To Appropriate District
Office
District I
1625 N. French Dr., Hobbs, NM 88240
District II
1301 W. Grand Ave., Artesia, NM 88210
District III
1000 Rio Brazos Rd., Aztec, NM 87410
District IV
1220 S. St. Francis Dr., Santa Fe, NM
87505

State of New Mexico
Energy, Minerals and Natural Resources

Form C-103
March 4, 2004

OIL CONSERVATION DIVISION
1220 South St. Francis Dr.
Santa Fe, NM 87505

WELL API NO. 30-045-32441
5. Indicate Type of Lease STATE <input type="checkbox"/> FEE <input type="checkbox"/>
6. State Oil & Gas Lease No.
7. Lease Name or Unit Agreement Name Blanco A (Federal well NMNM 012201)
8. Well Number 1 M
9. OGRID Number 000778
10. Pool name or Wildcat Basin Dk & Blanco MV

SUNDRY NOTICES AND REPORTS ON WELLS
(DO NOT USE THIS FORM FOR PROPOSALS TO DRILL OR TO DEEPEN OR PLUG BACK TO A
DIFFERENT RESERVOIR. USE "APPLICATION FOR PERMIT" (FORM C-101) FOR SUCH
PROPOSALS.)

1. Type of Well:
Oil Well ☐ Gas Well ☒ Other ☐

2. Name of Operator
BP AMERICA PRODUCTION CO

3. Address of Operator
P.O. BOX 3092 HOUSTON, TX 77079-2064

4. Well Location

Unit Letter **G** : **1785** feet from the **North** line and **1490** feet from the **EAST** line

Section **36** Township **28N** Range **08W** NMPM **SAN JUAN** County

11. Elevation (Show whether DR, RKB, RT, GR, etc.)
6218' GR

Pit or Below-grade Tank Application (For pit or below-grade tank closures, a form C-144 must be attached)

Pit Location: UL **G** Sect **36** Twp **28N** Rng **08W** Pit type **Drilling** Depth to Groundwater **>100'** Distance from nearest fresh water well **>1000'**

Distance from nearest surface water **>1000'** Below-grade Tank Location UL **G** Sect **36** Twp **28N** Rng **08W** ;

1750' feet from the **North** line and **1475** feet from the **EAST** line **PLEASE SEE ATTACHED PAD LAYOUT**

12. Check Appropriate Box to Indicate Nature of Notice, Report or Other Data

NOTICE OF INTENTION TO:

PERFORM REMEDIAL WORK ☐ PLUG AND ABANDON ☐

TEMPORARILY ABANDON ☐ CHANGE PLANS ☐

PULL OR ALTER CASING ☐ MULTIPLE COMPLETION ☐

OTHER: **UNDED DRILLING PIT PERMIT** ☒

SUBSEQUENT REPORT OF:

REMEDIAL WORK ☐ ALTERING CASING ☐

COMMENCE DRILLING OPNS. ☐ PLUG AND ABANDONMENT ☐

CASING TEST AND CEMENT JOB ☐

OTHER: ☐

13. Describe proposed or completed operations. (Clearly state all pertinent details, and give pertinent dates, including estimated date of starting any proposed work). SEE RULE 1103. For Multiple Completions: Attach wellbore diagram of proposed completion or recompletion.

Please reference BP America's San Juan Basin Drilling/Workover Pit Construction Plan on file with the NMOCD. Drilling pit Construction Plan issued date of **04/15/2004**. Pit will be closed according to closure plan on file.

11/17/04

I hereby certify that the information above is true and complete to the best of my knowledge and belief. I further certify that any pit or below-grade tank has been/will be constructed or closed according to NMOCD guidelines ☐, a general permit ☐ or an (attached) alternative OCD-approved plan ☐.

SIGNATURE Cherry Hlava TITLE Regulatory Analyst DATE 11/20/04

Type or print name Cherry Hlava E-mail address: _____ Telephone No. 281-366-4081

(This space for State use)

APPROVED BY Serry Pent TITLE DEPUTY OIL & GAS INSPECTOR, DIST. IV DATE DEC 3 2004
Conditions of approval, if any: _____

PAD LAYOUT PLAN & PROFILE
BP AMERICA PRODUCTION COMPANY

Blanco A #1M
 1785' 1755' F/NL 1480' F/EL 1490' FEL
 SEC. 36, T28N, R8W, N.M.P.M.
 SAN JUAN COUNTY, NEW MEXICO

Lat: 36°37'13"
 Long: 107°37'42"

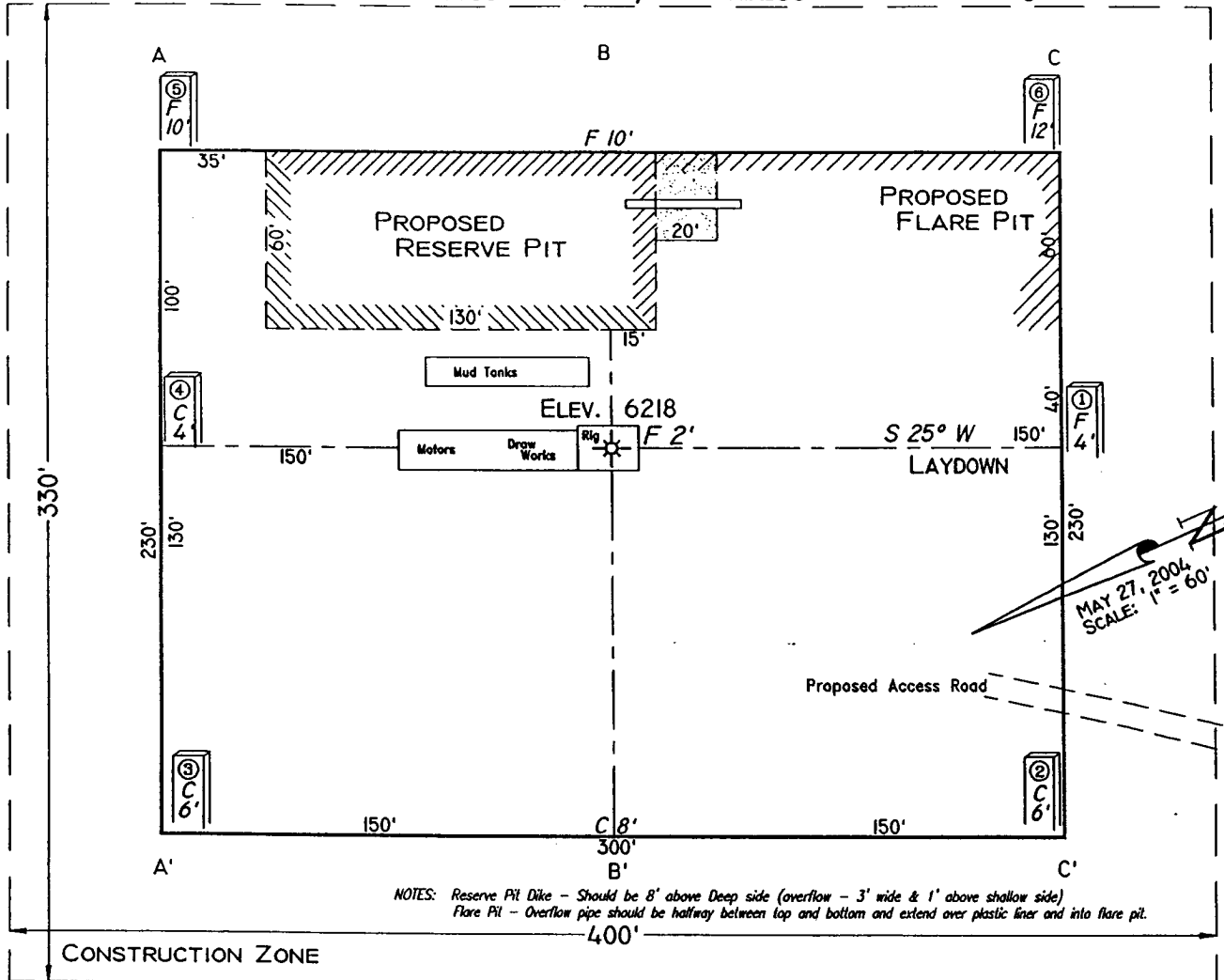

NOTES: Reserve Pit Dike - Should be 8' above Deep side (overflow - 3' wide & 1' above shallow side)
 Flare Pit - Overflow pipe should be halfway between top and bottom and extend over plastic liner and into flare pit.

Area of Construction Zone - 330'x400' or 3.03 acres, more or less.

SCALE: 1"=60'-HORIZ.
 1"=40'-VERT.

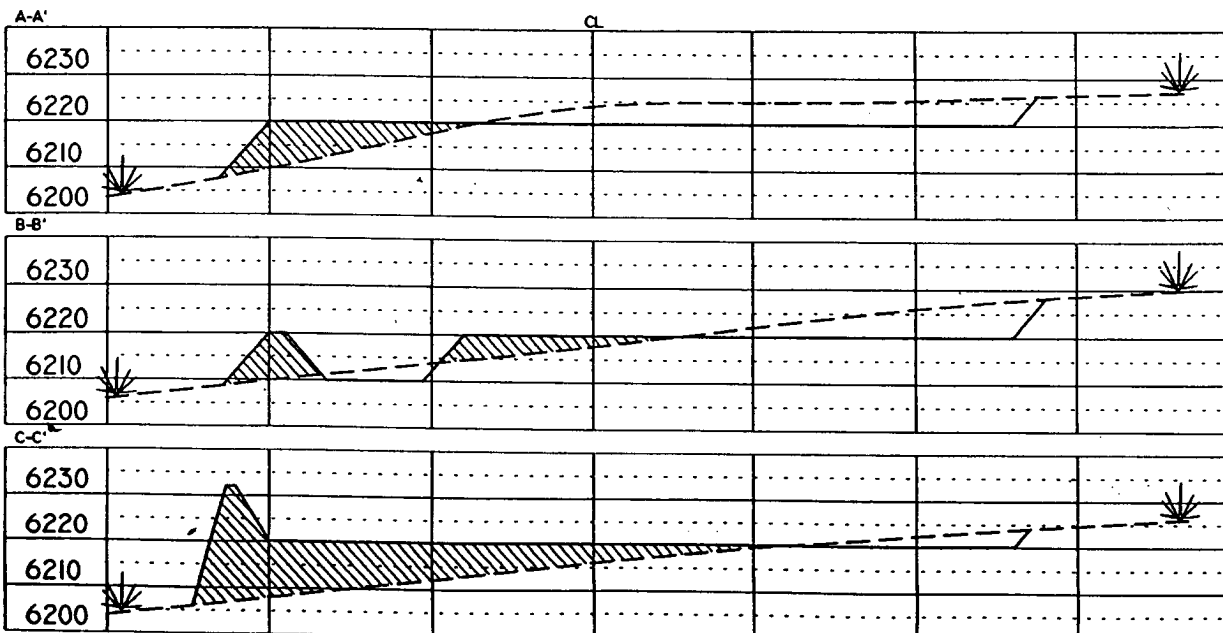

NOTE: Contractor should call One-Call for location of any marked or unmarked buried pipelines or cables on well pad and/or access road at least two (2) working days prior to construction.

Cuts and fills shown are approximate - final finished elevation is to be adjusted so earthwork will balance. Corner stakes are approximate and do not include additional areas needed for sideslopes and drainages. Final Pad Dimensions are to be verified by Contractor.

VANN SURVEYS
 P. O. Box 1306
 Farmington, NM