

Submit 3 Copies To Appropriate District Office
District I
1625 N. French Dr., Hobbs, NM 88240
District II
1301 W. Grand Ave., Artesia, NM 88210
District III
1000 Rio Brazos Rd., Aztec, NM 87410
District IV
1220 S. St. Francis Dr., Santa Fe, NM 87505

State of New Mexico
Energy, Minerals and Natural Resources

Form C-103
May 27, 2004

OIL CONSERVATION DIVISION

1220 South St. Francis Dr.
Santa Fe, NM 87505

WELL API NO.
30-039-22672

5. Indicate Type of Lease
STATE ☐ FEE ☐

6. State Oil & Gas Lease No.
AC-69

7. Lease Name or Unit Agreement Name
APACHE FEDERAL

8. Well Number #13E

9. OGRID Number
167067

10. Pool name : BASIN DAKOTA /
BALLARD PICTURED CLIFFS

SUNDRY NOTICES AND REPORTS ON WELLS

(DO NOT USE THIS FORM FOR PROPOSALS TO DRILL OR TO DEEPEN OR PLUG BACK TO DIFFERENT RESERVOIR. USE "APPLICATION FOR PERMIT" (FORM C-101) FOR SUCH PROPOSALS.)

1. Type of Well: Oil Well ☐ Gas Well ☒ Other

2. Name of Operator

XTO ENERGY INC.

3. Address of Operator

2700 FARMINGTON AVE, SUITE K-1, FARMINGTON, NM 87401

4. Well Location

Unit Letter K : 1650 feet from the SOUTH line and 1650 feet from the WEST line
Section 7 Township 24N Range 5W NMPM County RIO ARRIBA

11. Elevation (Show whether DR, RKB, RT, GR, etc.)
6,469' GL

Pit or Below-grade Tank Application ☐ or Closure ☐

Pit type _____ Depth to Groundwater _____ Distance from nearest fresh water well _____ Distance from nearest surface water _____

Pit Liner Thickness: _____ mil Below-Grade Tank: Volume _____ bbls; Construction Material _____

12. Check Appropriate Box to Indicate Nature of Notice, Report or Other Data

NOTICE OF INTENTION TO:

PERFORM REMEDIAL WORK ☐ PLUG AND ABANDON ☐
TEMPORARILY ABANDON ☐ CHANGE PLANS ☐
PULL OR ALTER CASING ☐ MULTIPLE COMPL ☐

OTHER: DOWNHOLE COMMINGLE ☒

SUBSEQUENT REPORT OF:

REMEDIAL WORK ☐ ALTERING CASING ☐
COMMENCE DRILLING OPNS. ☐ P AND A ☐
CASING/CEMENT JOB ☐

OTHER: ☐

13. Describe proposed or completed operations. (Clearly state all pertinent details, and give pertinent dates, including estimated date of starting any proposed work). SEE RULE 1103. For Multiple Completions: Attach wellbore diagram of proposed completion or recompletion.

XTO Energy Inc. requests approval for an exception to Rule 303-C to permit downhole commingling of production from the Ballard Pictured Cliffs (71439) and the Basin Dakota (71599) pools in the apache Federal #13E. XTO is currently recompleting this well in the PC and the DK is producing. XTO will downhole commingle these pools upon completion of the Pictured Cliffs. Both zones are included in the pre-approved pools established by Division Order R-11363. Based on production analysis of wells located in a nine section surrounding area the following allocation was determined:

Basin Dakota	Oil 100%	Gas 74%
Ballard Pictured Cliffs	Oil 0%	Gas 26%

Both pools have common interest owners. Commingling both zones will not reduce the ultimate recovery of either pool. Downhole commingling will improve recovery of liquids, eliminate redundant surface equipment and maximize productivity. BLM has been notified of intent to DHC with filing of Form 3160-5.

DHC 1749AZ

I hereby certify that the information above is true and complete to the best of my knowledge and belief. I further certify that any pit or below-grade tank has been/will be constructed or closed according to NMOCD guidelines ☐, a general permit ☐ or an (attached) alternative OCD-approved plan ☐.

SIGNATURE Kelly K. Small TITLE REGULATORY COMPLIANCE TECH DATE 01/11/05
Type or print name Kelly K. Small E-mail address: kelly_small@xtoenergy.com Telephone No. 505-324-1090

For State Use Only

APPROVED BY: [Signature] TITLE DEPUTY OIL & GAS INSPECTOR, DIST. 3 DATE JAN 12 2005
Conditions of Approval (if any):

District I
1625 N. French Dr., Hobbs, NM 88240
District II
811 South First, Artesia, NM 88210
District III
1000 Rio Brazos Rd., Aztec, NM 87410
District IV
1220 S. St. Francis Dr., Santa Fe, NM 87505

State of New Mexico
Energy, Minerals & Natural Resources Department

Form C-102
Revised August 15, 2000

OIL CONSERVATION DIVISION
1220 South St. Francis Dr.
Santa Fe, NM 87505

Submit to Appropriate District Office
State Lease - 4 Copies
Fee Lease - 3 Copies

WELL LOCATION AND ACREAGE DEDICATION PLAT



AMENDED
REPORT

¹ API Number 30-039-22672		² Pool Code 71439	³ Pool Name BALLARD PICTURED CLIFFS
⁴ Property Code	⁵ Property Name APACHE FEDERAL		⁶ Well Number 13E
⁷ OGRID No. 167067	⁸ Operator Name XTO Energy. Inc.		⁹ Elevation 6,469' GL

¹⁰ Surface Location

UL or lot no.	Section	Township	Range	Lot Idn	Feet from the	North/South line	Feet from the	East/West line	County
K	07	24N	05W		1,650'	SOUTH	1,650'	WEST	RIO ARRIBA

¹¹ Bottom Hole Location If Different From Surface

UL or lot no.	Section	Township	Range	Lot Idn	Feet from the	North/South line	Feet from the	East/West line	County
---------------	---------	----------	-------	---------	---------------	------------------	---------------	----------------	--------

¹² Dedicated Acres SW/4 160	¹³ Joint or Infill	¹⁴ Consolidation Code	¹⁵ Order No.
--	-------------------------------	----------------------------------	-------------------------

NO ALLOWABLE WILL BE ASSIGNED TO THIS COMPLETION UNTIL ALL INTERESTS HAVE BEEN CONSOLIDATED OR A NON-STANDARD UNIT HAS BEEN APPROVED BY THE DIVISION

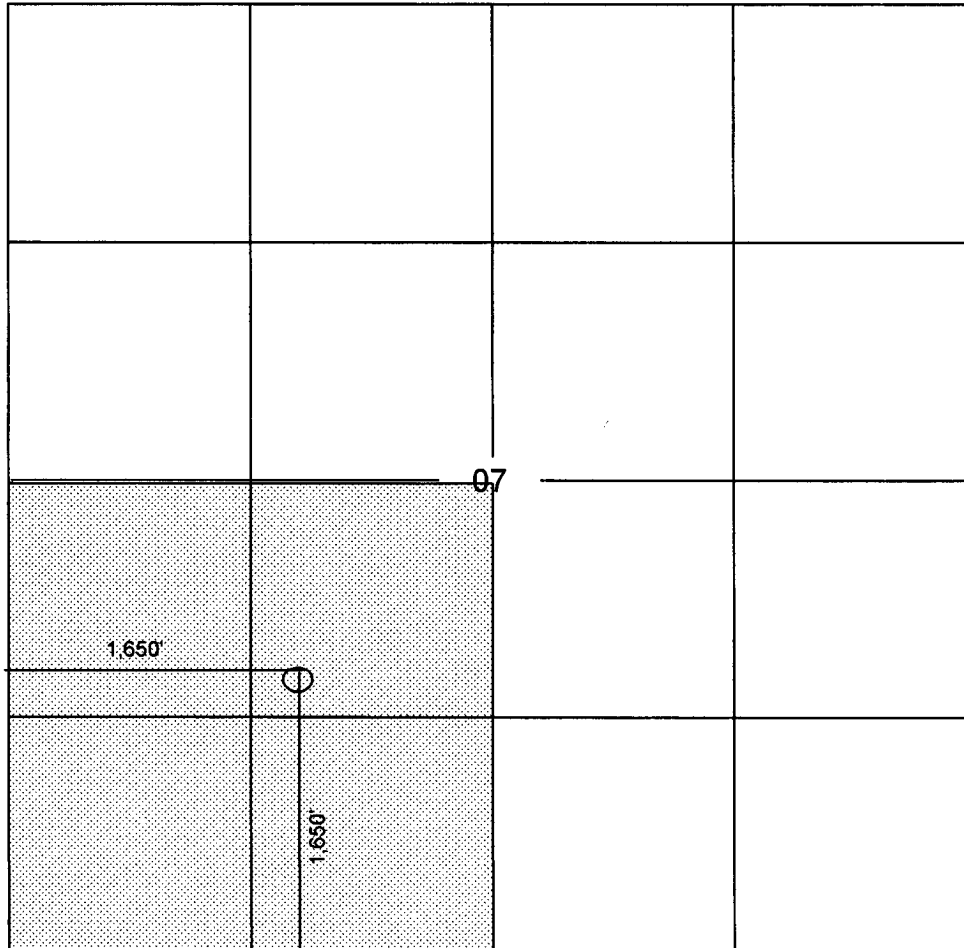

OPERATOR CERTIFICATION

I hereby certify that the information contained herein is true and complete to the best of my knowledge and belief

Kelly Small
Signature

KELLY SMALL
Printed Name

DRILLING ASSISTANT
Title

JANUARY 11, 2005
Date

SURVEYOR CERTIFICATION

I hereby certify that the well location shown on this plat was plotted from field notes of actual surveys made by me or under my supervision, and that the same is true and correct to the best of my belief.

FEBRUARY 18, 1981
Date of Survey

Signature and Seal of Professional Surveyor:
Original signed by Michael Daly

5992
Certificate Number