

Submit 3 Copies To Appropriate District Office
District I
1625 N. French Dr., Hobbs, NM 88240
District II
1301 W. Grand Ave., Artesia, NM 88210
District III
1000 Rio Brazos Rd., Aztec, NM 87410
District IV
1220 S. St. Francis Dr., Santa Fe, NM 87505

State of New Mexico
Energy, Minerals and Natural Resources

OIL CONSERVATION DIVISION
1220 South St. Francis Dr.
Santa Fe, NM 87505

Form C-103
May 27, 2004

WELL API NO. 30-039-22673
5. Indicate Type of Lease STATE <input type="checkbox"/> FEE <input type="checkbox"/>
6. State Oil & Gas Lease No. JIC-69
7. Lease Name or Unit Agreement Name APACHE FEDERAL
8. Well Number #11E
9. OGRID Number 167067
10. Pool name : BASIN DAKOTA / BALLARD PICTURED CLIFFS

SUNDRY NOTICES AND REPORTS ON WELLS
(DO NOT USE THIS FORM FOR PROPOSALS TO DRILL OR TO DEEPEN OR PLUG BACK TO A DIFFERENT RESERVOIR. USE "APPLICATION FOR PERMIT" (FORM C-104) FOR SUCH PROPOSALS.)

1. Type of Well: Oil Well ☐ Gas Well ☒ Other ☐

2. Name of Operator
XTO ENERGY INC.

3. Address of Operator
2700 FARMINGTON AVE, SUITE K-1, FARMINGTON, NM 87401

4. Well Location
Unit Letter L : 1,850 feet from the SOUTH line and 790' feet from the WEST line
Section 08 Township 24N Range 5W NMPM County RIO ARRIBA

11. Elevation (Show whether DR, RKB, RT, GR, etc.)
6,484' GL

Pit or Below-grade Tank Application ☐ or Closure ☐

Pit type _____ Depth to Groundwater _____ Distance from nearest fresh water well _____ Distance from nearest surface water _____

Pit Liner Thickness: _____ mil Below-Grade Tank: Volume _____ bbls; Construction Material _____

12. Check Appropriate Box to Indicate Nature of Notice, Report or Other Data

NOTICE OF INTENTION TO:

PERFORM REMEDIAL WORK ☐ PLUG AND ABANDON ☐
TEMPORARILY ABANDON ☐ CHANGE PLANS ☐
PULL OR ALTER CASING ☐ MULTIPLE COMPL ☐

SUBSEQUENT REPORT OF:

REMEDIAL WORK ☐ ALTERING CASING ☐
COMMENCE DRILLING OPNS. ☐ P AND A ☐
CASING/CEMENT JOB ☐

OTHER: DOWNHOLE COMMINGLE

X

OTHER: ☐

13. Describe proposed or completed operations. (Clearly state all pertinent details, and give pertinent dates, including estimated date of starting any proposed work). SEE RULE 1103. For Multiple Completions: Attach wellbore diagram of proposed completion or recompletion.

XTO Energy Inc. requests approval for an exception to Rule 303-C to permit downhole commingling of production from the Ballard Pictured Cliffs (71439) and the Basin Dakota (71599) pools in the Apache Federal #11E. XTO intends to recomplate this well in the PC and the DK is producing. XTO will downhole commingle these pools upon completion of the Pictured Cliffs. Both zones are included in the pre-approved pools established by Division Order R-11363. Based on production analysis of wells located in a nine section surrounding area the following allocation was determined:

Basin Dakota	100% Oil	100% Water	70% Gas
Ballard Pictured Cliffs	0% Oil	0% Water	30% Gas

Both pools have common interest owners. Commingling both zones will not reduce the ultimate recovery of either pool. Downhole commingling will improve recovery of liquids, eliminate redundant surface equipment and maximize productivity. BLM has been notified of intent to DHC with filing of Form 3160-5.

I hereby certify that the information above is true and complete to the best of my knowledge and belief. I further certify that any pit or below-grade tank has been/will be constructed or closed according to NMOCD guidelines ☐, a general permit ☐ or an (attached) alternative OCD-approved plan ☐.

SIGNATURE Kelly K. Small TITLE DRILLING ASSISTANT DATE 01/10/05
Type or print name KELLY K. SMALL E-mail address: kelly_small@xtoenergy.com Telephone No. 505-324-1090

For State Use Only

APPROVED BY: [Signature] TITLE ADJUTANT GENERAL, DIST. 3
Conditions of Approval (if any):

JAN 11 2005
DATE

District I
1625 N. French Dr., Hobbs, NM 88240
District II
811 South First, Artesia, NM 88210
District III
1000 Rio Brazos Rd., Aztec, NM 87410
District IV
1220 S. St. Francis Dr., Santa Fe, NM 87505

State of New Mexico
Energy, Minerals & Natural Resources Department

Form C-102
Revised August 15, 2000

OIL CONSERVATION DIVISION
1220 South St. Francis Dr.
Santa Fe, NM 87505

Submit to Appropriate District Office
State Lease - 4 Copies
Fee Lease - 3 Copies

WELL LOCATION AND ACREAGE DEDICATION PLAT

AMENDED
REPORT

¹ API Number 30-039-22673	² Pool Code 71439	³ Pool Name BALLARD PICTURED CLIFFS
⁴ Property Code	⁵ Property Name APACHE FEDERAL	⁶ Well Number 11E
⁷ OGRID No. 167067	⁸ Operator Name XTO Energy, Inc.	⁹ Elevation 6,484 GL

¹⁰ Surface Location

UL or lot no. L	Section 08	Township 24N	Range 05W	Lot Idn	Feet from the 1,850'	North/South line SOUTH	Feet from the 790'	East/West line WEST	County RIO ARRIBA
---------------------------	----------------------	------------------------	---------------------	---------	--------------------------------	----------------------------------	------------------------------	-------------------------------	-----------------------------

¹¹ Bottom Hole Location If Different From Surface

UL or lot no.	Section	Township	Range	Lot Idn	Feet from the	North/South line	Feet from the	East/West line	County
---------------	---------	----------	-------	---------	---------------	------------------	---------------	----------------	--------

¹² Dedicated Acres SW/4 160	¹³ Joint or Infill	¹⁴ Consolidation Code	¹⁵ Order No.
--	-------------------------------	----------------------------------	-------------------------

NO ALLOWABLE WILL BE ASSIGNED TO THIS COMPLETION UNTIL ALL INTERESTS HAVE BEEN CONSOLIDATED OR A NON-STANDARD UNIT HAS BEEN APPROVED BY THE DIVISION

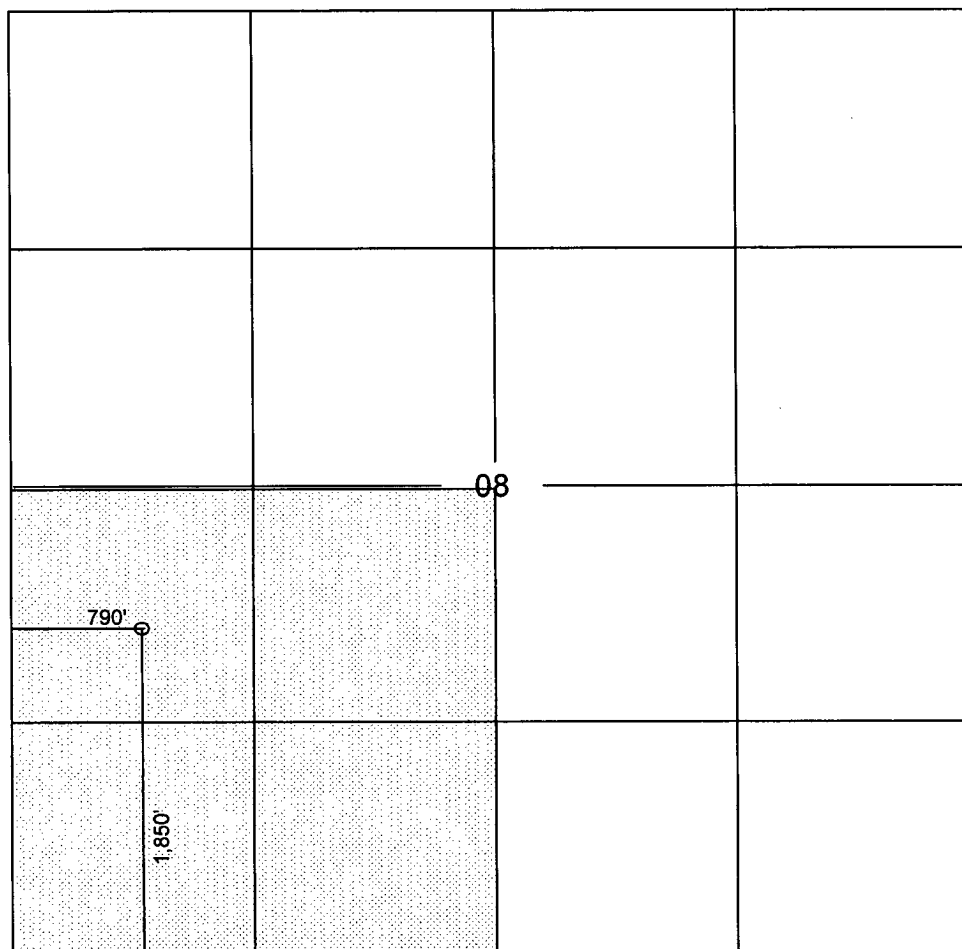

OPERATOR CERTIFICATION

I hereby certify that the information contained herein is true and complete to the best of my knowledge and belief

Kelly H Small
Signature

KELLY SMALL
Printed Name

DRILLING ASSISTANT
Title

JANUARY 10, 2005
Date

SURVEYOR CERTIFICATION

I hereby certify that the well location shown on this plat was plotted from field notes of actual surveys made by me or under my supervision, and that the same is true and correct to the best of my belief.

FEBRUARY 18, 1981
Date of Survey

Signature and Seal of Professional Surveyor:
Original signed by James P. Lease

1463
Certificate Number