

State of New Mexico  
Energy, Minerals and Natural Resources Department  
Oil Conservation Division

**Sundry Notices and Reports on Wells**

<p>1. <b>Type of Well</b> GAS</p> <hr/> <p>2. <b>Name of Operator</b> <b>BURLINGTON</b> RESOURCES OIL &amp; GAS COMPANY LP</p> <hr/> <p>3. <b>Address &amp; Phone No. of Operator</b> PO Box 4289, Farmington, NM 87499 (505) 326-9700</p> <hr/> <p>4. <b>Location of Well, Footage, Sec., T, R, M</b> 1680'FSL, 855'FEL, Sec.12, T-29-N, R-7-W, NMPM, Rio Arriba County</p>	<p>API # (assigned by OCD) 30-039-29272</p> <p>5. <b>Lease Number</b> Fee</p> <p>6. <b>State Oil&amp;Gas Lease #</b></p> <p>7. <b>Lease Name/Unit Name</b> San Juan 29-7 Unit</p> <p>8. <b>Well No.</b> 545S</p> <p>9. <b>Pool Name or Wildcat</b> Basin Fruitland Coal</p> <p>10. <b>Elevation:</b></p>
--	--

Type of Submission	Type of Action	
<input type="checkbox"/> Notice of Intent	<input type="checkbox"/> Abandonment	<input type="checkbox"/> Change of Plans
<input checked="" type="checkbox"/> Subsequent Report	<input type="checkbox"/> Recompletion	<input type="checkbox"/> New Construction
<input type="checkbox"/> Final Abandonment	<input type="checkbox"/> Plugging Back	<input type="checkbox"/> Non-Routine Fracturing
	<input type="checkbox"/> Casing Repair	<input type="checkbox"/> Water Shut off
	<input type="checkbox"/> Altering Casing	<input type="checkbox"/> Conversion to Injection
	<input checked="" type="checkbox"/> Other - Amended location	

**13. Describe Proposed or Completed Operations**

The subject well has been moved from 1690'FSL, 885'FEL, Sec. 12, T-29-N, R-7-W  
To 1680'FSL, 855' FEL.

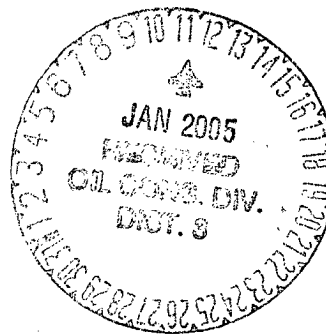

SIGNATURE Nancy Oltramano Senior Staff Specialist January 7, 2005

(This space for State Use)

Approved by [Signature] Title DEPUTY OIL & GAS INSPECTOR, DIST. 3 Date JAN 11 2005

DISTRICT I  
1625 N. French Dr., Hobbs, N.M. 88240

State of New Mexico  
Energy, Minerals & Natural Resources Department

Form C-102  
Revised August 15, 2000

DISTRICT II  
611 South First, Artesia, N.M. 88210

DISTRICT III  
1000 Rio Brazos Rd., Aztec, N.M. 87410

DISTRICT IV  
2040 South Pacheco, Santa Fe, NM 87505

OIL CONSERVATION DIVISION  
2040 South Pacheco  
Santa Fe, NM 87505

Submit to Appropriate District Office  
State Lease - 4 Copies  
Fee Lease - 3 Copies

☐ AMENDED REPORT

WELL LOCATION AND ACREAGE DEDICATION PLAT

<sup>1</sup> API Number 30-039-29272	<sup>2</sup> Pool Code 71629	<sup>3</sup> Pool Name Basin Fruitland Coal
<sup>4</sup> Property Code 7465	<sup>5</sup> Property Name SAN JUAN 29-7 UNIT	<sup>6</sup> Well Number 545S
<sup>7</sup> GRID No. 14538	<sup>8</sup> Operator Name BURLINGTON RESOURCES OIL AND GAS COMPANY LP	<sup>9</sup> Elevation 6363'

<sup>10</sup> Surface Location

UL or lot no.	Section	Township	Range	Lot Idn	Feet from the	North/South line	Feet from the	East/West line	County
1	12	29-N	7-W		1680'	SOUTH	855'	EAST	RIO ARriba

<sup>11</sup> Bottom Hole Location If Different From Surface

UL or lot no.	Section	Township	Range	Lot Idn	Feet from the	North/South line	Feet from the	East/West line	County
<sup>12</sup> Dedicated Acres E/320					<sup>13</sup> Joint or Infill		<sup>14</sup> Consolidation Code		<sup>15</sup> Order No.

NO ALLOWABLE WILL BE ASSIGNED TO THIS COMPLETION UNTIL ALL INTERESTS HAVE BEEN CONSOLIDATED  
OR A NON-STANDARD UNIT HAS BEEN APPROVED BY THE DIVISION

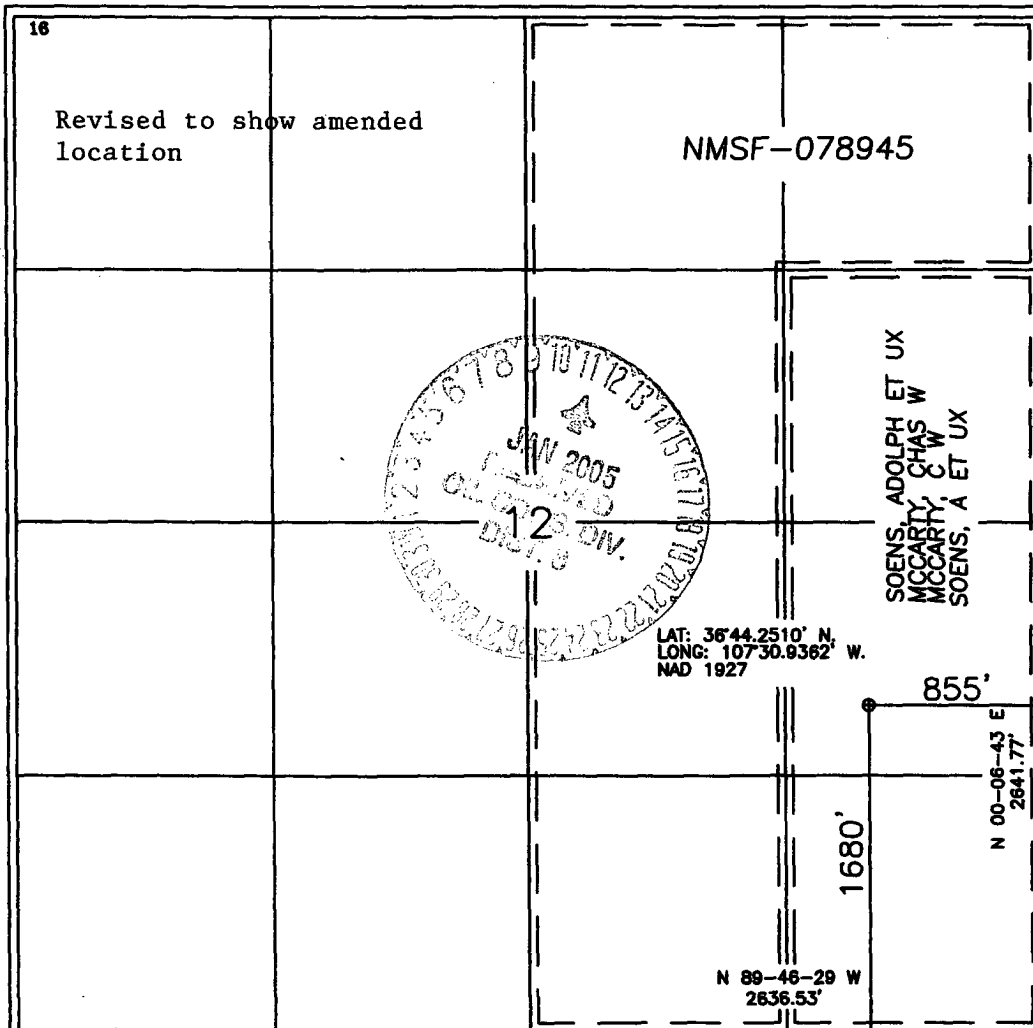

17 OPERATOR CERTIFICATION

I hereby certify that the information contained herein is true and complete to the best of my knowledge and belief

*Nancy Oltmanns*  
Signature

Nancy Oltmanns  
Printed Name  
Senior Staff Specialist

Title  
1-7-05  
Date

18 SURVEYOR CERTIFICATION

I hereby certify that the well location shown on this plat was plotted from field notes of actual surveys made by me or under my supervision, and that the same is true and correct to the best of my belief.

Date of Survey 12-28-04

Signature and Seal of Licensed Professional Surveyor

*Carl Russell*  
15703  
Certificate Number