

UNITED STATES  
DEPARTMENT OF THE INTERIOR  
BUREAU OF LAND MANAGEMENT

FORM APPROVED  
OMB NO. 1004-0137  
Expires March 31, 2007

SUNDRY NOTICES AND REPORTS ON WELLS

Do not use this form for proposals to drill or to re-enter an abandoned well. Use Form 3160-3 (APD) for such proposals.

2004 DEC 22 20 11 06

SUBMIT IN TRIPLICATE - Other instructions on reverse side

RECEIVED

070 FARMINGTON

1. Type of Well

☐ Oil Well ☒ Gas Well ☐ Other

2. Name of Operator

XTO Energy Inc.

3a. Address

2700 Farmington Ave., Bldg. K. Ste 1 Farmington,

3b. Phone No. (include area code)

5053241090

4. Location of Well (Footage, Sec., T., R., M., or Survey Description)

SEC 9 - T27N - R11W 1877' FSL & 796' FWL (Bolack 9 #1)  
SEC 9 - T27N - R11W 1650' FSL & 1650' FWL (Alice Bolack #5)

5. Lease Serial No.

NMM078872A

6. If Indian, Allottee or Tribe Name

7. If Unit or CA/Agreement, Name and/or No.

8. Well Name and No.

Bolack 9 #1 and  
Alice Bolack #5

9. API Well No.

30-045-27857 30-045-06661

10. Field and Pool, or Exploratory Area

BASIN FRUITLAND COAL  
KUTZ W PICTURED CLIFFS

11. County or Parish, State

SAN JUAN COUNTY NM

12. CHECK APPROPRIATE BOX(ES) TO INDICATE NATURE OF NOTICE, REPORT, OR OTHER DATA

TYPE OF SUBMISSION

- ☒ Notice of Intent  
☐ Subsequent Report  
☐ Final Abandonment Notice

TYPE OF ACTION

- |   |   |  |  |
|---|---|--|--|
| <input type="checkbox"/> Acidize              | <input type="checkbox"/> Deepen           | <input type="checkbox"/> Production (Start/Resume) | <input type="checkbox"/> Water Shut-Off                  |
| <input type="checkbox"/> Alter Casing         | <input type="checkbox"/> Fracture Treat   | <input type="checkbox"/> Reclamation               | <input type="checkbox"/> Well Integrity                  |
| <input type="checkbox"/> Casing Repair        | <input type="checkbox"/> New Construction | <input type="checkbox"/> Recomplete                | <input checked="" type="checkbox"/> Other <u>SURFACE</u> |
| <input type="checkbox"/> Change Plans         | <input type="checkbox"/> Plug and Abandon | <input type="checkbox"/> Temporarily Abandon       | <u>COMMINGLE</u>   |
| <input type="checkbox"/> Convert to Injection | <input type="checkbox"/> Plug Back        | <input type="checkbox"/> Water Disposal            |  |

13. Describe Proposed or Completed Operation (clearly state all pertinent details, including estimated starting date of any proposed work and approximate duration thereof. If the proposal is to deepen directionally or recompleate horizontally, give subsurface locations and measured and true vertical depths of all pertinent markers and zones. Attach the Bond under which the work will be performed or provide the Bond No. on file with BLM/BIA. Required subsequent reports shall be filed within 30 days following completion of the involved operations. If the operation results in a multiple completion or recompleation in a new interval, a Form 3160-4 shall be filed once testing has been completed. Final Abandonment Notices shall be filed only after all requirements, including reclamation, have been completed, and the operator has determined that the final site is ready for final inspection.)

XTO Energy Inc. proposes to surface commingle the above wells per attached documents.

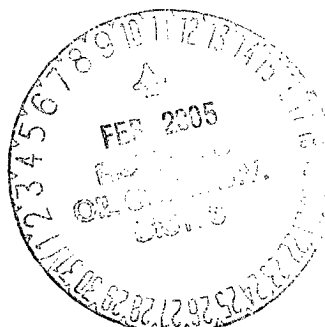

PLC 2405

14. I hereby certify that the foregoing is true and correct  
Name (Printed/Typed)

HOLLY C. PERKINS

Title

REGULATORY COMPLIANCE TECH

Date 12/21/2004

THIS SPACE FOR FEDERAL OR STATE OFFICE USE

Approved by

Title

Date

Conditions of approval, if any, are attached. Approval of this notice does not warrant or certify that the applicant holds legal or equitable title to those rights in the subject lease which would entitle the applicant to conduct operations thereon.

Office

Title 18 U.S.C. Section 1004 and Title 43 U.S.C. Section 1212, makes it a crime for any person knowingly and willfully to make to any department or agency of the United States any false, fictitious or fraudulent statements or representations as to any matter within its jurisdiction.

FARMINGTON

NMOC



2700 Farmington Ave, K-4 Farmington, NM 87401  
Phone: (505) 324-1090 FAX: (505) 564-6700

RECEIVED  
XTO FARMINGTON NM

December 22, 2004

Mr. William Jones  
New Mexico Oil Conservation Division  
1220 S. St. Francis Drive  
Santa Fe, NM 87505

Mr. Jim Lovato  
Bureau of Land Management  
1235 LaPlata Hwy  
Farmington, NM 87401

Subject: Proposed Surface Commingle  
Bolack 9 #1 and Alice Bolack #5  
Federal Lease NMNM078872A

Dear Mr. Jones & Mr. Lovato:

XTO Energy Inc. requests administrative approval for surface commingling natural gas produced from the wells operated in the Bolack 9 #1 and the Alice Bolack #5. These wells are both located in Sec 9-T27N-R11W, San Juan County, New Mexico.

XTO plans to produce the commingled gas through a central compressor, thus lowering operating expenses and extending the economic life of the wells and increasing their ultimate recoveries on all Indians and non-Indian leases. The anticipated fuel requirements for each well is also presented, and currently we anticipate the only fuel requirements to be for pumping unit engines, separators and for the compressor engine. There are no bypass gas lines for this system.

Each well will be equipped with allocation meters, which will be maintained by XTO Energy in accordance with State and Federal Regulations (Onshore Order No. 5). To ensure the initial system integrity, all flowlines will be pressure tested appropriately. Produced liquids will not be surface commingled. All interest owners have been notified via certified mail, return receipt, on December 14, 2004.

The following attachments are included with this application:

- Form C107B (application for surface commingle; diverse ownership)
- Map of all wells and their associated leases
- Form C-102 for each well (plats)
- Table of well & lease information, spacing, permits, lease numbers, gravities/BTU, MCF
- Schematic diagram showing all flowlines, compressors & equipment
- Details of allocation formula, including line purging and venting
- Letter to WI, NRI & ORRI owners & list of owners
- Administrative Application Checklist

Sincerely,

Holly C. Perkins  
Regulatory Compliance Tech

xc: OCD, Aztec Office

District I  
1625 N. French Drive, Hobbs, NM 88240  
District II  
1301 W. Grand Ave, Artesia, NM 88210  
District III  
1000 Rio Brazos Road, Aztec, NM 87410  
District IV  
1220 S. St Francis Dr, Santa Fe, NM  
87505

State of New Mexico  
Energy, Minerals and Natural Resources Department

Form C-107-B  
Revised June 10, 2003

**OIL CONSERVATION DIVISION**  
1220 S. St Francis Drive  
Santa Fe, New Mexico 87505

Submit the original  
application to the Santa Fe  
office with one copy to the  
appropriate District Office.

**APPLICATION FOR SURFACE COMMINGLING (DIVERSE OWNERSHIP)**

OPERATOR NAME: XTO ENERGY INC.

OPERATOR ADDRESS: 2700 FARMINGTON AVE, SUITE K-1

APPLICATION TYPE:

☒ Pool Commingling ☐ Lease Commingling ☐ Pool and Lease Commingling ☐ Off-Lease Storage and Measurement (Only if not Surface Commingled)

LEASE TYPE: ☐ Fee ☐ State ☒ Federal

Is this an Amendment to existing Order? ☐ Yes ☒ No If "Yes", please include the appropriate Order No. \_\_\_\_\_

Have the Bureau of Land Management (BLM) and State Land office (SLO) been notified in writing of the proposed commingling

☒ Yes ☐ No

**(A) POOL COMMINGLING**

Please attach sheets with the following information

| (1) Pool Names and Codes     | Gravities / BTU of<br>Non-Commingled<br>Production | Calculated Gravities /<br>BTU of Commingled<br>Production |  | Calculated Value of<br>Commingled<br>Production | Volumes |
|------------------------------|--|---|--|---|---------|
| KUTZ W PICTURED CLIFFS 79680 | .5980  |   |  |   |         |
| BASIN FRUITLAND COAL 71629   | .6090  |   |  |   |         |
|                              |  |   |  |   |         |
|                              |  |   |  |   |         |
|                              |  |   |  |   |         |

(2) Are any wells producing at top allowables? ☐ Yes ☒ No

(3) Have all interest owners been notified by certified mail of the proposed commingling? ☒ Yes ☐ No.

(4) Measurement type: ☒ Metering ☐ Other (Specify)

(5) Will commingling decrease the value of production? ☐ Yes ☒ No If "yes", describe why commingling should be approved

**(B) LEASE COMMINGLING**

Please attach sheets with the following information

(1) Pool Name and Code.

(2) Is all production from same source of supply? ☐ Yes ☐ No

(3) Has all interest owners been notified by certified mail of the proposed commingling? ☐ Yes ☐ No

(4) Measurement type: ☐ Metering ☐ Other (Specify)

**(C) POOL and LEASE COMMINGLING**

Please attach sheets with the following information

(1) Complete Sections A and E.

**(D) OFF-LEASE STORAGE and MEASUREMENT**

Please attached sheets with the following information

(1) Is all production from same source of supply? ☐ Yes ☐ No

(2) Include proof of notice to all interest owners.

**(E) ADDITIONAL INFORMATION (for all application types)**

Please attach sheets with the following information

(1) A schematic diagram of facility, including legal location.

(2) A plat with lease boundaries showing all well and facility locations. Include lease numbers if Federal or State lands are involved.

(3) Lease Names, Lease and Well Numbers, and API Numbers.

I hereby certify that the information above is true and complete to the best of my knowledge and belief.

SIGNATURE: Holly C Perkins

TITLE: REGULATORY COMPLIANCE TECH

DATE: 12/13/2004

TYPE OR PRINT NAME HOLLY C. PERKINS

TELEPHONE NO.: (505) 564-6720

E-MAIL ADDRESS: Holly\_perkins@xtoenergy.com

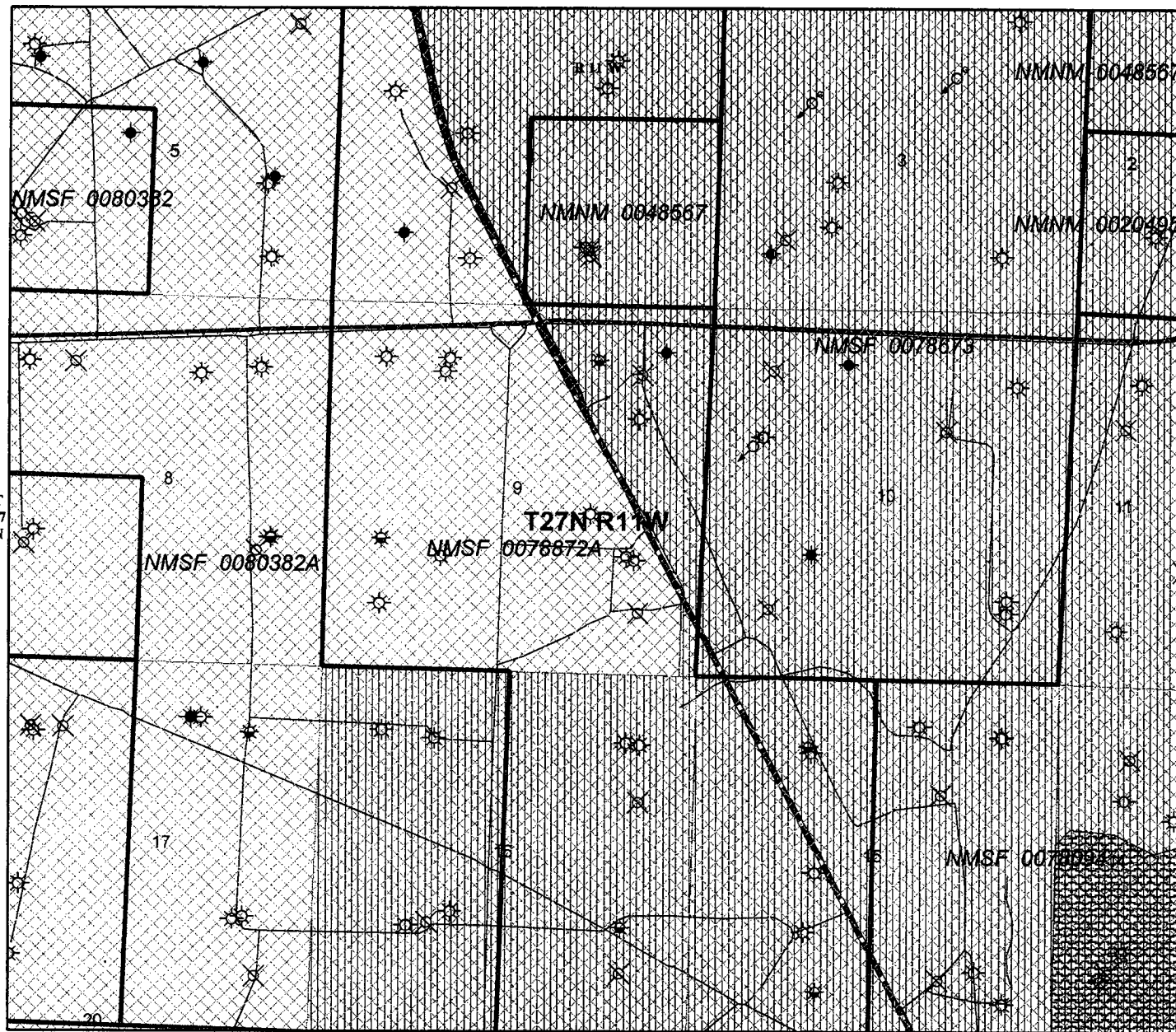

281  
366  
4491

### Legend

| Mineral Ownership Status |                      |
|--------------------------|----------------------|
|                          | Oil, Gas + Coal Only |
|                          | No Minerals          |
|                          | All Minerals         |
|                          | Coal Only            |
|                          | Oil + Gas Only       |
|                          | Other Minerals       |

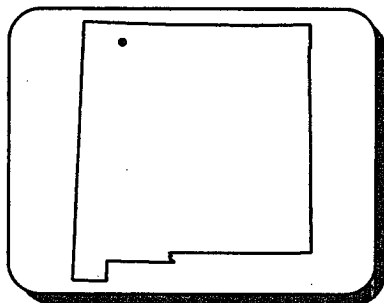

1:27,344

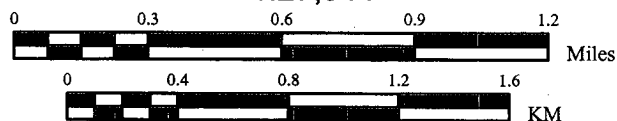

United States Department of the Interior  
Bureau of Land Management  
Farmington Field Office

Map created on Feb 03, 2005



#### CAUTION:

Land ownership data is derived from less accurate data than the 1:24000 scale base map. Therefore, land ownership may not be shown for parcels smaller than 40 acres, and land ownership lines may have plotting errors due to source data.

No warranty is made by the Bureau of Land Management for the use of the data for purposes not intended by the BLM.

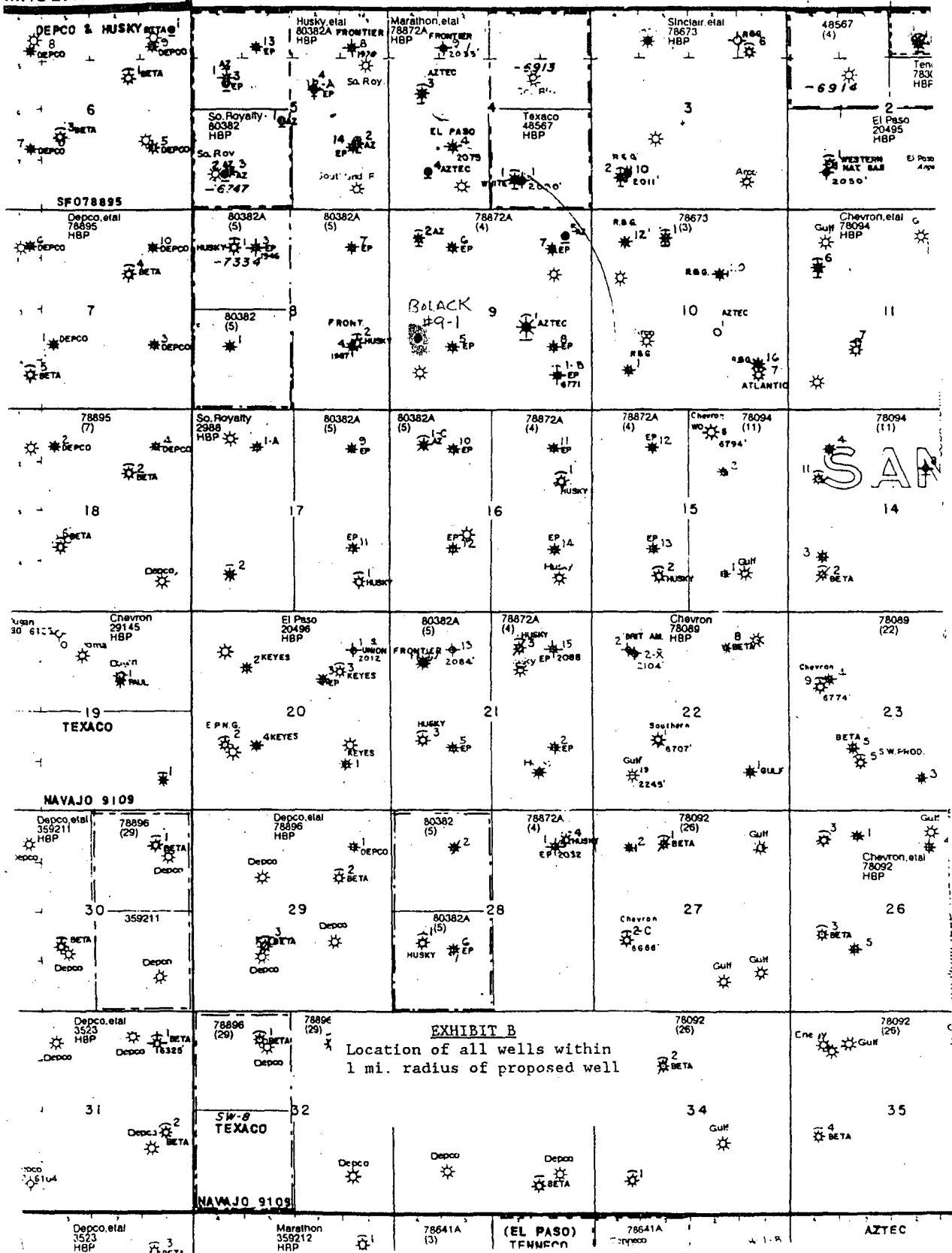



District I  
1625 N. French Dr., Hobbs, NM 88240  
District II  
811 South First, Artesia, NM 88210  
District III  
1000 Rio Brazos Rd., Aztec, NM 87410  
District IV  
1220 S. St. Francis Dr., Santa Fe, NM 87505

State of New Mexico  
Energy, Minerals & Natural Resources Department

Form C-102  
Revised August 15, 2000

OIL CONSERVATION DIVISION  
1220 South St. Francis Dr.  
Santa Fe, NM 87505

Submit to Appropriate District Office  
State Lease - 4 Copies  
Fee Lease - 3 Copies

WELL LOCATION AND ACREAGE DEDICATION PLAT

☐ AMENDED  
REPORT

|   |  |  |
|---|--|--|
| <sup>1</sup> API Number<br>30-045-27857 | <sup>2</sup> Pool Code<br>79680                | <sup>3</sup> Pool Name<br>Kutz W Pictured Cliffs |
| <sup>4</sup> Property Code              | <sup>5</sup> Property Name<br>ALICE BOLACK     | <sup>6</sup> Well Number<br>5                    |
| <sup>7</sup> OGRID No.<br>167067        | <sup>8</sup> Operator Name<br>XTO Energy, Inc. | <sup>9</sup> Elevation<br>6339' GR               |

<sup>10</sup> Surface Location

| UL or lot no. | Section | Township | Range | Lot Idn | Feet from the | North/South line | Feet from the | East/West line | County   |
|---------------|---------|----------|-------|---------|---------------|------------------|---------------|----------------|----------|
| K             | 9       | 27N      | 11W   |         | 1650          | SOUTH            | 1650          | WEST           | San Juan |

<sup>11</sup> Bottom Hole Location If Different From Surface

| UL or lot no. | Section | Township | Range | Lot Idn | Feet from the | North/South line | Feet from the | East/West line | County |
|---------------|---------|----------|-------|---------|---------------|------------------|---------------|----------------|--------|
|               |         |          |       |         |               |                  |               |                |        |

|   |                               |                                  |                         |
|---|-------------------------------|----------------------------------|-------------------------|
| <sup>12</sup> Dedicated Acres<br>160 SW/4 | <sup>13</sup> Joint or Infill | <sup>14</sup> Consolidation Code | <sup>15</sup> Order No. |
|---|-------------------------------|----------------------------------|-------------------------|

NO ALLOWABLE WILL BE ASSIGNED TO THIS COMPLETION UNTIL ALL INTERESTS HAVE BEEN CONSOLIDATED OR A NON-STANDARD UNIT HAS BEEN APPROVED BY THE DIVISION

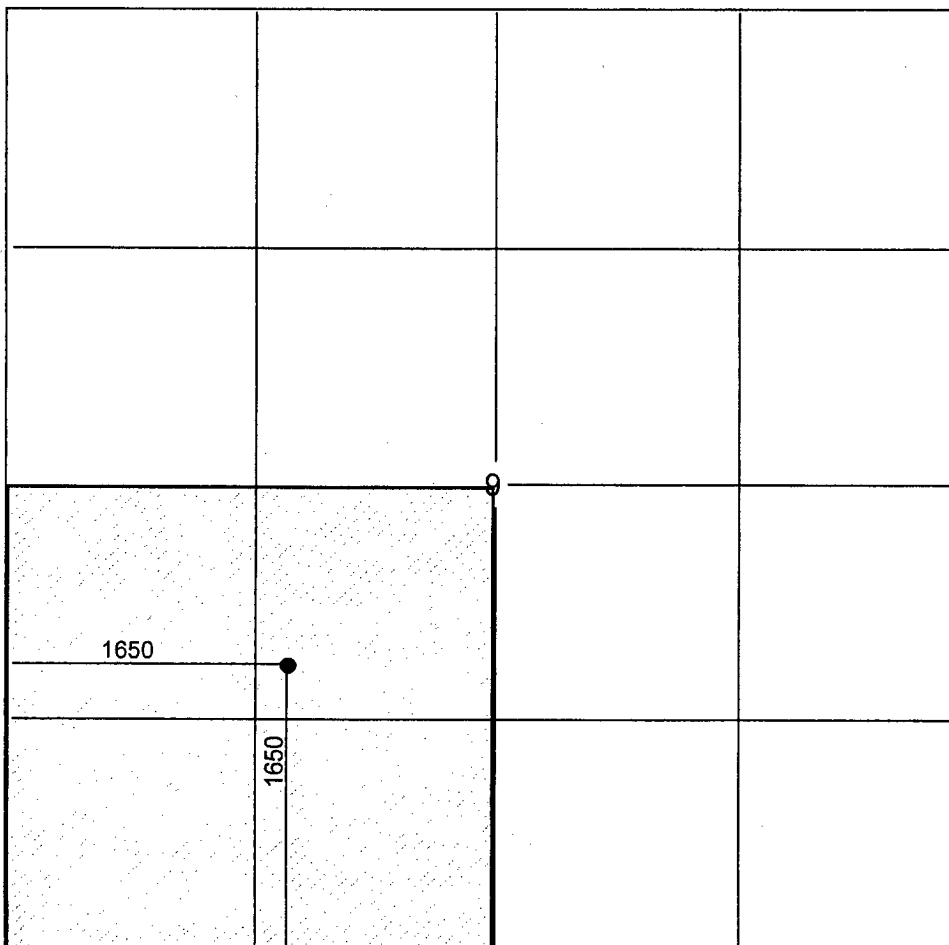

OPERATOR CERTIFICATION

I hereby certify that the information contained herein is true and complete to the best of my knowledge and belief

*Holly C. Perkins*  
Signature

Holly C. Perkins  
Printed Name

Regulatory compliance Tech  
Title

December 20, 2004  
Date

SURVEYOR CERTIFICATION

I hereby certify that the well location shown on this plat was plotted from field notes of actual surveys made by me or under my supervision, and that the same is true and correct to the best of my belief.

August 9, 2001  
Date of Survey

Signature and Seal of Professional Surveyor:  
Original signed by Charles J. Finklea

1302  
Certificate Number

| <b>BOLACK 9 #1 &amp; ALICE BOLACK #5 SURF CMGL</b>  |                           |                      |                        |  |
|---|---------------------------|----------------------|------------------------|--|
|   |                           |                      |                        |  |
|   | <b>Well Name</b>          | Bolack 9 #1          | Alice Bolack #5        |  |
|   | <b>API#</b>               | 30-045-27857         | 30-045-06661           |  |
|   | <b>Sec-T-R</b>            | Sec 9-T27N-R11W      | Sec 9-T27N-R11W        |  |
|   | <b>FNL/FSL</b>            | 1877' FSL            | 1650' FSL              |  |
|   | <b>FEL/FWL</b>            | 796' FWL             | 1650' FWL              |  |
|   | <b>Lease #</b>            | NMNM078872A          | NMNM078872A            |  |
|   | <b>Pool</b>               | Basin Fruitland Coal | Kutz W Pictured Cliffs |  |
|   | <b>Permits</b>            | N/A                  | N/A                    |  |
|   | <b>Spacing</b>            | W/2 320 acres        | SW/4 160 acres         |  |
|   | <b>Gravity</b>            | 0.609                | 0.598                  |  |
|   | <b>BTU</b>                | 52.64                | 105.237                |  |
|   | <b>Est Daily Gas Rate</b> | 50.95                | 103.5                  |  |
|   | <b>WI</b>                 | 1                    | 0.5                    |  |
|   | <b>NRI</b>                | 0.8                  | 0.4125                 |  |
| Compressor and other equipment fuel usage will be determined based on manufacturer's specifications |                           |                      |                        |  |
| Pumping unit & separator fuel will be allocated to well if equipment exists                         |                           |                      |                        |  |



# XTO ENERGY INC.

Proposed Comingle - Alice Bolack #005 & Bolack 9 #001

Sec. 09, T27N, R11W, Unit K & L

Federal Lease #: NMSF078872A

API #: 30-045-06661 & 30-045-27857

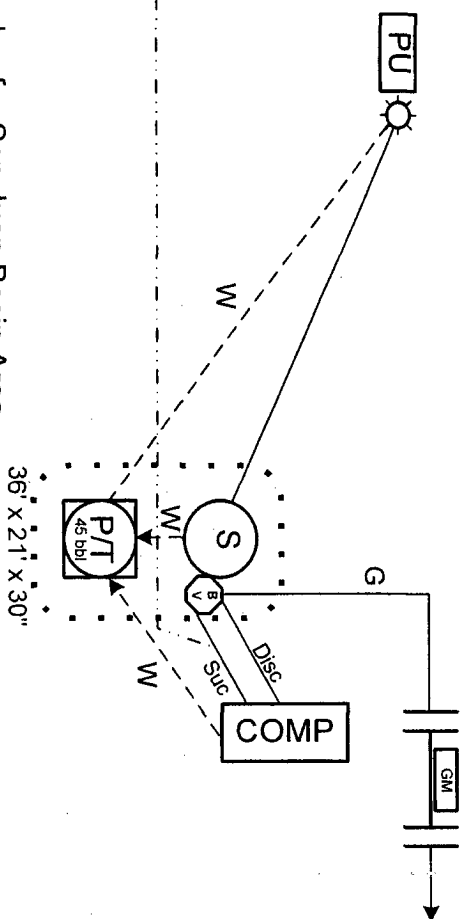
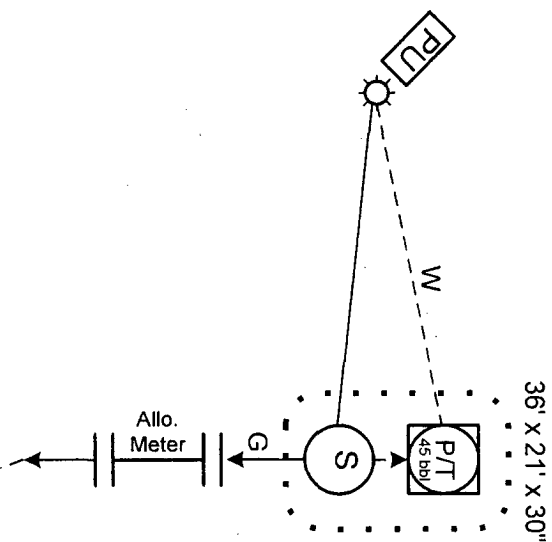

This lease is subject to the site security plan for San Juan Basin Area.

The plan is located at: XTO Energy Inc

2700 Farmington Ave., Bldg. K, Ste. 1

Farmington, NM 87401

Updated: 12/21/04

**XTO ENERGY INC.**  
**Bolack 9 #001**  
**Sec. 09, T27N, R11W, Unit L**  
**Federal Lease #: NMSF078872A**  
**API #: 30-045-27857**

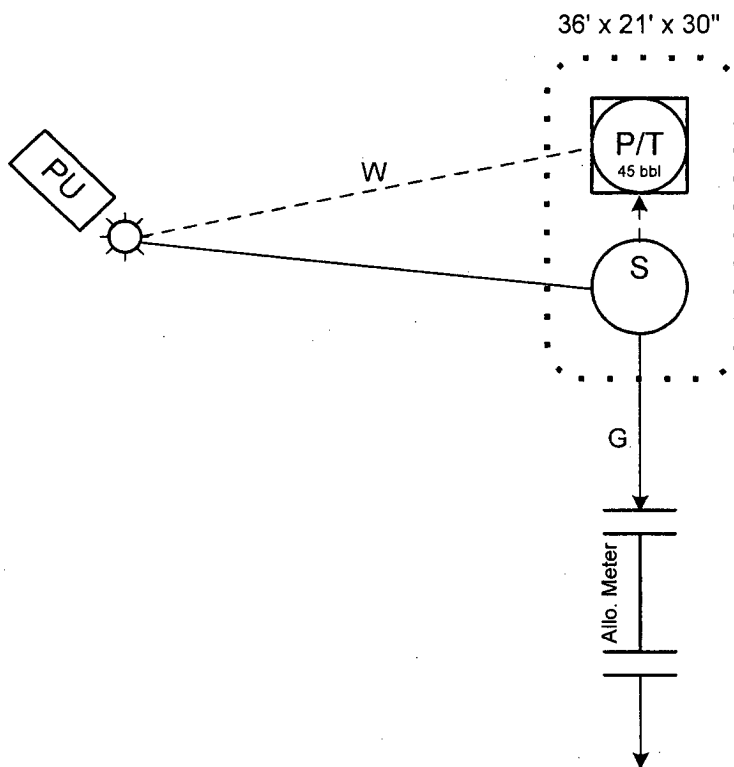

This lease is subject to the site security plan for San Juan Basin Area.  
The plan is located at: XTO Energy Inc  
2700 Farmington Ave., Bldg. K, Ste. 1  
Farmington, NM 87401  
Updated: 12/21/04

**XTO ENERGY INC.**  
**Alice Bolack #005**  
**Sec. 09, T27N, R11W, Unit K**  
**Federal Lease #: NMSF078872A**  
**API #: 30-045-06661**

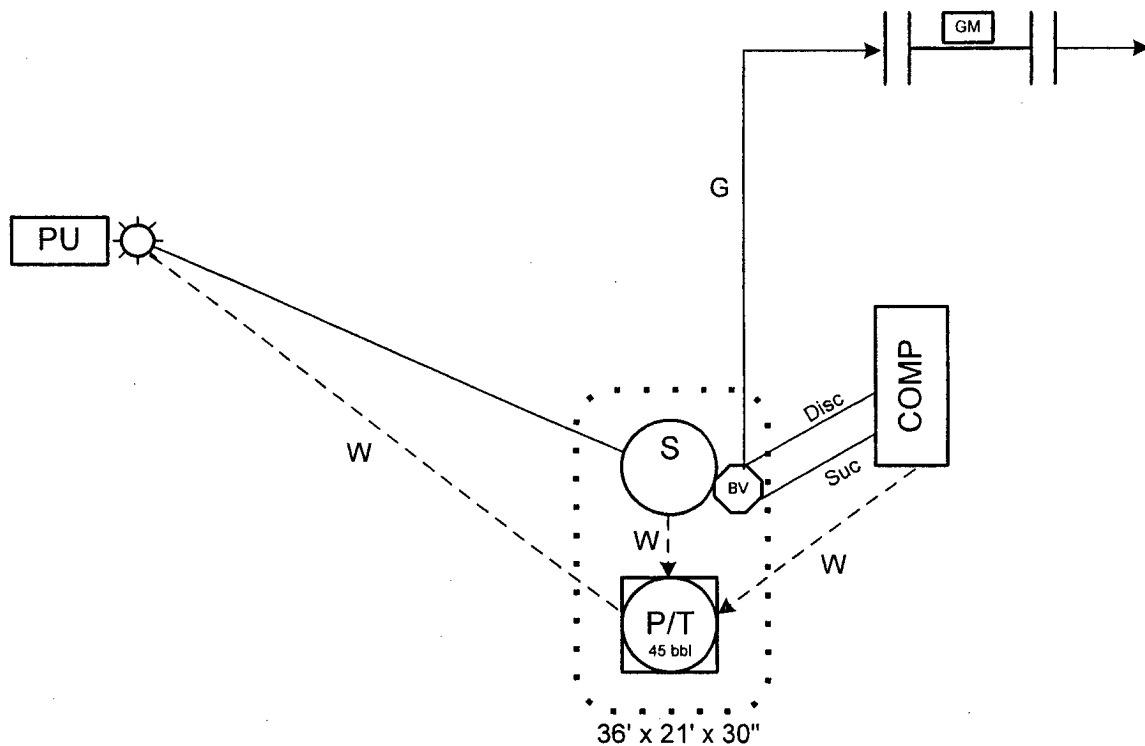

This lease is subject to the site security plan for San Juan Basin Area.  
The plan is located at: XTO Energy Inc  
2700 Farmington Ave., Bldg. K, Ste. 1  
Farmington, NM 87401  
Updated: 12/21/04

**Bolack 9 #1 & Alice Bolack #5**  
**PROPOSED ALLOCATION PROCEDURES**

Base Data:

W = Gas Volume (MCF) from allocation meters at individual wells during allocation period

X = Gas Volume (MCF) from CDP sales meter during allocation period

Y = BTU's from CDP sales meter during allocation period

Allocation period is typically a calendar month & will be the same for all wells

Individual Well Gas Production = A + B + C + D + E

A = Allocated Sales Volume, MCF  $(W / \text{SUM } W) \times X$

B = On lease fuel usage, MCF. Determined fr/equipment specification & operating conditions

C = Purged and/or vented gas fr/well and/or lease equipment, MCF. Calculated using equipment specifications & pressures.

D = Allocated fuel fr/gathering system equipment, MCF> The total fuel required to operate gathering system equipment will be allocated to the individual wells benefiting fr/the equipment using allocation factors determined by  $W / \text{SUM } W$  for the wells involved.

E = Allocated volume of gas lost and/or vented fr/the gathering system and/or gathering system equipment, MCF. The total volume will be determined using industry accepted procedures for the conditions existing at the time of the loss. All volumes corresponding to liquid condensation within the gathering system will also be determined. The total volume lost and/or vented will be allocated to the individual wells affected using factors determined by  $W / \text{SUM } W$ .

Allocated individual Well BTU's =  $(W \times \text{Individual well BTU}) / \text{SUM } (W \times \text{individual well BTU}) \times Y$ .  
Individual well gas heating values to be determined in accordance w/BLM regulations  
(Onshore Order No. 5)



2700 Farmington Ave, K-1 Farmington, NM 87401  
Phone: (505) 324-1090 FAX: (505) 564-6700

December 13, 2004

RE: Notice to Working and Royalty Interest Owners  
Application to Surface Commingle Gas Production  
San Juan County, NM

XTO Energy Inc. is applying to the New Mexico Oil Conservation Division (NMOCD) and Bureau of Land Management (BLM) for approval to surface commingle gas production from the Bolack 9 #1 and the Alice Bolack #5. The Bolack 9 #1 is a Basin Fruitland Coal well and the Alice Bolack #5 is a Kutz W Pictured Cliffs well. The NMOCD requires all interest owners be notified of plans to surface commingle when ownership is different between wells.

Produced gas from each well will be measured separately prior to being commingled. We plan to produce the commingled gas through a shared compressor. Produced liquids will not be surface commingled. In the future, additional wells, pools, and acreage may be added to this surface commingle or this gathering system. At such time, as an owner in this system, you will not be noticed as this commingle is expanded unless this method of allocating production between pools and wells changes.

If you need additional information or have any questions, I may be contacted at (505) 324-1090. If you have an objection to our application you must file a protest in writing to the NMOCD Santa Fe office at 1220 So. St. Francis Drive, Santa Fe, NM 87505 within 20 days from the date the NMOCD received the application.

Sincerely,

A handwritten signature in cursive script that reads 'Holly C. Perkins'.

Holly C. Perkins  
Regulatory Compliance Tech

xc: Well Files  
FW Land Dept.  
NMOCD, Aztec

Bolack 9 #1 & Alice Bolack #5 Surf CmgI Owner List

Harold D. Carter, Trustee  
5949 Sherry Lane, Suite 1475  
Dallas, TX 75225

Grover Family L.P.  
Attn: Arden R. Grover  
P O Box 3666  
Midland, TX 79702-3666

Cooksey Family Trust  
Robert A Cooksey, Trustee  
4925 Greenville, Box 92  
Dallas, TX 75206

Jones Family Trust  
8080 N Central Suite 1420  
Dallas, TX 75206

Claire S. K. Chun  
& Sun Oi Chun J/T  
2054 S. Beretania Street  
Honolulu, HI 96826-1312

Henry W. O. Chun  
2054 S. Beretania Street  
Honolulu, HI 96826-1312

Amy L. Fern  
719 12th Ave.  
Honolulu, HI 96816-2247

Dennis Y. Y. Hew  
& Jane G. K. Hew  
2233 Hoonanea Street  
Honolulu, HI 96822-2428

Anita C. Luke  
& Charles W. W. Luke J/T  
3216 Kaohinani Drive  
Honolulu, HI 96817-1041

Dorothy Lyum Park  
1116 A. Clio Street  
Honolulu, HI 96822-2701

Bolack 9 #1 & Alice Bolack #5 Surf Cmg! Owner List

Mildred O. Togikawa  
1020 8th Ave. #A  
Honolulu, HI 96816-2449

Thomas F. Schmidt  
& Lorinna Schmidt Jtwros  
2333 Kapiolani Blvd Ste 2  
Honolulu, HI 96826-4400

Henry Hung Pui Chun Revocable Trust  
Henry Hung Pui Chun Trustee  
2137 Liliha St.reet  
Honolulu, HI 96817-1639

Patsy Chun Chun Revocable Trust  
Patsy Chun Chun Trustee  
2137 Liliha St.reet  
Honolulu, HI 96817-1639

John Lawrence Kolivas  
& Deanna L. Carpenter Kolivas  
2927 Hibiscus Place  
Honolulu, HI 96815-4727

Alice L. Heu Revocable Living Trust  
Alice L. Heu, Trustee  
921 Hala Drive  
Honolulu, HI 96817-2122

Emily Hee Fasick  
P.O. Box 1831  
Honolulu, HI 96805-1831

Bolack Minerals Company  
A New Mexico Ltd Partnership  
3901 Bloomfield Hwy.  
Farmington, NM 87401-2831

MMS – Notify BLM

May Ruth Gaudin  
525 Granada Crescent  
N. Vancouver British Columbia  
Canada V7N 3A7

Bolack 9 #1 & Alice Bolack #5 Surf Cmgf Owner List

W. D. Kennedy Properties Ltd  
Attn: W. D. Kennedy  
550 West Texas #1225  
Midland, TX 79701-4257

Burlington Resources Oil & Gas  
Company LP  
P.O. Box 4289  
Farmington, NM 87499-0656





2700 Farmington Ave, K-1 Farmington, NM 87401

Phone: (505) 324-1090 FAX: (505) 564-6700

December 17, 2004

Ms. Connie Pruitt  
Farmington Daily Times  
P.O. Box 450,  
Farmington, NM 87499

Subject: Affidavit of Publication  
Bolack 9 #1 and Alice Bolack #5 Surface Commingle

Dear Ms. Pruitt:

Please publish the following legal notice for us pertaining to surface commingle of wells in San Juan County. After publication please send a notarized Affidavit of Publication to our company at the above address. Should any further information be necessary, please do not hesitate to call me at (505) 564-6720.

Public Notice

XTO Energy Inc. is applying to the New Mexico Oil Conservation Division (NMOCD) to surface commingle gas from two wells: the Bolack 9 #1 and the Alice Bolack #5. There will not be any commingling of oil, condensate or water. The wells and the commingling facility are located in Section 9 Township 27N, Range 11W, San Juan County, New Mexico. The producing pools are the Basin Fruitland Coal and the Alice Bolack #5. Any questions should be directed to Holly Perkins at 505-564-6720 or by mail to 2700 Farmington Avenue, Suite K-1, Farmington, NM 87401. Any objection or request for a formal hearing should be filed in writing with the NMOCD's Santa Fe office within 20 days from date of this publication. In the absence of any objection, XTO has requested that the NMOCD approve its application administratively. The NMOCD's address is 1220 South St. Francis Drive, Santa Fe, NM 87505.

Sincerely,

A handwritten signature in black ink that reads 'Holly C. Perkins'. The signature is fluid and cursive, with the first letters of each word being capitalized.

Holly C. Perkins  
Regulatory Compliance Tech

xc: Well Files  
Ft. Worth Land Dept

|         |          |          |           |      |         |
|---------|----------|----------|-----------|------|---------|
| DATE IN | SUSPENSE | ENGINEER | LOGGED IN | TYPE | APP NO. |
|---------|----------|----------|-----------|------|---------|

ABOVE THIS LINE FOR DIVISION USE ONLY

**NEW MEXICO OIL CONSERVATION DIVISION**  
**- Engineering Bureau -**  
 1220 South St. Francis Drive, Santa Fe, NM 87505



**ADMINISTRATIVE APPLICATION CHECKLIST**

THIS CHECKLIST IS MANDATORY FOR ALL ADMINISTRATIVE APPLICATIONS FOR EXCEPTIONS TO DIVISION RULES AND REGULATIONS WHICH REQUIRE PROCESSING AT THE DIVISION LEVEL IN SANTA FE

**Application Acronyms:**

**[NSL-Non-Standard Location] [NSP-Non-Standard Proration Unit] [SD-Simultaneous Dedication]**  
**[DHC-Downhole Commingling] [CTB-Lease Commingling] [PLC-Pool/Lease Commingling]**  
**[PC-Pool Commingling] [OLS - Off-Lease Storage] [OLM-Off-Lease Measurement]**  
**[WFX-Waterflood Expansion] [PMX-Pressure Maintenance Expansion]**  
**[SWD-Salt Water Disposal] [IPI-Injection Pressure Increase]**  
**[EOR-Qualified Enhanced Oil Recovery Certification] [PPR-Positive Production Response]**

**[1] TYPE OF APPLICATION - Check Those Which Apply for [A]**

[A] Location - Spacing Unit - Simultaneous Dedication  
☐ NSL ☐ NSP ☐ SD

Check One Only for [B] or [C]

[B] Commingling - Storage - Measurement  
☐ DHC ☐ CTB ☐ PLC ☒ PC ☐ OLS ☐ OLM

[C] Injection - Disposal - Pressure Increase - Enhanced Oil Recovery  
☐ WFX ☐ PMX ☐ SWD ☐ IPI ☐ EOR ☐ PPR

[D] Other: Specify \_\_\_\_\_

**[2] NOTIFICATION REQUIRED TO: - Check Those Which Apply, or ☐ Does Not Apply**

[A] ☒ Working, Royalty or Overriding Royalty Interest Owners

[B] ☐ Offset Operators, Leaseholders or Surface Owner

[C] ☐ Application is One Which Requires Published Legal Notice

[D] ☒ Notification and/or Concurrent Approval by BLM or SLO  
 U.S. Bureau of Land Management - Commissioner of Public Lands, State Land Office

[E] ☐ For all of the above, Proof of Notification or Publication is Attached, and/or,

[F] ☐ Waivers are Attached

**[3] SUBMIT ACCURATE AND COMPLETE INFORMATION REQUIRED TO PROCESS THE TYPE OF APPLICATION INDICATED ABOVE.**

**[4] CERTIFICATION:** I hereby certify that the information submitted with this application for administrative approval is **accurate** and **complete** to the best of my knowledge. I also understand that **no action** will be taken on this application until the required information and notifications are submitted to the Division.

**Note:** Statement must be completed by an individual with managerial and/or supervisory capacity.

HOLLY C. PERKINS  
 Print or Type Name

*Holly C. Perkins*  
 Signature

REGULATORY COMPLIANCE TECH 12/20/04  
 Title Date

Holly\_perkins@xtoenergy.com  
 e-mail Address