

District I
1625 N French Dr, Hobbs, NM 88240
District II
1301 W Grand Avenue, Artesia, NM 88210
District III
1000 Rio Brazos Road, Aztec, NM 87410
District IV
1220 S St Francis Dr, Santa Fe, NM 87505

State of New Mexico
Energy Minerals and Natural Resources
Department
Oil Conservation Division
1220 South St. Francis Dr.
Santa Fe, NM 87505

Form C-144
July 21, 2008

For temporary pits, closed-loop systems, and below-grade tanks, submit to the appropriate NMOCD District Office.
For permanent pits and exceptions submit to the Santa Fe Environmental Bureau office and provide a copy to the appropriate NMOCD District Office

6774
**Pit, Closed-Loop System, Below-Grade Tank, or
Proposed Alternative Method Permit or Closure Plan Application**

Type of action: ☐ Permit of a pit, closed-loop system, below-grade tank, or proposed alternative method
☒ Closure of a pit, closed-loop system, below-grade tank, or proposed alternative method
☐ Modification to an existing permit
☐ Closure plan only submitted for an existing permitted or non-permitted pit, closed-loop system, below-grade tank, or proposed alternative method

Instructions: Please submit one application (Form C-144) per individual pit, closed-loop system, below-grade tank or alternative request

Please be advised that approval of this request does not relieve the operator of liability should operations result in pollution of surface water, ground water or the environment. Nor does approval relieve the operator of its responsibility to comply with any other applicable governmental authority's rules, regulations or ordinances.

1.
Operator: Williams Operating Co, LLC OGRID # 120782
Address: PO Box 640 / 721 S Main Aztec, NM 87410
Facility or well name Rosa Unit 35D
API Number. 30-04534989 OCD Permit Number
U/L or Qtr/Qtr P Section 5 Township 31N Range 6W County San Juan
Center of Proposed Design Latitude 36 92395N Longitude -107 47938W NAD ☐ 1927 ☒ 1983
Surface Owner: ☒ Federal ☐ State ☐ Private ☐ Tribal Trust or Indian Allotment

2
☒ **Pit:** Subsection F or G of 19 15 17 11 NMAC
Temporary: ☒ Drilling ☒ Workover
☐ Permanent ☐ Emergency ☐ Cavitation ☐ P&A
☒ Lined ☐ Unlined Liner type Thickness 20 mil ☒ LLDPE ☐ HDPE ☐ PVC ☐ Other
☒ String-Reinforced
Liner Seams: ☒ Welded ☒ Factory ☐ Other Volume 20,000 bbl Dimensions: L 140' x W 70' x D 12'

3.
☐ **Closed-loop System:** Subsection H of 19 15 17 11 NMAC
Type of Operation ☐ P&A ☐ Drilling a new well ☐ Workover or Drilling (Applies to activities which require prior approval of a permit or notice of intent)
☐ Drying Pad ☐ Above Ground Steel Tanks ☐ Haul-off Bins ☐ Other
☐ Lined ☐ Unlined Liner type. Thickness mil ☐ LLDPE ☐ HDPE ☐ PVC ☐ Other
Liner Seams ☐ Welded ☐ Factory ☐ Other

4.
☐ **Below-grade tank:** Subsection I of 19.15.17 11 NMAC
Volume. bbl Type of fluid:
Tank Construction material:
☐ Secondary containment with leak detection ☐ Visible sidewalls, liner, 6-inch lift and automatic overflow shut-off
☐ Visible sidewalls and liner ☐ Visible sidewalls only ☐ Other
Liner type. Thickness mil ☐ HDPE ☐ PVC ☐ Other

5.
☐ **Alternative Method:**
Submittal of an exception request is required Exceptions must be submitted to the Santa Fe Environmental Bureau office for consideration of approval

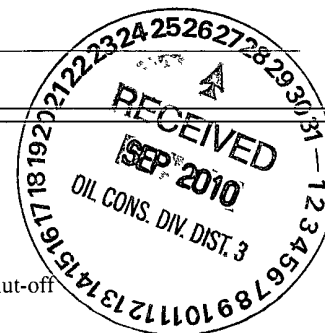

6.

Fencing: Subsection D of 19 15 17.11 NMAC (*Applies to permanent pits, temporary pits, and below-grade tanks*)

- ☐ Chain link, six feet in height, two strands of barbed wire at top (*Required if located within 1000 feet of a permanent residence, school, hospital, institution or church*)
- ☐ Four foot height, four strands of barbed wire evenly spaced between one and four feet
- ☒ Alternate Please specify As per BLM specifications

7

Netting: Subsection E of 19.15.17 11 NMAC (*Applies to permanent pits and permanent open top tanks*)

- ☐ Screen ☐ Netting ☐ Other _____
- ☐ Monthly inspections (If netting or screening is not physically feasible)

8

Signs: Subsection C of 19 15 17.11 NMAC

- ☐ 12"x 24", 2" lettering, providing Operator's name, site location, and emergency telephone numbers
- ☒ Signed in compliance with 19 15.3.103 NMAC

9

Administrative Approvals and Exceptions:

Justifications and/or demonstrations of equivalency are required Please refer to 19.15 17 NMAC for guidance.

Please check a box if one or more of the following is requested, if not leave blank:

- ☐ Administrative approval(s) Requests must be submitted to the appropriate division district or the Santa Fe Environmental Bureau office for consideration of approval
- ☐ Exception(s) Requests must be submitted to the Santa Fe Environmental Bureau office for consideration of approval.

10

Siting Criteria (regarding permitting): 19 15 17.10 NMAC

Instructions: The applicant must demonstrate compliance for each siting criteria below in the application. Recommendations of acceptable source material are provided below. Requests regarding changes to certain siting criteria may require administrative approval from the appropriate district office or may be considered an exception which must be submitted to the Santa Fe Environmental Bureau office for consideration of approval. Applicant must attach justification for request. Please refer to 19.15.17.10 NMAC for guidance. Siting criteria does not apply to drying pads or above-grade tanks associated with a closed-loop system.

Ground water is less than 50 feet below the bottom of the temporary pit, permanent pit, or below-grade tank - NM Office of the State Engineer - iWATERS database search, USGS, Data obtained from nearby wells	<input type="checkbox"/> Yes <input checked="" type="checkbox"/> No
Within 300 feet of a continuously flowing watercourse, or 200 feet of any other significant watercourse or lakebed, sinkhole, or playa lake (measured from the ordinary high-water mark) - Topographic map; Visual inspection (certification) of the proposed site	<input type="checkbox"/> Yes <input checked="" type="checkbox"/> No
Within 300 feet from a permanent residence, school, hospital, institution, or church in existence at the time of initial application. (Applies to temporary, emergency, or cavitation pits and below-grade tanks) - Visual inspection (certification) of the proposed site, Aerial photo, Satellite image	<input type="checkbox"/> Yes <input checked="" type="checkbox"/> No <input type="checkbox"/> NA
Within 1000 feet from a permanent residence, school, hospital, institution, or church in existence at the time of initial application (Applies to permanent pits) - Visual inspection (certification) of the proposed site, Aerial photo, Satellite image	<input type="checkbox"/> Yes <input type="checkbox"/> No <input checked="" type="checkbox"/> NA
Within 500 horizontal feet of a private, domestic fresh water well or spring that less than five households use for domestic or stock watering purposes, or within 1000 horizontal feet of any other fresh water well or spring, in existence at the time of initial application - NM Office of the State Engineer - iWATERS database search, Visual inspection (certification) of the proposed site	<input type="checkbox"/> Yes <input checked="" type="checkbox"/> No
Within incorporated municipal boundaries or within a defined municipal fresh water well field covered under a municipal ordinance adopted pursuant to NMSA 1978, Section 3-27-3, as amended - Written confirmation or verification from the municipality; Written approval obtained from the municipality	<input type="checkbox"/> Yes <input checked="" type="checkbox"/> No
Within 500 feet of a wetland. - US Fish and Wildlife Wetland Identification map, Topographic map, Visual inspection (certification) of the proposed site	<input type="checkbox"/> Yes <input checked="" type="checkbox"/> No
Within the area overlying a subsurface mine - Written confirmation or verification or map from the NM EMNRD-Mining and Mineral Division	<input type="checkbox"/> Yes <input checked="" type="checkbox"/> No
Within an unstable area - Engineering measures incorporated into the design, NM Bureau of Geology & Mineral Resources, USGS, NM Geological Society, Topographic map	<input type="checkbox"/> Yes <input checked="" type="checkbox"/> No
Within a 100-year floodplain - FEMA map	<input type="checkbox"/> Yes <input checked="" type="checkbox"/> No

11.

Temporary Pits, Emergency Pits, and Below-grade Tanks Permit Application Attachment Checklist: Subsection B of 19 15.17 9 NMAC**Instructions:** Each of the following items must be attached to the application. Please indicate, by a check mark in the box, that the documents are attached.

- ☒ Hydrogeologic Report (Below-grade Tanks) - based upon the requirements of Paragraph (4) of Subsection B of 19 15 17 9 NMAC
☒ Hydrogeologic Data (Temporary and Emergency Pits) - based upon the requirements of Paragraph (2) of Subsection B of 19 15 17.9 NMAC
☒ Siting Criteria Compliance Demonstrations - based upon the appropriate requirements of 19.15.17.10 NMAC
☒ Design Plan - based upon the appropriate requirements of 19 15 17 11 NMAC
☒ Operating and Maintenance Plan - based upon the appropriate requirements of 19 15 17.12 NMAC
☒ Closure Plan (Please complete Boxes 14 through 18, if applicable) - based upon the appropriate requirements of Subsection C of 19 15 17.9 NMAC and 19.15 17.13 NMAC

☐ Previously Approved Design (attach copy of design) API Number. _____ or Permit Number _____

12

Closed-loop Systems Permit Application Attachment Checklist: Subsection B of 19 15 17 9 NMAC**Instructions:** Each of the following items must be attached to the application. Please indicate, by a check mark in the box, that the documents are attached.

- ☐ Geologic and Hydrogeologic Data (only for on-site closure) - based upon the requirements of Paragraph (3) of Subsection B of 19 15 17 9
☐ Siting Criteria Compliance Demonstrations (only for on-site closure) - based upon the appropriate requirements of 19 15.17 10 NMAC
☐ Design Plan - based upon the appropriate requirements of 19 15 17 11 NMAC
☐ Operating and Maintenance Plan - based upon the appropriate requirements of 19 15 17 12 NMAC
☐ Closure Plan (Please complete Boxes 14 through 18, if applicable) - based upon the appropriate requirements of Subsection C of 19.15 17 9 NMAC and 19.15 17.13 NMAC

☐ Previously Approved Design (attach copy of design) API Number _____

☐ Previously Approved Operating and Maintenance Plan API Number. _____ (Applies only to closed-loop system that use above ground steel tanks or haul-off bins and propose to implement waste removal for closure)

13.

Permanent Pits Permit Application Checklist: Subsection B of 19 15 17.9 NMAC**Instructions:** Each of the following items must be attached to the application. Please indicate, by a check mark in the box, that the documents are attached.

- ☐ Hydrogeologic Report - based upon the requirements of Paragraph (1) of Subsection B of 19 15 17 9 NMAC
☐ Siting Criteria Compliance Demonstrations - based upon the appropriate requirements of 19.15.17 10 NMAC
☐ Climatological Factors Assessment
☐ Certified Engineering Design Plans - based upon the appropriate requirements of 19.15 17 11 NMAC
☐ Dike Protection and Structural Integrity Design - based upon the appropriate requirements of 19 15.17.11 NMAC
☐ Leak Detection Design - based upon the appropriate requirements of 19 15.17 11 NMAC
☐ Liner Specifications and Compatibility Assessment - based upon the appropriate requirements of 19 15 17.11 NMAC
☐ Quality Control/Quality Assurance Construction and Installation Plan
☐ Operating and Maintenance Plan - based upon the appropriate requirements of 19 15 17 12 NMAC
☐ Freeboard and Overtopping Prevention Plan - based upon the appropriate requirements of 19 15 17 11 NMAC
☐ Nuisance or Hazardous Odors, including H₂S, Prevention Plan
☐ Emergency Response Plan
☐ Oil Field Waste Stream Characterization
☐ Monitoring and Inspection Plan
☐ Erosion Control Plan
☐ Closure Plan - based upon the appropriate requirements of Subsection C of 19 15.17.9 NMAC and 19 15.17 13 NMAC

14.

Proposed Closure: 19 15 17 13 NMAC**Instructions:** Please complete the applicable boxes, Boxes 14 through 18, in regards to the proposed closure plan.

Type: ☒ Drilling ☐ Workover ☐ Emergency ☐ Cavitation ☐ P&A ☐ Permanent Pit ☐ Below-grade Tank ☐ Closed-loop System
☐ Alternative

Proposed Closure Method ☐ Waste Excavation and Removal
☐ Waste Removal (Closed-loop systems only)
☒ On-site Closure Method (Only for temporary pits and closed-loop systems)
☐ In-place Burial ☐ On-site Trench Burial
☐ Alternative Closure Method (Exceptions must be submitted to the Santa Fe Environmental Bureau for consideration)

15

Waste Excavation and Removal Closure Plan Checklist: (19.15.17.13 NMAC) **Instructions:** Each of the following items must be attached to the closure plan. Please indicate, by a check mark in the box, that the documents are attached.

- ☐ Protocols and Procedures - based upon the appropriate requirements of 19.15.17.13 NMAC
☐ Confirmation Sampling Plan (if applicable) - based upon the appropriate requirements of Subsection F of 19 15 17 13 NMAC
☐ Disposal Facility Name and Permit Number (for liquids, drilling fluids and drill cuttings)
☐ Soil Backfill and Cover Design Specifications - based upon the appropriate requirements of Subsection H of 19 15.17 13 NMAC
☐ Re-vegetation Plan - based upon the appropriate requirements of Subsection I of 19 15 17.13 NMAC
☐ Site Reclamation Plan - based upon the appropriate requirements of Subsection G of 19 15.17 13 NMAC

Waste Removal Closure For Closed-loop Systems That Utilize Above Ground Steel Tanks or Haul-off Bins Only: (19.15 17.13 D NMAC)

Instructions: Please identify the facility or facilities for the disposal of liquids, drilling fluids and drill cuttings. Use attachment if more than two facilities are required.

Disposal Facility Name: _____ Disposal Facility Permit Number _____
 Disposal Facility Name: _____ Disposal Facility Permit Number _____

Will any of the proposed closed-loop system operations and associated activities occur on or in areas that *will not* be used for future service and operations?

☐ Yes (If yes, please provide the information below) ☐ No

Required for impacted areas which will not be used for future service and operations:

- ☐ Soil Backfill and Cover Design Specifications - based upon the appropriate requirements of Subsection H of 19.15.17 13 NMAC
☐ Re-vegetation Plan - based upon the appropriate requirements of Subsection I of 19.15 17.13 NMAC
☐ Site Reclamation Plan - based upon the appropriate requirements of Subsection G of 19 15 17.13 NMAC

Siting Criteria (regarding on-site closure methods only): 19 15 17 10 NMAC

Instructions: Each siting criteria requires a demonstration of compliance in the closure plan. Recommendations of acceptable source material are provided below. Requests regarding changes to certain siting criteria may require administrative approval from the appropriate district office or may be considered an exception which must be submitted to the Santa Fe Environmental Bureau office for consideration of approval. Justifications and/or demonstrations of equivalency are required. Please refer to 19.15.17.10 NMAC for guidance.

Ground water is less than 50 feet below the bottom of the buried waste - NM Office of the State Engineer - iWATERS database search; USGS, Data obtained from nearby wells	<input type="checkbox"/> Yes <input checked="" type="checkbox"/> No <input type="checkbox"/> NA
Ground water is between 50 and 100 feet below the bottom of the buried waste - NM Office of the State Engineer - iWATERS database search, USGS, Data obtained from nearby wells	<input type="checkbox"/> Yes <input checked="" type="checkbox"/> No <input type="checkbox"/> NA
Ground water is more than 100 feet below the bottom of the buried waste - NM Office of the State Engineer - iWATERS database search, USGS; Data obtained from nearby wells	<input checked="" type="checkbox"/> Yes <input type="checkbox"/> No <input type="checkbox"/> NA
Within 300 feet of a continuously flowing watercourse, or 200 feet of any other significant watercourse or lakebed, sinkhole, or playa lake (measured from the ordinary high-water mark) - Topographic map; Visual inspection (certification) of the proposed site	<input type="checkbox"/> Yes <input checked="" type="checkbox"/> No
Within 300 feet from a permanent residence, school, hospital, institution, or church in existence at the time of initial application - Visual inspection (certification) of the proposed site; Aerial photo, Satellite image	<input type="checkbox"/> Yes <input checked="" type="checkbox"/> No
Within 500 horizontal feet of a private, domestic fresh water well or spring that less than five households use for domestic or stock watering purposes, or within 1000 horizontal feet of any other fresh water well or spring, in existence at the time of initial application. - NM Office of the State Engineer - iWATERS database; Visual inspection (certification) of the proposed site	<input type="checkbox"/> Yes <input checked="" type="checkbox"/> No
Within incorporated municipal boundaries or within a defined municipal fresh water well field covered under a municipal ordinance adopted pursuant to NMSA 1978, Section 3-27-3, as amended. - Written confirmation or verification from the municipality, Written approval obtained from the municipality	<input type="checkbox"/> Yes <input checked="" type="checkbox"/> No
Within 500 feet of a wetland. - US Fish and Wildlife Wetland Identification map; Topographic map, Visual inspection (certification) of the proposed site	<input type="checkbox"/> Yes <input checked="" type="checkbox"/> No
Within the area overlying a subsurface mine - Written confirmation or verification or map from the NM EMNRD-Mining and Mineral Division	<input type="checkbox"/> Yes <input checked="" type="checkbox"/> No
Within an unstable area - Engineering measures incorporated into the design, NM Bureau of Geology & Mineral Resources, USGS, NM Geological Society, Topographic map	<input type="checkbox"/> Yes <input checked="" type="checkbox"/> No
Within a 100-year floodplain - FEMA map	<input type="checkbox"/> Yes <input checked="" type="checkbox"/> No

On-Site Closure Plan Checklist: (19 15 17.13 NMAC) **Instructions:** Each of the following items must be attached to the closure plan. Please indicate, by a check mark in the box, that the documents are attached.

- ☒ Siting Criteria Compliance Demonstrations - based upon the appropriate requirements of 19.15 17 10 NMAC
☒ Proof of Surface Owner Notice - based upon the appropriate requirements of Subsection F of 19 15.17 13 NMAC
☐ Construction/Design Plan of Burial Trench (if applicable) based upon the appropriate requirements of 19.15.17 11 NMAC
☒ Construction/Design Plan of Temporary Pit (for in-place burial of a drying pad) - based upon the appropriate requirements of 19 15 17 11 NMAC
☒ Protocols and Procedures - based upon the appropriate requirements of 19 15 17.13 NMAC
☒ Confirmation Sampling Plan (if applicable) - based upon the appropriate requirements of Subsection F of 19.15.17.13 NMAC
☒ Waste Material Sampling Plan - based upon the appropriate requirements of Subsection F of 19.15 17.13 NMAC
☒ Disposal Facility Name and Permit Number (for liquids, drilling fluids and drill cuttings or in case on-site closure standards cannot be achieved)
☒ Soil Cover Design - based upon the appropriate requirements of Subsection H of 19.15.17 13 NMAC
☒ Re-vegetation Plan - based upon the appropriate requirements of Subsection I of 19 15 17.13 NMAC
☒ Site Reclamation Plan - based upon the appropriate requirements of Subsection G of 19.15.17 13 NMAC

19.

Operator Application Certification:

I hereby certify that the information submitted with this application is true, accurate and complete to the best of my knowledge and belief

Name (Print): _____ Title _____

Signature _____ Date: _____

e-mail address: _____ Telephone _____

20.

OCD Approval: ☐ Permit Application (including closure plan) ☒ Closure Plan (only) ☐ OCD Conditions (see attachment)

OCD Representative Signature: Jonathan D. Kelly Approval Date: 9/01/2011

Title: _____ OCD Permit Number: _____

21.

Closure Report (required within 60 days of closure completion): Subsection K of 19.15 17 13 NMAC

Instructions: Operators are required to obtain an approved closure plan prior to implementing any closure activities and submitting the closure report. The closure report is required to be submitted to the division within 60 days of the completion of the closure activities. Please do not complete this section of the form until an approved closure plan has been obtained and the closure activities have been completed.

☒ Closure Completion Date: 7/21/2010

22.

Closure Method:

☐ Waste Excavation and Removal ☒ On-Site Closure Method ☐ Alternative Closure Method ☐ Waste Removal (Closed-loop systems only)
☐ If different from approved plan, please explain

23.

Closure Report Regarding Waste Removal Closure For Closed-loop Systems That Utilize Above Ground Steel Tanks or Haul-off Bins Only:

Instructions: Please identify the facility or facilities for where the liquids, drilling fluids and drill cuttings were disposed. Use attachment if more than two facilities were utilized.

Disposal Facility Name _____ Disposal Facility Permit Number _____

Disposal Facility Name _____ Disposal Facility Permit Number _____

Were the closed-loop system operations and associated activities performed on or in areas that *will not* be used for future service and operations?

☐ Yes (If yes, please demonstrate compliance to the items below) ☐ No

Required for impacted areas which will not be used for future service and operations:

- ☐ Site Reclamation (Photo Documentation)
☐ Soil Backfilling and Cover Installation
☐ Re-vegetation Application Rates and Seeding Technique

24.

Closure Report Attachment Checklist: *Instructions: Each of the following items must be attached to the closure report. Please indicate, by a check mark in the box, that the documents are attached.*

- ☒ Proof of Closure Notice (surface owner and division)
☒ Proof of Deed Notice (required for on-site closure)
☒ Plot Plan (for on-site closures and temporary pits)
☒ Confirmation Sampling Analytical Results (if applicable)
☐ Waste Material Sampling Analytical Results (required for on-site closure)
☒ Disposal Facility Name and Permit Number
☒ Soil Backfilling and Cover Installation
☒ Re-vegetation Application Rates and Seeding Technique
☒ Site Reclamation (Photo Documentation)

On-site Closure Location Latitude 36 92395N Longitude -107 47938W NAD: ☐ 1927 ☒ 1983

25.

Operator Closure Certification:

I hereby certify that the information and attachments submitted with this closure report is true, accurate and complete to the best of my knowledge and belief. I also certify that the closure complies with all applicable closure requirements and conditions specified in the approved closure plan

Name (Print) Michael K Lane Title: Sr EH&S Specialist

Signature: [Signature] Date: 9/23/10

e-mail address: myke.lane@williams.com Telephone 505-634-4219

Williams Production Co., LLC
San Juan Basin: New Mexico Assets
Temporary Pit In-place Closure Report
Drilling/Completion and Workover
(Groundwater >100 feet bgs)

Well: Rosa Unit # 035D
API No: 30-04534989
Location: P S05 T 312N R 06W

In accordance with Rule 19.15.17.13 NMAC, the following plan describes the general in-place closure requirements of temporary pits on Williams Production Co, LLC (WPX) locations in the San Juan Basin of New Mexico. This is WPX's standard procedure for all temporary pits to be utilized for the drilling, completion and/or workovers of oil and gas wells operated by WPX. For those temporary pits which do not conform to this standard closure plan, a separate well/pit specific closure plan will be developed and utilized.

All closure activities will include proper documentation and will be submitted to OCD within 60 days of the pit closure on a Closure Report using Division Form C-144. The Report will include the following:

- Details on Capping and Covering, where applicable
- Plot Plan (Pit Diagram)
- Inspection reports
- Sampling Results
- Division Form C-105: WELL COMPLETION OR RECOMPLETION REPORT AND LOG
- Copy of Deed Notice filed with the County Clerk (format to meet County requirements)
A deed notice is not required on state, federal or tribal land according to NMOCD FAQ dated October 30, 2008 and posted on the NMOCD website

General Plan Requirements:

- 1 All free standing liquids will be removed from the pit at the start of the closure process. Liquids will be removed in a manner that the appropriate District Office approves including; recycled, reused, reclaimed, evaporated, and/or disposed of in a Division-approved facility. Once all free liquids are removed, the sludge will be stabilized by one of the following methods depending on equipment availability: blending with clean stockpiled soils or dewatering using a Bowl Decanter Centrifuge then blending with clean stockpiled soils
To the extent practical, free liquids were pulled from the reserve pit following the completion rig off. Haul date was 11/14/2009 to Rosa Unit SWD #001 (Order: SWD-916, API: 3003927055).
2. The preferred method of closure for all temporary pits will be on-site closure by in-place burial, provided all the criteria in 19.15.17 13.B are met.
On-site burial plan for this location was approved by the Aztec District Office on (7/7/2009).
- 3 The surface owner shall be notified of WPX's proposed closure plan using a means that provides proof of notice (i.e. certified mail/return receipt requested)
Williams notified the SMA of its intent to use a temporary pit and onsite burial in the Surface Use Plan in the well APD. The SMA was notified by email see attached. No return receipt required per BLM:FFO/NMOCD MOU dated 5/4/09.
- 4 Within six months of the "rig-off" status occurring WPX will ensure that the temporary pit is covered, recontoured and reseeding in progress
Drill rig-off (8/28/2009) Request for transfer to completion rig submitted (7/31/2010) to OCD Aztec District Office, Completion rig-off (11/4/2009). Pit covered (7/21/2010) Pit area along with unused portions of well pad to be interim reclaimed in accordance with Surface Management Agency requirements in APD-COAs and per BLM:FFO/NMOCD MOU dated 5/4/09.
- 5 Notice of Closure will be given to the Aztec District office between 72 hours and one week of the scheduled closure via email or phone. The notification of closure will include the following:
 - a. Operators Name (WPX)
 - b. Well Name and API Number
 - c. Location (USTR)

The Aztec District Office of NMOCD was notified by email using a format acceptable to the District. Copies of the notification from Abode Contractors on (7/21/2010) are attached.

- 6 The pit liner shall be removed above "mud level" after stabilization. Removal of the liner will consist of manually or mechanically cutting the liner at the mud level and removing all remaining liner. Care will be taken to remove "all" of the liner (i.e. anchored material). All excessive liner will be disposed of at a licensed disposal facility (probably San Juan Regional Landfill operated by Waste Management under NMED Permit SWM-052426).
The liner to the temporary pit was removed above the "mud level" once stabilized. Removal of the liner consisted of manually cutting the liner and removing all remaining liner material above the "mud level" including the anchor material. All excessive liner was disposed of at the San Juan Regional Landfill operated by Waste Management under NMED Permit SWM-052426.
- 7 Solidification of the remaining pit contents shall be achieved by mixing non-waste containing, earthen material. The solidification process will be accomplished use a combination of natural drying and mechanical mixing. Pit contents will be mixed with non-waste, earthen material to a consistency that is deemed safe and stable. The mixing ratio shall not exceed 3 parts non-waste to 1 part pit contents.
8. Following removal of free liquids, the pit contents were solidified using a Bowl Decanter Centrifuge. As the waste contents of the pit did not provide sufficient space to place the required four-foot cover, a portion of the waste was transported to the Bondad Landfill, La Plata Co, Colorado and operated by Waste Corporation of America under CDPHE Permit CRS 30-20112. The remaining oil contents were stabilized by mixing non-waste containing earthen material in order to achieve a consistency that was deemed safe and stable. The mixing ration was approximately 2.5 part native soil to 1 part pit contents. Solidification was completed on(7/18/10).
9. A five-point composite sample will be taken of the pit using sampling tools and all samples tested per 19.15.17 13(B)(1)(b) NMAC. In the event that the criteria are not met (See Table 1), all contents will be handled per 19.15.17.13(B)(1)(a) (i.e. dig and haul to a Division-approved facility). Approval to haul will be requested of the Aztec District office prior to initiation.
A five-point composite sampling was taken of the pit area using sampling tools and the sample was tested per 19.15.17 13(B)(1)(b) NMAC. Results are shown in Table 1 and lab reports are attached.

Table 1: Closure Criteria for Temporary Pits in Non-sensitive Areas with Groundwater >100 bgs

Components	Testing Methods	Limits (mg/Kg)	Pit (mg/Kg)
Benzene	EPA SW-846 Method 8021B or 8260B	0.2	0.003
BTEX	EPA SW-846 Method 8021B or 8260B	50	0.0939
TPH	EPA SW-846 Method 418.1	2500	179
GRO/DRO	EPA SW-846 Method 8015M (GRO/DRO)	500	ND
Chlorides	EPA SW-846 Method 300.1	500	45

- 10 Upon completion of solidification and testing, the pit area will be backfilled with non-waste earthen material compacted to native conditions to enable effective revegetation for successful evapotranspiration. A minimum of four feet of cover including replacement of one foot of suitable material to establish vegetation, or the background thickness of topsoil, whichever is greater.
Upon completion of solidification and testing, the pit area was backfilled with non-waste earthen material compacted to native conditions. A minimum of four feet of cover to the extent practical was achieved and the cover included just over a foot of topsoil suitable to establish vegetation.
- 11 Following cover, the site will be recontoured to meet the Surface Management Agency or surface owner requirements. Re-contouring will attempt to match fit, shape, line form, and texture of the surrounding geography. Re-shaping will include drainage control, prevent ponding, and minimize erosion. Natural drainages will be unimpeded and stormwater Best Management Practices (BMPs) will be used to aid in soil stabilization and protection surface water quality.
Following cover, Williams reestablished drainage and contours to approximately match previous topography meeting the Conditions of Approval in the APD and the direction offered by a BLM/USFS inspector. Cover and re-contouring were completed (7/21/2010).
12. Notification will be sent to the Aztec District office when the reclaimed area is seeded. Williams will comply with Surface Management Agency reseeding requirements in the COAs of the APD for the referenced well, per BLM:FFO/NMOCD MOU dated 5/4/09.

(un-impacted) consisting of at least three native plant species, including at least one grass, but not including noxious weeds, and maintained that cover through two successive growing seasons. Repeat seeding or planting will be continued until successful vegetative growth occurs. *Note: WPX assumes the seeding stipulations including mix and seeding methods specified by the Surface Management Agency (BLM, BOR, USFS, Tribal, etc.) or Land owner as part of a surface use agreement or APD are Division-approved methods unless notified by the Division of their unacceptability.*

Williams will comply with Surface Management Agency reseeding requirements in the COAs of the APD for the referenced well, per BLM:FFO/NMOCD MOU dated 5/4/09.

13. The temporary pit will be located with a steel marker, no less than four inches in diameter, cemented in a hole three feet deep in the center of the onsite burial upon the abandonment of all wells on the pad. The marker will be flush with the ground to allow access of the active well pad and for safety concerns. The marker will include a threaded collar to be used for future abandonment. The top of the marker will contain a welded steel 12" square plate that indicates the onsite burial of the temporary pit. The plate will be easily removable and a four-foot tall riser will be threaded into the top of the collar marker and welded around the base with the operations information at the time of all wells on the pad abandoned. The information will include Operator Name, Lease Name, Well Name, and number, USTR, and an indicator that the marker is an onsite pit burial location.

The temporary pit was located with a steel marker meeting the above listed specifications. The marker has the following information welded for future reference: Williams Production, NMSF-078768, S05-T31N-R06W-F, "Pit Burial" (photo attached). Steel marker set 7/21/10.

WILLIAMS PRODUCTION COMPANY ROSA UNIT #35D
1020' FSL & 705' FEL, SECTION 5, T31N, R6W, NMPM
SAN JUAN COUNTY, NEW MEXICO ELEVATION: 6332'

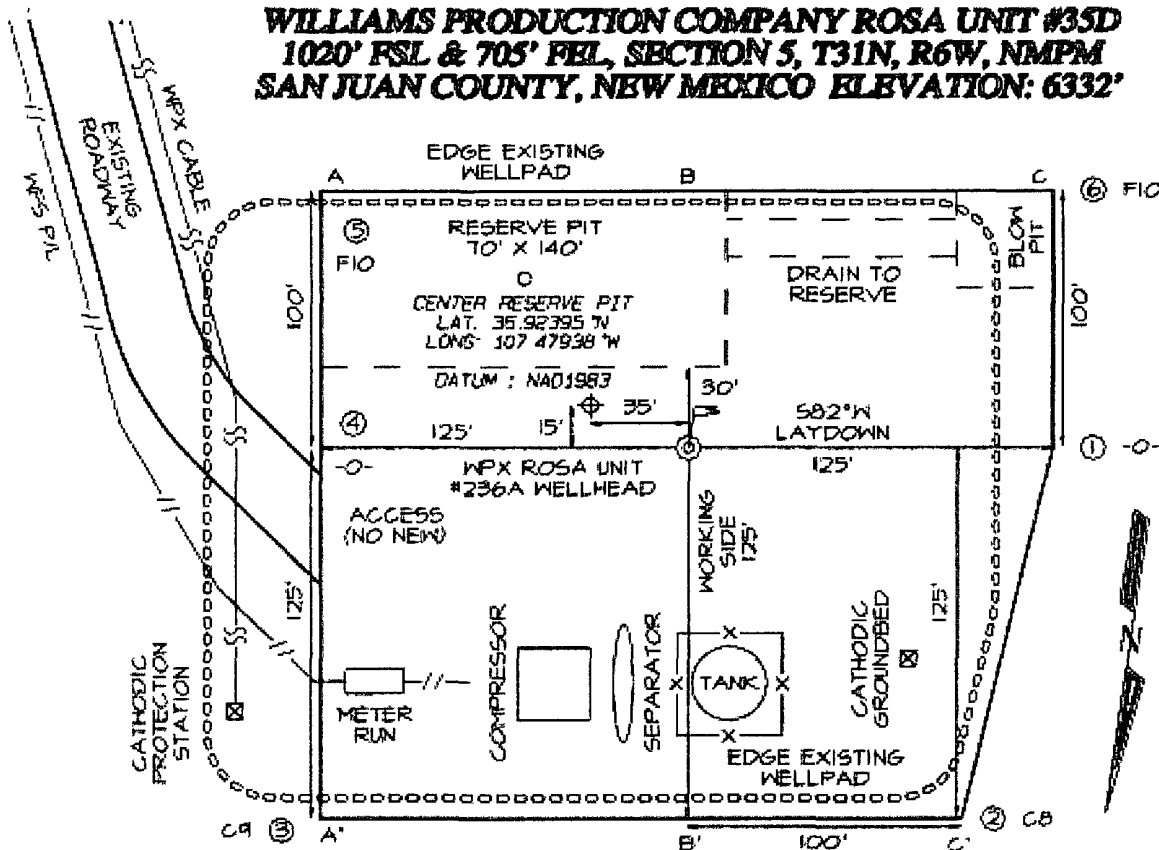

LATITUDE: 36.92410° N
LONGITUDE: 107.47959° W
 DATUM: NAD1983

Steel T-Posts have been set to define the Edge of Disturbance limits which are 50' offset from the edge of the stacked wellpad.

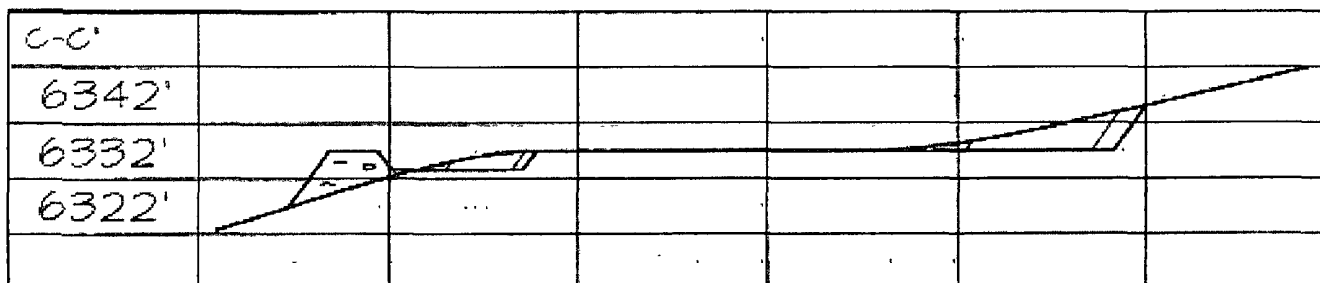
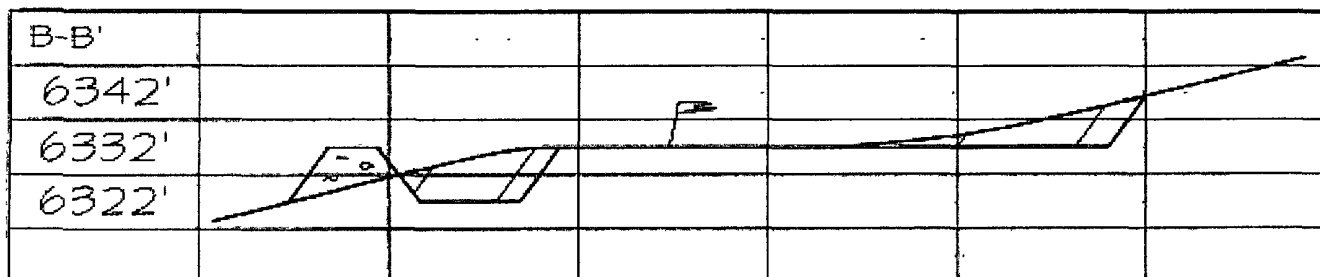
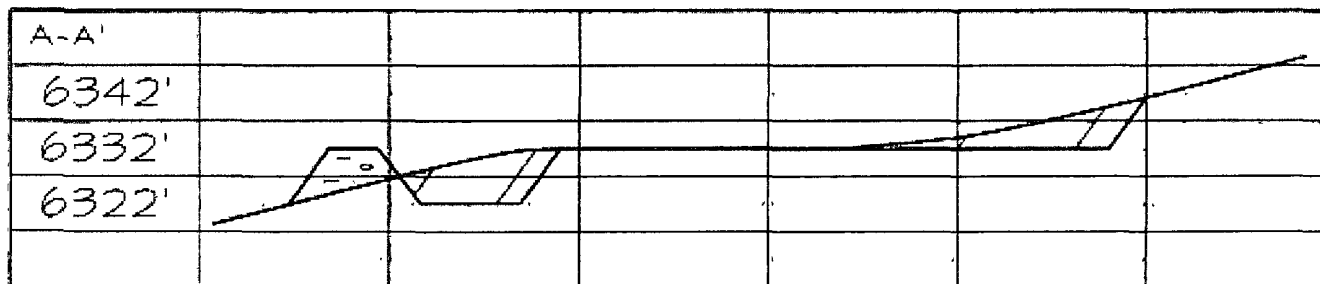

FILENAME: 3165PT

SHEET 2 OF 3

NCE SURVEYS, INC.

DRAWN BY: EDO

CHECKED BY: JCE



EPA METHOD 8015 Modified
Nonhalogenated Volatile Organics
Total Petroleum Hydrocarbons

Client:	WPX	Project #:	04108-0136
Sample ID:	Reserve Pit	Date Reported:	08-18-10
Laboratory Number:	55576	Date Sampled:	08-13-10
Chain of Custody No:	10195	Date Received:	08-16-10
Sample Matrix:	Soil	Date Extracted:	08-16-10
Preservative:	Cool	Date Analyzed:	08-17-10
Condition:	Intact	Analysis Requested:	8015 TPH

Parameter	Concentration (mg/Kg)	Det. Limit (mg/Kg)
Gasoline Range (C5 - C10)	ND	0.2
Diesel Range (C10 - C28)	ND	0.1
Total Petroleum Hydrocarbons	ND	0.2

ND - Parameter not detected at the stated detection limit.

References: Method 8015B, Nonhalogenated Volatile Organics, Test Methods for Evaluating Solid Waste, SW-846, USEPA, December 1996.

Comments: **Rosa Unit #35D**

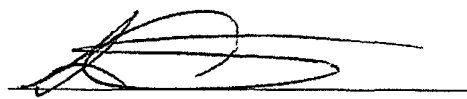
Analyst

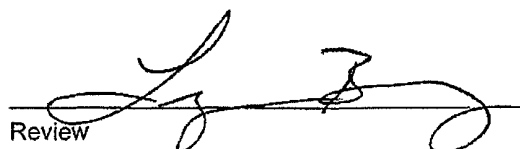
Review



EPA Method 8015 Modified
Nonhalogenated Volatile Organics
Total Petroleum Hydrocarbons

Quality Assurance Report

Client:	QA/QC	Project #:	N/A
Sample ID:	08-17-10 QA/QC	Date Reported:	08-17-10
Laboratory Number:	55571	Date Sampled:	N/A
Sample Matrix:	Methylene Chloride	Date Received:	N/A
Preservative:	N/A	Date Analyzed:	08-17-10
Condition:	N/A	Analysis Requested:	TPH

	I-Cal Date	I-Cal RF	C-Cal RF	% Difference	Accept Range
Gasoline Range C5 - C10	08-17-10	9.9960E+002	1.0000E+003	0.04%	0 - 15%
Diesel Range C10 - C28	08-17-10	9.9960E+002	1.0000E+003	0.04%	0 - 15%

Blank Conc. (mg/L - mg/Kg)	Concentration	Detection Limit
Gasoline Range C5 - C10	ND	0.2
Diesel Range C10 - C28	ND	0.1
Total Petroleum Hydrocarbons	ND	0.2

Duplicate Conc. (mg/Kg)	Sample	Duplicate	% Difference	Accept Range
Gasoline Range C5 - C10	ND	ND	0.0%	0 - 30%
Diesel Range C10 - C28	ND	ND	0.0%	0 - 30%

Spike Conc. (mg/Kg)	Sample	Spike Added	Spike Result	% Recovery	Accept Range
Gasoline Range C5 - C10	ND	250	257	103%	75 - 125%
Diesel Range C10 - C28	ND	250	252	101%	75 - 125%

ND - Parameter not detected at the stated detection limit.

References: Method 8015B, Nonhalogenated Volatile Organics, Test Methods for Evaluating Solid Waste, SW-846, USEPA, December 1996.

Comments: QA/QC for Samples 55571-55576

Analyst

Review



EPA METHOD 8021
AROMATIC VOLATILE ORGANICS

Client:	WPX	Project #:	04108-0136
Sample ID:	Reserve Pit	Date Reported:	08-18-10
Laboratory Number:	55576	Date Sampled:	08-13-10
Chain of Custody:	10195	Date Received:	08-16-10
Sample Matrix:	Soil	Date Analyzed:	08-17-10
Preservative:	Cool	Date Extracted:	08-16-10
Condition:	Intact	Analysis Requested:	BTEX

Parameter	Concentration (ug/Kg)	Det. Limit (ug/Kg)
Benzene	3.0	0.9
Toluene	21.8	1.0
Ethylbenzene	6.1	1.0
p,m-Xylene	45.4	1.2
o-Xylene	17.6	0.9
Total BTEX	93.9	

ND - Parameter not detected at the stated detection limit.

Surrogate Recoveries:	Parameter	Percent Recovery
	Fluorobenzene	103 %
	1,4-difluorobenzene	98.0 %
	Bromochlorobenzene	98.8 %

References: Method 5030B, Purge-and-Trap, Test Methods for Evaluating Solid Waste, SW-846, USEPA, December 1996.

Method 8021B, Aromatic Volatile Organics, Test Methods for Evaluating Solid Waste, SW-846, USEPA, December 1996.

Comments: Rosa Unit #35D

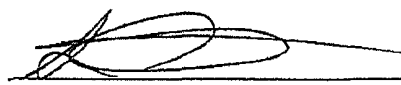

Analyst

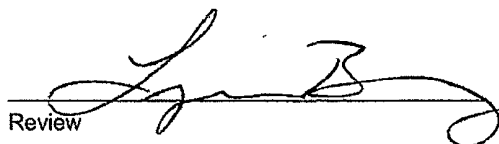

Review



**EPA METHOD 8021
AROMATIC VOLATILE ORGANICS**

Client:	N/A	Project #:	N/A
Sample ID:	0817BBLK QA/QC	Date Reported:	08-17-10
Laboratory Number:	55571	Date Sampled:	N/A
Sample Matrix:	Soil	Date Received:	N/A
Preservative:	N/A	Date Analyzed:	08-17-10
Condition:	N/A	Analysis:	BTEX

Calibration and Detection Limits (ug/L)	I-Cal:RF	C-Cal:RF	%Diff	Blank Conc	Detect Limit
		Accept Range: 0 - 15%			
Benzene	8.3627E+005	8.3795E+005	0.2%	ND	0.1
Toluene	9.3497E+005	9.3684E+005	0.2%	ND	0.1
Ethylbenzene	8.6362E+005	8.6535E+005	0.2%	ND	0.1
p,m-Xylene	2.1295E+006	2.1338E+006	0.2%	ND	0.1
o-Xylene	7.6544E+005	7.6697E+005	0.2%	ND	0.1

Duplicate Conc. (ug/Kg)	Sample	Duplicate	%Diff	Accept Range	Detect Limit
Benzene	ND	ND	0.0%	0 - 30%	0.9
Toluene	ND	ND	0.0%	0 - 30%	1.0
Ethylbenzene	ND	ND	0.0%	0 - 30%	1.0
p,m-Xylene	ND	ND	0.0%	0 - 30%	1.2
o-Xylene	ND	ND	0.0%	0 - 30%	0.9

Spike Conc. (ug/Kg)	Sample	Amount Spiked	Spiked Sample	% Recovery	Accept Range
Benzene	ND	50.0	50.1	100%	39 - 150
Toluene	ND	50.0	50.4	101%	46 - 148
Ethylbenzene	ND	50.0	49.2	98.3%	32 - 160
p,m-Xylene	ND	100	100	100%	46 - 148
o-Xylene	ND	50.0	50.2	100%	46 - 148

ND - Parameter not detected at the stated detection limit.

References. Method 5030B, Purge-and-Trap, Test Methods for Evaluating Solid Waste, SW-846, USEPA, December 1996.
Method 8021B, Aromatic and Halogenated Volatiles by Gas Chromatography Using Photoionization and/or Electrolytic Conductivity Detectors, SW-846, USEPA December 1996.

Comments: QA/QC for Samples 55571-55576, 55548-55550



Analyst



Review



EPA METHOD 418.1
TOTAL PETROLEUM
HYDROCARBONS

Client:	WPX	Project #:	04108-0136
Sample ID:	Reserve Pit	Date Reported:	08-18-10
Laboratory Number:	55576	Date Sampled:	08-13-10
Chain of Custody No:	10195	Date Received:	08-16-10
Sample Matrix:	Soil	Date Extracted:	08-18-10
Preservative:	Cool	Date Analyzed:	08-18-10
Condition:	Intact	Analysis Needed:	TPH-418.1

Parameter	Concentration (mg/kg)	Det. Limit (mg/kg)
Total Petroleum Hydrocarbons	179	39.5

ND = Parameter not detected at the stated detection limit.

References: Method 418.1, Petroleum Hydrocarbons, Total Recoverable, Chemical Analysis of Water and Waste, USEPA Storet No. 4551, 1978.

Comments: Rosa Unit #35D

Analyst

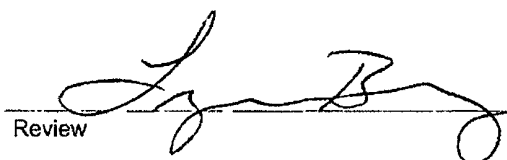
Review



EPA METHOD 418.1
TOTAL PETROLEUM
HYDROCARBONS
QUALITY ASSURANCE REPORT

Client:	QA/QC	Project #:	N/A
Sample ID:	QA/QC	Date Reported:	08-18-10
Laboratory Number:	08-18-TPH.QA/QC 55574	Date Sampled:	N/A
Sample Matrix:	Freon-113	Date Analyzed:	08-18-10
Preservative:	N/A	Date Extracted:	08-18-10
Condition:	N/A	Analysis Needed:	TPH

Calibration	I-Cal Date	C-Cal Date	I-Cal RF:	C-Cal RF:	% Difference	Accept. Range
	07-29-10	08-18-10	1,860	1,770	4.8%	+/- 10%

Blank Conc. (mg/Kg)	Concentration	Detection Limit
TPH	ND	39.5

Duplicate Conc. (mg/Kg)	Sample	Duplicate	% Difference	Accept. Range
TPH	66.3	67.7	2.1%	+/- 30%

Spike Conc. (mg/Kg)	Sample	Spike Added	Spike Result	% Recovery	Accept Range
TPH	66.3	2,000	2,010	97.3%	80 - 120%

ND = Parameter not detected at the stated detection limit.

References: Method 418.1, Petroleum Hydrocarbons, Total Recoverable, Chemical Analysis of Water and Waste, USEPA Storet No. 4551, 1978.

Comments: QA/QC for Samples 55574-55576

Analyst

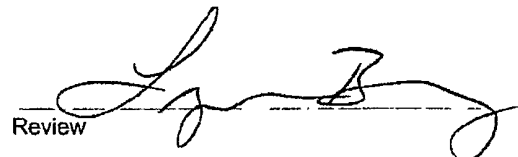
Review



envirotech
Analytical Laboratory

Chloride

Client:	WPX	Project #:	04108-0136
Sample ID:	Reserve Pit	Date Reported:	08-18-10
Lab ID#:	55576	Date Sampled:	08-13-10
Sample Matrix:	Soil	Date Received:	08-16-10
Preservative:	Cool	Date Analyzed:	08-17-10
Condition:	Intact	Chain of Custody:	10195

Parameter	Concentration (mg/Kg)
-----------	-----------------------

Total Chloride

45

Reference: U.S.E.P.A., 4500B, "Methods for Chemical Analysis of Water and Wastes", 1983.
Standard Methods For The Examination of Water And Waste Water", 18th ed., 1992.

Comments: Rosa Unit #35D

Analyst

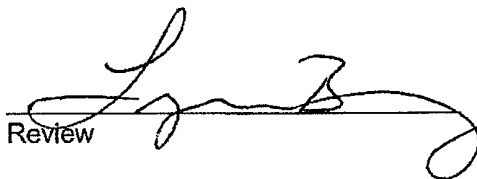
Review

CHAIN OF CUSTODY RECORD

10195

Client: WPX			Project Name / Location: Rosa unit # 35 D			ANALYSIS / PARAMETERS																																																	
Client Address: myke Lane			Sampler Name: Johnny Stinson			<table border="1"> <tr> <td>TPH (Method 8015)</td> <td>BTEX (Method 8021)</td> <td>VOC (Method 8260)</td> <td>RCRA 8 Metals</td> <td>Cation / Anion</td> <td>RCI</td> <td>TCLP with H/P</td> <td>PAH</td> <td>TPH (418.1)</td> <td>CHLORIDE</td> <td></td> <td></td> <td></td> <td></td> <td></td> <td></td> <td>Sample Cool</td> <td>Sample Intact</td> </tr> <tr> <td></td> <td></td> <td></td> <td></td> <td></td> <td></td> <td></td> <td></td> <td></td> <td></td> <td></td> <td></td> <td></td> <td></td> <td></td> <td></td> <td></td> <td></td> </tr> </table>														TPH (Method 8015)	BTEX (Method 8021)	VOC (Method 8260)	RCRA 8 Metals	Cation / Anion	RCI	TCLP with H/P	PAH	TPH (418.1)	CHLORIDE							Sample Cool	Sample Intact																		
TPH (Method 8015)	BTEX (Method 8021)	VOC (Method 8260)	RCRA 8 Metals	Cation / Anion	RCI															TCLP with H/P	PAH	TPH (418.1)	CHLORIDE							Sample Cool	Sample Intact																								
Client Phone No.:			Client No.: 04108-0136																																																				
Sample No./ Identification	Sample Date	Sample Time	Lab No.	Sample Matrix	No./Volume of Containers	Preservative																																																	
						HgCl ₂	HCl																																																
Reserve Pit	8-13-10	1:00 PM	55576	Soil Solid	1				✓	✓							✓	✓							Y	Y																													
				Soil Solid																																																			
				Soil Solid																																																			
				Soil Solid																																																			
				Soil Solid																																																			
				Soil Solid																																																			
				Soil Solid																																																			
				Soil Solid																																																			
				Soil Solid																																																			
				Soil Solid																																																			
				Soil Solid																																																			
				Soil Solid																																																			
Relinquished by: (Signature) <i>[Signature]</i>					Date 8-16-10	Time 10:10 AM	Received by: (Signature) <i>[Signature]</i>					Date 8-16-10	Time 10:15 AM																																										
Relinquished by: (Signature)							Received by: (Signature)																																																
Relinquished by: (Signature)							Received by: (Signature)																																																



5796 US Highway 64 • Farmington, NM 87401 • 505-632-0615 • lab@envirotech-inc.com

Meador, Tasha

From: johnny@adobecontractorsinc.com
Sent: Monday, July 19, 2010 9:14 AM
To: Brandon Powell; Bill Liess; Mark Kelly; Randy Mckee; Robert Switzer, Sherrie Landon
Cc: glenn@adobecontractorsinc.com; Lane, Myke; Meador, Tasha
Subject: Williams clean ups Rosa Unit #35D

Due to OCD timeline requirements, we are going to start hauling pit material out and closing the pit on the Rosa Unit #35D Wednesday 7/21 instead of the Rosa unit #180D. We will start the 180D at a later date. Please let Glen Shelby or I know if you have any questions.

Thank you,

Johnny Stinson
Gen. Manager/ Adobe Contractors
Office: (505)632-1486
Mobile: (505)320-6076
johnny@adobecontractorsinc.com

7/19/2010

UNITED STATES
DEPARTMENT OF INTERIOR
BUREAU OF LAND MANAGEMENT

FORM APPROVED
Budget Bureau No 1004-0135
Expires March 31, 1993

SUNDRY NOTICE AND REPORTS ON WELLS

Do not use this form for proposals to drill or to deepen or reentry to a different reservoir Use "APPLICATION TO DRILL" for permit for such proposals

5 Lease Designation and Serial No
NMSF-078765

6 If Indian, Allottee or Tribe Name

SUBMIT IN TRIPLICATE

7 If Unit or CA, Agreement Designation
Rosa Unit

1 Type of Well
Oil Well Gas Well ☒ Other

8 Well Name and No
Rosa Unit 035D

2 Name of Operator
WILLIAMS PRODUCTION COMPANY

9 API Well No
30-045-34989

3 Address and Telephone No
PO Box 640 Aztec, NM 87410-0640

10 Field and Pool, or Exploratory Area
BLANCO MV/BASIN DK/BASIN MC

4 Location of Well (Footage, Sec , T , R , M , or Survey Description)
1020' FSL & 705' FEL
1281' FSL & 320' FEL SEC 5 31N 6W

11 County or Parish, State
San Juan New Mexico

CHECK APPROPRIATE BOX(s) TO INDICATE NATURE OF NOTICE, REPORT, OR OTHER DATA

TYPE OF SUBMISSION

TYPE OF ACTION

Notice of Intent

☒ Subsequent Report

Final Abandonment

Abandonment

Recompletion

Plugging Back

Casing Repair

Altering Casing

☒ Other Completion

Change of Plans

New Construction

Non-Routine Fracturing

Water Shut-Off

Conversion to Injection

Dispose Water

(Note Report results of multiple completion
on Well Completion or Recompletion Report
and Log form)

13 Describe Proposed or Completed Operations (Clearly state all pertinent details, and give pertinent dates, including estimated date of starting any proposed work If well is directionally drilled, give subsurface locations and measured and true vertical depths for all markers and zones pertinent to this work)*

8-31-09 – MIRU AWS #880 – Pressure 5-1/2" production casing to 1500 psi for 30 minutes with 30 psi leak off Run CBL, TOC @ 5610'

9-1-09 – DO cement and FC to PBTD @ 8007'

9-2-09 – RDMO AWS #880

9-21-09 – Rigless – Perf Dakota, 7847'-7989', with 84, 0 3/4" holes Frac Dakota with 4600# 100 mesh BASF followed with 99,900# 40/70 BASF Set Flo-thru BP @ 7500' Perf lower Mancos, 7078'-7382', with 66, 0 3/4" holes

9-22-09 – Frac lower Mancos with 5654# 100 mesh BASF followed with 100,046# 40/70 BASF Set Flo-thru BP @ 7040' Perf upper Mancos, 6837'-7008', with 63, 0 3/4" holes Frac upper Mancos with 4803# 100 mesh BASF followed with 105,019# 40/70 BASF

14 I hereby certify that the foregoing is true and correct

Signed _____
Heather Riley

Title Regulatory Specialist Date 11/5/09

(This space for Federal or State office use)

Approved by _____ Title _____ Date _____

Conditions of approval, if any

Title 18 U S C Section 1001, makes it a crime for any person knowingly and willfully to make to any department or agency of the United States any false, fictitious or fraudulent statements or representations as to any matter within its jurisdiction

UNITED STATES
DEPARTMENT OF THE INTERIOR
BUREAU OF LAND MANAGEMENT

SUBMIT IN
DUPLICATE

(See other instructions on
reverse side)

FORM APPROVED
OMB NO 1004-0137
Expires February 28, 1995

5 LEASE DESIGNATION AND LEASE NO
NMSF-078765

6 IF INDIAN, ALLOTTEE OR

WELL COMPLETION OR RECOMPLETION REPORT AND LOG*

7 UNIT AGREEMENT NAME

Rosa Unit

1a TYPE OF WELL 1 OIL WELL ☒ GAS WELL DRY OTHER

b TYPE OF COMPLETION
☒ NEW WELL WORKOVER DEEPEN PLUG BACK DIFF RESVR OTHER

2 NAME OF OPERATOR
WILLIAMS PRODUCTION COMPANY

8 FARM OR LEASE NAME, WELL NO
Rosa Unit #35D

3 ADDRESS AND TELEPHONE NO
P O Box 640, Aztec, NM 87410 (505) 634-4208

9 API WELL NO

30-045-34989

4 LOCATION OF WELL (Report location clearly and in accordance with any State requirements)*
At Surface 1020' FSL & 705' FEL, sec 5, T31N, R6W
At top production interval reported below 1281' FSL & 320' FEL, sec 5, T31N, R6W
At total depth Same

10 FIELD AND POOL, OR WILDCAT
Basin Dakota

11 SEC, T, R, M, OR BLOCK AND
SURVEY OR AREA
Sec 5, T31N, R6W

14 PERMIT NO

DATE ISSUED

12 COUNTY OR

13 STATE

San Juan

New Mexico

15 DATE
SPUDDED
8-1-09

16 DATE T D
REACHED
8-26-09

17 DATE COMPLETED (READY TO PRODUCE)
11/3/09

18 ELEVATIONS (DK, RKB, RT, GR, ETC)*
6332' GR

19 ELEVATION CASINGHEAD

20 TOTAL DEPTH, MD & TVD
8013' MD / 7974' TVD

21 PLUG, BACK T D, MD & TVD
8007' MD / 7968' TVD

22 IF MULTICOMP,
HOW MANY
3*

23 INTERVALS
DRILLED BY

ROTARY TOOLS
x

CABLE TOOLS

24 PRODUCING INTERVAL(S), OF THIS COMPLETION - TOP, BOTTOM, NAME (MD AND TVD)*

BASIN DAKOTA 7847' - 7989' MD

Commingled with MV & MC per AZT-3244

25 WAS DIRECTIONAL SURVEY MADE

YES

26 TYPE ELECTRIC AND OTHER LOGS RUN

Pulsed Neutron Decay Log and CBL

27 WAS WELL CORED

No

28 CASING REPORT (Report all strings set in well)

CASING SIZE/GRADE	WEIGHT, LB /FT	DEPTH SET (MD)	HOLE SIZE	TOP OF CEMENT, CEMENTING RECORD	AMOUNT PULLED
10-3/4", J-55	40 5#	354'	14-3/4"	290 SX - SURFACE	
7-5/8", K-55	26 4#	3585'	9-7/8"	555 SX - SURFACE	
5-1/2", N-80	17 0#	8012'	6-3/4"	360 SX - 2850' (CBL)	

29 LINER RECORD

SIZE	TOP (MD)	BOTTOM (MD)	SACKS CEMENT*	SCREEN (MD)	SIZE	DEPTH SET (MD)	PACKER SET (MD)
					2 375", 4 7#, J-55 & N-80 EUE 8rd	7925'	none

30 TUBING RECORD

31 PERFORATION RECORD (Interval, size, and number)

Dakota Total of 84, 0 34" holes

32 ACID, SHOT, FRACTURE, CEMENT SQUEEZE, ETC

DEPTH INTERVAL
(MD)

AMOUNT AND KIND OF MATERIAL USED

7847' - 7989'

Fraced with 4600# 100 mesh BASF followed with 99,900# 40/70 mesh BASF

33 PRODUCTION

DATE OF FIRST PRODUCTION		PRODUCTION METHOD (Flowing, gas lift, pumping-size and type of pump)				WELL STATUS (PRODUCING OR SI)	
		Flowing				SI - waiting on tie-in	
DATE OF TEST	TESTED	CHOKE SIZE	PROD'N FOR TEST PERIOD	OIL - BBL	GAS - MCF	WATER - BBL	GAS-OIL RATIO
11/3/09	2 hr	16/64"					
FLOW TBG PRESS	CASING PRESSURE	CALCULATED 24-HOUR RATE		OIL - BBL	GAS - MCF	WATER - BBL	OIL GRAVITY-API (CORR)
0	650 psi				234 mcf/d		

34 DISPOSITION OF GAS (Sold, used for fuel, vented, etc) TO BE SOLD

TEST WITNESSED BY Craig Ward

35 LIST OF ATTACHMENTS SUMMARY OF POROUS ZONES, WELLBORE DIAGRAM, Directional EOW report

36 I hereby certify that the foregoing and attached information is complete and correct as determined from all available records

SIGNED _____ TITLE Regulatory Specialist DATE 11/5/09

UNITED STATES
DEPARTMENT OF THE INTERIOR
BUREAU OF LAND MANAGEMENT

SUBMIT IN
DUPLICATE

(See other instructions on
reverse side)

FORM APPROVED
OMB NO 1004-0137
Expires February 28, 1995

5 LEASE DESIGNATION AND LEASE NO
NMSF-078765

6 IF INDIAN, ALLOTTEE OR

7 UNIT AGREEMENT NAME
Rosa Unit

8 FARM OR LEASE NAME, WELL NO
Rosa Unit #35D

9 API WELL NO
30-045-34989

10 FIELD AND POOL, OR WILDCAT
Basin Mancos

11 SEC, T, R, M, OR BLOCK AND
SURVEY OR AREA
Sec 5, T31N, R6W

12 COUNTY OR
San Juan

13 STATE
New Mexico

19 ELEVATION CASINGHEAD

ROTARY TOOLS
X

CABLE TOOLS

25 WAS DIRECTIONAL SURVEY MADE
YES

27 WAS WELL CORED
No

WELL COMPLETION OR RECOMPLETION REPORT AND LOG*

1a TYPE OF WELL ☐ OIL WELL ☒ GAS WELL ☐ DRY ☐ OTHER

b TYPE OF COMPLETION
☒ NEW WELL ☐ WORKOVER ☐ DEEPEN ☐ PLUG BACK ☐ DIFF RESVR ☐ OTHER

2 NAME OF OPERATOR
WILLIAMS PRODUCTION COMPANY

3 ADDRESS AND TELEPHONE NO
P O Box 640, Aztec, NM 87410 (505) 634-4208

4 LOCATION OF WELL (Report location clearly and in accordance with any State requirements)*
At Surface 1020' FSL & 705' FEL, sec 5, T31N, R6W
At top production interval reported below 1281' FSL & 320' FEL, sec 5, T31N, R6W
At total depth Same

14 PERMIT NO

DATE ISSUED

18 ELEVATIONS (DK, RKB, RT, GR, ETC)*
6332' GR

15 DATE
SPUDDED
8-1-09

16 DATE T D
REACHED
8-26-09

17 DATE COMPLETED (READY TO PRODUCE)
11/3/09

20 TOTAL DEPTH, MD & TVD
8013' MD / 7974' TVD

21 PLUG, BACK T D, MD & TVD
8007' MD / 7968' TVD

22 IF MULTICOMP,
HOW MANY
3*

23 INTERVALS
DRILLED BY

24 PRODUCING INTERVAL(S), OF THIS COMPLETION - TOP, BOTTOM, NAME (MD AND TVD)*
BASIN MANCOS 6837' - 7382' MD
Commingled with MV & DK per AZT-3244

26 TYPE ELECTRIC AND OTHER LOGS RUN
Pulsed Neutron Decay Log and CBL

28 CASING REPORT (Report all strings set in well)

CASING SIZE/GRADE	WEIGHT, LB/FT	DEPTH SET (MD)	HOLE SIZE	TOP OF CEMENT, CEMENTING RECORD	AMOUNT PULLED
10-3/4", J-55	40 5#	354'	14-3/4"	290 SX - SURFACE	
7-5/8", K-55	26 4#	3585'	9-7/8"	555 SX - SURFACE	
5-1/2", N-80	17 0#	8012'	6-3/4"	360 SX - 2850' (CBL)	

29 LINER RECORD

SIZE	TOP (MD)	BOTTOM (MD)	SACKS CEMENT*	SCREEN (MD)	SIZE	DEPTH SET (MD)	PACKER SET (MD)
					2 3/5", 4 7#, J-55 & N-80 EUE 8rd	7925'	none

31 PERFORATION RECORD (Interval, size, and number)

Upper Mancos (63, 0 34" holes)

Lower Mancos (66, 0 34" holes)

32 ACID, SHOT, FRACTURE, CEMENT SQUEEZE, ETC

DEPTH INTERVAL (MD)	AMOUNT AND KIND OF MATERIAL USED
6837'-7008'	Frac with 4803# 100 mesh followed w/105,019# 40/70 BASF
7078'-7382'	Frac with 5654# 100 mesh followed with 100,046# 40/70 BASF

33 PRODUCTION

DATE OF FIRST PRODUCTION		PRODUCTION METHOD (Flowing, gas lift, pumping-size and type of pump)				WELL STATUS (PRODUCING OR SI)	
		Flowing				SI - waiting on tie-in	
DATE OF TEST	TESTED	CHOKE SIZE	PROD'N FOR TEST PERIOD	OIL - BBL	GAS - MCF	WATER - BBL	GAS-OIL RATIO
11/3/09	2 hr	16/64"					
FLOW TBG PRESS	CASING PRESSURE	CALCULATED 24-HOUR RATE		OIL - BBL	GAS - MCF	WATER - BBL	OIL GRAVITY-API (CORR)
0	650 psi				360 mcf/d		

34 DISPOSITION OF GAS (Sold, used for fuel, vented, etc) TO BE SOLD

TEST WITNESSED BY Craig Ward

35 LIST OF ATTACHMENTS SUMMARY OF POROUS ZONES, WELLBORE DIAGRAM, Directional EOW report

36 I hereby certify that the foregoing and attached information is complete and correct as determined from all available records

SIGNED _____ TITLE Regulatory Specialist DATE 11/5/09

UNITED STATES
DEPARTMENT OF THE INTERIOR
BUREAU OF LAND MANAGEMENT

SUBMIT IN
DUPLICATE

(See other instructions on
reverse side)

FORM APPROVED
OMB NO 1004-0137
Expires February 28, 1995

5 LEASE DESIGNATION AND LEASE NO
NMSF-078765

6 IF INDIAN, ALLOTTEE OR

WELL COMPLETION OR RECOMPLETION REPORT AND LOG*

1a TYPE OF WELL ☐ OIL WELL ☒ GAS WELL ☐ DRY ☐ OTHER

b TYPE OF COMPLETION
☒ NEW WELL ☐ WORKOVER ☐ DEEPEN ☐ PLUG BACK ☐ DIFF RESVR ☐ OTHER

2 NAME OF OPERATOR
WILLIAMS PRODUCTION COMPANY

3 ADDRESS AND TELEPHONE NO
P O Box 640, Aztec, NM 87410 (505) 634-4208

4 LOCATION OF WELL (Report location clearly and in accordance with any State requirements)*
At Surface 1020' FSL & 705' FEL, sec 5, T31N, R6W
At top production interval reported below 1281' FSL & 320' FEL, sec 5, T31N, R6W
At total depth Same

7 UNIT AGREEMENT NAME
Rosa Unit

8 FARM OR LEASE NAME, WELL NO
Rosa Unit #35D

9 API WELL NO
30-045-34989

10 FIELD AND POOL, OR WILDCAT
Blanco Mesaverde

11 SEC, T, R, M, OR BLOCK AND
SURVEY OR AREA
Sec 5, T31N, R6W

14 PERMIT NO

DATE ISSUED

12 COUNTY OR
San Juan

13 STATE
New Mexico

15 DATE
SPUDDED
8-1-09

16 DATE T D
REACHED
8-26-09

17 DATE COMPLETED (READY TO PRODUCE)
11/3/09

18 ELEVATIONS (DK, RKB, RT, GR, ETC)*
6332' GR

19 ELEVATION CASINGHEAD

20 TOTAL DEPTH, MD & TVD
8013' MD / 7974' TVD

21 PLUG, BACK T D, MD & TVD
8007' MD / 7968' TVD

22 IF MULTICOMP,
HOW MANY
3*

23 INTERVALS
DRILLED BY

ROTARY TOOLS
x

CABLE TOOLS

24 PRODUCING INTERVAL(S), OF THIS COMPLETION - TOP, BOTTOM, NAME (MD AND TVD)*
BLANCO MESAVERDE 5278' - 6001' MD

Commingled with MC & DK per AZT-3244

25 WAS DIRECTIONAL SURVEY MADE
YES

26 TYPE ELECTRIC AND OTHER LOGS RUN
Pulsed Neutron Decay Log and CBL

27 WAS WELL CORED
No

28 CASING REPORT (Report all strings set in well)

CASING SIZE/GRADE	WEIGHT, LB/FT	DEPTH SET (MD)	HOLE SIZE	TOP OF CEMENT, CEMENTING RECORD	AMOUNT PULLED
10-3/4", J-55	40 5#	354'	14-3/4"	290 SX - SURFACE	
7-5/8", K-55	26 4#	3585'	9-7/8"	555 SX - SURFACE	
5-1/2", N-80	17 0#	8012'	6-3/4"	360 SX - 2850' (CBL)	

29 LINER RECORD

SIZE	TOP (MD)	BOTTOM (MD)	SACKS CEMENT*	SCREEN (MD)	SIZE	DEPTH SET (MD)	PACKER SET (MD)
					2 3/5", 4 7#, J-55 & N-80 EUE 8rd	7925'	none

30 TUBING RECORD

31 PERFORATION RECORD (Interval, size, and number)

32 ACID, SHOT, FRACTURE, CEMENT SQUEEZE, ETC

DEPTH INTERVAL (MD) AMOUNT AND KIND OF MATERIAL USED

Upper MV (61, 0 34" holes)

Lower MV (71, 0 34" holes)

5278'-5575' Frac with 92,384# 20/40 mesh BASF

5636'-6001' Frac with 80,130# 20/40 mesh BASF

33 PRODUCTION

DATE OF FIRST PRODUCTION		PRODUCTION METHOD (Flowing, gas lift, pumping-size and type of pump)				WELL STATUS (PRODUCING OR SI)	
		Flowing				SI - waiting on tie-in	
DATE OF TEST	TESTED	CHOKE SIZE	PROD'N FOR TEST PERIOD	OIL - BBL	GAS - MCF	WATER - BBL	GAS-OIL RATIO
11/3/09	2 hr	16/64"					
FLOW TBG PRESS	CASING PRESSURE	CALCULATED 24-HOUR RATE		OIL - BBL	GAS - MCF	WATER - BBL	OIL GRAVITY-API (CORR)
0	650 psi				379 mcf/d		

34 DISPOSITION OF GAS (Sold, used for fuel, vented, etc.) TO BE SOLD

TEST WITNESSED BY Craig Ward

35 LIST OF ATTACHMENTS SUMMARY OF POROUS ZONES, WELLBORE DIAGRAM, Directional EOW report

36 I hereby certify that the foregoing and attached information is complete and correct as determined from all available records

SIGNED _____ TITLE Regulatory Specialist DATE 11/5/09

The Williams logo, featuring the word "Williams" in a bold, italicized, sans-serif font, with a stylized swoosh underline.

Exploration & Production
San Juan Basin Operations
720 So. Main / PO Box 640
Aztec, NM 87410
505-634-4200 / 505-634-4205 fax



Temporary Pit Inspection

FACILITY INFORMATION

Facility Name: RU#35D	API #: 30-039-34989
-----------------------	---------------------

Pit Type: Drilling Workover x Completion	Inspection: Daily x(Rig) Weekly (Tech)
--	---

Pit Liner intact (no visible tears)	<input checked="" type="checkbox"/> Yes <input type="checkbox"/> No If No, Report to EH&S immediately	Date / 11/02/09 Time Reported: 09:00
Pit Properly Fenced (no fence on rig side if on site)	<input checked="" type="checkbox"/> Yes <input type="checkbox"/> No Not Required (if site fully fenced)	
Pit Slopes intact	<input checked="" type="checkbox"/> Yes <input type="checkbox"/> No	
Adequate freeboard (liquid level 2 vertical feet from berm top)	<input checked="" type="checkbox"/> Yes <input type="checkbox"/> No Not Applicable	
Free oil or sheen present on pit	Yes <input checked="" type="checkbox"/> No	
Flare Pit free of liquids	Yes <input checked="" type="checkbox"/> No Not Applicable	
Comments: fluid was backed up into flare pit when we arrived, will have wtr haulers pull down and haul to Basin Disposal		
Inspector Signature:		
Printed Name: Craig Ward		
Title: consultant		
Date: 11/02/09 Phone: 505-793-3099		

Record Retention. Submit with Closure
File: EH&S Well Files

The logo for William's, featuring the brand name in a stylized, italicized font with a swoosh underline.

Exploration & Production
San Juan Basin Operations
720 So. Main / PO Box 640
Aztec, NM 87410
505-634-4200 / 505-634-4205 fax



Temporary Pit Inspection

FACILITY INFORMATION

Facility Name: RU#35D	API #: 30-039-34989
-----------------------	---------------------

Pit Type:	Drilling	Workover	<input checked="" type="checkbox"/> Completion	Inspection:	Daily	<input checked="" type="checkbox"/> (Rig)	Weekly (Tech)
-----------	----------	----------	--	-------------	-------	---	---------------

Pit Liner intact (no visible tears)	<input checked="" type="checkbox"/> Yes No If No, Report to EH&S immediately	Date / 10/30/09 Time Reported: 08:00
Pit Properly Fenced (no fence on rig side if on site)	<input checked="" type="checkbox"/> Yes No Not Required (if site fully fenced)	
Pit Slopes intact	<input checked="" type="checkbox"/> Yes No	
Adequate freeboard (liquid level 2 <u>vertical</u> feet from berm top)	<input checked="" type="checkbox"/> Yes No Not Applicable	
Free oil or sheen present on pit	Yes <input checked="" type="checkbox"/> No	
Flare Pit free of liquids	Yes <input checked="" type="checkbox"/> No Not Applicable	
Comments: fluid was backed up into flare pit when we arrived, will have wtr haulers pull down and haul to Basin Disposal		
Inspector Signature:		
Printed Name: Craig Ward		
Title: consultant		
Date: 10/30/09 Phone: 505-793-3099		

Record Retention: Submit with Closure
File: EH&S Well Files

Exploration & Production
San Juan Basin Operations
720 So. Main / PO Box 640
Aztec, NM 87410
505-634-4200 / 505-634-4205 fax



Temporary Pit Inspection

FACILITY INFORMATION

Facility Name: RU#35D	API #: 30-039-34989
-----------------------	---------------------

Pit Type:	Drilling	Workover	<input checked="" type="checkbox"/> Completion	Inspection:	Daily	<input checked="" type="checkbox"/> (Rig)	Weekly (Tech)
-----------	----------	----------	--	-------------	-------	---	---------------

Pit Liner intact (no visible tears)	<input checked="" type="checkbox"/> Yes No If No, Report to EH&S immediately	Date / 10/07/09 Time Reported: 07:30
Pit Properly Fenced (no fence on rig side if on site)	<input checked="" type="checkbox"/> Yes No Not Required (if site fully fenced)	
Pit Slopes intact	<input checked="" type="checkbox"/> Yes No	
Adequate freeboard (liquid level 2 <u>vertical</u> feet from berm top)	<input checked="" type="checkbox"/> Yes No Not Applicable	
Free oil or sheen present on pit	Yes <input checked="" type="checkbox"/> No	
Flare Pit free of liquids	Yes <input checked="" type="checkbox"/> No Not Applicable	
Comments: fluid was backed up into flare pit when we arrived, will have wtr haulers pull down and haul to Basin Disposal		
Inspector Signature:		
Printed Name: Craig Ward		
Title: consultant		
Date: 10/07/09 Phone: 505-793-3099		

Record Retention. Submit with Closure
File: EH&S Well Files

The logo for William's, featuring the brand name in a bold, italicized serif font, with a stylized swoosh underline that loops around the text.

The logo for William's, featuring the brand name in a bold, italicized serif font, with a stylized swoosh underline that loops around the letters.



William's





Exploration & Production
San Juan Basin Operations
720 So. Main / PO Box 640
Aztec, NM 87410
505-634-4200 / 505-634-4205 fax



Temporary Pit Inspection

FACILITY INFORMATION

Facility Name: RU#35D	API #: 30-039-34989
-----------------------	---------------------

Pit Type:	Drilling	Workover	<input checked="" type="checkbox"/> Completion	Inspection:	Daily	<input checked="" type="checkbox"/> (Rig)	Weekly (Tech)
-----------	----------	----------	--	-------------	-------	---	---------------

Pit Liner intact (no visible tears)	<input checked="" type="checkbox"/> Yes No If No, Report to EH&S immediately	Date / 10/07/09 Time Reported: 15:00
Pit Properly Fenced (no fence on rig side if on site)	<input checked="" type="checkbox"/> Yes No Not Required (if site fully fenced)	
Pit Slopes intact	<input checked="" type="checkbox"/> Yes No	
Adequate freeboard (liquid level 2 <u>vertical</u> feet from berm top)	<input checked="" type="checkbox"/> Yes No Not Applicable	
Free oil or sheen present on pit	Yes <input checked="" type="checkbox"/> No	
Flare Pit free of liquids	Yes <input checked="" type="checkbox"/> No Not Applicable	
Comments: fluid was backed up into flare pit when we arrived, will have wtr haulers pull down and haul to Basin Disposal		
Inspector Signature:		
Printed Name: Craig Ward		
Title: consultant		
Date: 10/07/09 Phone: 505-793-3099		

Record Retention: Submit with Closure
File EH&S Well Files

Exploration & Production
San Juan Basin Operations
720 So. Main / PO Box 640
Aztec, NM 87410
505-634-4200 / 505-634-4205 fax



Temporary Pit Inspection

FACILITY INFORMATION

Facility Name: RU#35D	API #: 30-039-34989
-----------------------	---------------------

Pit Type: Drilling Workover x Completion	Inspection: Daily x(Rig) Weekly (Tech)
--	---

Pit Liner intact (no visible tears)	x Yes No If No, Report to EH&S immediately	Date / 10/05/09 Time Reported: 07:30
Pit Properly Fenced (no fence on rig side if on site)	x Yes No Not Required (if site fully fenced)	
Pit Slopes intact	x Yes No	
Adequate freeboard (liquid level 2 vertical feet from berm top)	x Yes No Not Applicable	
Free oil or sheen present on pit	Yes x No	
Flare Pit free of liquids	Yes x No Not Applicable	
Comments: fluid was backed up into flare pit when we arrived, will have wtr haulers pull down and haul to Basin Disposal		
Inspector Signature:		
Printed Name: Craig Ward		
Title: consultant		
Date: 10/05/09 Phone: 505-793-3099		

Record Retention: Submit with Closure
File: EH&S Well Files

Exploration & Production
San Juan Basin Operations
720 So. Main / PO Box 640
Aztec, NM 87410
505-634-4200 / 505-634-4205 fax



Temporary Pit Inspection

FACILITY INFORMATION

Facility Name: RU#35D	API #: 30-039-34989
-----------------------	---------------------

Pit Type: Drilling Workover <input checked="" type="checkbox"/> Completion	Inspection: Daily <input checked="" type="checkbox"/> (Rig) Weekly (Tech)
--	---

Pit Liner intact (no visible tears)	<input checked="" type="checkbox"/> Yes No If No, Report to EH&S immediately	Date / 9/24/09 Time Reported: 16:30
Pit Properly Fenced (no fence on rig side if on site)	<input checked="" type="checkbox"/> Yes No Not Required (if site fully fenced)	
Pit Slopes intact	<input checked="" type="checkbox"/> Yes No	
Adequate freeboard (liquid level 2 <u>vertical</u> feet from berm top)	<input checked="" type="checkbox"/> Yes No Not Applicable	
Free oil or sheen present on pit	Yes <input checked="" type="checkbox"/> No	
Flare Pit free of liquids	Yes <input checked="" type="checkbox"/> No Not Applicable	

Comments:
fluid was backed up into flare pit when we arrived, will have wtr haulers pull down and haul to Basin Disposal

Inspector Signature:

Printed Name: Craig Ward

Title: consultant

Date: 9/24/09

Phone: 505-793-3099

Record Retention: Submit with Closure
File: EH&S Well Files

Exploration & Production
San Juan Basin Operations
720 So. Main / PO Box 640
Aztec, NM 87410
505-634-4200 / 505-634-4205 fax



Temporary Pit Inspection

FACILITY INFORMATION

Facility Name: RU#35D	API #: 30-039-34989
------------------------------	----------------------------

Pit Type: Drilling Workover x Completion	Inspection: Daily x(Rig) Weekly (Tech)
---	--

Pit Liner intact (no visible tears)	x Yes No If No, Report to EH&S immediately	Date / 9/23/09 Time Reported: 11:00
Pit Properly Fenced (no fence on rig side if on site)	x Yes No Not Required (if site fully fenced)	
Pit Slopes intact	x Yes No	
Adequate freeboard (liquid level 2 <u>vertical</u> feet from berm top)	x Yes No Not Applicable	
Free oil or sheen present on pit	Yes x No	
Flare Pit free of liquids	Yes x No Not Applicable	

Comments:

fluid was backed up into flare pit when we arrived, will have wtr haulers pull down and haul to Basin Disposal

Inspector Signature:

Printed Name: Craig Ward

Title: consultant

Date: 9/23/09

Phone: 505-793-3099

Record Retention Submit with Closure
File EH&S Well Files

Exploration & Production
San Juan Basin Operations
720 So. Main / PO Box 640
Aztec, NM 87410
505-634-4200 / 505-634-4205 fax



Temporary Pit Inspection

FACILITY INFORMATION

Facility Name: RU#35D	API #: 30-039-34989
------------------------------	----------------------------

Pit Type: Drilling Workover x Completion	Inspection: Daily x(Rig) Weekly (Tech)
---	---

Pit Liner intact (no visible tears)	<input checked="" type="checkbox"/> Yes No If No, Report to EH&S immediately	Date / 9/3/09 Time Reported: 07:00
Pit Properly Fenced (no fence on rig side if on site)	<input checked="" type="checkbox"/> Yes No Not Required (if site fully fenced)	
Pit Slopes intact	<input checked="" type="checkbox"/> Yes No	
Adequate freeboard (liquid level 2 <u>vertical</u> feet from berm top)	<input checked="" type="checkbox"/> Yes No Not Applicable	
Free oil or sheen present on pit	Yes <input checked="" type="checkbox"/> No	
Flare Pit free of liquids	Yes <input checked="" type="checkbox"/> No Not Applicable	

Comments:

fluid was backed up into flare pit when we arrived, will have wtr haulers pull down and haul to Basin Disposal

Inspector Signature:

Printed Name: Craig Ward

Title: consultant

Date: 9/3/09

Phone: 505-793-3099

Record Retention. Submit with Closure
File. EH&S Well Files



Exploration & Production
San Juan Basin Operations

720 So. Main / PO Box 640
Aztec, NM 87410
505-634-4200 / 505-634-4205 fax

Temporary Pit Inspection

FACILITY INFORMATION

Facility Name: ROSA UNIT # 35 -D	API #: 30-045-34989
----------------------------------	---------------------

Pit Type: <input checked="" type="checkbox"/> Drilling <input type="checkbox"/> Workover <input type="checkbox"/> Cavitation	Inspection: <input checked="" type="checkbox"/> Daily <input type="checkbox"/> Weekly <input type="checkbox"/> Monthly
--	--

Pit Liner intact (no visible tears)	<input checked="" type="checkbox"/> Yes <input type="checkbox"/> No If No, Report to EH&S immediately	Date / Time Reported:
Pit Properly Fenced (no fence on rig side if on site)	<input checked="" type="checkbox"/> Yes <input type="checkbox"/> No <input type="checkbox"/> Not Required (if site fully fenced)	
Pit Slopes intact	<input checked="" type="checkbox"/> Yes <input type="checkbox"/> No	
Adequate freeboard (liquid level 2 vertical feet from berm top)	<input checked="" type="checkbox"/> Yes <input type="checkbox"/> No <input type="checkbox"/> Not Applicable	
Free oil or sheen present on pit	<input type="checkbox"/> Yes <input checked="" type="checkbox"/> No	
Flare Pit free of liquids	<input checked="" type="checkbox"/> Yes <input type="checkbox"/> No <input type="checkbox"/> Not Applicable	
Comments:		
Inspector Signature: W.MOCK		
Printed Name: WILLIE MOCK		
Title: Drlg Consultant (TDCI)		
Date: 08/2/2009 Phone: (505) 793-0528		

Record Retention: Submit with Closure
File. EH&S



Exploration & Production
San Juan Basin Operations

720 So. Main / PO Box 640
Aztec, NM 87410
505-634-4200 / 505-634-4205 fax

Temporary Pit Inspection

FACILITY INFORMATION

Facility Name: ROSA UNIT # 35 -D	API #: 30-045-34989
----------------------------------	---------------------

Pit Type: <input checked="" type="checkbox"/> Drilling <input type="checkbox"/> Workover <input type="checkbox"/> Cavitation	Inspection: <input checked="" type="checkbox"/> Daily <input type="checkbox"/> Weekly <input type="checkbox"/> Monthly
--	--

Pit Liner intact (no visible tears)	<input checked="" type="checkbox"/> Yes <input type="checkbox"/> No If No, Report to EH&S immediately	Date / Time Reported:
Pit Properly Fenced (no fence on rig side if on site)	<input checked="" type="checkbox"/> Yes <input type="checkbox"/> No <input type="checkbox"/> Not Required (if site fully fenced)	
Pit Slopes intact	<input checked="" type="checkbox"/> Yes <input type="checkbox"/> No	
Adequate freeboard (liquid level 2 vertical feet from berm top)	<input checked="" type="checkbox"/> Yes <input type="checkbox"/> No <input type="checkbox"/> Not Applicable	
Free oil or sheen present on pit	<input type="checkbox"/> Yes <input checked="" type="checkbox"/> No	
Flare Pit free of liquids	<input checked="" type="checkbox"/> Yes <input type="checkbox"/> No <input type="checkbox"/> Not Applicable	

Comments:
Inspector Signature: W.MOCK
Printed Name: WILLIE MOCK
Title: Drlg Consultant (TDCI)
Date: 08/6/2009 Phone: (505) 793-0528

Record Retention: Submit with Closure
File: EH&S



Exploration & Production
San Juan Basin Operations

720 So. Main / PO Box 640
Aztec, NM 87410
505-634-4200 / 505-634-4205 fax

Temporary Pit Inspection

FACILITY INFORMATION

Facility Name: ROSA UNIT # 35 -D	API #: 30-045-34989
----------------------------------	---------------------

Pit Type: <input checked="" type="checkbox"/> Drilling <input type="checkbox"/> Workover <input type="checkbox"/> Cavitation	Inspection: <input checked="" type="checkbox"/> Daily <input type="checkbox"/> Weekly <input type="checkbox"/> Monthly
--	--

Pit Liner intact (no visible tears)	<input checked="" type="checkbox"/> Yes <input type="checkbox"/> No If No, Report to EH&S immediately	Date / Time Reported:
Pit Properly Fenced (no fence on rig side if on site)	<input checked="" type="checkbox"/> Yes <input type="checkbox"/> No <input type="checkbox"/> Not Required (if site fully fenced)	
Pit Slopes intact	<input checked="" type="checkbox"/> Yes <input type="checkbox"/> No	
Adequate freeboard (liquid level 2 vertical feet from berm top)	<input checked="" type="checkbox"/> Yes <input type="checkbox"/> No <input type="checkbox"/> Not Applicable	
Free oil or sheen present on pit	<input type="checkbox"/> Yes <input checked="" type="checkbox"/> No	
Flare Pit free of liquids	<input checked="" type="checkbox"/> Yes <input type="checkbox"/> No <input type="checkbox"/> Not Applicable	
Comments:		
Inspector Signature: W.MOCK		
Printed Name: WILLIE MOCK		
Title: Drlg Consultant (TDCI)		
Date: 08/5/2009 Phone: (505) 793-0528		

Record Retention: Submit with Closure
File. EH&S



Exploration & Production
San Juan Basin Operations

720 So. Main / PO Box 640
Aztec, NM 87410
505-634-4200 / 505-634-4205 fax

Temporary Pit Inspection

FACILITY INFORMATION

Facility Name: ROSA UNIT # 35 -D	API #: 30-045-34989
----------------------------------	---------------------

Pit Type: <input checked="" type="checkbox"/> Drilling <input type="checkbox"/> Workover <input type="checkbox"/> Cavitation	Inspection: <input checked="" type="checkbox"/> Daily <input type="checkbox"/> Weekly <input type="checkbox"/> Monthly
--	--

Pit Liner intact (no visible tears)	<input checked="" type="checkbox"/> Yes <input type="checkbox"/> No If No, Report to EH&S immediately	Date / Time Reported:
Pit Properly Fenced (no fence on rig side if on site)	<input checked="" type="checkbox"/> Yes <input type="checkbox"/> No <input type="checkbox"/> Not Required (if site fully fenced)	
Pit Slopes intact	<input checked="" type="checkbox"/> Yes <input type="checkbox"/> No	
Adequate freeboard (liquid level 2 vertical feet from berm top)	<input checked="" type="checkbox"/> Yes <input type="checkbox"/> No <input type="checkbox"/> Not Applicable	
Free oil or sheen present on pit	<input type="checkbox"/> Yes <input checked="" type="checkbox"/> No	
Flare Pit free of liquids	<input checked="" type="checkbox"/> Yes <input type="checkbox"/> No <input type="checkbox"/> Not Applicable	

Comments:

Inspector Signature: W.MOCK

Printed Name: WILLIE MOCK

Title: Drlg Consultant (TDCI)

Date: 08/4/2009	Phone: (505) 793-0528
-----------------	-------------------------

Record Retention. Submit with Closure
File: EH&S



Exploration & Production
San Juan Basin Operations
720 So. Main / PO Box 640
Aztec, NM 87410
505-634-4200 / 505-634-4205 fax

Temporary Pit Inspection

FACILITY INFORMATION

Facility Name: ROSA UNIT # 35 -D	API #: 30-045-34989
----------------------------------	---------------------

Pit Type: <input checked="" type="checkbox"/> Drilling <input type="checkbox"/> Workover <input type="checkbox"/> Cavitation	Inspection: <input checked="" type="checkbox"/> Daily <input type="checkbox"/> Weekly <input type="checkbox"/> Monthly
--	--

Pit Liner intact (no visible tears)	<input checked="" type="checkbox"/> Yes <input type="checkbox"/> No If No, Report to EH&S immediately	Date / Time Reported:
Pit Properly Fenced (no fence on rig side if on site)	<input checked="" type="checkbox"/> Yes <input type="checkbox"/> No <input type="checkbox"/> Not Required (if site fully fenced)	
Pit Slopes intact	<input checked="" type="checkbox"/> Yes <input type="checkbox"/> No	
Adequate freeboard (liquid level 2 vertical feet from berm top)	<input checked="" type="checkbox"/> Yes <input type="checkbox"/> No <input type="checkbox"/> Not Applicable	
Free oil or sheen present on pit	<input type="checkbox"/> Yes <input checked="" type="checkbox"/> No	
Flare Pit free of liquids	<input checked="" type="checkbox"/> Yes <input type="checkbox"/> No <input type="checkbox"/> Not Applicable	
Comments:		
Inspector Signature: W.MOCK		
Printed Name: WILLIE MOCK		
Title: Drlg Consultant (TDCI)		
Date: 08/3/2009 Phone: (505) 793-0528		

Record Retention: Submit with Closure
File: EH&S

Exploration & Production
San Juan Basin Operations
720 So. Main / PO Box 640
Aztec, NM 87410
505-634-4200 / 505-634-4205 fax



Temporary Pit Inspection

FACILITY INFORMATION

Facility Name: Rosa # 35D	API #:
----------------------------------	---------------

Pit Type: X Drilling <input type="checkbox"/> Workover <input type="checkbox"/> Cavitation	Inspection: <input type="checkbox"/> Daily (Rig) X Weekly (Tech)
---	---

Pit Liner intact (no visible tears)	X Yes <input type="checkbox"/> No If No, Report to EH&S immediately	Date / Time Reported: 6/28/10 10:40
Pit Properly Fenced (no fence on rig side if on site)	X Yes <input type="checkbox"/> No <input type="checkbox"/> Not Required (if site fully fenced)	
Pit Slopes intact	X Yes <input type="checkbox"/> No	
Adequate freeboard (liquid level 2 <u>vertical</u> feet from berm top)	X Yes <input type="checkbox"/> No <input type="checkbox"/> Not Applicable	
Free oil or sheen present on pit	Yes X No	
Flare Pit free of liquids	X Yes <input type="checkbox"/> No <input type="checkbox"/> Not Applicable	
Comments: Pit looks good		
Inspector Signature: Kenton Schwettman		
Printed Name: Kenton Schwettman		
Title: Tech		
Date: 6/28/10 Phone: (505)947-4973		

Record Retention: Submit with Closure
File: EH&S Well Files

Exploration & Production
San Juan Basin Operations
720 So. Main / PO Box 640
Aztec, NM 87410
505-634-4200 / 505-634-4205 fax



Temporary Pit Inspection

FACILITY INFORMATION

Facility Name: Rosa # 35D	API #:
----------------------------------	---------------

Pit Type: X Drilling <input type="checkbox"/> Workover <input type="checkbox"/> Cavitation	Inspection: <input type="checkbox"/> Daily (Rig) X Weekly (Tech)
---	---

Pit Liner intact (no visible tears)	X Yes <input type="checkbox"/> No If No, Report to EH&S immediately	Date / Time Reported: 6/21/10 10:40
Pit Properly Fenced (no fence on rig side if on site)	X Yes <input type="checkbox"/> No <input type="checkbox"/> Not Required (if site fully fenced)	
Pit Slopes intact	X Yes <input type="checkbox"/> No	
Adequate freeboard (liquid level 2 <u>vertical</u> feet from berm top)	X Yes <input type="checkbox"/> No <input type="checkbox"/> Not Applicable	
Free oil or sheen present on pit	Yes X No	
Flare Pit free of liquids	X Yes <input type="checkbox"/> No <input type="checkbox"/> Not Applicable	
Comments: Pit looks good		
Inspector Signature: Kenton Schwettman		
Printed Name: Kenton Schwettman		
Title: Tech		
Date: 6/21/10 Phone: (505)947-4973		

Record Retention: Submit with Closure
File. EH&S Well Files

Exploration & Production
San Juan Basin Operations
720 So. Main / PO Box 640
Aztec, NM 87410
505-634-4200 / 505-634-4205 fax



Temporary Pit Inspection

FACILITY INFORMATION

Facility Name: Rosa # 35D	API #:
----------------------------------	---------------

Pit Type: X Drilling <input type="checkbox"/> Workover <input type="checkbox"/> Cavitation	Inspection: <input type="checkbox"/> Daily (Rig) X Weekly (Tech)
---	---

Pit Liner intact (no visible tears)	X Yes <input type="checkbox"/> No If No, Report to EH&S immediately	Date / Time Reported: 6/16/10 10:40
Pit Properly Fenced (no fence on rig side if on site)	X Yes <input type="checkbox"/> No <input type="checkbox"/> Not Required (if site fully fenced)	
Pit Slopes intact	X Yes <input type="checkbox"/> No	
Adequate freeboard (liquid level 2 vertical feet from berm top)	X Yes <input type="checkbox"/> No <input type="checkbox"/> Not Applicable	
Free oil or sheen present on pit	Yes X No	
Flare Pit free of liquids	X Yes <input type="checkbox"/> No <input type="checkbox"/> Not Applicable	
Comments: Pit looks good		
Inspector Signature: Kenton Schwettman		
Printed Name: Kenton Schwettman		
Title: Tech		
Date: 6/16/10 Phone: (505)947-4973		

Record Retention: Submit with Closure
File EH&S Well Files

Exploration & Production
San Juan Basin Operations
720 So. Main / PO Box 640
Aztec, NM 87410
505-634-4200 / 505-634-4205 fax



Temporary Pit Inspection

FACILITY INFORMATION

Facility Name: Rosa # 35D	API #:
----------------------------------	---------------

Pit Type: X Drilling <input type="checkbox"/> Workover <input type="checkbox"/> Cavitation	Inspection: <input type="checkbox"/> Daily (Rig) X Weekly (Tech)
---	---

Pit Liner intact (no visible tears)	X Yes <input type="checkbox"/> No If No, Report to EH&S immediately	Date / Time Reported: 6/8/10 10:40
Pit Properly Fenced (no fence on rig side if on site)	X Yes <input type="checkbox"/> No <input type="checkbox"/> Not Required (if site fully fenced)	
Pit Slopes intact	X Yes <input type="checkbox"/> No	
Adequate freeboard (liquid level 2 vertical feet from berm top)	X Yes <input type="checkbox"/> No <input type="checkbox"/> Not Applicable	
Free oil or sheen present on pit	Yes X No	
Flare Pit free of liquids	X Yes <input type="checkbox"/> No <input type="checkbox"/> Not Applicable	
Comments: Pit looks good		
Inspector Signature: Kenton Schwettman		
Printed Name: Kenton Schwettman		
Title: Tech		
Date: 6/8/10 Phone: (505)947-4973		

Record Retention: Submit with Closure
File: EH&S Well Files

Exploration & Production
San Juan Basin Operations
720 So. Main / PO Box 640
Aztec, NM 87410
505-634-4200 / 505-634-4205 fax



Temporary Pit Inspection

FACILITY INFORMATION

Facility Name: Rosa # 35D	API #:
----------------------------------	---------------

Pit Type: X Drilling <input type="checkbox"/> Workover <input type="checkbox"/> Cavitation	Inspection: <input type="checkbox"/> Daily (Rig) X Weekly (Tech)
---	---

Pit Liner intact (no visible tears)	X Yes <input type="checkbox"/> No If No, Report to EH&S immediately	Date / Time Reported: 6/1/10 10:40
Pit Properly Fenced (no fence on rig side if on site)	X Yes <input type="checkbox"/> No <input type="checkbox"/> Not Required (if site fully fenced)	
Pit Slopes intact	X Yes <input type="checkbox"/> No	
Adequate freeboard (liquid level 2 <u>vertical</u> feet from berm top)	X Yes <input type="checkbox"/> No <input type="checkbox"/> Not Applicable	
Free oil or sheen present on pit	Yes X No	
Flare Pit free of liquids	X Yes <input type="checkbox"/> No <input type="checkbox"/> Not Applicable	
Comments: Pit looks good		
Inspector Signature: Kenton Schwettman		
Printed Name: Kenton Schwettman		
Title: Tech		
Date: 6/1/10 Phone: (505)947-4973		

Record Retention: Submit with Closure
File: EH&S Well Files

Exploration & Production
San Juan Basin Operations
720 So. Main / PO Box 640
Aztec, NM 87410
505-634-4200 / 505-634-4205 fax



Temporary Pit Inspection

FACILITY INFORMATION

Facility Name: Rosa # 35D	API #:
----------------------------------	---------------

Pit Type: X Drilling <input type="checkbox"/> Workover <input type="checkbox"/> Cavitation	Inspection: <input type="checkbox"/> Daily (Rig) X Weekly (Tech)
---	---

Pit Liner intact (no visible tears)	X Yes <input type="checkbox"/> No If No, Report to EH&S immediately	Date / Time Reported: 5/26/10 10:40
Pit Properly Fenced (no fence on rig side if on site)	X Yes <input type="checkbox"/> No <input type="checkbox"/> Not Required (if site fully fenced)	
Pit Slopes intact	X Yes <input type="checkbox"/> No	
Adequate freeboard (liquid level 2 <u>vertical</u> feet from berm top)	X Yes <input type="checkbox"/> No <input type="checkbox"/> Not Applicable	
Free oil or sheen present on pit	Yes X No	
Flare Pit free of liquids	X Yes <input type="checkbox"/> No <input type="checkbox"/> Not Applicable	
Comments: Pit looks good		
Inspector Signature: Kenton Schwettman		
Printed Name: Kenton Schwettman		
Title: Tech		
Date: 5/26/10 Phone: (505)947-4973		

Record Retention: Submit with Closure
File: EH&S Well Files

Exploration & Production
San Juan Basin Operations
720 So. Main / PO Box 640
Aztec, NM 87410
505-634-4200 / 505-634-4205 fax



Temporary Pit Inspection

FACILITY INFORMATION

Facility Name: Rosa # 35D	API #:
----------------------------------	---------------

Pit Type: X Drilling <input type="checkbox"/> Workover <input type="checkbox"/> Cavitation	Inspection: <input type="checkbox"/> Daily (Rig) X Weekly (Tech)
---	---

Pit Liner intact (no visible tears)	X Yes <input type="checkbox"/> No If No, Report to EH&S immediately	Date / Time Reported: 5/18/10 10:40
Pit Properly Fenced (no fence on rig side if on site)	X Yes <input type="checkbox"/> No <input type="checkbox"/> Not Required (if site fully fenced)	
Pit Slopes intact	X Yes <input type="checkbox"/> No	
Adequate freeboard (liquid level 2 <u>vertical</u> feet from berm top)	X Yes <input type="checkbox"/> No <input type="checkbox"/> Not Applicable	
Free oil or sheen present on pit	Yes X No	
Flare Pit free of liquids	X Yes <input type="checkbox"/> No <input type="checkbox"/> Not Applicable	
Comments: Pit looks good		
Inspector Signature: Kenton Schwettman		
Printed Name: Kenton Schwettman		
Title: Tech		
Date: 5/18/10 Phone: (505)947-4973		

Record Retention: Submit with Closure
File: EH&S Well Files

Exploration & Production
San Juan Basin Operations
720 So. Main / PO Box 640
Aztec, NM 87410
505-634-4200 / 505-634-4205 fax



Temporary Pit Inspection

FACILITY INFORMATION

Facility Name: Rosa # 35D	API #:
----------------------------------	---------------

Pit Type: X Drilling <input type="checkbox"/> Workover <input type="checkbox"/> Cavitation	Inspection: <input type="checkbox"/> Daily (Rig) X Weekly (Tech)
---	---

Pit Liner intact (no visible tears)	X Yes <input type="checkbox"/> No If No, Report to EH&S immediately	Date / Time Reported: 5/10/10 10:40
Pit Properly Fenced (no fence on rig side if on site)	X Yes <input type="checkbox"/> No <input type="checkbox"/> Not Required (if site fully fenced)	
Pit Slopes intact	X Yes <input type="checkbox"/> No	
Adequate freeboard (liquid level 2 vertical feet from berm top)	X Yes <input type="checkbox"/> No <input type="checkbox"/> Not Applicable	
Free oil or sheen present on pit	Yes X No	
Flare Pit free of liquids	X Yes <input type="checkbox"/> No <input type="checkbox"/> Not Applicable	
Comments: Pit looks good		
Inspector Signature: Kenton Schwettman		
Printed Name: Kenton Schwettman		
Title: Tech		
Date: 5/10/10 Phone: (505)947-4973		

Record Retention: Submit with Closure
File: EH&S Well Files

Exploration & Production
San Juan Basin Operations

720 So. Main / PO Box 640
Aztec, NM 87410
505-634-4200 / 505-634-4205 fax



Temporary Pit Inspection

FACILITY INFORMATION

Facility Name: Rosa # 35D	API #:
----------------------------------	---------------

Pit Type: X Drilling <input type="checkbox"/> Workover <input type="checkbox"/> Cavitation	Inspection: <input type="checkbox"/> Daily (Rig) X Weekly (Tech)
---	---

Pit Liner intact (no visible tears)	X Yes <input type="checkbox"/> No If No, Report to EH&S immediately	Date / Time Reported: 5/3/10 10:40
Pit Properly Fenced (no fence on rig side if on site)	X Yes <input type="checkbox"/> No <input type="checkbox"/> Not Required (if site fully fenced)	
Pit Slopes intact	X Yes <input type="checkbox"/> No	
Adequate freeboard (liquid level 2 <u>vertical</u> feet from berm top)	X Yes <input type="checkbox"/> No <input type="checkbox"/> Not Applicable	
Free oil or sheen present on pit	Yes X No	
Flare Pit free of liquids	X Yes <input type="checkbox"/> No <input type="checkbox"/> Not Applicable	
Comments: Pit looks good		
Inspector Signature: Kenton Schwettman		
Printed Name: Kenton Schwettman		
Title: Tech		
Date: 5/3/10 Phone: (505)947-4973		

Record Retention: Submit with Closure
File: EH&S Well Files

Exploration & Production
San Juan Basin Operations
720 So. Main / PO Box 640
Aztec, NM 87410
505-634-4200 / 505-634-4205 fax



Temporary Pit Inspection

FACILITY INFORMATION

Facility Name: Rosa # 35D	API #:
----------------------------------	---------------

Pit Type: X Drilling <input type="checkbox"/> Workover <input type="checkbox"/> Cavitation	Inspection: <input type="checkbox"/> Daily (Rig) X Weekly (Tech)
---	---

Pit Liner intact (no visible tears)	X Yes <input type="checkbox"/> No If No, Report to EH&S immediately	Date / Time Reported: 4/27/10 10:40
Pit Properly Fenced (no fence on rig side if on site)	X Yes <input type="checkbox"/> No <input type="checkbox"/> Not Required (if site fully fenced)	
Pit Slopes intact	X Yes <input type="checkbox"/> No	
Adequate freeboard (liquid level 2 <u>vertical</u> feet from berm top)	X Yes <input type="checkbox"/> No <input type="checkbox"/> Not Applicable	
Free oil or sheen present on pit	Yes X No	
Flare Pit free of liquids	X Yes <input type="checkbox"/> No <input type="checkbox"/> Not Applicable	
Comments: Pit looks good		
Inspector Signature: Kenton Schwettman		
Printed Name: Kenton Schwettman		
Title: Tech		
Date: 4/27/10 Phone: (505)947-4973		

Record Retention: Submit with Closure
File: EH&S Well Files

Exploration & Production
San Juan Basin Operations
720 So. Main / PO Box 640
Aztec, NM 87410
505-634-4200 / 505-634-4205 fax



Temporary Pit Inspection

FACILITY INFORMATION

Facility Name: Rosa # 35D	API #:
----------------------------------	---------------

Pit Type: X Drilling <input type="checkbox"/> Workover <input type="checkbox"/> Cavitation	Inspection: <input type="checkbox"/> Daily (Rig) X Weekly (Tech)
---	---

Pit Liner intact (no visible tears)	X Yes <input type="checkbox"/> No If No, Report to EH&S immediately	Date / Time Reported: 4/20/10 10:40
Pit Properly Fenced (no fence on rig side if on site)	X Yes <input type="checkbox"/> No <input type="checkbox"/> Not Required (if site fully fenced)	
Pit Slopes intact	X Yes <input type="checkbox"/> No	
Adequate freeboard (liquid level 2 <u>vertical</u> feet from berm top)	X Yes <input type="checkbox"/> No <input type="checkbox"/> Not Applicable	
Free oil or sheen present on pit	Yes X No	
Flare Pit free of liquids	X Yes <input type="checkbox"/> No <input type="checkbox"/> Not Applicable	
Comments: Pit looks good		
Inspector Signature: Kenton Schwettman		
Printed Name: Kenton Schwettman		
Title: Tech		
Date: 4/20/10 Phone: (505)947-4973		

Record Retention: Submit with Closure
File. EH&S Well Files

Exploration & Production
San Juan Basin Operations
720 So. Main / PO Box 640
Aztec, NM 87410
505-634-4200 / 505-634-4205 fax



Temporary Pit Inspection

FACILITY INFORMATION

Facility Name: Rosa # 35D	API #:
----------------------------------	---------------

Pit Type: X Drilling <input type="checkbox"/> Workover <input type="checkbox"/> Cavitation	Inspection: <input type="checkbox"/> Daily (Rig) X Weekly (Tech)
---	---

Pit Liner intact (no visible tears)	X Yes <input type="checkbox"/> No If No, Report to EH&S immediately	Date / Time Reported: 4/9/10 10:40
Pit Properly Fenced (no fence on rig side if on site)	X Yes <input type="checkbox"/> No <input type="checkbox"/> Not Required (if site fully fenced)	
Pit Slopes intact	X Yes <input type="checkbox"/> No	
Adequate freeboard (liquid level 2 vertical feet from berm top)	X Yes <input type="checkbox"/> No <input type="checkbox"/> Not Applicable	
Free oil or sheen present on pit	Yes X No	
Flare Pit free of liquids	X Yes <input type="checkbox"/> No <input type="checkbox"/> Not Applicable	
Comments: Pit looks good		
Inspector Signature: Kenton Schwettman		
Printed Name: Kenton Schwettman		
Title: Tech		
Date: 4/9/10 Phone: (505)947-4973		

Record Retention: Submit with Closure
File: EH&S Well Files

Exploration & Production
San Juan Basin Operations
720 So. Main / PO Box 640
Aztec, NM 87410
505-634-4200 / 505-634-4205 fax



Temporary Pit Inspection

FACILITY INFORMATION

Facility Name: Rosa # 35D	API #:
----------------------------------	---------------

Pit Type: X Drilling <input type="checkbox"/> Workover <input type="checkbox"/> Cavitation	Inspection: <input type="checkbox"/> Daily (Rig) X Weekly (Tech)
---	---

Pit Liner intact (no visible tears)	X Yes <input type="checkbox"/> No If No, Report to EH&S immediately	Date / Time Reported: 4/2/10 10:40
Pit Properly Fenced (no fence on rig side if on site)	X Yes <input type="checkbox"/> No <input type="checkbox"/> Not Required (if site fully fenced)	
Pit Slopes intact	X Yes <input type="checkbox"/> No	
Adequate freeboard (liquid level 2 <u>vertical</u> feet from berm top)	X Yes <input type="checkbox"/> No <input type="checkbox"/> Not Applicable	
Free oil or sheen present on pit	Yes X No	
Flare Pit free of liquids	X Yes <input type="checkbox"/> No <input type="checkbox"/> Not Applicable	
Comments: Pit looks good		
Inspector Signature: Kenton Schwettman		
Printed Name: Kenton Schwettman		
Title: Tech		
Date: 4/2/10 Phone: (505)947-4973		

Record Retention: Submit with Closure
File: EH&S Well Files

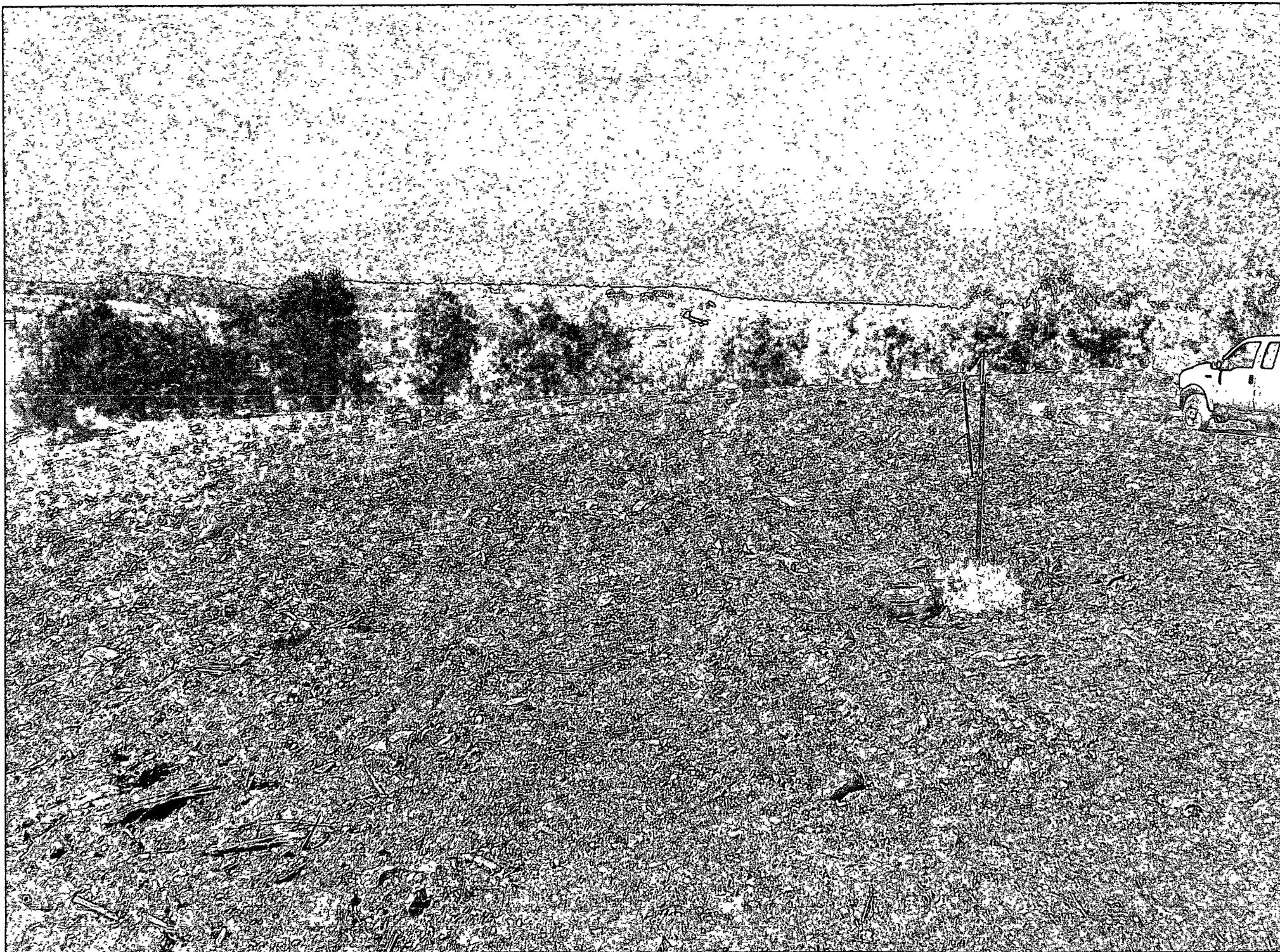

0 11 1 11 2 2 2

WILLIAMS PROD
ROSA UNIT 250
UNIT P SEC 5
13111 RBM
SAND JUNK CO
IN PLACE BURNIN



Exploration & Production
PO Box 640
Aztec, NM 87410
505/634-4219
505/634-4205 fax



Transmittal

To: Brandon Powell
NMOCD
1000 Rio Brazos Road
Aztec, New Mexico 87410

From: Tasha Meador
San Juan- Permitting Technician
505-634-4241
tasha.meador@williams.com

Date:

Re: Supplemental Submittal

Temporary Pit Closure report: NMOCD Permit #

60774

Enclosed and per your direction, please find our supplemental submittal for the referenced temporary pit closure report.

Please advise if additional information is required. Thank you for your time and consideration. Please call or contact me if there are any questions.

Respectfully resubmitted,

Tasha Meador

Tasha Meador
Williams Exploration & Production
721 S Main Aztec, NM
Office: 505-634-4200
Direct: 505-634-4241
Fax: 505-634-4205
tasha.meador@williams.com

Encl:

District IV
1220 S. St. Francis Dr., Santa Fe, NM 87505

OIL CONSERVATION DIVISION
1220 South St. Francis Dr.
Santa Fe, NM 87505

Form C-102
Revised October 12, 2005
Instructions on back
appropriate District Office
State Lease - 4 Copies
Fee Lease - 3 Copies

☐ AMENDED REPORT

JASON C. EDWARDS
Certificate Number 15269

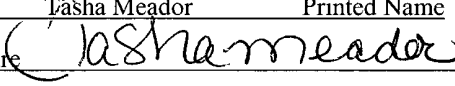
Submit To Appropriate District Office Two Copies District I 1625 N French Dr , Hobbs, NM 88240 District II 1301 W Grand Avenue Artesia, NM 88210 District III 1000 Rio Brazos Rd. , Aztec, NM 87410 District IV 1220 S St Francis Dr , Santa Fe, NM 87505		State of New Mexico Energy, Minerals and Natural Resources Oil Conservation Division 1220 South St. Francis Dr. Santa Fe, NM 87505			Form C-105 July 17, 2008		
		1. WELL API NO. 30-045-34989					
		2 Type of Lease <input type="checkbox"/> STATE <input type="checkbox"/> FEE <input checked="" type="checkbox"/> FED/INDIAN					
		3 State Oil & Gas Lease No SF-078765					
WELL COMPLETION OR RECOMPLETION REPORT AND LOG							
4 Reason for filing <input type="checkbox"/> COMPLETION REPORT (Fill in boxes #1 through #31 for State and Fee wells only) <input checked="" type="checkbox"/> C-144 CLOSURE ATTACHMENT (Fill in boxes #1 through #9, #15 Date Rig Released and #32 and/or #33, attach this and the plat to the C-144 closure report in accordance with 19 15 17 13 K NMAC)				5 Lease Name or Unit Agreement Name Rosa			
				6 Well Number Rosa Unit #035D			
7 Type of Completion <input checked="" type="checkbox"/> NEW WELL <input type="checkbox"/> WORKOVER <input type="checkbox"/> DEEPENING <input type="checkbox"/> PLUGBACK <input type="checkbox"/> DIFFERENT RESERVOIR <input type="checkbox"/> OTHER							
8 Name of Operator WILLIAMS PRODUCTION, LLC				9 OGRID 120782			
10 Address of Operator P O BOX 640 AZTEC, NM 87410				11 Pool name or Wildcat			
12. Location	Unit Ltr	Section	Township	Range	Lot	Feet from the	
Surface:						N/S Line	
BH:						Feet from the	
						E/W Line	
						County	
13 Date Spudded	14 Date T D Reached	15 Date Rig Released 11/3/2009		16 Date Completed (Ready to Produce)		17 Elevations (DF and RKB, RT, GR, etc)	
18 Total Measured Depth of Well		19 Plug Back Measured Depth		20 Was Directional Survey Made?		21 Type Electric and Other Logs Run	
22 Producing Interval(s), of this completion - Top, Bottom, Name							
23 CASING RECORD (Report all strings set in well)							
CASING SIZE	WEIGHT LB /FT	DEPTH SET		HOLE SIZE	CEMENTING RECORD	AMOUNT PULLED	
24 LINER RECORD				25 TUBING RECORD			
SIZE	TOP	BOTTOM	SACKS CEMENT	SCREEN	SIZE	DEPTH SET	
26 Perforation record (interval, size, and number)				27 ACID, SHOT, FRACTURE, CEMENT, SQUEEZE, ETC. DEPTH INTERVAL AMOUNT AND KIND MATERIAL USED			
28 PRODUCTION							
Date First Production		Production Method (<i>Flowing gas lift, pumping - Size and type pump</i>)			Well Status (<i>Prod or Shut-in</i>)		
Date of Test	Hours Tested	Choke Size	Prod'n For Test Period	Oil - Bbl	Gas - MCF	Water - Bbl	
Flow Tubing Press	Casing Pressure	Calculated 24-Hour Rate	Oil - Bbl	Gas - MCF	Water - Bbl	Oil Gravity - API - (<i>Corr</i>)	
29 Disposition of Gas (<i>Sold, used for fuel, vented, etc</i>)					30 Test Witnessed By		
31 List Attachments							
32 If a temporary pit was used at the well, attach a plat with the location of the temporary pit							
33 If an on-site burial was used at the well, report the exact location of the on-site burial							
Latitude 36 92410 Longitude 107 47959 NAD 1927 1983							
<i>I hereby certify that the information shown on both sides of this form is true and complete to the best of my knowledge and belief</i>							
Tasha Meador		Printed Name					
Signature 		Title		Permit Technician		Date 8/29/11	
E-mail Address: tasha.meador@williams.com							