

**UNITED STATES
DEPARTMENT OF THE INTERIOR
BUREAU OF LAND MANAGEMENT**

RECEIVED**OCT 06 2011**

Sundry Notices and Reports on Wells

Farmington Field Office
Bureau of Land Management1. Type of Well
GAS2. Name of Operator
BURLINGTON
RESOURCES OIL & GAS COMPANY LP

3. Address & Phone No. of Operator

PO Box 4289, Farmington, NM 87499 (505) 326-9700

4. Location of Well, Footage, Sec., T, R, M

Surface: Unit M (SWSW), 790' FSL & 1190' FWL, Section 29, T30N, R9W, NMPM

5. Lease Number
SF-077833-A
6. If Indian, All. or
Tribe Name
7. Unit Agreement Name
8. Well Name & Number
MANSFIELD #1
9. API Well No.
30-045-09093
10. Field and Pool
Blanco Mesa Verde
11. County and State
San Juan, NM

**12. CHECK APPROPRIATE BOX TO INDICATE NATURE OF NOTICE, REPORT, OTHER DATA**

Type of Submission

Type of Action

☐ Notice of Intent☐ Abandonment☐ Change of Plans☒ Other --☐ Cathodic☒ Subsequent Report☐ Recompletion☐ New Construction☐ Plugging☐ Non-Routine Fracturing☐ Final Abandonment☐ Casing Repair☐ Water Shut off☐ Altering Casing☐ Conversion to Injection**13. Describe Proposed or Completed Operations**Attached is a drawing for the **UPGRADE**/ placement of the cathodic ground, rectifier and cable for the subject well.**ACCEPTED FOR RECORD****OCT 06 2011**FARMINGTON FIELD OFFICE
BY Denise Journey**14. I hereby certify that the foregoing is true and correct.**Signed Denise Journey Denise JourneyTitle: Staff Regulatory TechnicianDate 10-5-11

(This space for Federal or State Office use)

APPROVED BY _____ Title _____ Date _____

CONDITION OF APPROVAL, if any:

Title 18 U.S.C. Section 1001, makes it a crime for any person knowingly and willfully to make any department or agency of the United States any false, fictitious or fraudulent statements or representations as to any matter within its jurisdiction

NMOCDA

Mansfield #1

Section 29, T30N, R09W, N.M.P.M., San Juan County, NM

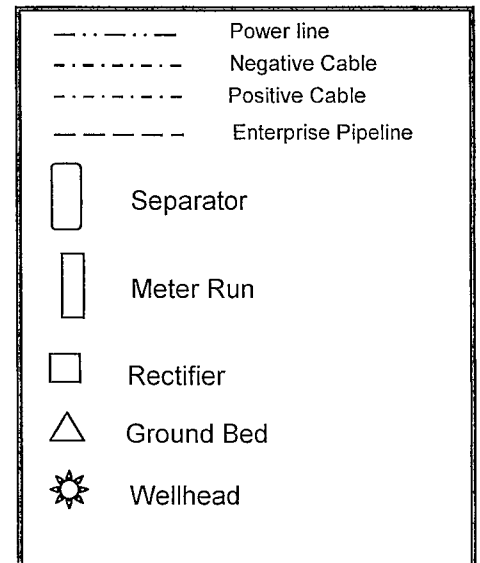
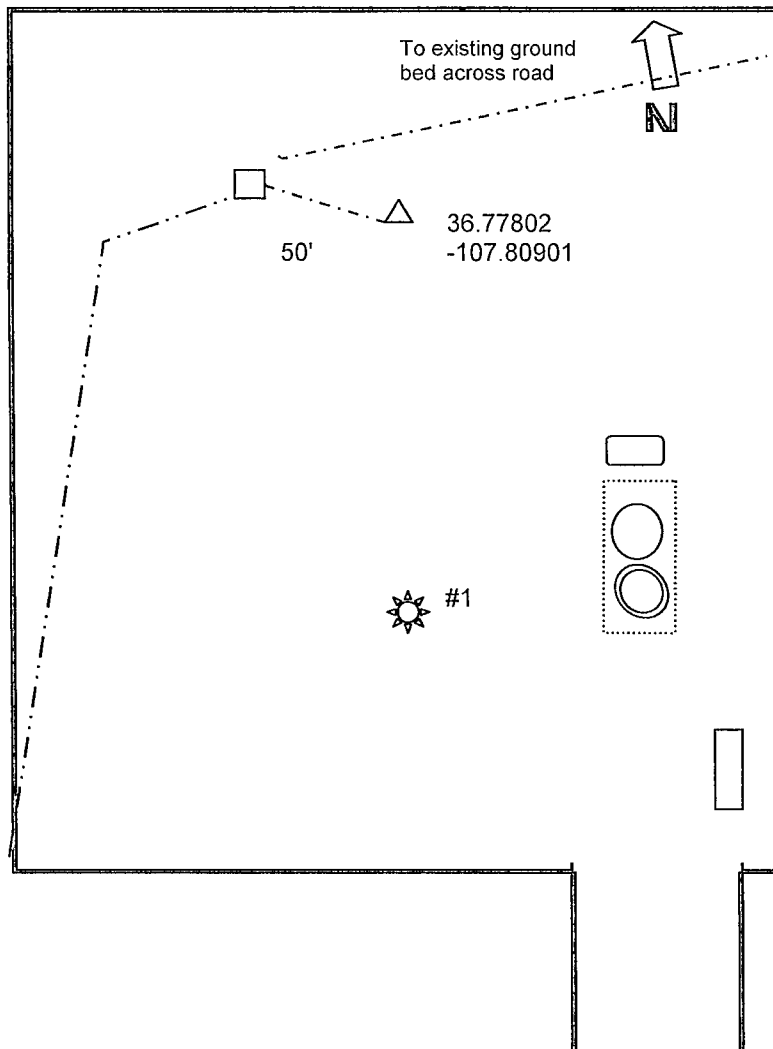

Drill ground bed approximately 102' north of #1 wellhead at staked location. Replace existing rectifier with a 40-16 rectifier and connect positive cable to ground bed. Reconnect existing negative cable and existing ground bed. Repair as needed.

#1 Cable:

Positive: 50'

Total Ditch: 50'