

Submit 3 Copies To Appropriate District
Office
District I
1625 N French Dr , Hobbs, NM 88240
District II
1301 W Grand Ave , Artesia, NM 88210
District III
1000 Rio Brazos Rd , Aztec, NM 87410
District IV
1220 S St. Francis Dr , Santa Fe, NM
87505

State of New Mexico
Energy, Minerals and Natural Resources

Form C-103
Jun 19, 2008

OIL CONSERVATION DIVISION
1220 South St. Francis Dr.
Santa Fe, NM 87505

SUNDRY NOTICES AND REPORTS ON WELLS (DO NOT USE THIS FORM FOR PROPOSALS TO DRILL OR TO DEEPEN OR PLUG BACK TO A DIFFERENT RESERVOIR USE "APPLICATION FOR PERMIT" (FORM C-101) FOR SUCH PROPOSALS)		WELL API NO. 30-045-35158
1. Type of Well: Oil Well <input type="checkbox"/> Gas Well <input checked="" type="checkbox"/> Other		5. Indicate Type of Lease STATE <input type="checkbox"/> FEE <input checked="" type="checkbox"/>
2. Name of Operator Burlington Resources Oil Gas Company LP		6. State Oil & Gas Lease No.
3. Address of Operator P.O. Box 4289, Farmington, NM 87499-4289		7. Lease Name or Unit Agreement Name Atlantic B Com
4. Well Location Unit Letter P : 901 feet from the South line and 1143 feet from the East line Section 34 Township 31N Range 10W NMPM San Juan County		8. Well Number 9B
11. Elevation (Show whether DR, RKB, RT, GR, etc.) 6282' GR		9. OGRID Number 14538
		10. Pool name or Wildcat Blanco MV/Basin DK

12. Check Appropriate Box to Indicate Nature of Notice, Report or Other Data

NOTICE OF INTENTION TO:

PERFORM REMEDIAL WORK ☐ PLUG AND ABANDON ☐
TEMPORARILY ABANDON ☐ CHANGE PLANS ☐
PULL OR ALTER CASING ☐ MULTIPLE COMPL ☐
DOWNHOLE COMMINGLE ☐

OTHER: ☐

SUBSEQUENT REPORT OF:

REMEDIAL WORK ☐ ALTERING CASING ☐
COMMENCE DRILLING OPNS. ☐ P AND A ☐
CASING/CEMENT JOB ☐

OTHER: ☒ CATHODIC SUNDRY

13. Describe proposed or completed operations. (Clearly state all pertinent details, and give pertinent dates, including estimated date of starting any proposed work). SEE RULE 1103. For Multiple Completions: Attach wellbore diagram of proposed completion or recompletion.

ATTACHED IS A DRAWING FOR THE PLACEMENT OF THE CATHODIC GROUND, RECTIFIER AND CABLE FOR THE SUBJECT WELL.

Spud Date: 2/10/2011

Rig Released Date: 3/2/2011

I hereby certify that the information above is true and complete to the best of my knowledge and belief.

SIGNATURE Denise Journey TITLE Staff Regulatory Technician DATE 10-18-11

Type or print name Denise Journey E-mail address: Denise.Journey@conocophillips.com PHONE: 505-326-9556

For State Use Only

APPROVED BY Accepted For Record TITLE _____ DATE _____
Conditions of Approval (if any): A



Atlantic B Com #9B

Section 34, T31N, R10W, N.M.P.M., San Juan County, NM

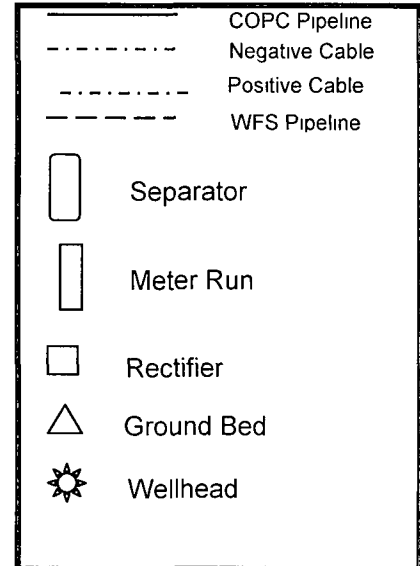
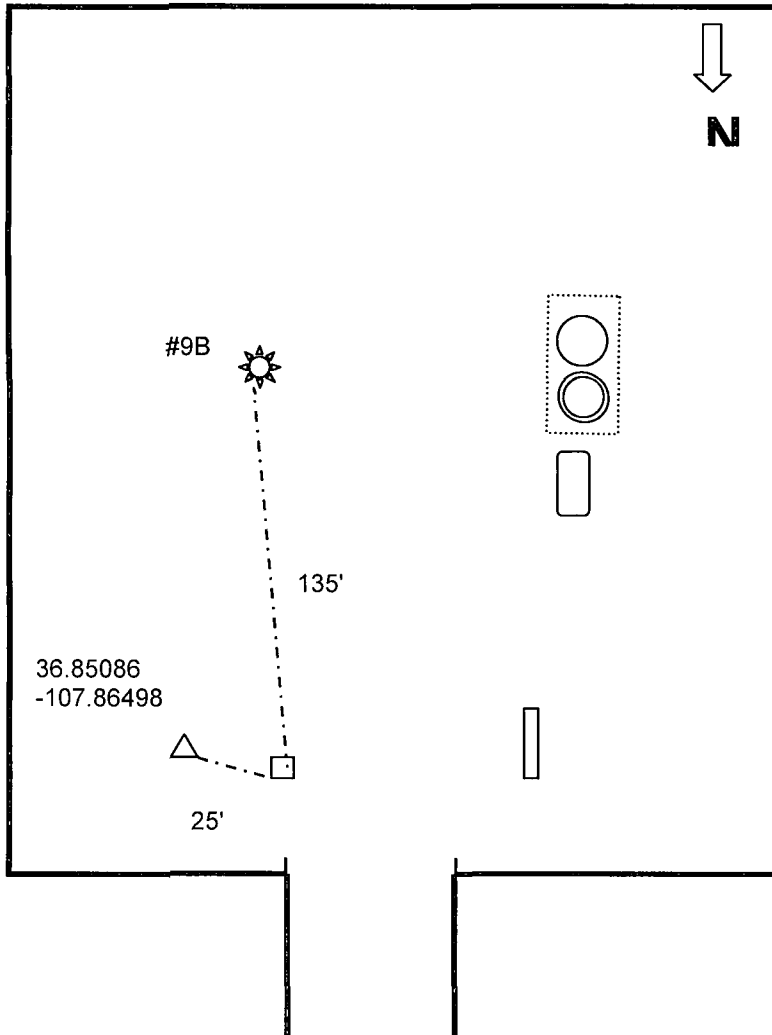

Drill ground bed approximately 135' north of #9B wellhead at staked location. Install single well solar array at staked location and connect to wellhead & new groundbed at lengths below.

#9B Cables:

Negative: 135'

Positive: 25'

Total Ditch: 160'