

District I
1625 N. French Dr., Hobbs, NM 88240
District II
1301 W. Grand Avenue, Artesia, NM 88210
District III
1000 Rio Brazos Road, Aztec, NM 87410
District IV
1220 S. St. Francis Dr., Santa Fe, NM 87505

State of New Mexico
Energy Minerals and Natural Resources
Oil Conservation Division
1220 South St. Francis Dr.
Santa Fe, NM 87505

Form C-141
Revised October 10, 2003

Submit 2 Copies to appropriate
District Office in accordance
with Rule 116 on back
side of form

Release Notification and Corrective Action

30-039-21624

OPERATOR

☐ Initial Report ☒ Final Report

Name of Company	Burlington Resources, A Wholly Owned Subsidiary of ConocoPhillips Company	Contact	Kelsi Gurvitz
Address	3401 E. 30th St., Farmington, NM 87402	Telephone No.	505-599-3403
Facility Name	San Juan 29-7 Unit #88A	Facility Type	Gas Well
		API #	300-39-21624
Surface Owner	Private	Mineral Owner	Federal
		Lease No.	SF-078943

LOCATION OF RELEASE

Unit Letter	Section	Township	Range	Feet from the	North/South Line	Feet from the	East/West Line	County
C	06	T29N	R07W	1050'	North	900'	West	Rio Arriba

Latitude 36.75895° N Longitude 107.61472° W

NATURE OF RELEASE

Type of Release – Paraffin & Produced water	Volume of Release – 6.5 BBL (5.5 BBL paraffin & 1 BBL produced water)	Volume Recovered – 5.75 BBL
Source of Release: Union on Discharge at Pumping Tee	Date and Hour of Occurrence unknown	Date and Hour of Discovery 1/8/10 – 2:30 p.m.
Was Immediate Notice Given? <input type="checkbox"/> Yes <input type="checkbox"/> No <input checked="" type="checkbox"/> Not Required	If YES, To Whom?	
By Whom?	Date and Hour –	
Was a Watercourse Reached? <input type="checkbox"/> Yes <input checked="" type="checkbox"/> No	If YES, Volume Impacting the Watercourse.	
If a Watercourse was Impacted, Describe Fully.*		
Describe Cause of Problem and Remedial Action Taken.* On January 8, 2010, it was discovered that the union on the discharge of the pumping tee was leaking due to a freeze in the line to the tank. Upon discovery, the well was shut in and a vacuum truck was called to location.		
Describe Area Affected and Cleanup Action Taken.* All fluid remained on location. Approximately 5.75 BBLS of fluid were recovered by the vacuum truck. Excavation and confirmation sampling occurred. Analytical results were below the regulatory standards set forth in the NMOCD Guidelines for Remediation of Leaks, Spills and Releases; therefore no further action is needed.		
I hereby certify that the information given above is true and complete to the best of my knowledge and understand that pursuant to NMOCD rules and regulations all operators are required to report and/or file certain release notifications and perform corrective actions for releases which may endanger public health or the environment. The acceptance of a C-141 report by the NMOCD marked as "Final Report" does not relieve the operator of liability should their operations have failed to adequately investigate and remediate contamination that pose a threat to ground water, surface water, human health or the environment. In addition, NMOCD acceptance of a C-141 report does not relieve the operator of responsibility for compliance with any other federal, state, or local laws and/or regulations.		
Signature: <i>Kelsi Gurvitz</i>	OIL CONSERVATION DIVISION	
Printed Name: Kelsi Gurvitz	Approved by District Supervisor: <i>Jonathon Kelly</i>	
Title: Environmental Consultant	Approval Date: <i>12/6/2011</i>	Expiration Date:
E-mail Address: kelsi.m.gurvitz@conocophillips.com	Conditions of Approval:	Attached <input type="checkbox"/>
Date: 12/1/10	Phone: 505-599-3403	

* Attach Additional Sheets If Necessary

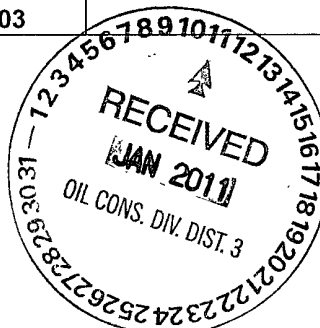



July 16, 2010

Project No. 92115-1327

Ms. Kelsi Gurvitz
ConocoPhillips
3401 East 30th Street
Farmington, New Mexico 87401

Phone: (505) 599-3403
Fax: (505) 599-4005

RE: CONFIRMATION SAMPLING DOCUMENTATION FOR THE SAN JUAN 29-7 UNIT #88A (hBr) WELL SITE, RIO ARriba COUNTY, NEW MEXICO

Dear Ms. Gurvitz;

Enclosed please find the field notes and analytical results for confirmation sampling activities performed at the San Juan 29-7 #88A (hBr) well site located in Section 6, Township 29N, Range 7W, Rio Arriba County, New Mexico. Prior to Envirotech's arrival, the area of release had been excavated to approximately 50' x 30' x 1.5' deep. Upon Envirotech's arrival, a brief site assessment was conducted and the cleanup standard for the site was determined to be 5000 ppm TPH and 100 ppm organic vapors, pursuant to New Mexico Oil Conservation Division (NMOCD) Guidelines for Remediation of Leaks, Spills, and Releases.

One (1) composite sample was collected from the excavation. The sample was analyzed in the field for total petroleum hydrocarbons (TPH) via USEPA Method 418.1 and for organic vapors using a photo-ionization detector (PID). The sample returned results below the 5000 ppm limit for TPH; however the sample was above the 100 ppm limit for organic vapors. The sample was then placed into a four (4) ounce glass jar, capped head space free, and transported on ice under chain of custody to Envirotech's laboratory to be analyzed for benzene and BTEX via USEPA Method 8021. The sample returned results below the regulatory limits of 10 ppm benzene and 50 ppm BTEX; therefore no further excavation was required. Envirotech Incorporated recommends no further action in regards to this incident.

We appreciate the opportunity to be of service. If you have questions or require additional information, please contact our office at 505-632-0615.

Respectfully submitted,
ENVIROTECH, INC.

Toni McKnight
Staff Engineer/Geologist
tmcknight@envirotech-inc.com

Enclosure(s): Field Notes
Analytical Results

Cc: Client File: 92115

12115-1327



8786 U.S. Hwy 64, Farmington, NM 87401

C.O.C. No:

PAGE NO: 1 OF 1

DATE STARTED: June 15, 2010

DATE FINISHED: June 15, 2011

ENVIRONMENTAL

POSAL FACILITY: FEI REMEDIATION METHOD: Landfarm

USE OF RELEASE: *Broken Value* MATERIAL RELEASED: *Condensed*

LOCATED APPROXIMATELY: 2 FT. 3 FROM WETLAND

DEPTH TO GROUNDWATER: $\approx 10'$ NEAREST WATER SOURCE: $> 1,000'$ NEAREST SURFACE WATER: $> 1,000'$

OCD RANKING SCORE: 0 NMOCD TPH CLOSURE STD: 5.00 PPM

LAND EXCAVATION DESCRIPTION:
Excavated by CF&M oilfield services to Final Extents upon Arrival.

[illegible]

SPILL PERIMETER

OVM RESULTS

SPILL PROFILE

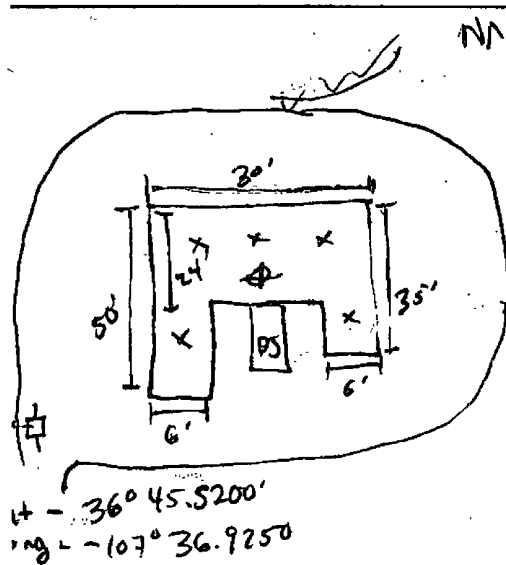
[illegible]

$L \quad | \quad 1.5'$

TRAVEL NOTES: CALLED OUT: @ 10:30 - left @ 11:00

ONSITE: 11:45 - Left @ 13:00



envirotech

**EPA METHOD 418.1
TOTAL PETROLEUM
HYDROCARBONS**

Client:	ConocoPhillips	Project #:	92115-1327
Sample No.:	1	Date Reported:	6/18/2010
Sample ID:	Composite Sample	Date Sampled:	6/15/2010
Sample Matrix:	Soil	Date Analyzed:	6/15/2010
Preservative:	Cool	Analysis Needed:	TPH-418.1
Condition:	Cool and Intact		

Parameter	Concentration (mg/kg)	Det. Limit (mg/kg)
Total Petroleum Hydrocarbons	1,040	5.0

ND = Parameter not detected at the stated detection limit.

References: Method 418.1, Petroleum Hydrocarbons, Total Recoverable, Chemical Analysis of Water and Waste, USEPA Storet No. 4551, 1978.

Comments: **San Juan 29-7 Unit #88A**

Instrument calibrated to 220 ppm standard. Zeroed before each sample

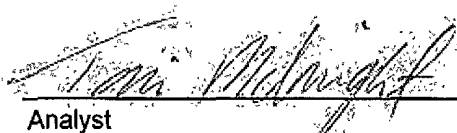
Analyst

Toni McKnight
Printed

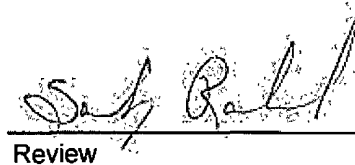
Review

Sarah Rowland
Printed



envirotech

Analytical Laboratory

EPA METHOD 8021 AROMATIC VOLATILE ORGANICS

Client:	ConocoPhillips	Project #:	92115-1327
Sample ID:	Composite	Date Reported:	06-17-10
Laboratory Number:	54753	Date Sampled:	06-15-10
Chain of Custody:	9692	Date Received:	06-15-10
Sample Matrix:	Soil	Date Analyzed:	06-16-10
Preservative:	Cool	Date Extracted:	06-15-10
Condition:	Intact	Analysis Requested:	BTEX

Parameter	Concentration (ug/Kg)	Det. Limit (ug/Kg)
Benzene	3.4	0.9
Toluene	60.7	1.0
Ethylbenzene	172	1.0
p,m-Xylene	2,240	1.2
o-Xylene	570	0.9
Total BTEX	3,050	

ND - Parameter not detected at the stated detection limit.

Surrogate Recoveries:	Parameter	Percent Recovery
	Fluorobenzene	100 %
	1,4-difluorobenzene	100 %
	Bromochlorobenzene	100 %

References: Method 5030B, Purge-and-Trap, Test Methods for Evaluating Solid Waste, SW-846, USEPA, December 1996.

Method 8021B, Aromatic Volatile Organics, Test Methods for Evaluating Solid Waste, SW-846, USEPA, December 1996.

Comments: Confirmation Sampling / San Juan 29-7 Unit #88A

Analyst

Review



envirotech

Analytical Laboratory

EPA METHOD 8021 AROMATIC VOLATILE ORGANICS

Client:	N/A	Project #:	N/A
Sample ID:	0616BBL QA/QC	Date Reported:	06-17-10
Laboratory Number:	54753	Date Sampled:	N/A
Sample Matrix:	Soil	Date Received:	N/A
Preservative:	N/A	Date Analyzed:	06-16-10
Condition:	N/A	Analysis:	BTEX

Calibration and Detection Limits (ug/E)	I-Cal RF	C-Cal RF	%Diff	Blank Conc	Detect Limit
		Accept Range 0 - 15%			
Benzene	1.2597E+006	1.2622E+006	0.2%	ND	0.1
Toluene	1.1556E+006	1.1579E+006	0.2%	ND	0.1
Ethylbenzene	1.0366E+006	1.0387E+006	0.2%	ND	0.1
p,m-Xylene	2.5600E+006	2.5651E+006	0.2%	ND	0.1
o-Xylene	9.3669E+005	9.3857E+005	0.2%	ND	0.1

Duplicate Conc. (ug/Kg)	Sample	Duplicate	%Diff	Accept Range	Detect Limit
Benzene	2.4	2.3	4.2%	0 - 30%	0.9
Toluene	60.7	57.7	4.9%	0 - 30%	1.0
Ethylbenzene	172	169	1.9%	0 - 30%	1.0
p,m-Xylene	2,240	2,240	0.0%	0 - 30%	1.2
o-Xylene	570	564	1.1%	0 - 30%	0.9

Spike Conc. (ug/Kg)	Sample	Amount Spiked	Spiked Sample	% Recovery	Accept Range
Benzene	2.4	50.0	46.3	88.3%	39 - 150
Toluene	60.7	50.0	104	93.7%	46 - 148
Ethylbenzene	172	50.0	266	120%	32 - 160
p,m-Xylene	2,240	100	2,330	99.6%	46 - 148
o-Xylene	570	50.0	613	99.0%	46 - 148

ND - Parameter not detected at the stated detection limit.

References: Method 5030B, Purge-and-Trap, Test Methods for Evaluating Solid Waste, SW-846, USEPA, December 1996.
Method 8021B, Aromatic and Halogenated Volatiles by Gas Chromatography Using Photoionization and/or Electrolytic Conductivity Detectors, SW-846, USEPA December 1996

Comments: QA/QC for Samples 54753, 54754, 54700-54702, 54731 and 54732.

Analyst

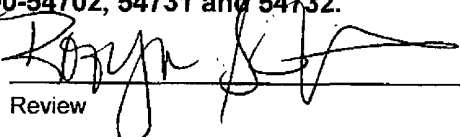
Review



envirotech

CONTINUOUS CALIBRATION
EPA METHOD 418.1
TOTAL PETROLEUM
HYDROCARBONS

Cal. Date: 15-Jun-10

Parameter	Standard Concentration mg/L	Concentration Reading mg/L
TPH	100	
	220	207
	500	
	1000	

The accepted percent relative deviation (%RSD) of the calibration factor is less than 20% over the working range.

Analyst

7/15/10
Date

Toni McKnight

Print Name

Review

7/12/10
Date

Sarah Rowland

Print Name

CHAIN OF CUSTODY RECORD

09692

Client: Conoco Phillips		Project Name / Location: San Juan 29-7		ANALYSIS / PARAMETERS RUSH													
Client Address:		Sampler Name: Toni McKnight															
Client Phone No.:		Client No.: 92115-1327															

Sample No./ Identification	Sample Date	Sample Time	Lab No.	Sample Matrix	No./Volume of Containers	Preservative HgCl ₂ HCl	TPH (Method 8015)	BTEX (Method 8021)	VOC (Method 8260)	RCRA 8 Metals	Cation / Anion	RCI	TCLP with H/P	PAH	TPH (418.1)	CHLORIDE			Sample Cool	Sample Intact
Composite	June 15, 2010	12:24	54753	Soil Solid	1/4oz		✓	✓											✓	✓
				Soil Solid	Sludge Aqueous															
				Soil Solid	Sludge Aqueous															
				Soil Solid	Sludge Aqueous															
				Soil Solid	Sludge Aqueous															
				Soil Solid	Sludge Aqueous															
				Soil Solid	Sludge Aqueous															
				Soil Solid	Sludge Aqueous															
				Soil Solid	Sludge Aqueous															
				Soil Solid	Sludge Aqueous															
				Soil Solid	Sludge Aqueous															
				Soil Solid	Sludge Aqueous															
				Soil Solid	Sludge Aqueous															

Relinquished by: (Signature) Toni McKnight	Date June 15, 2010	Time 14:30	Received by: (Signature) [Signature]	Date 6/15/10	Time 14:30
Relinquished by: (Signature)			Received by: (Signature)		
Relinquished by: (Signature)			Received by: (Signature)		

RUSH!!

envirotech
 Analytical Laboratory

5796 US Highway 64 • Farmington, NM 87401 • 505-632-0615 • lab@envirotech-inc.com