

**UNITED STATES
DEPARTMENT OF THE INTERIOR
BUREAU OF LAND MANAGEMENT**

RECEIVED**JAN 05 2012**

Sundry Notices and Reports on Wells

Farmington Field Office
Bureau of Land Management1. Type of Well
GAS5. Lease Number
SF-0789956. If Indian, All. or
Tribe Name7. Unit Agreement Name
San Juan 31-6 Unit

2. Name of Operator

ConocoPhillips

3. Address & Phone No. of Operator

PO Box 4289, Farmington, NM 87499 (505) 326-9700

8. Well Name & Number
San Juan 31-6 Unit 45N9. API Well No.

30-039-30298

4. Location of Well, Footage, Sec., T, R, M

Unit P (SESE), 480' FSL & 130' FEL, Section 31, T31N, R6W, NMPM

Unit J (NWSE), 1364' FSL & 1411' FEL, Section 31, T31N, R6W, NMPM

10. Field and Pool
Blanco MV/Basin DK11. County and State
Rio Arriba, NM**12. CHECK APPROPRIATE BOX TO INDICATE NATURE OF NOTICE, REPORT, OTHER DATA**

Type of Submission

Type of Action

☐ Notice of Intent☐ Abandonment☐ Change of Plans☒ Other - Cathodic☒ Subsequent Report☐ Recompletion☐ New Construction☐ Plugging☐ Non-Routine Fracturing☐ Final Abandonment☐ Casing Repair☐ Water Shut off☐ Altering Casing☐ Conversion to Injection**RCVD JAN 11 '12
OIL CONS. DIV.****13. Describe Proposed or Completed Operations****DIST. 3**

Attached is a drawing for the placement of the cathodic ground, rectifier and cable for the subject well.

ACCEPTED FOR RECORD**JAN 06 2012****FARMINGTON FIELD OFFICE
BY Denise Journey****14. I hereby certify that the foregoing is true and correct.**

Signed

Denise Journey

Denise Journey

Title Staff Regulatory TechnicianDate 12-28-11

(This space for Federal or State Office use)

APPROVED BY _____ Title _____ Date _____

CONDITION OF APPROVAL, if any:

Title 18 U.S.C. Section 1001, makes it a crime for any person knowingly and willfully to make any department or agency of the United States any false, fictitious or fraudulent statements or representations as to any matter within its jurisdiction

NMOCD-A

R

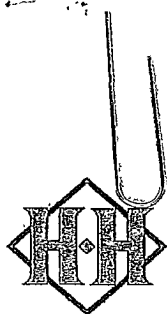

TECHNICAL SERVICES
A CORROSION COMPANY

CATHODIC PROTECTION PLAN FOR NEW WELLS

WELL NAME SJ 31-6 #45G LEGALS P-31-31-6 COUNTY Rio Arriba

PURPOSED C.P. SYSYTEM: Drill G.B. and set rect. on west edge of location. Set meter pole
of span pole # 60024 and trench approx 175' of A/C to rectifier. Trench approx 250' of #8 neg
cable from rectifier to well head.

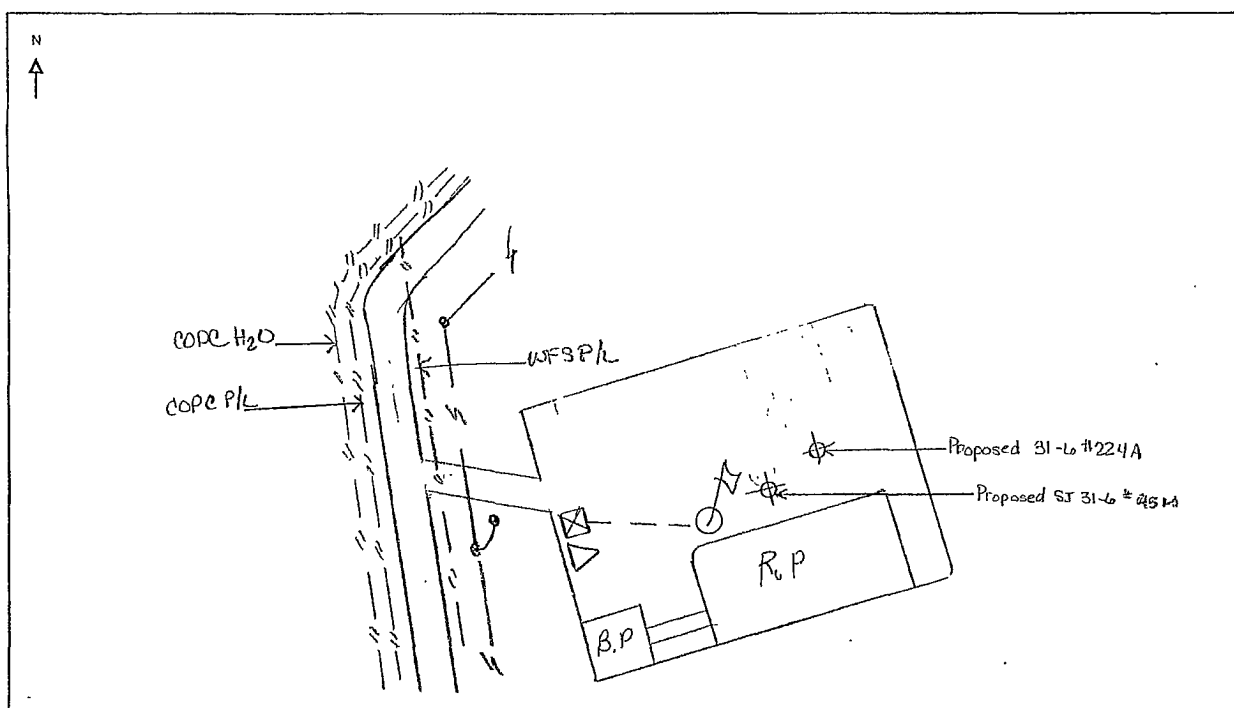

EXISTING WELLHEAD	METER HOUSE	G.B.	POWER SOURCE	CABLE	NEW WELL	OVERHEAD A.C.

COMMENTS: Place G.B. and rectifier on. proposed well to be drilled first, then tie other
systems wells to system

NEAREST POWER SOURCE Overhead A/c. DISTANCE: 175'
PIPELINES IN AREA: COPE H2O, COPE PL; WFSP/L

TECHNICIAN: Jim U. Hernandez DATE: 11/14/2006