

UNITED STATES
DEPARTMENT OF THE INTERIOR
BUREAU OF LAND MANAGEMENT

FORM APPROVED
OMB No. 1004-0137
Expires July 31, 2010

SUNDRY NOTICES AND REPORTS ON WELLS
**Do not use this form for proposals to drill or to re-enter an
abandoned well. Use Form 3160-3 (APD) for such proposals.**

1. Type of Well <input type="checkbox"/> Oil Well <input checked="" type="checkbox"/> Gas Well <input type="checkbox"/> Other		5. Lease Serial No SF-078835
2. Name of Operator ConocoPhillips Company		6. If Indian, Allottee or Tribe Name San Juan 28-7 Unit
3a. Address PO Box 4289, Farmington, NM 87499	3b. Phone No (include area code) (505) 326-9700	7. If Unit of CA/Agreement, Name and/or No San Juan 28-7 Unit 253N
4. Location of Well (Footage, Sec., T., R., M., or Survey Description) Surface Unit H (SENE), 2394' FNL & 1099' FEL, Sec. 7, T27N, R7W,		8. Well Name and No San Juan 28-7 Unit 253N
		9. API Well No 30-039-31032
		10. Field and Pool or Exploratory Area Blanco MV/Basin DK
		11. Country or Parish, State Rio Arriba, New Mexico

12. CHECK THE APPROPRIATE BOX(ES) TO INDICATE NATURE OF NOTICE, REPORT OR OTHER DATA

TYPE OF SUBMISSION	TYPE OF ACTION			
<input type="checkbox"/> Notice of Intent	<input type="checkbox"/> Acidize	<input type="checkbox"/> Deepen	<input type="checkbox"/> Production (Start/Resume)	<input type="checkbox"/> Water Shut-Off
<input checked="" type="checkbox"/> Subsequent Report	<input type="checkbox"/> Alter Casing	<input type="checkbox"/> Fracture Treat	<input type="checkbox"/> Reclamation	<input type="checkbox"/> Well Integrity
<input type="checkbox"/> Final Abandonment Notice	<input type="checkbox"/> Casing Repair	<input type="checkbox"/> New Construction	<input type="checkbox"/> Recomplete	<input checked="" type="checkbox"/> Other <u>Cathodic Sundry</u>
	<input type="checkbox"/> Change Plans	<input type="checkbox"/> Plug and Abandon	<input type="checkbox"/> Temporarily Abandon	
	<input type="checkbox"/> Convert to Injection	<input type="checkbox"/> Plug Back	<input type="checkbox"/> Water Disposal	

13 Describe Proposed or Completed Operation Clearly state all pertinent details, including estimated starting date of any proposed work and approximate duration thereof.
If the proposal is to deepen directionally or recompleat horizontally, give subsurface locations and measured and true vertical depths of all pertinent markers and zones
Attach the bond under which the work will be performed or provide the Bond No on file with BLM/BIA Required subsequent reports must be filed within 30 days
following completion of the involved operations If the operation results in a multiple completion or recompleat in a new interval, a Form 3160-4 must be filed once
Testing has been completed Final Abandonment Notices must be filed only after all requirements, including reclamation, have been completed and the operator has
determined that the site is ready for final inspection)

Attached is a drawing for the placement of the cathodic ground, rectifier and cable for the subject well.

ACCEPTED FOR RECORD

APR 25 2012

**FARMINGTON FIELD OFFICE
BY**

Eric J. Press

**RCVD MAY 2 '12
OIL CONS. DIV.
DIST. 3**

14 I hereby certify that the foregoing is true and correct. Name (Printed/Typed) DENISE JOURNEY	Title REGULATORY TECHNICIAN
Signature <i>Denise Journey</i>	Date 4/19/2012

THIS SPACE FOR FEDERAL OR STATE OFFICE USE

Approved by	Title	Date
Conditions of approval, if any, are attached. Approval of this notice does not warrant or certify that the applicant holds legal or equitable title to those rights in the subject lease which would entitle the applicant to conduct operations thereon.	Office	

Title 18 U.S.C Section 1001 and Title 43 U.S.C. Section 1212, make it a crime for any person knowingly and willfully to make to any department or agency of the United States any false, fictitious or fraudulent statements or representations as to any matter within its jurisdiction.



San Juan 28-7 #253N

Section 07, T27N, R07W, Rio Arriba County, NM

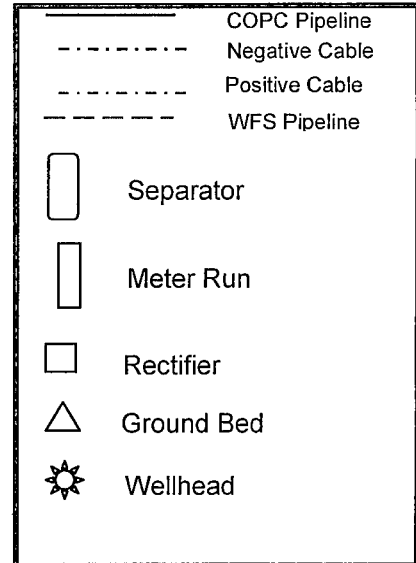
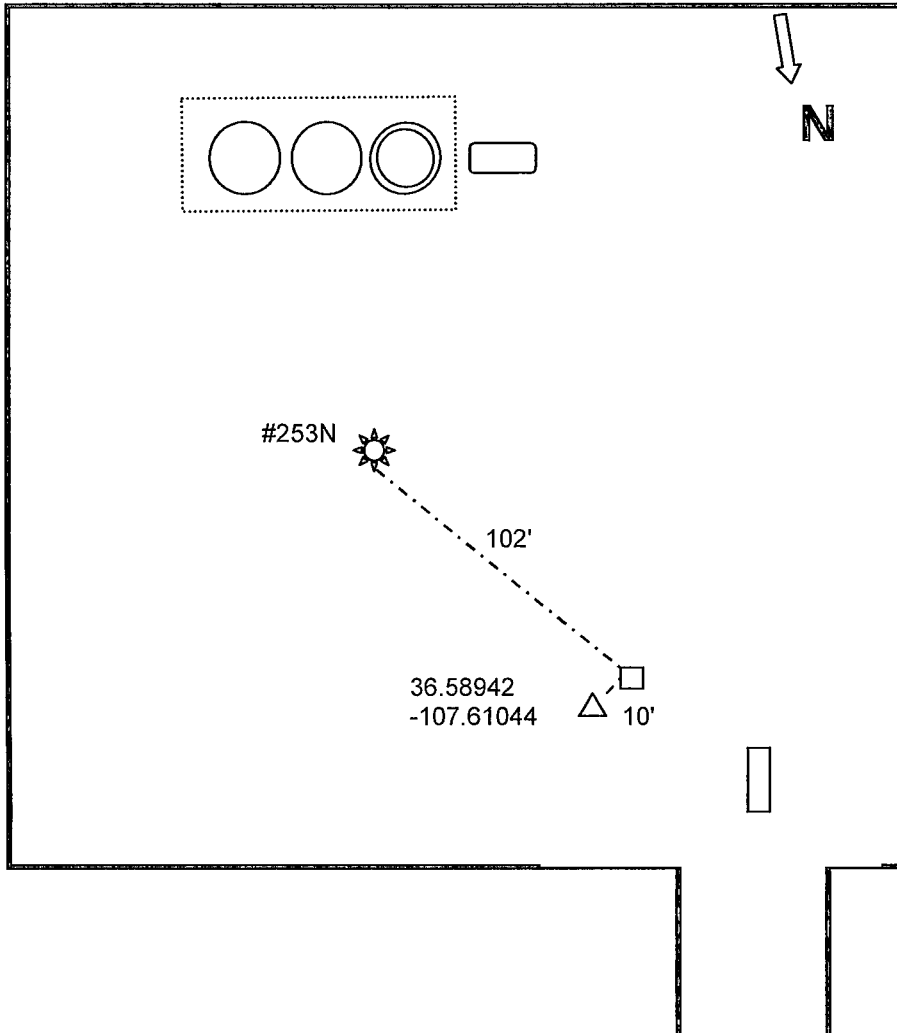

Drill ground bed approximately 102' northwest of #253N wellhead at staked location. Install single-well solar unit at staked location and connect to groundbed and #253N wellhead at lengths below.

#253N Cables:

Negative: 102'

Positive: 10'

Total Ditch: 112'