

Submit 3 Copies To Appropriate District Office  
District I  
1625 N French Dr, Hobbs, NM 88240  
District II  
1301 W Grand Ave., Artesia, NM 88210  
District III  
1000 Rio Brazos Rd, Aztec, NM 87410  
District IV  
1220 S St. Francis Dr, Santa Fe, NM 87505

State of New Mexico  
Energy, Minerals and Natural Resources

OIL CONSERVATION DIVISION  
1220 South St. Francis Dr.  
Santa Fe, NM 87505

Form C-103  
Jun 19, 2008

SUNDRY NOTICES AND REPORTS ON WELLS (DO NOT USE THIS FORM FOR PROPOSALS TO DRILL OR TO DEEPEN OR PLUG BACK TO A DIFFERENT RESERVOIR USE "APPLICATION FOR PERMIT" (FORM C-101) FOR SUCH PROPOSALS )		WELL API NO. <b>30-045-35208</b>
1. Type of Well: Oil Well <input type="checkbox"/> Gas Well <input checked="" type="checkbox"/> Other		5. Indicate Type of Lease STATE <input type="checkbox"/> FEE <input checked="" type="checkbox"/>
2. Name of Operator <b>Burlington Resources Oil Gas Company LP</b>		6. State Oil & Gas Lease No. FEE
3. Address of Operator P.O. Box 4289, Farmington, NM 87499-4289		7. Lease Name or Unit Agreement Name <b>San Juan 32-9 Unit</b>
4. Well Location Unit Letter <b>P</b> : <b>890</b> feet from the <b>South</b> line and <b>1168</b> feet from the <b>East</b> line Section <b>5</b> Township <b>31N</b> Range <b>10W 9W</b> NMPM <b>San Juan County</b>		8. Well Number <b>24B</b>
11. Elevation (Show whether DR, RKB, RT, GR, etc.) 6637' GR		9. OGRID Number <b>14538</b>
		10. Pool name or Wildcat <b>Blanco MV/Basin DK/Basin Mancos</b>

12. Check Appropriate Box to Indicate Nature of Notice, Report or Other Data

NOTICE OF INTENTION TO:

PERFORM REMEDIAL WORK ☐ PLUG AND ABANDON ☐  
TEMPORARILY ABANDON ☐ CHANGE PLANS ☐  
PULL OR ALTER CASING ☐ MULTIPLE COMPL ☐  
DOWNHOLE COMMINGLE ☐

OTHER: ☐

SUBSEQUENT REPORT OF:

REMEDIAL WORK ☐ ALTERING CASING ☐  
COMMENCE DRILLING OPNS. ☐ P AND A ☐  
CASING/CEMENT JOB ☐

OTHER: ☒ CATHODIC SUNDRY

13. Describe proposed or completed operations. (Clearly state all pertinent details, and give pertinent dates, including estimated date of starting any proposed work). SEE RULE 1103. For Multiple Completions: Attach wellbore diagram of proposed completion or recompletion.

ATTACHED IS A DRAWING FOR THE PLACEMENT OF THE CATHODIC GROUND, RECTIFIER AND CABLE FOR THE SUBJECT WELL.

Spud Date: 10/28/11

Rig Released Date: 11/23/11

I hereby certify that the information above is true and complete to the best of my knowledge and belief.

SIGNATURE Denise Journey TITLE Regulatory Technician DATE 5/10/12

Type or print name Denise Journey E-mail address: Denise.Journey@conocophillips.com PHONE: 505-326-9556

**For State Use Only**

APPROVED BY: ACCEPTED FOR RECORD TITLE \_\_\_\_\_ DATE MAY 11 2012  
Conditions of Approval (if any):

RCVD MAY 11 '12  
OIL CONS. DIV.  
DIST. 3

ca

✓



# San Juan 32-9 #24B

Section 05, T31N, R09W, San Juan County, NM

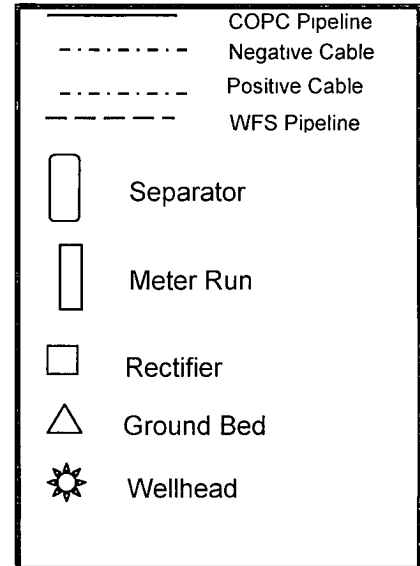
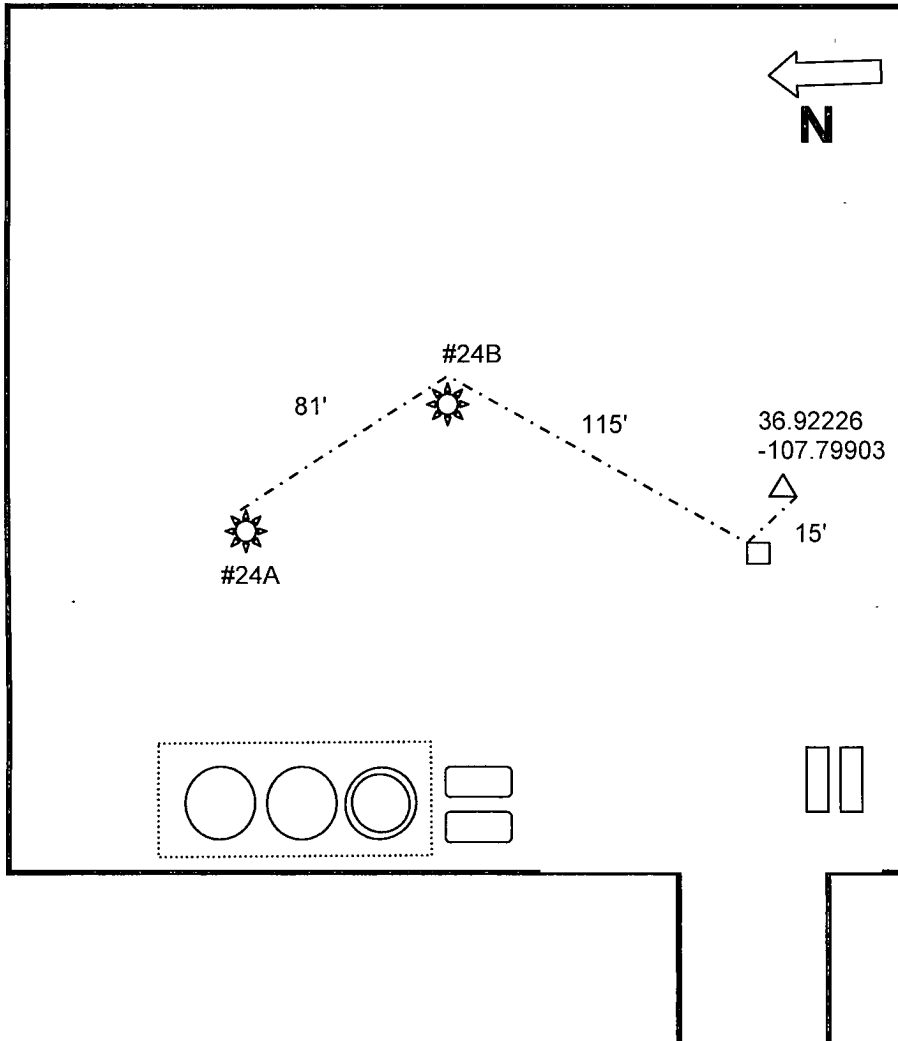

Drill ground bed approximately 115' southwest of #34B wellhead at staked location. Install 40-16 twin-well rectifier at staked location and tie-in to existing UGAC. Connect to groundbed, #24A and #34B wellheads at lengths below.

#34B Cables:

Negative: 311'

Positive: 15'

Total Ditch: 196'