

District I  
1625 N. French Dr , Hobbs, NM 88240

District II  
1301 W Grand Ave , Artesia, NM 88210

District III  
1000 Rio Brazos Rd , Aztec, NM 87410

District IV  
1220 S St Francis Dr., Santa Fe, NM 87505

State of New Mexico  
Energy Minerals and Natural Resources  
Department  
Oil Conservation Division  
1220 South St. Francis Dr.  
Santa Fe, NM 87505

Form C-144  
July 21, 2008

For temporary pits, closed-loop systems, and below-grade tanks, submit to the appropriate NMOCD District Office

For permanent pits and exceptions submit to the Santa Fe Environmental Bureau office and provide a copy to the appropriate NMOCD District Office

5228

**Pit, Closed-Loop System, Below-Grade Tank, or  
Proposed Alternative Method Permit or Closure Plan Application**

- Type of action: ☐ Permit of a pit, closed-loop system, below-grade tank, or proposed alternative method  
☒ Closure of a pit, closed-loop system, below-grade tank, or proposed alternative method  
☐ Modification to an existing permit  
☐ Closure plan only submitted for an existing permitted or non-permitted pit, closed-loop system, below-grade tank, or proposed alternative method

**Instructions: Please submit one application (Form C-144) per individual pit, closed-loop system, below-grade tank or alternative request**

Please be advised that approval of this request does not relieve the operator of liability should operations result in pollution of surface water, ground water or the environment. Nor does approval relieve the operator of its responsibility to comply with any other applicable governmental authority's rules, regulations or ordinances

Operator: <b>Burlington Resources Oil &amp; Gas Company, LP</b>		OGRID#: <b>14538</b>
Address: <b>P.O. Box 4289, Farmington, NM 87499</b>		
Facility or well name: <b>SAN JUAN 27-4 UNIT 140B</b>		
API Number: <b>30-039-30487</b>	OCD Permit Number: _____	
U/L or Qtr/Qtr: <b>H(SE/NE)</b>	Section: <b>10</b>	Township: <b>27N</b> Range: <b>4W</b> County: <b>Rio Arriba</b>
Center of Proposed Design: Latitude: <b>36.590006</b> °N Longitude: <b>107.2244388</b> °W NAD: <input type="checkbox"/> 1927 <input checked="" type="checkbox"/> 1983		
Surface Owner: <input checked="" type="checkbox"/> Federal <input type="checkbox"/> State <input type="checkbox"/> Private <input type="checkbox"/> Tribal Trust or Indian Allotment		

<input checked="" type="checkbox"/> <b>Pit:</b> Subsection F or G of 19 15.17 11 NMAC	
Temporary <input checked="" type="checkbox"/> Drilling <input type="checkbox"/> Workover	
<input type="checkbox"/> Permanent <input type="checkbox"/> Emergency <input type="checkbox"/> Cavitation <input type="checkbox"/> P&A	
<input checked="" type="checkbox"/> Lined <input type="checkbox"/> Unlined	Liner type: _____ Thickness <b>20</b> mil <input checked="" type="checkbox"/> LLDPE <input type="checkbox"/> HDPE <input type="checkbox"/> PVC <input type="checkbox"/> Other _____
<input checked="" type="checkbox"/> String-Reinforced	
Liner Seams <input checked="" type="checkbox"/> Welded <input checked="" type="checkbox"/> Factory <input type="checkbox"/> Other _____	Volume <b>4400</b> bbl Dimensions L <b>65'</b> x W <b>45'</b> x D <b>10'</b>

<input type="checkbox"/> <b>Closed-loop System:</b> Subsection H of 19 15 17 11 NMAC	
Type of Operation: <input type="checkbox"/> P&A <input type="checkbox"/> Drilling a new well <input type="checkbox"/> Workover or Drilling (Applies to activities which require prior approval of a permit or notice of intent)	
<input type="checkbox"/> Drying Pad <input type="checkbox"/> Above Ground Steel Tanks <input type="checkbox"/> Haul-off Bins <input type="checkbox"/> Other _____	
<input type="checkbox"/> Lined <input type="checkbox"/> Unlined	Liner type: _____ Thickness _____ mil <input type="checkbox"/> LLDPE <input type="checkbox"/> HDPE <input type="checkbox"/> PVD <input type="checkbox"/> Other _____
Liner Seams <input type="checkbox"/> Welded <input type="checkbox"/> Factory <input type="checkbox"/> Other _____	

<input type="checkbox"/> <b>Below-grade tank:</b> Subsection I of 19 15 17 11 NMAC	
Volume: _____ bbl	Type of fluid: _____
Tank Construction material: _____	
<input type="checkbox"/> Secondary containment with leak detection <input type="checkbox"/> Visible sidewalls, liner, 6-inch lift and automatic overflow shut-off	
<input type="checkbox"/> Visible sidewalls and liner <input type="checkbox"/> Visible sidewalls only <input type="checkbox"/> Other _____	
Liner Type _____ Thickness _____ mil <input type="checkbox"/> HDPE <input type="checkbox"/> PVC <input type="checkbox"/> Other _____	

<input type="checkbox"/> <b>Alternative Method:</b>	
Submittal of an exception request is required. Exceptions must be submitted to the Santa Fe Environmental Bureau office for consideration of approval.	

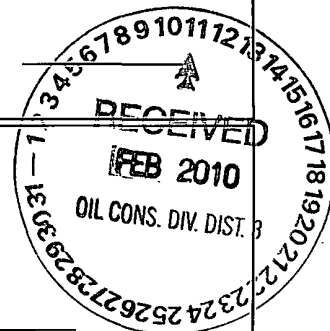

333+

6	<p><b>Fencing:</b> Subsection D of 19 15 17 11 NMAC (<i>Applies to permanent pit, temporary pits, and below-grade tanks</i>)</p> <p><input type="checkbox"/> Chain link, six feet in height, two strands of barbed wire at top (<i>Required if located within 1000 feet of a permanent residence, school, hospital, institution or church</i>)</p> <p><input type="checkbox"/> Four foot height, four strands of barbed wire evenly spaced between one and four feet</p> <p><input type="checkbox"/> Alternate Please specify _____</p>																				
7	<p><b>Netting:</b> Subsection E of 19 15 17 11 NMAC (<i>Applies to permanent pits and permanent open top tanks</i>)</p> <p><input type="checkbox"/> Screen <input type="checkbox"/> Netting <input type="checkbox"/> Other _____</p> <p><input type="checkbox"/> Monthly inspections (<i>If netting or screening is not physically feasible</i>)</p>																				
8	<p><b>Signs:</b> Subsection C of 19 15 17.11 NMAC</p> <p><input type="checkbox"/> 12" X 24", 2" lettering, providing Operator's name, site location, and emergency telephone numbers</p> <p><input checked="" type="checkbox"/> Signed in compliance with 19 15 3 103 NMAC</p>																				
9	<p><b>Administrative Approvals and Exceptions:</b></p> <p>Justifications and/or demonstrations of equivalency are required. Please refer to 19 15 17 NMAC for guidance.</p> <p><i>Please check a box if one or more of the following is requested, if not leave blank:</i></p> <p><input type="checkbox"/> Administrative approval(s) Requests must be submitted to the appropriate division district of the Santa Fe Environmental Bureau office for consideration of approval (Fencing/BGT Liner)</p> <p><input type="checkbox"/> Exception(s) Requests must be submitted to the Santa Fe Environmental Bureau office for consideration of approval</p>																				
10	<p><b>Siting Criteria (regarding permitting):</b> 19.15.17.10 NMAC</p> <p><i>Instructions: The applicant must demonstrate compliance for each siting criteria below in the application. Recommendations of acceptable source material are provided below. Requests regarding changes to certain siting criteria may require administrative approval from the appropriate district office or may be considered an exception which must be submitted to the Santa Fe Environmental Bureau Office for consideration of approval. Applicant must attach justification for request. Please refer to 19.15.17.10 NMAC for guidance. Siting criteria does not apply to drying pads or above grade-tanks associated with a closed-loop system.</i></p> <table style="width: 100%;"> <tr> <td style="width: 80%;"> <p><b>Ground water is less than 50 feet below the bottom of the temporary pit, permanent pit, or below-grade tank.</b></p> <p>- NM Office of the State Engineer - iWATERS database search; USGS; Data obtained from nearby wells</p> </td> <td style="width: 20%; text-align: right;"> <input type="checkbox"/> Yes <input type="checkbox"/> No </td> </tr> <tr> <td> <p><b>Within 300 feet of a continuously flowing watercourse, or 200 feet of any other watercourse, lakebed, sinkhole, or playa lake (measured from the ordinary high-water mark).</b></p> <p>- Topographic map; Visual inspection (certification) of the proposed site</p> </td> <td style="text-align: right;"> <input type="checkbox"/> Yes <input type="checkbox"/> No </td> </tr> <tr> <td> <p><b>Within 300 feet from a permanent residence, school, hospital, institution, or church in existence at the time of initial application.</b></p> <p>(<i>Applies to temporary, emergency, or cavitation pits and below-grade tanks</i>)</p> <p>- Visual inspection (certification) of the proposed site, Aerial photo; Satellite image</p> </td> <td style="text-align: right;"> <input type="checkbox"/> Yes <input type="checkbox"/> No   <input type="checkbox"/> NA </td> </tr> <tr> <td> <p><b>Within 1000 feet from a permanent residence, school, hospital, institution, or church in existence at the time of initial application.</b></p> <p>(<i>Applied to permanent pits</i>)</p> <p>- Visual inspection (certification) of the proposed site, Aerial photo; Satellite image</p> </td> <td style="text-align: right;"> <input type="checkbox"/> Yes <input type="checkbox"/> No   <input type="checkbox"/> NA </td> </tr> <tr> <td> <p><b>Within 500 horizontal feet of a private, domestic fresh water well or spring that less than five households use for domestic or stock watering purposes, or within 1000 horizontal feet of any other fresh water well or spring, in existence at the time of initial application.</b></p> <p>- NM Office of the State Engineer - iWATERS database search, Visual inspection (certification) of the proposed site.</p> </td> <td style="text-align: right;"> <input type="checkbox"/> Yes <input type="checkbox"/> No </td> </tr> <tr> <td> <p><b>Within incorporated municipal boundaries or within a defined municipal fresh water well field covered under a municipal ordinance adopted pursuant to NMSA 1978, Section 3-27-3, as amended</b></p> <p>- Written confirmation or verification from the municipality; Written approval obtained from the municipality</p> </td> <td style="text-align: right;"> <input type="checkbox"/> Yes <input type="checkbox"/> No </td> </tr> <tr> <td> <p><b>Within 500 feet of a wetland.</b></p> <p>- US Fish and Wildlife Wetland Identification map, Topographic map; Visual inspection (certification) of the proposed site</p> </td> <td style="text-align: right;"> <input type="checkbox"/> Yes <input type="checkbox"/> No </td> </tr> <tr> <td> <p><b>Within the area overlying a subsurface mine.</b></p> <p>- Written confirmation or verification or map from the NM EMNRD - Mining and Mineral Division</p> </td> <td style="text-align: right;"> <input type="checkbox"/> Yes <input type="checkbox"/> No </td> </tr> <tr> <td> <p><b>Within an unstable area.</b></p> <p>- Engineering measures incorporated into the design; NM Bureau of Geology &amp; Mineral Resources; USGS; NM Geological Society; Topographic map</p> </td> <td style="text-align: right;"> <input type="checkbox"/> Yes <input type="checkbox"/> No </td> </tr> <tr> <td> <p><b>Within a 100-year floodplain</b></p> <p>- FEMA map</p> </td> <td style="text-align: right;"> <input type="checkbox"/> Yes <input type="checkbox"/> No </td> </tr> </table>	<p><b>Ground water is less than 50 feet below the bottom of the temporary pit, permanent pit, or below-grade tank.</b></p> <p>- NM Office of the State Engineer - iWATERS database search; USGS; Data obtained from nearby wells</p>	<input type="checkbox"/> Yes <input type="checkbox"/> No	<p><b>Within 300 feet of a continuously flowing watercourse, or 200 feet of any other watercourse, lakebed, sinkhole, or playa lake (measured from the ordinary high-water mark).</b></p> <p>- Topographic map; Visual inspection (certification) of the proposed site</p>	<input type="checkbox"/> Yes <input type="checkbox"/> No	<p><b>Within 300 feet from a permanent residence, school, hospital, institution, or church in existence at the time of initial application.</b></p> <p>(<i>Applies to temporary, emergency, or cavitation pits and below-grade tanks</i>)</p> <p>- Visual inspection (certification) of the proposed site, Aerial photo; Satellite image</p>	<input type="checkbox"/> Yes <input type="checkbox"/> No  <input type="checkbox"/> NA	<p><b>Within 1000 feet from a permanent residence, school, hospital, institution, or church in existence at the time of initial application.</b></p> <p>(<i>Applied to permanent pits</i>)</p> <p>- Visual inspection (certification) of the proposed site, Aerial photo; Satellite image</p>	<input type="checkbox"/> Yes <input type="checkbox"/> No  <input type="checkbox"/> NA	<p><b>Within 500 horizontal feet of a private, domestic fresh water well or spring that less than five households use for domestic or stock watering purposes, or within 1000 horizontal feet of any other fresh water well or spring, in existence at the time of initial application.</b></p> <p>- NM Office of the State Engineer - iWATERS database search, Visual inspection (certification) of the proposed site.</p>	<input type="checkbox"/> Yes <input type="checkbox"/> No	<p><b>Within incorporated municipal boundaries or within a defined municipal fresh water well field covered under a municipal ordinance adopted pursuant to NMSA 1978, Section 3-27-3, as amended</b></p> <p>- Written confirmation or verification from the municipality; Written approval obtained from the municipality</p>	<input type="checkbox"/> Yes <input type="checkbox"/> No	<p><b>Within 500 feet of a wetland.</b></p> <p>- US Fish and Wildlife Wetland Identification map, Topographic map; Visual inspection (certification) of the proposed site</p>	<input type="checkbox"/> Yes <input type="checkbox"/> No	<p><b>Within the area overlying a subsurface mine.</b></p> <p>- Written confirmation or verification or map from the NM EMNRD - Mining and Mineral Division</p>	<input type="checkbox"/> Yes <input type="checkbox"/> No	<p><b>Within an unstable area.</b></p> <p>- Engineering measures incorporated into the design; NM Bureau of Geology &amp; Mineral Resources; USGS; NM Geological Society; Topographic map</p>	<input type="checkbox"/> Yes <input type="checkbox"/> No	<p><b>Within a 100-year floodplain</b></p> <p>- FEMA map</p>	<input type="checkbox"/> Yes <input type="checkbox"/> No
<p><b>Ground water is less than 50 feet below the bottom of the temporary pit, permanent pit, or below-grade tank.</b></p> <p>- NM Office of the State Engineer - iWATERS database search; USGS; Data obtained from nearby wells</p>	<input type="checkbox"/> Yes <input type="checkbox"/> No																				
<p><b>Within 300 feet of a continuously flowing watercourse, or 200 feet of any other watercourse, lakebed, sinkhole, or playa lake (measured from the ordinary high-water mark).</b></p> <p>- Topographic map; Visual inspection (certification) of the proposed site</p>	<input type="checkbox"/> Yes <input type="checkbox"/> No																				
<p><b>Within 300 feet from a permanent residence, school, hospital, institution, or church in existence at the time of initial application.</b></p> <p>(<i>Applies to temporary, emergency, or cavitation pits and below-grade tanks</i>)</p> <p>- Visual inspection (certification) of the proposed site, Aerial photo; Satellite image</p>	<input type="checkbox"/> Yes <input type="checkbox"/> No  <input type="checkbox"/> NA																				
<p><b>Within 1000 feet from a permanent residence, school, hospital, institution, or church in existence at the time of initial application.</b></p> <p>(<i>Applied to permanent pits</i>)</p> <p>- Visual inspection (certification) of the proposed site, Aerial photo; Satellite image</p>	<input type="checkbox"/> Yes <input type="checkbox"/> No  <input type="checkbox"/> NA																				
<p><b>Within 500 horizontal feet of a private, domestic fresh water well or spring that less than five households use for domestic or stock watering purposes, or within 1000 horizontal feet of any other fresh water well or spring, in existence at the time of initial application.</b></p> <p>- NM Office of the State Engineer - iWATERS database search, Visual inspection (certification) of the proposed site.</p>	<input type="checkbox"/> Yes <input type="checkbox"/> No																				
<p><b>Within incorporated municipal boundaries or within a defined municipal fresh water well field covered under a municipal ordinance adopted pursuant to NMSA 1978, Section 3-27-3, as amended</b></p> <p>- Written confirmation or verification from the municipality; Written approval obtained from the municipality</p>	<input type="checkbox"/> Yes <input type="checkbox"/> No																				
<p><b>Within 500 feet of a wetland.</b></p> <p>- US Fish and Wildlife Wetland Identification map, Topographic map; Visual inspection (certification) of the proposed site</p>	<input type="checkbox"/> Yes <input type="checkbox"/> No																				
<p><b>Within the area overlying a subsurface mine.</b></p> <p>- Written confirmation or verification or map from the NM EMNRD - Mining and Mineral Division</p>	<input type="checkbox"/> Yes <input type="checkbox"/> No																				
<p><b>Within an unstable area.</b></p> <p>- Engineering measures incorporated into the design; NM Bureau of Geology &amp; Mineral Resources; USGS; NM Geological Society; Topographic map</p>	<input type="checkbox"/> Yes <input type="checkbox"/> No																				
<p><b>Within a 100-year floodplain</b></p> <p>- FEMA map</p>	<input type="checkbox"/> Yes <input type="checkbox"/> No																				

11

**Temporary Pits, Emergency Pits and Below-grade Tanks Permit Application Attachment Checklist:** Subsection B of 19.15.17.9 NMAC  
*Instructions: Each of the following items must be attached to the application. Please indicate, by a check mark in the box, that the documents are attached.*

- ☐ Hydrogeologic Report (Below-grade Tanks) - based upon the requirements of Paragraph (4) of Subsection B of 19.15.17.9 NMAC
- ☐ Hydrogeologic Data (Temporary and Emergency Pits) - based upon the requirements of Paragraph (2) of Subsection B of 19.15.17.9
- ☐ Siting Criteria Compliance Demonstrations - based upon the appropriate requirements of 19.15.17.10 NMAC
- ☐ Design Plan - based upon the appropriate requirements of 19.15.17.11 NMAC
- ☐ Operating and Maintenance Plan - based upon the appropriate requirements of 19.15.17.12 NMAC
- ☐ Closure Plan (Please complete Boxes 14 through 18, if applicable) - based upon the appropriate requirements of Subsection C of 19.15.17.9 NMAC and 19.15.17.13 NMAC

☐ Previously Approved Design (attach copy of design)      API \_\_\_\_\_ or Permit \_\_\_\_\_

12

**Closed-loop Systems Permit Application Attachment Checklist:** Subsection B of 19.15.17.9 NMAC  
*Instructions: Each of the following items must be attached to the application. Please indicate, by a check mark in the box, that the documents are attached.*

- ☐ Geologic and Hydrogeologic Data (only for on-site closure) - based upon the requirements of Paragraph (3) of Subsection B of 19.15.17.9
- ☐ Siting Criteria Compliance Demonstrations (only for on-site closure) - based upon the appropriate requirements of 19.15.17.10 NMAC
- ☐ Design Plan - based upon the appropriate requirements of 19.15.17.11 NMAC
- ☐ Operating and Maintenance Plan - based upon the appropriate requirements of 19.15.17.12 NMAC
- ☐ Closure Plan (Please complete Boxes 14 through 18, if applicable) - based upon the appropriate requirements of Subsection C of 19.15.17.9 NMAC and 19.15.17.13 NMAC

☐ Previously Approved Design (attach copy of design)      API \_\_\_\_\_

☐ Previously Approved Operating and Maintenance Plan      API \_\_\_\_\_

13

**Permanent Pits Permit Application Checklist:** Subsection B of 19.15.17.9 NMAC

*Instructions: Each of the following items must be attached to the application. Please indicate, by a check mark in the box, that the documents are attached.*

- ☐ Hydrogeologic Report - based upon the requirements of Paragraph (1) of Subsection B of 19.15.17.9 NMAC
- ☐ Siting Criteria Compliance Demonstrations - based upon the appropriate requirements of 19.15.17.10 NMAC
- ☐ Climatological Factors Assessment
- ☐ Certified Engineering Design Plans - based upon the appropriate requirements of 19.15.17.11 NMAC
- ☐ Dike Protection and Structural Integrity Design: based upon the appropriate requirements of 19.15.17.11 NMAC
- ☐ Leak Detection Design - based upon the appropriate requirements of 19.15.17.11 NMAC
- ☐ Liner Specifications and Compatibility Assessment - based upon the appropriate requirements of 19.15.17.11 NMAC
- ☐ Quality Control/Quality Assurance Construction and Installation Plan
- ☐ Operating and Maintenance Plan - based upon the appropriate requirements of 19.15.17.12 NMAC
- ☐ Freeboard and Overtopping Prevention Plan - based upon the appropriate requirements of 19.15.17.11 NMAC
- ☐ Nuisance or Hazardous Odors, including H<sub>2</sub>S, Prevention Plan
- ☐ Emergency Response Plan
- ☐ Oil Field Waste Stream Characterization
- ☐ Monitoring and Inspection Plan
- ☐ Erosion Control Plan
- ☐ Closure Plan - based upon the appropriate requirements of Subsection C of 19.15.17.9 NMAC and 19.15.17.13 NMAC

14

**Proposed Closure:** 19.15.17.13 NMAC

*Instructions: Please complete the applicable boxes, Boxes 14 through 18, in regards to the proposed closure plan.*

Type    ☐ Drilling    ☐ Workover    ☐ Emergency    ☐ Cavitation    ☐ P&A    ☐ Permanent Pit    ☐ Below-grade Tank    ☐ Closed-loop System  
           ☐ Alternative

Proposed Closure Method    ☐ Waste Excavation and Removal  
   ☐ Waste Removal (Closed-loop systems only)  
   ☐ On-site Closure Method (only for temporary pits and closed-loop systems)  
   ☐ In-place Burial    ☐ On-site Trench  
   ☐ Alternative Closure Method (Exceptions must be submitted to the Santa Fe Environmental Bureau for consideration)

15

**Waste Excavation and Removal Closure Plan Checklist:** (19.15.17.13 NMAC) *Instructions: Each of the following items must be attached to the closure plan. Please indicate, by a check mark in the box, that the documents are attached.*

- ☐ Protocols and Procedures - based upon the appropriate requirements of 19.15.17.13 NMAC
- ☐ Confirmation Sampling Plan (if applicable) - based upon the appropriate requirements of Subsection F of 19.15.17.13 NMAC
- ☐ Disposal Facility Name and Permit Number (for liquids, drilling fluids and drill cuttings)
- ☐ Soil Backfill and Cover Design Specifications - based upon the appropriate requirements of Subsection H of 19.15.17.13 NMAC
- ☐ Re-vegetation Plan - based upon the appropriate requirements of Subsection I of 19.15.17.13 NMAC
- ☐ Site Reclamation Plan - based upon the appropriate requirements of Subsection G of 19.15.17.13 NMAC

**Waste Removal Closure For Closed-loop Systems That Utilize Above Ground Steel Tanks or Haul-off Bins Only:** (19 15 17 13 D NMAC)

*Instructions: Please identify the facility or facilities for the disposal of liquids, drilling fluids and drill cuttings. Use attachment if more than two facilities are required.*

Disposal Facility Name \_\_\_\_\_ Disposal Facility Permit #. \_\_\_\_\_

Disposal Facility Name \_\_\_\_\_ Disposal Facility Permit #. \_\_\_\_\_

Will any of the proposed closed-loop system operations and associated activities occur on or in areas that *will not* be used for future service and

☐ Yes (If yes, please provide the information) ☐ No

*Required for impacted areas which will not be used for future service and operations.*

☐ Soil Backfill and Cover Design Specification - based upon the appropriate requirements of Subsection H of 19 15 17 13 NMAC

☐ Re-vegetation Plan - based upon the appropriate requirements of Subsection I of 19 15 17 13 NMAC

☐ Site Reclamation Plan - based upon the appropriate requirements of Subsection G of 19 15 17 13 NMAC

**Siting Criteria (Regarding on-site closure methods only:** 19 15 17 10 NMAC

*Instructions: Each siting criteria requires a demonstration of compliance in the closure plan. Recommendations of acceptable source material are provided below. Requests regarding changes to certain siting criteria may require administrative approval from the appropriate district office or may be considered an exception which must be submitted to the Santa Fe Environmental Bureau office for consideration of approval. Justifications and/or demonstrations of equivalency are required. Please refer to 19 15 17 10 NMAC for guidance.*

Ground water is less than 50 feet below the bottom of the buried waste

- NM Office of the State Engineer - iWATERS database search, USGS, Data obtained from nearby wells

☐ Yes ☐ No

☐ N/A

Ground water is between 50 and 100 feet below the bottom of the buried waste

- NM Office of the State Engineer - iWATERS database search, USGS, Data obtained from nearby wells

☐ Yes ☐ No

☐ N/A

Ground water is more than 100 feet below the bottom of the buried waste

- NM Office of the State Engineer - iWATERS database search, USGS, Data obtained from nearby wells

☐ Yes ☐ No

☐ N/A

Within 300 feet of a continuously flowing watercourse, or 200 feet of any other significant watercourse or lakebed, sinkhole, or playa lake (measured from the ordinary high-water mark).

- Topographic map, Visual inspection (certification) of the proposed site

☐ Yes ☐ No

Within 300 feet from a permanent residence, school, hospital, institution, or church in existence at the time of initial application

- Visual inspection (certification) of the proposed site, Aerial photo, satellite image

☐ Yes ☐ No

☐ Yes ☐ No

Within 500 horizontal feet of a private, domestic fresh water well or spring that less than five households use for domestic or stock watering purposes, or within 1000 horizontal feet of any other fresh water well or spring, in existence at the time of the initial application

- NM Office of the State Engineer - iWATERS database; Visual inspection (certification) of the proposed site

☐ Yes ☐ No

Within incorporated municipal boundaries or within a defined municipal fresh water well field covered under a municipal ordinance adopted pursuant to NMSA 1978, Section 3-27-3, as amended.

- Written confirmation or verification from the municipality, Written approval obtained from the municipality

☐ Yes ☐ No

Within 500 feet of a wetland

- US Fish and Wildlife Wetland Identification map, Topographic map, Visual inspection (certification) of the proposed site

☐ Yes ☐ No

Within the area overlying a subsurface mine.

- Written confirmation or verification or map from the NM EMNRD-Mining and Mineral Division

☐ Yes ☐ No

Within an unstable area

- Engineering measures incorporated into the design; NM Bureau of Geology & Mineral Resources; USGS; NM Geological Society,

☐ Yes ☐ No

Topographic map

Within a 100-year floodplain

- FEMA map

☐ Yes ☐ No

**On-Site Closure Plan Checklist:** (19.15 17 13 NMAC) *Instructions: Each of the following items must be attached to the closure plan. Please indicate, by a check mark in the box, that the documents are attached.*

☐ Siting Criteria Compliance Demonstrations - based upon the appropriate requirements of 19 15 17.10 NMAC

☐ Proof of Surface Owner Notice - based upon the appropriate requirements of Subsection F of 19 15 17 13 NMAC

☐ Construction/Design Plan of Burial Trench (if applicable) based upon the appropriate requirements of 19 15 17 11 NMAC

☐ Construction/Design Plan of Temporary Pit (for in place burial of a drying pad) - based upon the appropriate requirements of 19 15 17 11 NMAC

☐ Protocols and Procedures - based upon the appropriate requirements of 19 15 17 13 NMAC

☐ Confirmation Sampling Plan (if applicable) - based upon the appropriate requirements of Subsection F of 19 15 17 13 NMAC

☐ Waste Material Sampling Plan - based upon the appropriate requirements of Subsection F of 19 15.17 13 NMAC

☐ Disposal Facility Name and Permit Number (for liquids, drilling fluids and drill cuttings or in case on-site closure standards cannot be achieved)

☐ Soil Cover Design - based upon the appropriate requirements of Subsection H of 19 15 17 13 NMAC

☐ Re-vegetation Plan - based upon the appropriate requirements of Subsection I of 19 15.17 13 NMAC

☐ Site Reclamation Plan - based upon the appropriate requirements of Subsection G of 19.15 17 13 NMAC

19  
**Operator Application Certification:**  
 I hereby certify that the information submitted with this application is true, accurate and complete to the best of my knowledge and belief

Name (Print) \_\_\_\_\_ Title \_\_\_\_\_  
 Signature \_\_\_\_\_ Date \_\_\_\_\_  
 e-mail address \_\_\_\_\_ Telephone \_\_\_\_\_

20  
**OCD Approval:** ☐ Permit Application (including closure plan) ☒ Closure Plan (only) ☐ OCD Conditions (see attachment)  
**OCD Representative Signature:** Jonah P. Kelly **Approval Date:** 6/25/2012  
**Title:** Compliance Officer **OCD Permit Number:** \_\_\_\_\_

21  
**Closure Report (required within 60 days of closure completion):** Subsection K of 19 15 17 13 NMAC  
*Instructions: Operators are required to obtain an approved closure plan prior to implementing any closure activities and submitting the closure report. The closure report is required to be submitted to the division within 60 days of the completion of the closure activities. Please do not complete this section of the form until an approved closure plan has been obtained and the closure activities have been completed*

☒ **Closure Completion Date:** April 27, 2009

22  
**Closure Method:**  
☐ Waste Excavation and Removal ☒ On-site Closure Method ☐ Alternative Closure Method ☐ Waste Removal (Closed-loop systems only)  
☐ If different from approved plan, please explain \_\_\_\_\_

23  
**Closure Report Regarding Waste Removal Closure For Closed-loop Systems That Utilize Above Ground Steel Tanks or Haul-off Bins Only:**  
*Instructions: Please identify the facility or facilities for where the liquids, drilling fluids and drill cuttings were disposed. Use attachment if more than two facilities were utilized.*

Disposal Facility Name \_\_\_\_\_ Disposal Facility Permit Number \_\_\_\_\_  
 Disposal Facility Name \_\_\_\_\_ Disposal Facility Permit Number \_\_\_\_\_

Were the closed-loop system operations and associated activities performed on or in areas that *will not* be used for future service and operations?  
☐ Yes (If yes, please demonstrate compliance to the items below) ☐ No

*Required for impacted areas which will not be used for future service and operations*  
☐ Site Reclamation (Photo Documentation)  
☐ Soil Backfilling and Cover Installation  
☐ Re-vegetation Application Rates and Seeding Technique

24  
**Closure Report Attachment Checklist:** *Instructions: Each of the following items must be attached to the closure report. Please indicate, by a check mark in the box, that the documents are attached.*

☒ Proof of Closure Notice (surface owner and division)  
☒ Proof of Deed Notice (required for on-site closure)  
☒ Plot Plan (for on-site closures and temporary pits)  
☒ Confirmation Sampling Analytical Results (if applicable)  
☐ Waste Material Sampling Analytical Results (if applicable)  
☒ Disposal Facility Name and Permit Number  
☒ Soil Backfilling and Cover Installation  
☒ Re-vegetation Application Rates and Seeding Technique  
☒ Site Reclamation (Photo Documentation)

On-site Closure Location Latitude 36.589875 °N Longitude 107.231623 °W NAD ☐ 1927 ☒ 1983

25  
**Operator Closure Certification:**  
 I hereby certify that the information and attachments submitted with this closure report is true, accurate and complete to the best of my knowledge and belief. I also certify that the closure complies with all applicable closure requirements and conditions specified in the approved closure plan.

Name (Print) Marie E. Jaramillo Title Staff Regulatory Tech  
 Signature [Signature] Date 2/10/10  
 e-mail address marie.e.jaramillo@conocophillips.com Telephone 505-326-9865

**Burlington Resources Oil Gas Company, LP**  
**San Juan Basin**  
**Closure Report**

**Lease Name: SAN JUAN 27-4 UNIT 140B**

**API No.: 30-039-30487**

In accordance with Rule 19.15.17.13 NMAC the following information describes the closure of the temporary pit referenced above. All proper documentation regarding closure activities is being included with the C-144. The temporary pit for this location was constructed and location drilled before June 16, 2008 (effective date for Rule 19.15.17). While closure of the temporary pit did fall within the rule some dates for submittals are after the rig release date.

- Details on Capping and Covering, where applicable. **(See report)**
- Plot Plan (Pit Diagram) **(Included as an attachment)**
- Inspection Reports **(Included as an attachment)**
- Sampling Results **(Included as an attachment)**
- C-105 **(Included as an attachment)**
- Copy of Deed Notice will be filed with County Clerk **(Not required on Federal, State, or Tribal land as stated by FAQ dated October 30, 2008)**

**General Plan:**

1. All free standing liquids will be removed at the start of the pit closure process from the pit and disposed of in a division-approved facility or recycle, reuse or reclaim the liquids in a manner that the appropriate division district office approves.

**All recovered liquids were disposed of at Basin Disposal (Permit #NM-01-005) and any sludge or soil required to be removed to facilitate closure was hauled to Envirotech Land Farm (Permit #NM-01-011) and JFJ Landfarm % IEI (Permit #NM-01-0010B).**

2. The preferred method of closure for all temporary pits will be on-site burial, assuming that all the criteria listed in sub-section (B) of 19.15.17.13 are met.

**The pit was closed using onsite burial.**

3. The surface owner shall be notified of BR's closing of the temporary pit as per the approved closure plan using certified mail, return receipt requested.

**The closure process notification to the landowner was sent via email. (See Attached)(Well located on Federal Land, certified mail is not required for Federal Land per BLM/OCD MOU.)**

4. Within 6 months of the Rig Off status occurring BR will ensure that temporary pits are closed, re-contoured, and reseeded.

**Provision 4 of the closure plan requirements were not met due to rig move off date as noted on C-105 which was prior to pit rule change. Burlington will ensure compliance with this rule in the future.**

5. Notice of Closure will be given to the Aztec Division office between 72 hours and one week of closure via email, or verbally. The notification of closure will include the following:
  - i. Operator's name
  - ii. Location by Unit Letter, Section, Township, and Range. Well name and API number.

**Notification is attached.**

6. Liner of temporary pit shall be removed above "mud level" after stabilization. Removal of liner will consist of manually or mechanically cutting liner at mud level and removing all remaining liner. Care will be taken to remove "All" of the liner i.e., edges of liner entrenched or buried. All excessive liner will be disposed of at a licensed disposal facility.

**Liner of temporary pit was removed above "mud level" after stabilization. Removal of the liner consisted of manually cutting liner at mud level and removing all remaining liner. Care was taken to remove "ALL" of the liner i.e., edges of liner entrenched or buried. All excessive liner was disposed of at a licensed disposal facility, (San Juan County Landfill).**

7. Pit contents shall be mixed with non-waste containing, earthen material in order to achieve the solidification process. The solidification process will be accomplished using a combination of natural drying and mechanically mixing. Pit contents will be mixed with non-waste, earthen material to a consistency that is deemed a safe and stable. The mixing ratio shall not exceed 3 parts clean soil to 1 part pit contents.

**Burlington mixed the Pit contents with non-waste containing, earthen material in order to achieve the solidification process. The solidification process was accomplished by using a combination of natural drying and mechanically mixing. Pit contents were mixed with non-waste, earthen material to a consistency that is deemed as safe and stable. The mixing ratio consisted of approximately 3 parts clean soil to 1 part pit contents.**

8. A five point composite sample will be taken of the pit using sampling tools and all samples tested per Subsection B of 19.15.17.13(B)(1)(b). In the event that the criteria are not met, all contents will be handled per Subparagraph (a) of Paragraph (1) of Subsection B of 19.15.17.13 i.e., Dig and haul.

**A five point composite sample was taken of the pit using sampling tools and all samples tested per Subsection B of 19.15.17.13(B)(1)(b). (Sample results attached).**

Components	Tests Method	Limit (mg/Kg)	Results
Benzene	EPA SW-846 8021B or 8260B	0.2	1.3 ug/kg
BTEX	EPA SW-846 8021B or 8260B	50	52.1 ug/kG
TPH	EPA SW-846 418.1	2500	66.4mg/kg
GRO/DRO	EPA SW-846 8015M	500	9.4 mg/Kg
Chlorides	EPA 300.1	1000/500	181 mg/L

9. Upon completion of solidification and testing standards being passed, the pit area will be backfilled with compacted, non-waste containing, earthen material. A minimum of four feet of cover shall be achieved and the cover shall include one foot of suitable material to establish vegetation at the site, or the background thickness of topsoil, whichever is greater. If standard testing fails BR will dig and haul all contents pursuant to 19.15.17.13.i.a. After doing such, confirmation sampling will be conducted to ensure a release has not occurred.

**The pit material passed solidification and testing standards. The pit area was then backfilled with compacted, non-waste containing, earthen material. More than four feet of cover was achieved and the cover included one foot of suitable material to establish vegetation at the site.**

10. During the stabilization process if the liner is ripped by equipment the Aztec OCD office will be notified within 48 hours and the liner will be repaired if possible. If the liner can not be repaired then all contents will be excavated and removed.

**The integrity of the liner was not damaged in the pit closure process.**

11. Dig and Haul Material will be transported to the Envirotech Land Farm located 16 miles south of Bloomfield on Angel Peak Road, CR 7175. Permit # NM010011

**Dig and Haul was not required.**

12. Re-contouring of location will match fit, shape, line, form and texture of the surrounding. Re-shaping will include drainage control, prevent ponding, and prevent erosion. Natural drainages will be unimpeded and water bars and/or silt traps will be placed in areas where needed to prevent erosion on a large scale. Final re-contour shall have a uniform appearance with smooth surface, fitting the natural landscape.

**The pit area was re-contoured to match fit, shape, line, form and texture of the surrounding area. Re-shaping included drainage control, to prevent ponding and erosion. Natural drainages were unimpeded and water bars and/or silt traps were placed in areas where needed to prevent erosion on a large scale. Final re-contour has a uniform appearance with smooth surface, fitting the natural landscape.**

13. Notification will be sent to OCD when the reclaimed area is seeded.

**Provision 13 was accomplished through complying with Forest seeding requirements as allowed by the BLM/OCD MOU.**

14. BR shall seed the disturbed areas the first growing season after the operator closes the pit. Seeding will be accomplished via drilling on the contour whenever practical or by other division-approved methods. BLM or Forest Service stipulated seed mixes will be used on federal lands. Vegetative cover will equal 70% of the native perennial vegetative cover (un-impacted) consisting of at least three native plant species, including at least one grass, but not including noxious weeds, and maintain that cover through two successive growing seasons. Repeat seeding or planting will be continued until successful vegetative growth occurs.

**Provision 14 was accomplished through complying with Forest seeding requirements as allowed by the BLM/OCD MOU.**

15. The temporary pit will be located with a steel marker, no less than four inches in diameter, cemented in a hole three feet deep in the center of the onsite burial upon the abandonment of all the wells on the pad. The marker will be flush with the ground to allow access of the active well pad and for safety concerns. The marker will include a threaded collar to be used for future abandonment. The top of the marker will contain a welded steel 12" square plate that indicates the onsite burial of the temporary pit. The plate will be easily removable and a four foot tall riser will be threaded into the top of the collar marker and welded around the base with the operator's information at the time of all wells on the pad are abandoned. The operator's information will include the following: Operator Name, Lease Name, Well Name and number, Unit Number, Section, Township, Range and an indicator that the marker is an onsite burial location.

**Provision 15 was accomplished by installing a steel marker in the temporary pit, no less than four inches in diameter, cemented in a hole three feet deep in the center of the onsite burial. The marker is flush with the ground to allow access of the active well pad and for safety concerns. The top of the marker contains a welded steel 12" square plate that indicates the onsite burial of the temporary pit. The plate contains the following: Operator Name, Lease Name, Well Name and number, Unit Number, Section, Township, Range and an indicator that the marker is an onsite burial location.**

**The plate will be easily removable and a four foot tall riser will be threaded into the top of the collar marker and welded around the base with the following operator's information at the time of all wells on the pad are abandoned. The riser will be labeled: BR, BLM, SAN JUAN 27-4 UNIT 140B, UL-H, Sec. 10, T 27N, R 4W, API # 30-039-30487**



## **Tafoya, Crystal**

---

**From:** Tafoya, Crystal  
**Sent:** Thursday, July 10, 2008 8:16 AM  
**To:** 'mark\_kelly@nm.blm.gov'  
**Subject:** OCD Pit Closure Notification

The following temporary pits will be closed on-site. The new OCD Pit Rule 17 requires the surface owner be notified. Please feel free to contact me at any time if you have any questions. Thank you!

Allison Unit 2B  
Allison Unit 40N  
Angel Peak B 27E  
Ballard 11F  
Cain 725S  
Canyon Largo Unit 250N  
Canyon Largo Unit 279E  
Canyon Largo Unit 288E  
Canyon largo Unit 297E  
Canyon Largo Unit 465E  
Carson SRC 4E  
Day B 4P  
Day B 5A  
East 17S  
EPNG A 1B  
EPNG B 1M  
Federal A 1E  
Filar 5M  
Filar 5N  
Fogelson 4 100  
Fogelson 4 100S  
Grambling C 202S  
Hagood 19  
Hamner 9S  
Hardie 4P  
Hare 295  
Heaton Com 100  
Helms Federal 1G  
Howell 12  
Huerfanito Unit 103F  
Huerfanito Unit 29S  
Huerfanito Unit 39S  
Huerfanito Unit 47S  
Huerfanito Unit 50E  
Huerfanito Unit 75E  
Huerfanito Unit 83E  
Huerfanito Unit 87E  
Huerfanito Unit 90E  
Huerfanito Unit 90M  
Huerfanito Unit 98S  
Huerfano Unit 108F  
Huerfano Unit 282E  
Huerfano unit 305  
Huerfano unit 307  
Huerfano Unit 554  
Johnston Federal 24S

King 3  
Lackey A Com 100S  
Lambe 1C  
Lambe 7S  
Lively 8M  
Lloyd A 100  
Lloyd A 100S  
Martin 100  
McCord B 1F  
McDermitt Com 100S  
McManus 13R  
Mitchell 1S  
Morris A 14  
Newberry B 1N  
Newsom B 503  
Newsom B 8N  
Pierce A 210S  
Roelofs 1N  
San Juan 27-4 Unit 132G  
San Juan 27-4 Unit 132M  
San Juan 27-4 Unit 139N  
San Juan 27-4 Unit 140B  
San Juan 27-4 Unit 141M  
San Juan 27-4 Unit 147Y  
San Juan 27-4 Unit 153B  
San Juan 27-4 Unit 22M  
San Juan 27-4 Unit 38P  
San Juan 27-4 Unit 41N  
San Juan 27-4 Unit 42N  
San Juan 27-4 Unit 569N  
San Juan 27-4 Unit 59N  
San Juan 27-4 Unit 60M  
San Juan 27-5 Unit 113F  
San Juan 27-5 Unit 59N  
San Juan 27-5 Unit 84N  
San Juan 27-5 unit 901  
San Juan 27-5 Unit 902  
San Juan 27-5 Unit 903  
San Juan 27-5 Unit 904  
San Juan 27-5 Unit 905  
San Juan 27-5 Unit 906  
San Juan 27-5 Unit 907  
San Juan 27-5 Unit 908  
San Juan 27-5 Unit 909  
San Juan 27-5 Unit 910  
San Juan 27-5 Unit 912  
San Juan 27-5 Unit 913  
San Juan 27-5 Unit 914  
San Juan 27-5 Unit 915  
San Juan 27-5 Unit POW 916  
San Juan 28-4 Unit 27M  
San Juan 28-5 Unit 54F  
San Juan 28-5 Unit 62E  
San Juan 28-5 Unit 63M  
San Juan 28-5 Unit 76N  
San Juan 28-5 Unit 77N  
San Juan 28-6 Unit 113N

District I

1625 N. French Dr., Hobbs, NM 88240

District II

1301 W. Grand Avenue, Artesia, NM 88210

District III

1000 Rio Brazos Rd., Aztec, NM 87410

District IV

1220 S. St. Francis Dr., Santa Fe, NM 87505

State of New Mexico  
Energy, Minerals & Natural Resources Department  
**OIL CONSERVATION DIVISION**  
1220 South St. Francis Dr.  
Santa Fe, NM 87505

Form C-102  
Revised October 12, 2005  
Submit to Appropriate District Office  
State Lease - 4 Copies  
Fee Lease - 3 Copies

☐ AMENDED REPORT**WELL LOCATION AND ACREAGE DEDICATION PLAT**

<sup>1</sup> API Number		<sup>2</sup> Pool Code		<sup>3</sup> Pool Name MESAVERDE					
<sup>4</sup> Property Code		<sup>5</sup> Property Name SAN JUAN 27-4 UNIT						<sup>6</sup> Well Number 140B	
<sup>7</sup> OGRID No.		<sup>8</sup> Operator Name BURLINGTON RESOURCES OIL & GAS COMPANY LP						<sup>9</sup> Elevation 7159	
<sup>10</sup> SURFACE LOCATION									
UL or lot no. H	Section 10	Township 27-N	Range 4-W	Lot Ida	Feet from the 1730	North/South line NORTH	Feet from the 503	East/West line EAST	County RIO ARriba
<sup>11</sup> Bottom Hole Location If Different From Surface									
UL or lot no.	Section	Township	Range	Lot Ida	Feet from the	North/South line	Feet from the	East/West line	County
<sup>12</sup> Dedicated Acres 320	<sup>13</sup> Joint or Infill	<sup>14</sup> Consolidation Code		<sup>15</sup> Order No.					

NO ALLOWABLE WILL BE ASSIGNED TO THIS COMPLETION UNTIL ALL INTERESTS HAVE BEEN  
CONSOLIDATED OR A NON-STANDARD UNIT HAS BEEN APPROVED BY THE DIVISION

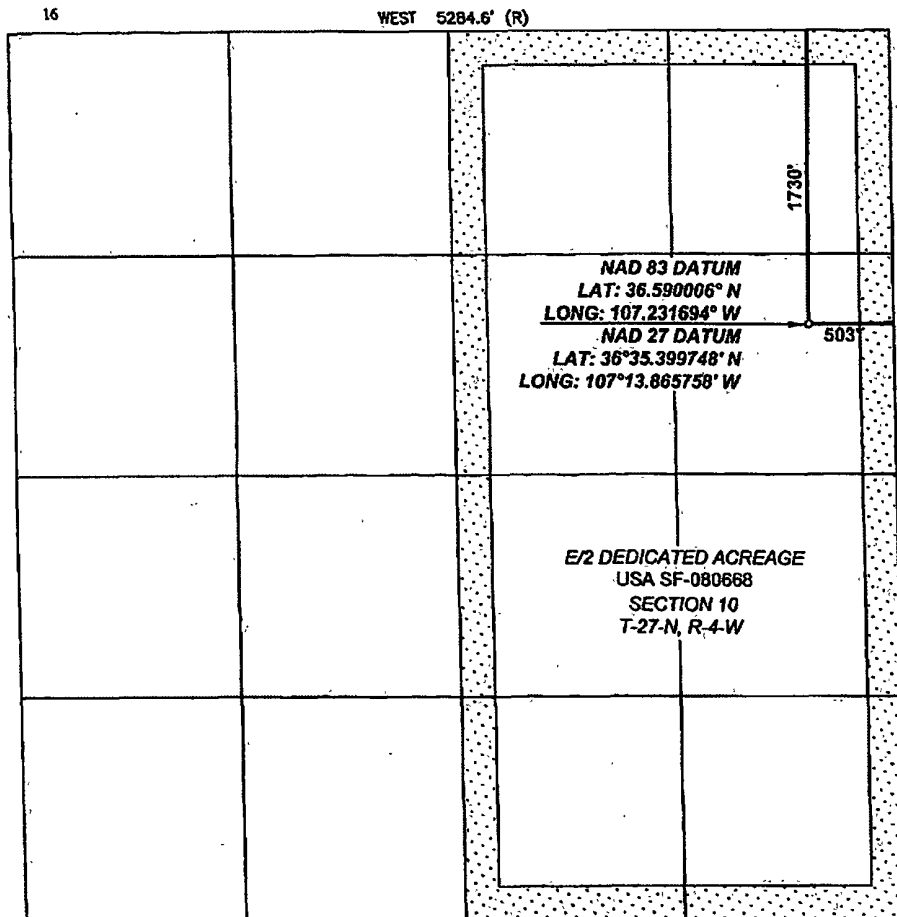
**17 OPERATOR CERTIFICATION**

I hereby certify that the information contained herein is true and complete to the best of my knowledge and belief, and that this organization either owns a working interest or unleased mineral interest in the land including the proposed bottom hole location or has a right to drill this well at this location pursuant to a contract with an owner of such a mineral or working interest, or to a voluntary pooling agreement or a compulsory pooling order heretofore entered by the division.

Signature

Printed Name

Title and E-mail Address

Date

**18 SURVEYOR CERTIFICATION**

I hereby certify that the well location shown on this plat was plotted from field notes of actual surveys made by me or under my supervision, and that the same is true and correct to the best of my belief.

Date of Survey: 4/16/07

Signature and Seal of Professional Surveyor:



Certificate Number: NM 11393

# BURLINGTON RESOURCES OIL & GAS COMPANY LP

SAN JUAN 27-4 UNIT 140B

1730' FNL, 503' FEL

SECTION 10, T-27-N, R-4-W, N.M.P.M.,

RIO ARriba COUNTY, NEW MEXICO

GROUND ELEV.: 7159 NAVD88

DATE: JULY 12, 2007

NEW ACCESS ROAD 1459'

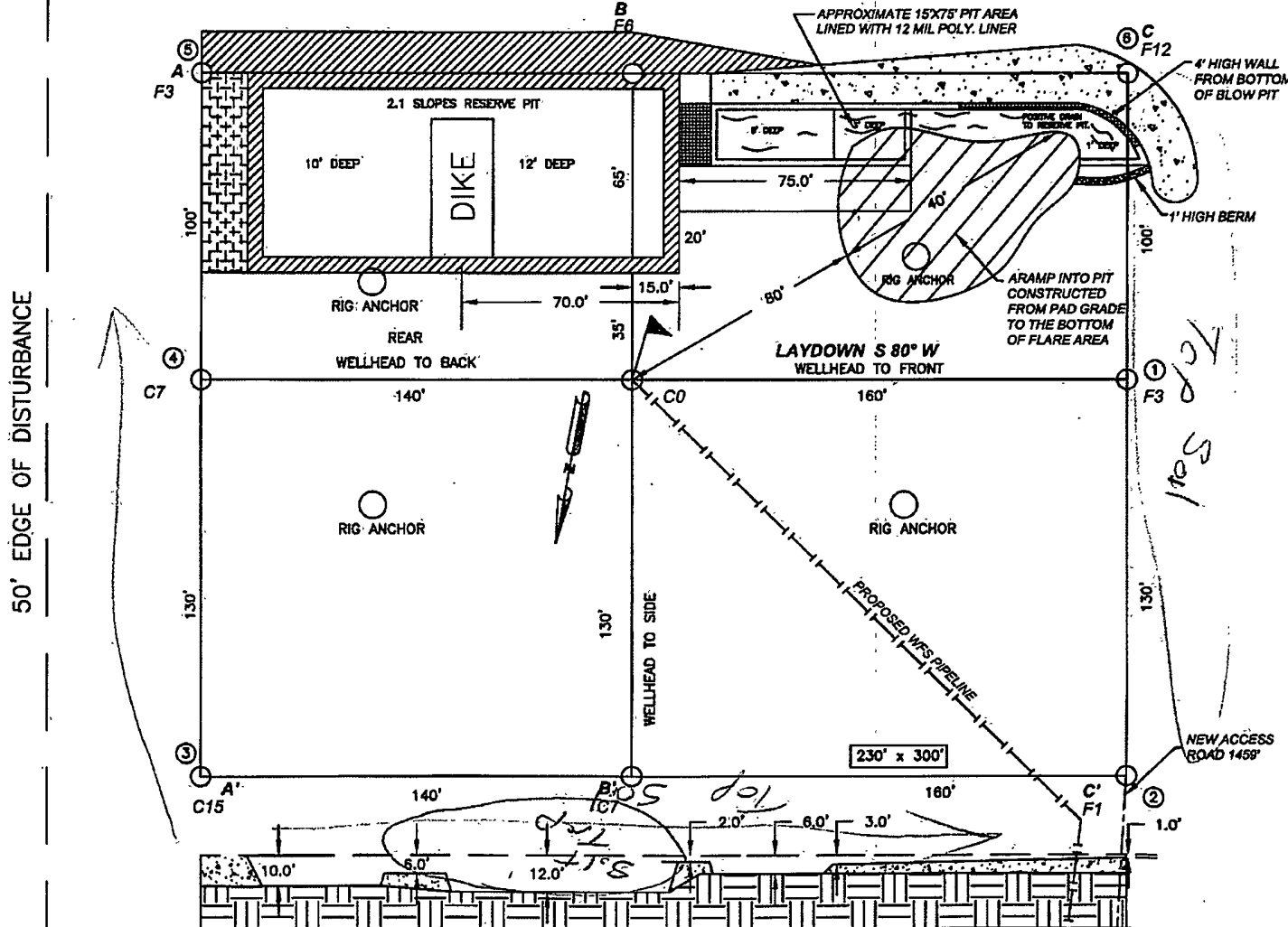

**PIT CROSS SECTION**

NAD 83 LAT.: 36.590006 °N/ LONG.: 107.231694 °W

NOTES:

1. RESERVE PIT DIKE: TO BE 8' ABOVE DEEP SIDE (OVERFLOW-3' WIDE AND 1' ABOVE SHALLOW SIDE).
2. C.C.I. SURVEYS IS NOT LIABLE FOR UNDERGROUND UTILITIES OR PIPELINES. CONTRACTOR SHOULD CALL ONE-CALL FOR LOCATION OF ANY MARKED OR UNMARKED BURIED PIPELINES OR CABLES ON WELL PAD AND OR ACCESS ROAD AT LEAST TWO (2) WORKING DAYS PRIOR TO CONSTRUCTION.

CCI

CHENAUT CONSULTING INC.

P.O. BOX 328  
BLOOMFIELD, NM, 87413  
PHONE: (505)325-7707

330' x 400' = 3.03 ACRES

# ENVIROTECH LABS

PRACTICAL SOLUTIONS FOR A BETTER TOMORROW

## EPA METHOD 8015 Modified Nonhalogenated Volatile Organics Total Petroleum Hydrocarbons

FOREST - comp

Client:	ConocoPhillips	Project #:	96052-0026
Sample ID:	SJ 27-4 #140B	Date Reported:	10-01-08
Laboratory Number:	47393	Date Sampled:	09-19-08
Chain of Custody No:	5358	Date Received:	09-23-08
Sample Matrix:	Soil	Date Extracted:	09-26-08
Preservative:	Cool	Date Analyzed:	09-29-088
Condition:	Intact	Analysis Requested:	8015 TPH

Parameter	Concentration (mg/Kg)	Det. Limit (mg/Kg)
Gasoline Range (C5 - C10)	ND	0.2
Diesel Range (C10 - C28)	9.4	0.1
Total Petroleum Hydrocarbons	9.4	0.2

ND - Parameter not detected at the stated detection limit.

References: Method 8015B, Nonhalogenated Volatile Organics, Test Methods for Evaluating Solid Waste, SW-846, USEPA, December 1996.

Comments: **Drilling Pit Sample.**

Analyst

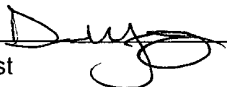

Review

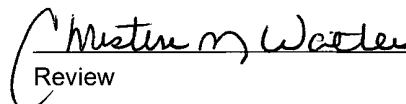

# ENVIROTECH LABS

PRACTICAL SOLUTIONS FOR A BETTER TOMORROW

## EPA METHOD 8015 Modified Nonhalogenated Volatile Organics Total Petroleum Hydrocarbons

Client:	ConocoPhillips	Project #:	96052-0026
Sample ID:	SJ 27-4 #140B Background	Date Reported:	10-01-08
Laboratory Number:	47394	Date Sampled:	09-19-08
Chain of Custody No:	5358	Date Received:	09-23-08
Sample Matrix:	Soil	Date Extracted:	09-26-08
Preservative:	Cool	Date Analyzed:	09-29-08
Condition:	Intact	Analysis Requested:	8015 TPH

Parameter	Concentration (mg/Kg)	Det. Limit (mg/Kg)
Gasoline Range (C5 - C10)	ND	0.2
Diesel Range (C10 - C28)	ND	0.1
Total Petroleum Hydrocarbons	ND	0.2

ND - Parameter not detected at the stated detection limit.

References: Method 8015B, Nonhalogenated Volatile Organics, Test Methods for Evaluating Solid Waste, SW-846, USEPA, December 1996.

Comments: **Drilling Pit Sample.**

Analyst

Review

# ENVIROTECH LABS

PRACTICAL SOLUTIONS FOR A BETTER TOMORROW

## EPA Method 8015 Modified Nonhalogenated Volatile Organics Total Petroleum Hydrocarbons

### Quality Assurance Report

Client:	QA/QC	Project #:	N/A
Sample ID:	09-29-08 QA/QC	Date Reported:	10-01-08
Laboratory Number:	47391	Date Sampled:	N/A
Sample Matrix:	Methylene Chloride	Date Received:	N/A
Preservative:	N/A	Date Analyzed:	09-29-08
Condition:	N/A	Analysis Requested:	TPH

	I-Cal Date	I-Cal RF:	C-Cal RF:	% Difference	Accept Range
Gasoline Range C5 - C10	05-07-07	9.9457E+002	9.9497E+002	0.04%	0 - 15%
Diesel Range C10 - C28	05-07-07	1.0017E+003	1.0021E+003	0.04%	0 - 15%

Blank Conc. (mg/L - mg/Kg)	Concentration	Detection Limit
Gasoline Range C5 - C10	ND	0.2
Diesel Range C10 - C28	ND	0.1
Total Petroleum Hydrocarbons	ND	0.2

Duplicate Conc. (mg/Kg)	Sample	Duplicate	% Difference	Accept. Range
Gasoline Range C5 - C10	ND	ND	0.0%	0 - 30%
Diesel Range C10 - C28	48.5	48.2	0.6%	0 - 30%

Spike Conc. (mg/Kg)	Sample	Spike Added	Spike Result	% Recovery	Accept. Range
Gasoline Range C5 - C10	ND	250	243	97.2%	75 - 125%
Diesel Range C10 - C28	48.5	250	294	98.3%	75 - 125%

ND - Parameter not detected at the stated detection limit.

References: Method 8015B, Nonhalogenated Volatile Organics, Test Methods for Evaluating Solid Waste, SW-846, USEPA, December 1996.

Comments: QA/QC for Samples 47391 - 47396 and 47424 - 47427.

Analyst

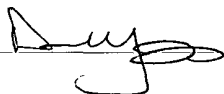

Review

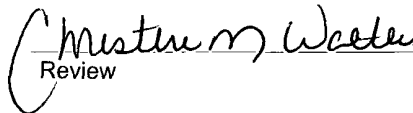

EPA METHOD 8021  
AROMATIC VOLATILE ORGANICS

Client:	ConocoPhillips	Project #:	96052-0026
Sample ID:	SJ 27-4 #140B	Date Reported:	10-01-08
Laboratory Number:	47393	Date Sampled:	09-19-08
Chain of Custody:	5358	Date Received:	09-23-08
Sample Matrix:	Soil	Date Analyzed:	09-29-08
Preservative:	Cool	Date Extracted:	09-26-08
Condition:	Intact	Analysis Requested:	BTEX

Parameter	Concentration (ug/Kg)	Det. Limit (ug/Kg)
Benzene	1.3	0.9
Toluene	14.7	1.0
Ethylbenzene	2.6	1.0
p,m-Xylene	26.1	1.2
o-Xylene	7.4	0.9
Total BTEX	52.1	

ND - Parameter not detected at the stated detection limit.

Surrogate Recoveries:	Parameter	Percent Recovery
	Fluorobenzene	96.0 %
	1,4-difluorobenzene	96.0 %
	Bromochlorobenzene	96.0 %

References: Method 5030B, Purge-and-Trap, Test Methods for Evaluating Solid Waste, SW-846, USEPA, December 1996.

Method 8021B, Aromatic Volatile Organics, Test Methods for Evaluating Solid Waste, SW-846, USEPA, December 1996.

Comments: Drilling Pit Sample.

Analyst

Review



EPA METHOD 8021  
AROMATIC VOLATILE ORGANICS

Client:	ConocoPhillips	Project #:	96052-0026
Sample ID:	SJ 27-4 #140B Background	Date Reported:	10-01-08
Laboratory Number:	47394	Date Sampled:	09-19-08
Chain of Custody:	5358	Date Received:	09-23-08
Sample Matrix:	Soil	Date Analyzed:	09-29-08
Preservative:	Cool	Date Extracted:	09-26-08
Condition:	Intact	Analysis Requested:	BTEX

Parameter	Concentration (ug/Kg)	Det. Limit (ug/Kg)
Benzene	1.0	0.9
Toluene	6.2	1.0
Ethylbenzene	1.1	1.0
p,m-Xylene	3.8	1.2
o-Xylene	1.5	0.9
Total BTEX	13.6	

ND - Parameter not detected at the stated detection limit.

Surrogate Recoveries:	Parameter	Percent Recovery
	Fluorobenzene	99.0 %
	1,4-difluorobenzene	99.0 %
	Bromochlorobenzene	99.0 %

References: Method 5030B, Purge-and-Trap, Test Methods for Evaluating Solid Waste, SW-846, USEPA, December 1996.

Method 8021B, Aromatic Volatile Organics, Test Methods for Evaluating Solid Waste, SW-846, USEPA, December 1996.

Comments: Drilling Pit Sample.

Analyst



Review

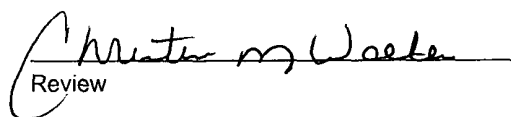

# ENVIROTECH LABS

PRACTICAL SOLUTIONS FOR A BETTER TOMORROW

## EPA METHOD 8021 AROMATIC VOLATILE ORGANICS

Client:	N/A	Project #:	N/A
Sample ID:	09-29-BT QA/QC	Date Reported:	10-01-08
Laboratory Number:	47391	Date Sampled:	N/A
Sample Matrix:	Soil	Date Received:	N/A
Preservative:	N/A	Date Analyzed:	09-29-08
Condition:	N/A	Analysis:	BTEX

Calibration and Detection Limits (ug/L)	I-Cal RF:	C-Cal RF:	%Diff.	Blank Conc	Detect. Limit
		Accept. Range 0 - 15%			
Benzene	5.2180E+007	5.2285E+007	0.2%	ND	0.1
Toluene	3.8577E+007	3.8654E+007	0.2%	ND	0.1
Ethylbenzene	3.1075E+007	3.1137E+007	0.2%	ND	0.1
p,m-Xylene	6.4899E+007	6.5029E+007	0.2%	ND	0.1
o-Xylene	2.9818E+007	2.9878E+007	0.2%	ND	0.1

Duplicate Conc. (ug/Kg)	Sample	Duplicate	%Diff.	Accept Range	Detect. Limit
Benzene	5.8	6.0	3.4%	0 - 30%	0.9
Toluene	22.4	22.3	0.4%	0 - 30%	1.0
Ethylbenzene	5.1	5.2	2.0%	0 - 30%	1.0
p,m-Xylene	25.5	25.8	1.2%	0 - 30%	1.2
o-Xylene	7.2	7.3	1.4%	0 - 30%	0.9

Spike Conc. (ug/Kg)	Sample	Amount Spiked	Spiked Sample	% Recovery	Accept Range
Benzene	5.8	50.0	56.8	102%	39 - 150
Toluene	22.4	50.0	66.4	91.7%	46 - 148
Ethylbenzene	5.1	50.0	52.1	94.6%	32 - 160
p,m-Xylene	25.5	100	122	97.5%	46 - 148
o-Xylene	7.2	50.0	55.2	96.5%	46 - 148

ND - Parameter not detected at the stated detection limit.

References: Method 5030B, Purge-and-Trap, Test Methods for Evaluating Solid Waste, SW-846, USEPA, December 1996  
Method 8021B, Aromatic and Halogenated Volatiles by Gas Chromatography Using Photoionization and/or Electrolytic Conductivity Detectors, SW-846, USEPA December 1996.

Comments: QA/QC for Samples 47391 - 47396, 47424, 47427, 47465 and 47479.

Analyst

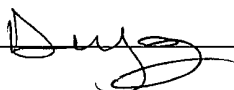

Review

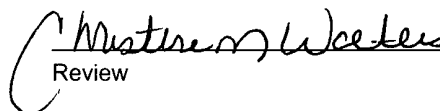

# ENVIROTECH LABS

PRACTICAL SOLUTIONS FOR A BETTER TOMORROW

Chloride

Client:	ConocoPhillips	Project #:	96052-0026
Sample ID:	SJ 27-4 #140B	Date Reported:	10-02-08
Lab ID#:	47393	Date Sampled:	09-19-08
Sample Matrix:	Soil	Date Received:	09-23-08
Preservative:	Cool	Date Analyzed:	09-29-08
Condition:	Intact	Chain of Custody:	5368

Parameter	Concentration (mg/Kg)
-----------	-----------------------

Total Chloride

181

Reference: U.S.E.P.A., 4500B, "Methods for Chemical Analysis of Water and Wastes", 1983.  
Standard Methods For The Examination of Water And Waste Water", 18th ed., 1992.

Comments: Drilling Pit Sample.

Analyst



Review

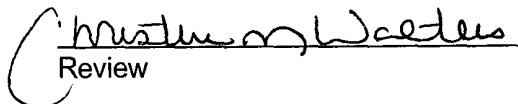

# ENVIROTECH LABS

PRACTICAL SOLUTIONS FOR A BETTER TOMORROW

## Chloride

Client:	ConocoPhillips	Project #:	96052-0026
Sample ID:	SJ 27-4 #140B Background	Date Reported:	10-02-08
Lab ID#:	47394	Date Sampled:	09-19-08
Sample Matrix:	Soil	Date Received:	09-23-08
Preservative:	Cool	Date Analyzed:	09-29-08
Condition:	Intact	Chain of Custody:	5358

Parameter	Concentration (mg/Kg)
-----------	-----------------------

Total Chloride

28.0

Reference: U.S.E.P.A., 4500B, "Methods for Chemical Analysis of Water and Wastes", 1983.  
Standard Methods For The Examination of Water And Waste Water", 18th ed., 1992.

Comments: **Drilling Pit Sample.**

Analyst



Review

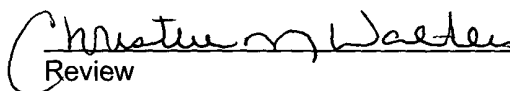

Client:	ConocoPhillips	Project #:	96052-0026
Sample ID:	SJ 27-4 #140B	Date Reported:	10-02-08
Laboratory Number:	47393	Date Sampled:	09-19-08
Chain of Custody No:	5358	Date Received:	09-23-08
Sample Matrix:	Soil	Date Extracted:	09-26-08
Preservative:	Cool	Date Analyzed:	09-26-08
Condition:	Intact	Analysis Needed:	TPH-418.1

Parameter	Concentration (mg/kg)	Det. Limit (mg/kg)
Total Petroleum Hydrocarbons	66.4	5.0

ND = Parameter not detected at the stated detection limit.

References: Method 418.1, Petroleum Hydrocarbons, Total Recoverable, Chemical Analysis of Water and Waste, USEPA Storet No. 4551, 1978.

Comments: **Drilling Pit Sample.**

Analyst

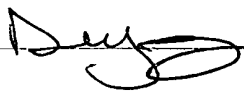

Review

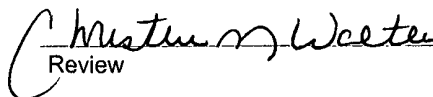

Client:	ConocoPhillips	Project #:	96052-0026
Sample ID:	SJ 27-4 #140B Background	Date Reported:	10-02-08
Laboratory Number:	47394	Date Sampled:	09-19-08
Chain of Custody No:	5358	Date Received:	09-23-08
Sample Matrix:	Soil	Date Extracted:	09-26-08
Preservative:	Cool	Date Analyzed:	09-26-08
Condition:	Intact	Analysis Needed:	TPH-418.1

Parameter	Concentration (mg/kg)	Det. Limit (mg/kg)
Total Petroleum Hydrocarbons	32.6	5.0

ND = Parameter not detected at the stated detection limit.

References: Method 418.1, Petroleum Hydrocarbons, Total Recoverable, Chemical Analysis of Water and Waste, USEPA Storet No. 4551, 1978.

Comments: Drilling Pit Sample.

Analyst

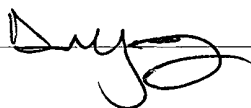

Review

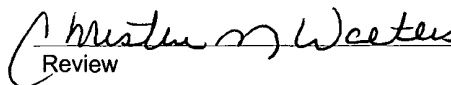

EPA METHOD 418.1  
TOTAL PETROLEUM  
HYDROCARBONS  
QUALITY ASSURANCE REPORT

Client:	QA/QC	Project #:	N/A
Sample ID:	QA/QC	Date Reported:	09-30-08
Laboratory Number:	09-26-TPH.QA/QC 47366	Date Sampled:	N/A
Sample Matrix:	Freon-113	Date Analyzed:	09-26-08
Preservative:	N/A	Date Extracted:	09-26-08
Condition:	N/A	Analysis Needed:	TPH

Calibration	I-Cal Date	C-Cal Date	I-Cal RF	C-Cal RF	% Difference	Accept. Range
	09-18-08	09-26-08	1,660	1,540	7.2%	+/- 10%

Blank Conc. (mg/Kg)	Concentration	Detection Limit
TPH	ND	14.6

Duplicate Conc. (mg/Kg)	Sample	Duplicate	% Difference	Accept. Range
TPH	19.9	15.9	20.1%	+/- 30%

Spike Conc. (mg/Kg)	Sample	Spike Added	Spike Result	% Recovery	Accept Range
TPH	19.9	2,000	2,190	108%	80 - 120%

ND = Parameter not detected at the stated detection limit.

References: Method 418.1, Petroleum Hydrocarbons, Total Recoverable, Chemical Analysis of Water and Waste, USEPA Storet No. 4551, 1978.

Comments: QA/QC for Samples 47366, 47388 - 47389 and 47391 - 47396.

Analyst

Review

Submit To Appropriate District Office Two Copies District I 1625 N French Dr , Hobbs, NM 88240 District II 1301 W Grand Avenue, Artesia, NM 88210 District III 1000 Rio Brazos Rd , Aztec, NM 87410 District IV 1220 S St Francis Dr , Santa Fe, NM 87505	<b>State of New Mexico</b> <b>Energy, Minerals and Natural Resources</b>  <b>Oil Conservation Division</b> <b>1220 South St. Francis Dr.</b> <b>Santa Fe, NM.87505</b>	<div style="text-align: right;"><b>Form C-105</b> July 17, 2008</div> 1. WELL API NO. <b>30-039-30487</b> 2. Type of Lease <input type="checkbox"/> STATE <input type="checkbox"/> FEE <input checked="" type="checkbox"/> FED/INDIAN 3. State Oil & Gas Lease No <b>SF-080668</b>
--	---	---

### WELL COMPLETION OR RECOMPLETION REPORT AND LOG

4 Reason for filing  <input type="checkbox"/> <b>COMPLETION REPORT</b> (Fill in boxes #1 through #31 for State and Fee wells only)  <input checked="" type="checkbox"/> <b>C-144 CLOSURE ATTACHMENT</b> (Fill in boxes #1 through #9, #15 Date Rig Released and #32 and/or #33; attach this and the plat to the C-144 closure report in accordance with 19 15.17.13 K NMAC)	5 Lease Name or Unit Agreement Name <b>SAN JUAN 27-4 UNIT</b> 6. Well Number. <b>140B</b>
---	--

7. Type of Completion <input checked="" type="checkbox"/> NEW WELL <input type="checkbox"/> WORKOVER <input type="checkbox"/> DEEPENING <input type="checkbox"/> PLUGBACK <input type="checkbox"/> DIFFERENT RESERVOIR <input type="checkbox"/> OTHER	
--	--

8. Name of Operator <b>Burlington Resources Oil Gas Company, LP</b>	9. OGRID 14538
10. Address of Operator PO Box 4298, Farmington, NM 87499	11 Pool name or Wildcat

12. Location	Unit Ltr	Section	Township	Range	Lot	Feet from the	N/S Line	Feet from the	E/W Line	County
<b>Surface:</b>										
<b>BH:</b>										

13. Date Spudded	14. Date T D. Reached	15. Date Rig Released <b>06/06/08</b>	16. Date Completed (Ready to Produce)	17. Elevations (DF and RKB, RT, GR, etc.)
18. Total Measured Depth of Well		19. Plug Back Measured Depth	20 Was Directional Survey Made?	21. Type Electric and Other Logs Run

22. Producing Interval(s), of this completion - Top, Bottom, Name	
---	--

### CASING RECORD (Report all strings set in well)

CASING SIZE	WEIGHT LB /FT.	DEPTH SET	HOLE SIZE	CEMENTING RECORD	AMOUNT PULLED

24. LINER RECORD				25. TUBING RECORD			
SIZE	TOP	BOTTOM	SACKS CEMENT	SCREEN	SIZE	DEPTH SET	PACKER SET

26. Perforation record (interval, size, and number)	27. ACID, SHOT, FRACTURE, CEMENT, SQUEEZE, ETC. <table border="1" style="width:100%; border-collapse: collapse;"> <tr> <th style="width:50%;">DEPTH INTERVAL</th> <th style="width:50%;">AMOUNT AND KIND MATERIAL USED</th> </tr> <tr><td> </td><td> </td></tr> <tr><td> </td><td> </td></tr> <tr><td> </td><td> </td></tr> </table>	DEPTH INTERVAL	AMOUNT AND KIND MATERIAL USED						
DEPTH INTERVAL	AMOUNT AND KIND MATERIAL USED								

### PRODUCTION

28. Date First Production	Production Method ( <i>Flowing, gas lift, pumping - Size and type pump</i> )	Well Status ( <i>Prod. or Shut-in</i> )					
Date of Test	Hours Tested	Choke Size	Prod'n For Test Period	Oil - Bbl	Gas - MCF	Water - Bbl	Gas - Oil Ratio
Flow Tubing Press	Casing Pressure	Calculated 24-Hour Rate	Oil - Bbl.	Gas - MCF	Water - Bbl	Oil Gravity - API - ( <i>Corr</i> )	

29. Disposition of Gas ( <i>Sold, used for fuel, vented, etc.</i> )	30. Test Witnessed By
---	-----------------------

31. List Attachments
----------------------

32 If a temporary pit was used at the well, attach a plat with the location of the temporary pit
--

33 If an on-site burial was used at the well, report the exact location of the on-site burial:
--

Latitude **36.589875°N** Longitude **107.231623°W** NAD ☐ 1927 ☒ 1983

*I hereby certify that the information shown on both sides of this form is true and complete to the best of my knowledge and belief*

Signature Printed Name Marie E. Jaramillo Title: Staff Regulatory Tech Date: 2/10/2010

E-mail Address [marie.e.jaramillo@conocophillips.com](mailto:marie.e.jaramillo@conocophillips.com)





**Pit Closure Form:**

Date: 4/27/09

Well Name: S.J. 27-4<sup>#</sup> 140B

Footages: \_\_\_\_\_ Unit Letter: H

Section: 10, T-27-N, R-4-W, County: Rio Arriba State: N.M.

Contractor Closing Pit: \_\_\_\_\_

Construction Inspector: Eric Smith Date: 4/27/09

Inspector Signature: [Signature]

**Jaramillo, Marie E**

---

**From:** Silverman, Jason M <Jason.M.Silverman@conocophillips.com>  
**Sent:** Thursday, April 16, 2009 2:41 PM  
**To:** 'jreidinger@fs.fed.us' <jreidinger@fs.fed.us>; Brandon.Powell@state.nm.us <Brandon.Powell@state.nm.us>; Mark Kelly <Mark\_Kelly@blm.gov>; Robert Switzer <Robert\_Switzer@blm.gov>; Sherrie Landon <Sherrie\_Landon@blm.gov>  
**Cc:** 'Paul & Son' <paulandson@gobrainstorm.net>; Becker, Joey W <Joe.W.Becker@conocophillips.com>; Bonilla, Amanda <Amanda.Bonilla@conocophillips.com>; Bowker, Terry D <Terry.D.Bowker@conocophillips.com>; Busse, Dollie L <Dollie.L.Busse@conocophillips.com>; Chavez, Virgil E <Virgil.E.Chavez@conocophillips.com>; Gordon Chenault <gordon@ccinm.com>; GRP:SJBU Production Leads <SJBUProductionLeads@conocophillips.com>; KENDAL BASSING <Kendal.R.Bassing@conocophillips.com>; Kennedy, Jim R <JIM.R.Kennedy@conocophillips.com>; Larry Thacker <lthackerccinm@hotmail.com>; Lopez, Richard A <Richard.A.Lopez@conocophillips.com>; Loudermilk, Jerry L <Jerry.L.Loudermilk@conocophillips.com>; Nelson, Terry J <Terry.J.Nelson@conocophillips.com>; O'Nan, Mike J. <Mike.J.O'Nan@conocophillips.com>; Peace, James T <James.T.Peace@conocophillips.com>; Poulson, Mark E <Mark.E.Poulson@conocophillips.com>; Richards, Brian <Brian.Richards@conocophillips.com>; Silverman, Jason M <Jason.M.Silverman@conocophillips.com>; Stamets, Steve A <Steve.A.Stamets@conocophillips.com>; Work, Jim A <Jim.A.Work@conocophillips.com>; Blair, Maxwell O <Maxwell.O.Blair@conocophillips.com>; Blakley, Mac <Maclovioa.Blakley@conocophillips.com>; Clark, Joni E <Joni.E.Clark@conocophillips.com>; Cornwall, Mary Kay <Mary.K.Cornwall@conocophillips.com>; Farrell, Juanita R <Juanita.R.Farrell@conocophillips.com>; Greer, David A <David.A.Greer@conocophillips.com>; Maxwell, Mary Alice <Mary.A.Maxwell@conocophillips.com>; McWilliams, Peggy L <Peggy.L.McWilliams@conocophillips.com>; Seabolt, Elmo F <Elmo.F.Seabolt@conocophillips.com>  
**Subject:** Reclamation Notice: San Juan 27-4 Unit 140B  
**Importance:** High  
**Attachments:** San Juan 27-4 unit 140B.PDF

**Paul & Son** will move a tractor to the **San Juan 27-4 Unit 140B** on **Monday, April 20th, 2009** to start the Reclamation Process.

Please contact Eric Smith (608-1387) if you have any questions or need further assistance.

Thanks, Jason Silverman

**San Juan 27-4 Unit 140B**

**Burlington Resource Well Network Number -10158771**

**Forest - Surface/Mineral**

**1730' FNL, 503' FEL**

**Sec. 10, T27N, R4W**

**Unit Letter "H" (SE/NE)**

**Lease: USA SF-080668**

**API: 30-039-30487**

**Lat: 36.590006**  
**Long: 107.231694 (nad 83)**

***Jason Silverman -----***  
***Construction Technician***  
***ConocoPhillips Company - SJBU***  
***Construction Department***  
***P.O. Box 4289***  
***Farmington, NM 87499-4289***  
***505-326-9821***  
***Jason.M.Silverman@ConocoPhillips.com***

# ConocoPhillips

## Reclamation Form:

Date: 4/27/09

Well Name: S.J. 27-4#140B

Footages: \_\_\_\_\_ Unit Letter: H

Section: 10 T-27-N, R-4-W, County: Rio Arriba State: N.M.

Reclamation Contractor: Paul & Sons

Reclamation Date: ~~5/7/09~~ 5/2/09

Road Completion Date: 5/10/09

Seeding Date: 5/17/09

Construction Inspector: Eric Smith Date: 5/20/09

Inspector Signature: [Signature]

S.J. 27-4140B, FOREST BR.  
S10, T27, R4, 1730' FNL,  
503' FEL, H. RA, USASF-  
080668, 30-039-30487

2009/11/12

**BURLINGTON**  
ConocoPhillips **RESOURCES**  
SAN JUAN 27-4 UNIT #140B  
LATITUDE 36° 35' 24.02160" N (NAD83)  
LONGITUDE 107° 13' 54.09840" W  
UNIT H SEC 10 T27N R04W  
1730' FNL 503' FEL  
API # 30-039-30487  
LEASE# USA SF-080668 ELEV. 7159'  
RIO ARriba COUNTY, NEW MEXICO  
EMERGENCY CONTACT: 1-505-599-3400

2009/11/12

## WELL PAD SAFETY AND ENVIRONMENTAL CHECK LIST

WELL NAME: San Juan 27-4 Unit #140B

API#: 30-039-30487

DATE	INSPECTOR	SAFETY CHECK	LOCATION CHECK	PICTURES TAKEN	COMMENTS
4/15/08	Art Sanchez	X	X	X	
6/4/08	Rodney Woody	X	X	X	H & P 282 on location
6/10/08	Rodney Woody	X	X	X	Called MVCI for liner repair and trash, called Brandon with OCD
6/18/08	Rodney Woody	X	X	X	Called MVCI to repair blow pit and liner, called Brandon with OCD
6/25/08	Rodney Woody	X	X	X	Liner has tears, fence loose, un-keyed
7/2/08	Rodney Woody	X	X	X	Fence need tighten, holes in liner and B & H on location
7/9/08	Rodney Woody	X	X	X	Called MVCI for repairs tears, fence, trash
7/16/08	Rodney Woody	X	X	X	Pit and location look good
7/23/08	Rodney Woody	X	X	X	Pit and location look good
7/30/08	Rodney Woody	X			Flow back on location
8/6/08	Rodney Woody	X	X	X	Pit and location look good, Nobles to pull blow pit
8/20/08	Rodney Woody	X	X	X	Crossfire to pick up trash

9/2/08	Rodney Woody	X	X	X	Pit and location look good, Nobles to pull blow pit
9/16/08	Rodney Woody	X			Key 11 on location
10/6/08	Rodney Woody	X	X	X	Pit and location look good
10/6/08	Rodney Woody	X	X	X	Crossfire to repair fence
10/22/08	Rodney Woody	X	X	X	Pit and location look good
11/17/08	Rodney Woody	X	X	X	Pit and location look good
2/4/09	Rodney Woody				No pics had to take day off
2/9/09	Rodney Woody	X	X	X	Pit and location look good
2/17/09	Rodney Woody	X	X	X	Pit and location look good
2/26/09	Rodney Woody				On vacation
3/20/09	Art Sanchez	X	X	X	

DATE: 6/21/12

WELL NAME: SAN JUAN 27-4 UNIT 140B

API# 30-039-30487

PERMIT #: 5228

MISSING DATA: PICTURES OF RECLAMATION

ATTACHED: PICTURES OF RECLAMATION

RCVD JUN 25 '12

OIL CONS. DIV.

DIST. 3

Jamie Goodwin  
ConocoPhillips  
505-326-9784



