

RECEIVED

submitted in lieu of Form 3160-5

UNITED STATES
DEPARTMENT OF THE INTERIOR
BUREAU OF LAND MANAGEMENT
Sundry Notices and Reports on Wells

JUL 11 2012

Farmington Field Office
Bureau of Land Management

1. Type of Well	5. Lease Number NMNM-27024
2. Name of Operator ConocoPhillips c/o BHP Billiton San Juan Coal	6. If Indian, All. or Tribe Name
3. Address & Phone No. of Operator PO Box 561, Waterflow, NM 87421 (505) 598-2000	7. Unit Agreement Name
Location of Well, Footage, Sec., T, R, M 990' FNL & 940' FWL, Section 31, T-30-N, R-14-W,	8. Well Name & Number Twin Mounds 31 #1
	9. API Well No. 30-045-25880
	10. Field and Pool Basin Dakota
	11. County & State San Juan County, NM

12. CHECK APPROPRIATE BOX TO INDICATE NATURE OF NOTICE, REPORT, OTHER DATA

Type of Submission	Type of Action
<input type="checkbox"/> Notice of Intent	<input type="checkbox"/> Abandonment
<input checked="" type="checkbox"/> Subsequent Report	<input type="checkbox"/> Recompletion
<input type="checkbox"/> Final Abandonment	<input type="checkbox"/> Plugging Back
	<input type="checkbox"/> Casing Repair
	<input type="checkbox"/> Altering Casing
	<input checked="" type="checkbox"/> Other - Below Grade Marker

RCVD AUG 3 '12
OIL CONS. DIV.
DIST. 3

13. Describe Proposed or Completed Operations

BHP - San Juan Coal for ConocoPhillips has set an underground plate instead of a 4" above ground marker to prevent stray electrical currents from entering the underground coal mine. Please find the attached certified survey.

14. I hereby certify that the foregoing is true and correct.

Signed William Clark Title _____ Contractor _____ Date July 10, 2012
William Clark

Type or print name _____ E-mail address: billc@apluswell.com PHONE: (505)325-2627

(This space for Federal or State Office use)

APPROVED BY Bruce Prew Title Branch Chief Environmental Date 7/16/12
CONDITION OF APPROVAL, if any:

Title 18 U.S.C. Section 1001, makes it a crime for any person knowingly to make to any department or agency of the United States any false, fictitious or fraudulent statements or representations as to any matter within its jurisdiction.

NMOCD *AV*

P & A WELL SURVEY
CONOCO MESA TWIN WELL LOCATED IN THE
NW/4 NW/4 SECTION 31, T.30N., R.14W.,
N.M.P.M., SAN JUAN COUNTY, NEW MEXICO.

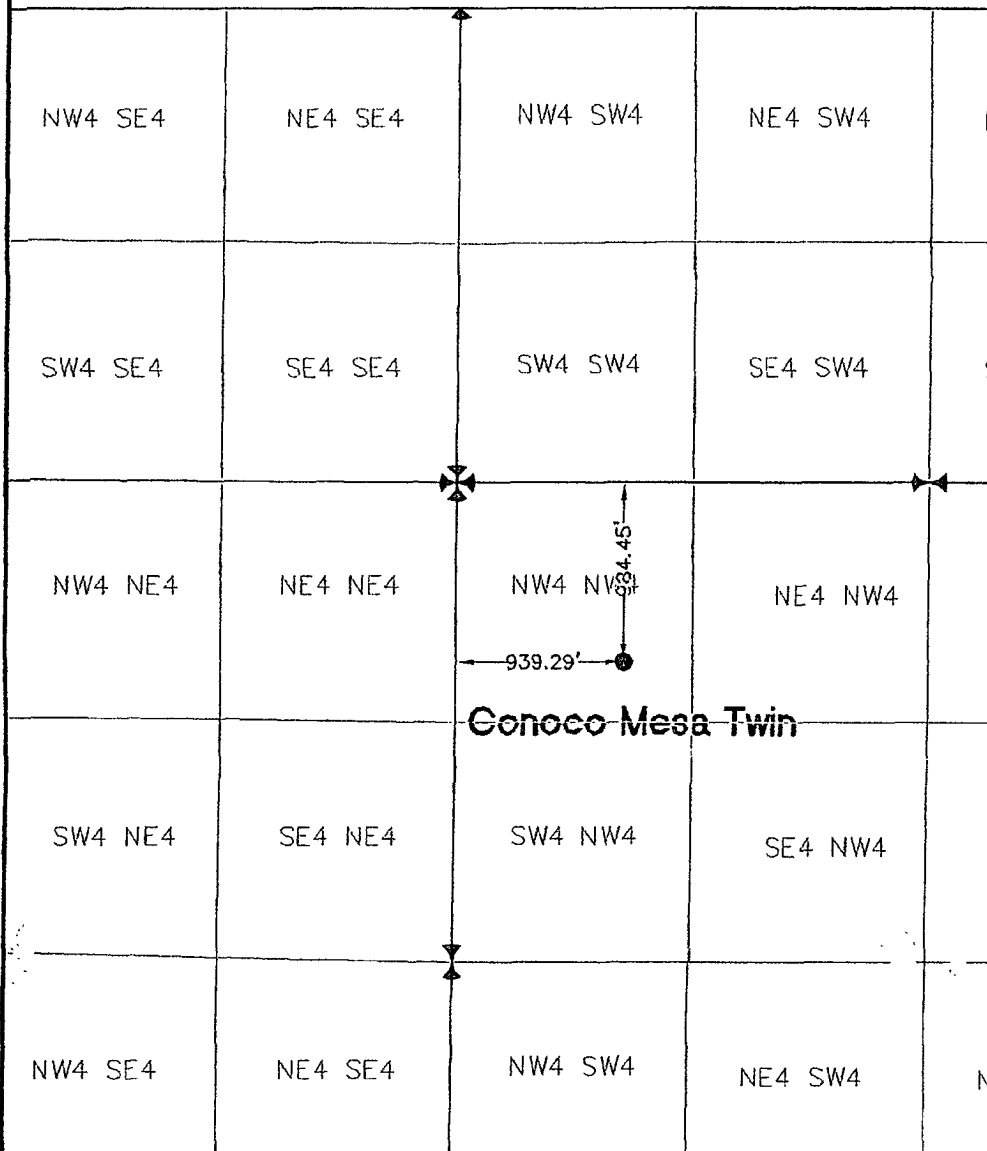

NAD 1927 NEW MEXICO WEST

N2101869.67
E340695.16
El. 5354

Lat: 36 46 30.93742
Long: 108 21 23.01917



SCALE: 1"=500'

I, Peter Epp, a Registered Professional Surveyor under the laws of the State of New Mexico, hereby certify that this plat was prepared from the field notes of a actual survey meeting the minimum requirements of the standards for easement surveys and is true and correct to the best of my knowledge and belief.

BASIS OF BEARING:
STATIC G.P.S. SURVEY SOLUTIONS
OBTAINED FROM SATELLITES TRACKED
APRIL, 2003. REFERENCE H.A.R.N.
NETWORK POINTS FMN 0 AND E432.
BEARING N 86°37'34" W (NAD27
NEW MEXICO WEST) SCALE FACTOR
= 0.99988810



Peter Epp P.L.S. New Mexico L.S. # 15512

Date: 12 MAR 12

CHECKED BY PE

DRAWN BY RC



EPP & ASSOCIATES, INC.
PROFESSIONAL LAND SURVEYORS

433 4th Avenue West
P.O. Box 837
Craig, CO 81625

Phone (970) 824-8236
Fax (970) 824-5227

Prepared for:
State of New Mexico
Oil Conservation Commission