

MAY - 3 2005

Location: ROSA 101M

Footages: \_\_\_\_\_

Unit Letter: F Sec: 24 Twn: 31N Rng: 6W

Lat: \_\_\_\_\_ Long: \_\_\_\_\_

Lease Num: \_\_\_\_\_ Land Type: BLM

Pit Type: BGT

Pit Reference: \_\_\_\_\_

Reference: \_\_\_\_\_ Wellhead \_\_\_\_\_ Footage: 48'

Direction: N or S 10 Degrees E or W

Initial size: BGT ± 15' Ø

Final Size: 20 x 20

Total Cubic Yards: N/A

Distances from (ft): \_\_\_\_\_ points

Groundwater: \_\_\_\_\_

Wellhead Protection Area: \_\_\_\_\_

Nearest Surface Water: \_\_\_\_\_

Distance to ephemeral stream: \_\_\_\_\_

(Navajo/Jicarilla only)

Ranking Score (points): \_\_\_\_\_

Sample ID	Description	Field Reading
1	Silty Clay	N/A
2		
3		
4		
5		
6		
7		
8		

Comments: COMPOSITE SOIL SAMPLE FROM SIDEWALKS & BTM.

Tests: TPH / BTEX

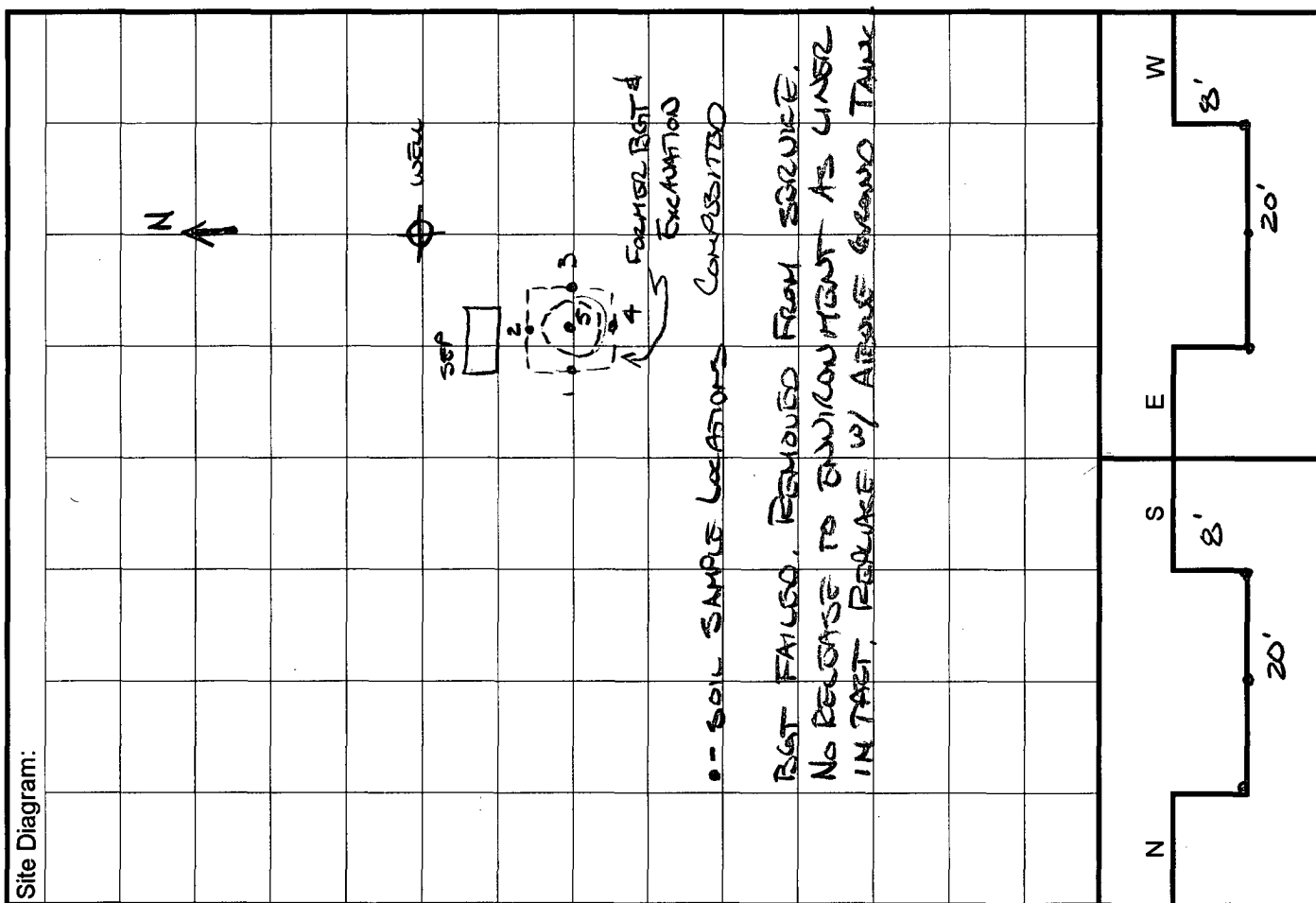

612 E. Murray Drive  
Farmington, NM 87499

Off: (505) 327-1072

FAX: (505) 327-1496

# iiná bá

P.O. Box 3788  
Shiprock, NM 87420

Off: (505) 368-4065

## ANALYTICAL REPORT

Date: 20-Apr-05

**CLIENT:** Williams - Exploration & Production  
**Work Order:** 0504014  
**Project:** Rosa 101M  
**Lab ID:** 0504014-001A

**Client Sample Info:** Rosa 101M  
**Client Sample ID:** BGT PIT BTM  
**Collection Date:** 4/6/2005 11:00:00 AM  
**Matrix:** SOIL

Parameter	Result	PQL	Qual	Units	DF	Date Analyzed
<b>DIESEL AND OIL RANGE ORGANICS</b>		<b>SW8015B</b>		Analyst: JEM		
T/R Hydrocarbons: C10-C22	ND	25.0		mg/Kg	1	4/18/2005
T/R Hydrocarbons: C22-C36	ND	50.0		mg/Kg	1	4/18/2005
Surr: o-Terphenyl	95.7	23-171		%REC	1	4/18/2005
<b>AROMATIC VOLATILES BY GC/PID</b>		<b>SW8021B</b>		Analyst: JEM		
Benzene	ND	25		µg/Kg	25	4/14/2005
Ethylbenzene	ND	25		µg/Kg	25	4/14/2005
m,p-Xylene	ND	50		µg/Kg	25	4/14/2005
Methyl tert-Butyl Ether	ND	250		µg/Kg	25	4/14/2005
o-Xylene	ND	25		µg/Kg	25	4/14/2005
Toluene	ND	50		µg/Kg	25	4/14/2005
Surr: 1,4-Difluorobenzene	90.5	75-110		%REC	25	4/14/2005
Surr: 4-Bromochlorobenzene	106	40-135		%REC	25	4/14/2005
Surr: Fluorobenzene	87.3	69-110		%REC	25	4/14/2005

**Qualifiers:**

ND - Not Detected at the Practical Quantitation Limit

J - Analyte detected below Practical Quantitation Limit

B - Analyte detected in the associated Method Blank

H - Parameter exceeded Maximum Allowable Holding Time

S - Spike Recovery outside accepted recovery limits

R - RPD outside accepted precision limits

E - Value above Upper Quantitation Limit - UQL