

UNITED STATES
DEPARTMENT OF THE INTERIOR
BUREAU OF LAND MANAGEMENT

FORM APPROVED
OMB No. 1004-0137
Expires: March 31, 2007

SUNDRY NOTICES AND REPORTS ON WELLS

Do not use this form for proposals to drill or to re-enter an abandoned well. Use Form 3160-3 (APD) for such proposals.

5. Lease Serial No.
JICARILLA CONTRACT 97

6. If Indian, Allottee or Tribe Name
JICARILLA APACHE

7. If Unit or CA/Agreement, Name and/or No.

8. Well Name and No.
TRIBAL C #10E

9. API Well No.
30-039-22130

10. Field and Pool, or Exploratory Area
BASIN DK/BLANCO MV

11. County or Parish, State
RIO ARRIBA CTY, NEW MEXICO

SUBMIT IN TRIPLICATE- Other instructions on reverse side.

1. Type of Well
 Oil Well Gas Well Other

2. Name of Operator
PATINA SAN JUAN, INC.

3a. Address
5802 US HIGHWAY 64 FARMINGTON, NM 87402

3b. Phone No. (include area code)
505-632-8056

4. Location of Well (Footage, Sec., T., R., M., or Survey Description)
**850' FSL, 1665' FEL
B Sec 07 - T26N - R3W**

12. CHECK APPROPRIATE BOX(ES) TO INDICATE NATURE OF NOTICE, REPORT, OR OTHER DATA

TYPE OF SUBMISSION	TYPE OF ACTION			
<input checked="" type="checkbox"/> Notice of Intent	<input type="checkbox"/> Acidize	<input type="checkbox"/> Deepen	<input type="checkbox"/> Production (Start/Resume)	<input type="checkbox"/> Water Shut-Off
<input type="checkbox"/> Subsequent Report	<input type="checkbox"/> Alter Casing	<input type="checkbox"/> Fracture Treat	<input type="checkbox"/> Reclamation	<input type="checkbox"/> Well Integrity
<input type="checkbox"/> Final Abandonment Notice	<input type="checkbox"/> Casing Repair	<input type="checkbox"/> New Construction	<input checked="" type="checkbox"/> Recomplete	<input type="checkbox"/> Other _____
	<input type="checkbox"/> Change Plans	<input type="checkbox"/> Plug and Abandon	<input type="checkbox"/> Temporarily Abandon	
	<input type="checkbox"/> Convert to Injection	<input type="checkbox"/> Plug Back	<input type="checkbox"/> Water Disposal	

13. Describe Proposed or Completed Operation (clearly state all pertinent details, including estimated starting date of any proposed work and approximate duration thereof. If the proposal is to deepen directionally or recomplete horizontally, give subsurface locations and measured and true vertical depths of all pertinent markers and zones. Attach the Bond under which the work will be performed or provide the Bond No. on file with BLM/BIA. Required subsequent reports shall be filed within 30 days following completion of the involved operations. If the operation results in a multiple completion or recompletion in a new interval, a Form 3160-4 shall be filed once testing has been completed. Final Abandonment Notices shall be filed only after all requirements, including reclamation, have been completed, and the operator has determined that the site is ready for final inspection.)

PATINA SAN JUAN, INC. PROPOSES TO ADD THE BLANCO MESA VERDE FORMATION IN THIS PRODUCING WELL.

A RETREIVABLE CAST IRON BRIDGE PLUG WILL BE SET OVER THE BASIN DAKOTA PERFORATIONS TO ISOLATE THE FORMATION AND THE SUBJECT WELL WILL BE RECOMPLETED IN THE BLANCO MESA VERDE FORMATION (POINT LOOKOUT). THE PLAN AND WELL BORE DIAGRAM ARE ATTACHED.

CONDITIONS OF APPROVAL
Adhere to previously issued stipulations.

**SEE ATTACHED FOR
CONDITIONS OF APPROVAL**

RECEIVED
 APR 19 PM 4 07
 070 FARMINGTON NM

14. I hereby certify that the foregoing is true and correct

Name (Printed/Typed) **JEAN M. MUSE** Title **REGULATORY/ENGINEERING TECH**

Signature *[Signature]* Date **04/19/2005**

THIS SPACE FOR FEDERAL OR STATE OFFICE USE

Approved by **Original Signed: Stephen Mason** Title _____ Date **JUN 09 2005**

Conditions of approval, if any, are attached. Approval of this notice does not warrant or certify that the applicant holds legal or equitable title to those rights in the subject lease which would entitle the applicant to conduct operations thereon. Office _____

Title 18 U.S.C. Section 1001 and Title 43 U.S.C. Section 1212, make it a crime for any person knowingly and willfully to make to any department or agency of the United States any false, fictitious or fraudulent statements or representations as to any matter within its jurisdiction.

(Instructions on page 2)

PATINA

OIL & GAS CORPORATION

Tribal C No. 10E
AFE#: TBD

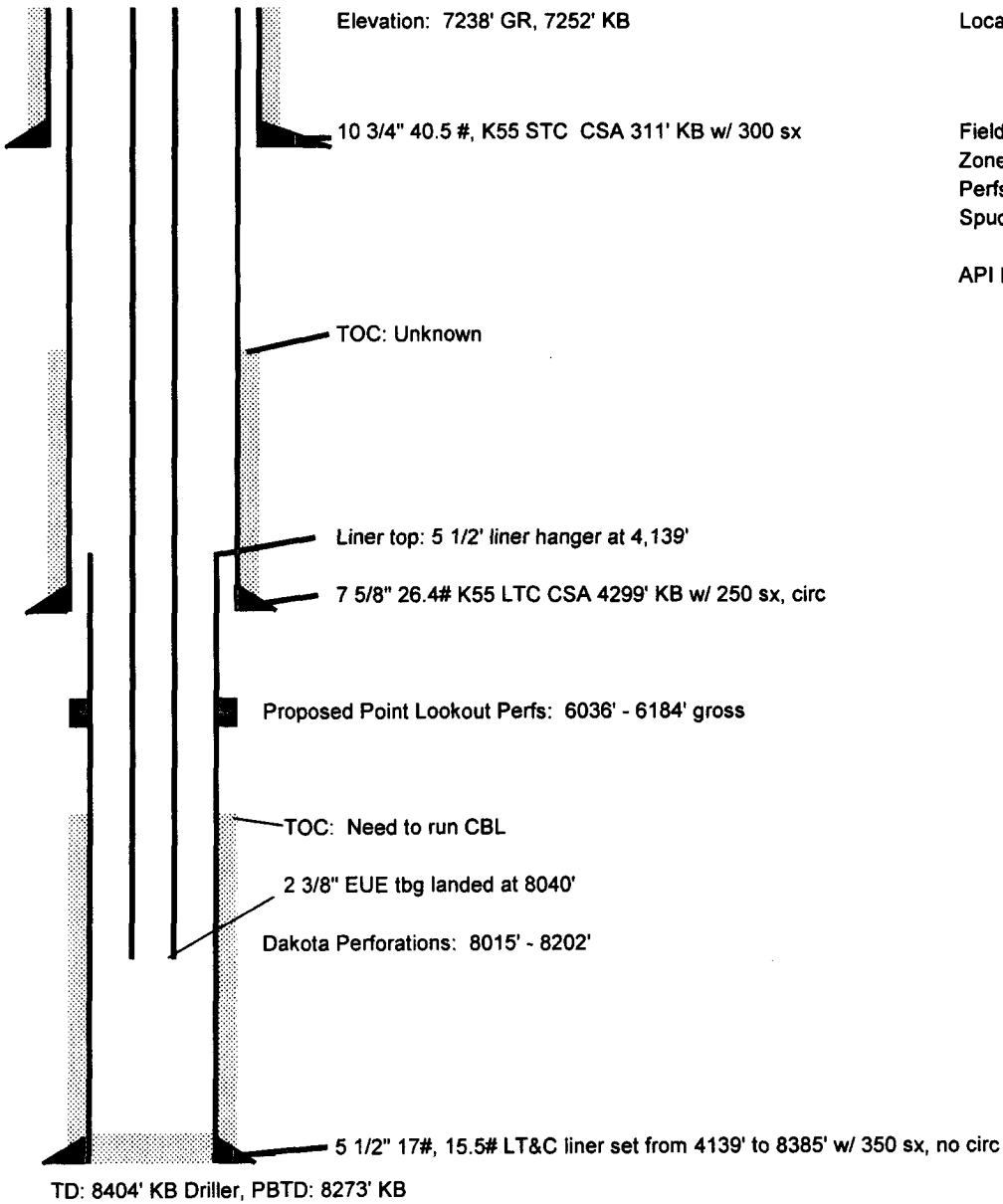

Location: 1665' FEL, 850' FNL, Sec 7, T26N,
R3W, Rio Arriba County, NM

Field: Blanco Mesa Verde / Basin Dakota
Zone: Point Lookout
Perfs: Dakota: 8015' - 8202'
Spud Date: June 29, 1979, 00:00

API No: 30-039-22130

9/10/2004 Tubing change out from 1 1/2" to 2 3/8"

Directions:

Location: 1665' FEL, 850' FNL, Sec 7, T26N, R3W, Rio Arriba County, NM

Field: Blanco Mesa Verde / Basin Dakota

API #: 30-039-22130

Spud Date: 6/29/1979

Elevation: Elevation: 7238' GR, 7252' KB

TD: TD: 8404' KB Driller, PBTD: 8273' KB

Wellhead:

Tubulars:

Surface: 10 3/4" 40.5 #, K55 STC CSA 311' KB w/ 300 sx
Intermediate: 7 5/8" 26.4# K55 LTC CSA 4299' KB w/ 250 sx, circ

Production:
Liner: 5 1/2" 17#, 15.5# LT&C liner set from 4139' to 8385' w/ 350 sx, no circ

Procedure to Complete Well in Point Lookout formation:

- 1) MIRU PU. Nipple down wellhead. NU BOPE. Top kill well with 2% KCl water as necessary.
- 2) Trip out of hole with 2 3/8" tubing.
- 3) Trip in hole with bit, scraper and tubing to clean up casing to PBTD.
- 4) TOH w/ bit and scraper.
- 5) Set retrievable plug at 6250'.
- 6) Trip in hole with packer and 2 3/8" workstring to set packer and test plug to 1500 psi.
- 7) Fill casing with clean 2 % KCl water to top of liner at 4139'.
- 8) Trip out of hole.
- 9) Run CBL over liner from 6250' to liner top at 4139'.
- 10) *If remediation is required, use your determination of the number of sacks of 50/50 Poz w/ 2% gel, 5#/sx Gilsonite, 1/4#/sx cellophane, 0.5% Halad 9, 0.2% CFR-3 (dispersant), 0.1% HR 5, 6.44 gal/sx water @ 13.5ppg (1.44cuft/sx).*
- 11) Perforate the Point Lookout formation with 3-1/8" casing gun (use deepest penetrating jets available) with 0.38" EHD jets and 120 degree phasing as follows:

From 6036' to 6184' (gross interval). Total shots = 22

All depths are from Formation Density log dated
- 12) Trip in hole with 5 1/2" packer and 3 1/2" 9.3# N80 workstring to 6,000'+/-. Load the backside with clean 2% KCl.
- 13) Rig up frac company and frac Point Lookout down tubing. **Maximum Treating Pressure is 5,000 psig.**

Record ISIP, 5,10 and 15 min SIP's.

- 14) Flow back load using chokes to control flowback rate to minimize sand recovery until well dies.
- 15) Trip out of hole laying down frac string and packer.
- 16) Trip in hole with mill, DC's and 2 3/8" workstring to clean out frac sand. Continue to clean up well until sand flowback is no longer a problem.
- 17) Trip out of hole with 2 3/8" workstring laying down.
- 18) Rig up well to produce with plunger.
- 19) Return well to production from the Point Lookout formation only. The well will be commingled at a later date.

WELL LOCATION AND ACREAGE DEDICATION PLAT

Supers-U's C
Effective 1-1-

All distances must be from the outer boundaries of the Section.

Consolidated Oil & Gas			Lease Tribal C		Well No. #10 F
Unit Letter B	Section 7	Township 26	Range 3	County Rio Arriba	
Actual Footage Location of Well: 850 feet from the North line and 1665 feet from the East line					
Ground Level Elev. 7233	Producing Formation Gallup	Pool B.S. Mesa Gallup	Dedicated Acreage: 160 Ac.		

1. Outline the acreage dedicated to the subject well by colored pencil or hachure marks on the plat below.
2. If more than one lease is dedicated to the well, outline each and identify the ownership thereof (both as to working interest and royalty).
3. If more than one lease of different ownership is dedicated to the well, have the interests of all owners been consolidated by communitization, unitization, force-pooling, etc?

Yes No If answer is "yes," type of consolidation Communitization

If answer is "no," list the owners and tract descriptions which have actually been consolidated. (Use reverse side of this form if necessary.)

No allowable will be assigned to the well until all interests have been consolidated (by communitization, unitization, forced-pooling, or otherwise) or until a non-standard unit, eliminating such interests, has been approved by the Commission.

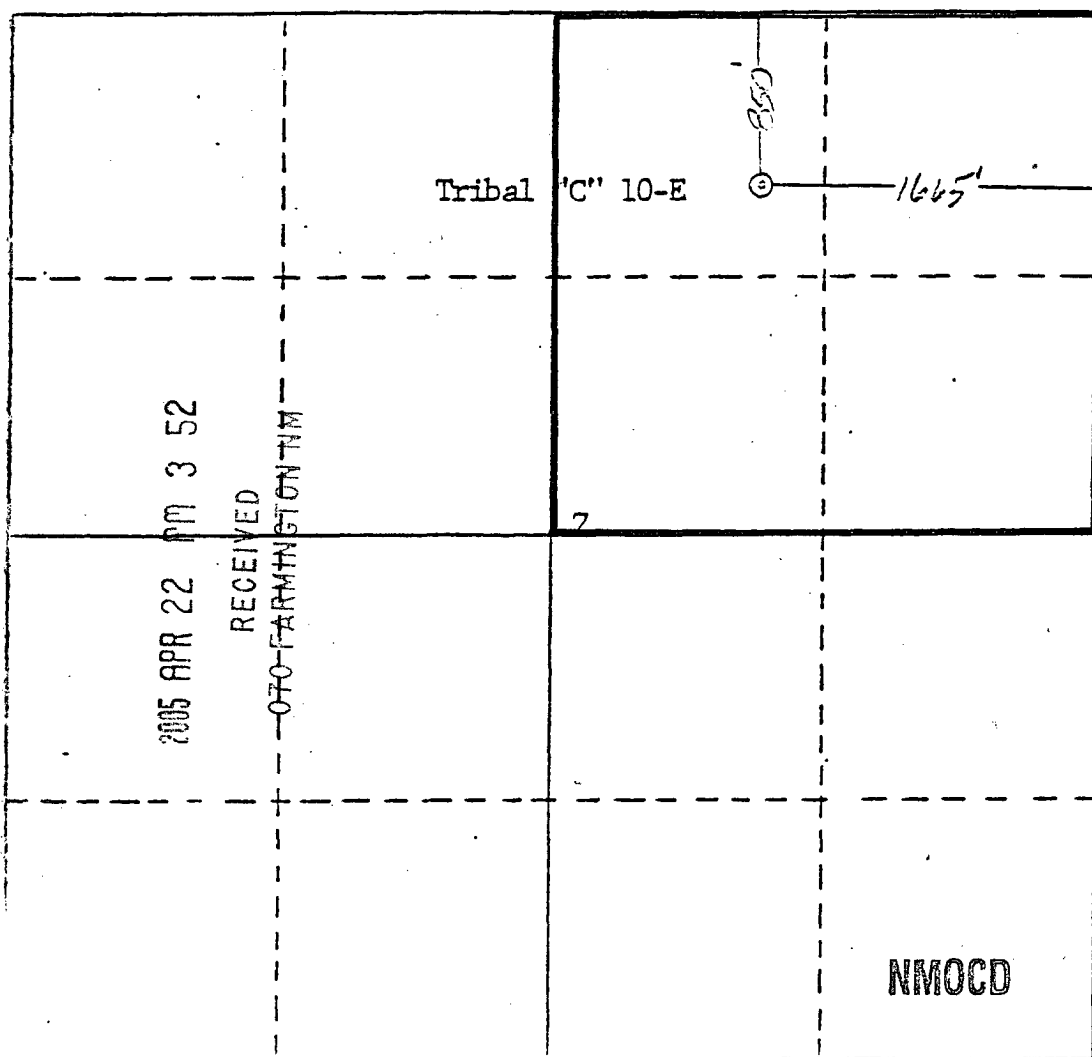

2005 APR 22 AM 3 52
 RECEIVED
 OFC-FARMINGTON NM

CERTIFICATION

I hereby certify that the information contained herein is true and complete to the best of my knowledge and belief.

C. M. Parham

Name
C. M. Parham

Position
Senior Production Engineer

Company
Consolidated Oil & Gas, Inc.

Date
August 3, 1979

I hereby certify that the well location shown on this plat was plotted from field notes of actual surveys made by me or under my supervision, and that the same is true and correct to the best of my knowledge and belief.

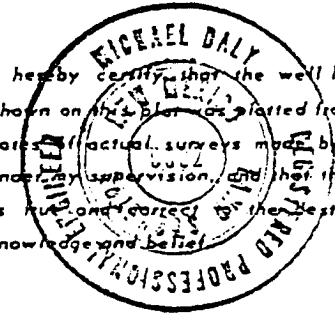

Date Surveyed
18 JUNE 1979

Registered Professional Engineer and/or Land Surveyor

Certificate No.

Bureau of Land Management Conditions of Approval:

- 1) If cement squeeze work is necessary, contact Matt Halbert of the BLM Farmington Field Office @ (505) 599-6350.**
- 2) If this well is located in a Specially Designated Area (SDA), compliance with the appropriate seasonal closure requirements will be necessary.**
- 3) Pits must be lined with an impervious material at least 12 mils thick. The pit must be fenced on three (3) sides during workover operations and on the 4th side after the rig moves off location. Pits must be closed within 90 days of completion of the workover operations. Prior to closing the pit the liner must be cut off at mud level.**