

Submit 3 Copies To Appropriate District Office
District I
1625 N. French Dr., Hobbs, NM 88240
District II
1301 W. Grand Ave., Artesia, NM 88210
District III
1000 Rio Brazos Rd., Aztec, NM 87410
District IV
1220 S. St. Francis Dr., Santa Fe, NM 87505

State of New Mexico
Energy, Minerals and Natural Resources

OIL CONSERVATION DIVISION
1220 South St. Francis Dr.
Santa Fe, NM 87505

Form C-103
May 27, 2004

SUNDRY NOTICES AND REPORTS ON WELLS (DO NOT USE THIS FORM FOR PROPOSALS TO DRILL OR TO DEEPEN OR PLUG BACK TO A DIFFERENT RESERVOIR. USE "APPLICATION FOR PERMIT" (FORM C-101) FOR SUCH PROPOSALS.)		WELL API NO. 30-045-33111
1. Type of Well: Oil Well <input type="checkbox"/> Gas Well <input checked="" type="checkbox"/> Other		5. Indicate Type of Lease STATE <input type="checkbox"/> FEE <input type="checkbox"/>
2. Name of Operator BP AMERICA PRODUCTION COMPANY		6. State Oil & Gas Lease No.
3. Address of Operator P.O. BOX 3092 HOUSTON, TX 77079-2064		7. Lease Name or Unit Agreement Name Barnes LS (BLM SF - 078039)
4. Well Location Unit Letter B : 860 feet from the North line and 1535 feet from the East line Section 24 Township 32N Range 11W NMPM SAN JUAN County		8. Well Number 1 N
11. Elevation (Show whether DR, RKB, RT, GR, etc.) 6215' GR		9. OGRID Number 000778
Pit or Below-grade Tank Application <input checked="" type="checkbox"/> or Closure <input type="checkbox"/>		10. Pool name or Wildcat Basin Dakota & Blanco Mesaverde
Pit type DRILLING Depth to Groundwater >100' Distance from nearest fresh water well >1000' Distance from nearest surface water >1000'		
Pit Liner Thickness: 12 mil Below-Grade Tank: Volume _____ bbls; Construction Material _____		

12. Check Appropriate Box to Indicate Nature of Notice, Report or Other Data

NOTICE OF INTENTION TO:		SUBSEQUENT REPORT OF:	
PERFORM REMEDIAL WORK <input type="checkbox"/>	PLUG AND ABANDON <input type="checkbox"/>	REMEDIAL WORK <input type="checkbox"/>	ALTERING CASING <input type="checkbox"/>
TEMPORARILY ABANDON <input type="checkbox"/>	CHANGE PLANS <input type="checkbox"/>	COMMENCE DRILLING OPNS. <input type="checkbox"/>	P AND A <input type="checkbox"/>
PULL OR ALTER CASING <input type="checkbox"/>	MULTIPLE COMPL. <input type="checkbox"/>	CASING/CEMENT JOB <input type="checkbox"/>	
OTHER: LINED DRILLING PIT <input checked="" type="checkbox"/>		OTHER: <input type="checkbox"/>	

13. Describe proposed or completed operations. (Clearly state all pertinent details, and give pertinent dates, including estimated date of starting any proposed work). SEE RULE 1103. For Multiple Completions: Attach wellbore diagram of proposed completion or recompletion.

Construct a lined drilling pit per BP America - San Juan Basin Drilling/ Workover Pit Construction Plan issued date of 11/17/2004. Pit will be closed according to closure plan on file.



I hereby certify that the information above is true and complete to the best of my knowledge and belief. I further certify that any pit or below-grade tank has been/will be constructed or closed according to NMOCD guidelines ☒, a general permit ☐ or an (attached) alternative OCD-approved plan ☐.

SIGNATURE Cherry Hlava TITLE Regulatory Analyst DATE 05/20/2005 9-8-05

Type or print name Cherry Hlava E-mail address: hlavacl@bp.com Telephone No. 281-366-4081

For State Use Only

APPROVED BY: [Signature] TITLE DEPUTY OIL & GAS INSPECTOR, DIST. 9 DATE SEP 12 2005

Conditions of Approval (if any):

PAD LAYOUT PLAN & PROFILE
BP AMERICA PRODUCTION COMPANY
 Barnes LS # 1N
 860' F/NL 1535' F/EL
 SEC. 24, T32N, R11W, N.M.P.M.
 SAN JUAN COUNTY, NEW MEXICO

Lat: 36.9753°
 Long: 107.9378°

Lat: 36°58'31"
 Long: 107°56'16"

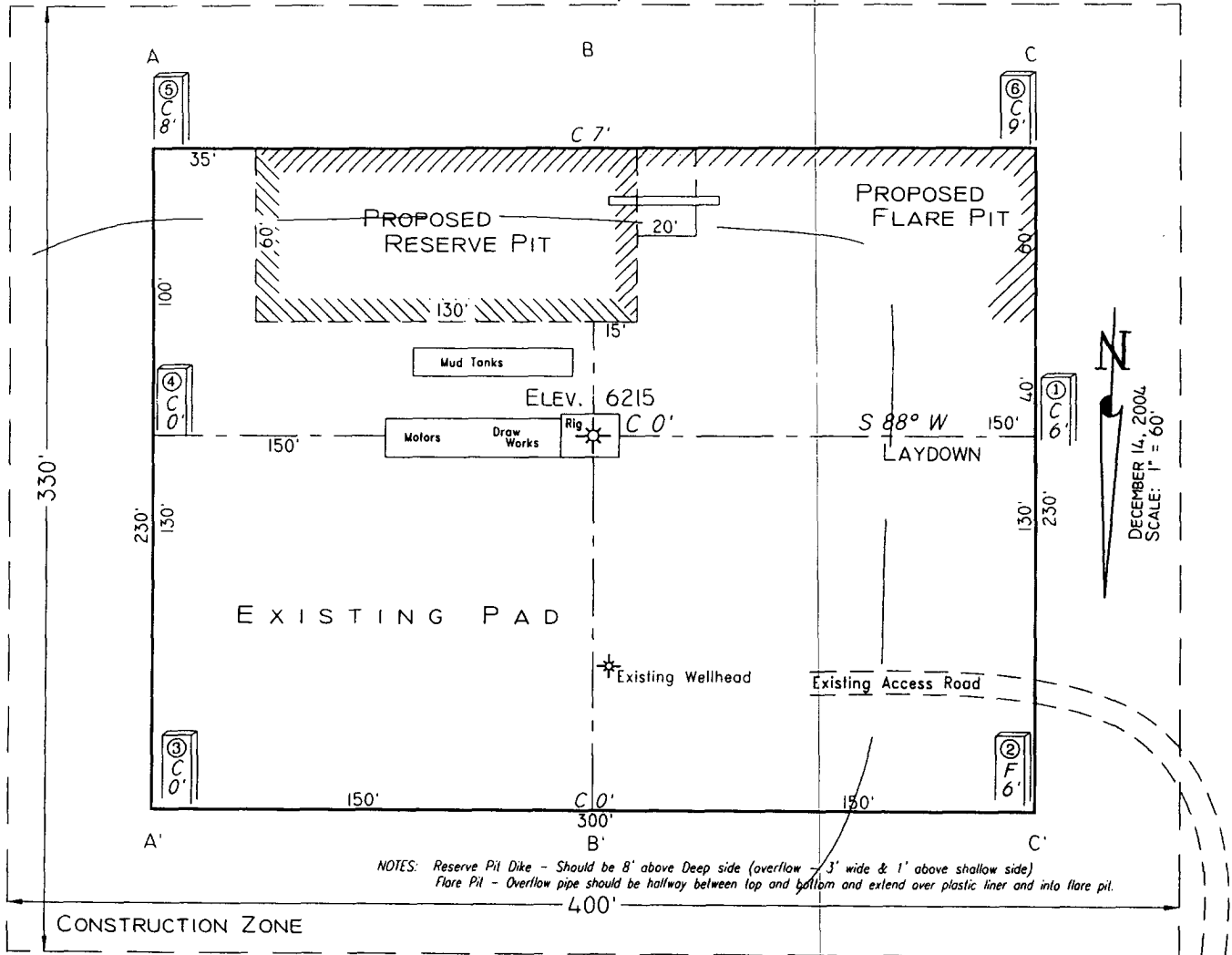

NOTES: Reserve Pit Dike - Should be 8' above Deep side (overflow) - 3' wide & 1' above shallow side.
 Flare Pit - Overflow pipe should be halfway between top and bottom and extend over plastic liner and into flare pit.

Area of Construction Zone - 330'x400' or 3.03 acres, more or less.

SCALE: 1"=60'-HORIZ.
 1"=40'-VERT.

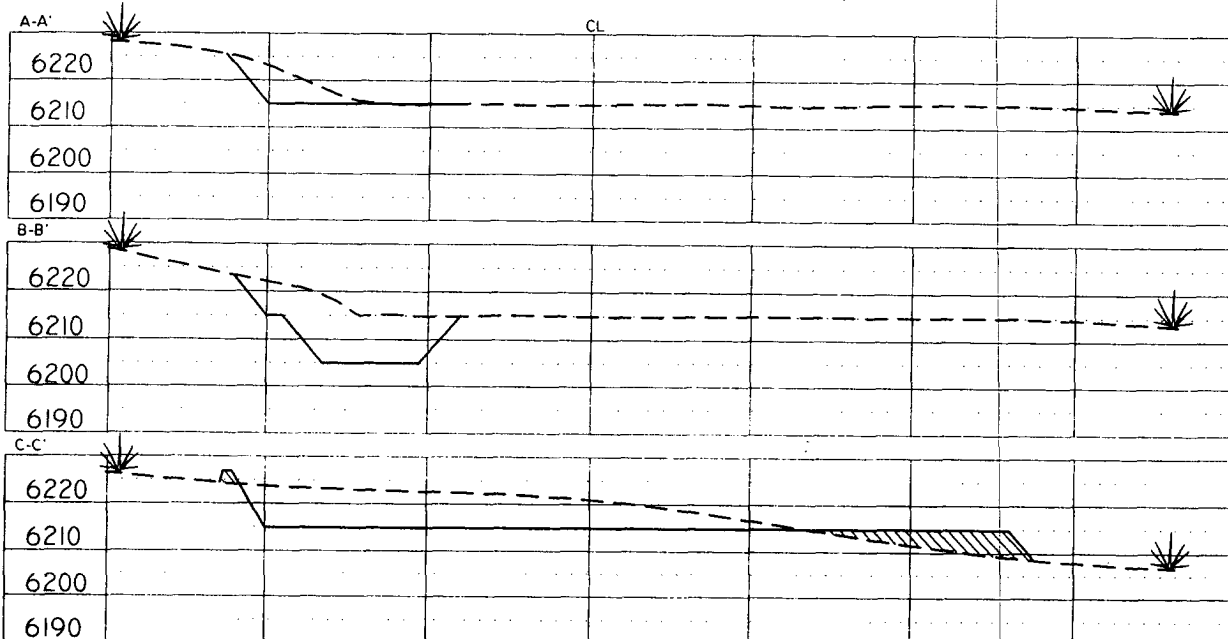

NOTE: Contractor should call One-Call for location of any marked or unmarked buried pipelines or cables on well pad and/or access road at least two (2) working days prior to construction.

Cuts and fills shown are approximate - final finished elevation is to be adjusted so earthwork will balance. Corner stakes are approximate and do not include additional areas needed for sideslopes and drainages. Final Pad Dimensions are to be verified by Contractor.

VANN SURVEYS
 P. O. Box 1306
 Farmington, NM