

Submit 3 Copies To Appropriate District Office
District I
1625 N. French Dr., Hobbs, NM 88240
District II
1301 W. Grand Ave., Artesia, NM 88210
District III
1000 Rio Brazos Rd., Aztec, NM 87410
District IV
1220 S. St. Francis Dr., Santa Fe, NM 87505

State of New Mexico
Energy, Minerals and Natural Resources

Form C-103
May 27, 2004

OIL CONSERVATION DIVISION
1220 South St. Francis Dr.
Santa Fe, NM 87505

WELL API NO. 30-045-33130
5. Indicate Type of Lease STATE <input type="checkbox"/> FEE <input type="checkbox"/>
6. State Oil & Gas Lease No.
7. Lease Name or Unit Agreement Name Florance (APD filed with BLM NMSF 080000)
8. Well Number 27 S
9. OGRID Number 000778
10. Pool name or Wildcat Basin Fruitland Coal
11. Elevation (Show whether DR, RKB, RT, GR, etc.) 5627'
Pit or Below-grade Tank Application <input checked="" type="checkbox"/> or Closure <input type="checkbox"/>
Pit type <u>DRILLING</u> Depth to Groundwater <u>>100'</u> Distance from nearest fresh water well <u>>1000'</u> Distance from nearest surface water <u>>1000'</u>
Pit Liner Thickness: <u>12</u> mil Below-Grade Tank: Volume <u>95</u> bbls; Construction Material <u>IMPERVIOUS</u>

SUNDRY NOTICES AND REPORTS ON WELLS
(DO NOT USE THIS FORM FOR PROPOSALS TO DRILL OR TO DEEPEN OR PLUG BACK TO A DIFFERENT RESERVOIR. USE "APPLICATION FOR PERMIT" (FORM C-101) FOR SUCH PROPOSALS.)

1. Type of Well: Oil Well ☐ Gas Well ☒ Other

2. Name of Operator
BP AMERICA PRODUCTION COMPANY

3. Address of Operator
P.O. BOX 3092 HOUSTON, TX 77079-2064

4. Well Location
Unit Letter D : 1670 feet from the South line and 990 feet from the West line
Section 26 Township 29N Range 09W NMPM SAN JUAN County

11. Elevation (Show whether DR, RKB, RT, GR, etc.)
5627'

Pit or Below-grade Tank Application ☒ or Closure ☐

Pit type DRILLING Depth to Groundwater >100' Distance from nearest fresh water well >1000' Distance from nearest surface water >1000'

Pit Liner Thickness: 12 mil Below-Grade Tank: Volume 95 bbls; Construction Material IMPERVIOUS

12. Check Appropriate Box to Indicate Nature of Notice, Report or Other Data

NOTICE OF INTENTION TO:		SUBSEQUENT REPORT OF:	
PERFORM REMEDIAL WORK <input type="checkbox"/>	PLUG AND ABANDON <input type="checkbox"/>	REMEDIAL WORK <input type="checkbox"/>	ALTERING CASING <input type="checkbox"/>
TEMPORARILY ABANDON <input type="checkbox"/>	CHANGE PLANS <input type="checkbox"/>	COMMENCE DRILLING OPNS. <input type="checkbox"/>	P AND A <input type="checkbox"/>
PULL OR ALTER CASING <input type="checkbox"/>	MULTIPLE COMPL <input type="checkbox"/>	CASING/CEMENT JOB <input type="checkbox"/>	
OTHER: <u>LINED DRILLING PIT</u> <input checked="" type="checkbox"/>		OTHER: <input type="checkbox"/>	

13. Describe proposed or completed operations. (Clearly state all pertinent details, and give pertinent dates, including estimated date of starting any proposed work). SEE RULE 1103. For Multiple Completions: Attach wellbore diagram of proposed completion or recompletion.

Construct a lined drilling pit per BP America – San Juan Basin Drilling/ Workover Pit Construction Plan issued date of 11/17/2004. Pit will be closed according to closure plan on file.



I hereby certify that the information above is true and complete to the best of my knowledge and belief. I further certify that any pit or below-grade tank has been/will be constructed or closed according to NMOCD guidelines ☒, a general permit ☐ or an (attached) alternative OCD-approved plan ☐.

SIGNATURE Cherry Hlava TITLE Regulatory Analyst DATE 09/01/2005

Type or print name Cherry Hlava E-mail address: hlavacl@bp.com Telephone No. 281-366-4081

For State Use Only

APPROVED BY: Lenny Ferty TITLE DEPUTY OIL & GAS INSPECTOR, DIST. 3 DATE SEP 06 2005
Conditions of Approval (if any):

PAD LAYOUT PLAN & PROFILE
BP AMERICA PRODUCTION COMPANY
 Florance # 27S
 1670' F/SL 990' F/WL
 SEC. 26, T29N, R9W, N.M.P.M.
 SAN JUAN COUNTY, NEW MEXICO

Lat: 36.6942°
 Long: 107.7556°
 Lat: 36°41'39"
 Long: 107°45'20"

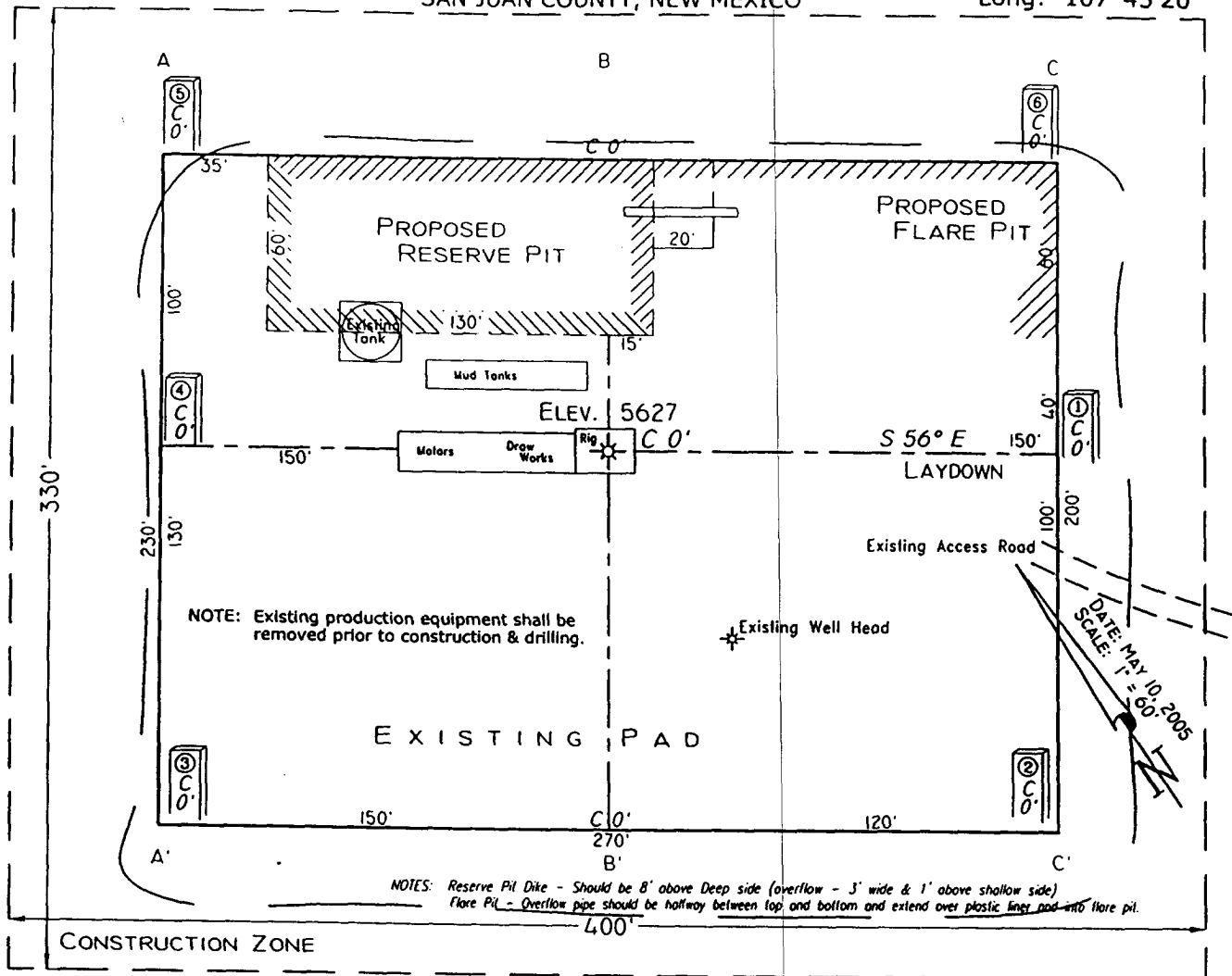

Area of Construction Zone - 330'x400' or 3.03 acres, more or less.

SCALE: 1"=60'-HORIZ.
1"=40'-VERT.

A-A'		CL					
5640							
5630							
5620							
5610							
B-B'							
5640							
5630							
5620							
5610							
C-C'							
5640							
5630							
5620							
5610							

NOTE: Contractor should call One-Call for location of any marked or unmarked buried pipelines or cables. well pad and/or access road at least two (2) working days prior to construction.

Cuts and fills shown are approximate - final finish elevation is to be adjusted. earthwork will balance. Corners are approximate and do not include additional areas needed for sideslopes and drainage. Final Pad Dimensions are to be verified by Contractor.

VANN SURVEY
 P. O. Box 130
 Farmington, NM