

District I
1625 N. French Dr., Hobbs, NM 88240
District II
1301 W. Grand Avenue, Artesia, NM 88210
District III
1000 Rio Brazos Road, Aztec, NM 87410
District IV
1220 S. St. Francis Dr., Santa Fe, NM 87505

State of New Mexico
Energy Minerals and Natural Resources

Form C-101
May 27, 2004

Oil Conservation Division
1220 South St. Francis Dr.
Santa Fe, NM 87505

Submit to appropriate District Office

☐ AMENDED REPORT

APPLICATION FOR PERMIT TO DRILL, RE-ENTER, DEEPEN, PLUGBACK, OR ADD A ZONE

¹ Operator Name and Address Holcomb Oil and Gas, Inc. P. O. Box 2058, Farmington, NM 87499-2058		² OGRID Number 10605
		³ API Number 30-045-23550
⁴ Property Code	⁵ Property Name State Gas Com BS	⁶ Well No. No. 1
⁹ Proposed Pool 1 Fruitland Coal		¹⁰ Proposed Pool 2

⁷ Surface Location

UL or lot no.	Section	Township	Range	Lot Idn	Feet from the	North/South line	Feet from the	East/West line	County
K	23	29N	11W		1450	South	1755	West	San Juan

⁸ Proposed Bottom Hole Location If Different From Surface

UL or lot no.	Section	Township	Range	Lot Idn	Feet from the	North/South line	Feet from the	East/West line	County

Additional Well Information

¹¹ Work Type Code P	¹² Well Type Code G	¹³ Cable/Rotary	¹⁴ Lease Type Code S	¹⁵ Ground Level Elevation 5433'
¹⁶ Multiple No	¹⁷ Proposed Depth 2550'	¹⁸ Formation Fruitland Coal	¹⁹ Contractor Key	²⁰ Spud Date August 2005
Depth to Groundwater 520'		Distance from nearest fresh water well 7200 S 1000'		Distance from nearest surface water 5200'
Pit: Liner: Synthetic <input type="checkbox"/> _____ mils thick Clay <input type="checkbox"/> Pit Volume: _____ bbls Drilling Method: Closed-Loop System <input type="checkbox"/> Fresh Water <input type="checkbox"/> Brine <input type="checkbox"/> Diesel/Oil-based <input type="checkbox"/> Gas/Air <input type="checkbox"/>				

²¹ Proposed Casing and Cement Program

Hole Size	Casing Size	Casing weight/foot	Setting Depth	Sacks of Cement	Estimated TOC
12 1/2	8 5/8	24#	300'	300 sks	surface
7 7/8	4 1/2	10.5	2954'	810 sks	surface

²² Describe the proposed program. If this application is to DEEPEN or PLUG BACK, give the data on the present productive zone and proposed new productive zone. Describe the blowout prevention program, if any. Use additional sheets if necessary.

Abandon Chacra zones at 2746' - 2752'; 2754' - 2761' and set cement retainer at 2600'.
Squeeze with 35 sks Class B cement leave 50' cement on top of retainer at 2550'.
Recomplete to the Fruitland Coal perms 1635' - 1650'; 1580' - 1592'; 1520' - 1528';
1490' - 1505'; 1470' - 1482' @ 2 JSPF.

²³ I hereby certify that the information given above is true and complete to the best of my knowledge and belief. I further certify that the drilling pit will be constructed according to NMOCD guidelines ☒ a general permit ☐, or an (attached) alternative OCD-approved plan ☐.

Printed name: W. J. Holcomb

Title: President

E-mail Address: holcomb@digii.net

Date: 08/25/05

Phone: (505) 326-0550

OIL CONSERVATION DIVISION

Approved by:

Title: DEPUTY OIL & GAS INSPECTOR, DIST. 3

Approval Date: AUG 25 2005 Expiration Date:

Conditions of Approval Attached ☐

No below grade pits
or tanks

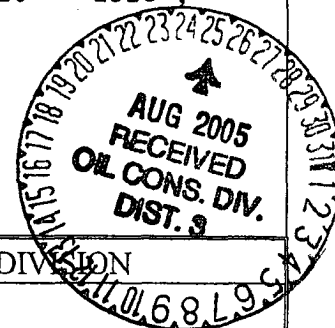

District I
1625 N. Fretich Dr., Hobbs, NM 88240
District II
1301 W. Grand Avenue, Artesia, NM 88210
District III
1000 Rio Brazos Rd., Aztec, NM 87410
District IV
1220 S. St. Francis Dr., Santa Fe, NM 87505

State of New Mexico
Energy, Minerals & Natural Resources Department
OIL CONSERVATION DIVISION
1220 South St. Francis Dr.
Santa Fe, NM 87505

Form C-102
Revised June 10, 2003
Submit to Appropriate District Office
State Lease - 4 Copies
Fee Lease - 3 Copies

☐ AMENDED REPORT

WELL LOCATION AND ACREAGE DEDICATION PLAT

¹ API Number 30-045-23550	² Pool Code	³ Pool Name Fruitland Coal
⁴ Property Code State Gas Com BS	⁵ Property Name	⁶ Well Number No. 1
⁷ OGRID No. 10605	⁸ Operator Name Holcomb Oil and Gas, Inc.	⁹ Elevation 5433'

¹⁰ Surface Location

UL or lot no. K	Section 23	Township 29N	Range 11W	Lot Idn	Feet from the 1450	North/South line South	Feet from the 1755	East/West line West	County San Juan
--------------------	---------------	-----------------	--------------	---------	-----------------------	---------------------------	-----------------------	------------------------	--------------------

¹¹ Bottom Hole Location If Different From Surface

UL or lot no.	Section	Township	Range	Lot Idn	Feet from the	North/South line	Feet from the	East/West line	County
---------------	---------	----------	-------	---------	---------------	------------------	---------------	----------------	--------

¹² Dedicated Acres 320	¹³ Joint or Infill Y	¹⁴ Consolidation Code U	¹⁵ Order No.
--------------------------------------	------------------------------------	---------------------------------------	-------------------------

NO ALLOWABLE WILL BE ASSIGNED TO THIS COMPLETION UNTIL ALL INTERESTS HAVE BEEN CONSOLIDATED OR A NON-STANDARD UNIT HAS BEEN APPROVED BY THE DIVISION

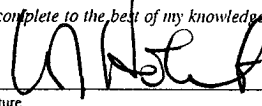
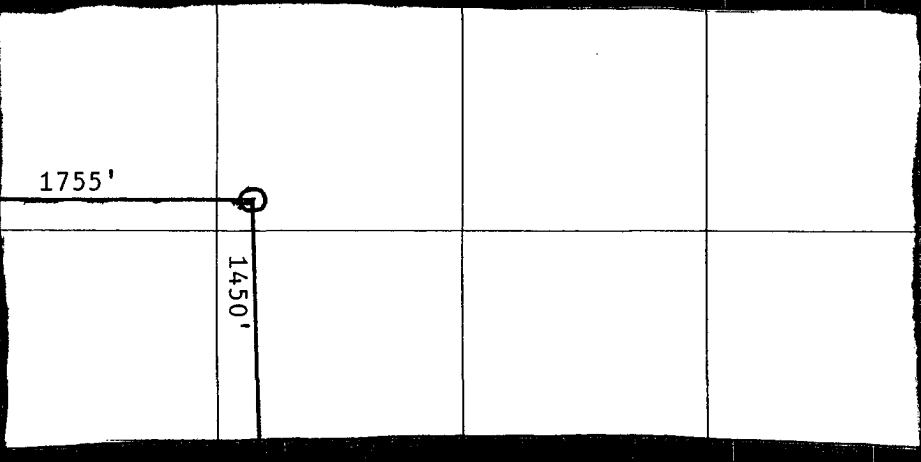
¹⁶ 	¹⁷ OPERATOR CERTIFICATION I hereby certify that the information contained herein is true and complete to the best of my knowledge and belief.  Signature W. J. Holcomb Printed Name President Title and E-mail Address Aug 24 2005 Date
	¹⁸ SURVEYOR CERTIFICATION I hereby certify that the well location shown on this plat was plotted from field notes of actual surveys made by me or under my supervision, and that the same is true and correct to the best of my belief. Date of Survey Signature and Seal of Professional Surveyor: Certificate Number

All distances must be from the outer boundaries of the Section.

Operator AMOCO PRODUCTION COMPANY			Lease STATE GAS COM "BS"		Well No. 1
Unit Letter K	Section 23	Township 29N	Range 11W	County San Juan	
Actual Footage Location of Well: 1450 feet from the South line and 1755 feet from the West line					
Ground Level Elev. 5433	Producing Formation Chacra		Pool Bloomfield Chacra ext		Dedicated Acreage 160 Acres

1. Outline the acreage dedicated to the subject well by colored pencil or hatchure marks on the plat below.
2. If more than one lease is dedicated to the well, outline each and identify the ownership thereof (both as to working interest and royalty).
3. If more than one lease of different ownership is dedicated to the well, have the interests of all owners been consolidated by communitization, unitization, force-pooling, etc?

☐ Yes ☐ No If answer is "yes," type of consolidation _____

If answer is "no," list the owners and tract descriptions which have actually been consolidated. (Use reverse side of this form if necessary.) _____

No allowable will be assigned to the well until all interests have been consolidated (by communitization, unitization, forced-pooling, or otherwise) or until a non-standard unit, eliminating such interests, has been approved by the Commission.

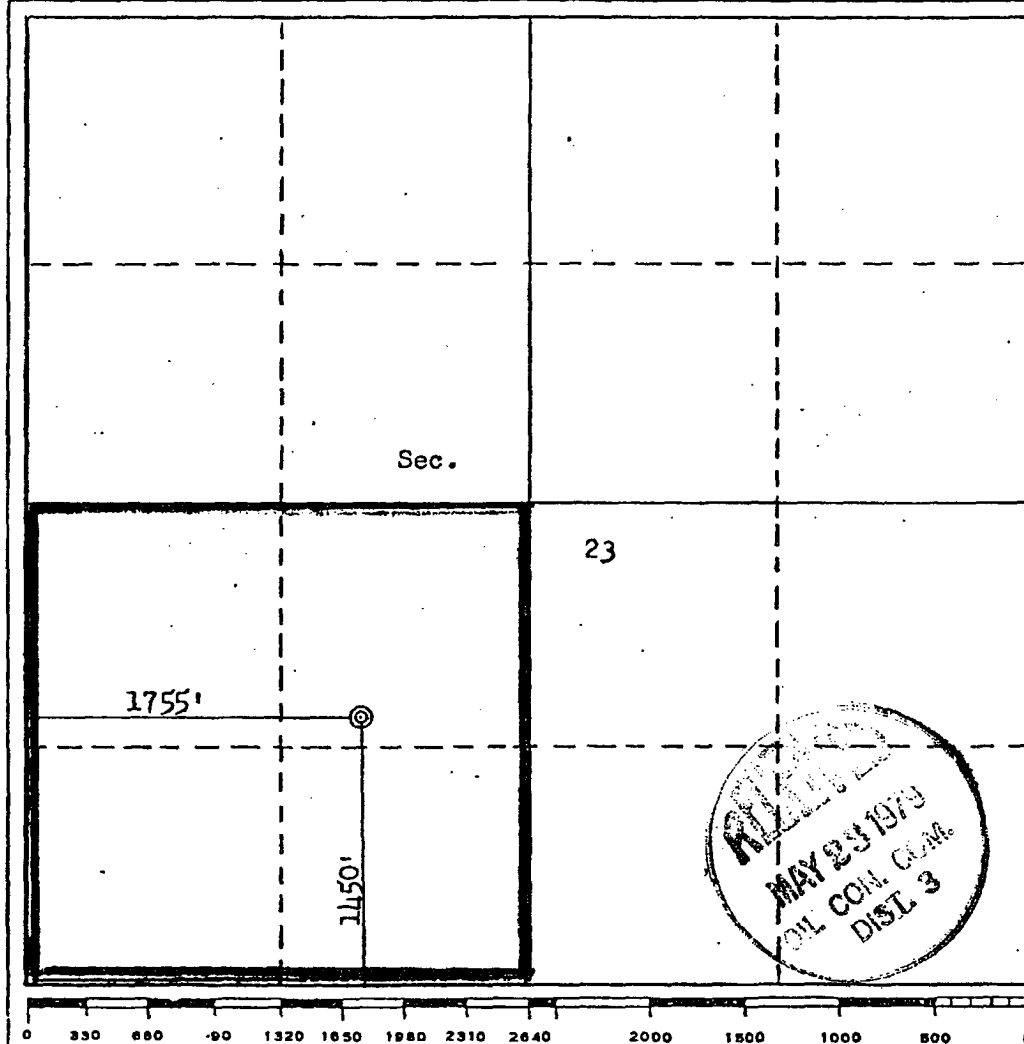

CERTIFICATION

I hereby certify that the information contained herein is true and complete to the best of my knowledge and belief.

B. E. Fackrell

Name
B. E. FACKRELL

Position
DISTRICT ENGINEER

Company
AMOCO PRODUCTION COMPANY

Date
MAY 2, 1979

I hereby certify that the well location shown on this plat was plotted from field notes of actual surveys made by me or under my supervision, and that the same is true and correct to the best of my knowledge and belief.

Date Surveyed
MAY 23 1979

Registered Professional Engineer and/or Land Surveyor
Fred B. Kerr Jr.

Certificate No. **3950**

F. B. KERR, JR.