

District I
1625 N. French Dr., Hobbs, NM 88240
District II
1301 W. Grand Avenue, Artesia, NM 88210
District III
1000 Rio Brazos Road, Aztec, NM 87410
District IV
1220 S. St. Francis Dr., Santa Fe, NM 87505

State of New Mexico
Energy Minerals and Natural Resources

Form C-144
June 1, 2004

Oil Conservation Division
1220 South St. Francis Dr.
Santa Fe, NM 87505

For drilling and production facilities, submit to
appropriate NMOCD District Office.
For downstream facilities, submit to Santa Fe
office

Pit or Below-Grade Tank Registration or Closure

Is pit or below-grade tank covered by a "general plan"? Yes ☒ No ☐

Type of action: Registration of a pit or below-grade tank ☐ Closure of a pit or below-grade tank ☒

Operator: Pure Resources Telephone: 970-259-1374 e-mail address: _____
Address: 463 Turner Drive, Durango CO 81303 Facility or well name: Rincon 240 API #: 300 3924482 U/L K 1500 FSL/ 1750 FWL Sec 21 T 27N R 6W
County: Rio Arriba Latitude _____ Longitude _____ NAD: 1927 ☐ 1983 ☐
Surface Owner: Federal ☒ State ☐ Private ☐ Indian ☐

Pit

Type: Drilling ☐ Production ☒ Disposal ☐
Workover ☐ Emergency ☐
Lined ☐ Unlined ☒
Liner type: Synthetic ☐ Thickness _____ mil Clay ☐
Pit Volume _____ bbl

Below-grade tank

Volume: _____ bbl Type of fluid: _____
Construction material: _____
Double-walled, with leak detection? Yes ☐ If not, explain why not. _____

Depth to ground water (vertical distance from bottom of pit to seasonal high water elevation of ground water.)

| | |
|---|---------------|
| Less than 50 feet | (20 points) |
| 50 feet or more, but less than 100 feet | (10 points) |
| 100 feet or more X | (0 points) X |

Wellhead protection area: (Less than 200 feet from a private domestic water source, or less than 1000 feet from all other water sources.)

| | |
|------|---------------|
| Yes | (20 points) |
| No X | (0 points) X |

Distance to surface water: (horizontal distance to all wetlands, playas, irrigation canals, ditches, and perennial and ephemeral watercourses.)

| | |
|---|---------------|
| Less than 200 feet | (20 points) |
| 200 feet or more, but less than 1000 feet | (10 points) |
| 1000 feet or more X | (0 points) X |

Ranking Score (Total Points)

0

- If this is a pit closure:** (1) Attach a diagram of the facility showing the pit's relationship to other equipment and tanks. (2) Indicate disposal location: (check the onsite box if you are burying in place) onsite ☒ offsite ☐ If offsite, name of facility: (3) Attach a general description of remedial action taken including remediation start date and end date. (4) Groundwater encountered: No ☒ Yes ☐ If yes, show depth below ground surface _____ ft. and attach sample results. (5) Attach soil sample results and a diagram of sample locations and excavations.

Additional Comments: Decommissioned Separator Pit. Separator was removed.

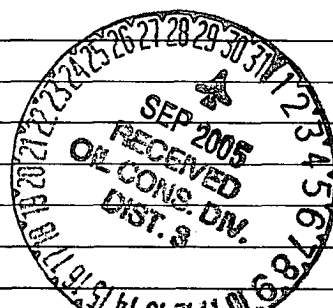

I hereby certify that the information above is true and complete to the best of my knowledge and belief. I further certify that the above-described pit or below-grade tank has been/will be constructed or closed according to NMOCD guidelines ☒, a general permit ☐, or an (attached) alternative OCD-approved plan ☐.

Date: 9/27/05

Printed Name/Title John Hagstrom as Agent for Pure Resources

Signature [Signature]

Your certification and NMOCD approval of this application/closure does not relieve the operator of liability should the contents of the pit or tank contaminate ground water or otherwise endanger public health or the environment. Nor does it relieve the operator of its responsibility for compliance with any other federal, state, or local laws and/or regulations.

Approval:

Printed Name/Title DEPUTY OIL & GAS INSPECTOR, DIST. 8

Signature [Signature]

Date: SEP 30 2005



June 22, 2005

SMA Project: 5115310

RE: Sampling activities for Pit Closure at the Rincon 240. Unit K, Sec. 21, T 27N, R 6W, Fruitland Coal, Rio Arriba County NM. Fed Lease SF079366. API 3003924482.

On May 27, 2005, SMA mobilized to the unlined separator pit at the Rincon 240. The dimensions of the unlined pit are approximately 18 X 18 X 4 feet.

On May 27, 2005, SMA collected a soil sample from the center pit bottom for field analysis by Photo Ionization Detector (PID). A four-point composite soil sample was collected from the sidewalls for field analysis by PID. The center pit bottom sample showed a PID reading of 356 units and the sidewall composite sample showed a PID reading of 0 units. Soil samples for closure were collected for laboratory analysis. Samples were analyzed for Diesel Range Organics (DRO), and Gasoline Range Organics (GRO). Based on Field Screening with a PID, BTEX was analyzed by laboratory methods. The laboratory analysis of the closure samples showed hydrocarbon levels of:

| May 27, 2005 | PID Units | DRO ppm | GRO ppm | Benzene | Total BTEX ppm |
|-------------------|-----------|---------|---------|---------|----------------|
| 4 Point Sidewall | 0 | BDL | 1.3 | NA | NA |
| Center Pit Bottom | 356 | 846 | 117 | BDL | 2.01 |

BDL: Below Detection Limits

NA: Not Analyzed

No remedial excavation is needed based on laboratory analysis of soil samples. On behalf of our client, Pure Resources, SMA requests closure for this pit. Groundwater was not encountered.

Respectfully submitted,



John Hagstrom
Environmental Technician
Souder, Miller and Associates



NTS

LEGEND



Wellhead

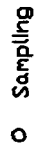

Sampling Point

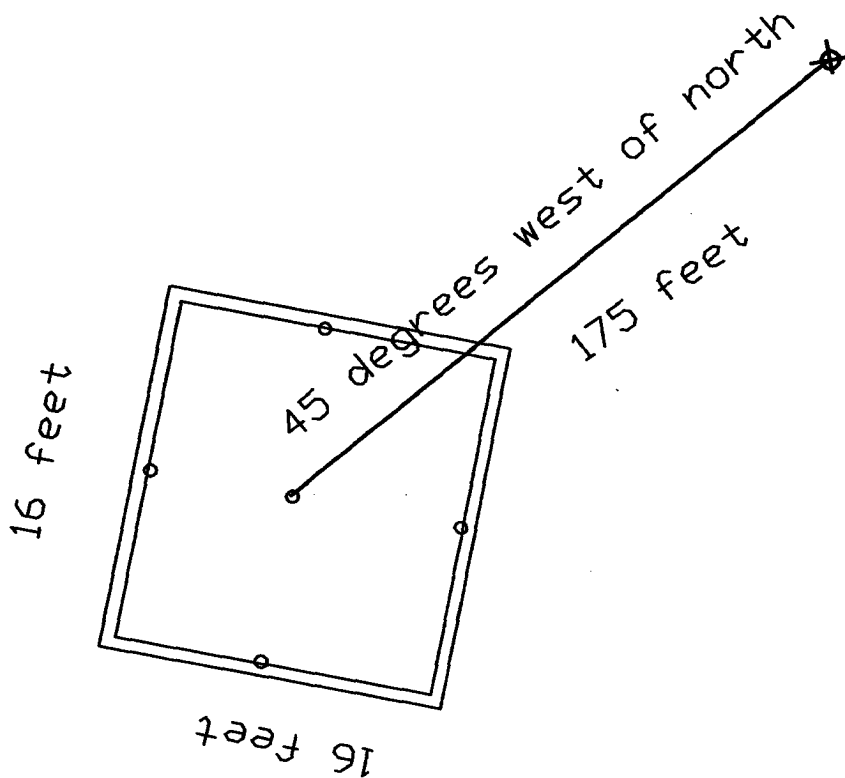

612 E. MURRAY DR. PH. (505) 325-5667
FARMINGTON, NM 87401 FAX (505) 327-1496

APPROVED:

DRAWN BY: JPH

CHK'D BY:

PROJECT NO: 5115310

DATE:

DATE: 9/22/05

DATE:

SHEET: 1 OF 1

Rincon 240
1500 FSL, 1750 FWL, S21, T27N, R6W
API 3003924482
Rio Arriba County, NM

612 E. Murray Drive
Farmington, NM 87499

Off: (505) 327-1072

FAX: (505) 327-1496

ANALYTICAL REPORT

iiná bá

P.O. Box 3788
Shiprock, NM 87420

Off: (505) 368-4065

Date: 14-Jun-05

CLIENT: Souder, Miller & Associates
Work Order: 0505056
Project: Pure Resources Rincon 240/5115310
Lab ID: 0505056-001A

Client Sample Info: Pure Resources
Client Sample ID: Rincon 240 SW
Collection Date: 5/27/2005 11:15:00 AM
Matrix: SOIL

| Parameter | Result | PQL | Qual | Units | DF | Date Analyzed |
|--------------------------------|--------|----------------|------|--------------|----|---------------|
| DIESEL RANGE ORGANICS | | SW8015B | | Analyst: JEM | | |
| T/R Hydrocarbons: C10-C28 | ND | 25.0 | | mg/Kg | 1 | 6/7/2005 |
| Surr: o-Terphenyl | 89.7 | 57-136 | | %REC | 1 | 6/7/2005 |
| GASOLINE RANGE ORGANICS | | SW8015B | | Analyst: JEM | | |
| T/R Hydrocarbons: C6-C10 | 1.3 | 4.50 | J | mg/Kg | 25 | 6/7/2005 |
| Surr: Trifluorotoluene | 92.4 | 84-149 | | %REC | 25 | 6/7/2005 |

Qualifiers:

ND - Not Detected at the Practical Quantitation Limit

J - Analyte detected below Practical Quantitation Limit

B - Analyte detected in the associated Method Blank

H - Parameter exceeded Maximum Allowable Holding Time

S - Spike Recovery outside accepted recovery limits

R - RPD outside accepted precision limits

E - Value above Upper Quantitation Limit - UQL

612 E. Murray Drive
Farmington, NM 87499

Off: (505) 327-1072
FAX: (505) 327-1496

ANALYTICAL REPORT

iiná bá

P.O. Box 3788
Shiprock, NM 87420

Off: (505) 368-4065

Date: 14-Jun-05

CLIENT: Souder, Miller & Associates
Work Order: 0505056
Project: Pure Resources Rincon 240/5115310
Lab ID: 0505056-002A

Client Sample Info: Pure Resources
Client Sample ID: Rincon 240 CP
Collection Date: 5/27/2005 11:17:00 AM
Matrix: SOIL

| Parameter | Result | PQL | Qual | Units | DF | Date Analyzed |
|-------------------------------------|--------|----------------|------|--------------|-----|---------------|
| DIESEL RANGE ORGANICS | | SW8015B | | Analyst: JEM | | |
| T/R Hydrocarbons: C10-C28 | 846 | 25.0 | | mg/Kg | 1 | 6/7/2005 |
| Surr: o-Terphenyl | 89.0 | 57-136 | | %REC | 1 | 6/7/2005 |
| GASOLINE RANGE ORGANICS | | SW8015B | | Analyst: JEM | | |
| T/R Hydrocarbons: C6-C10 | 117 | 18.0 | | mg/Kg | 100 | 6/7/2005 |
| Surr: Trifluorotoluene | 88.5 | 84-149 | | %REC | 100 | 6/7/2005 |
| AROMATIC VOLATILES BY GC/PID | | SW8021B | | Analyst: JEM | | |
| Benzene | ND | 25.0 | | µg/Kg | 25 | 6/8/2005 |
| Ethylbenzene | 130 | 25.0 | | µg/Kg | 25 | 6/8/2005 |
| m,p-Xylene | 1050 | 50.0 | | µg/Kg | 25 | 6/8/2005 |
| o-Xylene | 830 | 25.0 | | µg/Kg | 25 | 6/8/2005 |
| Toluene | ND | 50.0 | | µg/Kg | 25 | 6/8/2005 |
| Surr: 1,4-Difluorobenzene | 91.6 | 75-110 | | %REC | 25 | 6/8/2005 |
| Surr: 4-Bromochlorobenzene | 110 | 40-135 | | %REC | 25 | 6/8/2005 |
| Surr: Fluorobenzene | 81.1 | 69-110 | | %REC | 25 | 6/8/2005 |

Qualifiers: ND - Not Detected at the Practical Quantitation Limit
J - Analyte detected below Practical Quantitation Limit
B - Analyte detected in the associated Method Blank
H - Parameter exceeded Maximum Allowable Holding Time

S - Spike Recovery outside accepted recovery limits
R - RPD outside accepted precision limits
E - Value above Upper Quantitation Limit - UQL

Page 2 of 2