

District I
1625 N. French Dr., Hobbs, NM 88240
District II
1301 W. Grand Avenue, Artesia, NM 88210
District III
1000 Rio Brazos Road, Aztec, NM 87410
District IV
1220 S. St. Francis Dr., Santa Fe, NM 87505

State of New Mexico
Energy Minerals and Natural Resources

Oil Conservation Division
1220 South St. Francis Dr.
Santa Fe, NM 87505

Form C-141
Revised August 8, 2011

Submit 1 Copy to appropriate District Office to
accordance with 19.15.29 NMAC.

Release Notification and Corrective Action

OPERATOR

☐ Initial Report ☒ Final Report

Name of Company Burlington Resources, a Wholly Owned	Contact Lisa Hunter
Subsidiary of ConocoPhillips Company	
Address 3401 East 30th St, Farmington, NM	Telephone No. (505) 326-9786
Facility Name: San Juan 29-7 Unit 63	Facility Type: Natural Gas

Surface Owner Federal	Mineral Owner Federal	API No. 3003907668
------------------------------	------------------------------	---------------------------

LOCATION OF RELEASE

Unit Letter H	Section 10	Township 29N	Range 07W	Feet from the 1480	North/South Line North	Feet from the 600'	East/West Line East	County Rio Arriba
-------------------------	----------------------	------------------------	---------------------	------------------------------	----------------------------------	------------------------------	-------------------------------	-----------------------------

Latitude **36.74335** Longitude **-107.55075**

NATURE OF RELEASE

Type of Release Historic Hydrocarbon	Volume of Release Unknown	Volume Recovered 310 cyds
Source of Release Separator	Date and Hour of Occurrence Unknown	Date and Hour of Discovery 01-22-14
Was Immediate Notice Given? <input type="checkbox"/> Yes <input type="checkbox"/> No <input checked="" type="checkbox"/> Not Required	If YES, To Whom?	
By Whom?	Date and Hour	
Was a Watercourse Reached? <input type="checkbox"/> Yes <input checked="" type="checkbox"/> No	If YES, Volume Impacting the Watercourse.	

OIL CONS. DIV DIST. 3

MAY 29 2014

If a Watercourse was Impacted, Describe Fully.*
N/A

Describe Cause of Problem and Remedial Action Taken.*

Historical hydrocarbon impacted soil was found during an environmental assessment/remediation of 1.9 BBL condensate spill.

Describe Area Affected and Cleanup Action Taken.*

Historical hydrocarbon impacted soil was found during an environmental assessment/remediation of 1.9 BBL condensate spill. The excavation was 35' x 20' x 14' in depth and 310 yds of soil was transported to IEI land farm and 310 yds of clean soil was transported from Aztec Machine Company and placed in the excavation site. The soil sampling report is attached for review.

I hereby certify that the information given above is true and complete to the best of my knowledge and understand that pursuant to NMOCD rules and regulations all operators are required to report and/or file certain release notifications and perform corrective actions for releases which may endanger public health or the environment. The acceptance of a C-141 report by the NMOCD marked as "Final Report" does not relieve the operator of liability should their operations have failed to adequately investigate and remediate contamination that pose a threat to ground water, surface water, human health or the environment. In addition, NMOCD acceptance of a C-141 report does not relieve the operator of responsibility for compliance with any other federal, state, or local laws and/or regulations.

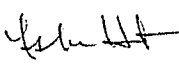
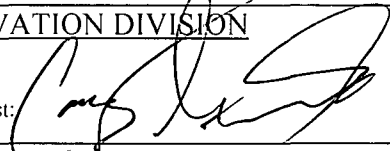
Signature: 	OIL CONSERVATION DIVISION	
Printed Name: Lisa Hunter	Approved by Environmental Specialist: 	
Title: Field Environmental Specialist	Approval Date: 6/12/14	Expiration Date:
E-mail Address: Lisa.Hunter@cop.com	Conditions of Approval:	Attached <input type="checkbox"/>
Date: May 27, 2014 Phone: (505) 326-9786		

* Attach Additional Sheets If Necessary

#NCS 1416351257



Animas Environmental Services, LLC

www.animasesenvironmental.com

624 E. Comanche
Farmington, NM 87401
505-564-2281

Durango, Colorado
970-403-3084

May 2, 2014

Lisa Hunter
ConocoPhillips
San Juan Business Unit
Office 214-04
5525 Hwy 64
Farmington, New Mexico 87401

Via electronic mail to:
SJBUE-Team@ConocoPhillips.com

**RE: Initial Release Assessment and Final Excavation Report
San Juan 29-7 #63
Rio Arriba County, New Mexico**

OIL CONS. DIV DIST. 3

MAY 29 2014

Dear Ms. Hunter:

On January 22 and February 18, 2014, Animas Environmental Services, LLC (AES) completed an initial release assessment and environmental clearance of the final excavation limits at the ConocoPhillips (CoP) San Juan 29-7 #63, located in Rio Arriba County, New Mexico. The release consisted of approximately 1.9 barrels (bbls) of hydrocarbons. The initial release assessment was completed by AES on January 22, 2014, and the final excavation was completed by CoP contractors while AES on location on February 18, 2014.

1.0 Site Information

1.1 Location

Location – SE¼ NE¼, Section 10, T29N, R7W, Rio Arriba County, New Mexico
Well Head Latitude/Longitude – N36.74343 and W107.55140, respectively
Release Location Latitude/Longitude – N36.74309 and W107.55106, respectively
Land Jurisdiction – Private
Figure 1. Topographic Site Location Map
Figure 2. Aerial Site Map, January 2014

1.2 NMOCD Ranking

In accordance with New Mexico Oil Conservation Division (NMOCD) release protocols, action levels were established per NMOCD *Guidelines for Remediation of Leaks, Spills,*

and Releases (August 1993) prior to site work. The release was given a ranking score of 10 based on the following factors:

- **Depth to Groundwater:** A cathodic protection well report form dated May 1991 reported the depth to groundwater at 140 feet below ground surface (bgs). (0 points)
- **Wellhead Protection Area:** The release location is not within a wellhead protection area. (0 points)
- **Distance to Surface Water Body:** Approximately 270 feet to the northeast is an unnamed wash which discharges to the wash in Gobernador Canyon. (10 points)

1.3 Assessment

AES was initially contacted by Lisa Hunter of CoP on January 20, 2014, and on January 22, 2014, Debbie Watson and Emilee Skyles of AES completed the initial release assessment field work. The assessment included collection and field sampling of 17 soil samples from 7 soil borings in and around the release area. Based on the field sampling results, AES recommended further excavation of the release area. Sample locations are shown on Figure 3.

On February 18, 2014, AES returned to the location to collect confirmation soil samples of the recommended excavation area. The field sampling activities included collection of five confirmation soil samples from each wall and the base of the excavation. The area of the final excavation measured approximately 23 feet by 18.5 feet by 14 feet in depth. Sample locations and final excavation area are presented on Figure 4.

2.0 Soil Sampling

A total of 17 soil samples from 7 borings (SB-1 through SB-7) as well as 5 composite samples (SC-1 through SC-5) were collected during the assessments. All soil samples were field screened for volatile organic compounds (VOCs), and selected samples were also analyzed for total petroleum hydrocarbons (TPH). One composite sample (SC-1) collected during the excavation clearance was submitted for confirmation laboratory analysis.

2.1 Field Sampling

2.1.1 Volatile Organic Compounds

Field screening for VOC vapors was conducted with a photo-ionization detector (PID) organic vapor meter (OVM). Before beginning field screening, the PID-OVM was first calibrated with 100 parts per million (ppm) isobutylene gas.

2.1.2 Total Petroleum Hydrocarbons

Field TPH samples were analyzed per U.S. Environmental Protection Agency (USEPA) Method 418.1 using a Buck Scientific Model HC-404 Total Hydrocarbon Analyzer Infrared Spectrometer (Buck). A 3-point calibration was completed prior to conducting soil analyses. Field analytical protocol followed AES's *Standard Operating Procedure: Field Analysis Total Petroleum Hydrocarbons per EPA Method 418.1*.

2.2 Laboratory Analyses

The soil sample collected for laboratory analysis was placed into a new, clean, laboratory-supplied container, which was then labeled, placed on ice, and logged onto a sample chain of custody record. The sample was maintained on ice until delivery to the analytical laboratory, Hall Environmental Analysis Laboratory (Hall) in Albuquerque, New Mexico. Sample SC-1 was laboratory analyzed for:

- Benzene, toluene, ethylbenzene, and xylene (BTEX) per USEPA Method 8021B.

2.3 Field and Laboratory Analytical Results

On January 22, 2014, initial assessment field screening results for VOCs via OVM showed concentrations ranging from 15.5 ppm in SB-6 up to 2,838 ppm in SB-4. Field TPH concentrations ranged from 20.5 mg/kg in SB-4 up to 13,100 mg/kg in SB-2.

On February 18, 2014, final excavation field screening results for VOCs via OVM ranged from 1.0 ppm in SC-5 up to 404 ppm in SC-1. Field TPH concentrations ranged from 36.6 mg/kg in SC-2 up to 65.2 mg/kg in SC-5. Results are included below in Table 1 and on Figures 3 and 4. The AES Field Sampling Reports are attached.

Table 1. Field Sampling VOCs and TPH Results
San Juan 29-7 #63 Initial Release Assessment and Final Excavation
January and February 2014

<i>Sample ID</i>	<i>Date Sampled</i>	<i>Sample Depth (ft bgs)</i>	<i>VOCs via OVM (ppm)</i>	<i>TPH 418.1 (mg/kg)</i>
<i>NMOCD Action Level*</i>			100	1,000
SB-1	1/22/14	1	119	39.1
SB-2	1/22/14	7	1,671	NA
		8.5	1,776	13,100
		11	1,971	>2500
SB-3	1/22/14	0.5	2,355	NA
		2	1,065	NA
		5	178	NA
		8	63.8	65.6
		12	83.5	33.8
		Surface	2,838	NA
SB-4	1/22/14	4	315	NA
		6	312	20.5
SB-5	1/22/14	4	26.4	36.4
SB-6	1/22/14	1.5	15.5	NA
		4	43.1	211
		7	42.0	NA
SB-7	1/22/14	Surface	362	169
SC-1	2/18/14	1 to 14	404	53.5
SC-2	2/18/14	1 to 14	7.5	36.6
SC-3	2/18/14	1 to 14	36.6	57.4
SC-4	2/18/14	1 to 14	24.2	61.3
SC-5	2/18/14	14	1.0	65.2

NA – not analyzed

*Action level determined by the NMOCD ranking score per *NMOCD Guidelines for Remediation of Leaks, Spills, and Releases* (August 1993)

Laboratory analyses for SC-1 were used to confirm field sampling results from the final excavation. Benzene and total BTEX concentrations were reported as less than 0.039 mg/kg and 0.60 mg/kg, respectively. Results are presented in Table 2 and on Figure 4. The laboratory analytical report is attached.

Table 2. Laboratory Analytical Results – Benzene and Total BTEX
San Juan 29-7 #63 Initial Release Assessment and Final Excavation
January and February 2014

Sample ID	Date Sampled	Sample	Benzene (mg/kg)	Total	GRO (mg/kg)	DRO (mg/kg)
		Depth (ft bgs)		BTEX (mg/kg)		
NMOCD Action Level*			10	50	1,000	
SC-1	2/18/14	1 to 14	<0.039	0.60	NA	NA

NA – not analyzed

*Action level determined by the NMOCD ranking score per *NMOCD Guidelines for Remediation of Leaks, Spills, and Releases* (August 1993)

3.0 Conclusions and Recommendations

On January 22, 2014, AES conducted an initial assessment of petroleum contaminated soils associated with an approximately 1.9 bbl release at the San Juan 29-7 #63. Action levels for releases are determined by the NMOCD ranking score per *NMOCD Guidelines for Remediation of Leaks, Spills, and Releases* (August 1993), and the site was assigned a rank of 10.

Initial assessment field screening results above the NMOCD action level of 100 ppm VOCs and 1,000 mg/kg TPH were reported in SB-1, SB-2, SB-3, SB-4, and SB-7. The highest VOC concentration was reported in SB-4 with 2,838 ppm, and the highest TPH concentration was reported in SB-2 with 13,100 mg/kg.

On February 18, 2014, final clearance of the excavation area was completed. Field screening results of the excavation extents showed that VOC concentrations were below applicable NMOCD action levels for the final walls and base of the excavation, except for SC-1 (north wall) which had a VOC concentration of 404 ppm. Field TPH concentrations were below the applicable NMOCD action level of 1,000 mg/kg for the final walls and base of the excavation. Laboratory analytical results from February 18, 2014, reported benzene and total BTEX concentrations in SC-1 below NMOCD action levels of 10 mg/kg and 50 mg/kg, respectively.

Based on final field and laboratory analytical results of the excavation of petroleum contaminated soils at the San Juan 29-7 #63, VOCs, benzene, total BTEX, and TPH concentrations were below applicable NMOCD action levels for each of the sidewalls and base of the excavation. No further work is recommended.

If you have any questions about this report or site conditions, please do not hesitate to contact Deborah Watson at (505) 564-2281.

Sincerely,



Emilee Skyles
Staff Geologist

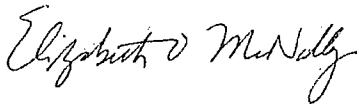

Elizabeth McNally, PE

Attachments:

- Figure 1. Topographic Site Location Map
- Figure 2. Aerial Site Map, January 2014
- Figure 3. Initial Assessment Sample Locations and Results, January 2014
- Figure 4. Final Excavation Sample Locations and Results, February 2014
- AES Field Sampling Report 012214
- AES Field Sampling Report 021814
- Hall Laboratory Analytical Report 1402689

\\SVRMAIN2\Shared\Animas 2000\Dropbox (Animas Environmental)\0000 Animas Server Dropbox
EM\2014 Projects\ConocoPhillips\SJ 29-7 #63\San Juan 29-7 #63 Release and Final Excavation Report
050214.docx

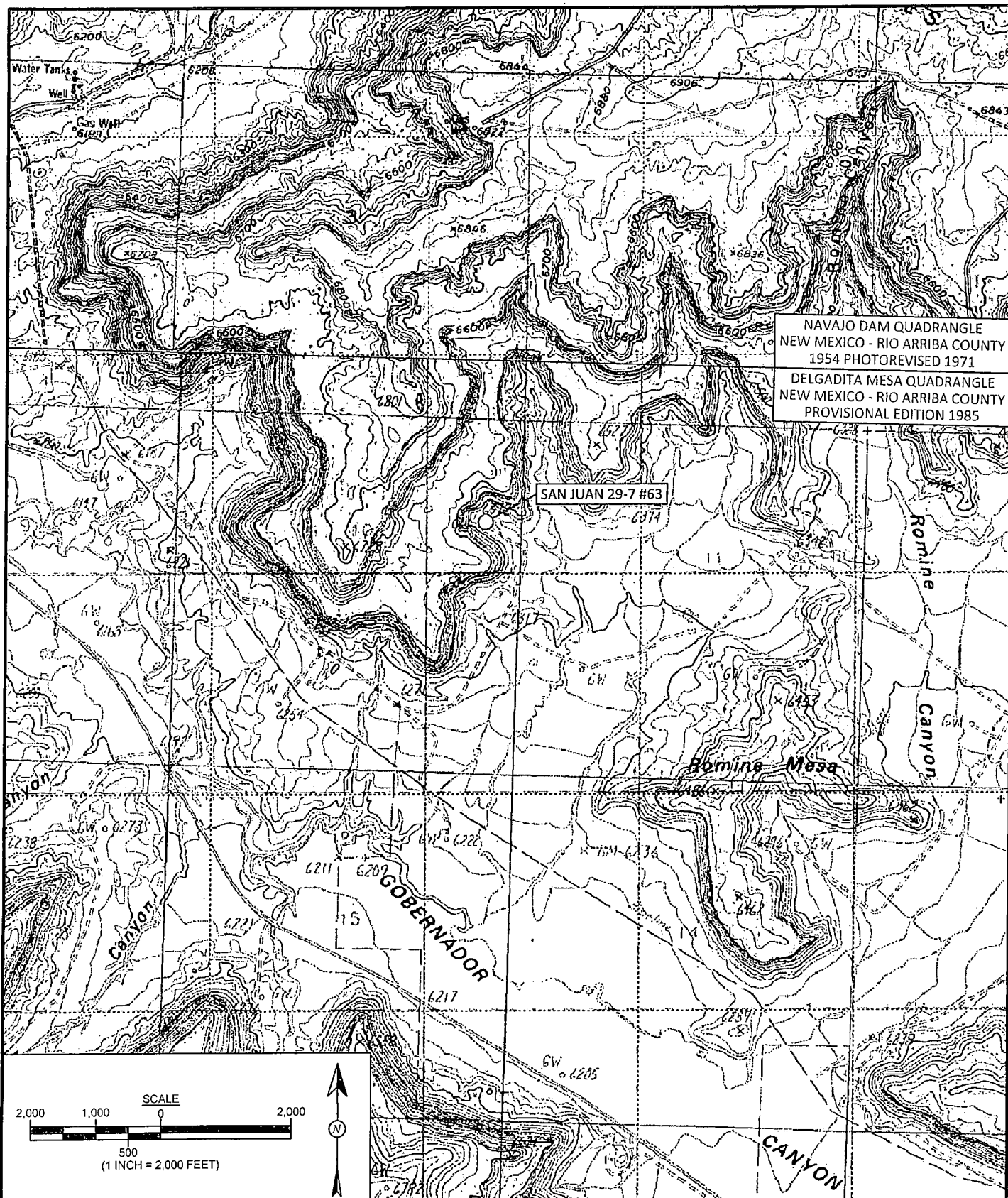

Animas Environmental Services, LLC

DRAWN BY: S. Glasses	DATE DRAWN: January 23, 2014
REVISIONS BY: C. Lameman	DATE REVISED: April 23, 2014
CHECKED BY: D. Watson	DATE CHECKED: April 23, 2014
APPROVED BY: E. McNally	DATE APPROVED: April 23, 2014

FIGURE 1

TOPOGRAPHIC SITE LOCATION MAP

ConocoPhillips
SAN JUAN 29-7 #63
SE¼ NE¼, SECTION 10, T29N, R7W
RIO ARRIBA COUNTY, NEW MEXICO
N36.74343, W107.55140

LEGEND

===== SECONDARY CONTAINMENT BERM

- x - FENCE

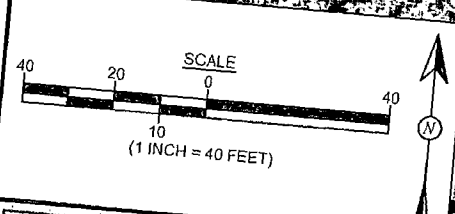
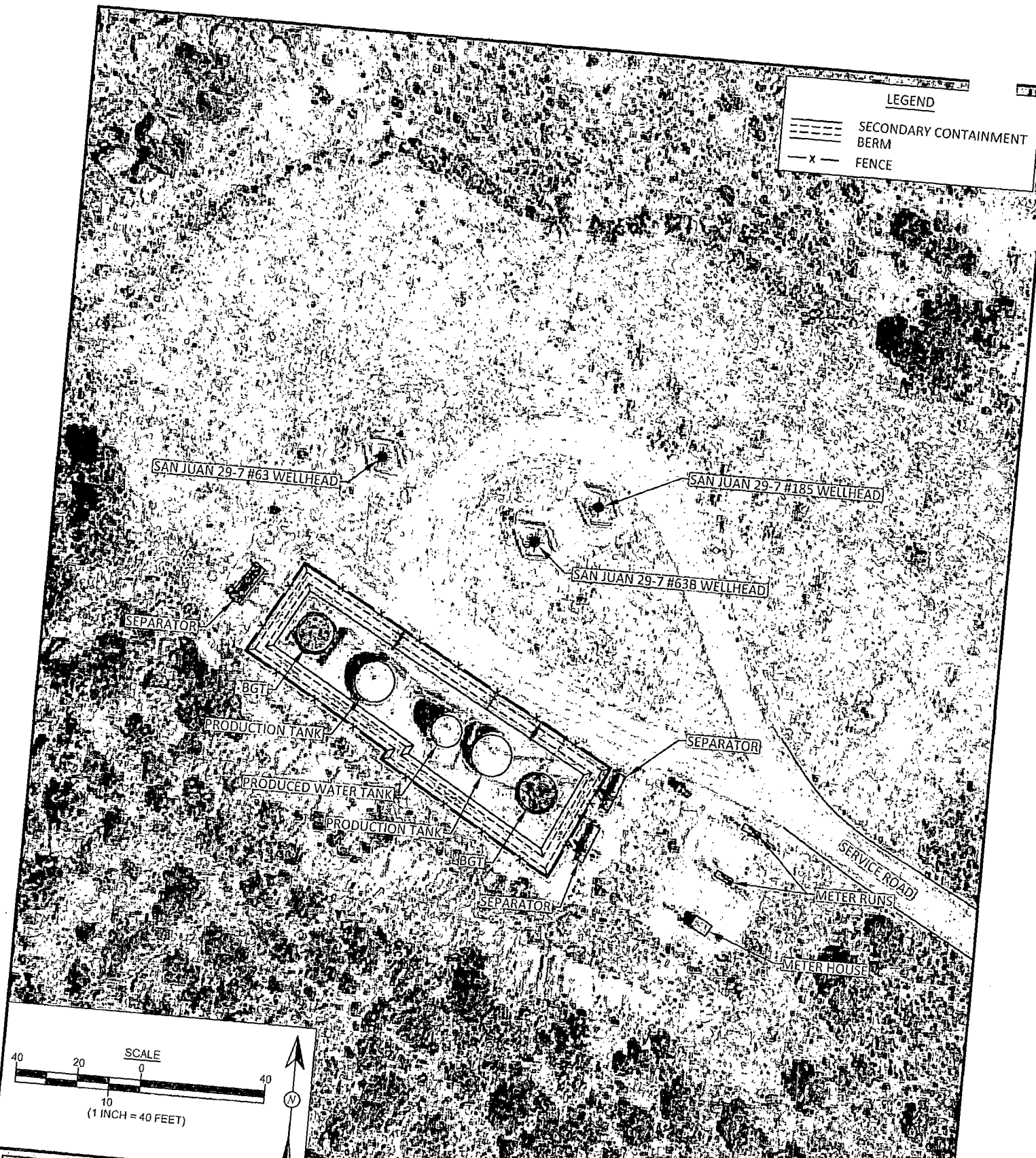

AERIAL SOURCE: © 2013 GOOGLE EARTH, AERIAL DATE: MAY 2, 2013



DRAWN BY: S. Glasses	DATE DRAWN: January 23, 2014
REVISIONS BY: C. Lameman	DATE REVISED: April 23, 2014
CHECKED BY: D. Watson	DATE CHECKED: April 23, 2014
APPROVED BY: E. McNally	DATE APPROVED: April 23, 2014

FIGURE 2

**AERIAL SITE MAP
JANUARY 2014**
ConocoPhillips
SAN JUAN 29-7 #63
SE¼ NE¼, SECTION 10, T29N, R7W
RIO ARriba COUNTY, NEW MEXICO
N36.74343, W107.55140

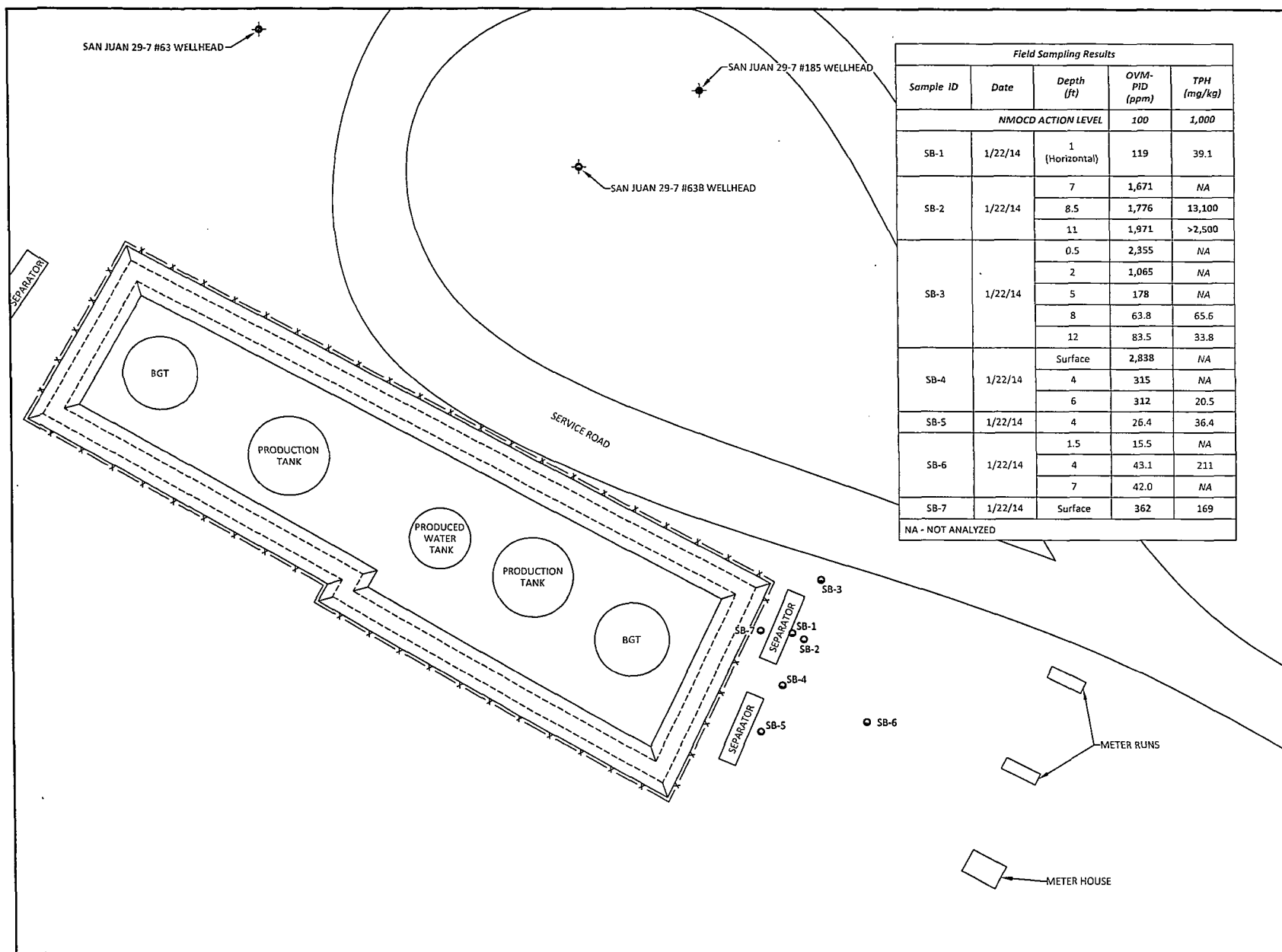

Field Sampling Results				
Sample ID	Date	Depth (ft)	OVM-PID (ppm)	TPH (mg/kg)
NMOCD ACTION LEVEL			100	1,000
SB-1	1/22/14	1 (Horizontal)	119	39.1
SB-2	1/22/14	7	1,671	NA
		8.5	1,776	13,100
		11	1,971	>2,500
SB-3	1/22/14	0.5	2,355	NA
		2	1,065	NA
		5	178	NA
		8	63.8	65.6
		12	83.5	33.8
SB-4	1/22/14	Surface	2,838	NA
		4	315	NA
		6	312	20.5
SB-5	1/22/14	4	26.4	36.4
SB-6	1/22/14	1.5	15.5	NA
		4	43.1	211
		7	42.0	NA
SB-7	1/22/14	Surface	362	169

NA - NOT ANALYZED

FIGURE 3

INITIAL ASSESSMENT SAMPLE LOCATIONS AND RESULTS JANUARY 2014
 ConocoPhillips
 SAN JUAN 29-7 #63
 SE¼ NE¼, SECTION 10, T29N, R7W
 RIO ARriba COUNTY, NEW MEXICO
 N36.74343, W107.55140



Animas Environmental Services, LLC

DRAWN BY: C. Lameman	DATE DRAWN: January 23, 2014
REVISIONS BY: C. Lameman	DATE REVISED: April 23, 2014
CHECKED BY: D. Watson	DATE CHECKED: April 23, 2014
APPROVED BY: E. McNally	DATE APPROVED: April 23, 2014

LEGEND

- SAMPLE LOCATIONS
- ===== SECONDARY CONTAINMENT BERM
- x — FENCE

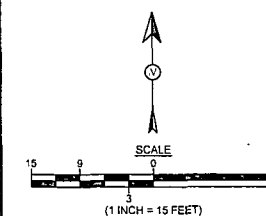

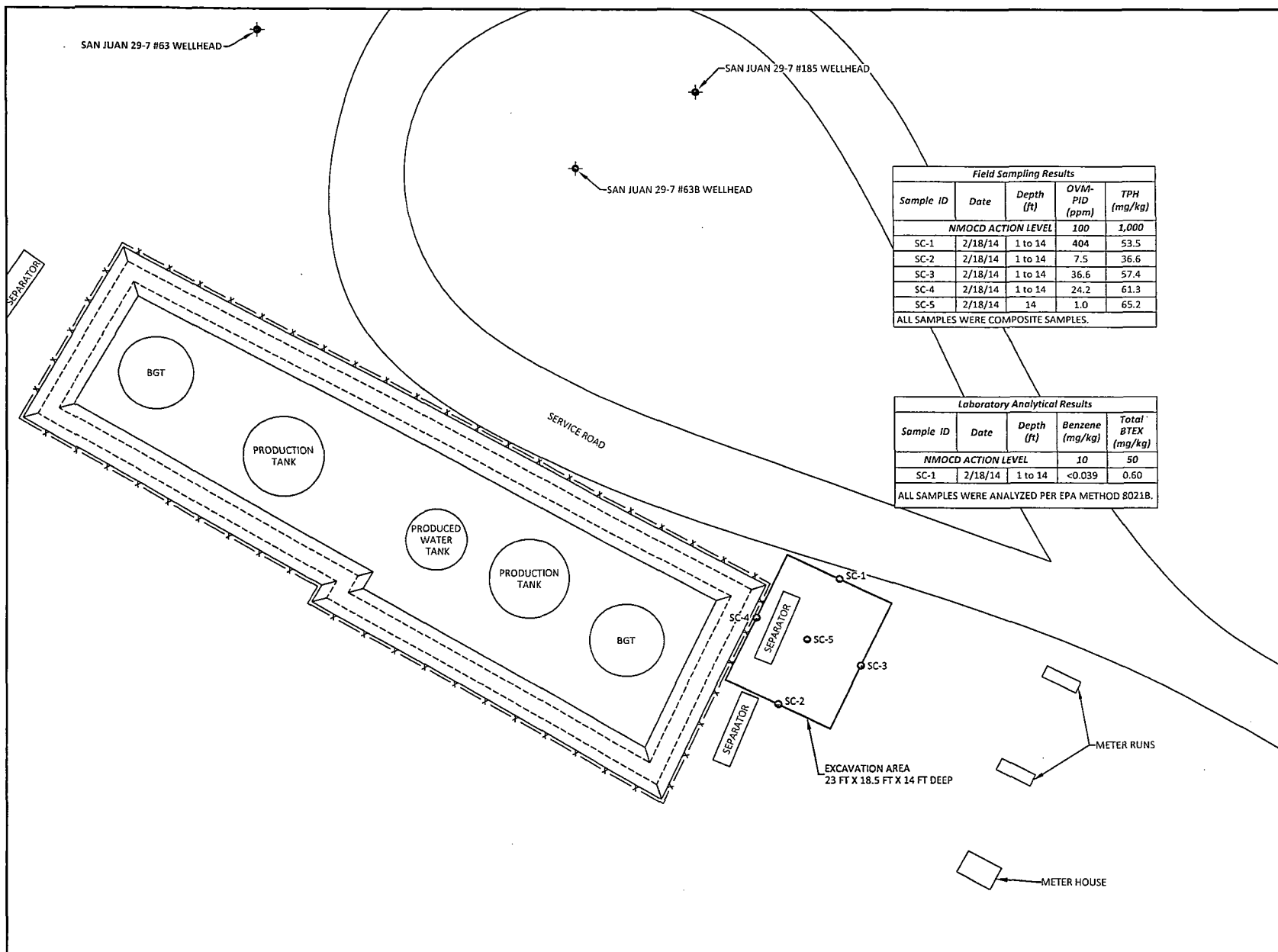

Field Sampling Results				
Sample ID	Date	Depth (ft)	OVM-PID (ppm)	TPH (mg/kg)
			NMOC ACTION LEVEL	100
SC-1	2/18/14	1 to 14	404	53.5
SC-2	2/18/14	1 to 14	7.5	36.6
SC-3	2/18/14	1 to 14	36.6	57.4
SC-4	2/18/14	1 to 14	24.2	61.3
SC-5	2/18/14	14	1.0	65.2

ALL SAMPLES WERE COMPOSITE SAMPLES.

Laboratory Analytical Results				
Sample ID	Date	Depth (ft)	Benzene (mg/kg)	Total BTEX (mg/kg)
			NMOC ACTION LEVEL	10
SC-1	2/18/14	1 to 14	<0.039	0.60

ALL SAMPLES WERE ANALYZED PER EPA METHOD 8021B.

FIGURE 4

FINAL EXCAVATION SAMPLE LOCATIONS AND RESULTS FEBRUARY 2014
 ConocoPhillips
 SAN JUAN 29-7 #63
 SE¼ NE¼, SECTION 10, T29N, R7W
 RIO ARriba COUNTY, NEW MEXICO
 N36.74343, W107.55140



Animas Environmental Services, LLC

DRAWN BY: C. Lameman	DATE DRAWN: February 19, 2014
REVISIONS BY: C. Lameman	DATE REVISED: April 23, 2014
CHECKED BY: D. Watson	DATE CHECKED: April 23, 2014
APPROVED BY: E. McNally	DATE APPROVED: April 23, 2014

LEGEND

- SAMPLE LOCATIONS
- ===== SECONDARY CONTAINMENT BERM
- x — FENCE

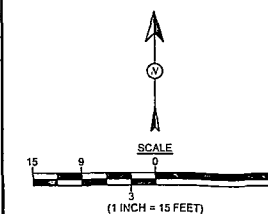

AES Field Sampling Report



Animas Environmental Services, LLC

www.animasenvironmental.com

Client: ConocoPhillips

Project Location: San Juan 29-7 #63

Date: 1/22/2014

Matrix: Soil

624 E. Comanche
Farmington, NM 87401
505-564-2281

Durango, Colorado
970-403-3084

Sample ID	Collection Date	Collection Time	OVM (ppm)	TPH* (mg/kg)	TPH Analysis Time	TPH PQL (mg/kg)	DF	TPH Analysts Initials
SB-1 @ 1'	1/22/2014	13:14	119	39.1	13:37	20.0	1	DAW
SB-2 @ 7'	1/22/2014	13:25	1,671	Not Analyzed for TPH				
SB-2 @ 8.5'	1/22/2014	13:29	1,776	13,119	13:45	200	10	DAW
SB-2 @ 11'	1/22/2014	14:10	1,971	>2,500	14:46	20.0	1	DAW
SB-3 @ 0.5'	1/22/2014	14:15	2,355	Not Analyzed for TPH				
SB-3 @ 2'	1/22/2014	14:17	1,065	Not Analyzed for TPH				
SB-3 @ 5'	1/22/2014	14:20	178	Not Analyzed for TPH				
SB-3 @ 8'	1/22/2014	14:32	63.8	65.6	14:40	20.0	1	DAW
SB-3 @ 12'	1/22/2014	14:34	83.5	33.8	15:23	20.0	1	DAW
SB-4 @ surface	1/22/2014	14:36	2,838	Not Analyzed for TPH				
SB-4 @ 4'	1/22/2014	14:45	315	Not Analyzed for TPH				
SB-4 @ 6'	1/22/2014	14:50	312	20.5	15:56	20.0	1	DAW
SB-5 @ 4'	1/22/2014	15:01	26.4	36.4	16:06	20.0	1	DAW
SB-6 @ 1.5'	1/22/2014	15:25	15.5	Not Analyzed for TPH				

Sample ID	Collection Date	Collection Time	OVN (ppm)	TPH* (mg/kg)	TPH Analysis Time	TPH PQL (mg/kg)	DF	TPH Analysts Initials
SB-6 @ 4'	1/22/2014	15:30	43.1	211	16:09	20.0	1	DAW
SB-6 @ 7'	1/22/2014	15:36	42.0	Not Analyzed for TPH				
SB-7 @ surface	1/22/2014	11:30	362	169	16:03	20.0	1	DAW

DF Dilution Factor

NA Not Analyzed

ND Not Detected at the Reporting Limit

PQL Practical Quantitation Limit

*Field TPH concentrations recorded may be below PQL.

Total Petroleum Hydrocarbons - USEPA 418.1

Analyst:

Deborah Wata

AES Field Sampling Report

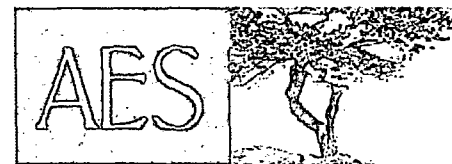

Animas Environmental Services, LLC

www.animasenvironmental.com

624 E. Comanche
Farmington, NM 87401
505-564-2281

Durango, Colorado
970-403-5084

Client: ConocoPhillips

Project Location: San Juan 29-7 #63

Date: 2/18/2014

Matrix: Soil

Sample ID	Collection Date	Collection Time	OVM (ppm)	Sample Location	TPH* (mg/kg)	TPH Analysis Time	TPH PQL (mg/kg)	DF	TPH Analysts Initials
SC-1	2/18/2014	12:42	404	North Wall	53.5	13:33	20.0	1	SL
SC-2	2/18/2014	12:35	7.5	South Wall	36.6	13:37	20.0	1	SL
SC-3	2/18/2014	12:47	36.6	East Wall	57.4	13:24	20.0	1	SL
SC-4	2/18/2014	12:50	24.2	West Wall	61.3	13:40	20.0	1	SL
SC-5	2/18/2014	13:50	1.0	Base	65.2	14:13	20.0	1	SL

DF Dilution Factor

NA Not Analyzed

ND Not Detected at the Reporting Limit

PQL Practical Quantitation Limit

**TPH concentrations recorded may be below PQL.*

Total Petroleum Hydrocarbons - USEPA 418.1

Analyst:

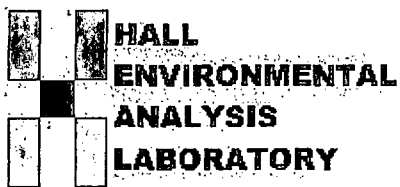

Hall Environmental Analysis Laboratory
4901 Hawkins NE
Albuquerque, NM 87109
TEL: 505-345-3975 FAX: 505-345-4107
Website: www.hallenvironmental.com

February 20, 2014

Debbie Watson
Animas Environmental
624 East Comanche
Farmington, NM 87401
TEL: (505) 486-4071
FAX

RE: CoP SJ 29-7 #63

OrderNo.: 1402689

Dear Debbie Watson:

Hall Environmental Analysis Laboratory received 1 sample(s) on 2/19/2014 for the analyses presented in the following report.

These were analyzed according to EPA procedures or equivalent. To access our accredited tests please go to www.hallenvironmental.com or the state specific web sites. In order to properly interpret your results it is imperative that you review this report in its entirety. See the sample checklist and/or the Chain of Custody for information regarding the sample receipt temperature and preservation. Data qualifiers or a narrative will be provided if the sample analysis or analytical quality control parameters require a flag. When necessary, data qualifiers are provided on both the sample analysis report and the QC summary report, both sections should be reviewed. All samples are reported, as received, unless otherwise indicated. Lab measurement of analytes considered field parameters that require analysis within 15 minutes of sampling such as pH and residual chlorine are qualified as being analyzed outside of the recommended holding time.

Please don't hesitate to contact HEAL for any additional information or clarifications.

ADHS Cert #AZ0682 -- NMED-DWB Cert #NM9425 -- NMED-Micro Cert #NM0190

Sincerely,

A handwritten signature in black ink, appearing to read "Andy Freeman".

Andy Freeman
Laboratory Manager
4901 Hawkins NE
Albuquerque, NM 87109

Hall Environmental Analysis Laboratory, Inc.

Analytical Report

Lab Order 1402689

Date Reported: 2/20/2014

CLIENT: Animas Environmental

Client Sample ID: SC-1

Project: CoP SJ 29-7 #63

Collection Date: 2/18/2014 12:42:00 PM

Lab ID: 1402689-001

Matrix: MEOH (SOIL)

Received Date: 2/19/2014 10:00:00 AM

Analyses	Result	RL	Qual	Units	DF	Date Analyzed	Batch
EPA METHOD 8021B: VOLATILES							Analyst: JMP
Benzene	ND	0.039		mg/Kg	1	2/19/2014 12:13:21 PM	R16838
Toluene	0.10	0.039		mg/Kg	1	2/19/2014 12:13:21 PM	R16838
Ethylbenzene	0.050	0.039		mg/Kg	1	2/19/2014 12:13:21 PM	R16838
Xylenes, Total	0.45	0.077		mg/Kg	1	2/19/2014 12:13:21 PM	R16838
Surr: 4-Bromofluorobenzene	98.3	80-120		%REC	1	2/19/2014 12:13:21 PM	R16838

Refer to the QC Summary report and sample login checklist for flagged QC data and preservation information.

Qualifiers:	* Value exceeds Maximum Contaminant Level.	B Analyte detected in the associated Method Blank
	E Value above quantitation range	H Holding times for preparation or analysis exceeded
	J Analyte detected below quantitation limits	ND Not Detected at the Reporting Limit
	O RSD is greater than RSDlimit	P Sample pH greater than 2.
	R RPD outside accepted recovery limits	RL Reporting Detection Limit
	S Spike Recovery outside accepted recovery limits	

QC SUMMARY REPORT

Hall Environmental Analysis Laboratory, Inc.

WO#: 1402689

20-Feb-14

Client: Animas Environmental

Project: CoP SJ 29-7 #63

Sample ID	MB-11782 MK	SampType:	MBLK	TestCode:	EPA Method 8021B: Volatiles					
Client ID:	PBS	Batch ID:	R16838	RunNo:	16838					
Prep Date:	2/18/2014	Analysis Date:	2/19/2014	SeqNo:	485044	Units:	mg/Kg			
Analyte	Result	PQL	SPK value	SPK Ref Val	%REC	LowLimit	HighLimit	%RPD	RPDLimit	Qual
Benzene	ND	0.050								
Toluene	ND	0.050								
Ethylbenzene	ND	0.050								
Xylenes, Total	ND	0.10								
Surr: 4-Bromofluorobenzene	0.85		1.000		85.4	80	120			

Sample ID	LCS-11782 MK	SampType:	LCS	TestCode:	EPA Method 8021B: Volatiles					
Client ID:	LCSS	Batch ID:	R16838	RunNo:	16838					
Prep Date:		Analysis Date:	2/19/2014	SeqNo:	485045	Units:	mg/Kg			
Analyte	Result	PQL	SPK value	SPK Ref Val	%REC	LowLimit	HighLimit	%RPD	RPDLimit	Qual
Benzene	1.0	0.050	1.000	0	104	80	120			
Toluene	1.1	0.050	1.000	0	108	80	120			
Ethylbenzene	1.1	0.050	1.000	0	105	80	120			
Xylenes, Total	3.2	0.10	3.000	0	107	80	120			
Surr: 4-Bromofluorobenzene	0.98		1.000		98.4	80	120			

OIL CONS. DIV DIST. 3
MAY 29 2014

Qualifiers:

- * Value exceeds Maximum Contaminant Level.
- E Value above quantitation range
- J Analyte detected below quantitation limits
- O RSD is greater than RSDlimit
- R RPD outside accepted recovery limits
- S Spike Recovery outside accepted recovery limits

- B Analyte detected in the associated Method Blank
- H Holding times for preparation or analysis exceeded
- ND Not Detected at the Reporting Limit
- P Sample pH greater than 2.
- RL Reporting Detection Limit

Sample Log-In Check List

Client Name: Animas Environmental

Work Order Number: 1402689

RcptNo: 1

Received by/date:

Logged By: **Michelle Garcia**

2/19/2014 10:00:00 AM

Michelle Garcia

Completed By: **Michelle Garcia**

2/19/2014 10:18:00 AM

Michelle Conner

Reviewed By:

Chain of Custody

1. Custody seals intact on sample bottles? Yes ☐ No ☐ Not Present ☒
2. Is Chain of Custody complete? Yes ☒ No ☐ Not Present ☐
3. How was the sample delivered? Courier

Log In

- | | | | |
|--|---|--|--|
| 4. Was an attempt made to cool the samples? | Yes <input checked="" type="checkbox"/> | No <input type="checkbox"/> | NA <input type="checkbox"/> |
| 5. Were all samples received at a temperature of $>0^{\circ}\text{C}$ to 6.0°C | Yes <input checked="" type="checkbox"/> | No <input type="checkbox"/> | NA <input type="checkbox"/> |
| 6. Sample(s) in proper container(s)? | Yes <input checked="" type="checkbox"/> | No <input type="checkbox"/> | |
| 7. Sufficient sample volume for indicated test(s)? | Yes <input checked="" type="checkbox"/> | No <input type="checkbox"/> | |
| 8. Are samples (except VOA and ONG) properly preserved? | Yes <input checked="" type="checkbox"/> | No <input type="checkbox"/> | |
| 9. Was preservative added to bottles? | Yes <input type="checkbox"/> | No <input checked="" type="checkbox"/> | NA <input type="checkbox"/> |
| 10. VOA vials have zero headspace? | Yes <input type="checkbox"/> | No <input type="checkbox"/> | No VOA Vials <input checked="" type="checkbox"/> |
| 11. Were any sample containers received broken? | Yes <input type="checkbox"/> | No <input checked="" type="checkbox"/> | |
| 12. Does paperwork match bottle labels?
(Note discrepancies on chain of custody) | Yes <input checked="" type="checkbox"/> | No <input type="checkbox"/> | |
| 13. Are matrices correctly identified on Chain of Custody? | Yes <input checked="" type="checkbox"/> | No <input type="checkbox"/> | |
| 14. Is it clear what analyses were requested? | Yes <input checked="" type="checkbox"/> | No <input type="checkbox"/> | |
| 15. Were all holding times able to be met?
(If no, notify customer for authorization.) | Yes <input checked="" type="checkbox"/> | No <input type="checkbox"/> | |
- # of preserved bottles checked for pH: (<2)

Adjusted? ☐

Checked by: _____

Special Handling (if applicable)

16. Was client notified of all discrepancies with this order? Yes ☐ No ☐ NA ☒

Person Notified:	<input type="text"/>	Date:	<input type="text"/>
By Whom:	<input type="text"/>	Via:	<input type="checkbox"/> eMail <input type="checkbox"/> Phone <input type="checkbox"/> Fax <input type="checkbox"/> In Person
Regarding:	<input type="text"/>		
Client Instructions:	<input type="text"/>		

- 17. Additional remarks:**

18. Cooler Information

Cooler No.	Temp. C	Condition	Seal Intact	Seal No.	Seal Date	Signed By
1	1.0	Good	Yes			

Client: Adamas Eavnon Mental Services

Mailing Address: 624 E. Comanche
Farmington, NM 87401

Phone #: (505) 564-2281

email or Fax#:

QA/QC Package:

☒ Standard ☐ Level 4: (Full Validation)

Accreditation:

☐ NELAP ☐ Other _____

☐ EDD (Type): _____

Project Name:
COP SJ 29-7 #63

Project #:	
------------	--

Project Manager:

D. Watson

On Ice: ☒ Yes ☐ No

Sample Temperature: 110

[illegible]

Date:	Time:	Relinquished by:
7/18/14	1:35	Stephane Lyon

Date: 2/19/14 Time: 1600 Relinquished by: Christine Warden

Received by:	Date	Time
<i>Chit Walt</i>	<i>2/18/14</i>	<i>1735</i>

Received by: Michelle Egan Date: 02/19/14 Time: 10

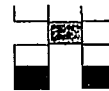

www.hallenvironmental.com

4901 Hawkins NE - Albuquerque, NM 87109

Tel. 505-345-3975 Fax 505-345-4107

Analysis Request

	X	BTEX + MDE E + PAH's PAH's (8021)
		BTEX + MTBE + TPH (Gas only)
		TPH 8015B (GRO / DRO / MRO)
		TPH (Method 418.1)
		EDB (Method 504.1)
		PAH's (8310 or 8270 SIMS)
		RCRA 8 Metals
		Anions ($F, Cl, NO_3, NO_2, PO_4, SO_4$)
		8081 Pesticides / 8082 PCB's
		8260B (VOA)
		8270 (Semi-VOA)
		Air Bubbles (Y or N)

OIL CONS DIV DIST. 3
MAY 29 2014

Remarks: Bill to Conoco Phillips

Bul to Conoco Phillips

If necessary, samples submitted to Hall Environmental may be subcontracted to other accredited laboratories. This serves as notice of this possibility. Any sub-contracted data will be clearly notated on the analytical report.