

District I
1625 N. French Dr., Hobbs, NM 88240
District II
1301 W. Grand Avenue, Artesia, NM 88210
District III
1000 Rio Brazos Road, Aztec, NM 87410
District IV
1220 S. St. Francis Dr., Santa Fe, NM 87505

State of New Mexico
Energy Minerals and Natural Resources

Form C-144
June 1, 2004

Oil Conservation Division
1220 South St. Francis Dr.
Santa Fe, NM 87505

For drilling and production facilities, submit to
appropriate NMOCD District Office.
For downstream facilities, submit to Santa Fe
office

Pit or Below-Grade Tank Registration or Closure

Is pit or below-grade tank covered by a "general plan"? Yes ☒ No ☐

(WFS CLOSURE)

Type of action: Registration of a pit or below-grade tank ☐ Closure of a pit or below-grade tank ☒

Operator: <u>CONOCOPHILLIPS COMPANY</u>		Telephone:		e-mail address:	
Address: <u>PO BOX 2197 HOUSTON, TX 77252</u>					
Facility or well name: <u>SAN JUAN 30 5 UNIT #085</u>		API #: <u>30-039-23129</u>		U/L or Qtr/Qtr <u>M</u> SEC <u>36</u> T <u>30N</u> R <u>5W</u>	
County: <u>RIO ARRIBA</u>		Latitude		Longitude	
Surface Owner: Federal <input type="checkbox"/> State <input checked="" type="checkbox"/> Private <input type="checkbox"/> Indian <input type="checkbox"/>				NAD: 1927 <input checked="" type="checkbox"/> 1983 <input type="checkbox"/>	
Pit Type: Drilling <input type="checkbox"/> Production <input checked="" type="checkbox"/> Disposal <input type="checkbox"/> Workover <input type="checkbox"/> Emergency <input type="checkbox"/> Lined <input type="checkbox"/> Unlined <input checked="" type="checkbox"/> Liner Type: Synthetic <input checked="" type="checkbox"/> Thickness _____ mil Clay <input type="checkbox"/> Pit Volume <u>120</u> bbl		Below-grade tank Volume: _____ bbl Type of fluid: _____ Construction Material: _____ Double-walled, with leak detection? Yes <input type="checkbox"/> If not, explain why not.			
Depth to ground water (vertical distance from bottom of pit to seasonal high water elevation of ground water.)		Less than 50 feet 50 feet or more, but less than 100 feet 100 feet or more		(20 points) (10 points) (0 points) <u>0</u>	
Wellhead protection area: (Less than 200 feet from a private domestic water source, or less than 1000 feet from all other water sources.)		Yes No		(20 points) (0 points) <u>0</u>	
Distance to surface water: (Horizontal distance to all wetlands, playas, irrigation canals, ditches, and perennial and ephemeral watercourses.)		Less than 200 feet 200 feet to 1,000 feet Greater than 1,000 feet		(20 points) (10 points) (0 points) <u>0</u>	
		Ranking Score (TOTAL POINTS):		<u>0</u>	

If this is a pit closure: (1) Attach a diagram of the facility showing the pit's relationship to other equipment and tanks. (2) Indicate disposal location: (check the onsite box if you are burying in place) onsite ☒ offsite ☐ If offsite, name of facility _____. (3) Attach a general description of remedial action taken including remediation start date and end date. (4) Groundwater encountered: No ☒ Yes ☐ If yes, show depth below ground surface _____ ft. and attach sample results. (5) Attach soil sample results and a diagram of sample locations and excavations.

Additional Comments:

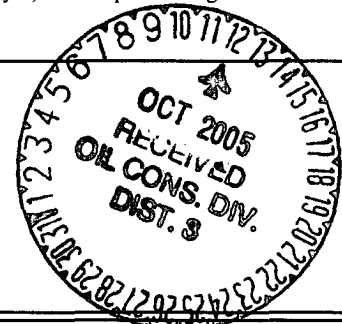

I hereby certify that the information above is true and complete to the best of my knowledge and belief. I further certify that the above-described pit or below-grade tank has been/will be constructed or closed according to NMOCD guidelines ☐, a general permit ☐, or an (attached) alternative OCD-approved plan ☒

Date: 9/9/05

Printed Name/Title Mark Harvey for Williams Field Services Signature Mark Harvey, for WFS

Your certification and NMOCD approval of this application/closure does not relieve the operator of liability should the contents of the pit or tank contaminate ground water or otherwise endanger public health or the environment. Nor does it relieve the operator of its responsibility for compliance with any other federal, state, or local laws and/or regulations.

Approval:

Printed Name/Title DEPUTY OIL & GAS INSPECTOR, DIST. 3

Signature Denny Felt

OCT 12 2005
Date: _____

ADDENDUM TO OCD FORM C-144

Operator: CONOCOPHILLIPS COMPANY

API: 30-039-23129

Well Name: SAN JUAN 30 5 UNIT #085

Meter: 85802

Facility Diagram:

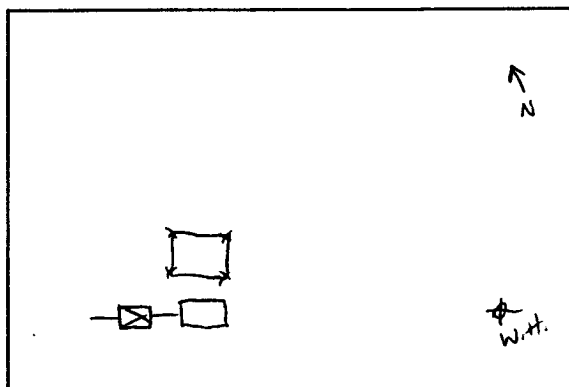

Sampling Diagram:

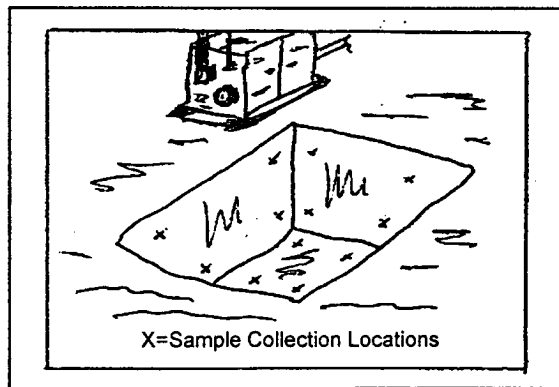

Pit Dimensions

Length 15 Ft.

Width 15 Ft.

Depth 3 Ft.

Location of Pit Center

Latitude

Longitude

(NAD 1927)

Pit ID

858021

Pit Type

Unknown

Date Closure Started: 4/18/03

Closure Method: Pushed In

Date Closure Completed: 4/18/03

Bedrock Encountered ? ☐

Cubic Yards Excavated:

Vertical Extent of Equipment Reached ? ☐

Description Of Closure Action:

The pit was assessed and sampled in accordance with NMOCD guidelines. Based on assessment findings, the pit was backfilled.

Assessment sample showed no evidence of hydrocarbon impact - 0 ppm headspace

Pit Closure Sampling:

Sample ID	Sample Date	Head Space	BTEX Total (mg/kg)	Benzene (mg/kg)	TPH DRO (mg/kg)	Purpose	Location	Depth
-----------	-------------	------------	--------------------	-----------------	-----------------	---------	----------	-------

--	--	--	--	--	--	--	--	--